

CITY OF SACRAMENTO  
1231 I Street, Sacramento, CA 95814

Permit No: 9811944  
Insp Area: 2

Site Address: 4074 WEYMOUTH LN SAC  
Parcel No: 0490310013

Sub-Type: COM  
Housing (Y/N): N

CONTRACTOR  
EAGLE ELECTRIC(AUBURN)  
11890 ENTERPRISE RD  
AUBURN CA 95603

OWNER  
GATLIN CYNTHIA AMELIA  
9221 GAMBIER CT  
SACRAMENTO CA 95829

ARCHITECT

Nature of Work: INSTALL/UPGRADE SECURITY LIGHTING

CONSTRUCTION LENDING AGENCY : I hereby affirm under penalty of perjury that there is a construction lending agency for the performance of the work for which this permit is issued (Sec. 3097, Civ. C).

Lender's Name \_\_\_\_\_ Lender's Address \_\_\_\_\_

LICENSED CONTRACTORS DECLARATION: I hereby affirm under penalty of perjury that I am licensed under provisions of Chapter 9 (commencing with section 7000) of Division 3 of the Business and Professions Code and my license is in full force and effect.

License Class C-10 License Number 589066 Date 12-3-98 Contractor Signature [Signature]

OWNER-BUILDER DECLARATION: I hereby affirm under penalty of perjury that I am exempt from the contractors License Law for the following reason (Sec. 7031.5, Business and Professions Code; any city or county which requires a permit to construct, alter, improve, demolish, or repair any structure, prior to its issuance, also requires the applicant for such permit to file a signed statement that he or she is licensed pursuant to the provisions of the Contractors License Law (Chapter 9 (commencing with Section 7000) of Division 8 of the Business and Professions Code) or that he or she is exempt therefrom and the basis for the alleged exemption. Any violation of Section 7031.5 by any applicant for a permit subjects the applicant to a civil penalty of not more than five hundred dollars (\$500.00);

I, as a owner of the property, or my employees with wages as their sole compensation, will do the work, and the structure is not intended or offered for sale (Sec. 7044, Business and Professional Code: The Contractors License Law does not apply to an owner of property who builds or improves thereon, and who does such work himself or herself or through his/her own employees, provided that such improvements are not intended or offered for sale. If, however, the building or improvement is sold within one year of completion, the owner-builder will have the burden of proving that he/she did not build or improve for the purpose of sale.)

I, as owner of the property, am exclusively contracting with licensed contractors to construct the project (Sec. 7044, Business and Professions Code: The Contractors License Law does not apply to an owner of property who builds or improves thereon, and who contracts for such projects with a contractor(s) licensed pursuant to the Contractors License Law).

I am exempt under Sec. \_\_\_\_\_ B & PC for this reason: \_\_\_\_\_

Date \_\_\_\_\_ Owner Signature \_\_\_\_\_

IN ISSUING THIS BUILDING PERMIT, the applicant represents, and the city relies on the representation of the applicant, that the applicant verified all measurements and locations shown on the application or accompanying drawings and that the improvement to be constructed does not violate any law or private agreement relating to permissible or prohibited locations for such improvements. This building permit does not authorize any illegal location of any improvement or the violation of any private agreement relating to location of improvements.

I certify that I have read this application and state that all information is correct. I agree to comply with all city and county ordinances and state laws relating to building construction and hereby authorize representative(s) of this city to enter upon the abovementioned property for inspection purposes.

Date 12-3-98 Applicant/Agent Signature [Signature]

WORKER'S COMPENSATION DECLARATION: I hereby affirm under penalty of perjury one of the following declarations:

I have and will maintain a certificate of consent to self-insure for workers' compensation as provided for by Section 3700 of the Labor Code, for the performance of work for which the permit is issued.

I have and will maintain workers' compensation insurance, as required by Section 3700 of the Labor Code, for the performance of the work for which this permit is issued. My workers' compensation insurance carrier and policy number are:

Carrier Ca Indem Policy Number N5043441B Exp Date 3-99

(This section need not be completed if the permit is for \$100 or less) I certify that in the performance of the work for which this permit is issued, I shall not employ any person in any manner so as to become subject to the workers' compensation laws of California and agree that if I should become subject to the workers' compensation provisions of Section 3700 of the Labor Code, I shall forthwith comply with those provisions.

Date 12-3-98 Applicant Signature [Signature]

WARNING: FAILURE TO SECURE WORKER'S COMPENSATION COVERAGE IS UNLAWFUL AND SHALL SUBJECT AN EMPLOYER TO CRIMINAL PENALTIES AND CIVIL FINES UP TO ONE HUNDRED THOUSAND DOLLARS (\$100,000) IN ADDITION TO THE COST OF COMPENSATION, DAMAGES AS PROVIDED FOR IN SECTION 3706 OF THE LABOR CODE, INTEREST AND ATTORNEY'S FEE.

THIS PERMIT SHALL EXPIRE BY LIMITATION IF WORK IS NOT COMMENCED WITHIN 180 DAYS.



① - 150 W MH  
 70 lbs / COMPACT

← Wilburwood

→ Brookfield

Townhouses  
 Location of  
 Fixtures by  
 ADDRESS - All  
 150 W - M.H.

2. ←

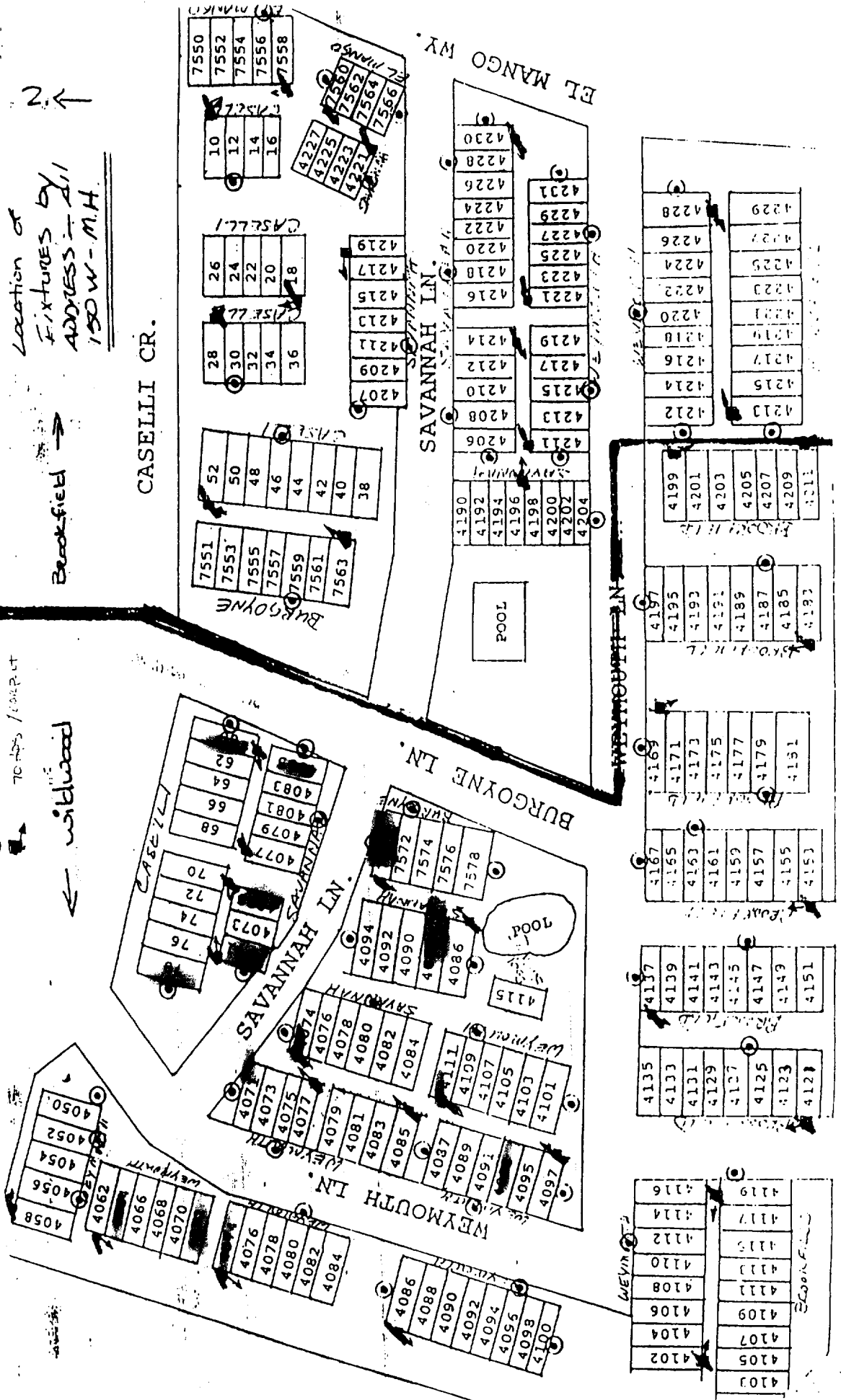

Permit (9) wild wood (carports)

4187 Brookfield

4183

4175

4167

4153

4145

4135

4129

4121

4117

4103

4106 Weymouth

4096

4090

4084

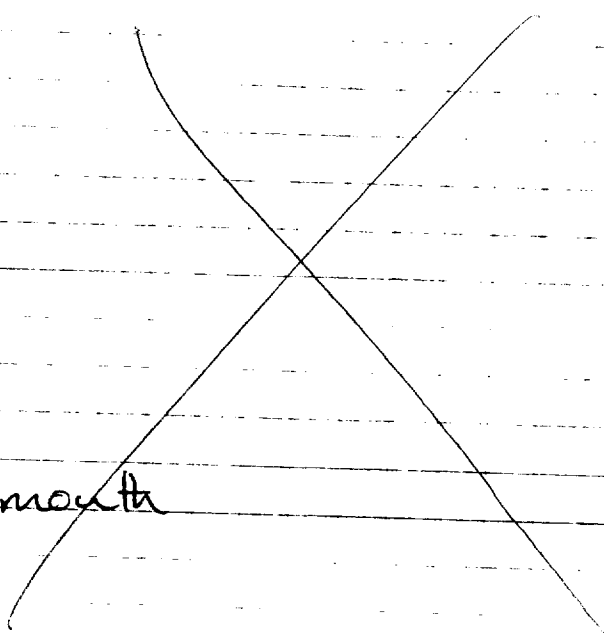

Permit (10) wild wood (carports)

4074 Weymouth Lane

4072

4064

4053

4171

4111

4074 Savannah Lane

4071

4075

4085

4088

78 Caselli Cir  
620

7570 Burgoyne ~~Way~~ Lane

# FRANKLIN VILLA

## Statement of Work

### Task A

Install flexible conduit and fittings over exposed existing wiring from exterior to existing panel in laundry room in Morrison Creek Estates and strap conduits per NEC.

### Task B

Install surface extension box and reroute existing conduit to side of box per NEC in laundry rooms in Morrison Creek Estates, Terrace and Commons.

### Task C

Replace existing non-raintite fittings with raintite fittings on building exteriors and strap existing conduits in Morrison Creek Terrace and Commons.

### Task D

Extend conduits to raise fixture location in Morrison Creek Terrace and Commons.

### Task E

Install new conduit and conductors from laundry room to new fixture location between bedroom windows in Morrison Creek Terrace and Commons.

### Task F

Trench and install new rigid conduit from carport to existing fixture location in Wildwood Area.

### Task G

Extend conduit and install new 150 Watt MH Flood at gable top in Wildwood Area.

### Task H

Install recycled HPS Floodlite on existing circuit on carport face in Wildwood Area.

### Task I

Install 150 Watt MH Flood on existing pole light adjacent swimming pools.