

CITY OF SACRAMENTO
1231 I Street, Sacramento, CA 95814

Permit No: 0417605
Insp Area: 4
Thos Bros: 256-J6

Site Address: 4941 KOKOMO DR SAC
Parcel No: CREEKSIDE 14 VIL 1 LOT #59

Sub-Type: NSFR
Housing (Y/N): N

CONTRACTOR
JOHN IAING HOMES
1536 EUREKA RD STE 100
ROSEVILLE CA. 95661

OWNER

ARCHITECT

Nature of Work: MP 2131 2 STORY 9 ROOM SFR

CONSTRUCTION LENDING AGENCY: I hereby affirm under penalty of perjury that there is a construction lending agency for the performance of the work for which this permit is issued (Sec. 3097, Civ. C).

Lender's Name _____ Lender's Address _____

LICENSED CONTRACTORS DECLARATION: I hereby affirm under penalty of perjury that I am licensed under provisions of Chapter 9 (commencing with section 7000) of Division 3 of the Business and Professions Code and my license is in full force and effect.

License Class B License Number 687596 Date _____ Contractor Signature [Signature]

OWNER-BUILDER DECLARATION: I hereby affirm under penalty of perjury that I am exempt from the contractors License Law for the following reason (Sec. 7031.5, Business and Professions Code; any city or county which requires a permit to construct, alter, improve, demolish, or repair any structure, prior to its issuance, also requires the applicant for such permit to file a signed statement that he or she is licensed pursuant to the provisions of the Contractors License Law (Chapter 9 (commencing with Section 7000) of Division 8 of the Business and Professions Code) or that he or she is exempt therefrom and the basis for the alleged exemption. Any violation of Section 7031.5 by any applicant for a permit subjects the applicant to a civil penalty of not more than five hundred dollars (\$500.00);

I, as a owner of the property, or my employees with wages as their sole compensation, will do the work, and the structure is not intended or offered for sale (Sec. 7044, Business and Professional Code: The Contractors License Law does not apply to an owner of property who builds or improves thereon, and who does such work himself or herself or through his/her own employees, provided that such improvements are not intended or offered for sale. If, however, the building or improvement is sold within one year of completion, the owner-builder will have the burden of proving that he/she did not build or improve for the purpose of sale.)

I, as owner of the property, am exclusively contracting with licensed contractors to construct the project PAID Business and Professions Code: The Contractors License Law does not apply to an owner of property who builds or improves thereon, and who contracts for such projects with a contractor(s) licensed pursuant to the Contractors License Law.

I am exempt under Sec. _____ B & PC for this reason: _____
Date _____ Owner Signature [Signature]

NOV 21 2004
NORTH PERMITS
CENTER

IN ISSUING THIS BUILDING PERMIT, the applicant represents, and the city relies on the representation of the applicant, that the applicant verified all measurements and locations shown on the application or accompanying drawings and that the improvement to be constructed does not violate any law or private agreement relating to permissible or prohibited locations for such improvements. This building permit does not authorize any illegal location of any improvement or the violation of any private agreement relating to location of improvements.

I certify that I have read this application and state that all information is correct. I agree to comply with all city and county ordinances and state laws relating to building construction and hereby authorize representative(s) of this city to enter upon the abovementioned property for inspection purposes.

Date 11-24-04 Applicant/Agent Signature [Signature]

WORKER'S COMPENSATION DECLARATION: I hereby affirm under penalty of perjury one of the following declarations:
I have and will maintain a certificate of consent to self-insure for workers' compensation as provided for by Section 3700 of the Labor Code, for the performance of work for which the permit is issued.

I have and will maintain workers' compensation insurance, as required by Section 3700 of the Labor Code, for the performance of the work for which this permit is issued. My workers' compensation insurance carrier and policy number are:

Carrier LUMBERMANS MUTUAL Policy Number 3BA16432400 Exp Date 04/15/2005

(This section need not be completed if the permit is for \$100 or less) I certify that in the performance of the work for which this permit is issued, I shall not employ any person in any manner so as to become subject to the workers' compensation laws of California and agree that if I should become subject to the workers' compensation provisions of Section 3700 of the Labor Code, I shall forthwith comply with those provisions.

Date 11-24-04 Applicant Signature [Signature]

WARNING: FAILURE TO SECURE WORKER'S COMPENSATION COVERAGE IS UNLAWFUL AND SHALL SUBJECT AN EMPLOYER TO CRIMINAL PENALTIES AND CIVIL FINES UP TO ONE HUNDRED THOUSAND DOLLARS (\$100,000) IN ADDITION TO THE COST OF COMPENSATION, DAMAGES AS PROVIDED FOR IN SECTION 3706 OF THE LABOR CODE, INTEREST AND ATTORNEY'S FEE.

THIS PERMIT SHALL EXPIRE BY LIMITATION IF WORK IS NOT COMMENCED WITHIN 180 DAYS.



INSULATION CONTRACTORS ASSOCIATION OF AMERICA

INSULATION CERTIFICATE
53024

1321 DUKE STREET, SUITE 303 • ALEXANDRIA, VA 22314 • (703) 739-0356

THIS IS TO CERTIFY THAT INSULATION HAS BEEN INSTALLED IN CONFORMANCE WITH CURRENT ENERGY REGULATIONS, CALIFORNIA ADMINISTRATIVE CODE, TITLE 24, STATE OF CALIFORNIA, IN THE BUILDING LOCATED AT:

John Laing LOT # 59 TRACT # Serenity
STREET Kokomo Dr CITY Natomas

EXTERIOR WALLS:
MANUFACTURER AG THICKNESS/TYPE 3 1/8 R-VALUE 13

CEILINGS:
BATT'S:
MANUFACTURER AG THICKNESS/TYPE 10 R-VALUE 30
BLOWN IN: Insulated MINIMUM THICKNESS 12 R-VALUE 30
MANUFACTURER Insulated

SQUARE FOOTAGE COVERED 1200 NUMBER OF BAGS USED 22
FLOORS:
MANUFACTURER THICKNESS/TYPE VALUE
SLAB ON GRADE: THICKNESS/TYPE VALUE
MANUFACTURER THICKNESS/TYPE VALUE

WIDTH OF INSULATION INCHES
FOUNDATION WALLS:
MANUFACTURER THICKNESS/TYPE R-VALUE

GENERAL CONTRACTOR
CALIFORNIA CONTRACTORS LICENSE # _____ DATE _____

SIGNATURE _____ TITLE _____

INSULATION CONTRACTOR ARCADE INSULATION

CALIFORNIA CONTRACTORS LICENSE #815286
NEVADA CONTRACTORS LICENSE #0055201

Signature: *Becky Laing* DATE: 7/20/05
TITLE: Inspector

KwikKote

No. 200-924224

Stucco System

Installation Card

Job Name: Serenity @ Creekside

Address: 4941 KOKOMO DRIVE

Permit # - 0417605

Lot #: 0000059

Stucco System Trade Name: KWIK KOTE

Stucco System Manufacturer: KWIK KOTE CORP.

ICBO Evaluation Service, Inc.

Report No. 3607

Date of Job Completion:

Home Builder: JOHN LAING HOMES

Address: 1544 EUREKA RD SUITE 250

ROSEVILLE, CA

Stucco Contractor: KENYON PLASTERING, INC.

Address: PO BOX 2077

North Highlands, CA

Telephone Number: 916/349-8191

Approved Contractor Number as
issued by the Stucco Manufacturer: 1001

Card Print Date: 11/30/2004

This is to certify that the stucco system on the building exterior at the above address had been installed in accordance with the evaluation report specified above and the manufacturer's instructions.

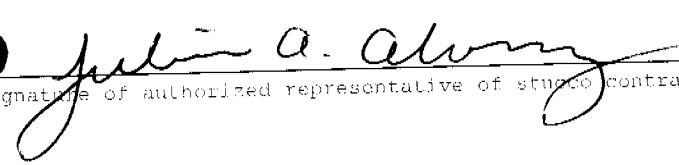
Signature of authorized representative of stucco contractor

5-17-05
Date

INSTALLATION CERTIFICATE

CF-6R

John Laing Homes - Creekside

Permit Number
0417605

An installation certificate is required to be posted at the building site or made available for all appropriate inspections. (The information provided on this form is required; however, use of this form to provide the information is optional.) After completion of final inspection a copy must be provided to the building department (upon request) and the building owner at occupancy, per Section 10-103(b).

LOT 57

HVAC SYSTEMS:

Heating Equipment

Equip. Type (pkg. Heat pump)	CEC Certified Mfr name and Model #	# of Identical Systems	(1) Efficiency (AFUE, etc.) > CF-1R value	Duct Location (attic, etc.)	Duct or Piping R-value	Heating Load (Btu/hr)	Heating Capacity (Btu/hr)	
Furnace	York P4HUA12L04801	1	0.80	Attic	R-6	18,398	60,000	Plan 1
Furnace	York P4HUA12L04801	1	0.80	Attic	R-6	27,032	80,000	Plan 2
Furnace	York P4HUB16L6401	1	0.80	Attic	R-6	30,441	80,000	Plan 3
Furnace	York P4HUA12L04801	1	0.80	Attic	R-6	25,183	100,000	Plan 4

Cooling Equipment

Equip. Type (pkg. Heat pump)	CEC Certified Compressor Unit Mfr Name and Model #	# of Identical Systems	(1) Efficiency (SEER, etc.) > CF-1R Value	Duct Location (attic, etc.)	Duct R-value	Cooling Load (Btu/hr)	Cooling Capacity (Btu/hr)	
Condenser	York H*RC024 *	1	13.0	Attic	R-6	16,989	23,400	Plan 1
Condenser	York H*RC030 *	1	13.0	Attic	R-6	19,658	29,400	Plan 2
Condenser	York H*RC030 *	1	13.0	Attic	R-6	21,746	29,400	Plan 3
Condenser	York H*RE024 *	1	14.0	Attic	R-6	17,996	24,000	Plan 4

***TXV - Indicates Thermal Expansion Valve On Coil**

(1) > reads greater than or equal to.
I, the undersigned, verify that equipment listed above is: 1) the actual equipment installed, 2) equivalent to or more efficient than that specified in the certificate of compliance (Form CF-1R) submitted for compliance with the *Energy Efficiency Standards* for residential buildings, and 3) equipment that meets or exceeds the appropriate requirements for manufactured devices (from the *Appliance Efficiency Regulations* or Part 6), where applicable.

Beutler Corporation

Signature, Date

OR General Contractor (Co. Name) OR Owner

WATER HEATING SYSTEMS:

Heater Type	CEC Certified Mfr Name & Model #	Distribution Type (Std, point of use)	If Recirculation Control Type	# of Identical Systems	(2) Rated Input (kW or Btu/hr)	Tank Volume (gallons)	(2) Efficiency (EF,RE)	(2) Standby Loss (%)	External Insulation R-value

(2) For small gas storage (rated input of less than or equal to 75,000 Btu/hr), electric resistance and heat pump water heaters, list Energy Factor. For large gas storage water heaters (rated input of greater than 75,000 Btu/hr), list Recovery Efficiency, Standby Loss and Rated Input. For instantaneous gas water heaters, list Recovery efficiency and Rated Input.
(3) R-12 external insulation is mandatory for storage water heaters with an energy factor of less than 0.58.

Facets & Shower Heads:

All facets and showerheads installed are certified to the Commission, pursuant to Title 24, Part 6, Section 111.

I, the undersigned, verify that equipment listed above my signature is: 1) the actual equipment installed; 2) equivalent to or more efficient than that specified in the certificate of compliance (Form CF-1R) submitted for compliance with the *Energy Efficiency Standards* for residential buildings; and 3) equipment that meets or exceeds the appropriate requirements for manufactured devices (from the *Appliance Efficiency Regulations* or Part 6), where applicable.

Signature, Date

Installing Subcontractor (Co. Name)
OR General Contractor (Co. Name) OR Owner

COPY TO: Building Department
HERS Provider (if applicable)
Building Owner at Occupancy

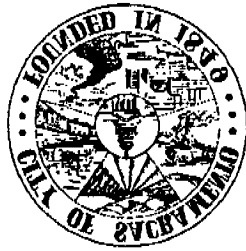

ALTERNATE MATERIALS OR METHODS

Lot 59
P# - 0417605

Permission has been granted for the installation of:

VANGUARD Manablock system
Job name/location Serenity / Crestside Parcel 14
Total no. of buildings 148 Dwellings

REQUIREMENTS

1. Permission is granted to above named address only.
2. Installers must be certified by manufacturers and city of Sacramento.
3. Manufactures installation instructions must be on jobsite and available to inspectors.
4. This notice must be posted on jobsite with permits.
5. Permission to use alternate materials or methods can be revoked if found to have been unlawfully issued.
6. This permission has been granted per the following code sections:
CPC 301.2—CMC 105.0—CBC 104.2.8—CEC 90-2

Administrative Authority
Keith A. Winkle
CHIEF PLUMBING INSPECTOR

9/29/04
Date

I request permission to use the product or method shown above. I am the legal owner/or authorized agent of owner.

NAME: _____

DATE: _____

Lot 59

170 Sliding Patio Door

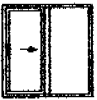

4 1/2" Jamb with 1 3/8" Fin Set-Back

4 1/2" Jamb with Flush Fin (Stucco)

T-Bar

Door Mull Bar

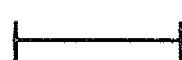

Size Limitations

XO

Minimum Width: 5'0"
Maximum Width: 8'0"

Minimum Height: 6'8"
Maximum Height: 8'0"

OXXO

Minimum Width: 10'0"
Maximum Width: 12'0"
Minimum Height:
Maximum Height:



XOO/OOX

Minimum Width: 9'0"

Minimum Height: 6'8"

Thermal Testing (NFRC 100-97)



Clear

0.5

Argon

0.48

Low-E

0.35

Low-E/Argon

0.31

Solar Heat Gain Coefficient

3/4" air Clear, Steel Spacer, Clear: Res-.64 / Non Res-.6
3/4" air LowE.04, Steel Spacer, Clear: Res-.34 / Non Res-.3

Structural Testing (AAMA 101-97)

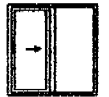

Class

Uniform Load

Wind Velocity(mph)



Water Penetration(psf)

Air@25(mph) Infiltration(cfm/ft2)

Insulated 8888

LC25 / *C30*

37.5 / *45*

122.5 / *134*

3.75 / *5.25*

.15 / *.06*

Insulated

9888 / 128610

R20

30

110

5.25

0.09

Single Glass

128610

R20

30

110

3.75

0.15

Visible Light Transmittance

3/4" air Clear, Steel Spacer, Clear: Res-.67 / Non Res-.6
3/4" air LowE.04, Steel Spacer, Clear: Res-.59 / Non Res-.5

** Commercial Rating is available only if it is stated on purchase order when order is placed.

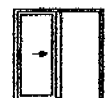

STC Ratings

DS/DS 28

DS / Lam 33

3/16 / 3/16 31

Fix Lam/Lam Vent Lam/DS 34

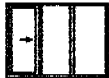

Lam / Lam 35*

* Max Door Panel 24' FT2

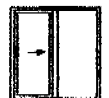

Colors Available:

- *White
- *Almond
- *Bronze Exterior / White Interior

Lot 59

570 Single Hungs

AKA 70 Series

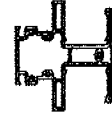
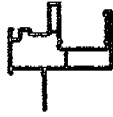

2 5/8" Jamb with 1 3/8" Fin Set-Back

2 5/8" Jamb with 7/8" Fin Set-Back

2 5/8" Jamb with J-Channel

Dual Pocket Bar - Used with Multiple SH to substitute mulling windows.



Size Limitations

SH

Minimum Width:	13"	Minimum Height:	20"
Minimum Width:	10"	Minimum Height:	26"
Maximum Width:	40"	Maximum Height:	80"
Maximum Area	24 sq ft	Fixed Lite	
	12 sq ft	Vent Lite	

Multiple SH

Minimum Width:	26"	Minimum Height:	20"
Minimum Width:	20"	Minimum Height:	26"
Maximum Width:	90"	Maximum Height:	80"
Maximum Area:	40 sq ft of perimeter frame or 4-SH wide		



Thermal Testing (NFRC 100.97)

Clear	Argon	Low-E	Low-E/Argon
0.50	0.48	0.35	0.32

Solar Heat Gain Coefficient

5/8" air Clear, Steel Spacer, Clear:	Res-.61 / Non Res-.59
5/8" air LowE.04, Steel Spacer, Clear:	Res-.32 / Non Res-.33



Structural Testing AAMA 101-97)

Test	Insulated 4wSH	Insulated
	12060	4080
Class:	R15	LC25
Uniform Load	22.5	37.5
Window Velocity(mph)	95	122.5
Water Penetration(psf)	4.5	6.00
Air@(mph) Infiltration(cfm/R2)	0.09	0.08

Visible Light Transmittance

Single Glaze 4060	5/8" air Clear, Steel Spacer, Clear	Res-.64 / Non Res-.65
	5/8" air LowE.04, Steel Spacer, C	Res-.55 / Non Res-.57



Egress Information

Minimum:	2660
Minimum:	3050

STC Ratings

SS/SS	27
DS/DS	31
DS / 3/16	33



Clear Opening Calculations

Width: Rough opening width minus 3.8125 (3 13/16")
 Height: Vent callout divided by 2 minus 3.375 (3 3/8")
 Minimum Clear Opening Width: 20" Minimum Clear Opening Height: 24"
 Check local codes for Egress requirements



Colors Available

- *White
- *Almond

LOT 59

770 Picture and Radius Windows

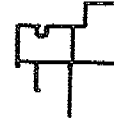
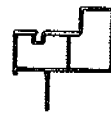
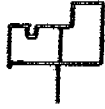

2 5/8" Jamb with 1 3/8" Fin Set-Back

2 5/8" Jamb with 7/8" Fin Set-Back

2 5/8" Jamb with J-Channel

Size Limitations



PW

Minimum Width:	12"	Minimum Height:	12"
Minimum Width:	8"	Minimum Height:	13"
Maximum Width:	8'0"	Maximum Height:	6'0"

Maximum Area: 40 sq ft (per perimeter frame and single lite)

Quarter Rounds

Minimum:	18"Radius	Maximum:	48"Radius
----------	-----------	----------	-----------

Ovals

Minimum:	24"Wide 36"High	Maximum:	36"Wide 72"High
----------	--------------------	----------	--------------------



Half Rounds

Minimum:	9"Radius	Maximum:	36"Radius
----------	----------	----------	-----------

Full Rounds

Minimum:	18"Diameter	Maximum:	48"Diameter
----------	-------------	----------	-------------

Eyebrow/Arch Top

Minimum:	36"Wide 12"High	Maximum:	96"Wide 60"High
----------	--------------------	----------	--------------------

Round Tops

Minimum:	18"Wide 36"High	Maximum:	72"Wide 72"High
----------	--------------------	----------	--------------------



Arch Tops

Minimum:	36"Wide 24"High	Maximum:	72"Wide 72"High
----------	--------------------	----------	--------------------

Octagons

Minimum:	18"Wide 18"High	Maximum:	60"Wide 60"High
----------	--------------------	----------	--------------------



**Any shape window with a leg must have a minimum 6" leg

Thermal Testing (NFRC 101.01)

Clear	Argon	Low-E	Low-E/Argon
0.50	0.47	0.34	0.30

Solar Heat Gain Coefficient

5/8"air Clear, Steel Spacer, Clear:	Res-.67 / Non Res-.63
5/8"air LowE.04, Steel Spacer, Clear:	Res-.35 / Non Res-.35



Structural Testing (AAMA 101-97)



	Insulated 8060	Single Glaze 8060
Class	C30	LC25
Uniform Load PSF	45	37.5
Wind Velocity MPH	134	122.5
Water Penetration(psf)	9.00	9.00
Air@25(mph) Infiltration(cfm/ft2)	0.01	0.01

Visible Light Transmittance

5/8"air Clear, Steel Spacer, Clear:	Res-.71 / Non Res-.70
5/8"air LowE.04, Steel Spacer, Clear:	Res-.62 / Non Res-.61



STC Ratings

SS/SS	27
DS/DS	29
DS / 3/16	33



Colors Available

- *White
- *Almond

All information is subject to change

12/13/2004

THIS PLOT PLAN IS FOR THE PURPOSES OF INDICATING COMPLIANCE WITH ZONING SET BACKS, GENERAL DRAINAGE DIRECTION, AND APPROXIMATE UTILITY CONNECTION. ALL OTHER DATA SHOWN HEREON IS CONCEPTUAL. THIS PLOT PLAN DOES NOT REFLECT AS-BUILT CONDITION, RETAINING WALLS AND WALKWAY STEPS ARE OPTIONAL AND MAY OR MAY NOT BE CONSTRUCTED. CHANGES IN THE FIELD WHICH ARE INCONSISTENT WITH THIS PLAN SHALL BE SUBJECT TO VERBAL, FOLLOWED BY WRITTEN APPROVAL BY THE CITY OF SACRAMENTO.

ALLEY P

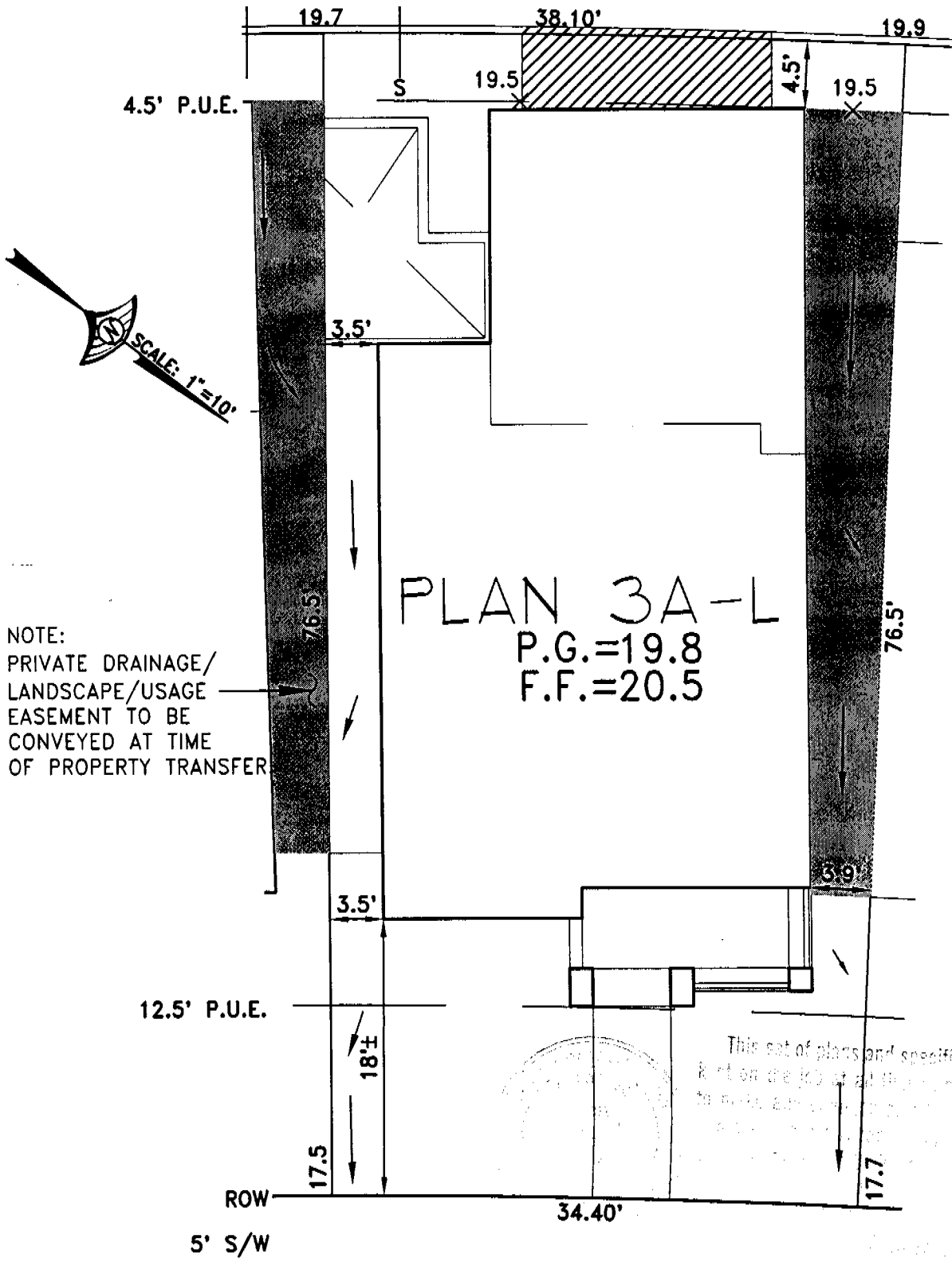

NOTE:
PRIVATE DRAINAGE/
LANDSCAPE/USAGE
EASEMENT TO BE
CONVEYED AT TIME
OF PROPERTY TRANSFER

PLAN 3A-L
P.G.=19.8
F.F.=20.5

KOKOMO DRIVE

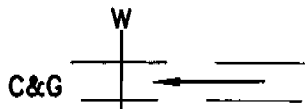

4944 KOKOMO DRIVE

- ☐ - UTILITY VAULT
- ☐ - TRANSFORMER
- ☐ - UTILITY SERVICE BOX
- - STREET LIGHT
- - FIRE HYDRANT

A.P.N.:
LOT FOOTAGE: 2773 SQ. FT.
ADDRESS: _____ KOKOMO DRIVE
CITY OF SACRAMENTO

CREEKSIDE VILLAGE 14-1
JOHN LAING HOMES
PLOT PLAN FOR LOT 59



WOOD RODGERS
ENGINEERING • MAPPING • PLANNING • SURVEYING

3301 C St, Bldg. 100-B Tel 916.341.7760
Sacramento, CA 95816 Fax 916.341.7767

DATE: SEPTEMBER 2004	DRAWN: JNC	CHECKED:	JOB #: 1035.031
-------------------------	---------------	----------	--------------------

