

**CITY OF SACRAMENTO**  
1231 I Street, Sacramento, CA 95814

**Permit No: 0011007**  
**Insp Area: 4**

**Site Address: 2425 MAYBROOK DR SAC**  
Parcel No: 201-0390-066 NORTHBR VIL 6-2 LOT 63

Sub-Type: NSFR  
Housing (Y/N): N

CONTRACTOR  
US HOME  
2366 GOLD MEADOW DR STE 100  
GOLD RIVER, CA 95670 77041

OWNER

ARCHITECT

**Nature of Work: MP 2489 1 STORY 8 ROOM SFR**

**CONSTRUCTION LENDING AGENCY :** I hereby affirm under penalty of perjury that there is a construction lending agency for the performance of the work for which this permit is issued (Sec. 3097, Civ. C).

Lender's Name \_\_\_\_\_ Lender's Address \_\_\_\_\_

**LICENSED CONTRACTORS DECLARATION:** I hereby affirm under penalty of perjury that I am licensed under provisions of Chapter 9 (commencing with section 7000) of Division 3 of the Business and Professions Code and my license is in full force and effect.

License Class B License Number 451839 Date 9/29/00 Contractor Signature Don McCloskey

**OWNER-BUILDER DECLARATION:** I hereby affirm under penalty of perjury that I am exempt from the contractors License Law for the following reason (Sec. 7031.5, Business and Professions Code: any city or county which requires a permit to construct, alter, improve, demolish, or repair any structure, prior to its issuance, also requires the applicant for such permit to file a signed statement that he or she is licensed pursuant to the provisions of the Contractors License Law (Chapter 9 (commencing with Section 7000) of Division 8 of the Business and Professions Code) or that he or she is exempt therefrom and the basis for the alleged exemption. Any violation of Section 7031.5 by any applicant for a permit subjects the applicant to a civil penalty of not more than five hundred dollars (\$500.00).

\_\_\_\_ I, as a owner of the property, or my employees with wages as their sole compensation, will do the work, and the structure is not intended or offered for sale (Sec. 7044, Business and Professional Code: The Contractors License Law does not apply to an owner of property who builds or improves thereon, and who does such work himself or herself or through his/her own employees, provided that such improvements are not intended or offered for sale. If, however, the building or improvement is sold within one year of completion, the owner-builder will have the burden of proving that he/she did not build or improve for the purpose of sale.)

\_\_\_\_ I, as owner of the property, am exclusively contracting with licensed contractors to construct the project (Sec. 7044, Business and Professions Code: The Contractors License Law does not apply to an owner of property who builds or improves thereon, and who contracts for such projects with a contractor(s) licensed pursuant to the Contractors License Law).

\_\_\_\_ I am exempt under Sec. \_\_\_\_\_ B & PC for this reason: \_\_\_\_\_

Date \_\_\_\_\_ Owner Signature \_\_\_\_\_

**IN ISSUING THIS BUILDING PERMIT,** the applicant represents, and the city relies on the representation of the applicant, that the applicant verified all measurements and locations shown on the application or accompanying drawings and that the improvement to be constructed does not violate any law or private agreement relating to permissible or prohibited locations for such improvements. This building permit does not authorize any illegal location of any improvement or the violation of any private agreement relating to location of improvements.

I certify that I have read this application and state that all information is correct. I agree to comply with all city and county ordinances and state laws relating to building construction and hereby authorize representative(s) of this city to enter upon the abovementioned property for inspection purposes.

Date 9/29/00 Applicant/Agent Signature Don McCloskey

**WORKER'S COMPENSATION DECLARATION:** I hereby affirm under penalty of perjury one of the following declarations:

\_\_\_\_ I have and will maintain a certificate of consent to self-insure for workers' compensation as provided for by Section 3700 of the Labor Code, for the performance of work for which the permit is issued.

I have and will maintain workers' compensation insurance, as required by Section 3700 of the Labor Code, for the performance of the work for which this permit is issued. My workers' compensation insurance carrier and policy number are:

Carrier OLD REPUBLIC INS. CO. Policy Number MWC107468 00 Exp Date 11/01/2000

\_\_\_\_ (This section need not be completed if the permit is for \$100 or less) I certify that in the performance of the work for which this permit is issued, I shall not employ any person in any manner so as to become subject to the workers' compensation laws of California and agree that if I should become subject to the workers' compensation provisions of Section 3700 of the Labor Code, I shall forthwith comply with those provisions.

Date 9/29/00 Applicant Signature Don McCloskey

**WARNING: FAILURE TO SECURE WORKER'S COMPENSATION COVERAGE IS UNLAWFUL AND SHALL SUBJECT AN EMPLOYER TO CRIMINAL PENALTIES AND CIVIL FINES UP TO ONE HUNDRED THOUSAND DOLLARS (\$100,000) IN ADDITION TO THE COST OF COMPENSATION, DAMAGES AS PROVIDED FOR IN SECTION 3706 OF THE LABOR CODE, INTEREST AND ATTORNEY'S FEE.**

**THIS PERMIT SHALL EXPIRE BY LIMITATION IF WORK IS NOT COMMENCED WITHIN 180 DAYS.**

RESIDENTIAL SUBDIVISION BUILDING PERMIT APPLICATION

Project Address: 2425 MAYMEAD DR Assessor Parcel # 201-0390-066  
 Lot Number 63 Subdivision NORTHBOROUGH VILLAGE 6-1

**OWNER INFORMATION:**

Legal Property Owner: US HOME Phone# 858-3900  
 Owner Address: 2366 GOLD MEADOW Way City GOLD RIVER State CA. Zip 95670

**CONTRACTOR INFORMATION:**

Contractor: SAME AS ABOVE Lic. # 451839 Phone # 858-3900 Fax 858-3925  
DON McCLOSKEY 719-9050

**PROJECT INFORMATION:**

Land Use Zone RIA Occupancy Group R3 Construction Type VN Fed Code 1A  
 No. of Stories: 1 No. of Rooms: \_\_\_\_\_ Street Width: \_\_\_\_\_  
 1<sup>st</sup> Floor Area \_\_\_\_\_ 2<sup>nd</sup> Floor Area \_\_\_\_\_ Basement \_\_\_\_\_ Roof Material \_\_\_\_\_

AREA IN SQUARE FOOT OF:

Dwelling/Living 2493  
 Garage/Storage 576  
 Decks/Balconies 120  
 Carports \_\_\_\_\_

SCOPE OF WORK: \_\_\_\_\_

FOR OFFICE USE ONLY

Information Above Complete  AR Flood Waiver Required  Planning Approval  
 Violation Files Checked  Flood Elevation Certificate Required  Design Review Approval  
 Standard Setbacks  Water Development Infill Area  Special Fee Districts Apply:  
 County Sewer \_\_\_\_\_

**THE FOLLOWING MUST BE PROVIDED IN ORDER TO SUBMIT FOR PERMIT**

2 COMPLETE PLOT PLANS, LEGIBLE & DRAWN TO SCALE  
 11 X 17 COPY OF FLOOR PLAN WITH FOLLOWING INFORMATION

a) Assessors Parcel Number c) Owners Name  
 b) New Floor Area d) Project Address

Date: \_\_\_\_\_ Received by: (staff) \_\_\_\_\_ Permit # \_\_\_\_\_



# WesPac

**insulation**

a MASCO Company



304 North Market Blvd., Ste. 11 • Sacramento, CA 95834  
916) 927-7149 • Fax (916) 927-4257  
Lic #487478

## Installed Insulation Certificate

We certify that the building insulation listed herein is installed in conformance with current energy conservation regulations, California Administrative Code, Title 24, State of California

RECTOR	AREA	TYPE	INCHES/BAGS (BLOWN)
--------	------	------	---------------------

Certified by *Chris Miller*

Title REGISTERED

Address or Lot Number 1500

Date Installed 1/15/11

Lot Area = 6,871 sf  
Building Footprint = 3,103 sf  
Gross Coverage = 45.2%  
Porch Allowance = 34 sf  
Net Coverage = 44.7%

APN:

201-039-066

Address:

2425 Maybrook Drive

Owner:

Plan:

2489 L

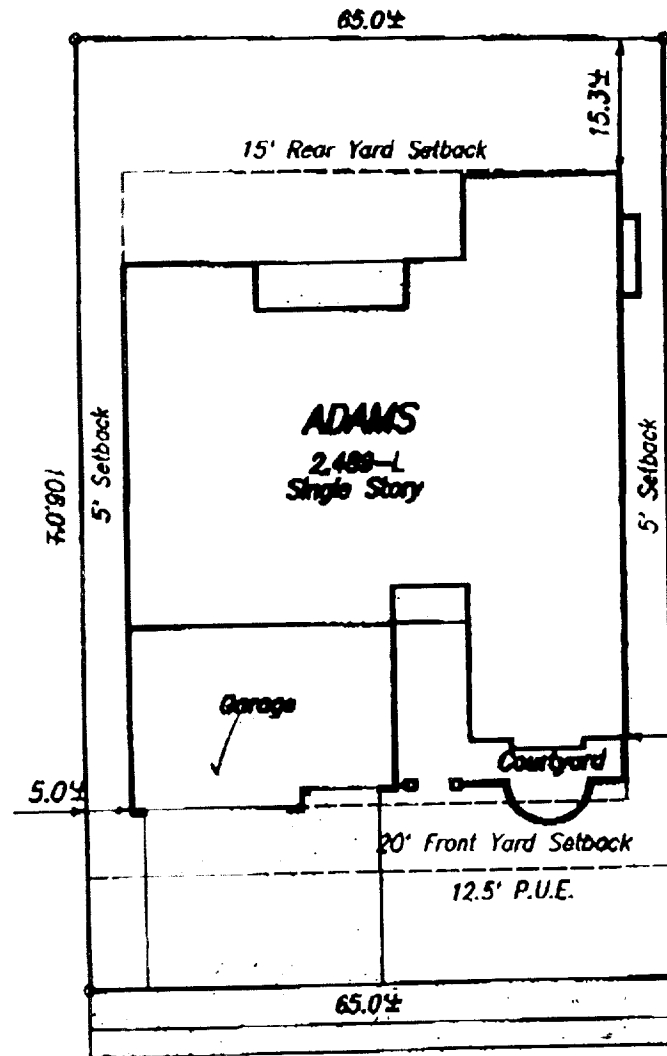

This set of plans and specifications must be kept on the job at all times and it is unlawful to make any changes or alterations from the same without written permission from the building inspector on file.

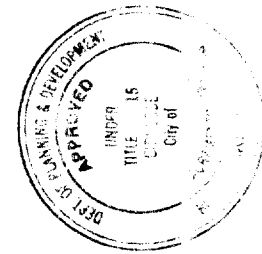

Maybrook Drive

Plot Plan for Lot 63 for Northborough Village 6-2  
U.S.Home - Northborough - Legends Series  
City of Sacramento

Note:  
This plot plan has been prepared for the purpose of showing the building foundation relationship to the property line, proposed drainage elevations and direction of flow to conform to local ordinances and for the purpose of building permit issuance. Information shown is approximate except for those setbacks which are minimums required by ordinance. This plot does not reflect as-built conditions which will likely vary from this plan.

Murray Smith & Associates  
Engineering, Inc.  
3110 Gold Canal Drive  
Rancho Cordova, CA 95670  
Ph.: (916) 635-1511

September 1, 2000

PN: 99003