

R239 F158

BUILDING DIVISION — BUILDING INSPECTOR'S REPORT CARD \$22.00

TYPE BUILDINGS

(Variance)

R242 F-50

PERMIT NO. G-554	LOCATION 4910 - Ortega Street A-4 (31.02)
DATE June-5-68	PURPOSE Add gar. & family room to dwlg. & lengthen.
ZONE R-1	OWNER Miss Barbara Scudder Same Att. carport roof.
	ARCH'T
	CONTR Robert Lerman 8701 - El Chapul Way



VAL \$4,200.	STORIES	ROOMS	APTS.	SIZE
--------------	---------	-------	-------	------

INSP.	DATE	BLDG. TYPE	OCCUPANCY GROUP	PHONE (O) (C)
-------	------	------------	-----------------	---------------

FORM	7-10-68	7020		
------	---------	------	--	--

JOIST				
-------	--	--	--	--

FRAME	8-5-68			
-------	--------	--	--	--

SHEET ROCK	8-9-68			
------------	--------	--	--	--

FINAL	8-27-68			
-------	---------	--	--	--

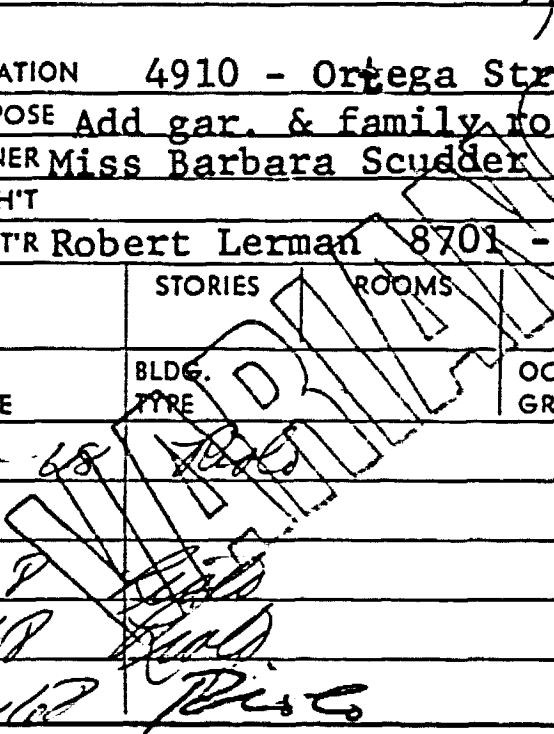

DATE	SPECIAL CONDITIONS OF WORK — REMARKS
7-8-68	P.T. 15' to rear property line or variance from
	planing needed. Foundation shows 10' to rear property
8-2-68	Assertions not made ^{took} took
COMPLETE AND OK	INSPECTOR