

CITY OF SACRAMENTO
1231 I Street, Sacramento, CA 95814

Permit No: 0103897
Insp Area: 4

Site Address: 3458 SWALLOWS NEST DR SAC
Parcel No: 274-0580-040

Sub-Type: NSFR
COSTA BL AT SW NEST LOT 26 Housing (Y/N): N

CONTRACTOR
REGIS CONTRACTORS
1425 RIVER PARK DR SUITE 530
SACRAMENTO CA 95815

OWNER

ARCHITECT

Nature of Work: MP 2293 1 STORY 8 ROOM SFR

CONSTRUCTION LENDING AGENCY: I hereby affirm under penalty of perjury that there is a construction lending agency for the performance of the work for which this permit is issued (Sec. 3097, Civ. Code).

Lender's Name _____ Lender's Address _____

LICENSED CONTRACTORS DECLARATION: I hereby affirm under penalty of perjury that I am licensed under provisions of Chapter 9 (commencing with section 7000) of Division 3 of the Business and Professions Code and my license is in full force and effect.

License Class B License Number 708694 Date 4-4-01 Contractor Signature Don Moran

OWNER-BUILDER DECLARATION: I hereby affirm under penalty of perjury that I am exempt from the contractors License Law for the following reason (Sec. 7031.5, Business and Professions Code, any city or county which requires a permit to construct, alter, improve, demolish, or repair any structure, prior to its issuance, also requires the applicant for such permit to file a signed statement that he or she is licensed pursuant to the provisions of the Contractors License Law (Chapter 9 (commencing with Section 7000) of Division 8 of the Business and Professions Code) or that he or she is exempt therefrom and the basis for the alleged exemption: Any violation of Section 7031.5 by any applicant for a permit subjects the applicant to a civil penalty of not more than five hundred dollars (\$500.00).

I, as a owner of the property, or my employees with wages as their sole compensation, will do the work, and the structure is not intended or offered for sale (Sec. 7044, Business and Professional Code). The Contractors License Law does not apply to an owner of property who builds or improves thereon, and who does such work himself or herself or through his/her own employees, provided that such improvements are not intended or offered for sale. If, however, the building or improvement is sold within one year of completion, the owner-builder will have the burden of proving that he/she did not build or improve for the purpose of sale.)

I, as owner of the property, am exclusively contracting with licensed contractors to construct the project (Sec. 7044, Business and Professions Code). The Contractors License Law does not apply to an owner of property who builds or improves thereon, and who contracts for such projects with a contractor(s) licensed pursuant to the Contractors License Law.

I am exempt under Sec. _____ B & PC for this reason: _____

Date _____ Owner Signature _____

IN ISSUING THIS BUILDING PERMIT, the applicant represents, and the city relies on the representation of the applicant, that the applicant verified all measurements and locations shown on the application or accompanying drawings and that the improvement to be constructed does not violate any law or private agreement relating to permissible or prohibited locations for such improvements. This building permit does not authorize any illegal location of any improvement or the violation of any private agreement relating to location of improvements.

I certify that I have read this application and state that all information is correct. I agree to comply with all city and county ordinances and state laws relating to building construction and hereby authorize representative(s) of this city to enter upon the abovementioned property for inspection purposes.

Date 4-4-01 Applicant Agent Signature Don Moran

WORKER'S COMPENSATION DECLARATION: I hereby affirm under penalty of perjury one of the following declarations:

I have and will maintain a certificate of consent to self-insure for workers' compensation as provided for by Section 3700 of the Labor Code, for the performance of work for which the permit is issued.

DM I have and will maintain workers' compensation insurance, as required by Section 3700 of the Labor Code, for the performance of the work for which this permit is issued. My workers' compensation insurance carrier and policy number are:

Carrier LIBERTY MUTUAL Policy Number WC2-151-030013-019 Exp. Date 01/01/2001

(This section need not be completed if the permit is for \$100 or less) I certify that in the performance of the work for which this permit is issued, I shall not employ any person in any manner so as to become subject to the workers' compensation laws of California and agree that if I should become subject to the workers' compensation provisions of Section 3700 of the Labor Code, I shall forthwith comply with those provisions.

Date 4-4-01 Applicant Signature Don Moran

WARNING: FAILURE TO SECURE WORKER'S COMPENSATION COVERAGE IS UNLAWFUL AND SHALL SUBJECT AN EMPLOYER TO CRIMINAL PENALTIES AND CIVIL FINES UP TO ONE HUNDRED THOUSAND DOLLARS (\$100,000) IN ADDITION TO THE COST OF COMPENSATION, DAMAGES AS PROVIDED FOR IN SECTION 3706 OF THE LABOR CODE, INTEREST AND ATTORNEY'S FEE.

THIS PERMIT SHALL EXPIRE BY LIMITATION IF WORK IS NOT COMMENCED WITHIN 180 DAYS.



**INSULATION CONTRACTORS
ASSOCIATION
OF AMERICA**

INSULATION
CERTIFICATE

73647

1321 DUKE STREET, SUITE 303 • ALEXANDRIA, VA 22314 • (703) 739-0356

**THIS IS TO CERTIFY THAT INSULATION HAS BEEN INSTALLED IN CONFORMANCE WITH
CURRENT ENERGY REGULATIONS CALLED FOR BY ADMINISTRATIVE CODE TITLE 24 STATE OF
CALIFORNIA, IN THE BUILDING LOCATED AT**

Fogis LOT # 26 TRACT # _____

STREET 3458 Sunflowers Blvd CITY Sac

EXTERIOR WALLS:

MANUFACTURER F/c THICKNESS/TYPE 3/8 R- VALUE 13

CEILINGS:

BATTS: F/g THICKNESS/TYPE 1/2 R- VALUE 38

MANUFACTURER F/g THICKNESS/TYPE 10 R- VALUE 38

MANUFACTURER F/g THICKNESS/TYPE _____ R- VALUE _____

SQUARE FOOTAGE COVERED 2293 NUMBER OF BAGS USED 45

FLOORS: MANUFACTURER _____ THICKNESS/TYPE _____ R- VALUE _____

SLAB ON GRADE: MANUFACTURER _____ THICKNESS/TYPE _____ R- VALUE _____

MANUFACTURER _____ THICKNESS/TYPE _____ R- VALUE _____

WIDTH OF INSULATION _____ INCHES

FOUNDATION WALLS: MANUFACTURER _____ THICKNESS/TYPE _____ R- VALUE _____

GENERAL CONTRACTOR _____ CALIFORNIA CONTRACTORS LICENSE # _____

INSULATION CONTRACTOR ARCADIE INSULATION SIGNATURE _____ TITLE _____

CALIFORNIA CONTRACTORS LICENSE # 263784 DATE 1-19-01

SIGNATURE [Signature] TITLE Inspector

KWIKKOTE
STUCCO SYSTEM
INSTALLATION CARD

#C30253
REGIS CONTRACTORS
COSTA BLANCA LOT # 26
3458 SWALLOWS NEST SACRAMENTO

Stucco System Trade Name: KWIK KOTE
Name Stucco Manufacturer: KWIK KOTE CORP
ICBO Evaluation Service, Inc. Report No. 3607
Date of Job Completion 10-23-01

Stucco Contractor Kenyon Plastering, Inc.
Name John W. Kenyon, III
Address P.O. Box 2077
North Highlands, CA 95660
Telephone # (916) 349-8191

Approved Contractor Number as issued by the Stucco Manufacturer: 1

This is to certify that the stucco system on the building exterior at the above address had been installed in accordance with the evaluation report specified above and the manufacturer's instructions.

Signature of authorized representative of stucco contractor:

John Inyell

Date: 12-10-01

Builder Copy

KWIKKOTE
STUCCO SYSTEM
INSTALLATION CARD

#C30253
REGIS CONTRACTORS
COSTA BLANCA LOT # 26
3458 SWALLOWS NEST SACRAMENTO

Stucco System Trade Name: KWIK KOTE
Name Stucco Manufacturer: KWIK KOTE CORP
ICBO Evaluation Service, Inc. Report No. 3607
Date of Job Completion 10-23-01

Stucco Contractor Kenyon Plastering, Inc.
Name John W. Kenyon, III
Address P.O. Box 2077
North Highlands, CA 95660
Telephone # (916) 349-8191

Approved Contractor Number as issued by the Stucco Manufacturer: 1

This is to certify that the stucco system on the building exterior at the above address had been installed in accordance with the evaluation report specified above and the manufacturer's instructions.

Signature of authorized representative of stucco contractor:

John Inyell

Date: 12-11-01

Subcontractor Copy

All air condensers must be located at the rear of the house regardless of the location shown on the models

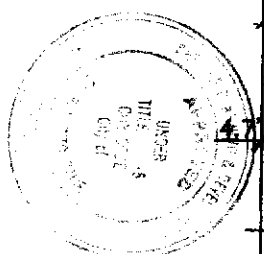
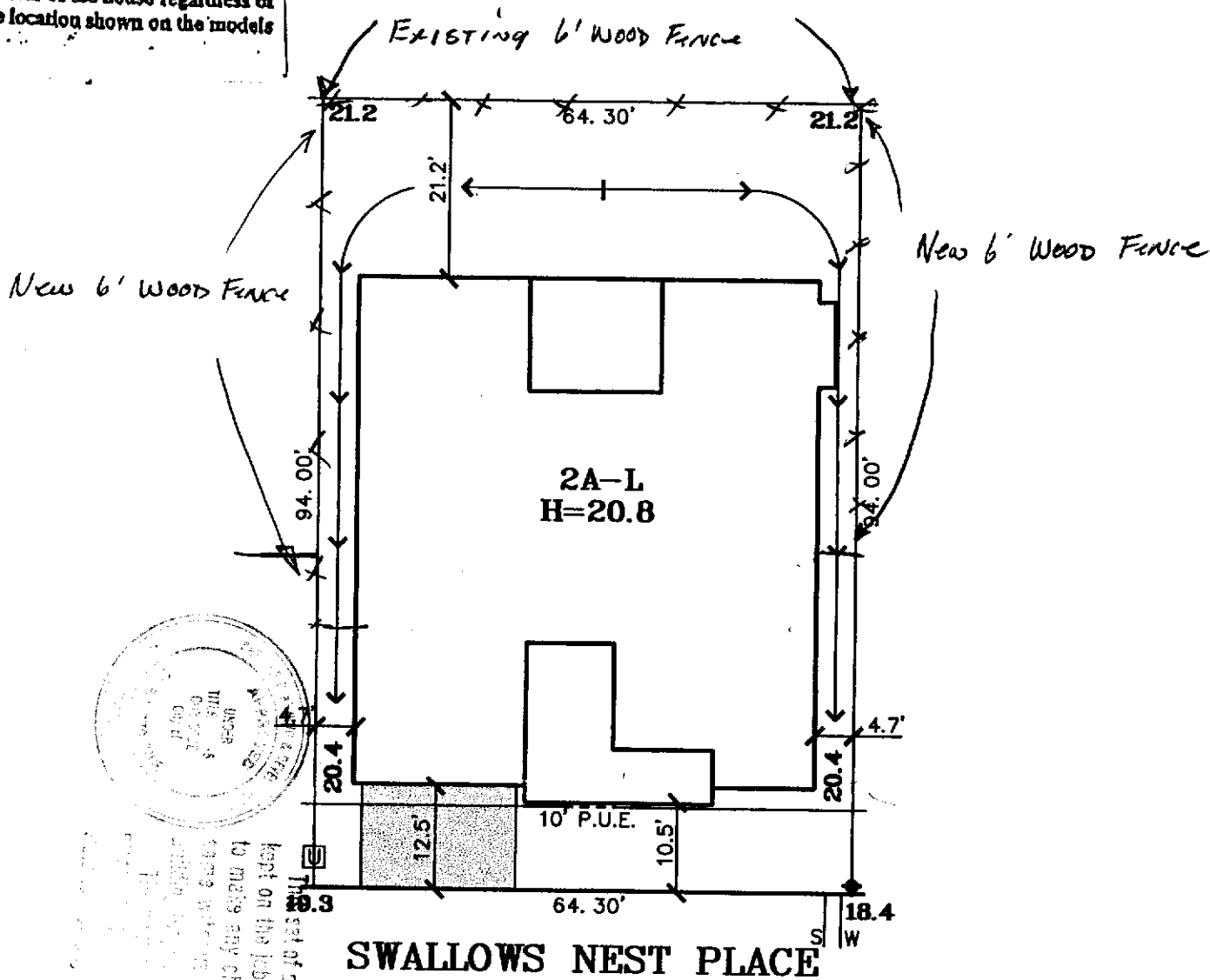

I, the undersigned, being a duly licensed professional engineer and architect, certify that I am the author of the above described plan and specifications and that I am a duly licensed professional engineer and architect in the State of California.

Adjustments to height and location of fences may change due to window locations on this lot as well as the adjacent lots.

All underground utilities have been installed buyer has inspected the lot and is aware of the location of transformers and utility boxes on this lot.



Signature _____

DATE: 11-29-00
 A.P.N.:
 ADDRESS: 3458 SWALLOWS NEST PLACE

LOT AREA: 6,044 SF
 LOT COVERAGE: 38%

The Splink Corporation
 2590 VENTURE OAKS WAY
 SACRAMENTO, CA. 95833
 PH (916)925-5550 FAX (916)921-9274

**COSTA BLANCA
 AT SWALLOWS NEST**
 LOT 26
 PLAN 2A

COSTA BLANCA
 CITY OF SACRAMENTO, CA
 CLIENT: REGIS HOMES
 JOB NO.: 7908-004