

**CITY OF SACRAMENTO**

1231 I Street, Sacramento, CA 95814

**Permit No: 0008512**

**Insp Area: 4**

**Site Address: 3754 BILSTED WY SAC**

Parcel No: 225-1330-048  
N

NATOMAS CROSSING UNIT 18 LOT 48

**Sub-Type:**

NSFR

**Housing (Y/N):**

**CONTRACTOR**

KIMBALL HILL HOMES  
10535 EAST STOCKTON BL. STE. K  
ELK GROVE CA 95624

**OWNER**

**ARCHITECT**

**Nature of Work: MP 2156 2 STORY 9 ROOM SFR**

**CONSTRUCTION LENDING AGENCY:** I hereby affirm under penalty of perjury that there is a construction lending agency for the performance of the work for which this permit is issued (Sec. 3097, Civ. C').

Lender's Name \_\_\_\_\_ Lender's Address \_\_\_\_\_

**LICENSED CONTRACTORS DECLARATION:** I hereby affirm under penalty of perjury that I am licensed under provisions of Chapter 9 (commencing with section 7000) of Division 3 of the Business and Professions Code and my license is in full force and effect.

License Class B License Number 701803 Date 8/15/00 Contractor Signature N. Collins

**OWNER-BUILDER DECLARATION:** I hereby affirm under penalty of perjury that I am exempt from the contractors License Law for the following reason (Sec. 7031.5, Business and Professions Code; any city or county which requires a permit to construct, alter, improve, demolish, or repair any structure, prior to its issuance, also requires the applicant for such permit to file a signed statement that he or she is licensed pursuant to the provisions of the Contractors License Law (Chapter 9 (commencing with Section 7000) of Division 8 of the Business and Professions Code) or that he or she is exempt therefrom and the basis for the alleged exemption. Any violation of Section 7031.5 by any applicant for a permit subjects the applicant to a civil penalty of not more than five hundred dollars (\$500.00);

I, as a owner of the property, or my employees with wages as their sole compensation, will do the work, and the structure is not intended or offered for sale (Sec. 7044, Business and Professional Code: The Contractors License Law does not apply to an owner of property who builds or improves thereon, and who does such work himself or herself or through his/her own employees, provided that such improvements are not intended or offered for sale. If, however, the building or improvement is sold within one year of completion, the owner-builder will have the burden of proving that he/she did not build or improve for the purpose of sale.)

I, as owner of the property, am exclusively contracting with licensed contractors to construct the project (Sec. 7044, Business and Professions Code: The Contractors License Law does not apply to an owner of property who builds or improves thereon, and who contracts for such projects with a contractor(s) licensed pursuant to the Contractors License Law).

I am exempt under Sec. \_\_\_\_\_ B & PC for this reason: \_\_\_\_\_

Date \_\_\_\_\_ Owner Signature \_\_\_\_\_

**IN ISSUING THIS BUILDING PERMIT,** the applicant represents, and the city relies on the representation of the applicant, that the applicant verified all measurements and locations shown on the application or accompanying drawings and that the improvement to be constructed does not violate any law or private agreement relating to permissible or prohibited locations for such improvements. This building permit does not authorize any illegal location of any improvement or the violation of any private agreement relating to location of improvements.

I certify that I have read this application and state that all information is correct. I agree to comply with all city and county ordinances and state laws relating to building construction and hereby authorize representative(s) of this city to enter upon the abovementioned property for inspection purposes.

Date 8/15/00 Applicant/Agent Signature N. Collins

**WORKER'S COMPENSATION DECLARATION:** I hereby affirm under penalty of perjury one of the following declarations:

I have and will maintain a certificate of consent to self-insure for workers' compensation as provided for by Section 3700 of the Labor Code, for the performance of work for which the permit is issued.

I have and will maintain workers' compensation insurance, as required by Section 3700 of the Labor Code, for the performance of the work for which this permit is issued. My workers' compensation insurance carrier and policy number are:

Carrier CLAREDON NAT. INS. CO. Policy Number SCF98-3482-000 Exp Date 10/01/2000

(This section need not be completed if the permit is for \$100 or less. If the permit is for more than \$100, I shall not employ any person in any manner so as to become subject to the workers' compensation laws of California and agree that if I should become subject to the workers' compensation provisions of Section 3700 of the Labor Code, I shall forthwith comply with those provisions.

Date 8/15/00 Applicant Signature N. Collins

**WARNING - FAILURE TO SECURE WORKER'S COMPENSATION COVERAGE IS UNLAWFUL AND SHALL SUBJECT AN EMPLOYER TO CRIMINAL PENALTIES AND CIVIL FINES UP TO ONE HUNDRED THOUSAND DOLLARS (\$100,000) IN ADDITION TO THE COST OF COMPENSATION, DAMAGES AS PROVIDED FOR IN SECTION 3706 OF THE LABOR CODE, INTEREST AND ATTORNEY'S FEE.**

**THIS PERMIT SHALL EXPIRE BY LIMITATION IF WORK IS NOT COMMENCED WITHIN 180 DAYS.**

**PLANNING SERVICES**  
**NEIGHBORHOOD DEVELOPMENT SERVICES**  
**AUG 15 2000**



**INSULATION CONTRACTORS  
ASSOCIATION  
OF AMERICA**

**INSULATION  
CERTIFICATE**

61987

1321 DUKE STREET, SUITE 303 • ALEXANDRIA, VA 22314 • (703) 739-0356

**THIS IS TO CERTIFY THAT INSULATION HAS BEEN INSTALLED IN CONFORMANCE WITH CURRENT ENERGY REGULATIONS, CALIFORNIA ADMINISTRATIVE CODE, TITLE 24, STATE OF CALIFORNIA, IN THE BUILDING LOCATED AT:**

*Attorney's*  
Kim Bell LLC LOT # 48 TRACT # Arroyos

STREET 3754 Blinstead CITY Sacto

**EXTERIOR WALLS**

MANUFACTURER CLT THICKNESS, TYPE R-19

**CEILINGS**

BATTS CLT THICKNESS, TYPE R-30

MANUFACTURER Fiscelle THICKNESS, TYPE R-50

BLOWN IN Fiscelle THICKNESS, TYPE R-50

MANUFACTURER Fiscelle THICKNESS, TYPE R-50

NUMBER OF BAGS USED 23

FOUNDAION WALLS R

GENERAL CONTRACTOR R

SIGNATURE \_\_\_\_\_ DATE \_\_\_\_\_

SIGNATURE \_\_\_\_\_ TITLE \_\_\_\_\_

INSULATION CONTRACTOR **ARCADE INSULATION**  
 CALIFORNIA CONTRACTORS LICENSE #263784

DATE 5-2-1

*[Handwritten Signature]*





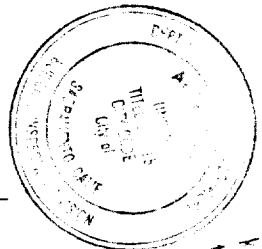
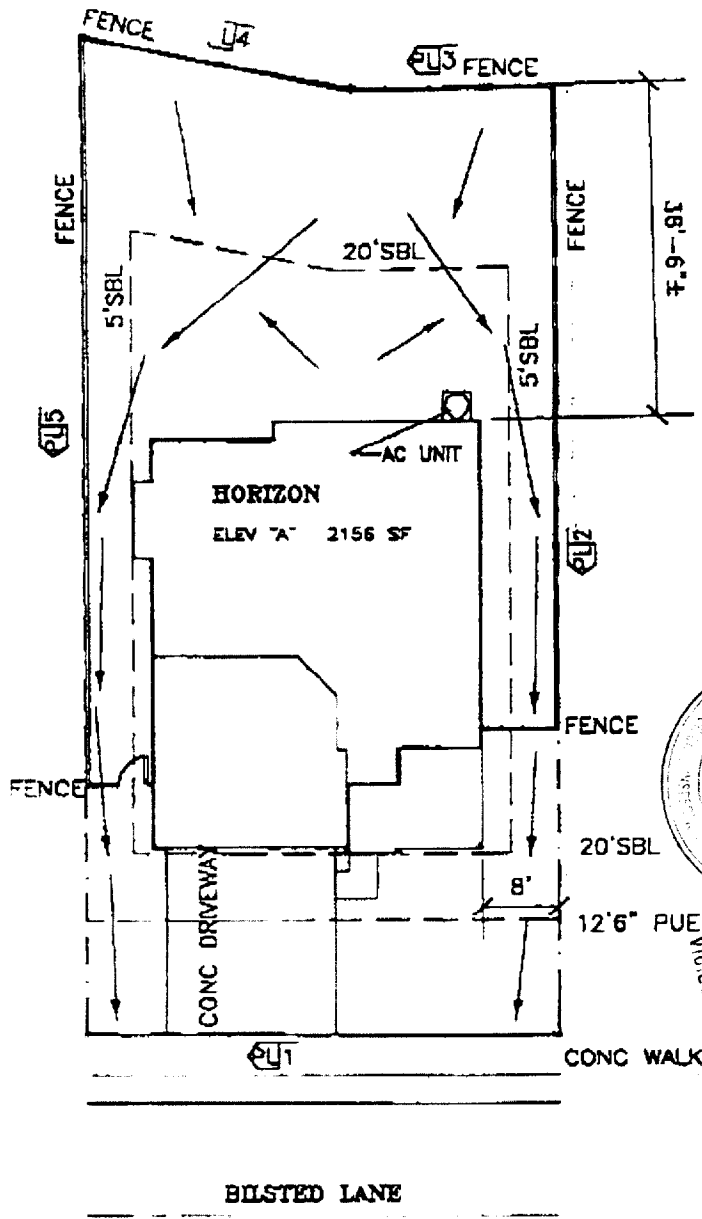

This set of plans is prepared for the City of Fair Oaks, California, and is not to be used for any other project without written permission from the Building Inspection Division. The approval of this plan and specification SHALL NOT be held to permit or approve the violation of any City Ordinance or State Law.



**BLOOM**  
**Architectural**  
**Developments**  
**Incorporated**  
 4437 Kenneth Avenue  
 Fair Oaks, CA 95828  
 (916)861-1553  
 (916)987-3011 Fax



LOT#	BEARING	LENGTH	R
PL1	N32°53'47"W	50.00'	.
PL2	N57°06'13"E	104.16'	.
PL3	N33°52'12"W	21.35'	.
PL4	N21°11'59"W	29.26'	.
PL5	N57°06'13"E	109.73'	.

**Plot Plan Disclosure** This plot plan approximates a general representation of lot dimensions, easements, fence and home placement, etc. This illustration is not a condition of Kimball Hill Homes sales agreement. The actual placement and measurements demonstrated on this diagram are subject to change without notice.

Signature S.H. O.H.  
**KHH California, Inc.** (916)714-1153  
 10535 E. Stockton Blvd. Ste. K, Elk Grove, CA 95758

**Job#** 1648 48 **Plan#** 2156  
**Date** Feb 16 00 **Draft** 1  
**Plan** HORIZON **Elev** A  
**Project** Natomas Crossing  
**Lot** 48 **Unit** 18  
**Address** 3754 Bilsted Lane  
**City** Sacramento **State** CA  
**APN** -----0000

**PLOT PLAN**  
 Scale 1"=20'