

**CITY OF SACRAMENTO**  
1231 I Street, Sacramento, CA 95814

**Permit No: 0515637**

**Insp Area: 4**

**Thos Bros:**

**Sub-Type: NSFR**

**Housing (Y/N): N**

**Site Address: 5 SUFFOLK HILLS PL SAC**

**Parcel No: THE HAMPTONS VIL. 3 LOT # 73**

**CONTRACTOR**  
KB HOME NORTH BAY INC.  
611 ORANGE DR  
VACAVILLE CA. 95687

**OWNER**

PAID  
CITY OF SACRAMENTO  
MAR 07 2006

**ARCHITECT**

**Nature of Work: MP1708 2 STORY 7RM SFR**

NEIGHBORHOODS PLANNING  
AND DEVELOPMENT SERVICES

**CONSTRUCTION LENDING AGENCY:** I hereby affirm under penalty of perjury that there is a construction lending agency for the performance of the work for which this permit is issued (Sec. 3097, Civ. C).

Lender's Name \_\_\_\_\_ Lender's Address \_\_\_\_\_

**LICENSED CONTRACTORS DECLARATION:** I hereby affirm under penalty of perjury that I am licensed under provisions of Chapter 9 (commencing with section 7000) of Division 3 of the Business and Professions Code and my license is in full force and effect.

License Class B License Number \_\_\_\_\_ Date 3/7/06 Contractor Signature [Signature]

**OWNER-BUILDER DECLARATION:** I hereby affirm under penalty of perjury that I am exempt from the contractors License Law for the following reason (Sec. 7031.5, Business and Professions Code; any city or county which requires a permit to construct, alter, improve, demolish, or repair any structure, prior to its issuance, also requires the applicant for such permit to file a signed statement that he or she is licensed pursuant to the provisions of the Contractors License Law (Chapter 9 (commencing with Section 7000) of Division 8 of the Business and Professions Code) or that he or she is exempt therefrom and the basis for the alleged exemption. Any violation of Section 7031.5 by any applicant for a permit subjects the applicant to a civil penalty of not more than five hundred dollars (\$500.00);

I, as a owner of the property, or my employees with wages as their sole compensation, will do the work, and the structure is not intended or offered for sale (Sec. 7044, Business and Professional Code: The Contractors License Law does not apply to an owner of property who builds or improves thereon, and who does such work himself or herself or through his/her own employees, provided that such improvements are not intended or offered for sale. If, however, the building or improvement is sold within one year of completion, the owner-builder will have the burden of proving that he/she did not build or improve for the purpose of sale.)

I, as owner of the property, am exclusively contracting with licensed contractors to construct the project (Sec. 7044, Business and Professions Code: The Contractors License Law does not apply to an owner of property who builds or improves thereon, and who contracts for such projects with a contractor(s) licensed pursuant to the Contractors License Law).

I am exempt under Sec. \_\_\_\_\_ B & PC for this reason: \_\_\_\_\_

Date \_\_\_\_\_ Owner Signature \_\_\_\_\_

**IN ISSUING THIS BUILDING PERMIT,** the applicant represents, and the city relies on the representation of the applicant, that the applicant verified all measurements and locations shown on the application or accompanying drawings and that the improvement to be constructed does not violate any law or private agreement relating to permissible or prohibited locations for such improvements. This building permit does not authorize any illegal location of any improvement or the violation of any private agreement relating to location of improvements.

I certify that I have read this application and state that all information is correct. I agree to comply with all city and county ordinances and state laws relating to building construction and hereby authorize representative(s) of this city to enter upon the abovementioned property for inspection purposes.

Date 3/7/06 Applicant/Agent Signature [Signature]

**WORKER'S COMPENSATION DECLARATION:** I hereby affirm under penalty of perjury one of the following declarations:  
I have and will maintain a certificate of consent to self-insure for workers' compensation as provided for by Section 3700 of the Labor Code, for the performance of work for which the permit is issued.

I have and will maintain workers' compensation insurance, as required by Section 3700 of the Labor Code, for the performance of the work for which this permit is issued. My workers' compensation insurance carrier and policy number are:

Carrier \_\_\_\_\_ Policy Number \_\_\_\_\_ Exp Date \_\_\_\_\_

(This section need not be completed if the permit is for \$100 or less) I certify that in the performance of the work for which this permit is issued, I shall not employ any person in any manner so as to become subject to the workers' compensation laws of California and agree that if I should become subject to the workers' compensation provisions of Section 3700 of the Labor Code, I shall forthwith comply with those provisions.

Date 3/7/06 Applicant Signature [Signature]

**WARNING: FAILURE TO SECURE WORKER'S COMPENSATION COVERAGE IS UNLAWFUL AND SHALL SUBJECT AN EMPLOYER TO CRIMINAL PENALTIES AND CIVIL FINES UP TO ONE HUNDRED THOUSAND DOLLARS (\$100,000) IN ADDITION TO THE COST OF COMPENSATION, DAMAGES AS PROVIDED FOR IN SECTION 3706 OF THE LABOR CODE, INTEREST AND ATTORNEY'S FEE.**

**THIS PERMIT SHALL EXPIRE BY LIMITATION IF WORK IS NOT COMMENCED WITHIN 180 DAYS.**

THIS PLOT PLAN IS NOT FOR SALES PURPOSES. THIS PLOT PLAN IS FOR THE PURPOSES OF INDICATING COMPLIANCE WITH ZONING SET BACKS, GENERAL DRAINAGE DIRECTION, AND APPROXIMATE UTILITY CONNECTION. ALL OTHER DATA SHOWN HEREON IS CONCEPTUAL. THIS PLOT PLAN DOES NOT REFLECT AS-BUILT CONDITION, RETAINING WALLS ARE OPTIONAL AND MAY OR MAY NOT BE CONSTRUCTED.

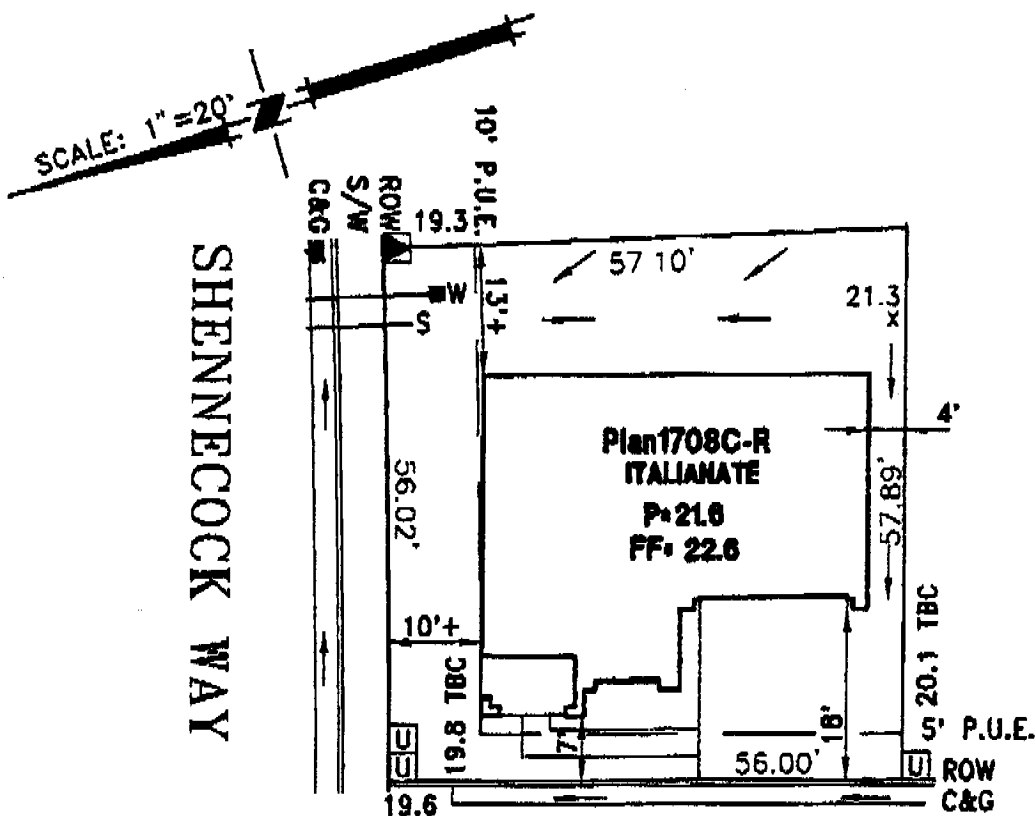

**LEGEND**

- DRAIN INLET
- S SEWER SERVICE
- W WATER SERVICE
- STREET LIGHT
- ▲ TRANSFORMER
- U UTILITY BOX
- SL STREET LIGHT SERVICE POINT
- FIRE HYDRANT
- STOP SIGN

**SUFFOLK HILLS PLACE**

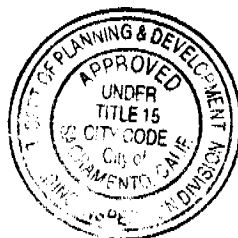

This set of plans and specifications must be kept on the job at all times and it is unlawful to make any changes or alterations from the same without written permission from the Building Inspection Division.

The approval of this plan and specification SHALL NOT be held to permit or approve the violation of any City Ordinance or State Law.

**THE HAMPTONS - VILLAGE 3 - CLUSTER**

KB HOME NORTH BAY  
PLOT PLAN FOR LOT 73

A.P.N.:  
LOT AREA: 3,213 S.F.  
ADDRESS: 5 SUFFOLK HILLS PLACE  
CITY OF SACRAMENTO, CALIFORNIA

**WOOD RODGERS**  
ENGINEERING • PLANNING • MAPPING • SURVEYING  
3001 L STREET, SUITE 100, SACRAMENTO, CA 95810  
PHONE: (916) 361-7700 FAX: (916) 361-7707

AUGUST 2005 DRAWN: DAM 1217.013

J:\Jobs\1217-Natomas Meadows\The Hamptons-V3\Civil\Plotplan\LOT 073.dwg 9/20/05 1:59pm dmento

CTC

INSTALLATION CERTIFICATE

(Page 1 of 13)

CF-6R

Hamptons Clusters- Plan # 1708 C Right

Lot 73

Site Address 5 Suffolk Hills Place

Permit Number 0515637

An installation certificate is required to be posted at the building site or made available for all appropriate inspections. (The information provided on this form is required; however, use of this form to provide the information is optional.) After completion of final inspection, a copy must be provided to the building department (upon request) and the building owner at occupancy, per Section 10-103(b).

HVAC SYSTEMS:

Heating Equipment

Table with 8 columns: Equip. Type (pkg. heat pump), CEC Certified Mfr Name and Model Number, # of Identical Systems, Efficiency (AFUE, etc.) (>CF-IR value), Duct Location (Attic, etc.), Duct or Piping R-value, Heating Load (Btu/hr), Heating Capacity (Btu/hr)

Cooling Equipment

Table with 8 columns: Equip. Type (pkg. heat pump), CEC Certified Compressor Unit Mfr Name and Model Number, # of Identical Systems, Efficiency (SEER, etc.) (>CF-IR value), Duct Location (Attic, etc.), Duct or Piping R-value, Cooling Load (Btu/hr), Cooling Capacity (Btu/hr)

1. ≥ reads greater than or equal to

I, the undersigned, verify that equipment listed above is: 1) the actual equipment installed, 2) equivalent to or more efficient than that specified in the certificate of compliance (Form CF-1R) submitted for compliance with the Energy Efficiency Standards for residential buildings, and 3) equipment that meets or exceeds the appropriate requirements for manufactured devices (from the Appliance Efficiency Regulations or Part 6), where applicable.

Signature, Date

Installing Subcontractor (Co. Name) OR General Contractor (Co. Name) OR Owner

WATER HEATING SYSTEMS:

Table with 10 columns: Heater Type, CEC Certified Mfr Name & Model Number, Distribution Type (Std. Point-of-Use), If Recirculation, Control Type, # of Identical Systems, Rated Input (kW or Btu/hr), Tank Volume (gallons), Efficiency (EF, RE), Standby Loss (%), External Insulation R-value

- 2. For small gas storage (rated input of less than or equal to 75,000 Btu/hr), electric resistance and heat pump water heaters, list Energy Factor. For large gas storage water heaters (rated input of greater than 75,000 Btu/hr), list Recovery Efficiency, Standby Loss and Rated Input. For instantaneous gas water heaters, list Recovery Efficiency and Rated Input. 3. R-12 external insulation is mandatory for storage water heaters with an energy factor of less than 0.59.

Faucets & Shower Heads:

All faucets and showerheads installed are certified to the Commission, pursuant to Title 24, Part 6, Section 111.

I, the undersigned, verify that equipment listed above my signature is: 1) the actual equipment installed; 2) equivalent to or more efficient than that specified in the certificate of compliance (Form CF-1R) submitted for compliance with the Energy Efficiency Standards for residential buildings; and 3) equipment that meets or exceeds the appropriate requirements for manufactured devices (from the Appliance Efficiency Regulations or Part 6), where applicable.

Signature, Date [Handwritten Signature] 8/1/06

Installing Subcontractor (Co. Name) OR General Contractor (Co. Name) OR Owner CAN AM PLUMBING

COPY TO: Building Department, HERS Provider (if applicable), Building Owner at Occupancy

**INSTALLATION CERTIFICATE**

LOT **73**

Site Address

**5 Suffolk Hills Place**

PLANE **1708**

**C Right**

**KB HOME - HAMPTONS (CLUSTER)**

CF-6R

Permit Number **0515637**

**HYAC SYSTEMS:**

**Heating Equipment**

Equip. Type (pkgs Heat pump)	CEC Certified Mfr Name and Model #	# of Identical Systems	Efficiency (AFUE, etc.) or CF-IR Value	Duct Location (attic, etc.)	Duct or Piping R-value	Heating Load (Btu/hr)	Heating Capacity (Btu/hr)
FURNACE	Carrier 98STX070-12	1	80%	ATTIC	6	28,313	70,000
FURNACE	Carrier 98STX070-12	1	80%	ATTIC	6	27,627	70,000
FURNACE	Carrier 98STX070-12	1	80%	ATTIC	6	31,392	70,000
FURNACE	Carrier 98STX090-13	1	80%	ATTIC	6	27,627	90,000

PLAN 1708  
PLAN 1722  
PLAN 1848  
PLAN 1922

**Cooling Equipment**

Equip. Type (pkgs Heat pump)	CEC Certified Compressor Unit Mfr Name and Model #	# of Identical Systems	Efficiency (SEER, etc.) or CF-IR Value	Duct Location (attic, etc.)	Duct R-value	Cooling Load (Btu/hr)	Cooling Capacity (Btu/hr)
A/C	Carrier 38BRC036*	1	13.0	ATTIC	6	22,792	33,100
A/C	Carrier 38BRC036*	1	13.0	ATTIC	6	23,526	33,100
A/C	Carrier 38BRC036*	1	13.0	ATTIC	6	25,043	33,100
A/C	Carrier 38BRC042*	1	13.0	ATTIC	6	23,526	38,600

PLAN 1708  
PLAN 1722  
PLAN 1848  
PLAN 1922

\* = TXV valve installed as part of coil

(1) I, the undersigned, verify that equipment listed above is (1) the actual equipment installed, (2) equivalent to or more efficient than that specified in the certificate of compliance (Form CF-IR) submitted for compliance with the Energy Efficiency Standards for residential buildings, and (3) equipment that meets or exceeds the appropriate requirements for manufactured devices (from the *Appliance Efficiency Requirements*, or Part 6), where applicable.

Signature, Date

*[Handwritten Signature]*

**BEUTLER CORPORATION**  
Installing Subcontractor (Co. Name)  
OR General Contractor (Co. Name) OR Owner

# INSTALLATION CERTIFICATE

(Page 2 of 13)

Lot 73 1708 C Right

Site Address: 5 Suffolk Hills Place

FENESTRATION/GLAZING: Elite Windows

Permit Number 0515637

Manufacturer Brand Name (GROUP LIKE PRODUCTS)	Product U-Factor (U)	Product SHGC (g)	# of Panels	Total Quantity of Like Product (Quantity)	Square Feet	Exterior Shading Device or Overhang	Comments/Location Special Feat
1. <u>LOWE</u>	<u>0.35</u>	<u>0.45</u>	<u>1</u>				<u>LOWE<sup>2</sup></u>
2.							
3.							
4.							
5.							
6.							
7.							
8.							
9.							
10.							
11.							
12.							
13.							
14.							
15.							

1. Manufactured fenestration products use the values from the product label. Field fabricated fenestration products use the default values from Section 114 of the Energy Efficiency Standards.

2. Installed U-Factor must be less than or equal to values from CF-1R. Installed SHGC must be less than or equal to values from CF-1R, or a shading device (exterior or overhang) is installed as specified on the CF-1R. Alternatively, installed weighted average U-Factors for the total fenestration area are less than or equal to values from CF-1R.

I, the undersigned, verify that the fenestration/glazing listed above my signature: 1) is the actual fenestration product installed; 2) is equivalent to or has a lower U-Factor and lower SHGC than that specified in the certificate of compliance (Form CF-1R) submitted for compliance with the Energy Efficiency Standards for residential buildings; and 3) the product meets or exceeds the appropriate requirements for manufactured devices (Form Part 6), where applicable.

Item #s (if applicable) \_\_\_\_\_ Signature, Date 12/17/10  
 \_\_\_\_\_  
 Installing Subcontractor (Co. Name) OR  
 General Contractor (Co. Name) OR Owner  
 OR Window Distributor

Item #s (if applicable) \_\_\_\_\_ Signature, Date \_\_\_\_\_  
 \_\_\_\_\_  
 Installing Subcontractor (Co. Name) OR  
 General Contractor (Co. Name) OR Owner  
 OR Window Distributor

Item #s (if applicable) \_\_\_\_\_ Signature, Date \_\_\_\_\_  
 \_\_\_\_\_  
 Installing Subcontractor (Co. Name) OR  
 General Contractor (Co. Name) OR Owner  
 OR Window Distributor

COPY TO: Building Department  
 MERS Provider (if applicable)  
 Building Owner at Occupancy

Manufacturer's Name

**INSULATION CERTIFICATE**

1708C Right  
#0515637

THIS IS TO CERTIFY THAT INSULATION HAS BEEN INSTALLED IN CONFORMANCE WITH THE CURRENT ENERGY REGULATIONS, CALIFORNIA ADMINISTRATION CODE TITLE 24, STATE OF CALIFORNIA, IN THE BUILDING LOCATED AT:

S Suffolk Hills Place

SITE ADDRESS LOT 73 HAMPTON (CLUSTER) NATOMAS CA  
NUMBER CITY STATE

**CEILINGS:**

BLOW:	MANUFACTURER	<u>GREEN FIBER</u>	THICKNESS	<u>10.3"</u>	R/VALUE	<u>38</u>
		<u>GREEN FIBER</u>	THICKNESS		R/VALUE	
BATTS:	MANUFACTURER	<u>KNAUF</u>	THICKNESS	<u>13"</u>	R/VALUE	<u>38</u>
		<u>KNAUF</u>				

**EXTERIOR WALLS:**

MANUFACTURER	<u>KNAUF</u>	THICKNESS	<u>6"</u>	R/VALUE	<u>19</u>
	<u>KNAUF</u>	THICKNESS	<u>3.5"</u>	R/VALUE	<u>13</u>

**FLOOR INSULATION:**

MANUFACTURER	<u>KNAUF</u>	THICKNESS	<u>10.25"</u>	R/VALUE	<u>30</u>
	<u>KNAUF</u>				

**AIR INFILTRATION: (TITLE 24)**

YES XXX NO       

OTHER: \_\_\_\_\_

GENERAL CONTRACTOR: KB HOMES LICENSE # \_\_\_\_\_

BY: \_\_\_\_\_ TITLE \_\_\_\_\_ DATE \_\_\_\_\_

INSULATION CONTRACTOR: WESTERN INSULATION LP LICENSE # 794484

BY: Becky Gutherz TITLE AUTH. AGENT DATE 6/15/2006  
BECKY GUTHERZ