

CITY OF SACRAMENTO

1231 I Street, Sacramento, CA 95814

Permit No: 9810767

Insp Area: 4

Site Address: 2546 CAMPDEN WY SAC

Parcel No: 274-0460-040

L122/HERITAGE PLACE

Sub-Type: NSFR

Housing (Y/N): N

CONTRACTOR

EPICK INC.
1263 THE ESPLANADE
CHICO, CA 95926

OWNER

EPICK HOMES
1263 THE ESPLANDE
CHICO CA 95926

ARCHITECT

Nature of Work: NEW HOME, MP1710, 6 ROOMS

CONSTRUCTION LENDING AGENCY: I hereby affirm under penalty of perjury that there is a construction lending agency for the performance of the work for which this permit is issued (Sec. 3097, Civ. C).

Lender's Name 1st Bank Lender's Address 1525 Douglas Blvd Roseville

LICENSED CONTRACTORS DECLARATION: I hereby affirm under penalty of perjury that I am licensed under provisions of Chapter 9 (commencing with section 7000) of Division 3 of the Business and Professions Code and my license is in full force and effect.

License Class B3 License Number 663709 Date 3/11/99 Contractor Signature [Signature]

OWNER-BUILDER DECLARATION: I hereby affirm under penalty of perjury that I am exempt from the contractors License Law for the following reason (Sec. 7031.5, Business and Professions Code; any city or county which requires a permit to construct, alter, improve, demolish, or repair any structure, prior to its issuance, also requires the applicant for such permit to file a signed statement that he or she is licensed pursuant to the provisions of the Contractors License Law (Chapter 9 (commencing with Section 7000) of Division 8 of the Business and Professions Code) or that he or she is exempt therefrom and the basis for the alleged exemption. Any violation of Section 7031.5 by any applicant for a permit subjects the applicant to a civil penalty of not more than five hundred dollars (\$500.00);

I, as a owner of the property, or my employees with wages as their sole compensation, will do the work, and the structure is not intended or offered for sale (Sec. 7044, Business and Professions Code: The Contractors License Law does not apply to an owner of property who builds or improves thereon, and who does such work himself or herself or through his/her own employees, provided that such improvements are not intended or offered for sale. If, however, the building or improvement is sold within one year of completion, the owner-builder will have the burden of proving that he/she did not build or improve for the purpose of sale.)

I, as owner of the property, am exclusively contracting with licensed contractors to construct the project (Sec. 7044, Business and Professions Code: The Contractors License Law does not apply to an owner of property who builds or improves thereon, and who contracts for such projects with a contractor(s) licensed pursuant to the Contractors License Law).

I am exempt under Sec. _____ B & PC for this reason: _____
Date 3/11/99 Owner Signature [Signature]

IN ISSUING THIS BUILDING PERMIT, the applicant represents, and the city relies on the representation of the applicant, that the applicant verified all measurements and locations shown on the application or accompanying drawings and that the improvement to be constructed does not violate any law or private agreement relating to permissible or prohibited locations for such improvements. This building permit does not authorize any illegal location of any improvement or the violation of any private agreement relating to location of improvements.

I certify that I have read this application and state that all information is correct. I agree to comply with all city and county ordinances and state laws relating to building construction and hereby authorize representative(s) of this city to enter upon the above mentioned property for inspection purposes.

Date 3/11/99 Applicant/Agent Signature [Signature]

WORKER'S COMPENSATION DECLARATION: I hereby affirm under penalty of perjury one of the following declarations:
I have and will maintain a certificate of consent to self-insure for workers' compensation as provided for by Section 3700 of the Labor Code, for the performance of work for which the permit is issued.

I have and will maintain workers' compensation insurance, as required by Section 3700 of the Labor Code, for the performance of the work for which this permit is issued. My workers' compensation insurance carrier and policy number are:

Carrier STATE FUND Policy Number 1442812-98 Exp Date 10/01/1999

(This section need not be completed if the permit is for \$100 or less) I certify that in the performance of the work for which this permit is issued, I shall not employ any person in any manner so as to become subject to the workers' compensation laws of California and agree that if I should become subject to the workers' compensation provisions of Section 3700 of the Labor Code, I shall forthwith comply with those provisions.

Date 3/11/99 Applicant Signature [Signature]

WARNING: FAILURE TO SECURE WORKER'S COMPENSATION COVERAGE IS UNLAWFUL AND SHALL SUBJECT AN EMPLOYER TO CRIMINAL PENALTIES AND CIVIL FINES UP TO ONE HUNDRED THOUSAND DOLLARS (\$100,000) IN ADDITION TO THE COST OF COMPENSATION, DAMAGES AS PROVIDED FOR IN SECTION 3706 OF THE LABOR CODE, INTEREST AND ATTORNEY'S FEE.

THIS PERMIT SHALL EXPIRE BY LIMITATION IF WORK IS NOT COMMENCED WITHIN 180 DAYS.

NATOMAS UNIFIED SCHOOL DISTRICT

1515 Sports Drive, #1 • Sacramento, CA 95834

Phone 916/641-3300 • Fax 916/928-1629

CERTIFICATION OF COMPLIANCE

SCHOOL DISTRICT DEVELOPMENT FEES

PART I: TO BE COMPLETED BY APPLICANT			
PROPERTY OWNER'S NAME	Erick Torres #1 LLC		
OWNER'S ADDRESS	1263 The Esplanade Ste. C. Chico Ca. 95926		
PROJECT ADDRESS	2546 Campden Way		
PARCEL NUMBER	274-0420-040		
SUBDIVISION NAME	Lot 12a / Remington		
NUMBER OF UNITS	173		
PRINT APPLICANT'S NAME	Burt Untzelberger	APPLICANT'S SIGNATURE:	<i>[Signature]</i>
TITLE OF APPLICANT	Proj. Supr.		
DATE	3/2/99	TELEPHONE NUMBER	(530) 891-4757
PART II: TO BE COMPLETED BY BUILDING DEPARTMENT			
PLAN IDENTIFICATION NUMBER	9810767		
BUILDING TYPE (CHECK ONE)	<input checked="" type="checkbox"/> RESIDENTIAL <input type="checkbox"/> APARTMENT/CONDOMINIUM <input type="checkbox"/> COMMERCIAL/INDUSTRIAL		
SQUARE FEET OF CHARGEABLE BUILDING AREA	1710		
SIGNATURE	Maureen McAlen		
TITLE	Bldg Tech	DATE	
PART III: TO BE COMPLETED BY NATOMAS UNIFIED SCHOOL DISTRICT			
DISTRICT CERTIFICATION NUMBER	99-118		
FEES COLLECTED			
RESIDENTIAL	1710	SQ. FT. X \$ 1.93	= \$ 3300.30
APARTMENT/CONDOMINIUM		SQ. FT. X \$	= \$
COMMERCIAL/INDUSTRIAL		SQ. FT. X \$	= \$

This certification covers only the amount of square footage indicated above. Any additions or corrections to the square footage for this project will require an amendment to the Certificate of Compliance.

As the authorized school district official, I hereby certify that the requirements of Government Code Section 65995 have been complied with by the above signed applicant.

AUTHORIZED SCHOOL DISTRICT OFFICIAL:

SIGNATURE: *[Signature]*
 TITLE: Fac Plan Dir. DATE: 3/2/99

COUNTY SANITATION DISTRICT NO. 1
 SACRAMENTO REGIONAL COUNTY SANITATION DISTRICT
SEWER IMPACT FEE
 PERMIT AND CALCULATION SHEET **3/3/99**

APPLICATION NO:	BLDG PERMIT NO:
GENERAL INFORMATION	THIS PERMIT GOOD ONLY WHEN VALIDATED BY THE CASHIER
	- DEPT 26 788 08 \$2,855.00 - TRN 384559 03/03/99 - RECEIPT 687118 C#1 \$2,855.00
	250204 3/3/99 THIS PERMIT TO CONNECT EXPIRES ONE YEAR FROM DATE OF ISSUANCE

FEE CALCULATION		BUILDING USE	
INSPECTION		RESIDENTIAL SF <input type="checkbox"/>	MF <input type="checkbox"/>
CSD-1	470	COMMERCIAL USE	UNITS
SRCSO	2385		
CONSTRUCTION			
IN-LIEU			
TOTAL FEE	2855		

APN: **274-0460-040**

DESCRIPTION/Heritage Place
 SUBDIVISION **Riverdale** LOT: **122**

PROPERTY ADDRESS **2546 Campden Way**

OWNER **Epick Homes #1 LLC**

MAILING ADDRESS **1263 The Esplanade Ste. C**

CITY-STATE-ZIP **Phico Ca. 95926** PHONE **(530) 891-4757**

ADDITIONAL FEES MAY BE DUE IF CHANGES IN USE INCREASE SEWER IMPACT.

APPLICANT SIGNATURE *[Signature]*

CONSOLIDATED UTILITY BILLING USE ONLY

ACCT _____ INPUT _____ START _____

INSPECTOR'S COPY



INSULATION CONTRACTORS ASSOCIATION OF AMERICA

INSULATION CERTIFICATE
55418

1321 DUKE STREET, SUITE 303 • ALEXANDRIA, VA 22314 • (703) 739-0356

INSULATION HAS BEEN INSTALLED IN CONFORMANCE WITH THE CALIFORNIA ADMINISTRATIVE CODE, TITLE 24, STATE REGULATIONS AS INDICATED AT

EPICK LOT # 122 TRACT # RIVER GATE
STREET 2546 Campden Wy CITY SAC

EXTERIOR WALLS:

MANUFACTURER _____ THICKNESS/TYPE _____ R-VALUE 13

CEILINGS:

BATTS: MANUFACTURER _____ THICKNESS/TYPE _____ R-VALUE 38

BLOWN IN: CT MINIMUM 15" MANUFACTURER _____ THICKNESS _____ R-VALUE 38

SQUARE FOOTAGE COVERED 1650 NUMBER OF BAGS USED 36

FLOORS: MANUFACTURER _____ THICKNESS/TYPE _____ R-VALUE _____

SLAB ON GRADE: MANUFACTURER _____ THICKNESS/TYPE _____ R-VALUE _____

WIDTH OF INSULATION _____ INCHES

FOUNDATION WALLS: MANUFACTURER _____ THICKNESS/TYPE _____ R-VALUE _____

GENERAL CONTRACTOR _____ CALIFORNIA CONTRACTORS LICENSE # _____

DATE _____

SIGNATURE _____ TITLE _____

INSULATION CONTRACTOR ARCADE INSULATION

CALIFORNIA CONTRACTORS LICENSE #263784

9-10-99 DATE

SIGNATURE _____ TITLE _____

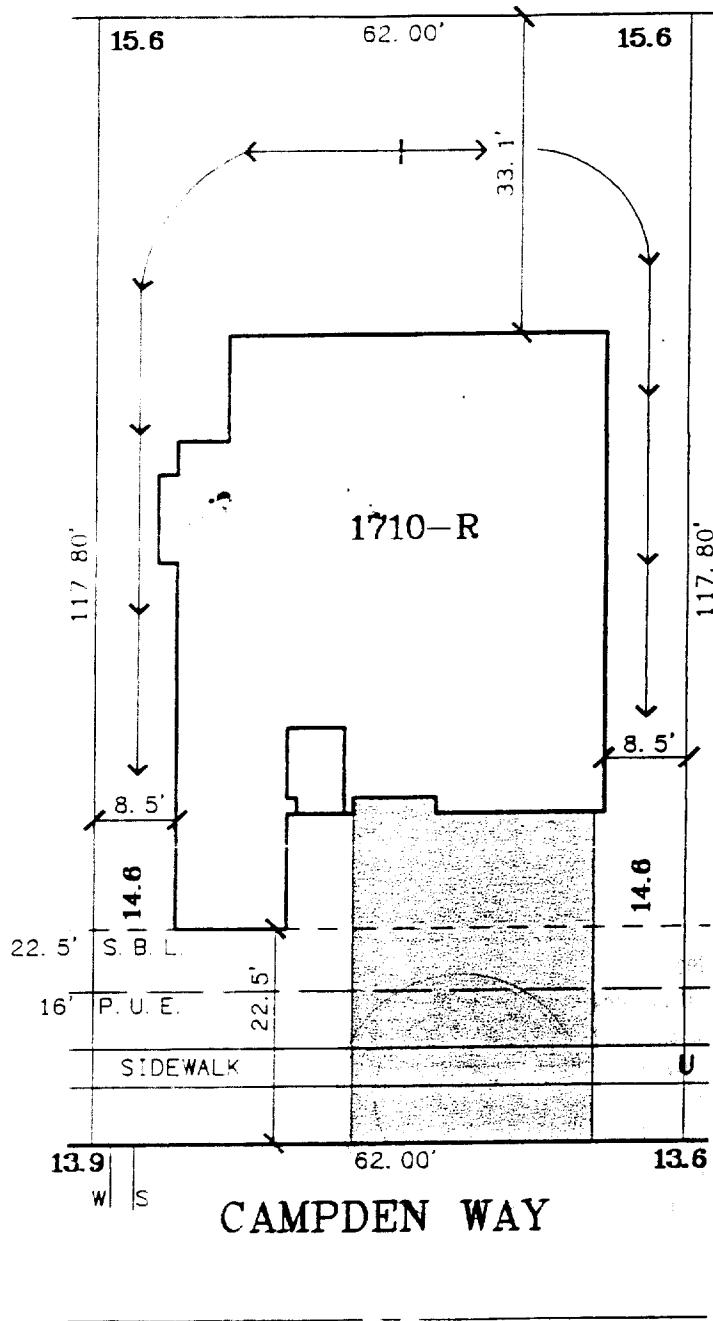

SCALE: 1" = 20'

LOT AREA: 7,304 SQ.FT.

A. P. N.
ADDRESS : 2546 CAMPDEN WAY

APPROVED BY

The Spink Corporation
2590 VENTURE OAKS WAY
SACRAMENTO, CA. 95833
PH:(916)925-5550 FAX:(916)921-9274

HERITAGE PLACE
UNIT NO. 2
LOT 122
PLAN 1710

RIVERSGATE

CITY OF SACRAMENTO, CA.
CLIENT: EPICK HOMES #1, L.L.C.
JOB NO.: 2808-004