

This set of plans and specifications must be kept on the job at all times and it is unlawful to make any changes or alterations from the same without written permission from the City of Sacramento Sign Section.

The approval of this plan and specification SHALL NOT be held to permit or approve the violation of any City Ordinance or State Law.

All electrical work must be U.L. labeled or be of equivalent standards, N.E.C. Sec. 90-6/and comply with chapter 14, Div. 2 of Sacramento City Code.

EQUIPMENT MUST BE USED AS DESIGNED AND INTENDED

# FILE COPY

PERM H

S-20932

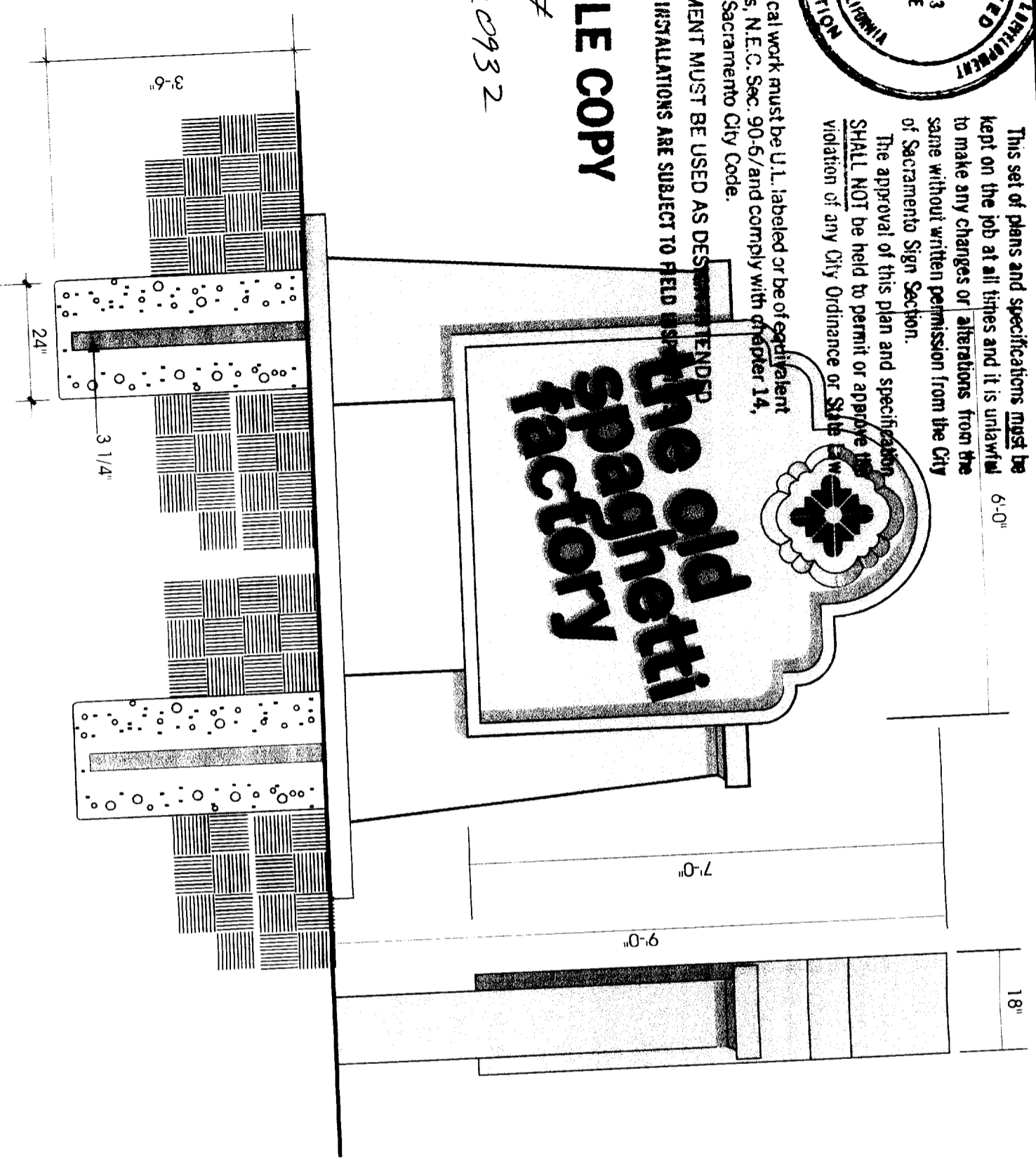

This is an original unpublished drawing created by Western Sign Co., Inc. It is submitted for your approval. It is not to be shown to anyone outside your organization, nor is it to be reproduced, copied or exhibited in any fashion without expressed written permission of Western Sign Co., Inc.

**Western Sign Co., Inc.**  
SIGN COMPARTMENT, INC.  
(916)933-3765 FAX (530)622-9367 (530)622-1420

SCALE: 1/4" = 1'-0" DATE: 9/23/99  
JOB: Old Spaghetti Factory  
Sacramento, Ca.  
SALESMAN: Dave Brazelton  
6221 Enterprise Drive  
Diamond Springs, CA 95619

- MANUFACTURE AND INSTALL ONE SINGLE FACE ILLUMINATED MONUMENT SIGN
- CONSTRUCTION
- FABRICATED ALUMINUM W/ TEXCOTE FINISH PAINTED TO MATCH BUILDING
- LETTERS
- 3" DEEP ALUMINUM CHANNEL CONSTRUCTION W/ CLEAR PLEX FACE COVER
- PAINTED RED INSIDE & RETURNS
- 1" RED TRIMCAP RETAINERS
- ILLUMINATION
- SINGLE TUBE TECNOLUX RUBY RED 30 M.A. NEON INSIDE OF LETTERS
- FABRICATED BORDER
- TO BE INDIRECTLY ILLUMINATED W/ SINGLE TUBE GREEN NEON
- DECORATION AT TOP OF SIGN
- TO BE CARVED HIGH DENSITY SIGN FOAM TO MATCH BUILDING

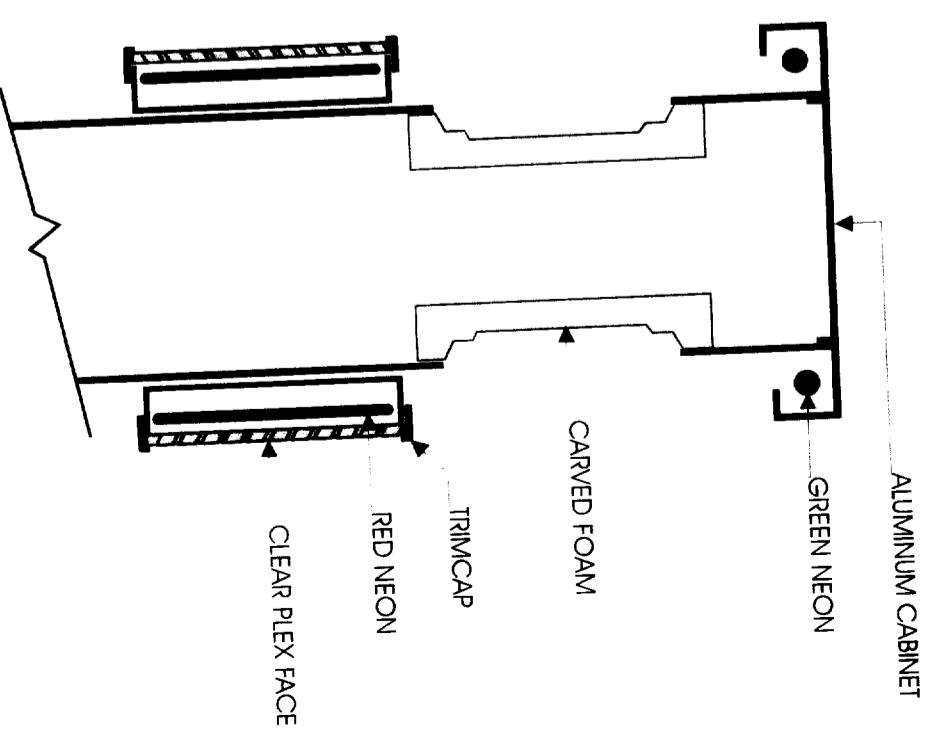

CONSTRUCTION DETAIL

**GROUND SIGN ENGINEERING**

JOB NAME: THE OLD SPAGHETTI FACTORY

ADDRESS: J STREET SACRAMENTO CA

QUOTE # 3312

SIGN ELEMENTS	TOP SIGN	LOW SIGN	LOW SKIRT	TOP SKIRT	OTHER	OTHER	OTHER
HEIGHT	7.00						
LENGTH	6.00						
HEIGHT TO BOTTOM	2.00						
WIND PRESSURE (pounds)	8.190						

POLE SPECIFICATIONS	POLE RESULTS (in grey cells)					
NUMBER OF POLES	2	POLE STAGE #	1	2	3	STUB
NUMBER OF POLE STAGES	1	POLE HEIGHT (TOP)	21	40	60	
SIGN MOUNT	B	SLEEVE LENGTH		2	2	2
POLE SHAPE	P	YEILD STRENGTH	31,600	31,600	31,600	31,600
POLE WINDLOAD	30	SECTION MODULUS	1.56			
NUMBER OF ANCHORS		POLE SIZE RESULTS	3x0.25			

BASE SPECIFICATIONS	BASE RESULTS			
BASE SHAPE	CAISSON	DRILLED FOUNDATION	BASE DEPTH	3.50 FEET
BASE WINDLOAD	30 PSF		BASE WIDTH	2.00 FEET
SOIL CONDITION	P MED CLAY, DENSE SAND		BASE LENGTH	
LATERAL SOIL PRESSURE	400 PSF		CUBIC YARDS	0.81 CU. YRD
RE-BAR			ANCHOR BOLT SIZE	
AUGER DIAMETER	2 FEET		BASE PLATE SIZE	

NOTE: Safety factors may be adjusted by increasing or decreasing windloads for poles and bases  
**SECTION MODULUS CALCULATIONS FOR POLES**

WIND PRESSURE  $P_n$  = HEIGHT X LENGTH X HEIGHT TO CENTRE X WINDLOAD      8.190 POUNDS  
 (FOR EACH SIGN ELEMENT)      or      8.19 KIIPS

SECTION MODULUS SM =  $(P_n \times 12) / \text{YEILD STRENGTH}$       = 1.56 0.00 0.00 0.00  
 NUMBER OF POLES      FOR POLE STAGES 1 2 3 STUB

YEILD STRENGTH = ALLOWABLE WORKING STRENGTH OF STEEL  $L_e (36,000 \text{ PSI} \times 88\% = 31,600 \text{ PER AS}$

**BASE CALCULATIONS**

CAISSON BASE      OVERTURNING MOMENT < LATERAL SOIL PRESSURE RESISTANCE

$P_a \times \text{HEIGHT TO CENTER} + \text{BASE DEPTH} \times 34 / (\text{BASE DEPTH} \times 56)$        $P_n \times \text{BASE DEPTH}$

(BASE DEPTH X 32 X AUGER DIAMETER) X NUMBER OF BASES

AREA WIND PRESSURE  $P_a$  = HEIGHT X LENGTH X WINDLOAD / 1000 (TO CONVERT TO KIIPS)

SOIL PRESSURE SP = ALLOWABLE LATERAL SOIL PRESSURE IN KIIPS

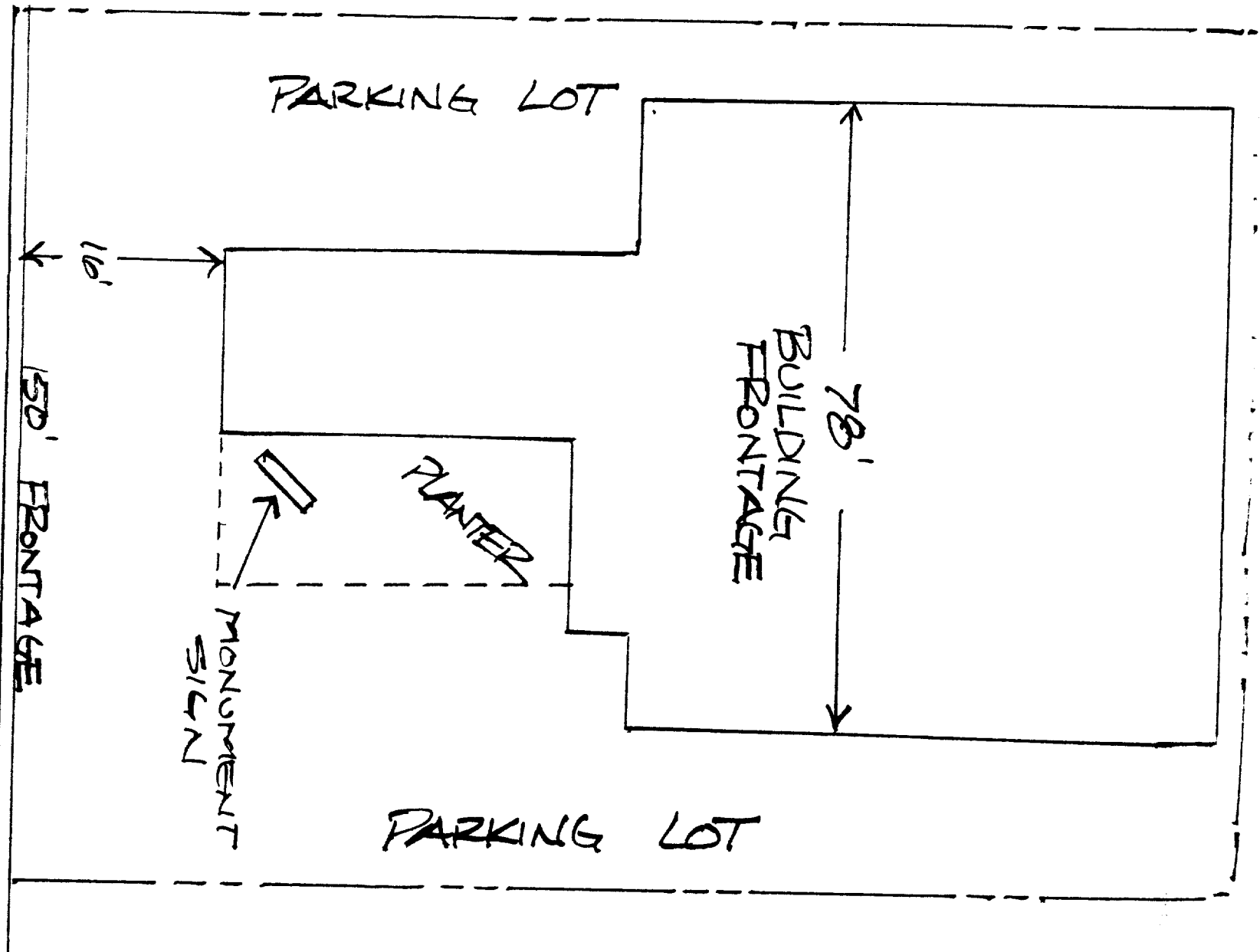

The old Spayheth factory  
 1910 J Street,  
 Sacramento, CA.

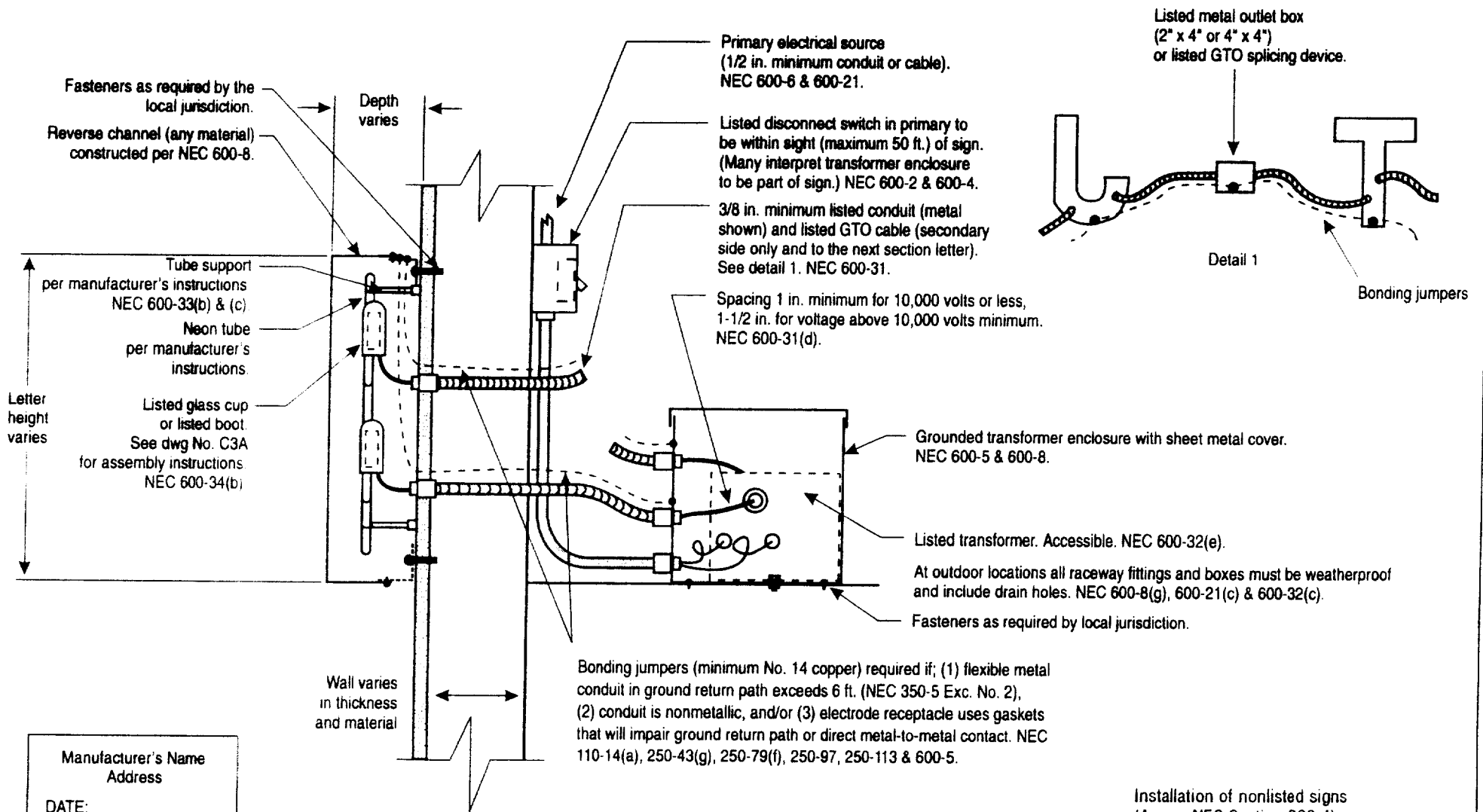

Manufacturer's Name \_\_\_\_\_  
 Address \_\_\_\_\_

DATE: \_\_\_\_\_

VOLTAGE: \_\_\_\_\_

AMPERES: \_\_\_\_\_

No. LAMPS: \_\_\_\_\_

Markings per NEC 600-7

All rights reserved. No part of this work covered by the copyright hereon may be reproduced or used in any form or by any means - graphic, electronic, or mechanical, including photocopying, recording, taping, or information storage and retrieval systems - without written permission of the publisher, except that single copies of individual pages may be made by a bona fide electrical sign installation firm for the sole purpose of providing guidance on the installation of electrical signs or outline lighting, without the permission of the publisher.

Installation of nonlisted signs  
 (As per NEC Section 600-4)

<b>HALO-ILLUMINATED INDOOR AND OUTDOOR REVERSE CHANNEL LETTERS. REMOTE TRANSFORMER WITH GLASS CUPS</b>	
	Date: October 1994
Scale None	IAEI Dwg. No. <b>NEC-T3</b>