

CITY OF SACRAMENTO

Permit No: 9804660

1231 I Street, Sacramento, CA 95814

Insp Area: 3

Site Address: 4124 3RD AV SAC

Sub-Type: RES

Parcel No: 0140114032

Housing (Y/N): Y

CONTRACTOR

OWNER

ARCHITECT

BATES THOMAS A
3519 26TH AV
SAC CA 95820

Nature of Work: REHAB PER HOUSING CASE

CONSTRUCTION LENDING AGENCY : I hereby affirm under penalty of perjury that there is a construction lending agency for the performance of the work for which this permit is issued (Sec. 3097, Civ. C).

Lender's Name _____ Lender's Address _____

LICENSED CONTRACTORS DECLARATION: I hereby affirm under penalty of perjury that I am licensed under provisions of Chapter 9 (commencing with section 7000) of Division 3 of the Business and Professions Code and my license is in full force and effect.

License Class _____ License Number _____ Date _____ Contractor Signature _____

OWNER-BUILDER DECLARATION: I hereby affirm under penalty of perjury that I am exempt from the contractors License Law for the following reason (Sec. 7031.5, Business and Professions Code; any city or county which requires a permit to construct, alter, improve, demolish, or repair any structure, prior to its issuance, also requires the applicant for such permit to file a signed statement that he or she is licensed pursuant to the provisions of the Contractors License Law (Chapter 9 (commencing with Section 7000) of Division 8 of the Business and Professions Code) or that he or she is exempt therefrom and the basis for the alleged exemption. Any violation of Section 7031.5 by any applicant for a permit subjects the applicant to a civil penalty of not more than five hundred dollars (\$500.00);

TJB
I, as a owner of the property, or my employees with wages as their sole compensation, will do the work, and the structure is not intended or offered for sale (Sec. 7044, Business and Professional Code: The Contractors License Law does not apply to an owner of property who builds or improves thereon, and who does such work himself or herself or through his/her own employees, provided that such improvements are not intended or offered for sale. If, however, the building or improvement is sold within one year of completion, the owner-builder will have the burden of proving that he/she did not build or improve for the purpose of sale.)

I, as owner of the property, am exclusively contracting with licensed contractors to construct the project (Sec. 7044, Business and Professions Code: The Contractors License Law does not apply to an owner of property who builds or improves thereon, and who contracts for such projects with a contractor(s) licensed pursuant to the Contractors License Law).

I am exempt under Sec. _____ B & PC for this reason: _____

Date 7-23-98 Owner Signature Thomas A. Bates

IN ISSUING THIS BUILDING PERMIT, the applicant represents, and the city relies on the representation of the applicant, that the applicant verified all measurements and locations shown on the application or accompanying drawings and that the improvement to be constructed does not violate any law or private agreement relating to permissible or prohibited locations for such improvements. This building permit does not authorize any illegal location of any improvement or the violation of any private agreement relating to location of improvements.

I certify that I have read this application and state that all information is correct. I agree to comply with all city and county ordinances and state laws relating to building construction and herby authorize representative(s) of this city to enter upon the abovementioned property for inspection purposes.

Date 7-23-98 Applicant/Agent Signature Thomas A. Bates

WORKER'S COMPENSATION DECLARATION: I hereby affirm under penalty of perjury one of the following declarations:

I have and will maintain a certificate of consent to self-insure for workers' compensation as provided for by Section 3700 of the Labor Code, for the performance of work for which the permit is issued.

I have and will maintain workers' compensation insurance, as required by Section 3700 of the Labor Code, for the performance of the work for which this permit is issued. My workers' compensation insurance carrier and policy number are:

Carrier _____ Policy Number _____

(This section need not be completed if the permit is for \$100 or less) I certify that in the performance of the work for which this permit is issued, I shall not employ any person in any manner so as to become subject to the workers' compensation laws of California and agree that if I should become subject to the workers' compensation provisions of Section 3700 of the Labor Code, I shall forthwith comply with those provisions.

Date 7-23-98 Applicant Signature Thomas A. Bates

WARNING: FAILURE TO SECURE WORKER'S COMPENSATION COVERAGE IS UNLAWFUL AND SHALL SUBJECT AN EMPLOYER TO CRIMINAL PENALTIES AND CIVIL FINES UP TO ONE HUNDRED THOUSAND DOLLARS (\$100,000) IN ADDITION TO THE COST OF COMPENSATION, DAMAGES AS PROVIDED FOR IN SECTION 3706 OF THE LABOR CODE, INTEREST AND ATTORNEY'S FEE.

THIS PERMIT SHALL EXPIRE BY LIMITATION IF WORK IS NOT COMMENCED WITHIN 180 DAYS.

RECORDING REQUESTED BY

NORTH AMERICAN TITLE GUARANTY
Loan No 145315 Order No 145315
AND WHEN RECORDED MAIL TO

Recorded in the County of Sacramento
John Dark, Clerk/Recorder



199805081073 2:51pm 05/08/98

004 40000070 04 13
R02 1 02 DTT Paid 7.00 0.00 0.00 0.00 0.00
0.00 0.00

Name
Thomas A. Bates
Address
3519 26th Avenue
Sacramento, CA 95820
City &
State

SPACE ABOVE THIS LINE FOR RECORDER'S USE

INDIVIDUAL GRANT DEED

A.P.N. 014-0114-032-0000

The undersigned grantor(s) declare(s):
Documentary transfer tax is \$ 31.90

City Transfer Tax is \$ 79.75

- (X) computed on full value of property conveyed, or
- () computed on full value less value of liens and encumbrances remaining at time of sale.
- () Unincorporated area: (X) City of Sacramento, and

FOR A VALUABLE CONSIDERATION, receipt of which is hereby acknowledged, DARRYL MAURICE CADOGAN

hereby GRANT(S) to THOMAS A. BATES, an unmarried man

the following described real property in the City of Sacramento
County of Sacramento, State of California:

LOT 19, AS SHOWN ON THE "PLAT OF VENADO PLACE", RECORDED IN THE OFFICE OF THE
COUNTY RECORDER OF SACRAMENTO COUNTY ON JULY 16, 1906, IN BOOK 7 OF MAPS, MAP NO.
16.

Dated: May 1, 1998

Darryl Maurice Cadogan
Darryl Maurice Cadogan

STATE OF CALIFORNIA)
COUNTY OF Sacramento)
On 5-7-98 before me,
L. Bishop, personally appeared
Darryl Maurice Cadogan

personally known to me (or proved to me on the basis of satisfactory evidence) to be the person(s) whose name(s) is/are subscribed to the within instrument and acknowledged to me that he/she/they executed the same in his/her/their authorized capacity(ies), and that by his/her/their signature(s) on the instrument the person(s), or the entity upon behalf of which the person(s) acted, executed the instrument.

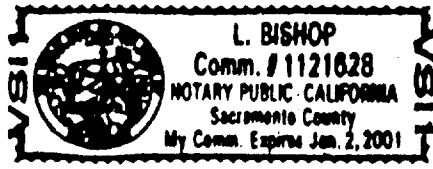

WITNESS my hand and official seal
Signature *L. Bishop*

(This area for official notarial seal)

MAIL TAX STATEMENTS TO SAME AS ABOVE
NAME ADDRESS CITY/STATE/ZIP

OWNER-BUILDER VERIFICATION

ATTENTION PROPERTY OWNER

An owner-builder building permit has been applied for in your name and bearing your signature.

Please complete and return this information in the envelope provided at your earliest opportunity to avoid unnecessary delay in processing and issuing your building permit. No building permit will be issued until this verification is received.

1. I personally plan to provide the major labor and materials for construction of the proposed improvement (yes or no) yes

2. I (have/have not) yes signed an application for a building permit for the proposed work.

3. I have contracted with the following person (firm) to provide the proposed construction:

Name _____ Address _____

City _____ Telephone _____

Contractors License No. _____

4. I plan to provide portions of the work, but I have hired the following person to coordinate, supervise, and provide the major work.

Name _____ Address _____

City _____ Telephone _____

Contractors License No. _____

5. I will provide some of the work but I have contracted (hired) the following to provide the work indicated:

Name	Address	Phone	Type of Work

Signed Thomas A. Bates

Job Address 4124 Sunnyside Ave Sacramento, CA Date 2-23-98

Permit No.: _____

4124 3RD AVE. SAC., CA. 95817

North or Front View of the front portion of Deck

ISSUED

JUL 23 1998

26'

CITY OF SACRAMENTO
DEVELOPMENT SERVICES DIV

BEAM

APPROVED BY: *[Signature]*
 APPROVAL DATE: *7-17-98*

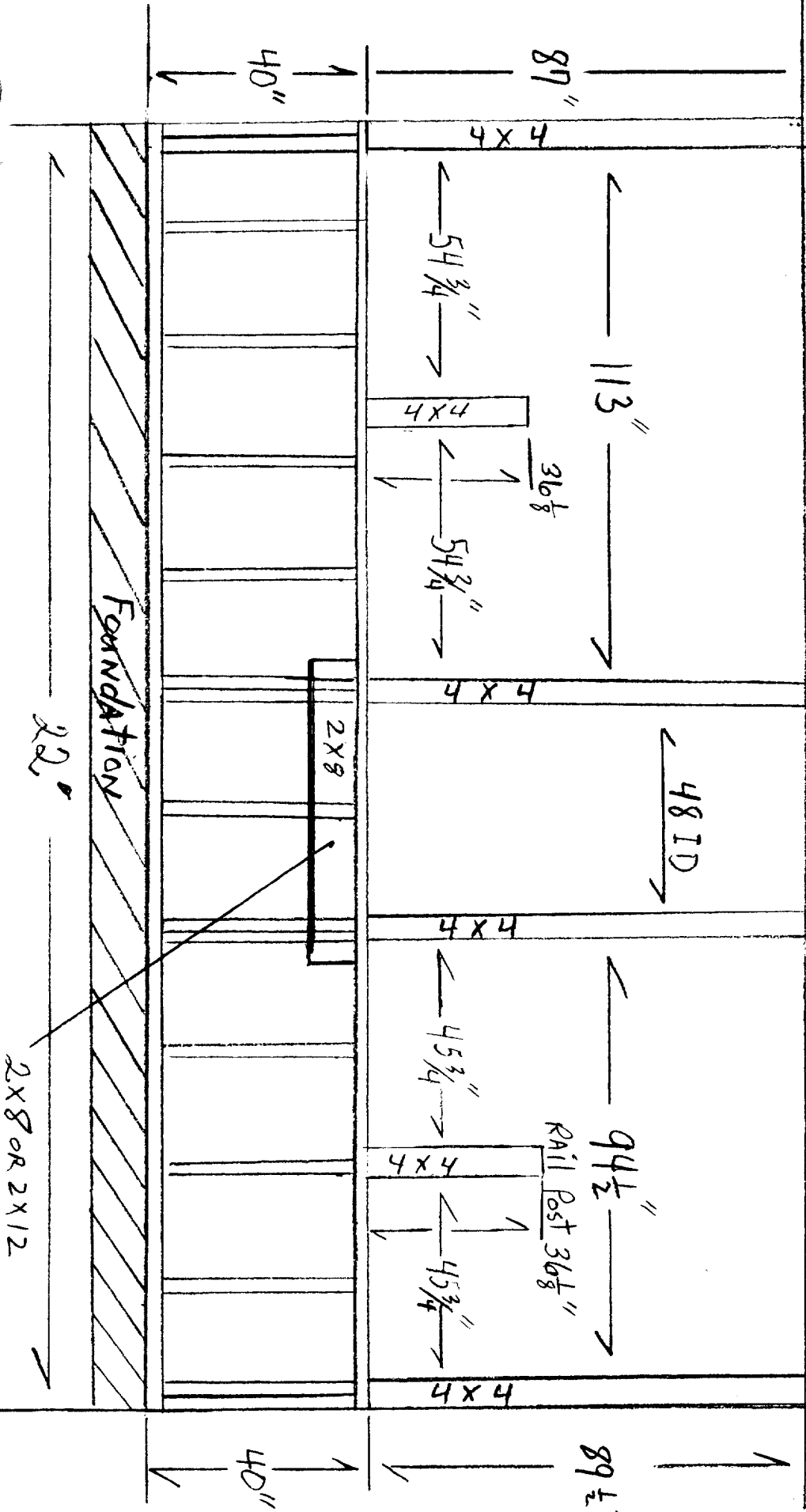

ALL WORK SUBJECT FIELD INSPECTOR'S APPROVAL

4124 3rd Ave. Sac., Ca. 95817

North or Front View of House at Back Portion of Deck

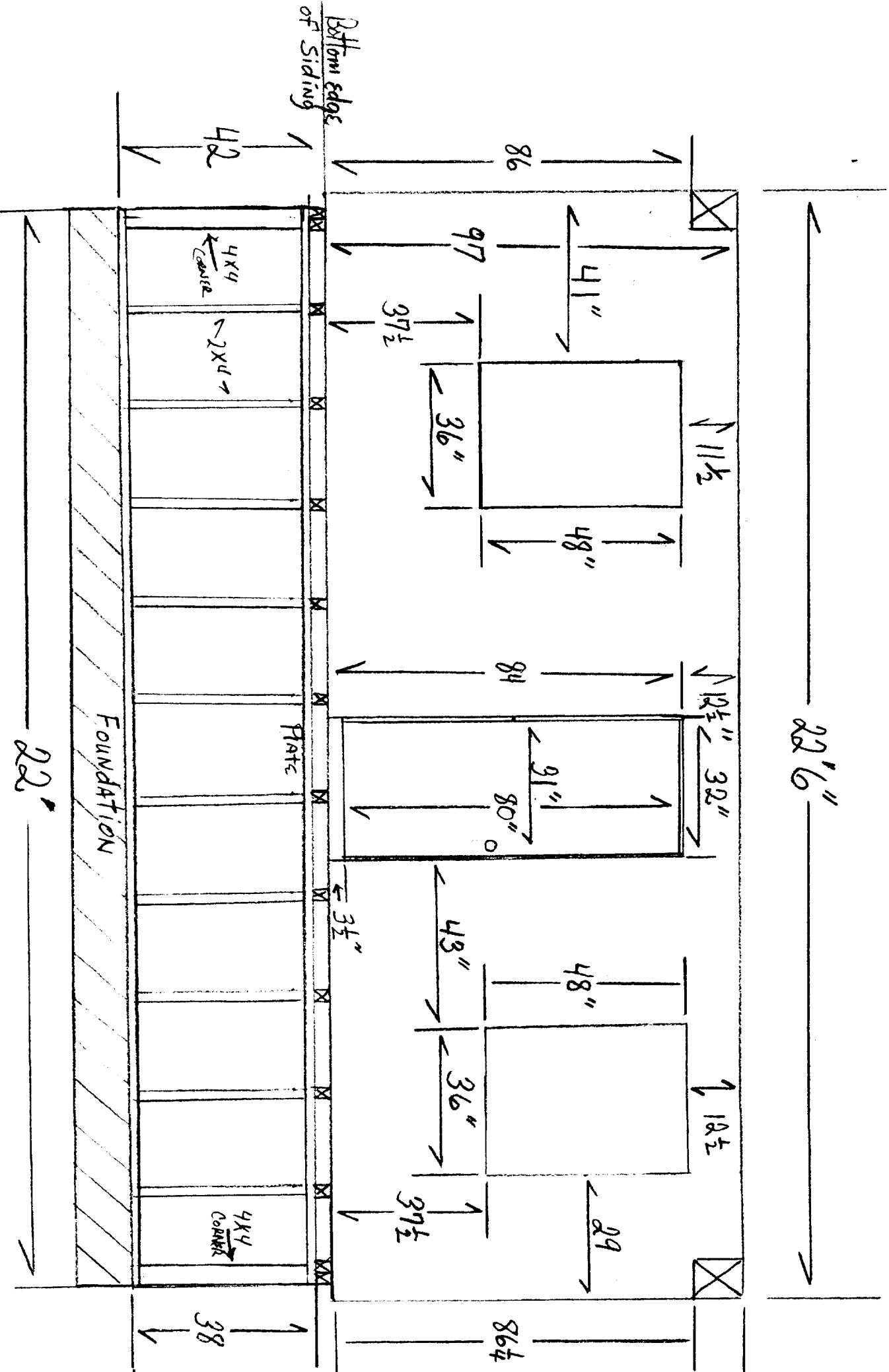

4124 38th Ave. Sac., Ca. 95817

Support wall for Middle of Front Deck

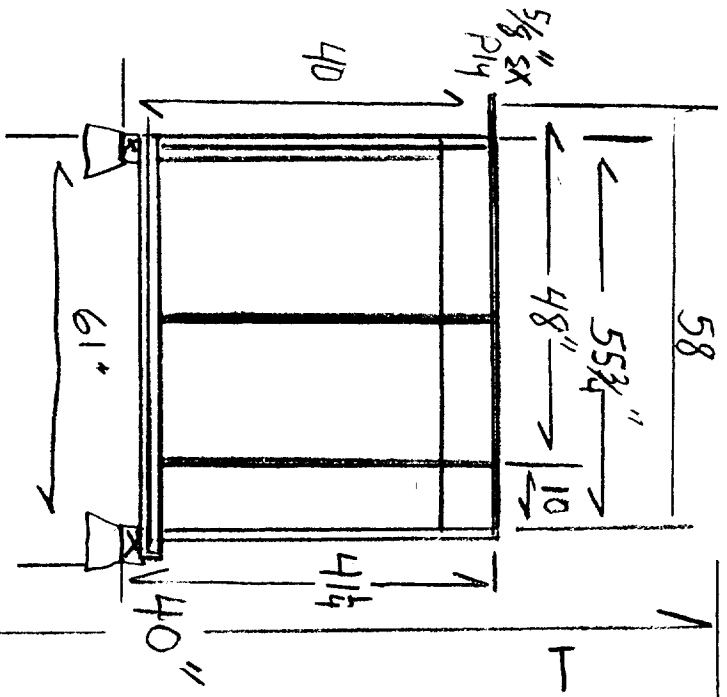

Outside edge of Ledger to outside edge of Top Plate 55 3/4

Top of Ledger to Foundation 41 1/4

Top Plate

Joist

gap 3/4"

Siding

How

Joist

2x10

FLOOR

2 B1

3/4" Sp

2" P1/4
SPACER

Bottom
Plats

2x6

Bottom
OD Plats to Plats
1/4"

2x4

Foundation

2x4
2x4

2x4

19 5/8"

2x4

2x6

19 5/8"

2x4 PLATE

2x4

2x4

2x6

2x4
Block

7 3/4"

2x4

2x6
1x10

B

Deck Railing

2x4 stringer
2x4
1x4
2x2

4124 3rd Ave. SAC, CA 95817

Front Deck Stairs & Railing

Stringer

Mb/room car

4x4 Post

1x4

1x4

3 1/2"

37 1/2"
Total Run 67 1/2"
Riser 7 5/8"
Total Rise 47 1/4"

4x4 Post

37 1/2"

3-Hangers for Stringers

50 1/2"

47 1/2"

52"

1 3/4" x 9/8"

1 piece Bullnose Trim (typical)

Close Riser Cap

Siding

1/2" x 2" x 6" Long Bolt Block

Paint entire stair structure

6 1/2" (typical)

2x6 pressure Treated Kwikwik

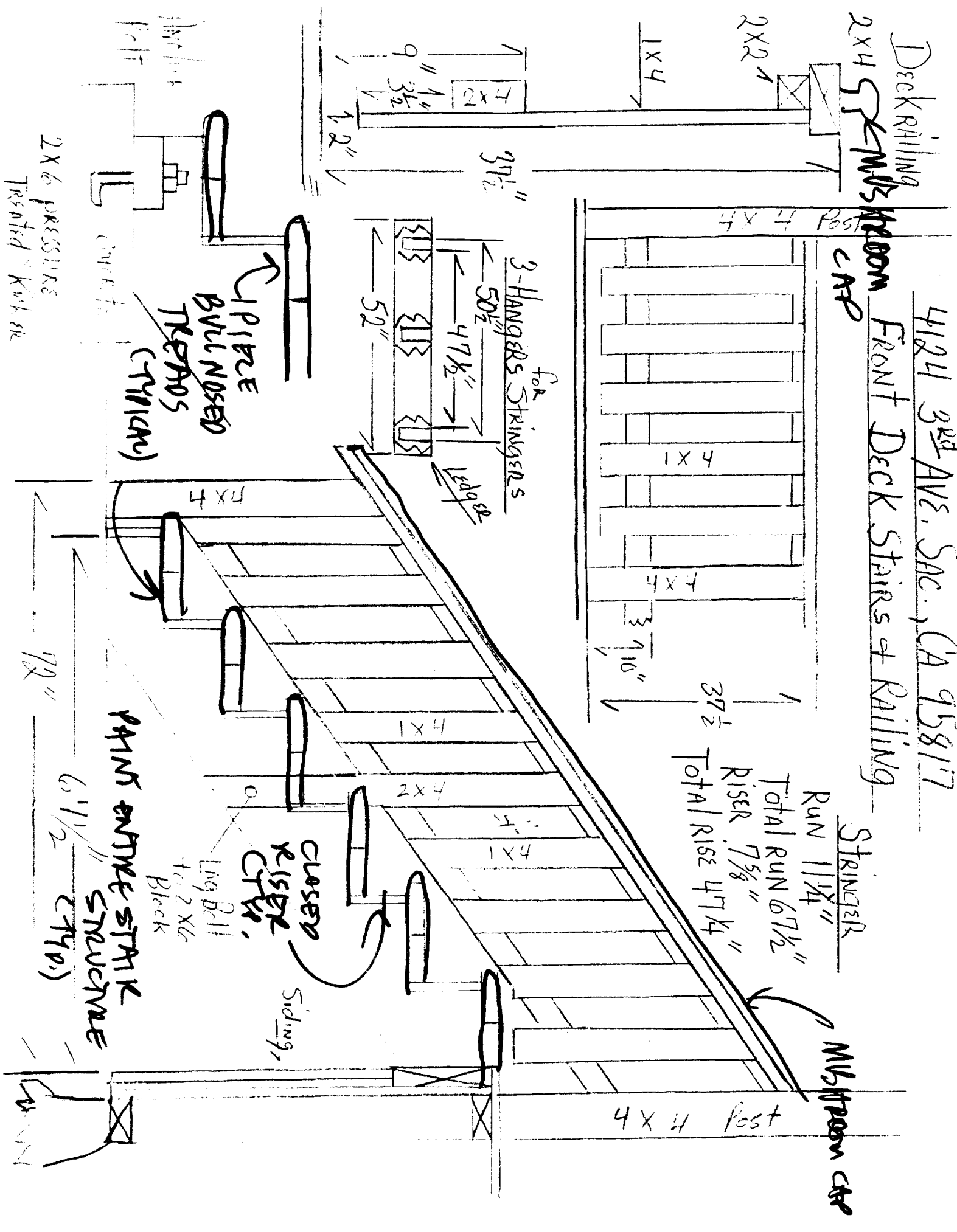

916 736-1769
 BATES

4124 3RD AVE. SAC, CA 95817

Side wall
 to Support
 FRONT DECK

Top View of the front Deck

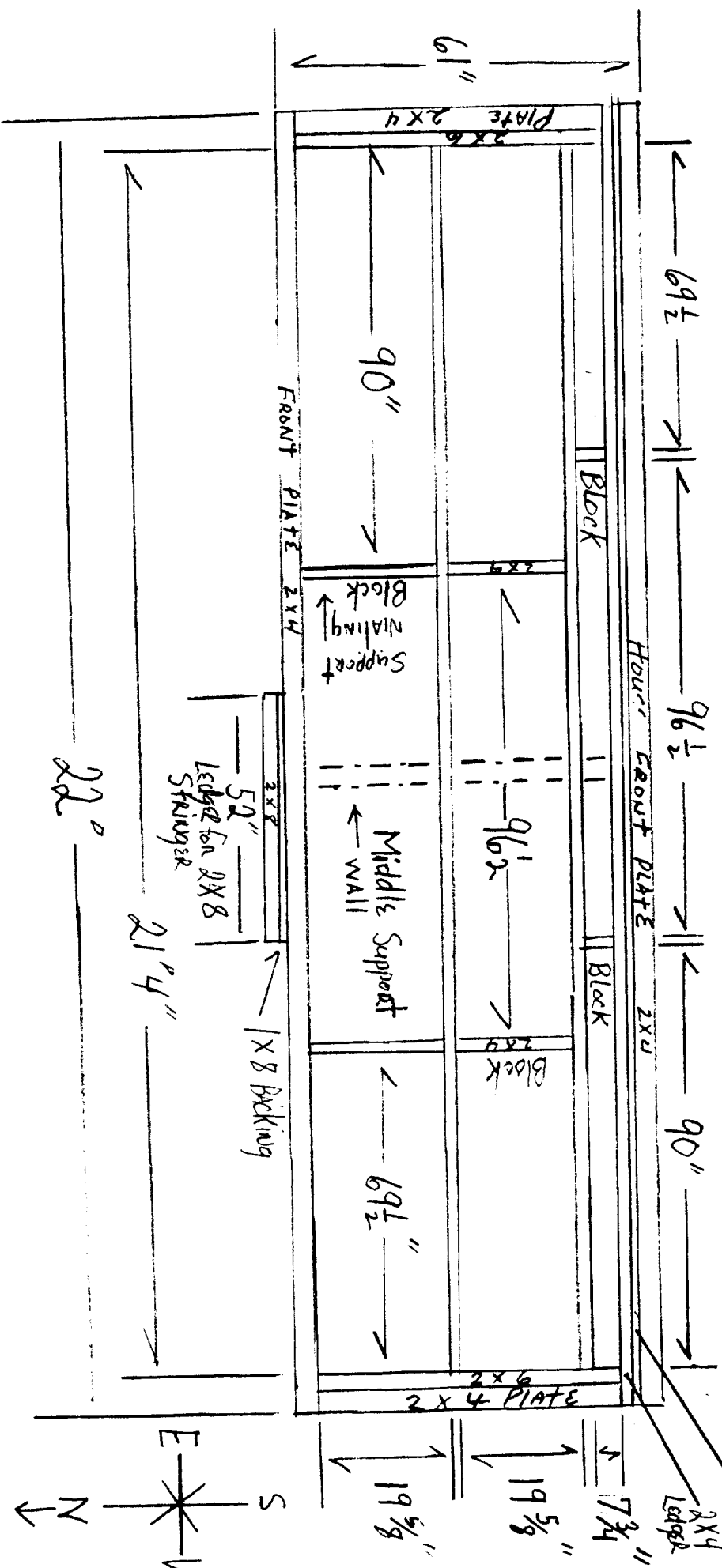
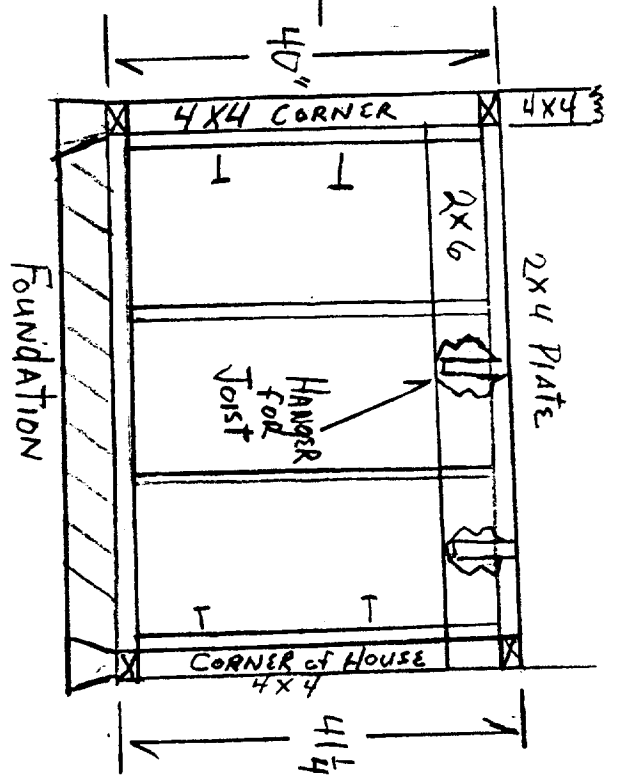

4124 3RD AVE. SAC, CA, 95817

Front Portion of Deck, Stringer & Supports
Back side of House (south)

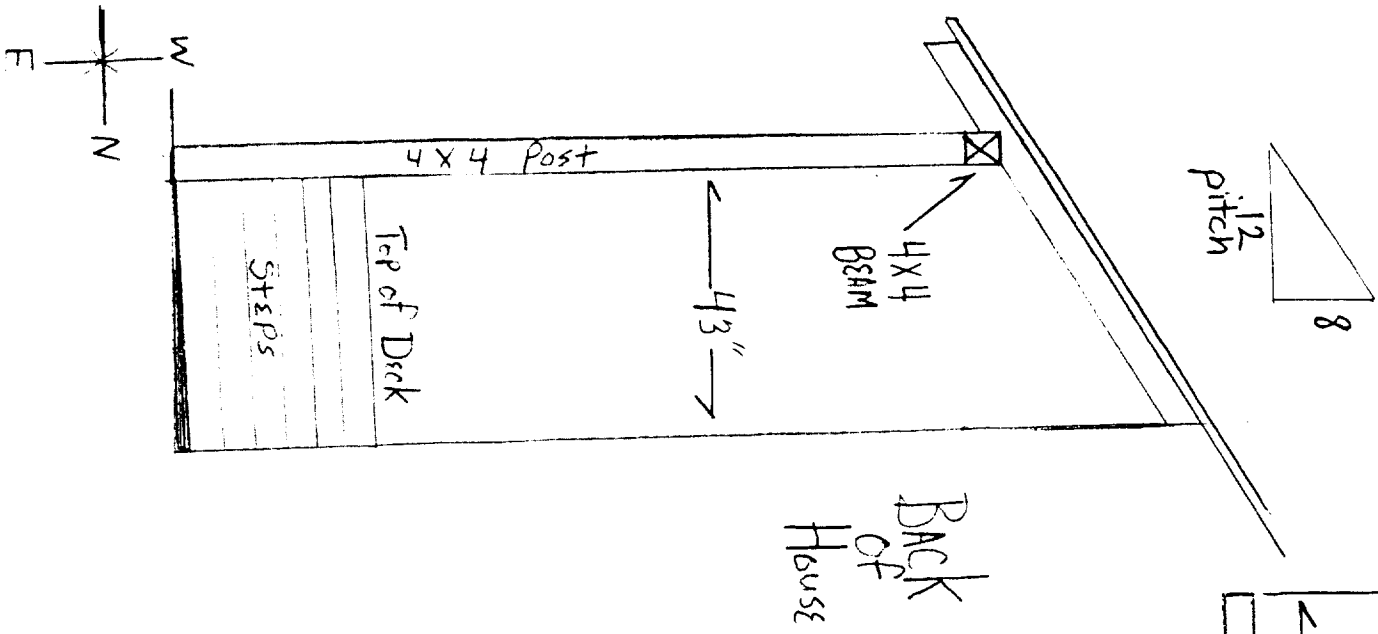
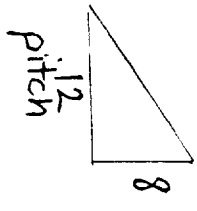

BACK OF House

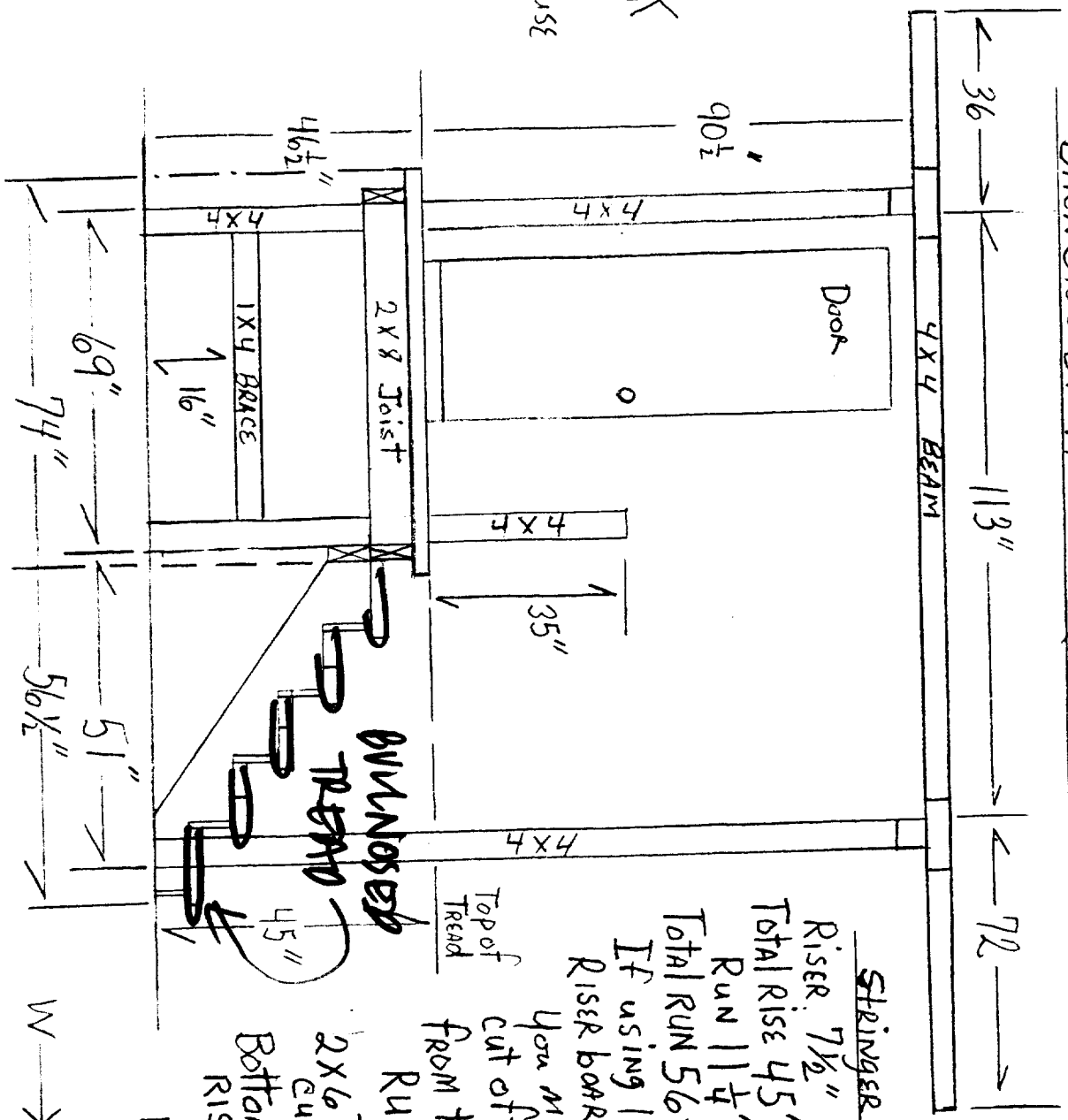

Stringer
Riser: $7\frac{1}{2}$ "
Total Rise 45 "
Run $11\frac{1}{4}$ "
Total Run $56\frac{1}{2}$ "
If using 1×8 Riser board, you must cut off $\frac{3}{4}$ from top

Bottom Riser 6 "
 2×6 Tread cut

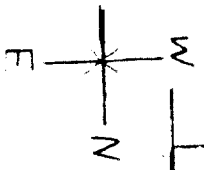

South or Rear View of House + Back Portion of Deck + Stringer

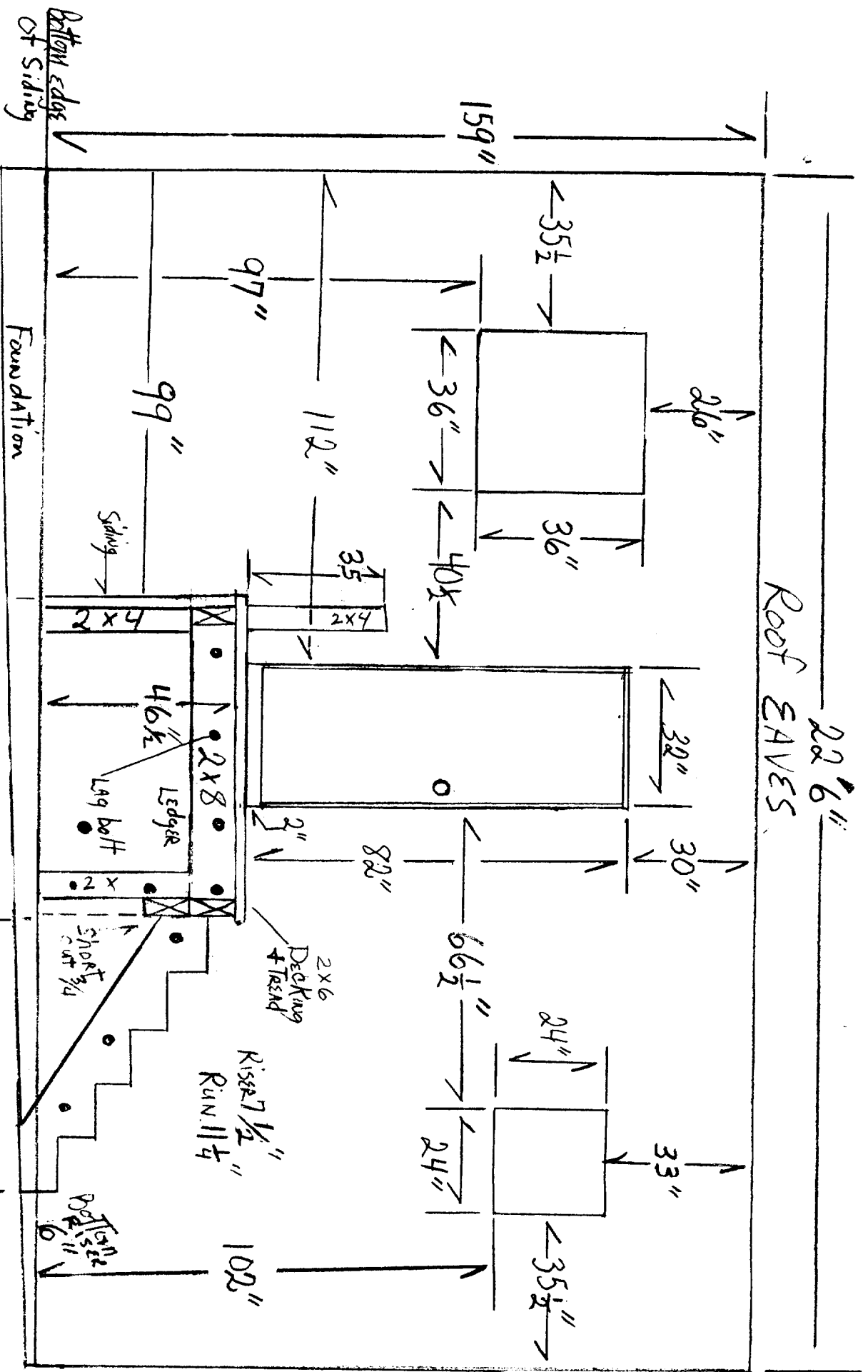

22' 6"

Roof EAVES

Bottom edge of Siding

Foundation

Siding

2x6 Decking + TRAMP

Riser 7 1/2" Run 11 1/4"

Pattern 11 1/4"

Stringer with out Riser Board + Run
 Short cut top Run 3/4" = 10 1/2" NO RISER BOARD

TOP FROM 2x6 STR. BOARD

4194 3RD AVE, SAC, CA 95817

Top View of 2x6 on Back Deck

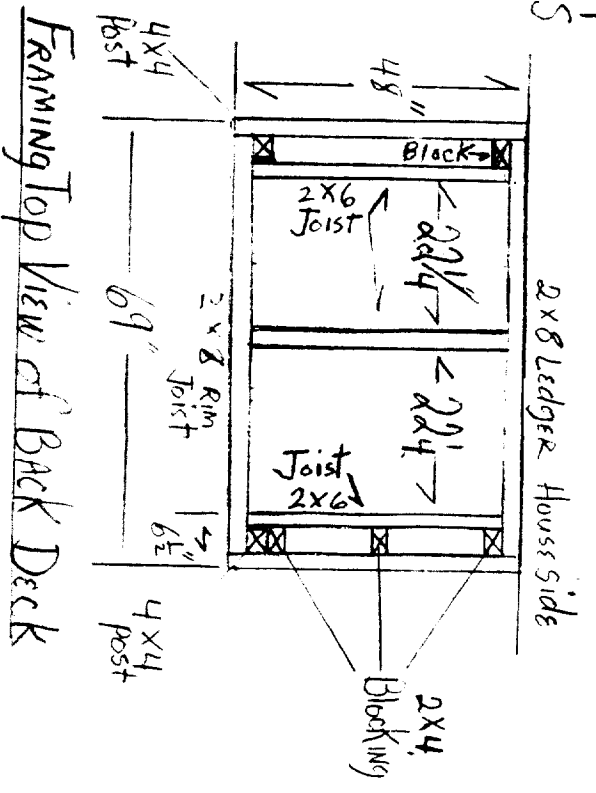
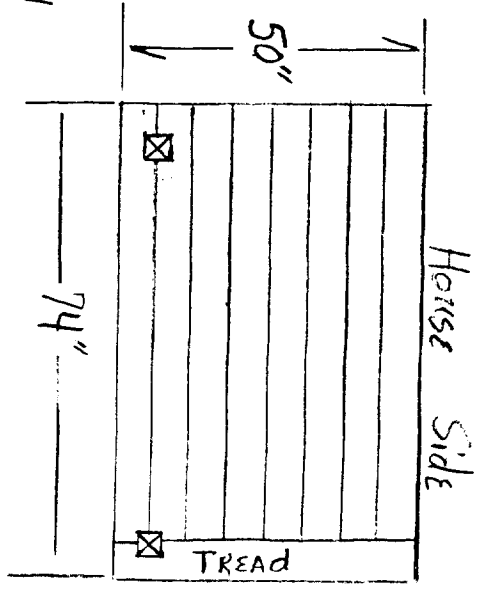

Framing Top View of Back Deck

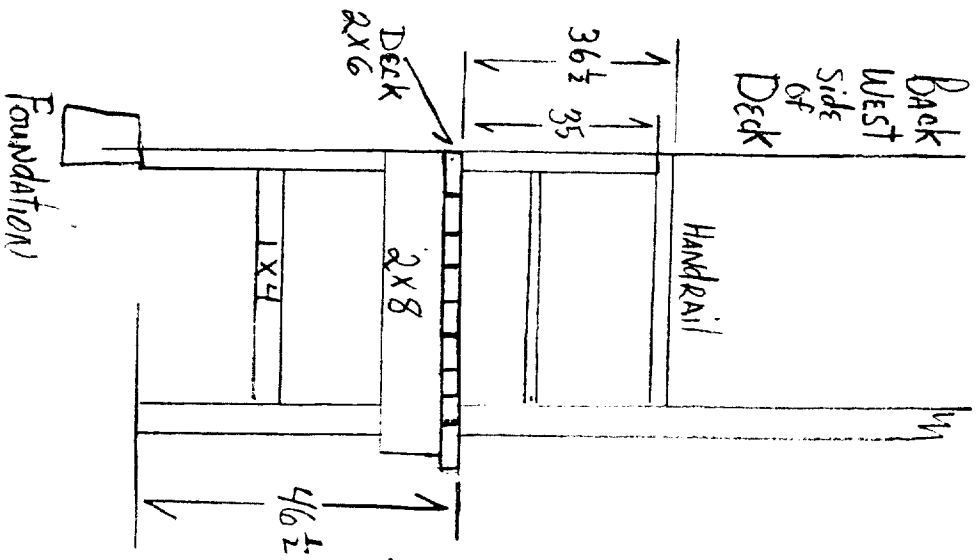

2x6 for Decking + Tread
1x8 for Riser board

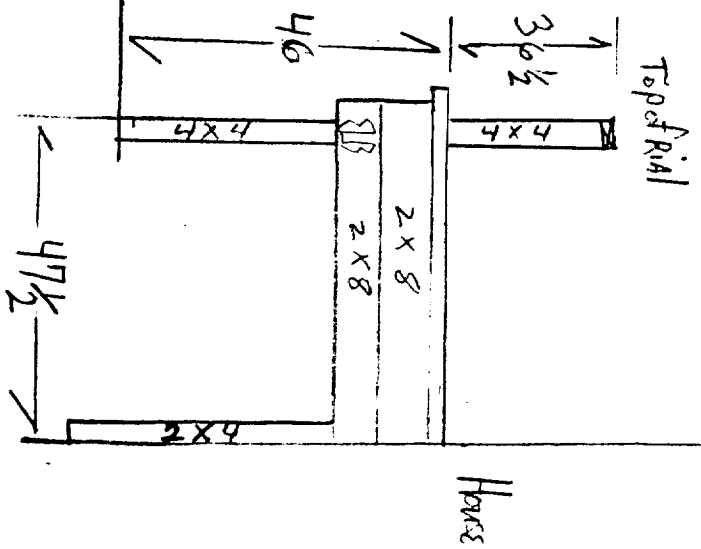
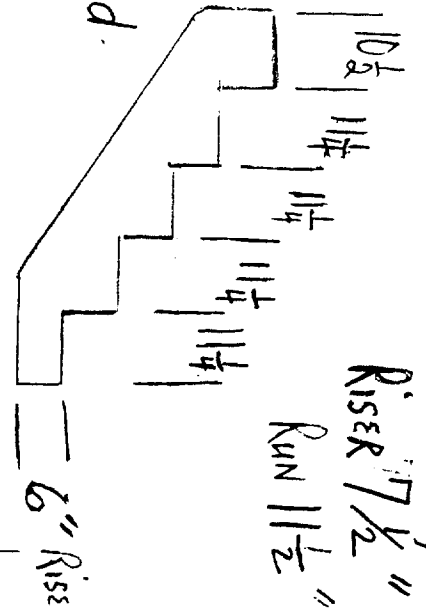

EAST Side of Back Deck

4104 3RD AVE. SAC., CA 95817

Deck, Stairs & Railing
Back side of House (South)

Stair handrail

Bottom 2"x4" is
Set even with
Bottom of
1"x4"s

MUSHROOM CAP
Deck RAILING

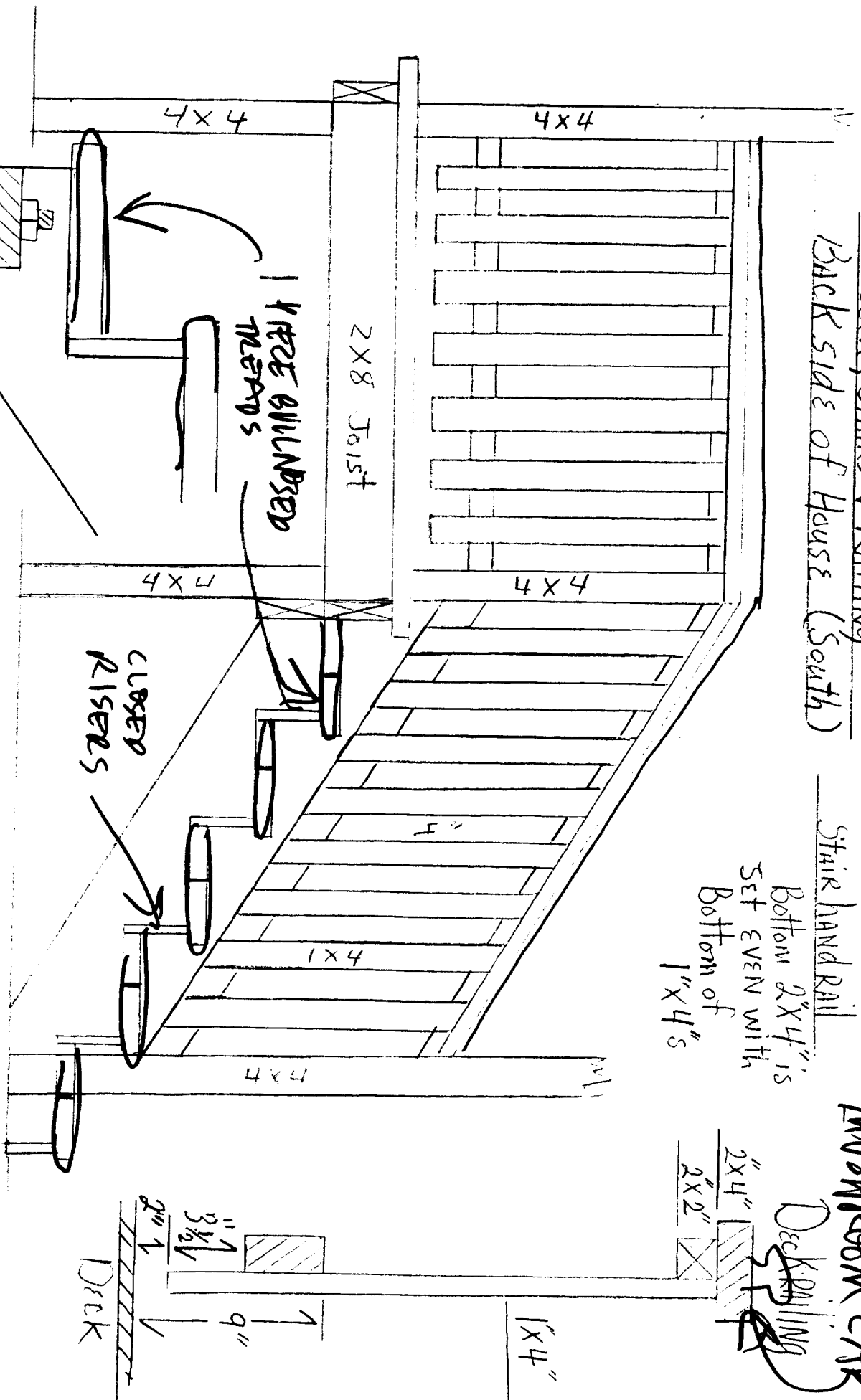

Anchor Bolt

Concrete

2x6 Pressure Treated "Kicker"

1x4x2x8 GULLNERED
NEEDS

CLOSED
RISERS

NOTE: PAINT ENTIRE STAIR
STRUCTURE
(STY.P.)

Anchor Bolt

4x4 Post

4x4 Cup

Concrete

