

**CITY OF SACRAMENTO**

**1231 I Street, Sacramento, CA 95814**

**Permit No: 9904667**

**Insp Area: 3**

**Site Address: 5310 7TH AV SAC**

**Parcel No: 015-0054-002**

**Sub-Type: RES**

**Housing (Y/N): N**

**CONTRACTOR**

PATIOS PLUS  
705-2 E BIDWELL #161  
FOLSOM CA 95630

**OWNER**

BERGMAN JANICE D  
5310 7TH AV  
SACRAMENTO CA 95820

**ARCHITECT**

**Nature of Work: 240 SQ FT ALUMINUM PATIO COVER**

**CONSTRUCTION LENDING AGENCY :** I hereby affirm under penalty of perjury that there is a construction lending agency for the performance of the work for which this permit is issued (Sec. 3097, Civ. C).

Lender's Name \_\_\_\_\_ Lender's Address \_\_\_\_\_

**LICENSED CONTRACTORS DECLARATION:** I hereby affirm under penalty of perjury that I am licensed under provisions of Chapter 9 (commencing with section 7000) of Division 3 of the Business and Professions Code and my license is in full force and effect.

X License Class B License Number 488632 Date 5-11-99 Contractor Signature [Signature]

**OWNER-BUILDER DECLARATION:** I hereby affirm under penalty of perjury that I am exempt from the contractors License Law for the following reason (Sec. 7031.5, Business and Professions Code; any city or county which requires a permit to construct, alter, improve, demolish, or repair any structure, prior to its issuance, also requires the applicant for such permit to file a signed statement that he or she is licensed pursuant to the provisions of the Contractors License Law (Chapter 9 (commencing with Section 7000) of Division 8 of the Business and Professions Code) or that he or she is exempt therefrom and the basis for the alleged exemption. Any violation of Section 7031.5 by any applicant for a permit subjects the applicant to a civil penalty of not more than five hundred dollars (\$500.00);

\_\_\_\_ I, as a owner of the property, or my employees with wages as their sole compensation, will do the work, and the structure is not intended or offered for sale (Sec. 7044, Business and Professional Code: The Contractors License Law does not apply to an owner of property who builds or improves thereon, and who does such work himself or herself or through his/her own employees, provided that such improvements are not intended or offered for sale. If, however, the building or improvement is sold within one year of completion, the owner-builder will have the burden of proving that he/she did not build or improve for the purpose of sale.)

\_\_\_\_ I, as owner of the property, am exclusively contracting with licensed contractors to construct the project (Sec. 7044, Business and Professions Code: The Contractors License Law does not apply to an owner of property who builds or improves thereon, and who contracts for such projects with a contractor(s) licensed pursuant to the Contractors License Law).

\_\_\_\_ I am exempt under Sec. \_\_\_\_\_ B & PC for this reason: \_\_\_\_\_

Date \_\_\_\_\_ Owner Signature \_\_\_\_\_

**IN ISSUING THIS BUILDING PERMIT,** the applicant represents, and the city relies on the representation of the applicant, that the applicant verified all measurements and locations shown on the application or accompanying drawings and that the improvement to be constructed does not violate any law or private agreement relating to permissible or prohibited locations for such improvements. This building permit does not authorize any illegal location of any improvement or the violation of any private agreement relating to location of improvements.

I certify that I have read this application and state that all information is correct. I agree to comply with all city and county ordinances and state laws relating to building construction and hereby authorize representative(s) of this city to enter upon the abovementioned property for inspection purposes.

X Date 5-11-99 Applicant/Agent Signature [Signature]

**WORKER'S COMPENSATION DECLARATION:** I hereby affirm under penalty of perjury one of the following declarations:

\_\_\_\_ I have and will maintain a certificate of consent to self-insure for workers' compensation as provided for by Section 3700 of the Labor Code, for the performance of work for which the permit is issued.

\_\_\_\_ I have and will maintain workers' compensation insurance, as required by Section 3700 of the Labor Code, for the performance of the work for which this permit is issued. My workers' compensation insurance carrier and policy number are:

Carrier \_\_\_\_\_ Policy Number \_\_\_\_\_ Exp Date \_\_\_\_\_

\_\_\_\_ (This section need not be completed if the permit is for \$100 or less) I certify that in the performance of the work for which this permit is issued, I shall not employ any person in any manner so as to become subject to the workers' compensation laws of California and agree that if I should become subject to the workers' compensation provisions of Section 3700 of the Labor Code, I shall forthwith comply with those provisions.

X Date 5-11-99 Applicant Signature [Signature]

**WARNING:** FAILURE TO SECURE WORKER'S COMPENSATION COVERAGE IS UNLAWFUL AND SHALL SUBJECT AN EMPLOYER TO CRIMINAL PENALTIES AND CIVIL FINES UP TO ONE HUNDRED THOUSAND DOLLARS (\$100,000) IN ADDITION TO THE COST OF COMPENSATION, DAMAGES AS PROVIDED FOR IN SECTION 3706 OF THE LABOR CODE, INTEREST AND ATTORNEY'S FEE.

**THIS PERMIT SHALL EXPIRE BY LIMITATION IF WORK IS NOT COMMENCED WITHIN 180 DAYS.**

### City of Sacramento Development Services Division Planning and Zoning Information Request

Project Address: 5310 7<sup>th</sup> AVE SACR

Assessor's Parcel Number: 015-0054-002

PREVIOUS USE \_\_\_\_\_

Current Land Use: \_\_\_\_\_

Description of Request/Proposed Use: \_\_\_\_\_

IS THIS A CHANGE OF USE? \_\_\_\_\_

Zoning Designation: R-1

Prior Applications for Project Site(P#,Z#,DRPB#): \_\_\_\_\_

Comments: Needs to meet rear yard setback  
15' (between posts and rear property line)

Are There Any Planning Issues?: (Circle One) YES NO

\* STAFF Site Plan Check Required? (Circle One) YES NO

\* FIELD INSPECTION REQUIRED (CIRCLE ONE) YES NO

\* Design Review/ Preservation Required?: (Circle One) YES NO

Planning Review by/Date: [Signature] 5-11-99

A list of items that must be reviewed by Planning is provided on the reverse side of this form.

MICRO ENTERPRISE ZONING

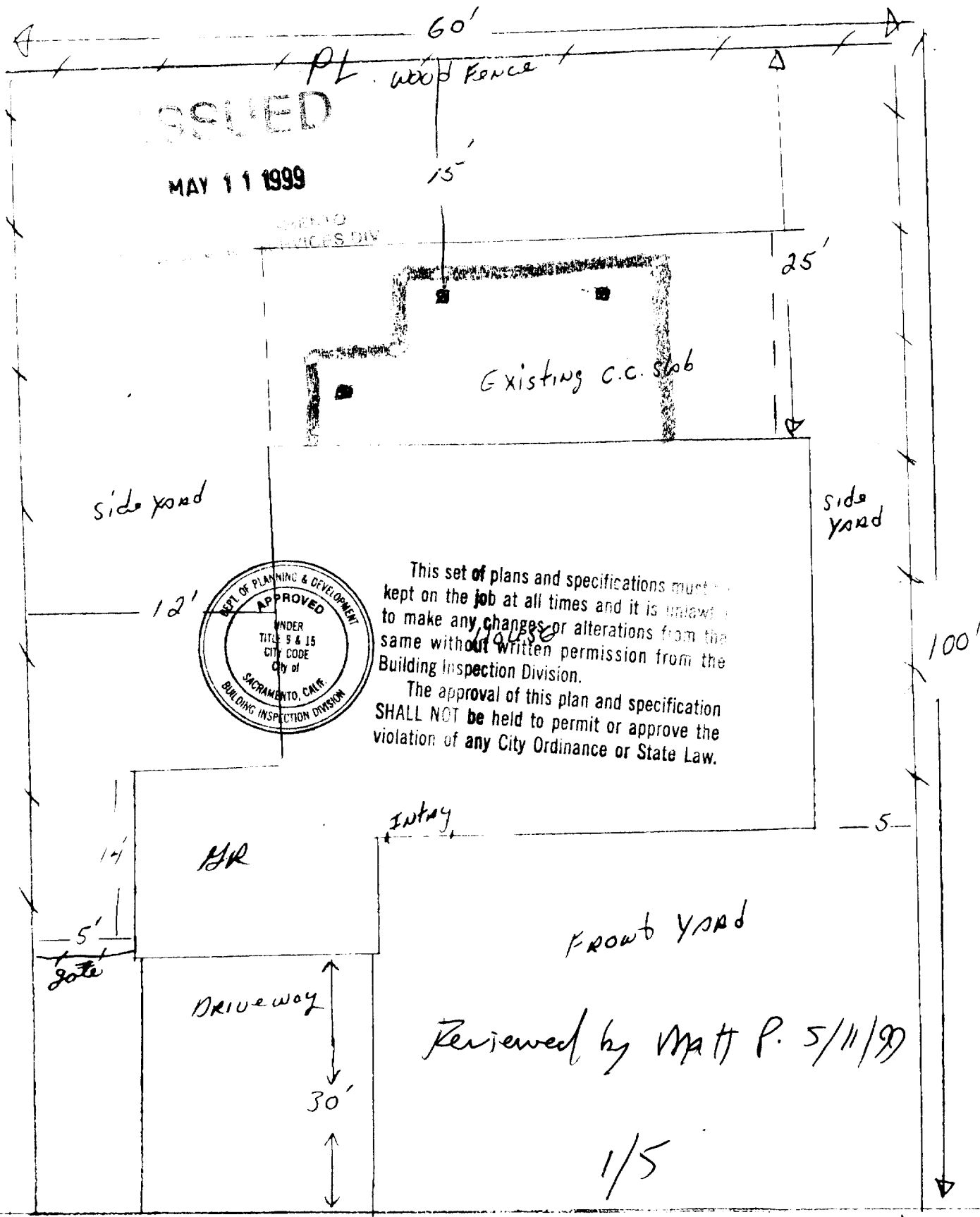

ISSUED

MAY 11 1999

SACRAMENTO SERVICES DIV

PL WOOD FENCE

Existing C.C. slab

Side yard

Side yard

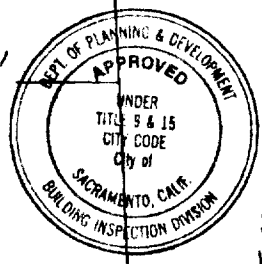

This set of plans and specifications must be kept on the job at all times and it is unlawful to make any changes or alterations from the same without written permission from the Building Inspection Division.

The approval of this plan and specification SHALL NOT be held to permit or approve the violation of any City Ordinance or State Law.

MR

Entry

FRONT YARD

Reviewed by Matt P. 5/11/99

1/5

5310 7th AVE SACTO 95820

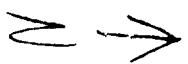

EXISTING ROOF

EXISTING "ALUMINUM"

2x6 ROOF MOUNT

1 1/2" Lattice

14x14

1 1/2" Lattice

2x6 RAFTERS

5x8'

6x8 POST  
6x8 Header

6x8 POST  
6x8 Header

6x8 POST

2/5

TOP VIEW OF NEW ALUMINUM LATTICE PATIO COVER

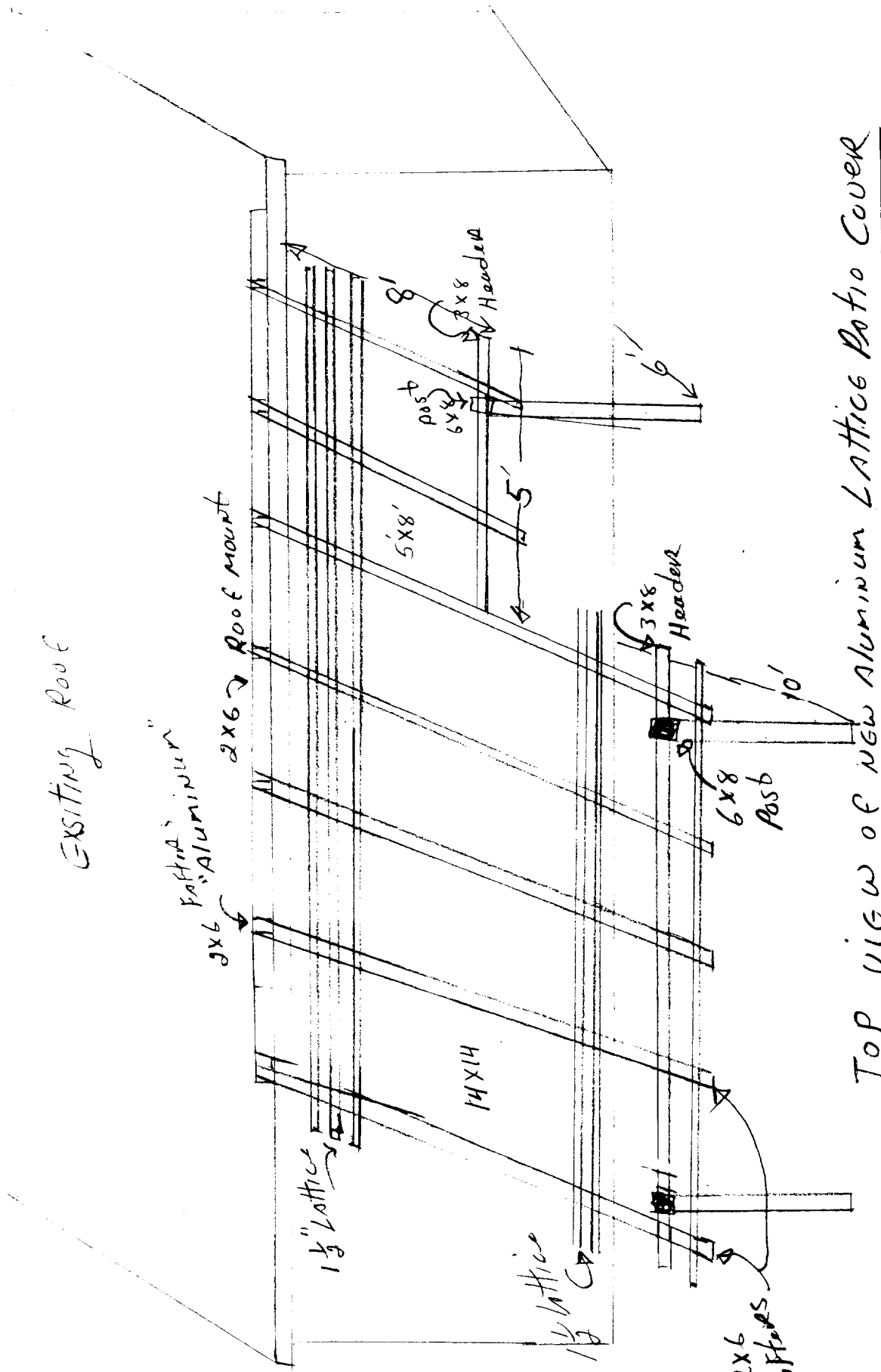
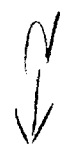

Existing Roof

Roof Mount

BACK OF HOUSE

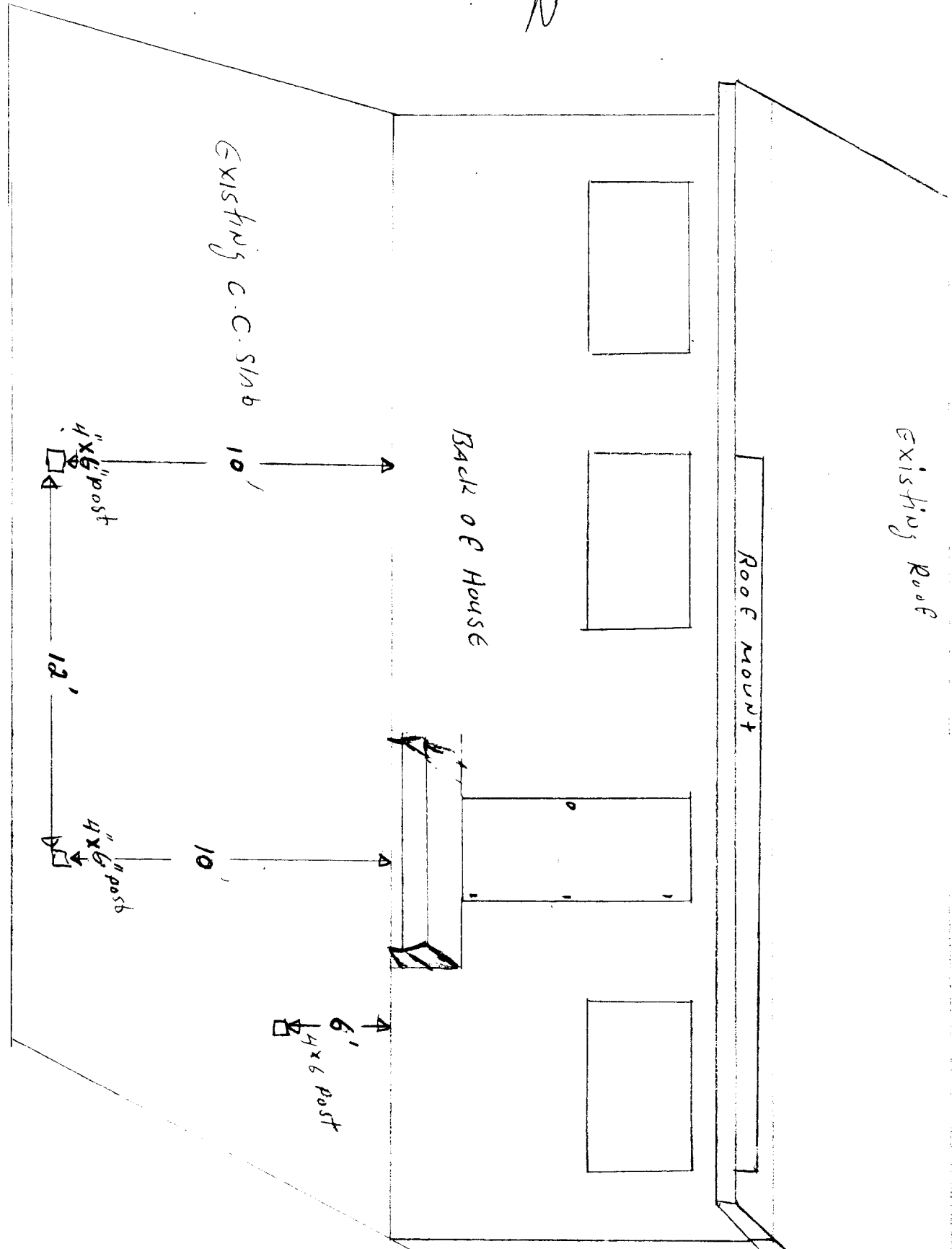
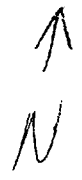

Existing c.c. slab

4x6 post

12'

4x6 post

10'

6' 4x6 post

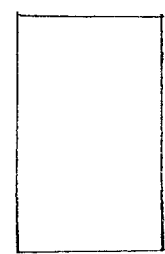
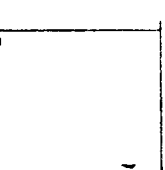
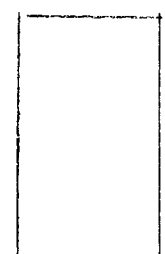

3/5

WOOD Back Panel

P.L.

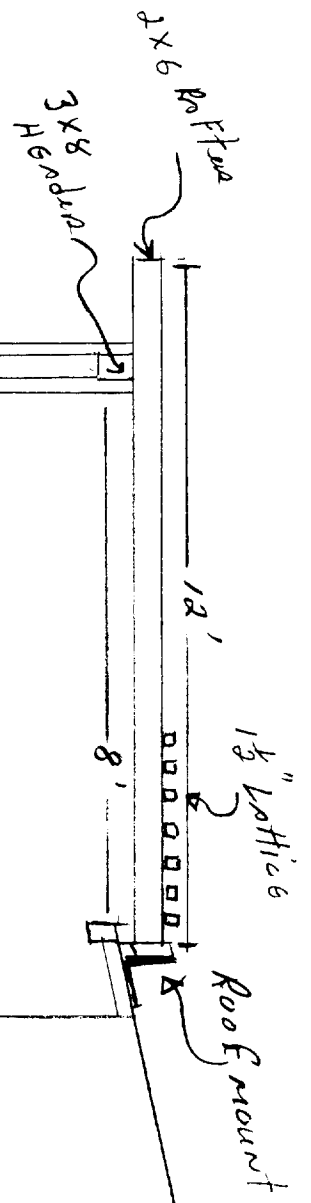
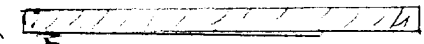

15'

4x6 Post

10'

side view

Existing House

415



TEH 8/20/97

13702  
 13703  
 13704  
 13705  
 13706  
 13707  
 13708  
 13709  
 13710  
 13711  
 13712  
 13713  
 13714  
 13715  
 13716  
 13717  
 13718  
 13719  
 13720  
 13721  
 13722  
 13723  
 13724  
 13725  
 13726  
 13727  
 13728  
 13729  
 13730  
 13731  
 13732  
 13733  
 13734  
 13735  
 13736  
 13737  
 13738  
 13739  
 13740  
 13741  
 13742  
 13743  
 13744  
 13745  
 13746  
 13747  
 13748  
 13749  
 13750  
 13751  
 13752  
 13753  
 13754  
 13755  
 13756  
 13757  
 13758  
 13759  
 13760  
 13761  
 13762  
 13763  
 13764  
 13765  
 13766  
 13767  
 13768  
 13769  
 13770  
 13771  
 13772  
 13773  
 13774  
 13775  
 13776  
 13777  
 13778  
 13779  
 13780  
 13781  
 13782  
 13783  
 13784  
 13785  
 13786  
 13787  
 13788  
 13789  
 13790  
 13791  
 13792  
 13793  
 13794  
 13795  
 13796  
 13797  
 13798  
 13799  
 13800

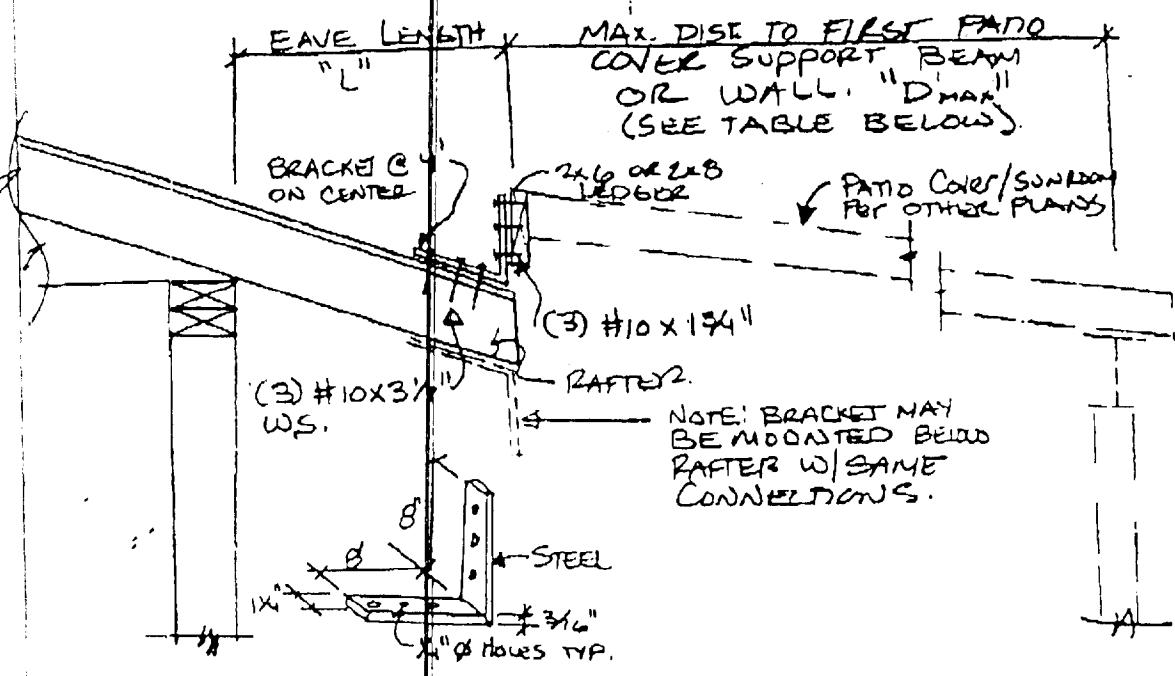

ROOF LIVE LOAD (PSF)	RAFTER SPACING (IN)	EAVE LENGTH (IN)	MAX DISTANCE TO FIRST PATIO COVER SUPPORT BEAM OR WALL
10	16	12	38'-10"
		16	29'-8"
		24	18'-3"
	24	12	25'-11"
		16	19'-3"
		24	12'-2"
20	16	12	22'-6"
		16	17'-3"
		24	10'-2"
	24	12	15'-0"
		16	11'-6"
		24	6'-8"

THIS DIMENSION SHOWN DOES NOT INCREASE THE ALLOWABLE SPAN OF ROOF AS SHOWN OF PATIO COVER PLAN

NOTE: THIS DETAIL IS INTEND FOR USE WITH PATIO COVERS/SUNROOMS THAT ARE USED PER 1994 UBC, APPX 31, DIV III

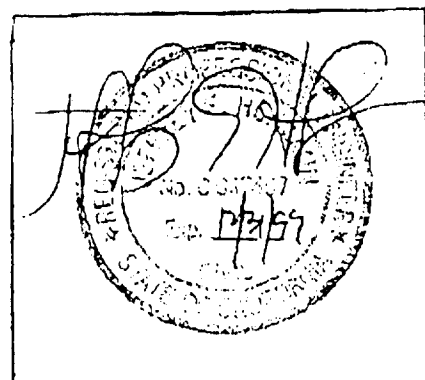

STANDARD DETAIL FOR SUPPORT OF PATIO COVER @ EXISTING 2x4 (MIN) #2DF EAVE

JOB #: 97-704 DATE: 8/20/97

PACIFIC CONSULTING ENGINEERS  
 2130 BELL AVE., SUITE 145  
 SACRAMENTO, CA 95833

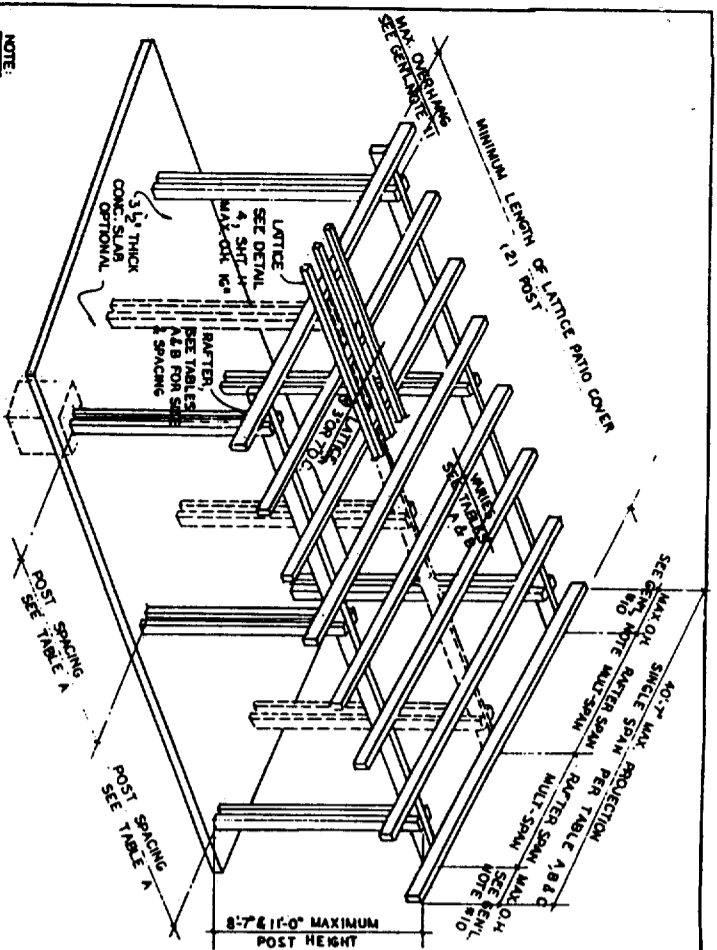

**OPEN LATTICE-TYPE PATIO COVER**

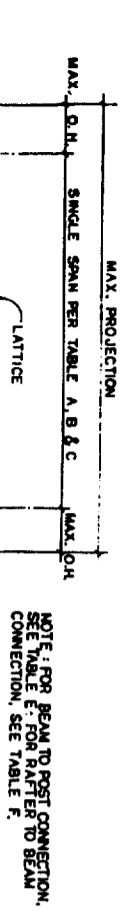

**CROSS SECTION, SINGLE SPAN**

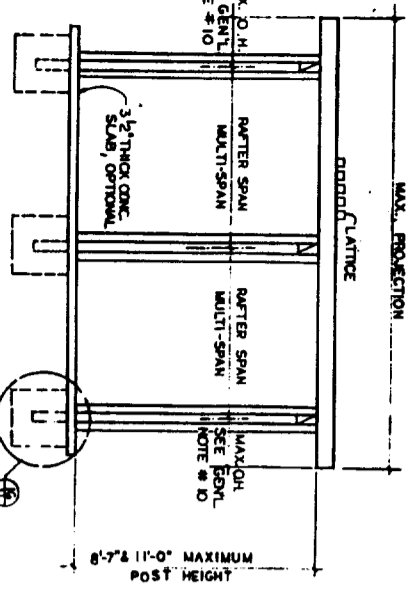

**CROSS SECTION, MULTI SPAN**

NOTE: FOR BEAM TO POST CONNECTION, SEE TABLE E. FOR RAFTER TO BEAM CONNECTION, SEE TABLE F.

**TABLE A**

FREESTANDING LATTICE PATIO COVER WITH OVERHANG (WIND SPEED = 70 & 90 MPH.)

MAXIMUM POST SPACING / BEAM AND FOOTING SIZE

TRIBUTARY WIDTH	FOOTING SIZE		MAXIMUM POST SPACING / BEAM	
	70 MPH	90 MPH	70 MPH	90 MPH
3" X 8" X .042" HEADER / BEAM	8'-7"	11'-0"	3" X 8" X .042" W/ INSERT	3" X 8" X .042" W/ INSERT
MAXIMUM POST HEIGHT = 8'-7"	MAXIMUM POST HEIGHT = 11'-0"	MAXIMUM POST HEIGHT = 8'-7"	MAXIMUM POST HEIGHT = 11'-0"	MAXIMUM POST HEIGHT = 11'-0"

**TABLE B**

MAXIMUM RAFTER SPAN & OVERHANG

RAFTER SIZE (AT 24" O.C.)	WIND SPEED		BEAM TO POST CONNECTION		RAFTER TO BEAM CONNECTION	
	70 MPH	90 MPH	WIND SPEED-70	WIND SPEED-90	WIND SPEED-70	WIND SPEED-90
2 X 6 1/2 X 0.24	12'-4"	4'-4"	12'-4"	4'-4"	12'-4"	4'-4"
2 X 6 1/2 X 0.32	16'-6"	5'-9"	16'-6"	5'-9"	16'-6"	5'-9"
2 X 6 1/2 X 0.40	20'-7"	7'-3"	20'-7"	7'-3"	20'-7"	7'-3"
3 X 8 X 0.42	23'-11"	8'-4"	23'-11"	8'-4"	23'-11"	8'-4"

**TABLE C**

FREESTANDING LATTICE PATIO COVER WITH OVERHANG (WIND SPEED-70 & 90 MPH) SINGLE SPAN

RAFTER SIZE (AT 24" O.C.)	PROJECTION (CLEAR)	FOOTING SIZE	
		70 MPH	90 MPH
L-20 PSF	31'-9"	17'-9"	7'-0"
3 X 8 X 0.42	31'-9"	17'-9"	7'-0"
3 X 8 X 0.42	26'-5"	14'-9"	5'-10"

**TABLE D**

FREESTANDING LATTICE PATIO COVER WITH OVERHANG (WIND SPEED-70 & 90 MPH) MULTI-SPAN

RAFTER SIZE (AT 24" O.C.)	PROJECTION (CLEAR)	FOOTING SIZE	
		70 MPH	90 MPH
L-20 PSF	31'-9"	17'-9"	7'-9"
3 X 8 X 0.42	31'-9"	17'-9"	7'-9"
3 X 8 X 0.42	26'-5"	14'-9"	5'-10"

**TABLE E**

RAFTER TO BEAM CONNECTION

RAFTER	TO BEAM	TO RAFTER	TO BEAM
2 X 6 1/2 X 0.24	2" X 6 1/2 SWS W/ 2" X 6 1/2 SWS EA. (4-TOTAL) EA. SIDE OF RAFTER W/ 2" X 6 1/2 SWS (4-TOTAL)	2" X 6 1/2 SWS W/ 2" X 6 1/2 SWS EA. (4-TOTAL) EA. SIDE OF RAFTER W/ 2" X 6 1/2 SWS (4-TOTAL)	2" X 6 1/2 SWS W/ 2" X 6 1/2 SWS EA. (4-TOTAL) EA. SIDE OF RAFTER W/ 2" X 6 1/2 SWS (4-TOTAL)
2 X 6 1/2 X 0.32	2" X 6 1/2 SWS W/ 2" X 6 1/2 SWS EA. (4-TOTAL) EA. SIDE OF RAFTER W/ 2" X 6 1/2 SWS (4-TOTAL)	2" X 6 1/2 SWS W/ 2" X 6 1/2 SWS EA. (4-TOTAL) EA. SIDE OF RAFTER W/ 2" X 6 1/2 SWS (4-TOTAL)	2" X 6 1/2 SWS W/ 2" X 6 1/2 SWS EA. (4-TOTAL) EA. SIDE OF RAFTER W/ 2" X 6 1/2 SWS (4-TOTAL)
2 X 6 1/2 X 0.40	2" X 6 1/2 SWS W/ 2" X 6 1/2 SWS EA. (4-TOTAL) EA. SIDE OF RAFTER W/ 2" X 6 1/2 SWS (4-TOTAL)	2" X 6 1/2 SWS W/ 2" X 6 1/2 SWS EA. (4-TOTAL) EA. SIDE OF RAFTER W/ 2" X 6 1/2 SWS (4-TOTAL)	2" X 6 1/2 SWS W/ 2" X 6 1/2 SWS EA. (4-TOTAL) EA. SIDE OF RAFTER W/ 2" X 6 1/2 SWS (4-TOTAL)
3 X 8 X 0.42	2" X 6 1/2 SWS W/ 2" X 6 1/2 SWS EA. (4-TOTAL) EA. SIDE OF RAFTER W/ 2" X 6 1/2 SWS (4-TOTAL)	2" X 6 1/2 SWS W/ 2" X 6 1/2 SWS EA. (4-TOTAL) EA. SIDE OF RAFTER W/ 2" X 6 1/2 SWS (4-TOTAL)	2" X 6 1/2 SWS W/ 2" X 6 1/2 SWS EA. (4-TOTAL) EA. SIDE OF RAFTER W/ 2" X 6 1/2 SWS (4-TOTAL)

**TABLE F**

RAFTER TO BEAM CONNECTION

RAFTER	TO BEAM	TO RAFTER	TO BEAM
2 X 6 1/2 X 0.24	2" X 6 1/2 SWS W/ 2" X 6 1/2 SWS EA. (4-TOTAL) EA. SIDE OF RAFTER W/ 2" X 6 1/2 SWS (4-TOTAL)	2" X 6 1/2 SWS W/ 2" X 6 1/2 SWS EA. (4-TOTAL) EA. SIDE OF RAFTER W/ 2" X 6 1/2 SWS (4-TOTAL)	2" X 6 1/2 SWS W/ 2" X 6 1/2 SWS EA. (4-TOTAL) EA. SIDE OF RAFTER W/ 2" X 6 1/2 SWS (4-TOTAL)
2 X 6 1/2 X 0.32	2" X 6 1/2 SWS W/ 2" X 6 1/2 SWS EA. (4-TOTAL) EA. SIDE OF RAFTER W/ 2" X 6 1/2 SWS (4-TOTAL)	2" X 6 1/2 SWS W/ 2" X 6 1/2 SWS EA. (4-TOTAL) EA. SIDE OF RAFTER W/ 2" X 6 1/2 SWS (4-TOTAL)	2" X 6 1/2 SWS W/ 2" X 6 1/2 SWS EA. (4-TOTAL) EA. SIDE OF RAFTER W/ 2" X 6 1/2 SWS (4-TOTAL)
2 X 6 1/2 X 0.40	2" X 6 1/2 SWS W/ 2" X 6 1/2 SWS EA. (4-TOTAL) EA. SIDE OF RAFTER W/ 2" X 6 1/2 SWS (4-TOTAL)	2" X 6 1/2 SWS W/ 2" X 6 1/2 SWS EA. (4-TOTAL) EA. SIDE OF RAFTER W/ 2" X 6 1/2 SWS (4-TOTAL)	2" X 6 1/2 SWS W/ 2" X 6 1/2 SWS EA. (4-TOTAL) EA. SIDE OF RAFTER W/ 2" X 6 1/2 SWS (4-TOTAL)
3 X 8 X 0.42	2" X 6 1/2 SWS W/ 2" X 6 1/2 SWS EA. (4-TOTAL) EA. SIDE OF RAFTER W/ 2" X 6 1/2 SWS (4-TOTAL)	2" X 6 1/2 SWS W/ 2" X 6 1/2 SWS EA. (4-TOTAL) EA. SIDE OF RAFTER W/ 2" X 6 1/2 SWS (4-TOTAL)	2" X 6 1/2 SWS W/ 2" X 6 1/2 SWS EA. (4-TOTAL) EA. SIDE OF RAFTER W/ 2" X 6 1/2 SWS (4-TOTAL)

**TABLE C**

FREESTANDING LATTICE PATIO COVER WITH OVERHANG (WIND SPEED-70 & 90 MPH) SINGLE SPAN

RAFTER SIZE (AT 24" O.C.)	PROJECTION (CLEAR)	FOOTING SIZE	
		70 MPH	90 MPH
L-20 PSF	31'-9"	17'-9"	7'-0"
3 X 8 X 0.42	31'-9"	17'-9"	7'-0"
3 X 8 X 0.42	26'-5"	14'-9"	5'-10"

**TABLE D**

FREESTANDING LATTICE PATIO COVER WITH OVERHANG (WIND SPEED-70 & 90 MPH) MULTI-SPAN

RAFTER SIZE (AT 24" O.C.)	PROJECTION (CLEAR)	FOOTING SIZE	
		70 MPH	90 MPH
L-20 PSF	31'-9"	17'-9"	7'-9"
3 X 8 X 0.42	31'-9"	17'-9"	7'-9"
3 X 8 X 0.42	26'-5"	14'-9"	5'-10"



- POST TYPES**
- 1 3" SQ. POST + (2) - 2" X 6 1/2" X .024" W/ (8) - #14 SWS.
  - 2 3" SQ. POST + (2) - 2" X 6 1/2" X .032" W/ (8) - #14 SWS.
  - 3 3" SQ. POST + (2) - 2" X 6 1/2" X .024" W/ (12) - #14 SWS.
  - 4 3" SQ. POST + (2) - 2" X 6 1/2" X .032" W/ (12) - #14 SWS.

- LINKS/NOTES:**
1. CONCRETE SLAB DECKS NOT EXIST AND NO SLAB WILL BE CONSTRUCTED AS PART OF THIS INSTALLATION.
  2. CONCRETE SLAB DECKS NOT EXIST AND NO SLAB WILL BE CONSTRUCTED AS PART OF THIS INSTALLATION.
  3. CONCRETE SLAB DECKS NOT EXIST AND NO SLAB WILL BE CONSTRUCTED AS PART OF THIS INSTALLATION.
  4. CONCRETE SLAB DECKS NOT EXIST AND NO SLAB WILL BE CONSTRUCTED AS PART OF THIS INSTALLATION.
  5. CONCRETE SLAB DECKS NOT EXIST AND NO SLAB WILL BE CONSTRUCTED AS PART OF THIS INSTALLATION.
  6. CONCRETE SLAB DECKS NOT EXIST AND NO SLAB WILL BE CONSTRUCTED AS PART OF THIS INSTALLATION.
  7. CONCRETE SLAB DECKS NOT EXIST AND NO SLAB WILL BE CONSTRUCTED AS PART OF THIS INSTALLATION.
  8. CONCRETE SLAB DECKS NOT EXIST AND NO SLAB WILL BE CONSTRUCTED AS PART OF THIS INSTALLATION.
  9. CONCRETE SLAB DECKS NOT EXIST AND NO SLAB WILL BE CONSTRUCTED AS PART OF THIS INSTALLATION.
  10. CONCRETE SLAB DECKS NOT EXIST AND NO SLAB WILL BE CONSTRUCTED AS PART OF THIS INSTALLATION.
  11. CONCRETE SLAB DECKS NOT EXIST AND NO SLAB WILL BE CONSTRUCTED AS PART OF THIS INSTALLATION.
  12. CONCRETE SLAB DECKS NOT EXIST AND NO SLAB WILL BE CONSTRUCTED AS PART OF THIS INSTALLATION.

ICBO E.S. EVALUATION REPORT NO. 50318

7-28-92

ALUMINA-LATTICE PATIO COVER

FOX ENGINEERING

JAMES M. FOX, STRUCTURAL ENGINEER

0000 TELEGRAPH RD. ROBERTY, CALIFORNIA 90000

ALUMINA-LATTICE PATIO COVER

VALLEY ALUMINUM COMPANY

802/278-0224

6/15