

CITY OF SACRAMENTO
1231 I Street, Sacramento, CA 95814

Permit No: 0105640
Insp Area: 4

Site Address: 3409 DELPHINIUM WY SAC
Parcel No: 274-0500-065 NATOMAS W 2 LOT 71

Sub-Type: N1/2PLEX
Housing (Y/N): N

CONTRACTOR
KAUFMAN & BROAD
151 NORTH SUNRISE AV #1012
ROSEVILLE CA 95661

OWNER

ARCHITECT

Nature of Work: NSFR HALF-PLEX, MP1114, 4 RMS

CONSTRUCTION LENDING AGENCY: I hereby affirm under penalty of perjury that there is a construction lending agency for the performance of the work for which this permit is issued (Sec. 3097, Civ. C.)

Lender's Name _____ Lender's Address _____

LICENSED CONTRACTORS DECLARATION: I hereby affirm under penalty of perjury that I am licensed under provisions of Chapter 9 commencing with section 7000) of Division 3 of the Business and Professions Code and my license is in full force and effect.

License Class B License Number 250003 Date 2/12/01 Contractor Signature [Signature]

OWNER-BUILDER DECLARATION: I hereby affirm under penalty of perjury that I am exempt from the contractors License Law for the following reason (Sec. 7031.5, Business and Professions Code; any city or county which requires a permit to construct, alter, improve, demolish, or repair any structure, prior to its issuance, also requires the applicant for such permit to file a signed statement that he or she is licensed pursuant to the provisions of the Contractors License Law (Chapter 9 (commencing with Section 7000) of Division 8 of the Business and Professions Code) or that he or she is exempt therefrom and the basis for the alleged exemption. Any violation of Section 7031.5 by any applicant for a permit subjects the applicant to a civil penalty of not more than five hundred dollars (\$500.00).

I, as a owner of the property, or my employees with wages as their sole compensation, will do the work, and the structure is not intended or offered for sale (Sec. 7044, Business and Professional Code). The Contractors License Law does not apply to an owner of property who builds or improves thereon, and who does such work himself or herself or through his/her own employees, provided that such improvements are not intended or offered for sale. If, however, the building or improvement is sold within one year of completion, the owner-builder will have the burden of proving that he/she did not build or improve for the purpose of sale.

I, as owner of the property, am exclusively contracting with licensed contractors to construct the project (Sec. 7044, Business and Professions Code). The Contractors License Law does not apply to an owner of property who builds or improves thereon, and who contracts for such projects with a contractor(s) licensed pursuant to the Contractors License Law.

I am exempt under Sec. _____ B & PC for this reason: _____

Date _____ Owner Signature _____

IN ISSUING THIS BUILDING PERMIT, the applicant represents, and the city relies on the representation of the applicant, that the applicant verified all measurements and locations shown on the application or accompanying drawings and that the improvement to be constructed does not violate any law or private agreement relating to permissible or prohibited locations for such improvements. This building permit does not authorize any illegal location of any improvement or the violation of any private agreement relating to location of improvements.

I certify that I have read this application and state that all information is correct. I agree to comply with all city and county ordinances and state laws relating to building construction and hereby authorize representative(s) of this city to enter upon the abovementioned property for inspection purposes.

Date 5/18/01 Applicant/Agent Signature [Signature]

WORKER'S COMPENSATION DECLARATION: I hereby affirm under penalty of perjury one of the following declarations:

I have and will maintain a certificate of consent to self-insure for workers' compensation as provided for by Section 3700 of the Labor Code, for the performance of work for which the permit is issued.

I have and will maintain workers' compensation insurance, as required by Section 3700 of the Labor Code, for the performance of the work for which this permit is issued. My workers' compensation insurance carrier and policy number are:

Carrier Benjamin Franklin Ins Policy Number WC1588099094 Exp Date 5/01/02

(This section need not be completed if the permit is for \$100 or less) I certify that in the performance of the work for which this permit is issued, I shall not employ any person in any manner so as to become subject to the workers' compensation laws of California and agree that if I should become subject to the workers' compensation provisions of Section 3700 of the Labor Code, I shall forthwith comply with those provisions.

Date 5/18/01 Applicant Signature [Signature]

WARNING: FAILURE TO SECURE WORKER'S COMPENSATION COVERAGE IS UNLAWFUL AND SHALL SUBJECT AN EMPLOYER TO CRIMINAL PENALTIES AND CIVIL FINES UP TO ONE HUNDRED THOUSAND DOLLARS (\$100,000) IN ADDITION TO THE COST OF COMPENSATION, DAMAGES AS PROVIDED FOR IN SECTION 3706 OF THE LABOR CODE, INTEREST AND ATTORNEY'S FEE.

THIS PERMIT SHALL EXPIRE BY LIMITATION IF WORK IS NOT COMMENCED WITHIN 180 DAYS.

RESIDENTIAL SUBDIVISION BUILDING PERMIT APPLICATION

Project Address: 3409 Delphinium Wwy Assessor Parcel # 274-0500-065
Lot Number: 71 Subdivision Natomas West Village 2

OWNER INFORMATION:

Legal Property Owner: KB Home Phone# (707) 469-2464
Owner Address: 2611 Orange Dr. City Vacaville State CA Zip 95687

CONTRACTOR INFORMATION:

Contractor: KB Home Lic. # 255425 Phone # 469-2464 Fax 469-2405

PROJECT INFORMATION:

Land Use Zone _____ Occupancy Group _____ Construction Type _____ Fed Code _____
No. of Stories: 1 No. of Rooms: _____ Street Width: _____
1st Floor Area 1114 2nd Floor Area _____ Basement _____ Roof Material _____
AREA IN SQUARE FOOT OF:
Dwelling/Living 1114
Garage/Storage 224
Decks/Balconies 30
Carports _____
SCOPE OF WORK: New Single Family Dwelling

FOR OFFICE USE ONLY

- Information Above Complete AR Flood Waiver Required Planning Approval
- Violation Files Checked Flood Elevation Certificate Required Design Review Approval
- Standard Setbacks Water Development Infill Area Special Fee Districts Apply:
- County Sewer

THE FOLLOWING MUST BE PROVIDED IN ORDER TO SUBMIT FOR PERMIT

- 2 COMPLETE PLOT PLANS, LEGIBLE & DRAWN TO SCALE
- 11 X 17 COPY OF FLOOR PLAN WITH FOLLOWING INFORMATION
 - a) Assessors Parcel Number c) Owners Name
 - b) New Floor Area d) Project Address

COUNTY SANITATION DISTRICT NO. 1
 SACRAMENTO REGIONAL COUNTY SANITATION DISTRICT
SEWER IMPACT FEE
 PERMIT AND CALCULATION SHEET C.44

APPLICATION NO:
 GENERAL INFORMATION

BLDG PERMIT NO:

THIS PERMIT GOOD ONLY WHEN
 VALIDATED BY THE CASHIER

SUD2001-00103

268817

27/288

THIS PERMIT TO CONNECT EXPIRES
 ONE YEAR FROM DATE OF ISSUANCE

3/16/01

FEE CALCULATION

BUILDING USE

INSPECTION	RESIDENTIAL	SF	MF	UNITS
CSD-1			<input checked="" type="checkbox"/>	
SRCSD				
CONSTRUCTION				
IN-LIEU				
TOTAL FEE				

APN: 2791-0500-0665

DESCRIPTION / SUBDIVISION: *Mafornas West Bl Hayes & Lot: 71B*

PROPERTY ADDRESS: *3409 Delphinium*

OWNER: *KB Home*

MAILING ADDRESS: *1011 Deane Dr*

CITY-STATE-ZIP: *Vallejo CA 95657* PHONE: *707-465-3467*

ADDITIONAL FEES MAY BE DUE IF CHANGES IN USE INCREASE SEWER IMPACT.

APPLICANT SIGNATURE: *[Signature]*

CONSOLIDATED UTILITY BILLING USE ONLY

ACCT _____ INPUT _____ START _____

Natomas Unified School District
 1515 Sports Drive, #1 • Sacramento, CA 95834-1905
 Phone 916/641-3300 • Fax 916/928-1629

CERTIFICATION OF COMPLIANCE
SCHOOL DISTRICT DEVELOPMENT FEES

PART I: TO BE COMPLETED BY APPLICANT			
Property Owner's Name	KB Home		
Owner's Address	611 Orange St. Vacaville Ca 95687 (707) 469-2464		
Project Address	3409 Delphinium Way		
Parcel Number	274-0500-065		
Subdivision Name	Natomas West Village 2		
Number of Units	1		
Print Applicant's Name	DR Permit Expediting	Applicant's Signature	
Title of Applicant	Permit Tech		
Date	A-26-01	Telephone Number	723-9948
PART II: TO BE COMPLETED BY BUILDING DEPARTMENT			
Plan Identification Number	Plan HP		
Building Type (Check One)	<input checked="" type="checkbox"/> Residential <input type="checkbox"/> Apartment/Condominium <input type="checkbox"/> Commercial/Industrial		
Square Feet of Chargeable Building Area	1114		
Signature	<i>[Signature]</i>		
Title	Blida Insp	Date 5/7/01	
PART III: TO BE COMPLETED BY NATOMAS UNIFIED SCHOOL DISTRICT			
District Certification Number	01 2001		
Fees Collected:			
Residential:	1114	Sq. Ft. X \$ 3.35	= \$ 3,731.70
Apartment/Condominium:		Sq. Ft. X \$	= \$
Commercial/Industrial:		Sq. Ft. X \$	= \$
<p>NOTICE TO APPLICANT: Pursuant to government code section 66020 (d), this will serve to notify you that the 90-day approval period in which you may protest the fees, or other payment identified above, will begin to run on the date in which the building or installation permit for this project is issued, or on which they are paid to the District, or to another public entity authorized to collect them on behalf of the District, whichever is earlier.</p>			
Applicant Signature:	<i>[Signature]</i>		Date: 4-17-01

This certification covers only the amount of square footage indicated above. Any additions or corrections to the square footage for this project will require an amendment to the Certificate of Compliance.

As the authorize Natomas Unified School District official, I hereby certify that the requirements of Government Code Section 95995 have been complied with by the above signed applicant.

SIGNATURE: Michael Morman DATE: 5/17/01
 TITLE: Michael Morman
Facilities Planning Director

CERTIFICATION OF INSULATION

PART I GENERAL

PART II AREAS INSULATED

PART III CERTIFICATION

ADDRESS OR TRACT <div style="font-size: 24px; font-family: cursive;">KB HOMES</div> <div style="float: right; margin-top: 10px;">LOT # 70/71</div> <div style="margin-top: 20px; font-size: 24px; font-family: cursive;">CALIFORNIA GARDENS</div>	SACRAMENTO INSULATION CONTRACTORS <input checked="" type="checkbox"/> P.O. BOX 854, WEST SACRAMENTO, CA 95691 LIC. #202026 <input type="checkbox"/> 1309 MELODY ROAD, MARYSVILLE, CA 95901 LIC. #202026 <input type="checkbox"/> P.O. BOX 9651, FRESNO, CA 93793-9651 LIC. #202026 <input type="checkbox"/> P.O. BOX 1631, RENO, NV 89505 LIC. #10675 <input type="checkbox"/> 3326 A PONDEROSA WAY, LAS VEGAS, NV 89118 LIC. #10675 DATE INSULATION COMPLETED
--	--

WALLS		CEILING			FLOORS	
(SQUARE FEET)		(SQUARE FEET)			(SQUARE FEET)	
TYPE OF INSULATION		TYPE OF INSULATION			TYPE OF INSULATION	
MATERIAL FIBERGLASS		MATERIAL FIBERGLASS			MATERIAL FIBERGLASS	
FORM BATTS		FORM BATTS & BLOW			FORM BATTS	
MANUFACTURER'S PRODUCT I D		MANUFACTURER'S PRODUCT I D			MANUFACTURER'S PRODUCT I D	
MANUFACTURER		MANUFACTURER			MANUFACTURER	
OCF		OCF			OCF	
		BAGS				
R - VALUE INSTALLED	APPLIED THICKNESS	R - VALUE INSTALLED	APPLIED THICKNESS	MIN. INSTALLED WEIGHT PER SQUARE FOOT	R - VALUE INSTALLED	APPLIED THICKNESS
13	3 5/8"	38 38	12 1/4" 14 3/4"			

KNEE WALLS IF R-VALUE IS OTHER THAN WALLS ABOVE

MATERIAL FIBERGLASS	FORM BATTS	R VALUE	MANUFACTURER OCF
----------------------------	-------------------	---------	-------------------------

AIR INFILTRATION SEALANT

MATERIAL FOAM	MANUFACTURER W R GRACE
----------------------	-------------------------------

THIS IS TO CERTIFY THAT INSULATION AND/OR SEALANT HAS BEEN INSTALLED IN CONFORMANCE WITH APPLICABLE CODES, MATERIAL STANDARDS AND REGULATIONS.

SIGNATURE - INSULATION CONTRACTOR <i>Jeff Cable</i>	TITLE MANAGER	DATE 1-8-02
SIGNATURE - GENERAL CONTRACTOR	TITLE	DATE

REMARKS

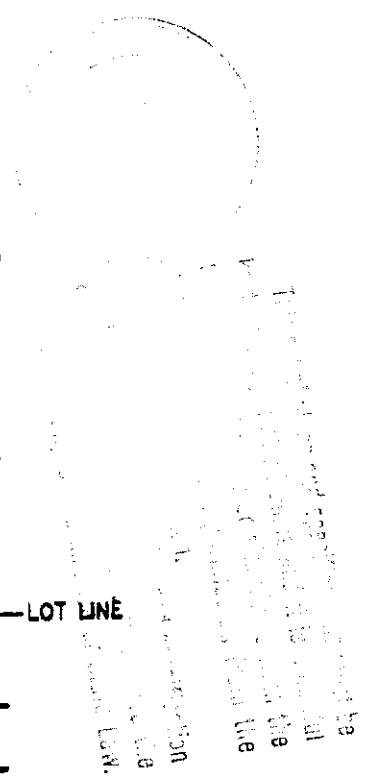
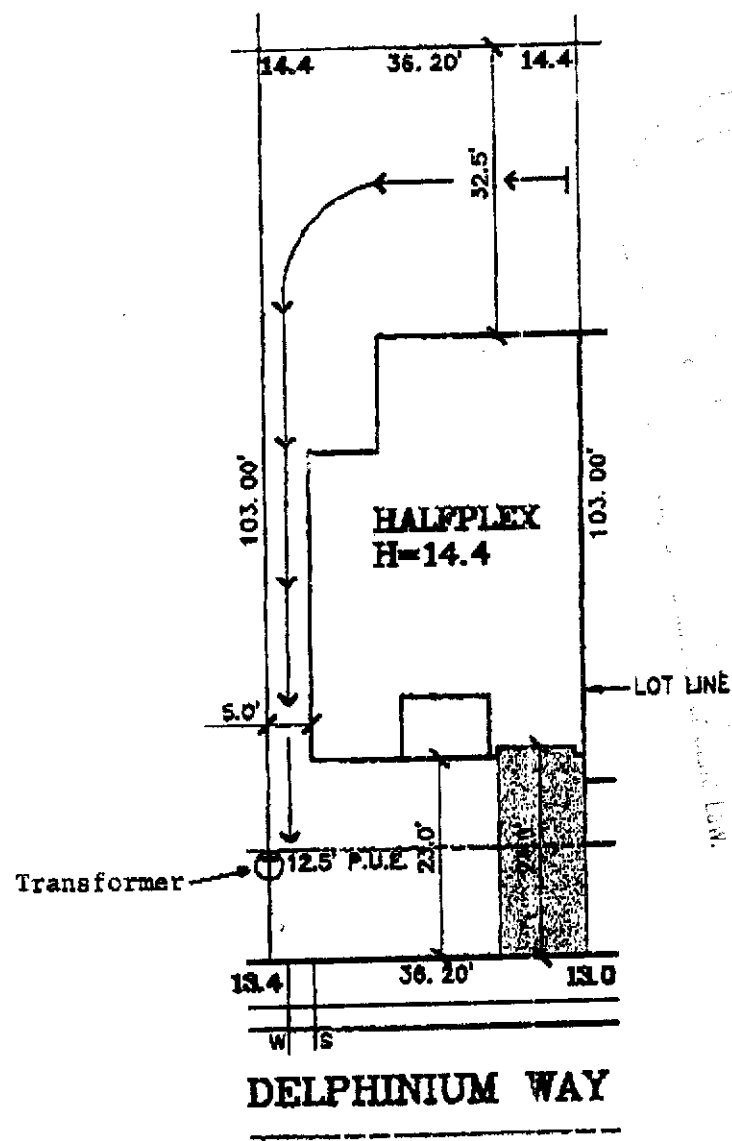

DATE: 3-29-01
 A.P.N.: 274-0500-065
 ADDRESS: 3400 DELPHINIUM WAY

LOT AREA: 3,729 SF
 LOT COVERAGE: 37%

The Spink Corporation
 2590 VENTURE OAKS WAY
 SACRAMENTO, CA. 95833
 PH (916)925-5550 FAX (916)921-9274

NATOMAS WEST VILLAGE 2
 LOT 71
 PLAN HP

CALIFORNIA GARDENS
 CITY OF SACRAMENTO, CA
 CLIENT: KAUFMAN & BROAD