



2.17

DEVELOPMENT SERVICES DEPT.
PLANNING DIVISION

CITY OF SACRAMENTO
CALIFORNIA

1231 I STREET
ROOM 300
SACRAMENTO, CA
95814-2998

PLANNING
916-808-5381
FAX 916-808-5328

May 13, 2005

City Council
Sacramento, California

Honorable Members in Session:

SUBJECT: Sheldon Whitehouse Rezone (P05-018)

LOCATION AND COUNCIL DISTRICT: Whitehouse Road, north of Sheldon Road. Council District 8

RECOMMENDATION:

This report recommends the item be passed for publication of title and continued to June 14, 2005.

CONTACT PERSON: Antonio Ablog, Assistant Planner 808-7702
Tom Pace, Senior Planner 808-6848

FOR COUNCIL MEETING OF: June 7, 2005

SUMMARY:

This item is presented at this time for approval of publication of title pursuant to City Charter, Section 32.

BACKGROUND INFORMATION:

Prior to publication of an item in a local paper to meet legal advertising requirements, the City Council must first pass the item for publication. The City Clerk then transmits the title of the item to the paper for publication and advertising the meeting date.

Respectfully submitted,



Gary Stonehouse
Planning Director

RECOMMENDATION APPROVED:



ROBERT P. THOMAS
City Manager

Table of Contents

1. Ordinance

Pages 3-5

ORDINANCE NO.

ADOPTED BY THE SACRAMENTO CITY COUNCIL

ON DATE OF _____

AN ORDINANCE AMENDING THE DISTRICTS ESTABLISHED BY THE COMPREHENSIVE ZONING ORDINANCE (TITLE 17 OF THE CITY CODE) BY REZONING 27.60± GROSS ACRES *FROM* THE STANDARD SINGLE-FAMILY (R-1) ZONE *TO* THE SINGLE-FAMILY ALTERNATIVE (R-1A) ZONE ON WHITEHOUSE ROAD NORTH OF SHELDON ROAD.

(APN: 117-0212-014, -015, -022, -023, -025, and -024)
(P05-018)

BE IT ENACTED BY THE COUNCIL OF THE CITY OF SACRAMENTO:

SECTION 1

The Property generally described and referred to as APN: 117-0212-014, -015, -022, -023, -025, and -024 is shown on the attached Exhibit 1. This exhibit describes the property and both its current zoning and the zones for which it is to be placed pursuant to this amendment.

The zoning designation for the following property, which constitutes 27.60± gross acres of Standard Single-Family (R-1) zoned land, is hereby removed and placed into 27.60± gross acres zoned Single-Family Alternative (R-1A).

APN: 117-0212-014, -015, -022, -023, -025, and -024

SECTION 2

The City Clerk of the City of Sacramento is hereby directed to amend the official zoning maps which are a part of said Ordinance to conform to the provisions of this Ordinance.

FOR CITY CLERK USE ONLY

ORDINANCE NO.: _____

DATE ADOPTED: _____

PASSED FOR PUBLICATION:

PASSED:

EFFECTIVE:

MAYOR

ATTEST:

CITY CLERK

P05-018

Attachments:

Rezone Exhibit

FOR CITY CLERK USE ONLY

ORDINANCE NO.: _____

DATE ADOPTED: _____

Rezone Exhibit

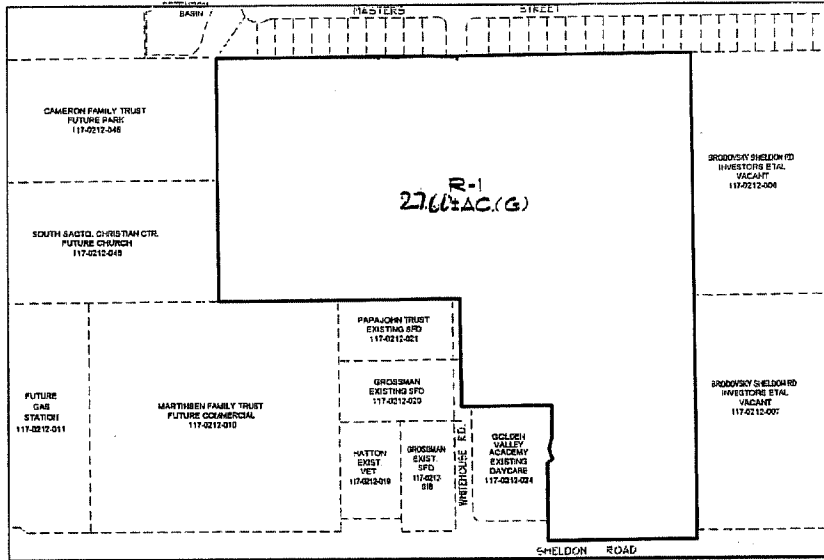

Existing Zoning

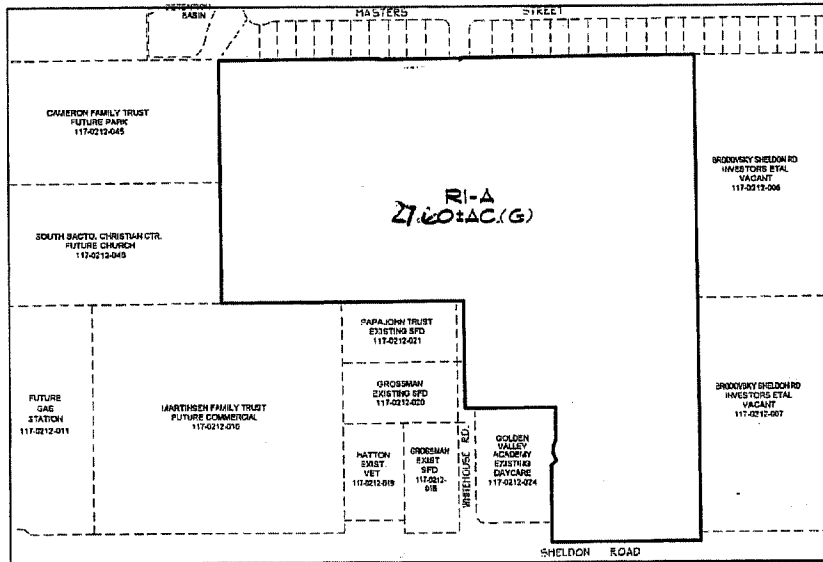

Proposed Zoning

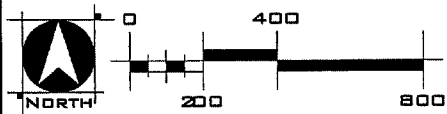

WOOD RODGERS
 ENGINEERING • PLANNING • MAPPING • SURVEYING
 3301 D STREET, 8LDB, 100-B, SACRAMENTO, CA 95816
 PHONE: (916) 341-7760 FAX: (916) 341-7767

5

FOR CITY CLERK USE ONLY

ORDINANCE NO.: _____

DATE ADOPTED: _____