

CITY OF SACRAMENTO

Permit No: 0319390

1231 I Street, Sacramento, CA 95814

Insp Area: 1
Thos Bros: 297 C3

Site Address: 420 I ST SAC

Sub-Type: NFNDTN

Parcel No: 006-0024-040

SENIOR HOUSING CENTER

Housing (Y/N): N

CONTRACTOR

WALSH AND FORSTER
1300 S ST
SACRAMENTO CA 95614

OWNER

HOUSING AUTHORITY/CITY OF SACRAMENTO
SACRAMENTO CA
95812-1834

ARCHITECT

Nature of Work: Retrofit Foundation only permit for remodeled bldg. No underground plumbing or electrical is required.

CONSTRUCTION LENDING AGENCY: I hereby affirm under penalty of perjury that there is a construction lending agency for the performance of the work for which this permit is issued (Sec. 3097, Civ. C).

Lender's Name _____ Lender's Address _____

LICENSED CONTRACTORS DECLARATION: I hereby affirm under penalty of perjury that I am licensed under provisions of Chapter 9 (commencing with section 7000) of Division 3 of the Business and Professions Code and my license is in full force and effect.

License Class _____ License Number 509780 Date 12/25/03 Contractor Signature *[Signature]*

OWNER-BUILDER DECLARATION: I hereby affirm under penalty of perjury that I am exempt from the contractors License Law for the following reason (Sec. 7031.5, Business and Professions Code; any city or county which requires a permit to construct, alter, improve, demolish, or repair any structure, prior to its issuance, also requires the applicant for such permit to file a signed statement that he or she is licensed pursuant to the provisions of the Contractors License Law (Chapter 9 (commencing with Section 7000) of Division 8 of the Business and Professions Code) or that he or she is exempt therefrom and the basis for the alleged exemption. Any violation of Section 7031.5 by any applicant for a permit subjects the applicant to a civil penalty of not more than five hundred dollars (\$500.00);

I, as a owner of the property, or my employees with wages as their sole compensation, will do the work, and the structure is not intended or offered for sale (Sec. 7044, Business and Professional Code: The Contractors License Law does not apply to an owner of property who builds or improves thereon, and who does such work himself or herself or through his/her own employees, provided that such improvements are not intended or offered for sale. If, however, the building or improvement is sold within one year of completion, the owner-builder will have the burden of proving that he/she did not build or improve for the purpose of sale.)

I, as owner of the property, am exclusively contracting with licensed contractors to construct the project (Sec. 7044, Business and Professions Code: The Contractors License Law does not apply to an owner of property who builds or improves thereon, and who contracts for such projects with a contractor(s) licensed pursuant to the Contractors License Law).

I am exempt under Sec. _____ B & PC for this reason: _____

Date _____ Owner Signature _____

IN ISSUING THIS BUILDING PERMIT, the applicant represents, and the city relies on the representation of the applicant, that the applicant verified all measurements and locations shown on the application or accompanying drawings and that the improvement to be constructed does not violate any law or private agreement relating to permissible or prohibited locations for such improvements. This building permit does not authorize any illegal location of any improvement or the violation of any private agreement relating to location of improvements.

I certify that I have read this application and state that all information is correct. I agree to comply with all city and county ordinances and state laws relating to building construction and herby authorize representative(s) of this city to enter upon the abovementioned property for inspection purposes.

Date 12/25/03 Applicant/Agent Signature *[Signature]*

WORKER'S COMPENSATION DECLARATION: I hereby affirm under penalty of perjury one of the following declarations:

I have and will maintain a certificate of consent to self-insure for workers' compensation as provided for by Section 3700 of the Labor Code, for the performance of work for which the permit is issued.

I have and will maintain workers' compensation insurance, as required by Section 3700 of the Labor Code, for the performance of the work for which this permit is issued. My workers' compensation insurance carrier and policy number are:

Carrier STATE FUND Policy Number 162416-1834 Exp Date 03/01/2004

(This section need not be completed if the permit is for \$100 or less) I certify that in the performance of the work for which this permit is issued, I shall not employ any person in any manner so as to become subject to the workers' compensation laws of California and agree that if I should become subject to the workers' compensation provisions of Section 3700 of the Labor Code, I shall forthwith comply with those provisions.

Date 12/25/03 Applicant Signature *[Signature]*

WARNING: FAILURE TO SECURE WORKER'S COMPENSATION COVERAGE IS UNLAWFUL AND SHALL SUBJECT AN EMPLOYER TO CRIMINAL PENALTIES AND CIVIL FINES UP TO ONE HUNDRED THOUSAND DOLLARS (\$100,000) IN ADDITION TO THE COST OF COMPENSATION, DAMAGES AS PROVIDED FOR IN SECTION 3706 OF THE LABOR CODE, INTEREST AND ATTORNEY'S FEE.

THIS PERMIT SHALL EXPIRE BY LIMITATION IF WORK IS NOT COMMENCED WITHIN 180 DAYS.



**WALLACE • KUHL
& ASSOCIATES INC.**

September 24, 2004

Geotechnical Engineering

Engineering Geology

Environmental Consulting

Remediation Services

Construction Inspection

Materials Testing

Ruthy Talansky
A. F. Evans Development
100 Bush Street, Suite 925
San Francisco, CA 94101-3931

Special Inspection Final Report
PING YUEN CENTER
Permit Nos. 03-11307 and 03-19390
WKA Job No. 5548.03

In accordance with City of Sacramento special inspection requirements, our firm has performed *Special Inspection and Testing* in accordance with Sections 106 and 1701 of the Uniform Building Code for the subject project. Our observation and test results indicate that the following items were constructed, to the best of our knowledge, in accordance with the project's plans and specifications:

Earthwork/

Foundations: Sampled and tested backfill soils of basement walls. Inspected installation, sampled and tested grout, and observed load testing of micro-pile foundations.

Concrete: Inspected placement of reinforcing steel and concrete for elevator pit footings, walls and slab-on-grade, grade beams, topping slabs at 1st through 4th floors. Obtained concrete samples for laboratory compressive strength testing and performed slump tests.

Epoxy

Anchors: Verified correct installation of epoxied rebar dowels and allthread anchors per manufacturer's instructions and the project plans.

**Structural
Steel:**

Performed shop welding inspection of wide flange and tube steel beams, tube steel columns, stairs, rails, gates and canopies at Armour Steel, Rio Linda, California. Monitored contractor compliance with Welding Procedure Specifications (WPS). Identified material with manufacturer's mill certificates. Checked welder certification records.

CORPORATE OFFICE

3050 Industrial Boulevard
West Sacramento
CA 95691
Tel 916.372.1434
Fax 916.372.2565

ROCKLIN OFFICE

500 Menlo Drive
Suite 100
Rocklin, CA 95765
Tel 916.435.9722
Fax 916.435.9822

STOCKTON OFFICE

3410 West Hammer Lane
Suite F
Stockton, CA 95219
Tel 209.234.7722
Fax 209.234.7727

PING YUEN CENTER

Permit Nos. 03-11307 and 03-19390

WKA Job No. 5548.03

September 24, 2004

Page 2

Structural

Steel: Performed field welding inspection of structural steel framing, canopy structure, connection plates, channel splices, weld washers, drag tie connections, tower framing, gates and edge form. Verified correct installation and tension of high strength A325 bolts for structural steel framing connections. Monitored contractor compliance with Welding Procedure Specifications (WPS). Checked welder certification records.

Fireproofing: Monitored application of monokote fireproofing at structural steel framing throughout 1st through 3rd floors. Randomly checked thickness and obtained samples for density testing. Performed adhesion tests.

Last date at jobsite: September 22, 2004

Wallace - Kuhl & Associates, Inc.



David A. Redford, P.E.
Senior Engineer

DAR:mlo

cc: YHLA Architects
Miyamoto International
Walsh & Forster, Inc.
City of Sacramento

24 31 10 000000
22000 100 000000
22 000 100 000000

10/10/10

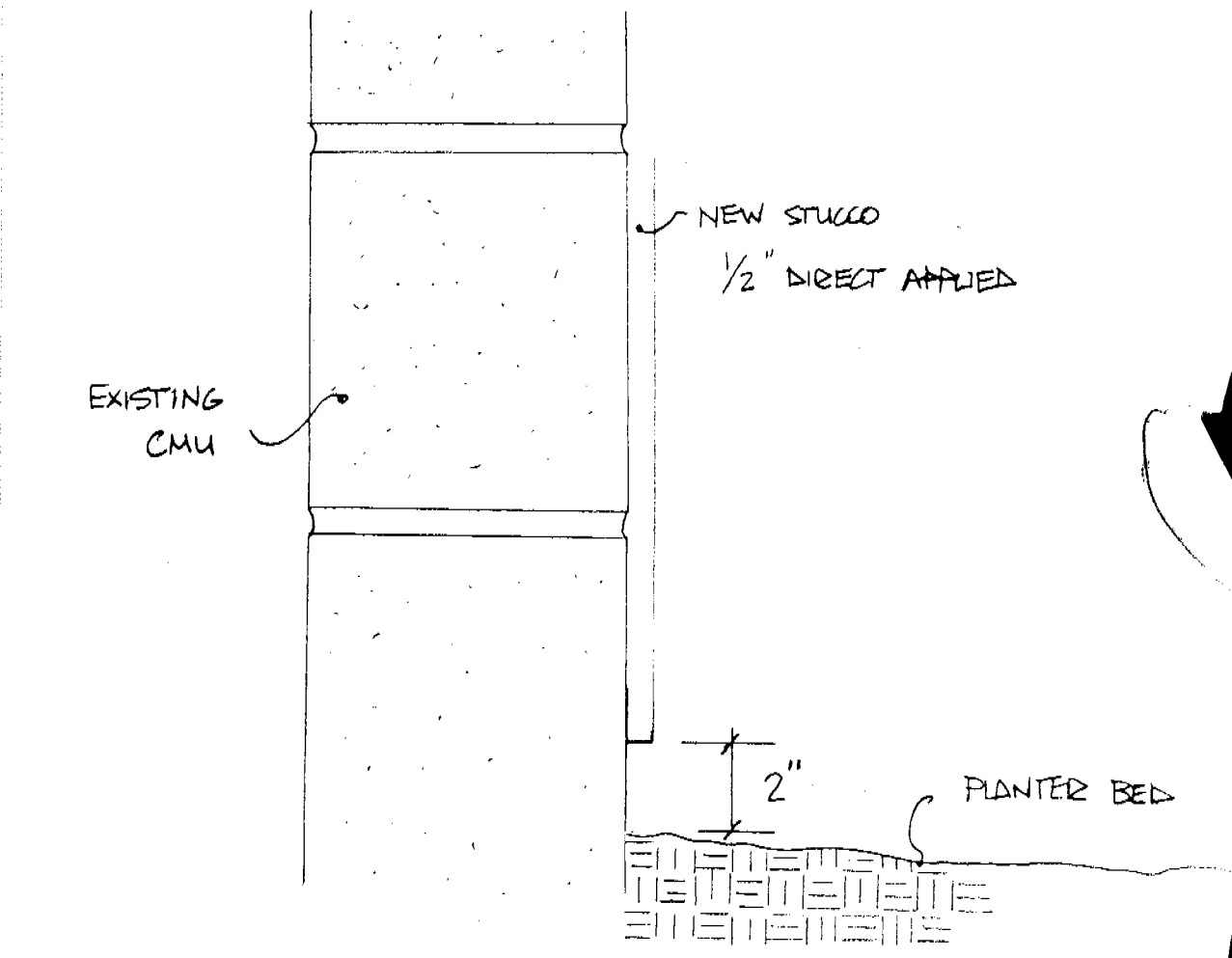
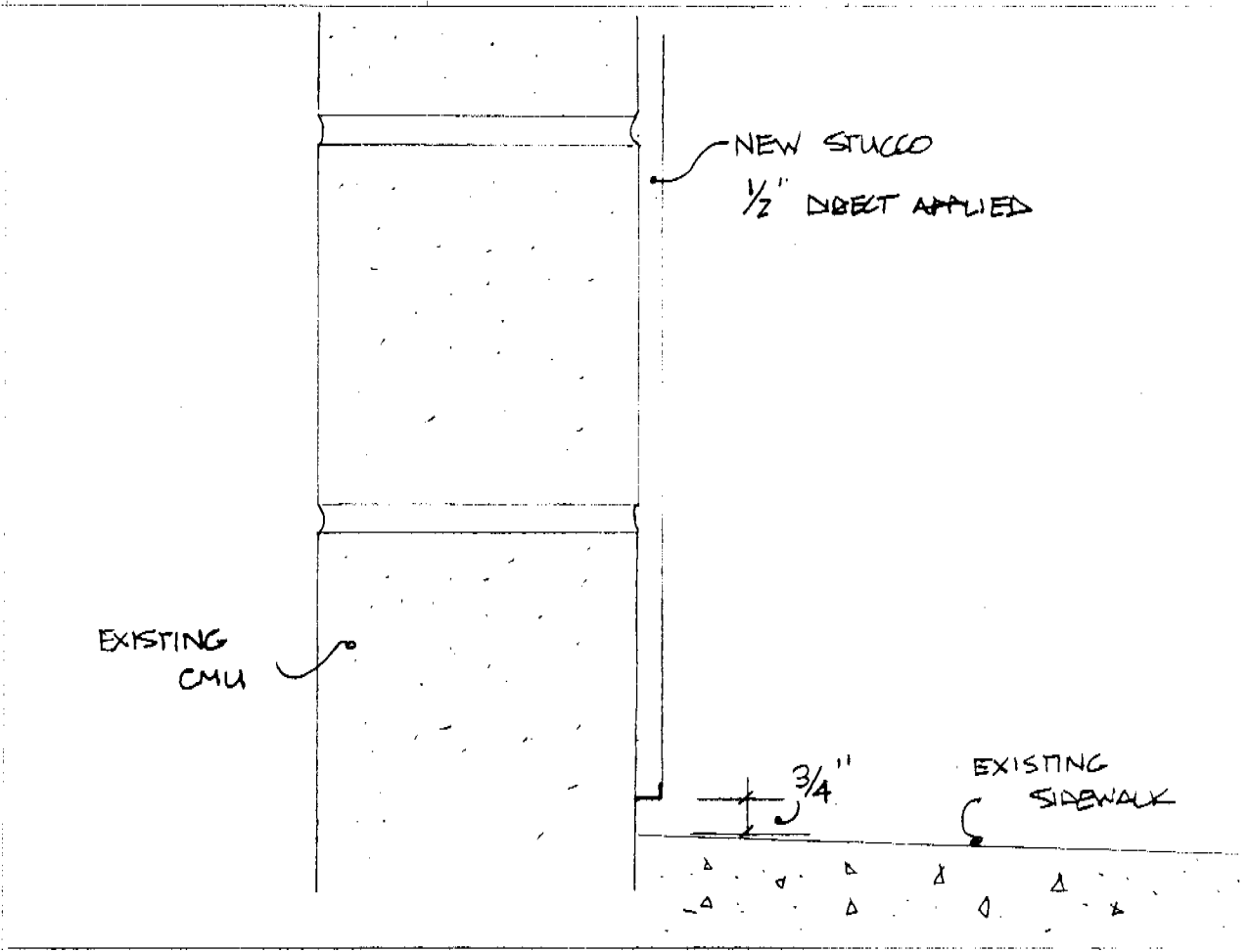

APPLICATION FOR COMMERCIAL BUILDING PERMIT

CITY OF SACRAMENTO
PLANNING & BUILDING DEPARTMENT
 1231 I Street, Suite 200 or 2101 Arena Bl., 200
 Sacramento, CA 95814 Sacramento, CA 95834
 (916) 264-5656, 1-866 EZ PERMIT or www.cityofsacramento.org

ACTIVITY # 0319390	Insp. Area
------------------------------	-------------------

Applicant to complete all areas down to valuation

ADDRESS 420 I St Sacramento CA Suite _____
PARCEL # _____

CHLA CONTACT		LICENSED CONTRACTOR Lic No. # _____	
Name <u>Bob Lindley (Architect)</u>	Street Address <u>2727 Del Rio Plc, Ste D</u>	Name <u>Walsh E Forester - Carl Andrey</u>	Address <u>1300 S St</u>
City/State/Zip <u>Davis CA</u>	Phone _____ FAX _____	City/State/Zip <u>Sacramento CA 95612</u>	Phone <u>447-5550</u> FAX <u>447-2434</u>
E-mail: _____		E-mail: _____	
MSM ARCHITECT (ENGINEER) Structure		OWNER	
Name <u>Lon Determan</u>	Address <u>1450 Halyard Dr, Ste 1</u>	Name _____	Address _____
City/State/Zip <u>W Sacramento CA 95621</u>	Phone <u>373-1995</u> FAX <u>373-1466</u>	City/State/Zip _____	Phone _____ FAX _____
E-mail: _____		E-mail: _____	

→ Will permittee have any employees on the jobsite? No Yes → **INSURANCE CO:** _____
 → **WORKER'S COMPENSATION POLICY #** _____ **EXPIRATION DATE:** _____

NATURE OF WORK IN DETAIL: Foundation only

OCCUPANT/TENANT: _____ **VALUATION: \$** _____

FLOOD STATUS						S.C.A.T.				
JOB DESCRIPTION		BLDG <input type="checkbox"/>	SHELL <input type="checkbox"/>	APT <input type="checkbox"/>	TI () <input type="checkbox"/>	REM () <input type="checkbox"/>	SW <input type="checkbox"/>	FIRE <input type="checkbox"/>	ADD <input type="checkbox"/>	OTHER <input type="checkbox"/>
INSPECTION DISCIPLINES			BLDG	MECH	PLUMB	ELEC	SITE	FIRE		
# Stories	1 st flr Area	Total Area	Use Zone	Occp Group	Const type	Fire Req. Y/N		Fed Code	Vio. File	
						SPR	ALARM			
(B)	(L)	(P)	(M)	(E)	(F)	(S)		D	(PW)	(UTIP)

COMMENTS:

REGIONAL SANITATION FEES? Yes No HEALTH DEPARTMENT? Yes No
 WATER FLOW TEST FOR NEW BUILDINGS OR ADDITIONS? Yes No