



DEPARTMENT OF
PUBLIC WORKS

TRANSPORTATION DIVISION

CITY OF SACRAMENTO
CALIFORNIA

1025 J STREET
SUITE 200
SACRAMENTO, CA
95814-2819

916-449-5307
FAX 916-448-8450

January 3, 1991

Transportation and Community Development Committee
Sacramento, California

Honorable Members In Session:

SUBJECT: REPEALING THROUGH STREET RESOLUTION 88-325 AND APPROVING AN
UPDATED THROUGH STREET RESOLUTION

SUMMARY

This report recommends that the Transportation and Community Development Committee approve this report and refer it to the full City Council for adoption of the attached resolution which designates several roadways as through streets.

BACKGROUND INFORMATION

For improved traffic safety, whenever the speed limit on a street is 30 MPH or greater, the intersecting side streets are posted with stop signs making the street a through street. Through streets are important to the City transportation system because they provide improved circulation for greater volumes of traffic. Through streets are generally wider than residential streets and therefore have the capacity for these greater volumes. All of the street segments recommended in this report now carry, or will carry, a significant amount of traffic due to the residential and commercial development taking place along these segments and in the surrounding areas.

Recommended for inclusion on the through street resolution are the following streets:

1. CENTER PARKWAY is a south area street that has been extended south approximately 6000 feet to Bruceville Road. The extension creates a through street segment which extends from the North City Limits to Bruceville Road.

2. CALVINE ROAD is a south area street that has been extended a few hundred feet west of Suntrail Circle and now intersects Carlin Avenue. The extension creates a through street which extends from Bruceville Road to Carlin Road.
3. BRUCEVILLE ROAD, again in the south area, is a roadway which has been extended south from Timberlake Way to Cosumnes River Boulevard. It will be a major collector street. The extension creates a through street that extends from Valley Hi Drive to Calvine Road.
4. JACINTO ROAD is a new south area street which is to be a major collector for the City's southern most developments. The road origin is at the County maintained portion of Jacinto Road (east of Bruceville Road) and extends west to Calvine Road.
5. CALVINE ROAD is a new roadway which extends from Jacinto Road to Franklin Boulevard.

Exhibit A through E shows the locations of the recommended through streets.

The resolution recommended by this report includes streets that the City Council will consider under the speed limit resolution, which is being presented concurrently, in a separate item.

FINANCIAL DATA

No City funds are requested.

Funding for installation of necessary stop signs has been included in the operating budget of the Traffic Signs and Markings organization of the Transportation Division.

MBE/WBE

There is no MBE/WBE impact related to this matter.

POLICY CONSIDERATIONS

This recommended through street resolution has been revised in accordance with Section 25.40 of the Sacramento City Code, which authorizes the City Council to designate through streets.

RECOMMENDATIONS

It is recommended that the Transportation and Community Development Committee approve this report and refer it to the full City Council for adoption of the attached resolution which adopts Center Parkway, G Parkway, Calvine Road, Calvine Road, Bruceville Road and Jacinto Road as through streets, in accordance with Sacramento City Code Section 25.40.

Respectfully submitted,

ROBERT L. LEE
Deputy Director of Public Works

Recommendation Approved:

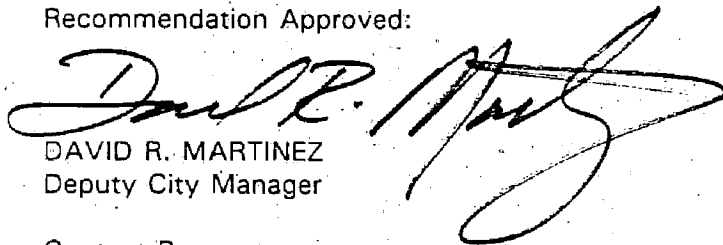
DAVID R. MARTINEZ
Deputy City Manager

Approved:

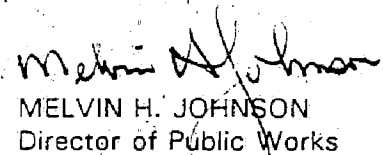
MELVIN H. JOHNSON
Director of Public Works

Contact Person to
Answer Questions:

EDWARD WILLIAMS, Transportation Division
449-3507

January 3, 1991
District No. 7

EW:lm
CA4-03.L
12.21.90

Attachments

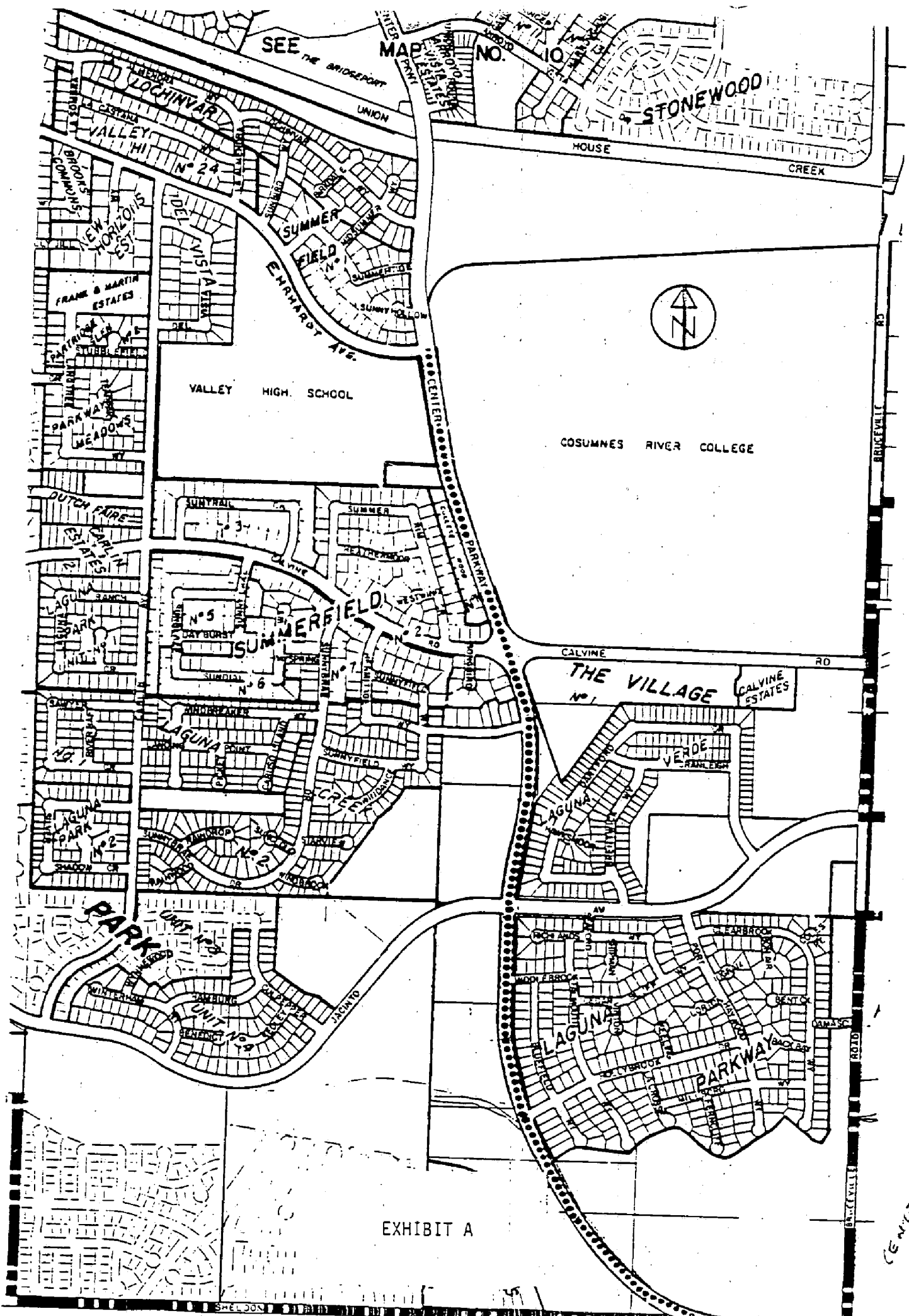

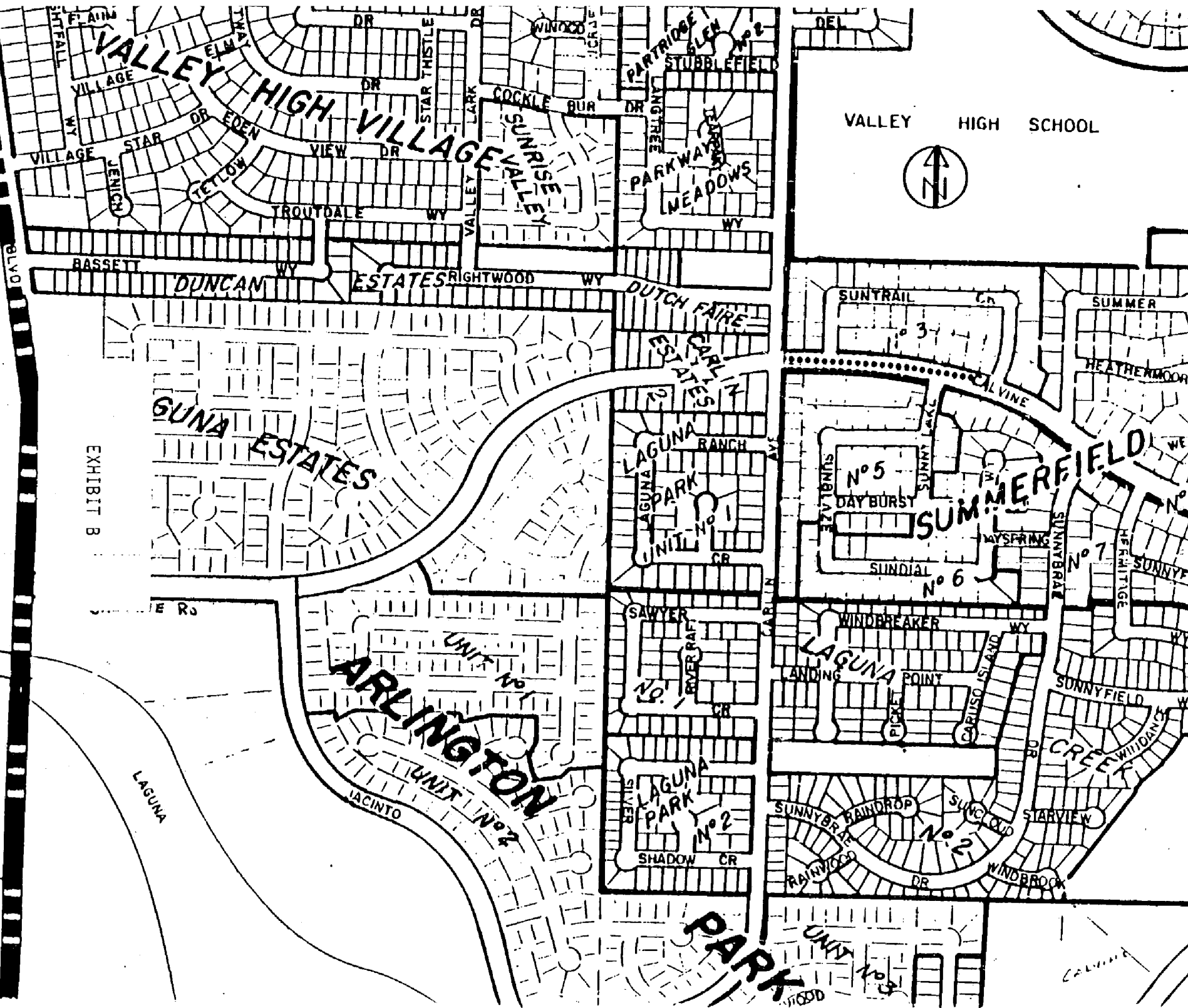
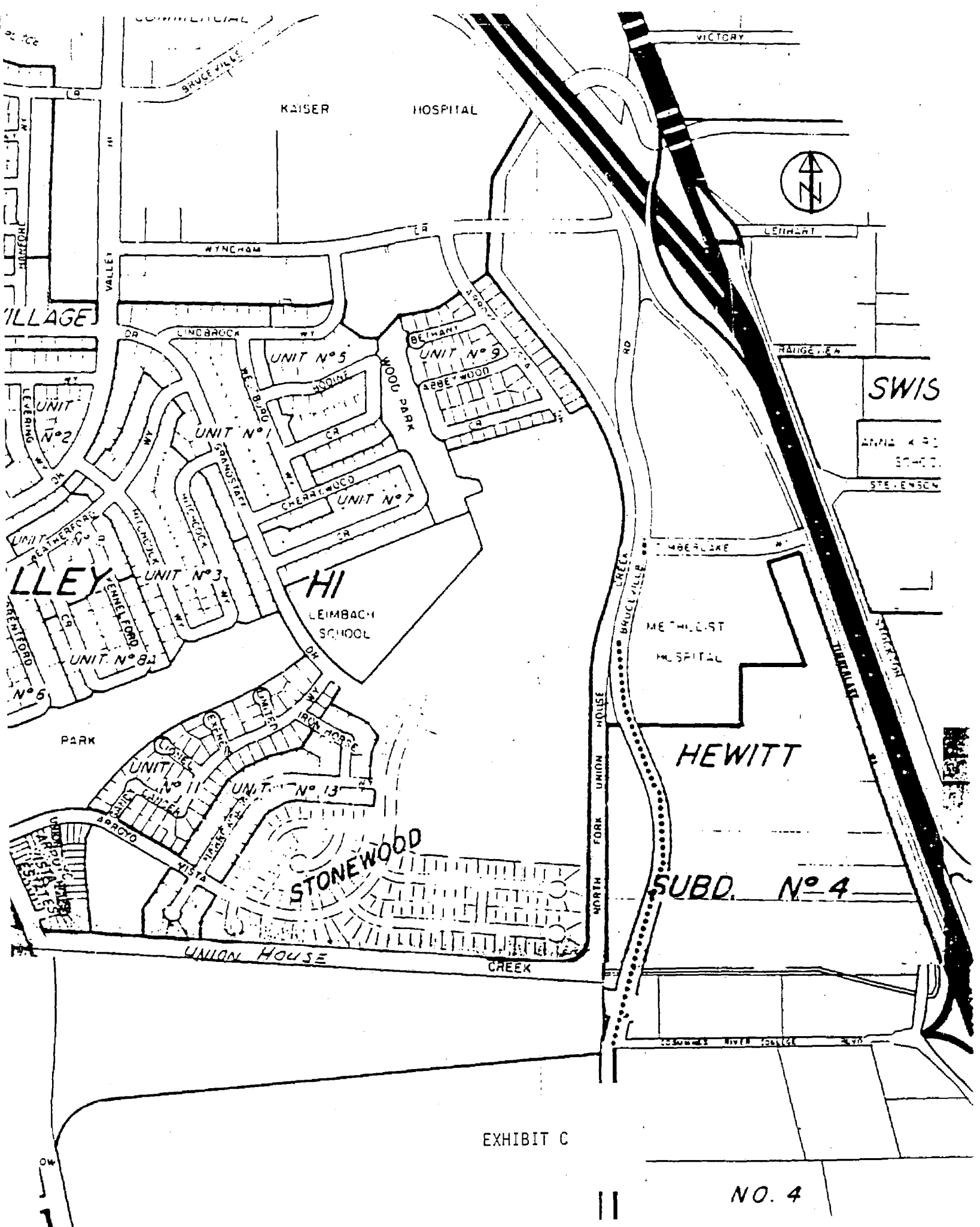

EXHIBIT B



KAISER HOSPITAL



SWIS

ANNE K. P.
SCHOOL
STE. ENSEN

HEWITT

SUBD. N° 4

STONEWOOD

EXHIBIT C

NO. 4

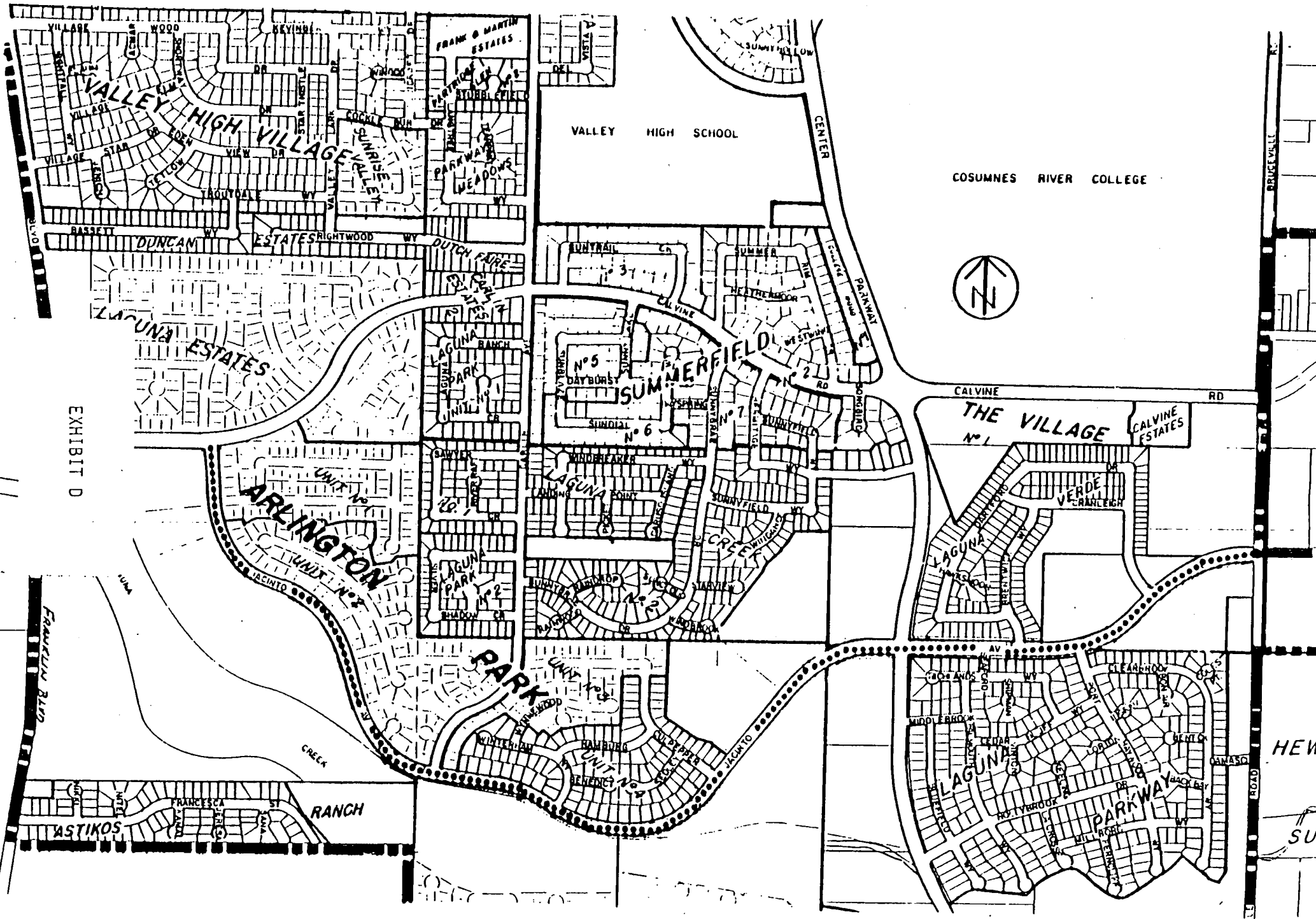
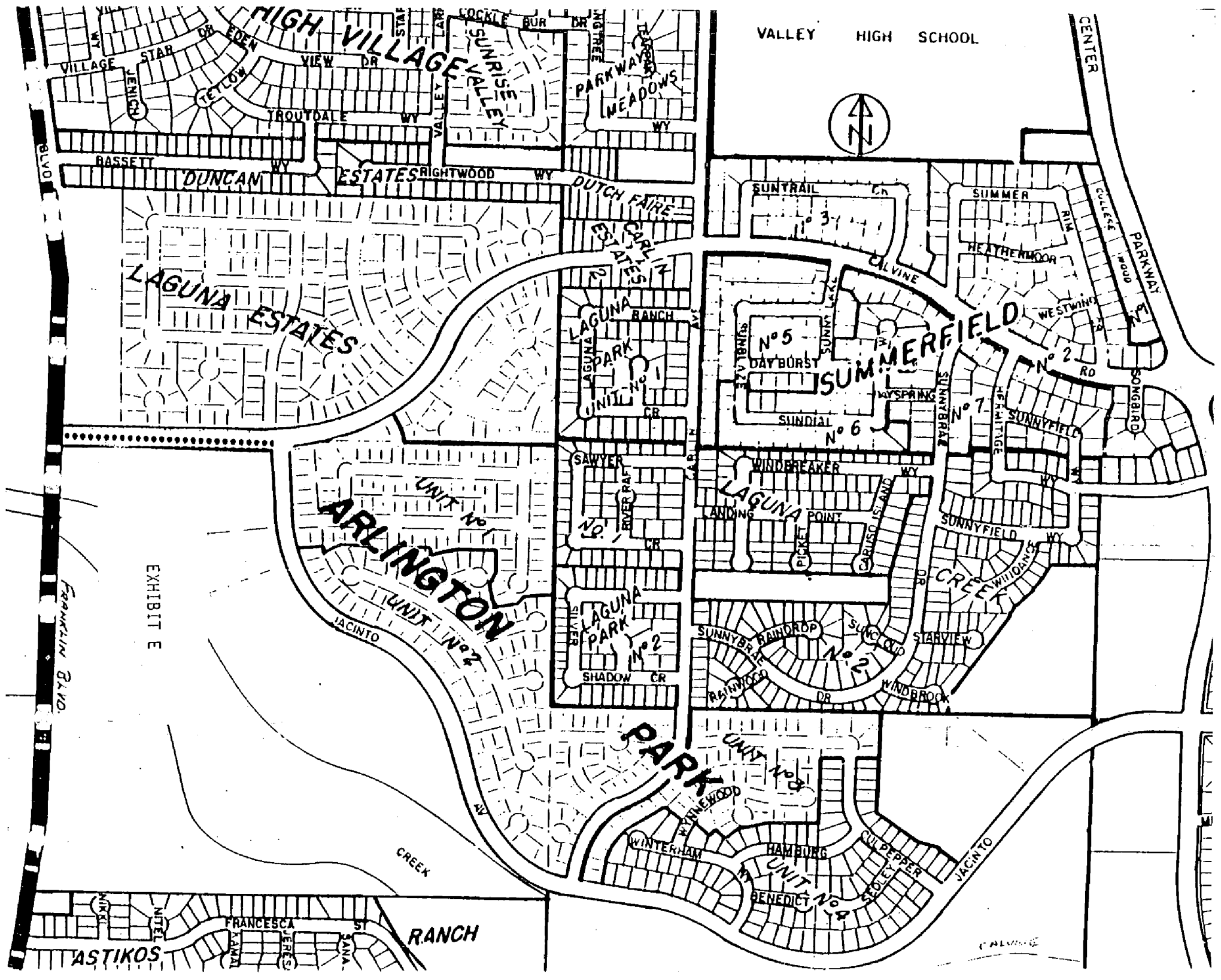

EXHIBIT D





RESOLUTION NO.

ADOPTED BY THE SACRAMENTO CITY COUNCIL

ON DATE OF _____

RESOLUTION REPEALING THROUGH STREET
RESOLUTION 88-325 AND APPROVING AN
UPDATED THROUGH STREET RESOLUTION

BE IT RESOLVED BY THE COUNCIL OF THE CITY OF SACRAMENTO:

SECTION 1.

Pursuant to Section 25.40 of the Sacramento City Code, the following streets are hereby designated as through streets:

Albatross Way	Marconi to Glenrose Avenue
Alhambra Boulevard	C Street to 2nd Avenue
Altos Avenue	El Camino to Eleanor Avenue
American Avenue	Bowman Avenue to Columbus Avenue
American River Drive	Howe Avenue to City Limits
Amherst Street	Florin Road to Meadowview Road
Arcade Boulevard	Rio Linda Blvd to Del Paso Blvd
Arden Way	Del Paso Boulevard to Ethan Way
Ascot Avenue	Dry Creek Road to 20th Street
Astoria Street	Grand Avenue to Del Paso Boulevard
Auburn Boulevard	Harvard Street to Connie Drive
Azevedo Drive	West El Camino Ave to San Juan Road
Bannon Street	Bercut Drive to North B Street
Belden Street	Arcade Blvd to Las Palmas Avenue
Bell Avenue	Bollenbacher Ave to Winters Street
Belvedere Avenue	Power Inn Rd to Florin Perkins Road
Bercut Drive	Bannon Street to Richards Boulevard
Blair Avenue	43rd Avenue to Freeport Boulevard
Blumenfeld Drive	Arden Way to Fee Drive
Branch Street	Acacia Avenue to Eleanor Avenue
Brookfield Drive	Meadowview Road to Tangerine Avenue
Broadway	Front Street to 65th Street
<u>Bruceville Road</u>	<u>Valley Hi Drive to Calvine Road</u>
C Street	Alhambra Boulevard to Elvas Avenue

NOTE: Changes to previous Resolution are shown underlined

FOR CITY CLERK USE ONLY

RESOLUTION NO.: _____

DATE ADOPTED: _____

C Street
C Street
Calvados Avenue
Calvine Road
Calvine Road
Capitol Avenue
Capitol Mall
Carlson Drive
Center Parkway
Challenge Way
Chestnut Hill Drive
Clay Street
College Town Drive
Connie Drive
D Street
Del Paso Boulevard
Del Rio Road
Detroit Boulevard
Dixianne Avenue
Dry Creek Road
E Street
Edison Avenue
Ehrhardt Avenue
El Camino Avenue
El Centro Road
Elder Creek Road
Eleanor Avenue
East Levee Road
El Monte Avenue
El Parasio
Elvas Avenue
Ethan Way
Evergreen Street
Exposition Boulevard
F Street
Fair Oaks Boulevard
Fee Drive
Florin Road
Florin Perkins Road
Folsom Boulevard
Franklin Boulevard
Front Street
Freeport Boulevard
Fruitridge Road
G Street
G Parkway
Garden Highway
Gateway Oaks Drive

16th Street to 29th Street
51st Street to Elvas Avenue
Oxford to Evergreen Street
Bruceville Rd to Carlin Road
Jacinto Road to Franklin Boulevard
15th Street to Alhambra Boulevard
Front Street to 9th Street
J Street to Sandburg Drive
North City Limits to Bruceville Road
Arden Way to Exposition Boulevard
Notre Dame Drive to Citadel Way
Helena Avenue to El Camino Avenue
Howe Avenue to Jed Smith Drive
Roseville Road to Marconi Avenue
McKinley Boulevard to 51st Street
Astoria Street to Northgate Blvd
South Land Park Dr to Normandy Lane
Meadowview Rd to Shrader/Fallis Cr
Del Paso Blvd to Evergreen Street
City Lmts on the North to Grand Ave
7th Street to Alhambra Boulevard
Auburn Boulevard to Howe Avenue
Center Parkway to Franklin Boulevard
Natomas East Main Drainage Canal to Ethan Way
Elkhorn Road to City Limits on south
Stockton Blvd to East City Limits
Grove Avenue to Del Paso Boulevard
Garden Hwy. to Northgate Boulevard
Acoma Street to Fairfield Street
Stockton Boulevard & City Limits
C Street to Folsom Boulevard
El Camino Avenue to Hurley Way
Del Paso Boulevard to Arden Way
Tribute Road to Arden Way
7th Street to Alhambra Boulevard
H Street to East City Limits
Tribute Road to Blumenfeld Drive
Riverside Blvd to East City Limits
Kiefer Blvd to South City Limits
Alhambra Blvd to East City Limits
Broadway to South City Limits
Broadway to Capitol Mall
Broadway to South City Limits
Seamas Avenue to East City Limits
7th Street to Alhambra Boulevard
Franklin Boulevard to Mack Road
City Lmts on west to Northgate Blvd
West El Camino Ave to Garden Highway

FOR CITY CLERK USE ONLY

ORDINANCE NO.: _____

DATE ADOPTED: _____

Glenrose Avenue
Glenrose Avenue
Gloria Drive
Grand Avenue
Greenhaven Drive
Grove Avenue
H Street
Harvard Street
Havenside Drive
Helena Avenue
Heritage Lane
Hornet Drive
Howe Avenue
Howe Avenue
I Street
Irvin Way
J Street
Jacinto Road
Jackson Road
Jansen Drive
Jibboom Street
Julliard Drive
K Street
Karbet Way
Kiefer Boulevard
L Street
Lake Forrest Drive
Land Park Drive
La Mancha Way
La Riviera Drive
Lawrence Drive
Lemon Hill Avenue
Lexington Street
Logan Street
Longview Drive
Mack Road
Main Avenue
Marconi Avenue
Marconi Circle
Marysville Boulevard
Marysville Boulevard
McKinley Boulevard
McMahon Drive
Meadowgate Drive
Meadowview Road
Messina Drive
Miller Way
Munroe Street

Auburn Boulevard to Albatross Way
Del Paso Blvd to Lexington Street
Havenside Drive/Drainage Canal to 35th Avenue
Norwood Avenue to Talent Street
Riverside Boulevard to Pocket Road
Lindley Drive to Del Paso Boulevard
6th Street to Fair Oaks Boulevard
Arden Way to Auburn Boulevard
Riverside Boulevard to Gloria Drive/Drainage Canal
Del Paso Boulevard to Clay Street
Arden Way to Exposition Boulevard
Folsom Boulevard to College Town Dr
Auburn Boulevard to Marconi Avenue
Cadillac Drive to Folsom Boulevard
Front Street to 29th Street
24th Street to Freeport Boulevard
3rd Street to Alhambra Boulevard
Bruceville Road to Calvine Road
Folsom Boulevard to East City Limits
65th Street Expwy. to Stockton Blvd
Richards Boulevard to I Street
Notre Dame Drive to Folsom Boulevard
14th Street to Alhambra Boulevard
25th Avenue to Seamas Avenue
Folsom Boulevard to East City Limits
3rd Street to 35th Street
Marquette Drive to Wissemann Drive
Broadway to Sutterville Road
Tangerine Avenue to Mack Road
College Town Drive to Watt Avenue
Fruitridge Road to Stockton Blvd
Stockton Boulevard to Power Inn Road
Glenrose Avenue to Arden Way
Elder Creek Rd to Lemon Hill Avenue
Roseville Road to East City Limits
Meadowview Road to Stockton Blvd
Northgate Blvd to Rio Linda Blvd
Del Paso Boulevard to Howe Avenue
Auburn Boulevard to Roseville Road
Rio Linda Boulevard to Bell Avenue
Raley Boulevard to Del Paso Blvd
Alhambra Boulevard to Elvas Avenue
65th Street Expwy. to Stockton Blvd
Franklin Boulevard to G Parkway
Interstate 5 to Brookfield Drive
Carlson Drive to Sandburg Drive
Stockton Boulevard to Y Street
American River Drive to City Limits

FOR CITY CLERK USE ONLY

ORDINANCE NO.: _____

DATE ADOPTED: _____

Muir Way
N Street
Natomas Park Drive
North B Street
North 12th Street
North 16th Street
North Avenue
Northgate Boulevard
Norwood Avenue
Norwood Bypass
Notre Dame Drive
Occidental Drive
P Street
Park Riviera Drive
Pebblewood Drive
Pinell Street
Pocket Road
Pocket Road
Power Inn Road
Q Street
Raley Boulevard
Response Road
Richards Boulevard
Rio Linda Boulevard
Riverside Boulevard
Roseville Road
Royal Oaks Drive
Rush River Drive
S Street
S Street
Martin L. King Jr. Boulevard
Sandburg Drive
San Juan Road
Seamas Avenue
Silver Eagle Road
Sonoma Avenue
Sorento Road
South Avenue
South Land Park Drive
Stockton Boulevard
Sutterville Road
T Street
Taylor Street
Traction Avenue
Tribute Road
University Avenue
Vallejo Way
Valley Hi Drive

Broadway to Roberston Way
3rd Street to Folsom Boulevard
West El Camino Ave to Garden Highway
Bannon Street to North 16th Street
North 16th Street to A Street
North 12th Street to A Street
Marysville Boulevard to Tate Street
Main Avenue to Del Paso Boulevard
Norwood Bypass to Main Avenue
Norwood Avenue to Grove Avenue
Folsom Boulevard to Lake Forest Dr
La Riviera Drive to Julliard Drive
2nd Street to Alhambra Boulevard
Riverside Boulevard to Pocket Road
Azevedo Drive to Truxel Road
Bell Avenue to South Avenue
Park Riviera Way to Riverside Blvd
Riverside Blvd to Interstate 5
Folsom Blvd to South City Limits
2nd Street to Alhambra Boulevard
City Lmts on Nth to Marysville Blvd.
Exposition Blvd to Challenge Way
Jibboom Street to North 12th Street
City Lmts on North to Del Paso Blvd.
W Street to Pocket Road
Marconi Circle to East City Limits
Arden Way to Highway 160
Gloria Drive to Greenhaven Drive
3rd Street to 34th Street
59th Street to 65th Street
Broadway to South City Limits
Carlson Drive to Carlson Drive
W City Limits to Silver Eagle Road
Riverside Blvd. to Sth Land Park Dr
San Juan Road to Norwood Avenue
Belden Street to Del Paso Boulevard
East Levee Road to Del Paso Road
Rio Linda Boulevard to Astoria St
Sutterville Road to Windbridge
Alhambra Blvd to South City Limits
Riverside Boulevard to Franklin Blvd
3rd Street to Kroy Way
Harris Avenue to Ford Road
El Camino Avenue to Eleanor Avenue
Exposition Boulevard to Fee Drive
Fair Oaks Blvd to American River Dr
5th Street to Freeport Boulevard
Mack Road to Franklin Boulevard

FOR CITY CLERK USE ONLY

ORDINANCE NO.: _____

DATE ADOPTED: _____

Van Ness Street
W Street
Watt Avenue
Watt Avenue
West El Camino Avenue
Windbridge Drive
Winters Street
Wissemann Drive
Woodbine Avenue
X Street
2nd Avenue
3rd Street
4th Avenue
5th Avenue
5th Street
7th Street
8th Street
9th Street
10th Street
11th Street
12th Avenue
12th Street
14th Avenue
15th Street
16th Avenue
16th Street
19th Street
21st Avenue
21st Avenue
21st Street
21st Street
24th Street
26th Avenue
28th Street
29th Street
29th Street
30th Street
33rd Street
34th Street
35th Avenue
36th Street
37th Street
39th Street
43rd Avenue
47th Avenue
49th Street
51st Street
56th Street

Auburn Boulevard to El Camino Avenue
3rd Street to 27th Street
North City Limits to Auburn Blvd
American River Drive to Folsom Blvd
W City Lmts to Natomas East Main Drainage Canal
Greenhaven Drive to Pocket Road
Bell Avenue to Grand Avenue
Lake Forest Drive to Folsom Blvd
47th Avenue to Florin Road
3rd Street to Alhambra Boulevard
Riverside Boulevard to Stockton Blvd
I Street to Broadway
21st Street to Franklin Boulevard
Franklin Boulevard to 33rd Street
I Street to Vallejo Way
E Street to T Street
E Street to T Street
E Street to Broadway
D Street to Broadway
Riverside Boulevard to Freeport Blvd
Franklin Boulevard to Stockton Blvd
A Street to L Street
Martin L. King Jr. Blvd to Power Inn Road
C Street to Broadway
Martin L. King Jr. Blvd to the S Sacramento Freeway
A Street to Broadway
H Street to Broadway
Franklin Blvd to Martin L. King Jr. Blvd
Stockton Boulevard to 79th Street
C Street to Freeport Boulevard
Florin Road to Meadowview Road
T Street to Laramore Way
24th Street to Franklin Boulevard
A Street to V Street
C Street to U Street
Florin Road to Meadowview Road
C Street to U Street
5th Avenue to 12th Avenue
Folsom Boulevard to 5th Avenue
Riverside Blvd to Freeport Boulevard
16th Avenue to 26th Avenue
Y Street to Broadway
McKinley Boulevard to Stockton Blvd
Riverside Boulevard to Blair Avenue
24th Street to Stockton Boulevard
V Street to Broadway
C Street to D Street
Elvas Avenue to Folsom Boulevard

FOR CITY CLERK USE ONLY

ORDINANCE NO.: _____

DATE ADOPTED: _____

59th Street
62nd Street
65th Street
65th Street Expressway
71st Street
Unnamed Street through
McKinley Park

Folsom Boulevard to Broadway
Broadway to 14th Avenue
Elvas Avenue to 14th Avenue
14th Avenue to City Limits
14th Avenue to 21st Avenue
Between Alhambra Blvd at G Street and H Street

SECTION 2.

Resolution No. 88-325 is hereby repealed.

MAYOR

ATTEST:

CITY CLERK

CA4-03.L

FOR CITY CLERK USE ONLY

ORDINANCE NO.: _____

DATE ADOPTED: _____