

CITY OF SACRAMENTO
1231 I Street, Sacramento, CA 95814

Permit No: 0012985

Insp Area: 4

Site Address: 3403 SWALLOWES NEST DR SAC
Parcel No: COSTA BL AT SW NEST LOT 35

Sub-Type: NSFR
Housing (Y/N): N

CONTRACTOR
REGIS CONTRACTORS
1425 RIVER PARK DR SUITE 530
SACRAMENTO CA 95815

OWNER

ARCHITECT

Nature of Work: MP 2293 1 STORY 8 ROOM SFR

CONSTRUCTION LENDING AGENCY: I hereby affirm under penalty of perjury that there is a construction lending agency for the performance of the work for which this permit is issued (Sec. 3097, Civ. C).

Lender's Name _____ Lender's Address _____

LICENSED CONTRACTORS DECLARATION: I hereby affirm under penalty of perjury that I am licensed under provisions of Chapter 9 (commencing with section 7000) of Division 3 of the Business and Professions Code and my license is in full force and effect.

License Class B1 License Number 208694 Date 11-16-00 Contractor Signature Don Moran

OWNER-BUILDER DECLARATION: I hereby affirm under penalty of perjury that I am exempt from the contractors License Law for the following reason (Sec. 7031.5, Business and Professions Code; any city or county which requires a permit to construct, alter, improve, demolish, or repair any structure, prior to its issuance, also requires the applicant for such permit to file a signed statement that he or she is licensed pursuant to the provisions of the Contractors License Law (Chapter 9 (commencing with Section 7000) of Division 8 of the Business and Professions Code) or that he or she is exempt therefrom and the basis for the alleged exemption. Any violation of Section 7031.5 by any applicant for a permit subjects the applicant to a civil penalty of not more than five hundred dollars (\$500.00);

I, as a owner of the property, or my employees with wages as their sole compensation, will do the work, and the structure is not intended or offered for sale (Sec. 7044, Business and Professional Code: The Contractors License Law does not apply to an owner of property who builds or improves thereon, and who does such work himself or herself or through his/her own employees, provided that such improvements are not intended or offered for sale. If, however, the building or improvement is sold within one year of completion, the owner-builder will have the burden of proving that he/she did not build or improve for the purpose of sale.)

I, as owner of the property, am exclusively contracting with licensed contractors to construct the project (Sec. 7044, Business and Professions Code: The Contractors License Law does not apply to an owner of property who builds or improves thereon, and who contracts for such projects with a contractor(s) licensed pursuant to the Contractors License Law).

I am exempt under Sec. _____ B & PC for this reason: _____

Date _____ Owner Signature _____

IN ISSUING THIS BUILDING PERMIT, the applicant represents, and the city relies on the representation of the applicant, that the applicant verified all measurements and locations shown on the application or accompanying drawings and that the improvement to be constructed does not violate any law or private agreement relating to permissible or prohibited locations for such improvements. This building permit does not authorize any illegal location of any improvement or the violation of any private agreement relating to location of improvements.

I certify that I have read this application and state that all information is correct. I agree to comply with all city and county ordinances and state laws relating to building construction and hereby authorize representative(s) of this city to enter upon the abovementioned property for inspection purposes.

Date 11-16-00 Applicant/Agent Signature Don Moran

WORKER'S COMPENSATION DECLARATION: I hereby affirm under penalty of perjury one of the following declarations:

I have and will maintain a certificate of consent to self-insure for workers' compensation as provided for by Section 3700 of the Labor Code, for the performance of work for which the permit is issued.

I have and will maintain workers' compensation insurance, as required by Section 3700 of the Labor Code, for the performance of the work for which this permit is issued. My workers' compensation insurance carrier and policy number are:

Carrier LIBERTY MUTUAL Policy Number WC2-151-030013-019 Exp Date 1/1/2001

(This section need not be completed if the permit is for \$100 or less) I certify that in the performance of the work for which this permit is issued, I shall not employ any person in any manner so as to become subject to the workers' compensation laws of California and agree that if I should become subject to the workers' compensation provisions of Section 3700 of the Labor Code, I shall forthwith comply with those provisions.

Date 11-16-00 Applicant Signature Don Moran

WARNING: FAILURE TO SECURE WORKER'S COMPENSATION COVERAGE IS UNLAWFUL AND SHALL SUBJECT AN EMPLOYER TO CRIMINAL PENALTIES AND CIVIL FINES UP TO ONE HUNDRED THOUSAND DOLLARS (\$100,000) IN ADDITION TO THE COST OF COMPENSATION, DAMAGES AS PROVIDED FOR IN SECTION 3706 OF THE LABOR CODE, INTEREST AND ATTORNEY'S FEE.

THIS PERMIT SHALL EXPIRE BY LIMITATION IF WORK IS NOT COMMENCED WITHIN 180 DAYS.



**INSULATION CONTRACTORS
ASSOCIATION
OF AMERICA**

INSULATION
CERTIFICATE
69056

1321 DUKE STREET, SUITE 303 • ALEXANDRIA, VA 22314 • (703) 739-0356

THIS IS TO CERTIFY THAT INSULATION HAS BEEN INSTALLED IN CONFORMANCE WITH CURRENT ENERGY REGULATIONS, CALIFORNIA ADMINISTRATIVE CODE, TITLE 24, STATE OF CALIFORNIA, IN THE BUILDING LOCATED AT:

3403 Swallows Nest City Alexandria
LOT # 35 TRACT #

EXTERIOR WALLS:

MANUFACTURER _____ THICKNESS/TYPE _____ R- VALUE _____

CEILING:

MANUFACTURER _____ THICKNESS/TYPE _____ R- VALUE _____

BLOWN IN: _____ MINIMUM THICKNESS _____ R- VALUE **38**

MANUFACTURER _____ THICKNESS/TYPE _____ R- VALUE _____

SLAB ON GRADE: _____ THICKNESS/TYPE _____ R- VALUE _____

MANUFACTURER _____ THICKNESS/TYPE _____ R- VALUE _____

WIDTH OF INSULATION _____ INCHES

FOUNDATION WALLS: _____ THICKNESS/TYPE _____ R- VALUE _____

MANUFACTURER _____ THICKNESS/TYPE _____ R- VALUE _____

GENERAL CONTRACTOR _____

CALIFORNIA CONTRACTORS LICENSE # _____

INSULATION CONTRACTOR **ARCADE INSULATION**

CALIFORNIA CONTRACTORS LICENSE #263784 DATE **7-25-01**

SIGNATURE _____ TITLE _____

Builder Copy

Date: 8-9-01 *John Kenyon III*

Signature of authorized representative of stucco contractor:

This is to certify that the stucco system on the building exterior at the above address had been installed in accordance with the evaluation report specified above and the manufacturer's instructions.

Approved Contractor Number as issued by the Stucco Manufacturer: 1

Stucco Contractor: Kenyon Plastering, Inc.
 Name: John W. Kenyon, III
 Address: P.O. Box 2077
North Highlands, CA 95660
 Telephone #: (916) 349-8191

#C30248
 REGIS CONTRACTORS
 COSTA BLANCA LOT # 35
 3403 SWALLOW NEST SACRAMENTO

Stucco System Trade Name: KWIK KOTE
 Name Stucco Manufacturer: KWIK KOTE CORP
 ICBO Evaluation Service, Inc. Report No. 3607
 Date of Job Completion: 7-3-01

KWIKKOTE
 STUCCO SYSTEM
 INSTALLATION CARD



WALLACE • KUHL & ASSOCIATES INC.
 GEOTECHNICAL ENGINEERING • CONSTRUCTION TESTING

3050 Industrial Blvd.
 PO Box 1137
 West Sacramento
 California 95691
 916-372-1434

DATE 6-12-01		JOB NO. 3798.03		WEATHER		TEMP. ° at		AM	
PROJECT COSTA BIANCA		REGIS. HRS. 6.5		Technician I <input type="checkbox"/>		Staff E/G <input type="checkbox"/>			
LOCATION Lot # 34				Technician II <input type="checkbox"/>		Project E/G <input type="checkbox"/>			
TYPE OF WORK PULL TEST				Technician III <input type="checkbox"/>		Senior E/G <input type="checkbox"/>			
Inside 50 mi. radius <input type="checkbox"/>		Outside 50 mi. radius <input type="checkbox"/>		Nuclear Densities <input type="checkbox"/>		Principal E/G <input type="checkbox"/>			
PERSONNEL		REG. HRS	OT HRS	TOTAL HRS	TRAVEL	ON JOB	VEHICLE	MILES	
DS		.5	0	1.0	.5		# 14	12	

OBSERVATIONS:
 ON SITE AS REQUESTED TO PERFORM PULL TEST ON 5/8" ALL-HEAD FOR PHD2 HOLD DOWN @ A PULL VALUE OF 3000# AND A GAGE PSI. OF 1700# USING JACK A WITH GAGE # 5A @ THE FOLLOWING LOCATION.
 LOT # 34 - 1EA PHD2 ON W/WALL OF GARAGE. PASSED

FIELD REPORT

Signed

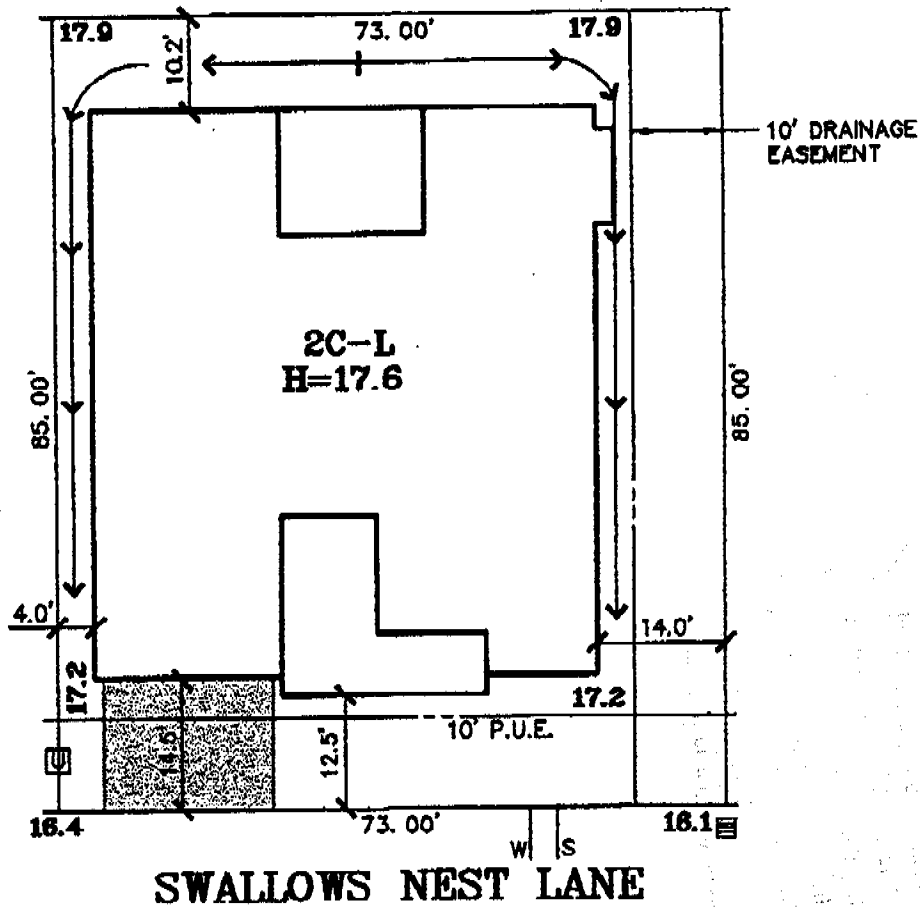

THIS PLAN IS A PRELIMINARY PLAN AND IS NOT TO BE USED FOR CONSTRUCTION. THE CITY OF SACRAMENTO, CALIFORNIA, IS NOT RESPONSIBLE FOR THE ACCURACY OF THIS PLAN. THE CITY OF SACRAMENTO, CALIFORNIA, IS NOT RESPONSIBLE FOR THE ACCURACY OF THIS PLAN.

SCALE: 1" = 20'

DATE: 10-19-00

A.P.N.:

ADDRESS: 3403 SWALLOWS NEST LANE

LOT AREA: 6,205 SF
LOT COVERAGE: 37%

The Splink Corporation
 2590 VENTURE OAKS WAY
 SACRAMENTO, CA. 95833
 PH (916)925-5550 FAX (916)921-9274

**COSTA BLANCA
 AT SWALLOWS NEST**
 LOT 35
 PLAN 2C

COSTA BLANCA
 CITY OF SACRAMENTO, CA
 CLIENT: REGIS HOMES
 JOB NO.: 7908-004