

SACRAMENTO CITY PLANNING COMMISSION

Report of Planning Director, R. L. Rathfon

July 27, 1965

APPLICATION FOR SPECIAL PERMIT

OWNERS OF RECORD: Orville J. Rigby, 1902 Silica Ave, Sacramento
Sylvester Wirtz, 8230 Oak Ave, Citrus Heights, Calif.
R. Mattuschek, 2329 Albatross Way, Sacramento

APPLICANT: Orville J. Rigby, 1902 Silica Ave

LEGAL DESCRIPTION OF PROPERTY: N. 193.9 of E. 160' Lot 3, Blk "F"
No. Sacramento Sub #2.

LOCATION: SW corner of Silica Ave & Albatross Way (abandoned)

USE: Existing - Vacant lot, 1 family dwelling & nursing home for 8 people.
Proposed - 48-bed nursing home with 24 off-street parking area.

ZONING: Existing - R-1 single family. Proposed - Same

REQUEST: To develop R-1 single family zone with a Nursing Home to accommodate 48 persons and provide off street parking for 24 cars, according to submitted plans.

GENERAL INFORMATION: 48 bed capacity.
Parking Required - 24. Parking Proposed - 24

STATEMENT: Proposed nursing home will be a one-story H Shape structure, 48 bed capacity plus reception room, offices, lounges, recreation room, therapy and rehabilitation rooms, and separate utility building. Off street parking as shown off of Albatross Way, which has been abandoned, will have to be revised in order to meet the requirements of Sec. 6 of Ord. 2550-4th Series.

SILICA

AVENUE

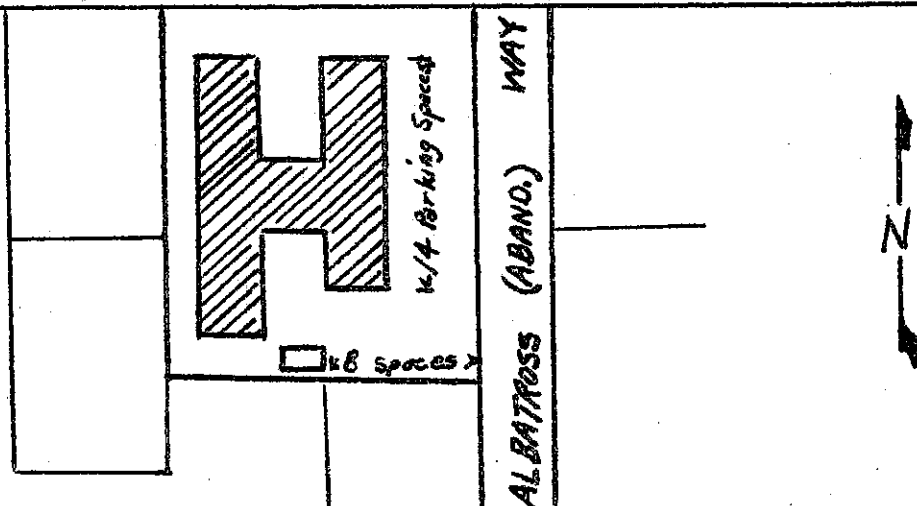

65-112
Item #4