



APPROVED
BY THE CITY COUNCIL

MAY 6 1997

OFFICE OF THE
CITY CLERK

A697-053

A.2

NEIGHBORHOOD SERVICES
DEPARTMENT

CITY OF SACRAMENTO
CALIFORNIA

1231 I STREET
SUITE 400
SACRAMENTO, CA
95814-2977

PH 916-264-5200
FAX 916-264-7643

April 22, 1997

City Council
Sacramento, California

Honorable Members in Session:

**SUBJECT: RIGHT OF ENTRY AGREEMENT TO ALLOW THE UNITED STATES
GEOLOGICAL SURVEY TO LOCATE 10 TO 20 SHALLOW GROUND-WATER
OBSERVATION WELLS ON PARKS AND OTHER CITY-OWNED PROPERTY**

LOCATION: Various locations City-wide

RECOMMENDATION:

Staff recommends that City Council authorize the City Manager to execute an agreement with the United States Geological Survey (USGS) for the purpose of locating 10 to 20 shallow ground-water observation wells on parks and other property owned by the City for the purpose of a National Water Quality Assessment (NAWQA) Program.

CONTACT PERSON: Vic Edmisten, Parks and Recreation Manager, 264-5336

FOR COUNCIL MEETING OF: May 6, 1997

SUMMARY:

Staff is proposing the City enter into a Right-of-Entry agreement with USGS, Water Resources Division, to allow the placement of 10 to 20 shallow ground-water observation wells on parks and other property owned by the City of Sacramento. The wells will be used for water-quality sampling as part of the Sacramento Basin Study Unit of the NAWQA Program being conducted by USGS. The program is slated to last through 1998, with the final report being written in 1999; the City would be provided, at no cost, copies of final reports.

City Council
USGS Well Sites
May 6, 1997

The agreement requires USGS assume full responsibility for installation, maintenance, repair, excavation, and restoration of the wells and the property. If, during the course of the study, contamination is discovered, the City's would potentially be exposed to characterization and clean-up costs. However, the City would only be required to clean up contamination where the City property was the source of the contamination.

COMMITTEE/COMMISSION ACTION:

This item was presented at the November 21, 1996, meeting of the Citizens Advisory Committee for Parks and Recreation (CAC). The CAC expressed no opposition to the placement of the wells in City parks, so long as there is no impact to users or the park itself.

BACKGROUND:

USGS has requested permission to install 10 to 20 shallow ground-water observation wells on parks and other property owned by the City of Sacramento. The wells will be used for water-quality sampling as part of the Sacramento Basin Study Unit of the NAWQA Program. The purpose of the NAWQA Program is to assess the status of and trends in the quality of the Nation's ground and surface water resources and to determine the natural and human factors that affect the quality of water. The study will obtain geologic and water chemistry data for shallow ground water beneath young residential and commercial urban areas and to attempt to determine what effect, if any, that land-use has on ground water quality in the Sacramento Metropolitan Area.

USGS will work with parks staff to identify appropriate sites and well locations and to minimize disruption to the sites during drilling, maintenance, and sampling. The following locations have been selected to date:

North Laguna Creek Park	Renfree Park	Sojourner Truth Park	Parkway Oaks Park
Mesa Grande Park	Reith Park	Northgate Park	Hite Park
Charter Pointe Park	Seymour Park	Jefferson Park	Chuckwagon Park
Bannon Creek Park			

Site location maps and proposed well construction specifications are attached. Installation of the proposed wells will have no significant impact to park maintenance, operations, or use.

It is anticipated that wells will be installed in mid-1997 with maintenance and sampling occurring throughout 1997/98. The wells will remain in use through 1999. At the completion of the study in 1999, USGS will be responsible for the proper maintenance and abandonment of these well sites; the site will then be returned to as near its original condition as possible. The City also may have the option of taking over responsibility of the wells.

The benefits identified by USGS for this national study include:

1. Geologic, hydrologic, and water-chemistry data on the shallow ground water system beneath Sacramento; most previous studies have focused on deeper parts of the ground-water system, or have been conducted at sites of known point-source contamination.
2. Documentation of whether contamination exists regionally in shallow ground-water beneath Sacramento, and if so, its possible relation to specific land-use practices; this information can be used by City and community planners and water agencies to minimize the effects of specific land uses on water quality.
3. Installation of a network of shallow wells that can provide early warning of contamination before it might be detected in a ground water or surface water public supply or other drinking water well.
4. Participation in future USGS studies to further the understanding of the effect of human activities on ground and surface water quality.

The above information will be available, at no cost, to the City of Sacramento.

FINANCIAL CONSIDERATIONS:

There are no significant costs to the City associated with the drilling component of this agreement. All costs related to installation, operation, maintenance, repair, and restoration of the site will be the responsibility of USGS. USGS will pay the City \$250 for each well site placed on City property to help offset staff costs associated with coordinating and monitoring this program.

If contamination is discovered, the City would potentially be exposed to clean-up costs. However, the City would only be required to clean up contamination where the City property was the source of the contamination, as opposed to a plume having resulted in water under the City land being contaminated. It is important to note the City would be responsible for the cost of characterizing the nature of the contaminate. It is difficult to project the cost for environmental investigations due to the individual nature of each contaminate and the variance in physical characteristics of each site.

ENVIRONMENTAL CONSIDERATIONS:

The Planning Services Division, Environmental Section, has reviewed the proposed project and has determined that this project is exempt from the California Environmental Quality Act (CEQA) under § 15304 and § 15306 of the CEQA Guidelines.

POLICY CONSIDERATIONS:

The focus of the USGS study is on shallow ground water, as opposed to the deep aquifers the City uses for drinking water. Well water accounts for approximately 20% of the City's total annual water usage. The water from these wells meets the water quality parameters established by the Environmental Protection

City Council
USGS Well Sites
May 6, 1997

Agency. The wells are systematically tested for metals, minerals, volatile organic compounds, pesticides, radiologicals, nitrates and nitrites. The State's Department of Health Services, Office of Drinking Water, directs the frequency and evaluates the findings of the well water testing.

The outcome of this project is consistent with City policy concerning environmental protection and improvement.

M/WBE CONSIDERATIONS:

Not applicable as no goods or services are being provided at this time.

Respectfully submitted,



VICTOR L. EDMISTEN
Parks and Recreation Manager

RECOMMENDATION APPROVED:

APPROVED:



WILLIAM H. EDGAR
City Manager

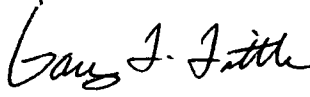

GARY L. LITTLE
Director, Area 2

A:DRILL3.CCR

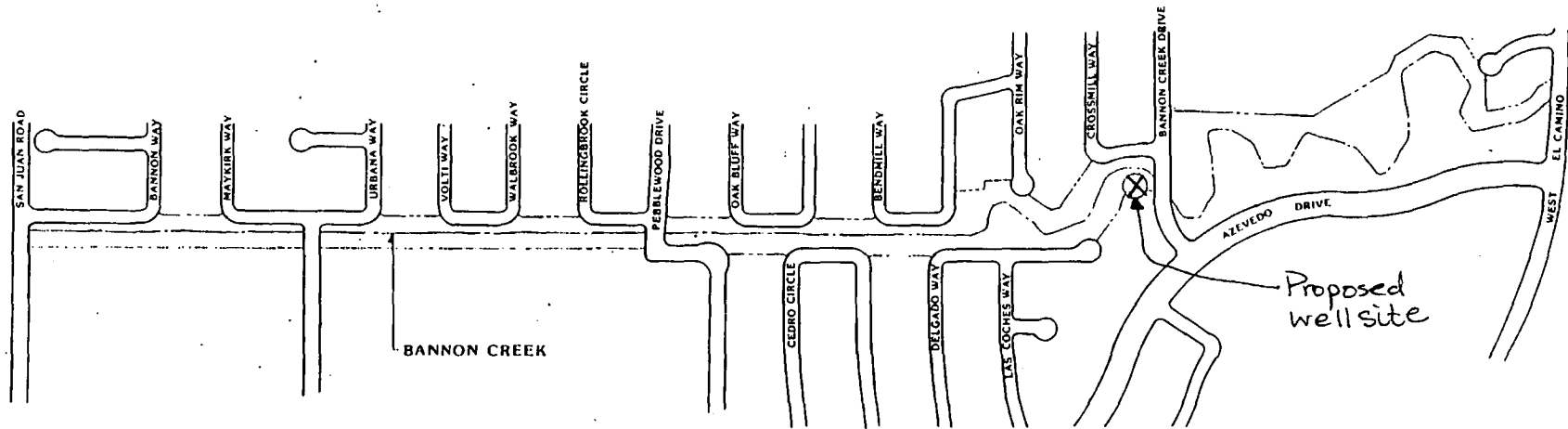

SITE PLAN

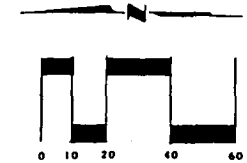

NO	DESCRIPTION	DATE	BY

DRAWN BY: JOHN GIER, JR.
 DESIGNED BY: _____
 LANDSCAPE ARCHITECT
 DATE: _____
 FIELD BOOK: _____ SCALE: 1" = 20'

CITY OF SACRAMENTO
 DEPARTMENT OF COMMUNITY SERVICES



BANNON CREEK PARKWAY
 PHASE II

SHEET
 3
 SHEETS

5

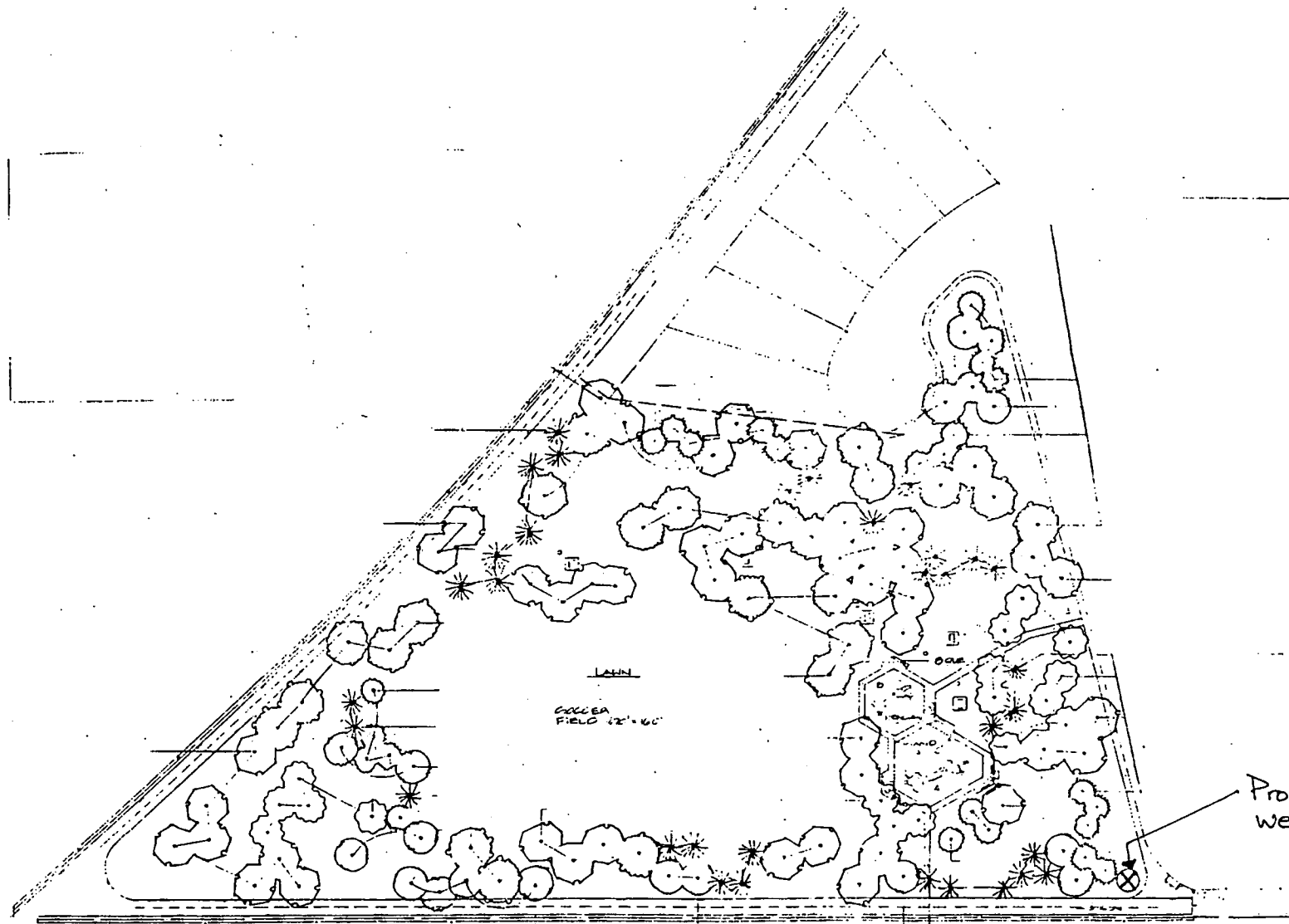

Proposed well site

CHARTER POINTE PARK

NO.	DESCRIPTION	DATE
1	DESIGNED	12/15/00
2	REVISED	12/15/00
3	REVISED	12/15/00
4	REVISED	12/15/00
5	REVISED	12/15/00
6	REVISED	12/15/00
7	REVISED	12/15/00
8	REVISED	12/15/00
9	REVISED	12/15/00
10	REVISED	12/15/00

NO.	DESCRIPTION	DATE
1	DESIGNED	12/15/00
2	REVISED	12/15/00
3	REVISED	12/15/00
4	REVISED	12/15/00
5	REVISED	12/15/00
6	REVISED	12/15/00
7	REVISED	12/15/00
8	REVISED	12/15/00
9	REVISED	12/15/00
10	REVISED	12/15/00

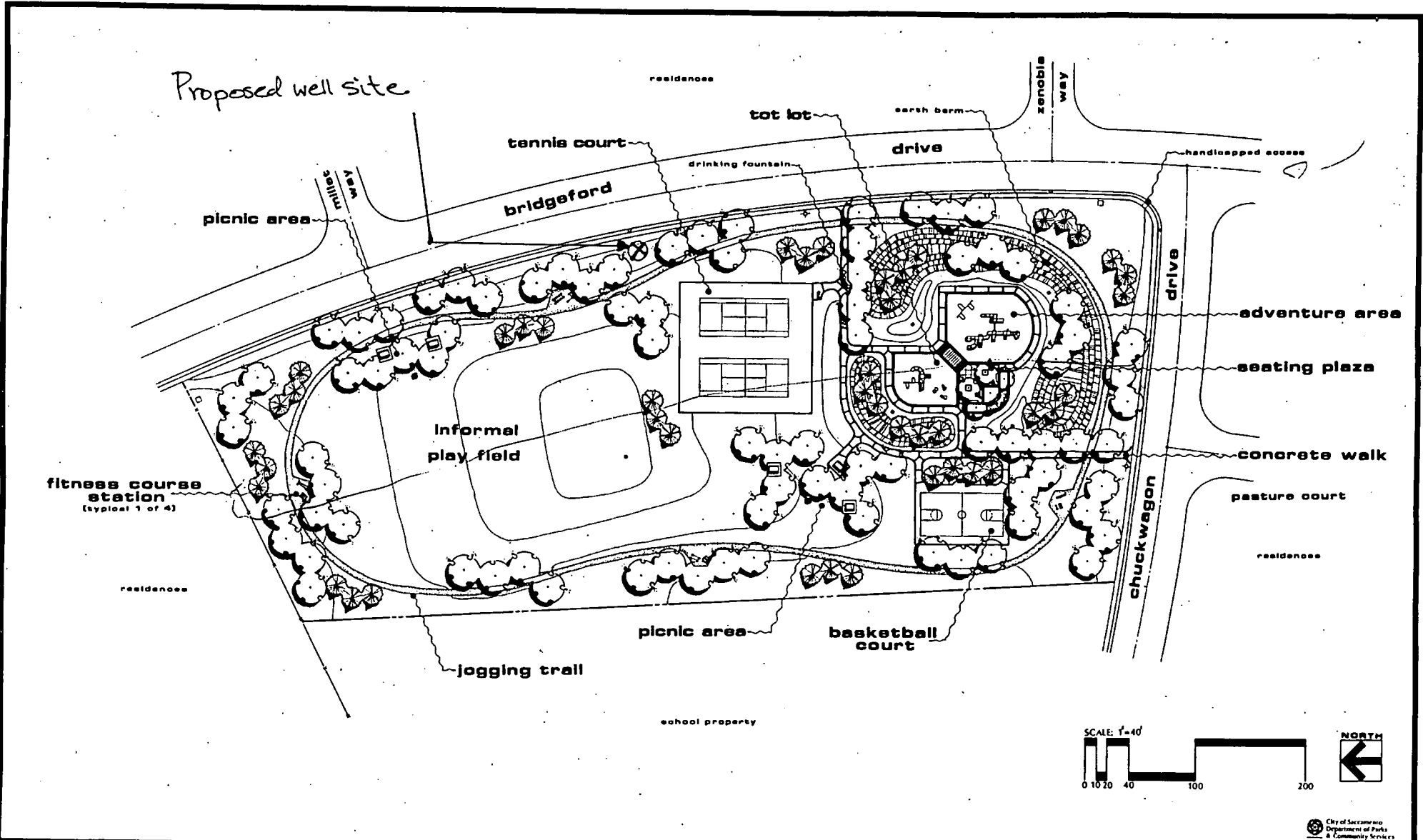

REVISIONS	
NO.	DESCRIPTION

DRAWN BY AM
 DESIGNED BY AM, MK
 LANDSCAPE ARCHITECT AM
 DATE 9-20-03
 FIELD BOOK _____ SCALE 1"=40'

CITY OF SACRAMENTO
 DEPARTMENT OF PARKS & COMMUNITY SERVICES



CHUCKWAGON PARK (6.15 AC)

SHEET
 1/1
 SHEETS

Proposed well site

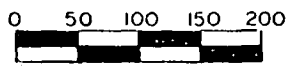
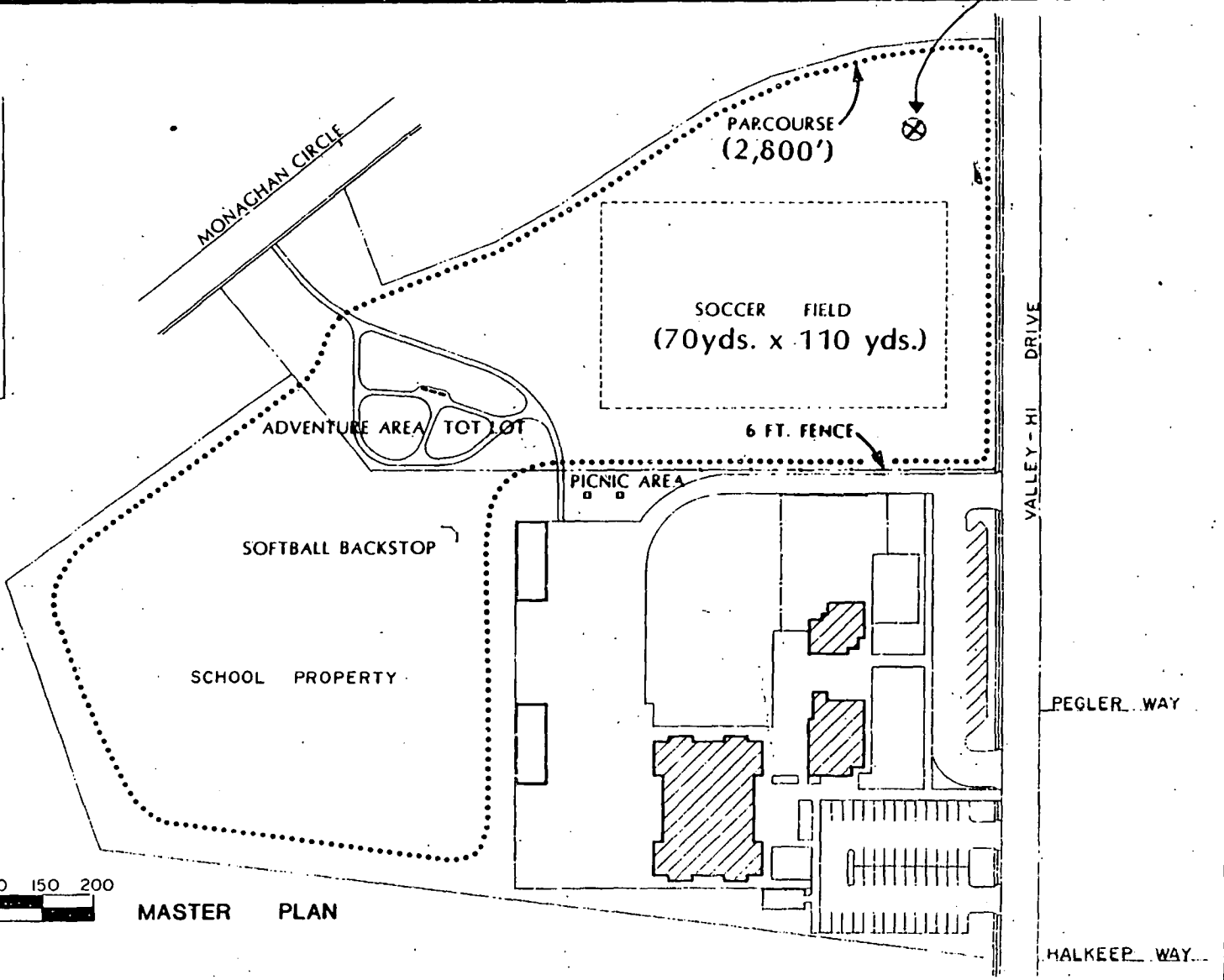
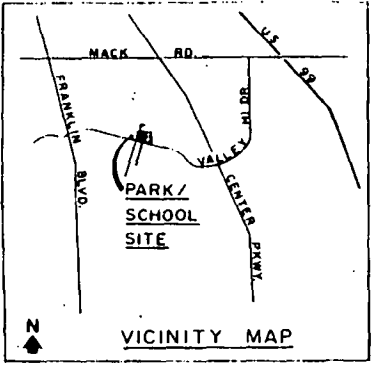

MASTER PLAN

NO.	DESCRIPTION	DATE	BY
1	PRELIMINARY PLAN	8-75	[Signature]
2	REVISED MASTER PLAN	8-75	[Signature]

DRAWN BY A. GOERZHLAQ
 DESIGNED BY _____
 LANDSCAPE ARCHITECT _____
 DATE _____
 FIELD BOOK _____ SCALE 1"=50'

CITY OF SACRAMENTO
 DEPARTMENT OF COMMUNITY SERVICES



HITE PARK (5.50 AC.)

SHEET
 1/2268
 SHEETS

MASTER PLAN

JEFFERSON PARK

CITY OF SACRAMENTO
DEPARTMENT OF COMMUNITY SERVICES

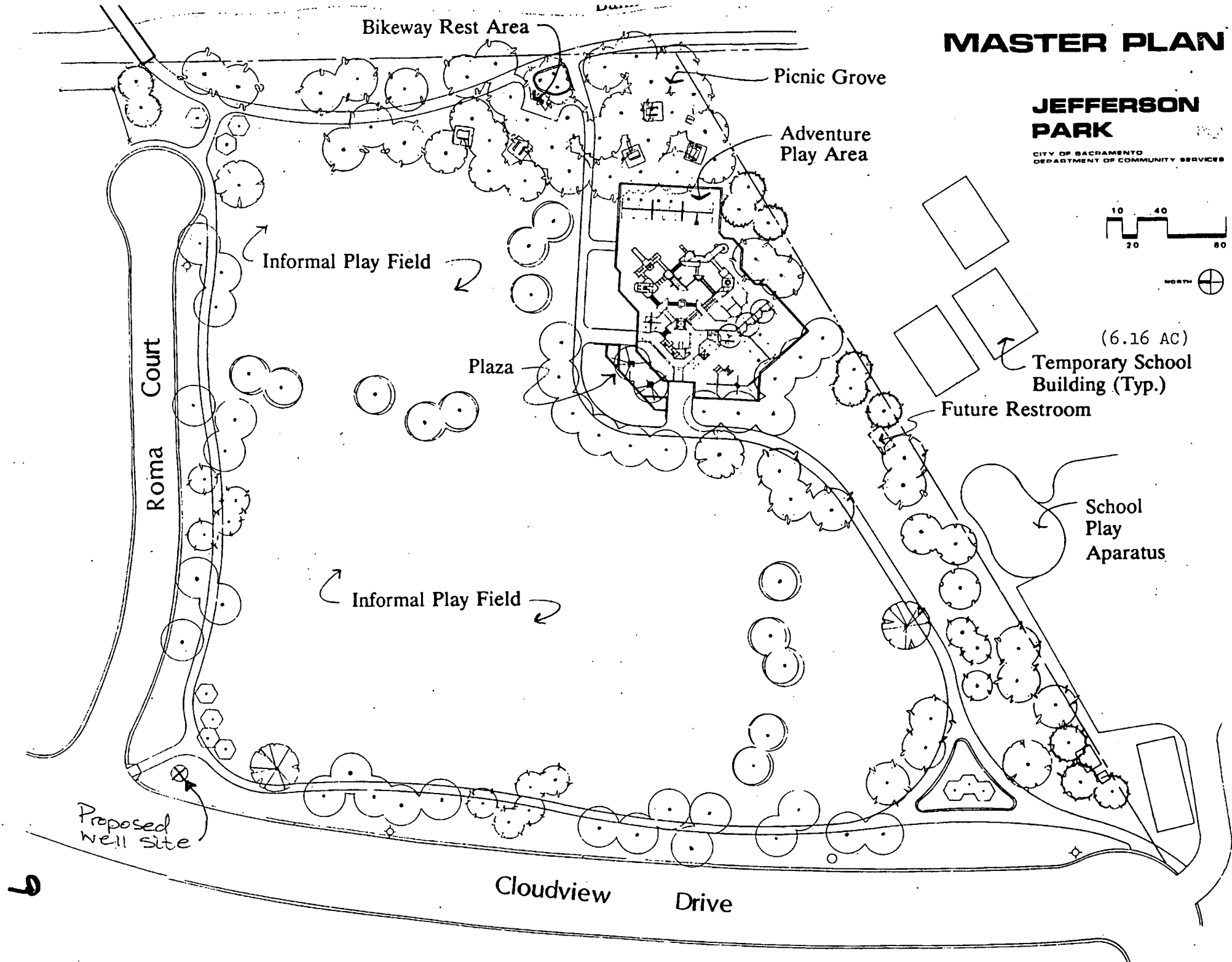
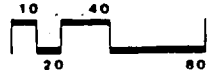

6

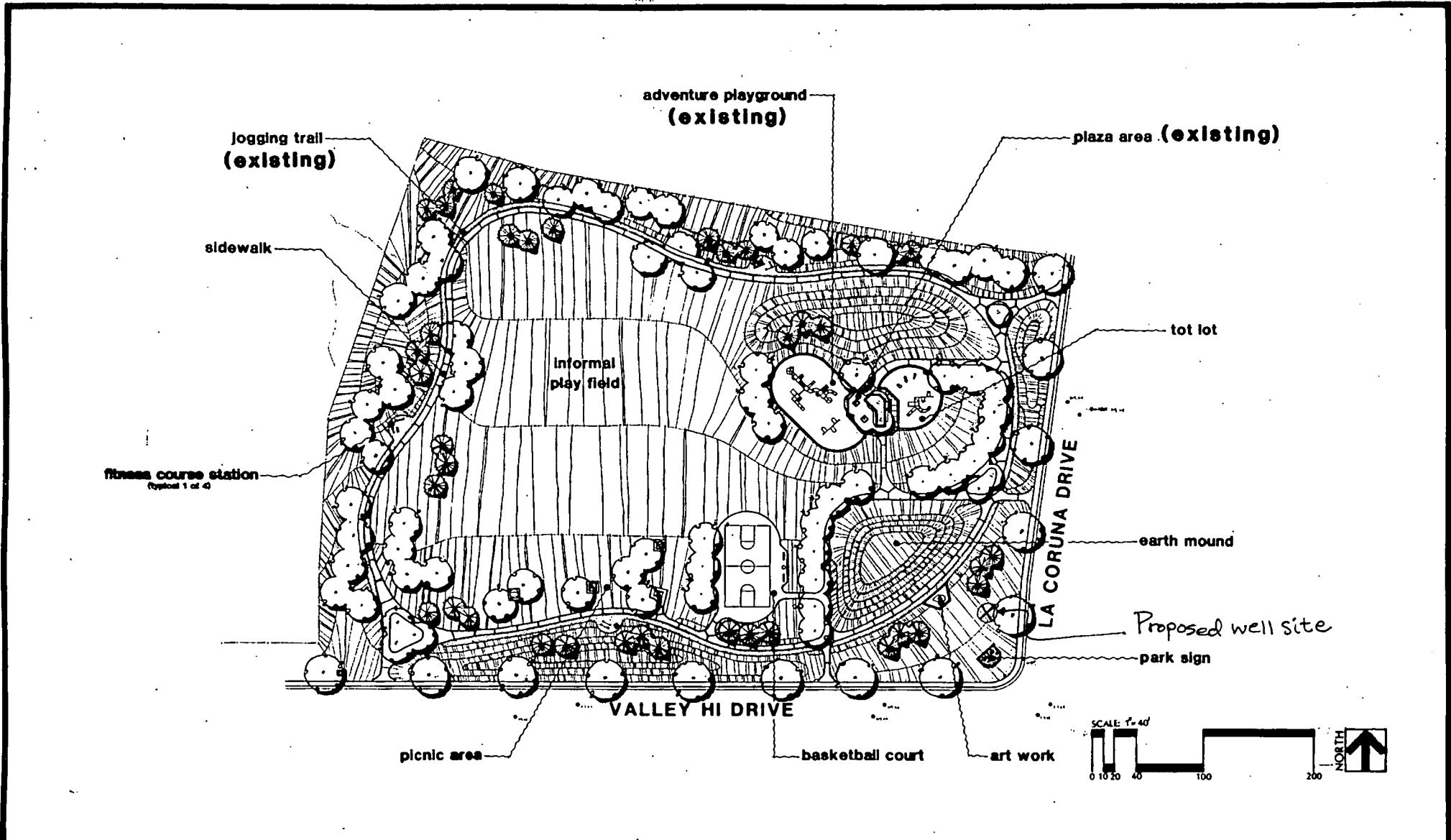

REVISIONS NO.	DESCRIPTION	DATE	BY

DRAWN BY G.M. MCK
 DESIGNED BY G.M. MCK
 LANDSCAPE ARCHITECT MSK
 DATE 7-18-00
 FIELD BOOK _____ SCALE 1"=40'

CITY OF SACRAMENTO
 DEPARTMENT OF PARKS & COMMUNITY SERVICES



MASTER PLAN
MESA GRANDE PARK (6.38 AC)

SHEET _____
 SHEETS _____

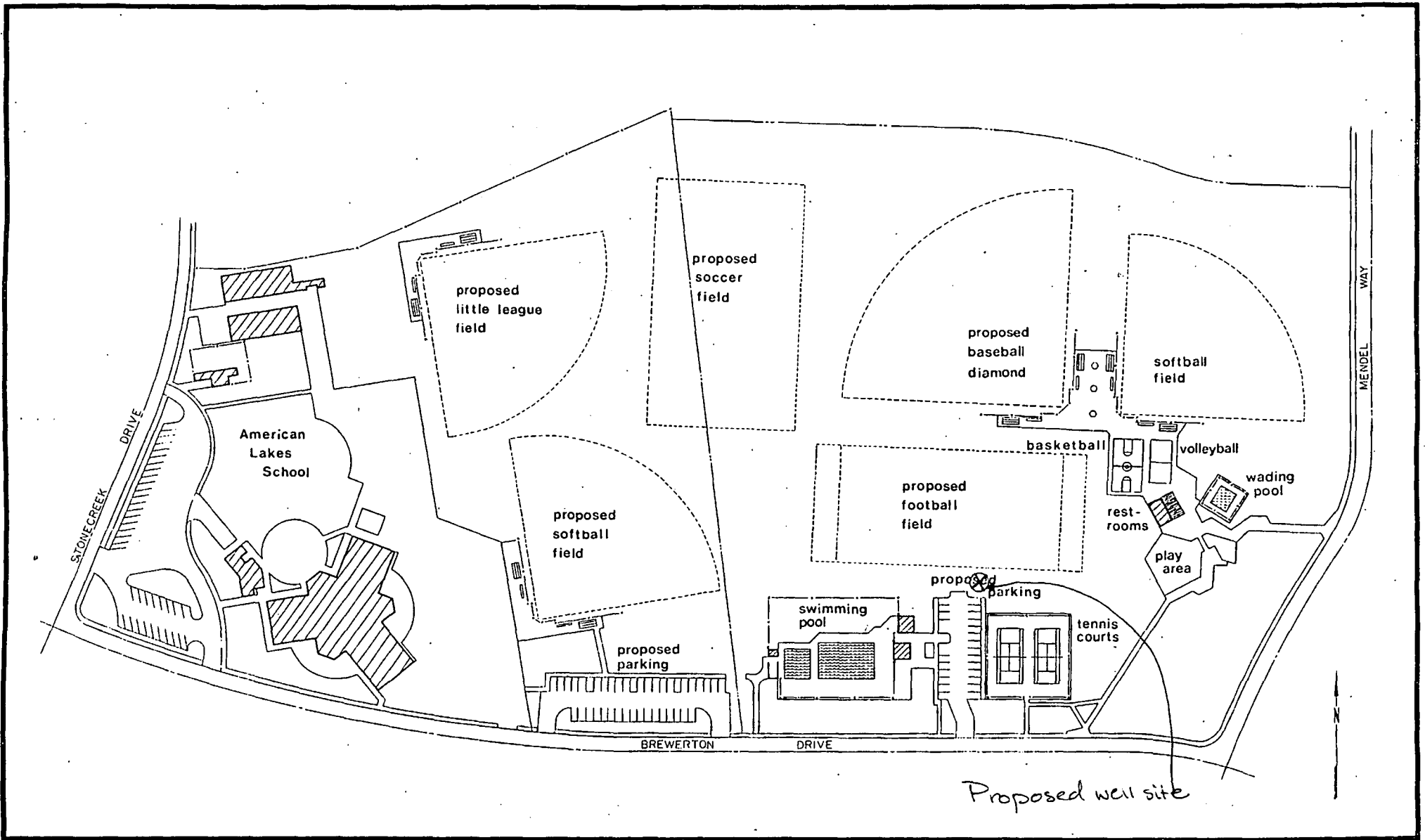

REVISIONS NO.	DESCRIPTION	DATE	BY

DRAWN BY J. MANANEY
 DESIGNED BY _____
 LANDSCAPE ARCHITECT _____
 DATE 9-82
 FIELD BOOK _____ SCALE 1" = 60' 0"

CITY OF SACRAMENTO
 DEPARTMENT OF COMMUNITY SERVICES



NORTHGATE PARK / AMERICAN LAKES SCHOOL
 MASTER PLAN

SHEET _____
 c/c SHEETS _____

NORTH LAGUNA CREEK PARK

MASTER PLAN
FOR
NORTH LAGUNA CREEK COMMUNITY
AND
CITY OF SACRAMENTO
OCTOBER 26, 1994

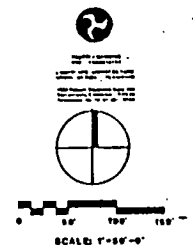

HOBBIES & SEATING AREA

PARKING LOT (60 SPACES)

COMMUNITY CENTER

SEATING PLAZA
W/ PICNIC TABLES, TRELLIS, TREE WELLS

BIKE RACK

BASEBALL (200') / MULTIPURPOSE FIELD

BASKETBALL

CONCRETE WALK (15')
MOUND (15')
ASPHALT PATH (15')

JACINTO ROAD

CLIPPED BANK

FENCE
NATURE INTERPRETIVE AREA
WETLAND OVERLOOK STRUCTURE

ENTRY PLAZA
W/ STRUCTURE, PICNIC TABLES,
ACCENT LIGHTING & IRON WALLS

PICNIC TABLES (15')

TOP LOT

TENNIS VOLLEY BALL

GAZEBO W/ PICNIC TABLES

PLAYGROUND
TURF AMPHITHEATER

WATER FRONT PROMENADE

POND

TENNIS COURTS

RESTROOM
BIKE RACK

Proposed well site

SOCCER FIELD (100' x 300')

PARKING LOT (40 SPACES)

CENTER PARKWAY

12

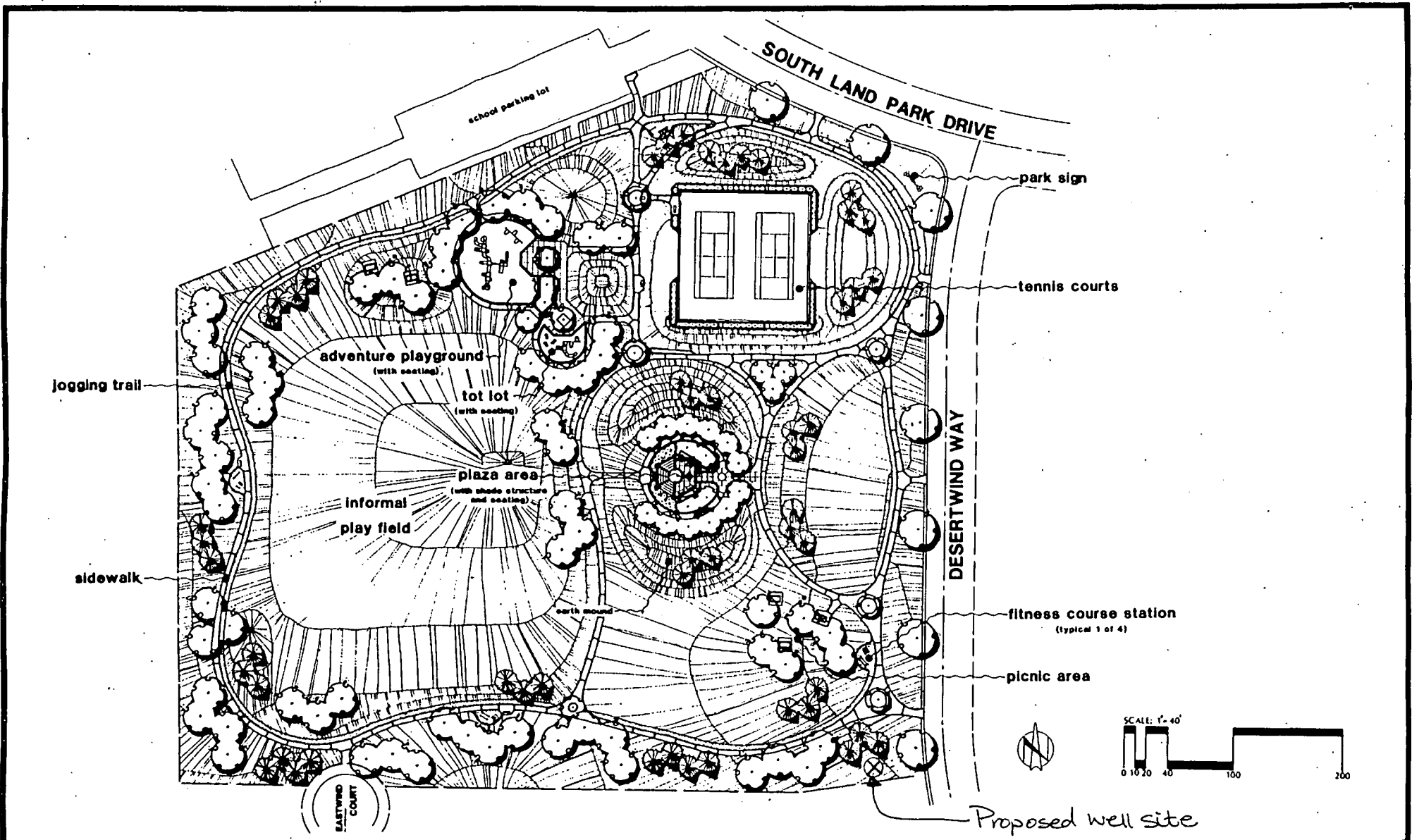

jogging trail

sidewalk

school parking lot

SOUTH LAND PARK DRIVE

park sign

tennis courts

adventure playground
(with seating)

tot lot
(with seating)

plaza area
(with shade structure
and seating)

informal
play field

DESERTWIND WAY

fitness course station
(typical 1 of 4)

picnic area



Proposed well site

BASEBALL COURT

REVISIONS	NO.	DESCRIPTION	DATE BY

DRAWN BY SMH
 DESIGNED BY SMH, DRR
 LANDSCAPE ARCHITECT MSK
 DATE 5-21-00
 FIELD BOOK SCALE 1"=40'

CITY OF SACRAMENTO
 DEPARTMENT OF PARKS & COMMUNITY SERVICES



PARKWAY OAKS PARK
MASTER PLAN (9.15 AC)

SHEET
 2/6 SHEETS

13

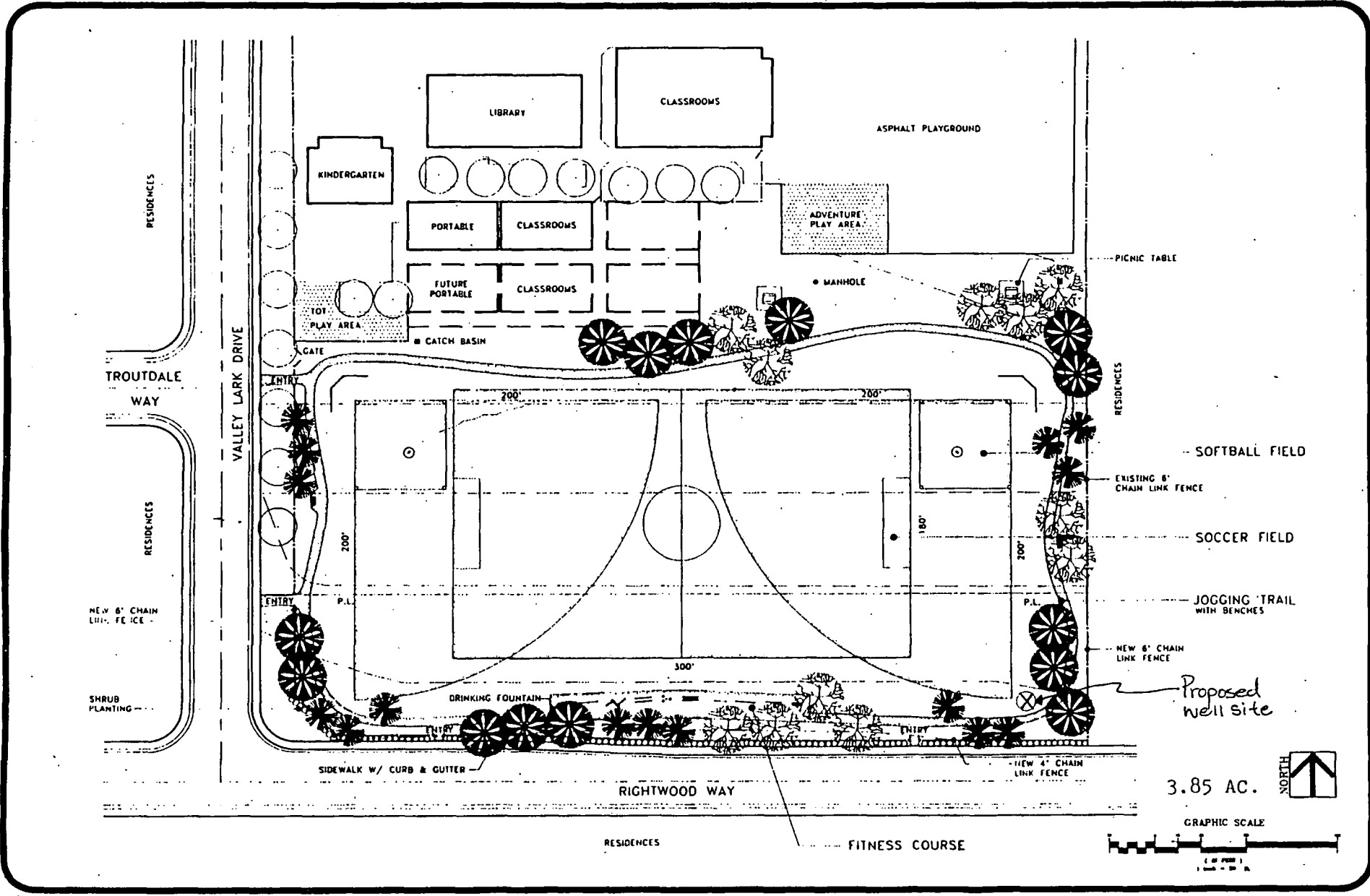

Scale	1" = 100'
North Arrow	↑
Graphic Scale	0 100 200'

REITH PARK MASTER PLAN

City of Sacramento
Department of Parks and Community Services



11

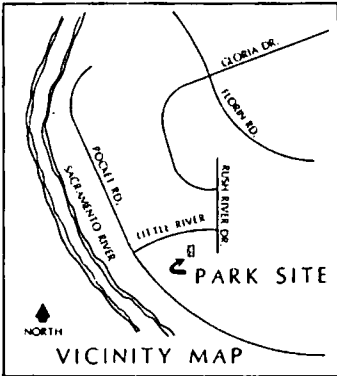
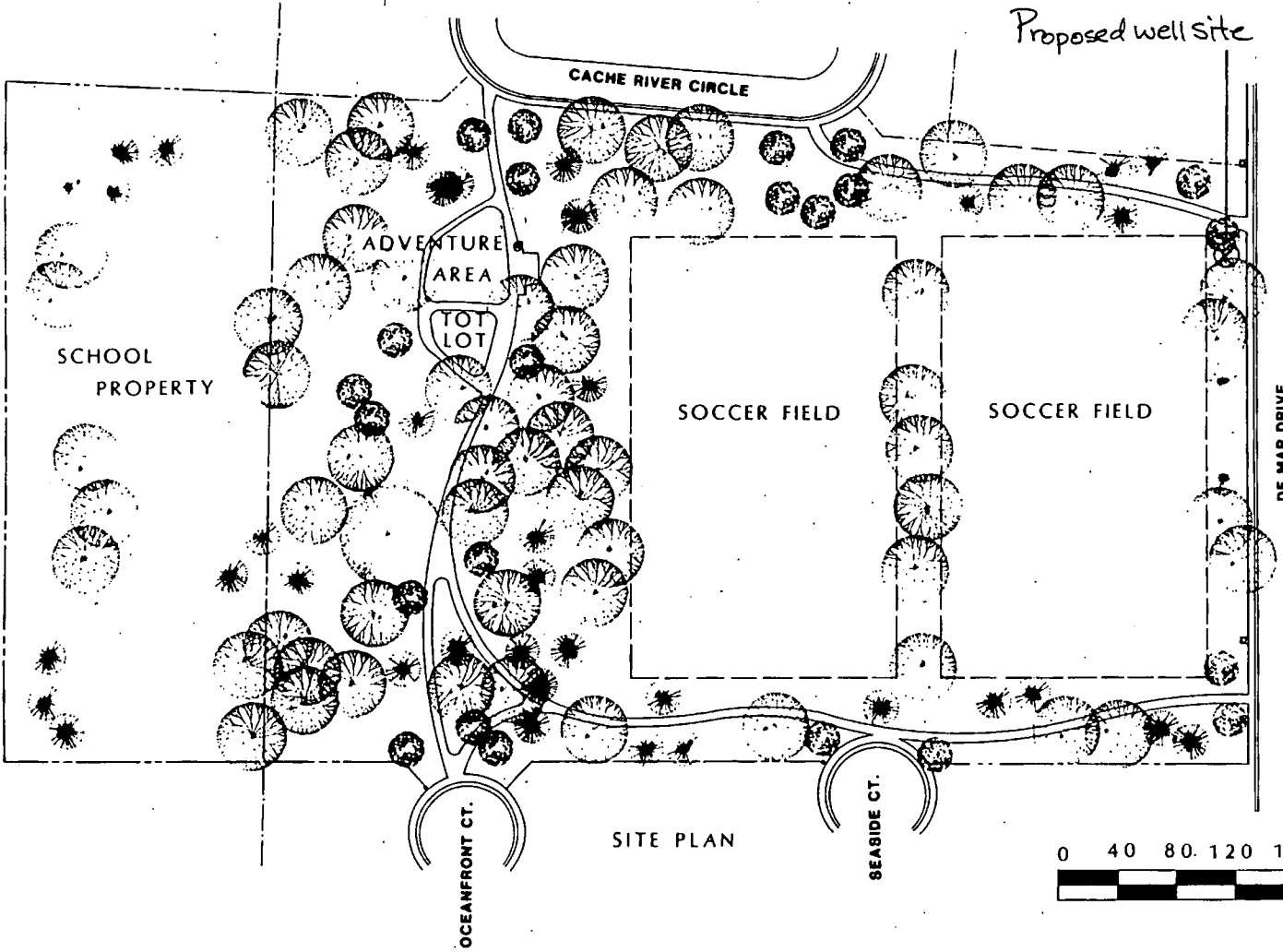

LEGEND

- ⊙ DRINKING FOUNTAIN
- STREET LIGHT

DEVELOPED ACREAGE

CITY	6.727
SCHOOL	1.942
TOTAL	8.669

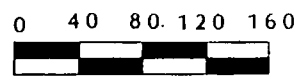

REVISIONS

NO.	DESCRIPTION	DATE	BY

DRAWN BY _____
DESIGNED BY _____
LANDSCAPE ARCHITECT _____
DATE _____
FIELD BOOK _____ SCALE _____

CITY OF SACRAMENTO
DEPARTMENT OF COMMUNITY SERVICES



RENFREE PARK (6.7 AC.)

SHEET _____
of _____ SHEETS

15

JOHN F. KENNEDY SCHOOL

SEE SHEET 2 OF 4 FOR CONTINUATION

BEAR FLAG SCHOOL

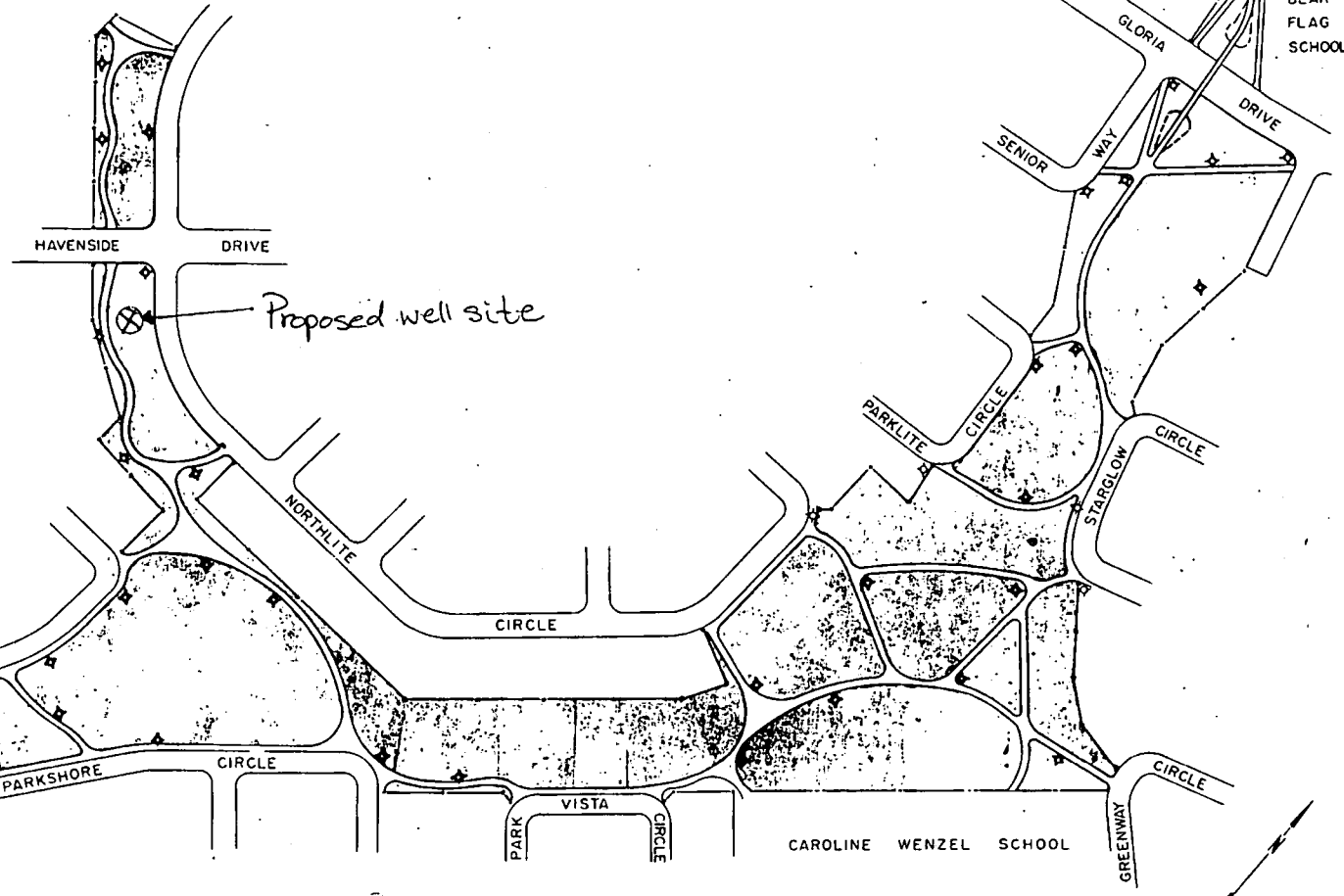
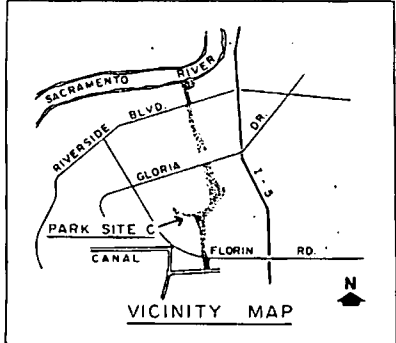

SEE SHEET 4 OF 4 FOR CONTINUATION

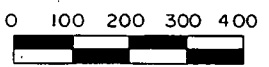

16

NO.	DESCRIPTION	DATE BY

DRAWN BY J. MAHANEY
 DESIGNED BY _____
 LANDSCAPE ARCHITECT
 DATE 1-02
 FIELD BOOK _____ SCALE _____

CITY OF SACRAMENTO
 DEPARTMENT OF COMMUNITY SERVICES



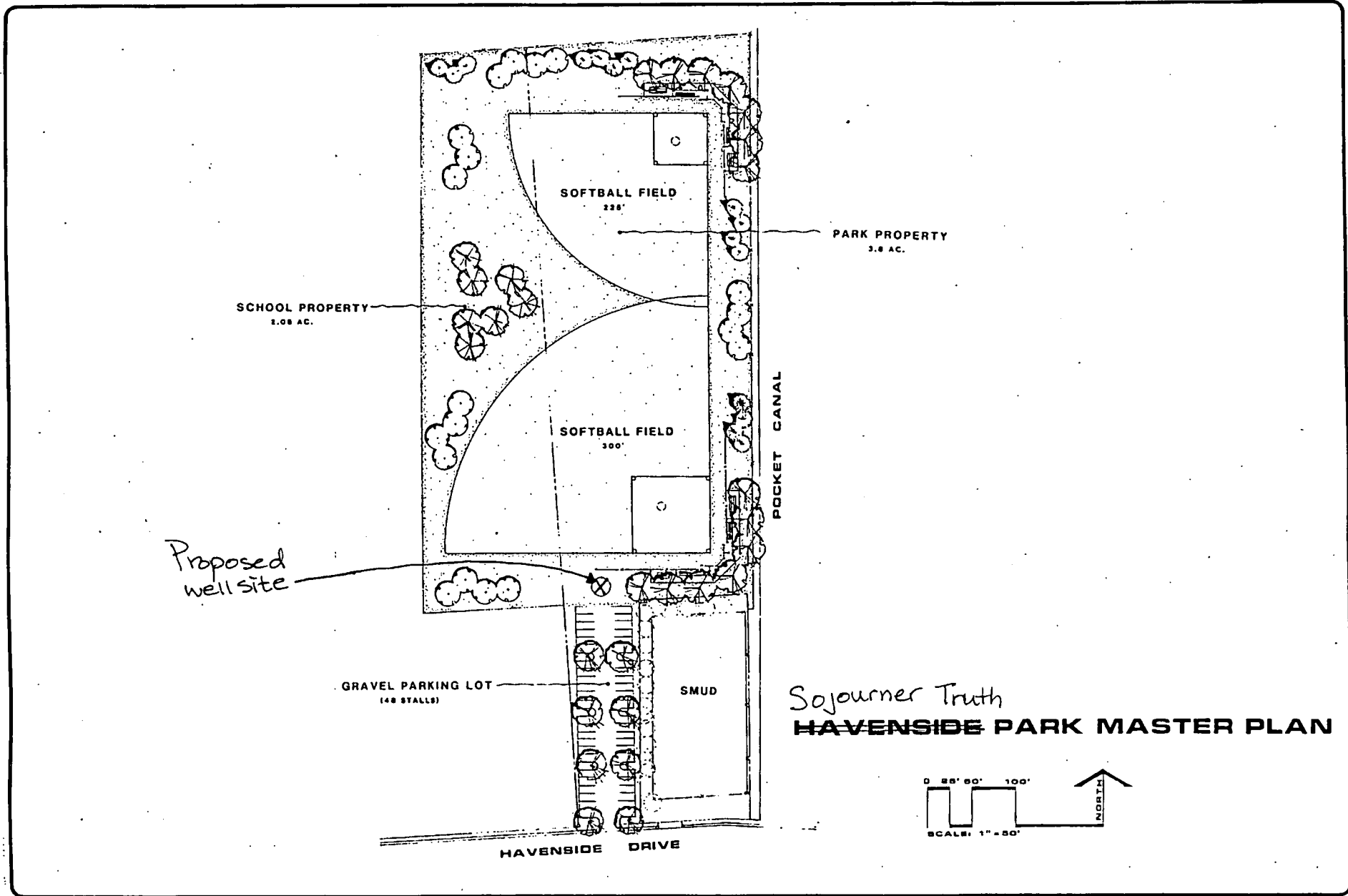

SEYMOUR PARK SECTION C (24.93 AC.)

SHEET 3
4 SHEETS

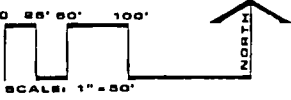

Sojourner Truth
HAVENSIDE PARK MASTER PLAN



 CITY OF SACRAMENTO
 DEPARTMENT OF PARKS & COMMUNITY SERVICES
 1211 I STREET, SUITE 400
 SACRAMENTO, CALIFORNIA 95811

LANDSCAPE ARCHITECT
 DW: BY/DON: BY
 CAD FILE
 DATE: _____
 SCALE: _____
 P.N. _____
 REVISIONS _____

SHEET NO.
 0

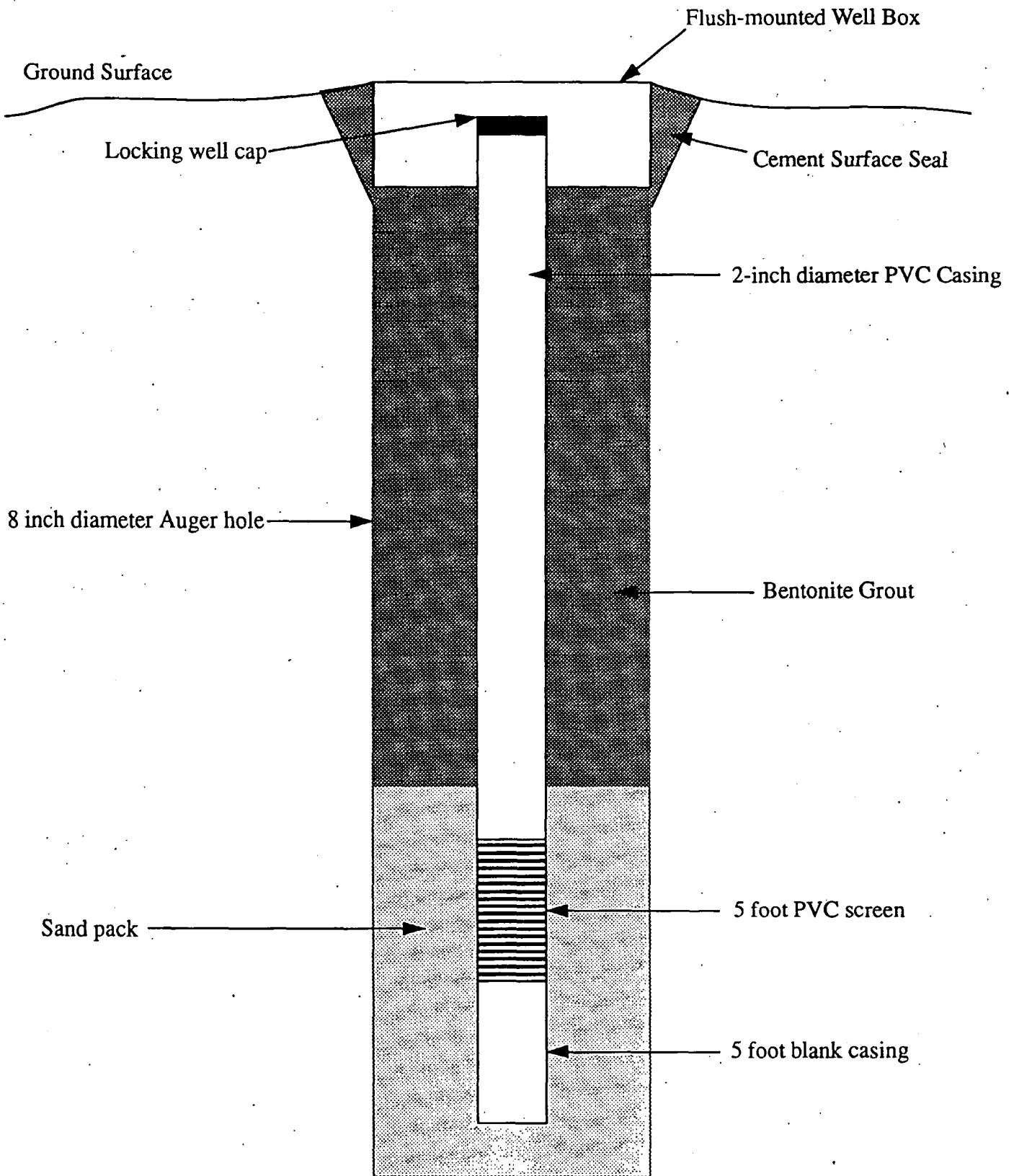

PROPOSED WELL CONSTRUCTION FOR URBAN LAND-USE STUDY