

USE BLACK INK BALL POINT PEN — PRESS FIRMLY
SIGN PERMIT APPLICATION

CONSTRUCTION LENDING AGENCY

I hereby affirm under penalty of perjury that these are a construction lending agency for the performance of the work for which this permit is issued (See Section 70040).

Contractor Name: _____
Address: _____
LICENSED CONTRACTORS DECLARATION

I hereby affirm under penalty of perjury that I am licensed under provisions of Chapter 9 commencing with Section 70000 of Division 3 of the Business and Professions Code and my license is in full force and effect.

License Class: 0-46 Lic. Number: 743218
Date: 6-5-00 Contractor: X Vernon Staunman (Signature)

OWNER - BUILDER DECLARATION

I hereby affirm under penalty of perjury that I am exempt from the Contractors License Law for the following reason (Sec. 70314.5, Business and Professions Code): Any city or county which requires a permit to construct, alter, improve, demolish, or repair any structure prior to its issuance, also requires the applicant for such permit to file a signed statement that he or she is licensed pursuant to the provisions of the Contractors License Law. Chapter 9 commencing with Section 70000 of Division 3 of the Business and Professions Code of that he or she is exempt therefrom and the basis for the signed statement.

Any violation of Section 70314.5 by any applicant for a permit subjects the applicant to a civil penalty of not more than five hundred dollars (\$500.00).

SITE ADDRESS

1502 W. EL COMIN.

SUITE

INSP. AREA

ASSESSOR PARCEL NO: 274-0068-035

LICENSED CONTRACTOR: VERNON STANMAN

BUSINESS OWNER: _____

PERMIT NO. 0006832

ADDRESS: 1180 MARKET ST YUBA CITY

SIGN INFORMATION

ATTACHED INTERIOR / ELECT SINGLE FACED
 ILLUMINATED NON-ILLUMINATED BILLBOARD / SUBDIVISION
 INDIVIDUAL LETTERS PAINTED ON BUILDING LOGO
 METAL POLE DOUBLE FACED
 PLASTIC MOUNTMENT VINYL/GATOR FOAM
 WOODEN PROJECTING RE-FACE

(A) HEIGHT: 18" (B) LENGTH: 10'-3"
(A X B) SIGN AREA: _____ FOOTING SIZE: _____
POLE SIZE: _____
STREET FRONTAGE (FT): _____
OCCUPANCY FRONTAGE (FT): 15'

CITY OF SACRAMENTO
BUILDING INSPECTION DIVISION
WORKERS COMPENSATION DECLARATION

I hereby affirm under penalty of perjury that the following declaration is true, correct and complete as stated: My workers compensation insurance carrier shall provide workers compensation benefits for the employees of the permittee as provided for by Section 5700 of the Labor Code.

State Fund
S63236-89

Signature: X Vernon Staunman

APPLICANT: _____

ZIP CODE: 95691 PHONE NO: 530 755-9892

OFFICE USE ONLY

ENGINEERING REQUIRED: YES NO APPROVED BY: _____
DESIGN REVIEW REQUIRED: YES NO APPROVED BY: _____
SPECIAL PERMIT REQUIRED: YES NO APPROVED BY: _____
VARIANCE REQUIRED: YES NO APPROVED BY: _____
EXC. AID. IN REQ.: YES NO WHICH REQ'D: _____

DATE OF SIGN: 6-10-00

SIGNATURE: Allen Cabaret

PERSONNEL

BUILDING INSPECTOR: DP DATE: 7-3-00

ELECTRICAL INSPECTOR: TKH DATE: 6-30-00

SIGN INSPECTOR: _____ DATE: _____

PERMIT NO. 0006832

ISSUE DATE: 6/8 FEE: \$75.00

TOTAL FEES \$

THIS PERMIT SHALL EXPIRE BY LIMITATION IF WORK AUTHORIZED IS NOT COMMENCED WITHIN 180 DAYS

6-5-00 X Vernon Staunman

10'-3"

INSURANCE

18"

HAIR

1502 W. El Camino

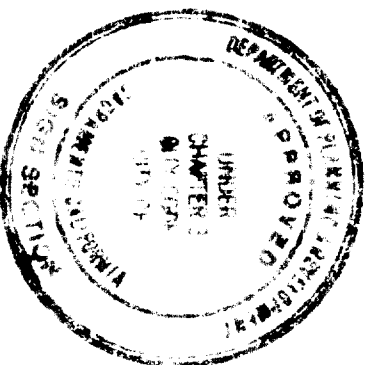
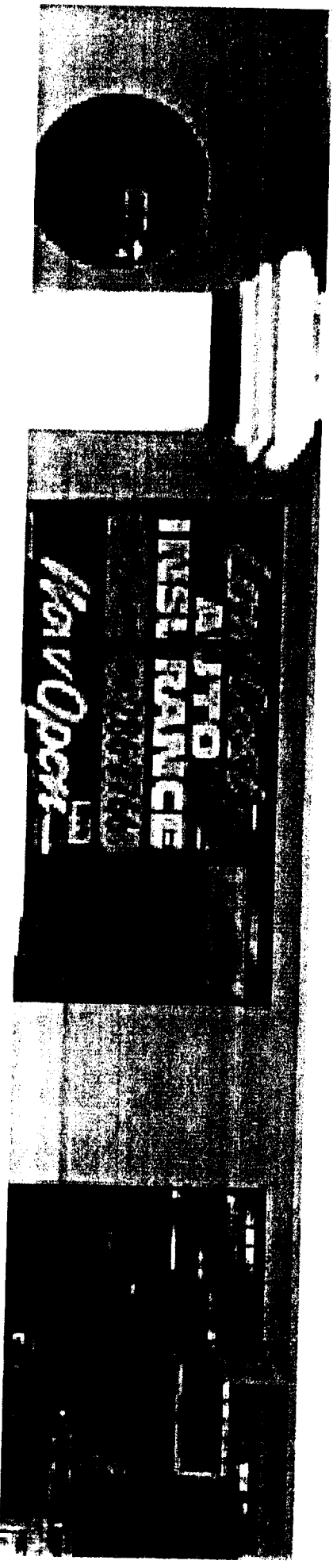

This set of plans and specifications must be kept on file at all times and it is unlawful to make any changes or alterations from the same without written permission from the City or the Public Sign Section.

The approval of this plan and specification shall not be held to permit or approve the violation of any City Ordinance or State Law.

All electrical work must be UL labeled or be of equivalent standards, A.F.C. Sec. 90.67 and comply with chapter 14, Division 10 of the Los Angeles City Code.

NO EQUIPMENT MUST BE USED AS DESIGN INTENDED
ALL SIGN INSTALLATIONS ARE SUBJECT TO FIELD INSPECTIONS

S212226

NEON ILLUMINATED PAN CHANNEL LETTERS

RETURNS: 5" Deep, .040 Aluminum Bronze
TRIM CAP COLOR: 3/4" White
LETTER FACES: 3/16", #21111
ILLUMINATION: 30 M.A. Neon transformer
NEON: 15mm, 3" on center, clear red
RACEWAY TYPE: Transformer Cans
RACEWAY COLOR: N/A
RACEWAY SIZE: 8" high by 8" deep by 16" wide
FASCIA TYPE: Stucco
STORE FRONTAGE: 15'
MAX. SIGN LENGTH ALLOWED: 10.5'
ACTUAL SIGN LENGTH: 10.5'
MAX. LETTER HEIGHT ALLOWED: 22"
MIN. LETTER HEIGHT ALLOWED: 18"
ACTUAL LETTER HEIGHT: 18"
OVERALL HEIGHT OF SIGN: 18"
BUILDING HEIGHT FROM ROOF TO GRADE: N/A
MAX. SQUARE FOOTAGE ALLOWED: 19.25 SQ. FT.
ACTUAL SQUARE FOOTAGE: 16.5 Sq. Ft.
LETTER STYLE: Swiss
NOTE: N/A

ALL SIGNAGE TO BE UNDERWRITERS LABORATORY LISTED

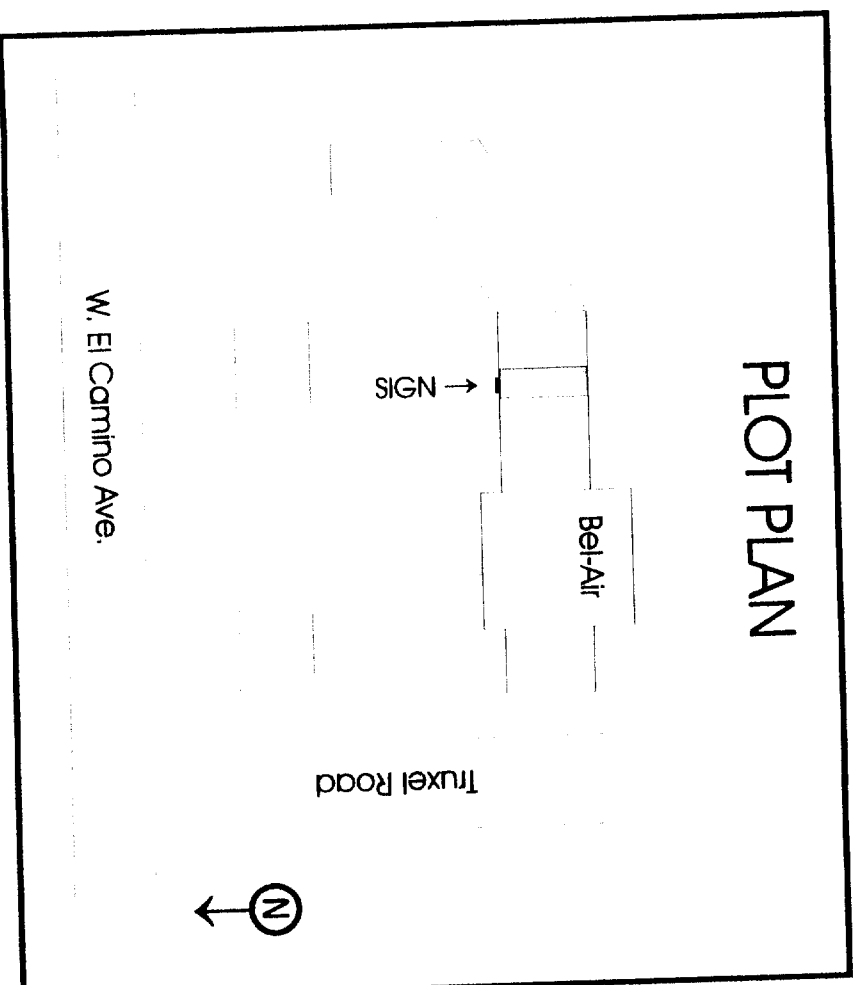

Listed sign section (consists of channel letter, electrode receptacle, plastic face and tube stands) suitable for outdoor location unless marked for indoor only.

Tube support per NEC 600-33(b).

Plastic face (optional)

Neon tube. Spacings maintained per spacing table.

Glass cup and conduit plug assembly. See dwg C3B for assembly instructions.

Letter height varies

Drain holes if used outdoors

Wall varies in thickness and material

Depth varies

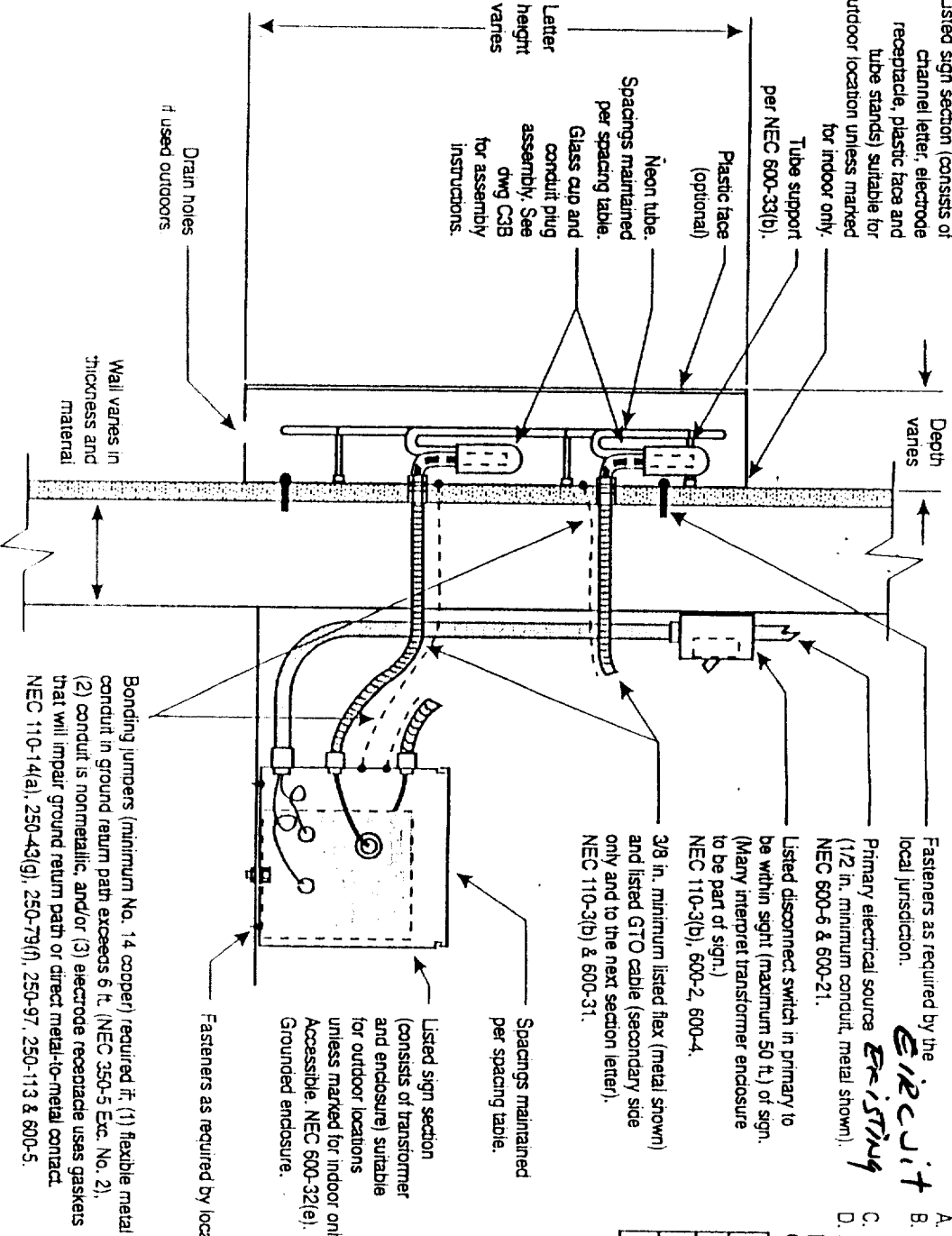

Fasteners as required by the local jurisdiction. **EXISTING**

Primary electrical source (1/2 in. minimum conduit, metal shown). NEC 600-6 & 600-21.

Listed disconnect switch in primary to be within sight (maximum 50 ft.) of sign. (Many interpret transformer enclosure to be part of sign.) NEC 110-3(b), 600-2, 600-4.

3/8 in. minimum listed flex (metal shown) and listed GTO cable (secondary side only and to the next section letter). NEC 110-3(b) & 600-31.

Spacings maintained per spacing table.

Listed sign section (consists of transformer and enclosure) suitable for outdoor locations unless marked for indoor only. Accessible. NEC 600-32(e). Grounded enclosure.

Fasteners as required by local jurisdiction.

Bonding jumpers (minimum No. 14 copper) required if: (1) flexible metal conduit in ground return path exceeds 6 ft. (NEC 350-5 Exc. No. 2), (2) conduit is nonmetallic, and/or (3) electrode receptacle uses gaskets that will impair ground return path or direct metal-to-metal contact. NEC 110-14(a), 250-43(g), 250-79(f), 250-97, 250-113 & 600-5.

All rights reserved. No part of this work covered by the copyright herein may be reproduced or used in any form or by any means - graphic, electronic, or mechanical, including photocopying, recording, taping, or information storage and retrieval systems - without written permission of the publisher, except that single copies of individual pages may be made by a bona fide electrical sign installation firm for the sole purpose of providing guidance on the installation of electrical signs or outline lighting, without the permission of the publisher.

LISTED

by qualified electrical testing laboratory

ELECTRIC SIGN SECTION

NO. XX-123456

of

Listing marks:
Listing mark sign section label shall be on each letter and transformer enclosure.
The first blank space identifies the number of each sign section. The second blank space indicates the total number of sign sections.

SPACING TABLE

- A. Between primary wiring and insulated high voltage wiring.
B. Between insulated high voltage wiring and dead metal where wiring parallels dead metal for more than 1" within sign sections.
C. Between neon tube (if over 7500 volt circuit) and nearest surface.
D. Between uninsulated high voltage conductors or components. (Mid-point-grounded transformer) and dead metal (ground), low voltage circuit conductors and high voltage conductors of opposite polarity.

Voltage	A	B	C	D
1001 to 5000	1/2 inch	1/2 inch	none	3/4 in
5001 to 10000	3/4 inch	3/4 inch	1/4 inch if	1-1/8 in
10001 to 15000	1 inch	1 inch	7500V+	1-1/2 in

6-20-00
The approval of all Electrical Work is subject to field inspections.

Installation of signs listed per UL48
Note: Installation requirements only.
Manufacturing requirements contained in UL48.

**ILLUMINATED CHANNEL LETTER
GLASS CUP AND CONDUIT PLUG ASSEMBLY**

Date: October 1994

Scale None IAEI Dwg. No. UL48-T1C