

CITY OF SACRAMENTO  
1231 I Street, Sacramento, CA 95814

Permit No: 0012361

Insp Area: 4

Site Address: 1501 MAYFIELD ST SAC  
Parcel No: 225-1120-008 NORTHPT 14 LOT 8

Sub-Type: NSFR  
Housing (Y/N): N

CONTRACTOR  
LENNAR RENAISSANCE INC.  
2240 DOUGLAS BL  
ROSEVILLE CA. 95661

OWNER

ARCHITECT

Nature of Work: NSFR MP202 1 STORY 9 RMS

**CONSTRUCTION LENDING AGENCY :** I hereby affirm under penalty of perjury that there is a construction lending agency for the performance of the work for which this permit is issued (Sec. 3097, Civ. C).

Lender's Name \_\_\_\_\_ Lender's Address \_\_\_\_\_

**LICENSED CONTRACTORS DECLARATION:** I hereby affirm under penalty of perjury that I am licensed under provisions of Chapter 9 (commencing with section 7000) of Division 3 of the Business and Professions Code and my license is in full force and effect.

License Class A License Number 732349 Date 2/28/01 Contractor Signature [Signature]

**OWNER-BUILDER DECLARATION:** I hereby affirm under penalty of perjury that I am exempt from the contractors License Law for the following reason (Sec. 7031.5, Business and Professions Code: any city or county which requires a permit to construct, alter, improve, demolish, or repair any structure, prior to its issuance, also requires the applicant for such permit to file a signed statement that he or she is licensed pursuant to the provisions of the Contractors License Law (Chapter 9 (commencing with Section 7000) of Division 8 of the Business and Professions Code) or that he or she is exempt therefrom and the basis for the alleged exemption. Any violation of Section 7031.5 by any applicant for a permit subjects the applicant to a civil penalty of not more than five hundred dollars (\$500.00):

\_\_\_\_\_, I, as a owner of the property, or my employees with wages as their sole compensation, will do the work, and the structure is not intended or offered for sale (Sec. 7044, Business and Professional Code: The Contractors License Law does not apply to an owner of property who builds or improves thereon, and who does such work himself or herself or through his/her own employees, provided that such improvements are not intended or offered for sale. If, however, the building or improvement is sold within one year of completion, the owner-builder will have the burden of proving that he/she did not build or improve for the purpose of sale.)

\_\_\_\_\_, I, as owner of the property, am exclusively contracting with licensed contractors to construct the project (Sec. 7044, Business and Professions Code: The Contractors License Law does not apply to an owner of property who builds or improves thereon and who contracts for such projects with a contractor(s) licensed pursuant to the Contractors License Law).

I am exempt under Sec. \_\_\_\_\_ B & PC for this reason: \_\_\_\_\_

Date \_\_\_\_\_ Owner Signature \_\_\_\_\_

**IN ISSUING THIS BUILDING PERMIT,** the applicant represents, and the city relies on the representation of the applicant, that the applicant verified all measurements and locations shown on the application or accompanying drawings and that the improvement to be constructed does not violate any law or private agreement relating to permissible or prohibited locations for such improvements. This building permit does not authorize any illegal location of any improvement or the violation of any private agreement relating to location of improvements.

I certify that I have read this application and state that all information is correct. I agree to comply with all city and county ordinances and state laws relating to building construction and hereby authorize representative(s) of this city to enter upon the abovementioned property for inspection purposes.

Date 11-2-00 Applicant/Agent Signature [Signature]

**WORKER'S COMPENSATION DECLARATION:** I hereby affirm under penalty of perjury one of the following declarations:

\_\_\_\_\_, I have and will maintain a certificate of consent to self-insure for workers' compensation as provided for by Section 3700 of the Labor Code, for the performance of work for which the permit is issued.

\_\_\_\_\_, I have and will maintain workers' compensation insurance, as required by Section 3700 of the Labor Code, for the performance of the work for which this permit is issued. My workers' compensation insurance carrier and policy number are:

Carrier TRANSCONTINENTAL INSURANCE CO Policy Number WC166792277 Exp Date 6/1/2001

\_\_\_\_\_, (This section need not be completed if the permit is for \$100 or less) I certify that in the performance of the work for which this permit is issued, I shall not employ any person in any manner so as to become subject to the workers' compensation laws of California and agree that if I should become subject to the workers' compensation provisions of Section 3700 of the Labor Code, I shall forthwith comply with those provisions.

Date 11-2-00 Applicant Signature [Signature]

WARNING: FAILURE TO SECURE WORKER'S COMPENSATION COVERAGE IS UNLAWFUL AND SHALL SUBJECT AN EMPLOYER TO CRIMINAL PENALTIES AND CIVIL FINES UP TO ONE HUNDRED THOUSAND DOLLARS (\$100,000) IN ADDITION TO THE COST OF COMPENSATION, DAMAGES AS PROVIDED FOR IN SECTION 3706 OF THE LABOR CODE, INTEREST AND ATTORNEY'S FEE.

**THIS PERMIT SHALL EXPIRE BY LIMITATION IF WORK IS NOT COMMENCED WITHIN 180 DAYS.**

# RESIDENTIAL BUILDING PERMIT APPLICATION

New Construction    
  Addition    
  Remodels    
  Other

Project Address: 1501 MAYFIELD STREET     Assessor Parcel # 225-112-008  
LOT # 8

**OWNER INFORMATION:**

Legal Property Owner: LENNAR RENAISSANCE     Phone # (916) 773-7471  
 Owner Address: 2240 DOUGLAS BLVD.     City ROSEVILLE     State CA     Zip 95661

**CONTRACTOR INFORMATION:**

Contractor: LENNAR RENAISSANCE     Lic. # 732348     Phone # (916) 773-7471     Fax # (916) 773-4086

**PROJECT INFORMATION:**

Land Use Zone R/A     Occupancy Group R3     Construction Type UM     Fed Code 1A  
 No. of stories: ONE     No. of rooms: 4     Street width: \_\_\_\_\_  
 1<sup>st</sup> Floor Area 1803     2<sup>nd</sup> Floor Area \_\_\_\_\_     Basement \_\_\_\_\_     Roof Material TILE

AREA IN SQUARE FOOT OF:	EXISTING	NEW
Dwelling/Living	_____	<u>1803</u>
Garage/Storage	_____	<u>496</u>
Decks/Balconies	_____	<u>150</u>
Carports	_____	_____

SCOPE OF WORK: NEW CONSTRUCTION SFD

**FOR OFFICE USE ONLY:**

- |   |   |  |
|---|---|--|
| <input type="checkbox"/> Information above complete | <input type="checkbox"/> AR Flood Waiver required             | <input type="checkbox"/> Planning Approval                   |
| <input type="checkbox"/> Violation files checked    | <input type="checkbox"/> Flood Elevation Certificate Required | <input type="checkbox"/> Design Review Approval              |
| <input type="checkbox"/> Standard setbacks          | <input type="checkbox"/> Water Development Infill Area        | <input type="checkbox"/> Special Fee Districts Apply : _____ |
| <input type="checkbox"/> County Sewer               |   |  |

**NEW STRUCTURES & ADDITIONS**

❖ THE FOLLOWING MUST BE PROVIDED IN ORDER TO SUBMIT FOR PLAN REVIEW

- |   |   |
|---|---|
| <input type="checkbox"/> 2 COMPLETE PLANS, LEGIBLE & DRAWN TO SCALE   | ❖ Plans to include: site plan, floor plan, elevations, roof/ceiling plan, foundation and structural framing details, and structural calculations for non-conforming structures. |
| <input type="checkbox"/> 3 SETS IF PROJECT IS IN A DESIGN REVIEW AREA |   |
| <input type="checkbox"/> Title 24 Energy Compliance documentation     | <input type="checkbox"/> 11" x 17" copy of floor plan for County Assessor   |
| <input type="checkbox"/> Grading and Erosion Control Questionnaire    | <input type="checkbox"/> Plan Review Fees   |

Date: \_\_\_\_\_ Received by: (staff) \_\_\_\_\_

ACTIVITY/PERMIT # \_\_\_\_\_

This Plot Plan is for the purpose of showing the house to be constructed on the lot and may not represent the final as-built configuration of the property or improvements thereon. Setbacks, other than minimum ordinance, are approximate only and must not be assumed to be precise.

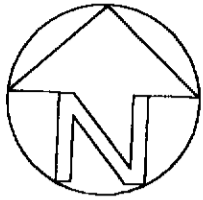

SCALE: 1" = 20'

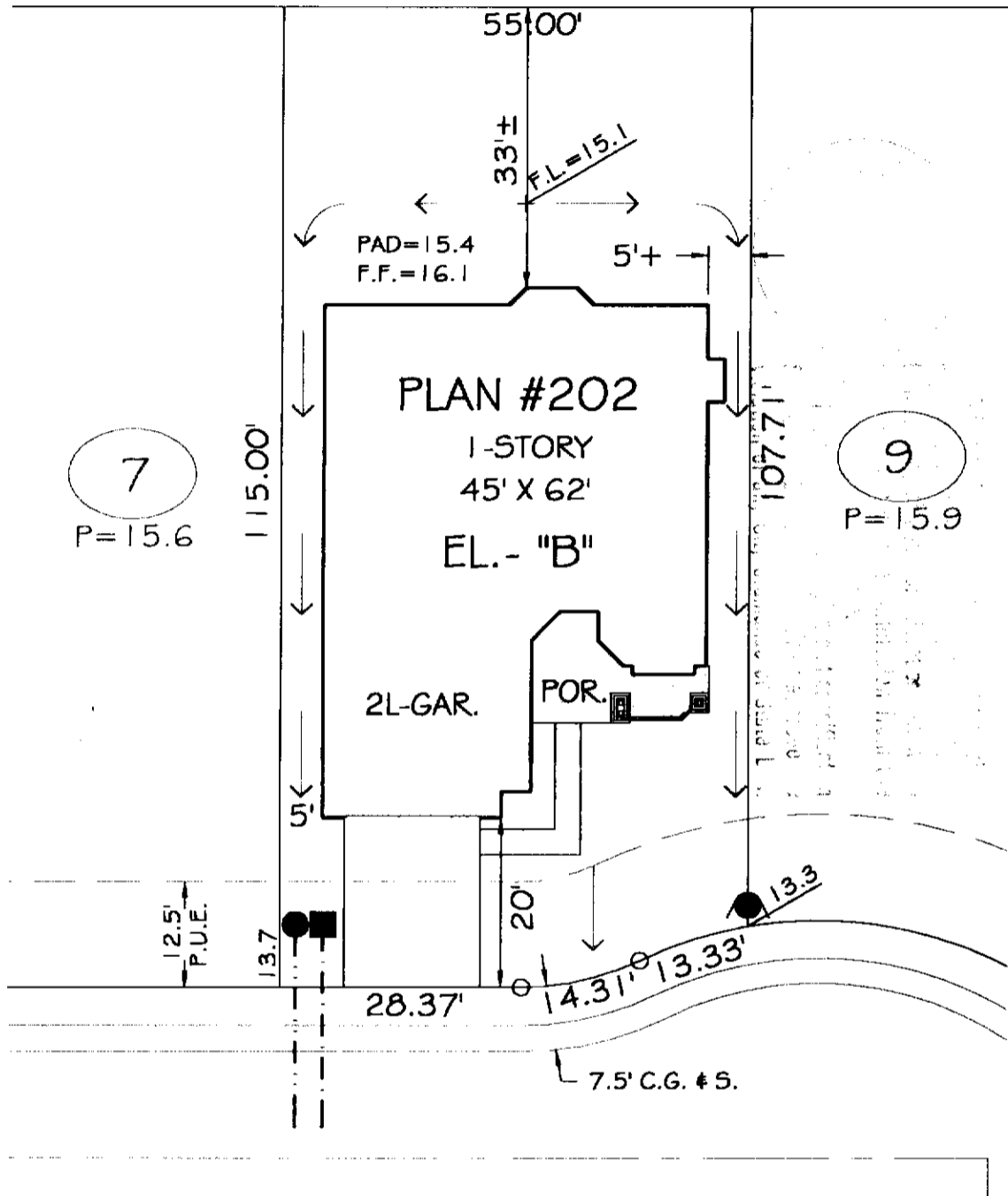

# 1501 MAYFIELD STREET

<p><b>LOT COVERAGE</b></p> <p>Lot Area: <u>6240</u> s.f.          Building: <u>2299</u> s.f.          Building/Lot Area: <u>37</u> %</p>	<p><b>RETAINING WALL</b></p> <p>Height: _____          Length: _____          Distance From P.L.: _____</p>	<p><b>SYMBOLS</b></p> <p>Drainage Inlet: </p> <p>Fire Hydrant: </p> <p>Street Light: </p> <p>Sewer: </p> <p>Sign: </p> <p>Water: </p> <p>Transformer Pad: </p>	<p><b>Winncrest Homes</b> A Lennar Company</p> <hr/> <p style="font-size: 1.5em; font-weight: bold;">Glenmere</p> <p>a Northpointe Park Village Community</p> <hr/> <p style="font-size: 1.2em; font-weight: bold;">Home Site #8</p> <p>@</p> <p>NORTHPOINTE PARK VILLAGE No. 14          CITY OF SACRAMENTO, CALIFORNIA          A.P.N.: 225-112-008-000</p>
<p><b>NOTES</b></p> <p>1. MEASUREMENTS ALONG CURVED LINES ARE ARC LENGTHS, U.O.N.</p>		<p>BCB    9/30/99    ARS</p> <p>DRAWN BY    DATE    CHK'D BY    DATE</p>	<p>1" = 20'</p> <p>DRWG SCALE</p>