

CITY OF SACRAMENTO

Permit No: 0115000

1231 I Street, Sacramento, CA 95814

Insp Area: 2

Site Address: 1240 KONDOS AV SAC

Thos Bros:

Parcel No: 006-0281-071

CAPITOL PARK HOMES LOT 64

Sub-Type: NSFR

Housing (Y/N): N

CONTRACTOR

OWNER

ARCHITECT

CNM CONSTRUCTION CO
818 19TH ST.
SACRAMENTO CA. 95814

Nature of Work: MP 1306 3 STORY 7 ROOM SFR

CONSTRUCTION LENDING AGENCY : I hereby affirm under penalty of perjury that there is a construction lending agency for the performance of the work for which this permit is issued (Sec. 3097, Civ. C).

Lender's Name

Lender's Address

LICENSED CONTRACTORS DECLARATION: I hereby affirm under penalty of perjury that I am licensed under provisions of Chapter 9 (commencing with section 7000) of Division 3 of the Business and Professions Code and my license is in full force and effect.

License Class B

License Number 767087

Date 11-26-01

Contractor Signature

OWNER-BUILDER DECLARATION: I hereby affirm under penalty of perjury that I am exempt from the contractors License Law for the following reason (Sec. 7031.5, Business and Professions Code; any city or county which requires a permit to construct, alter, improve, demolish, or repair any structure, prior to its issuance, also requires the applicant for such permit to file a signed statement that he or she is licensed pursuant to the provisions of the Contractors License Law (Chapter 9 (commencing with Section 7000) of Division 8 of the Business and Professions Code) or that he or she is exempt therefrom and the basis for the alleged exemption. Any violation of Section 7031.5 by any applicant for a permit subjects the applicant to a civil penalty of not more than five hundred dollars (\$500.00);

I, as a owner of the property, or my employees with wages as their sole compensation, will do the work, and the structure is not intended or offered for sale (Sec. 7044, Business and Professional Code: The Contractors License Law does not apply to an owner of property who builds or improves thereon, and who does such work himself or herself or through his/her own employees, provided that such improvements are not intended or offered for sale. If, however, the building or improvement is sold within one year of completion, the owner-builder will have the burden of proving that he/she did not build or improve for the purpose of sale.)

I, as owner of the property, am exclusively contracting with licensed contractors to construct the project (Sec. 7044, Business and Professions Code: The Contractors License Law does not apply to an owner of property who builds or improves thereon, and who contracts for such projects with a contractor(s) licensed pursuant to the Contractors License Law).

I am exempt under Sec. B & PC for this reason:

Date

11-26-01

Owner Signature

IN ISSUING THIS BUILDING PERMIT, the applicant represents, and the city relies on the representation of the applicant, that the applicant verified all measurements and locations shown on the application or accompanying drawings and that the improvement to be constructed does not violate any law or private agreement relating to permissible or prohibited locations for such improvements. This building permit does not authorize any illegal location of any improvement or the violation of any private agreement relating to location of improvements.

I certify that I have read this application and state that all information is correct. I agree to comply with all city and county ordinances and state laws relating to building construction and hereby authorize representative(s) of this city to enter upon the abovementioned property for inspection purposes.

Date

11-26-01

Applicant/Agent Signature

WORKER'S COMPENSATION DECLARATION: I hereby affirm under penalty of perjury one of the following declarations:

I have and will maintain a certificate of consent to self-insure for workers' compensation as provided for by Section 3700 of the Labor Code, for the performance of work for which the permit is issued.

I have and will maintain workers' compensation insurance, as required by Section 3700 of the Labor Code, for the performance of the work for which this permit is issued. My workers' compensation insurance carrier and policy number are:

Carrier STATE FUND

Policy Number 713-01 UNIT 0007764

Exp Date 10/01/2002

(This section need not be completed if the permit is for \$100 or less) I certify that in the performance of the work for which this permit is issued, I shall not employ any person in any manner so as to become subject to the workers' compensation laws of California and agree that I should become subject to the workers' compensation provisions of Section 3700 of the Labor Code. I shall forthwith comply with these provisions.

Date

11-26-01

Applicant Signature

WARNING: FAILURE TO SECURE WORKER'S COMPENSATION COVERAGE IS UNLAWFUL AND SHALL SUBJECT AN EMPLOYER TO CRIMINAL PENALTIES AND CIVIL FINES UP TO ONE HUNDRED THOUSAND DOLLARS (\$100,000) IN ADDITION TO THE COST OF COMPENSATION, DAMAGES AS PROVIDED FOR IN SECTION 3706 OF THE LABOR CODE, INTEREST AND ATTORNEY'S FEE.

THIS PERMIT SHALL EXPIRE BY LIMITATION IF WORK IS NOT COMMENCED WITHIN 180 DAYS.

RESIDENTIAL SUBDIVISION BUILDING PERMIT APPLICATION

Project Address: 1240 Kondos

Assessor Parcel # 006-281-071

Lot Number: 64C

Subdivision CAPITOL PARK HOMES

OWNER INFORMATION:

Legal Property Owner: SHASTA/DOWNTOWN SINGLE FAM Phone# 449-8989
 Owner Address: 818 19th ST City SACRAMENTO State CA Zip 95814

CONTRACTOR INFORMATION:

Contractor: CNM CONST. Lic. # 767087 Phone # 449-8989 Fax 449-8865

PROJECT INFORMATION:

Land Use Zone RIA Occupancy Group R3 Construction Type VN Fed Code 1A

No. of Stories: 2 No. of Rooms: 5 Street Width: 20

1st Floor Area 900 2nd Floor Area 406 Basement - Roof Material COMP

AREA IN SQUARE FOOT OF:

Dwelling/Living 1306

Garage/Storage 561 / -

Decks/Balconies 60

Carports -

SCOPE OF WORK: NEW SINGLE FAMILY RESIDENCE

FOR OFFICE USE ONLY

- | | | |
|---|---|---|
| <input type="checkbox"/> Information Above Complete | <input type="checkbox"/> AR Flood Waiver Required | <input type="checkbox"/> Planning Approval |
| <input type="checkbox"/> Violation Files Checked | <input type="checkbox"/> Flood Elevation Certificate Required | <input type="checkbox"/> Design Review Approval |
| <input type="checkbox"/> Standard Setbacks | <input type="checkbox"/> Water Development Infill Area | <input type="checkbox"/> Special Fee Districts Apply: |
| <input type="checkbox"/> County Sewer | | |

→ THE FOLLOWING MUST BE PROVIDED IN ORDER TO SUBMIT FOR PERMIT →

- 2 COMPLETE PLOT PLANS, LEGIBLE & DRAWN TO SCALE
- 11 X 17 COPY OF FLOOR PLAN WITH FOLLOWING INFORMATION

a) Assessors Parcel Number	c) Owners Name
b) New Floor Area	d) Project Address

Date: _____ Received by: (staff) _____ Permit # _____

CERTIFICATION OF INSULATION

<p>ADDRESS ON TRACT</p> <p>CNM 1240 Kondas CAPITOL PARK HOMES</p>	<p>SACRAMENTO BUILDING PRODUCTS</p> <p><input checked="" type="checkbox"/> P.O. BOX 854, WEST SACRAMENTO, CA 95691 LIC. #202026 <input type="checkbox"/> 1309 MELODY ROAD, MARYSVILLE, CA 95901 LIC. #202026 <input type="checkbox"/> P.O. BOX 9651, FRESNO, CA 93793-9651 LIC. #202026 <input type="checkbox"/> P.O. BOX 1631, RENO, NV 89505 LIC. #10675 <input type="checkbox"/> 3326 A PONDEROSA WAY, LAS VEGAS, NV 89118 LIC. #10675</p> <p>LOT # 64C</p> <p>DATE INSULATION COMPLETED 8-8-02</p>
--	--

WALLS			CEILING			FLOORS		
(SQUARE FEET)			(SQUARE FEET)			(SQUARE FEET)		
TYPE OF INSULATION			TYPE OF INSULATION			TYPE OF INSULATION		
MATERIAL FIBERGLASS			MATERIAL FIBERGLASS			MATERIAL FIBERGLASS		
FORM BATTS			FORM BATTS & BLOW			FORM BATTS		
MANUFACTURER'S PRODUCT I.D.			MANUFACTURER'S PRODUCT I.D.			MANUFACTURER'S PRODUCT I.D.		
MANUFACTURER			MANUFACTURER			MANUFACTURER		
CT	OC	JM	CT	OC	JM	CT	OC	JM
BAGS								
R-VALUE INSTALLED	APPLIED THICKNESS	R-VALUE INSTALLED	APPLIED THICKNESS	MIN. INSTALLED WEIGHT PER	R-VALUE INSTALLED	APPLIED THICKNESS	R-VALUE INSTALLED	APPLIED THICKNESS
13	3 1/2"	30	9"					

KNEE WALLS IF R-VALUE IS OTHER THAN WALLS ABOVE

MATERIAL FIBERGLASS	FORM BATTS	R VALUE	MANUFACTURER		
			CT	OC	JM

AIR INFILTRATION SEALANT

MATERIAL FOAM	MANUFACTURER	
	HILTI	HANDY FOAM

THIS IS TO CERTIFY THAT INSULATION AND SEALANT HAS BEEN INSTALLED IN ACCORDANCE WITH APPLICABLE CODES, MATERIAL STANDARDS AND REGULATIONS.

SIGNATURE — INSULATION CONTRACTOR <i>[Signature]</i>	TITLE MANAGER	DATE 8-9-02
SIGNATURE — GENERAL CONTRACTOR <i>[Signature]</i>	TITLE	DATE

REMARKS

PART I GENERAL PART II AREAS INSULATED PART III CERTIFICATION

Certification of Compliance
School District Development

Part I—To be completed by the APPLICANT

Owner's Name/Address Wanda Lynn Smith Dev., 815 19th St. Suite 101
Project Address 1240 Kondos
Parcel Number 600-281-171 Lot No. 64
Subdivision Name WINDMILL HILLS HOMES No. of Units 69
Applicant's Signature [Signature] Title Project Mgr.
Phone No. (714) 491-5107 Date 11-6-01

Notice to Applicant: Pursuant to Government Code Section 66020(d), this will serve to notify you that the 90-day approval period in which you may protest the fees or other payment identified above will begin to run on the date in which the building or installation permit for this project is issued or on which they are paid to the district(s) or to another public entity authorized to collect them on behalf of the district(s), whichever is earlier.

Part II—To be completed by the BUILDING DEPARTMENT

Plan Identification Number AP 1306
Building Type (check one) Residential Apartment/Condominium Commercial/Industrial
Square Feet of Chargeable Building Area 1306
Signature/Title [Signature] Date 11-23-01

Part III—To be completed by the SCHOOL DISTRICT

School District 340 Certificate No. 1
 Exempt Comments _____
Residential/Apartment/etc. _____ Square ft. x \$ _____ = \$ _____
Commercial/Industrial _____ Square ft. x \$ _____ = \$ _____
Total fees collected..... = \$ 452.22

This certification covers only the amount of square footage indicated above. Any additions or corrections to the square footage for this project will require an amendment to the Certificate of Compliance.

As the authorized school official, I hereby certify that the requirements of Government Code Section 65995 and any other authorized requirements have been complied with by the above signed applicant.

Signature _____ Date 11/26/01



KONDOS

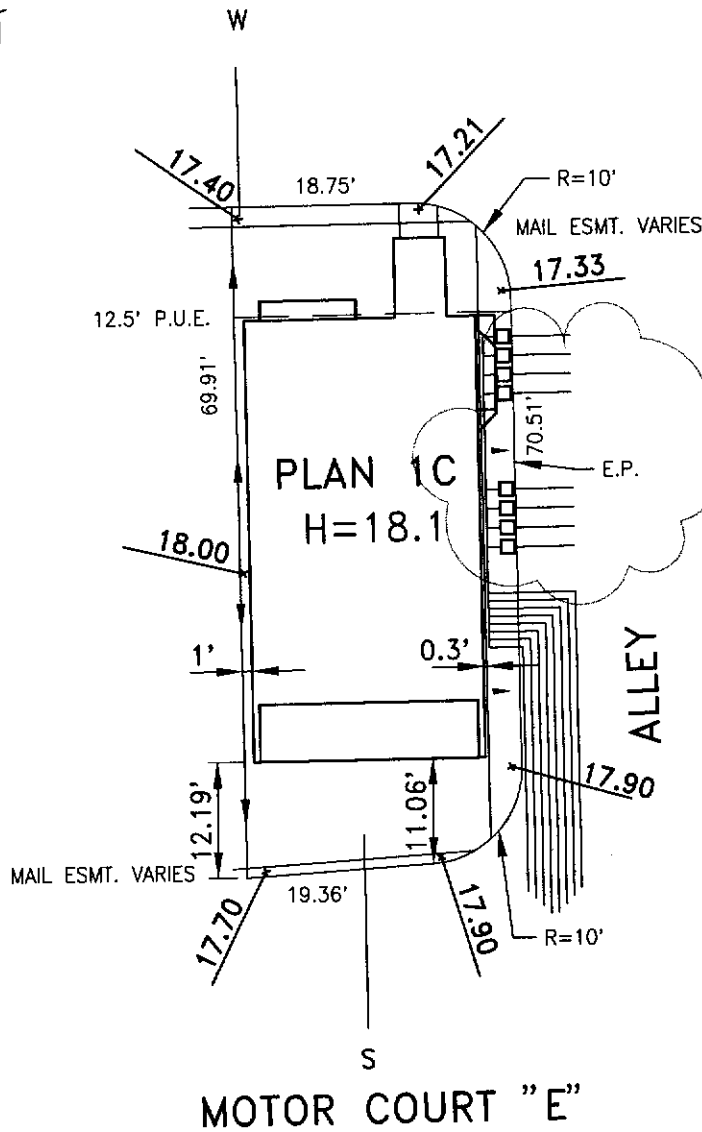

SCALE: 1"=20'

This set of plans is prepared for the use of the City of Sacramento, California. It is not to be used for any other project without the written consent of the City Engineer.

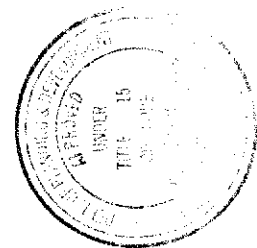

NOTE:

This plan is only intended to reference the building plan designated for this lot. All setbacks other than minimum code requirements are approximate. The "as-built" field condition may vary from this plan.

DATE: 10-22-01
A.P.N.: 006-2810-071
ADDRESS: 1240 KONDOS

LOT AREA: 1946
LOT COVERAGE: 50%



Stantec

Stantec Consulting Inc.
 2590 Venture Oaks Way
 Sacramento, CA 95833-3288
 Tel. 916.925.5550
 Fax. 916.921.9274
 www.stantec.com

CAPITOL PARK
 LOT 64
 PLAN 1C

Client/Project
 CNM CONSTRUCTION

Figure No.
1.0

Title
CAPITOL PARK
City of Sacramento, CA

October 24, 2001
 84400121