

CITY OF SACRAMENTO
1231 I Street, Sacramento, CA 95814

Permit No: 0100172

Insp Area: 2

Site Address: 8401 SERIO WY SAC

Parcel No: 117-1370-025

JACINTO N 2 LOT 25

Sub-Type: NSFR

Housing (Y/N): N

CONTRACTOR

BEAZER HOMES
3009 DOUGLAS BL #150
ROSEVILLE CA 95661

OWNER

ARCHITECT

Nature of Work: NSFR MP1441 7 RMS

CONSTRUCTION LENDING AGENCY: I hereby affirm under penalty of perjury that there is a construction lending agency for the performance of the work for which this permit is issued (Sec. 3097, Civ. C).

Lender's Name _____

Lender's Address _____

LICENSED CONTRACTORS DECLARATION: I hereby affirm under penalty of perjury that I am licensed under provisions of Chapter 9 (commencing with section 7000) of Division 3 of the Business and Professions Code and my license is in full force and effect.

License Class B

License Number 724191

Date 1/29/01

Contractor Signature

Sheryl Van Maeren

OWNER-BUILDER DECLARATION: I hereby affirm under penalty of perjury that I am exempt from the contractors License Law for the following reason (Sec. 7031.5, Business and Professions Code): any city or county which requires a permit to construct, alter, improve, demolish, or repair any structure, prior to its issuance, also requires the applicant for such permit to file a signed statement that he or she is licensed pursuant to the provisions of the Contractors License Law (Chapter 9 (commencing with Section 7000) of Division 8 of the Business and Professions Code) or that he or she is exempt therefrom and the basis for the alleged exemption. Any violation of Section 7031.5 by any applicant for a permit subjects the applicant to a civil penalty of not more than five hundred dollars (\$500.00).

I, as a owner of the property, or my employees with wages as their sole compensation, will do the work, and the structure is not intended or offered for sale (Sec. 7044, Business and Professional Code: The Contractors License Law does not apply to an owner of property who builds or improves thereon, and who does such work himself or herself or through his/her own employees, provided that such improvements are not intended or offered for sale. If, however, the building or improvement is sold within one year of completion, the owner-builder will have the burden of proving that he/she did not build or improve for the purpose of sale.)

I, as owner of the property, am exclusively contracting with licensed contractors to construct the project (Sec. 7044, Business and Professions Code. The Contractors License Law does not apply to an owner of property who builds or improves thereon, and who contracts for such projects with a contractor(s) licensed pursuant to the Contractors License Law.)

I am exempt under Sec. _____ B & PC for this reason: _____

Date _____

Owner Signature _____

IN ISSUING THIS BUILDING PERMIT, the applicant represents, and the city relies on the representation of the applicant, that the applicant verified all measurements and locations shown on the application or accompanying drawings and that the improvement to be constructed does not violate any law or private agreement relating to permissible or prohibited locations for such improvements. This building permit does not authorize any illegal location of any improvement or the violation of any private agreement relating to location of improvements.

I certify that I have read this application and state that all information is correct. I agree to comply with all city and county ordinances and state laws relating to building construction and hereby authorize representative(s) of this city to enter upon the above mentioned property for inspection purposes.

Date 1/29/01

Applicant/Agent Signature

Sheryl Van Maeren

WORKER'S COMPENSATION DECLARATION: I hereby affirm under penalty of perjury one of the following declarations:

I have and will maintain a certificate of consent to self-insure for workers' compensation as provided for by Section 3700 of the Labor Code, for the performance of work for which the permit is issued

I have and will maintain workers' compensation insurance, as required by Section 3700 of the Labor Code, for the performance of the work for which this permit is issued. My workers' compensation insurance carrier and policy number are:

Carrier LIBERTY MUTUAL INS CO

Policy Number WA2-651-004147-080

Exp Date 04/01/2001

(This section need not be completed if the person certifies that in the performance of the work for which this permit is issued, I shall not employ any person in any manner so as to be subject to the workers' compensation laws of California and agree that if I should become subject to the workers' compensation provisions of Section 3700 of the Labor Code, I shall forthwith comply with those provisions.

Date 1/29/01

Applicant Signature

Sheryl Van Maeren

WARNING: FAILURE TO SECURE WORKER'S COMPENSATION COVERAGE IS UNLAWFUL AND SHALL SUBJECT AN EMPLOYER TO CRIMINAL PENALTIES AND CIVIL FINES UP TO ONE HUNDRED THOUSAND DOLLARS (\$100,000) IN ADDITION TO THE COST OF COMPENSATION, DAMAGES AS PROVIDED FOR IN SECTION 3706 OF THE LABOR CODE, INTEREST AND ATTORNEY'S FEE.

THIS PERMIT SHALL EXPIRE BY LIMITATION IF WORK IS NOT COMMENCED WITHIN 180 DAYS.

RESIDENTIAL BUILDING PERMIT APPLICATION

New Construction
 Addition
 Remodels
 Other

Project Address: 914 SERRA WAY LOT 65
 Assessor Parcel # 117 1370 025

OWNER INFORMATION:

Legal Property Owner: Beazer Homes Holdings Corp. Phone # 916-773-3888
 Owner Address: 3009 Douglas Blvd. 150 City Roseville State CA Zip 95661

CONTRACTOR INFORMATION:

Contractor: Same as above Lic. # B724191 Phone # 773-3888 Fax # 773-0425

PROJECT INFORMATION:

Land Use Zone _____ Occupancy Group _____ Construction Type _____ Fed Code _____
 No. of stories: _____ No. of rooms: _____ Street width: _____
 1st Floor Area 1441 2nd Floor Area _____ Basement _____ Roof Material _____

AREA IN SQUARE FOOT OF:	EXISTING	NEW
Dwelling/Living	_____	<u>1441</u>
Garage/Storage	_____	<u>439</u>
Decks/Balconies	_____	_____
Carports	_____	_____

SCOPE OF WORK: Single Family Homes

FOR OFFICE USE ONLY

- | | | |
|---|---|---|
| <input type="checkbox"/> Information above complete | <input type="checkbox"/> AR Flood Waiver required | <input type="checkbox"/> Planning Approval |
| <input type="checkbox"/> Violation files checked | <input type="checkbox"/> Flood Elevation Certificate Required | <input type="checkbox"/> Design Review Approval |
| <input type="checkbox"/> Standard setbacks | <input type="checkbox"/> Water Development Infill Area | <input type="checkbox"/> Special Fee Districts Apply: _____ |
| <input type="checkbox"/> County Sewer | | |

NEW STRUCTURES & ADDITIONS

*THE FOLLOWING MUST BE PROVIDED IN ORDER TO SUBMIT FOR PLAN REVIEW

- | | |
|--|---|
| <input type="checkbox"/> 2 COMPLETE PLANS, LEGIBLE & DRAWN TO SCALE
<input type="checkbox"/> 3 SETS IF PROJECT IS IN A DESIGN REVIEW AREA | * Plans to include: site plan, floor plan, elevations, roof/ceiling plan, foundation and structural framing details, and structural calculations for non-conforming structures. |
| <input type="checkbox"/> Title 24 Energy Compliance documentation
<input type="checkbox"/> Grading and Erosion Control Questionnaire | <input type="checkbox"/> 11" x 17" copy of floor plan for County Assessor
<input type="checkbox"/> Plan Review Fees |

Date: _____

Received by: (staff) _____

ACTIVITY/PERMIT #

KWIKKOTE
STUCCO SYSTEM
INSTALLATION CARD

21 412

BEAZER HOMES

BELLEFLEUR # LOT 25

8401 SERIO WAY SACRAMENTO

Stucco System Trade Name: KWIK KOTE
Name Stucco Manufacturer: KWIK KOTE CORP
ICBO Evaluation Service, Inc. Report No. 3607
Date of Job Completion _____

Stucco Contractor Kenvon Plastering, Inc.
Name John W. Kenvon, III
Address P.O. Box 2077
North Highlands, CA 95660
Telephone # (916) 349-8191

Approved Contractor Number as issued by the Stucco Manufacturer: 1

This is to certify that the stucco system on the building exterior at the above address had been installed in accordance with the evaluation report specified above and the manufacturer's instructions.

Signature of authorized representative of stucco contractor:

Date: 5-8-01

Builder Copy

KwikKote

No. 200-000289

Stucco System Installation Card

Job Name: BELLEFLEUR II
Address: 8401 SERIO WY
SACRAMENTO, CA
Lot #: 0000025

Stucco System Trade Name: KWIK KOTE
Stucco System Manufacturer: KWIK KOTE CORP.

ICBO Evaluation Service, Inc.
Report No. 3607
Date of Job Completion: 5/7/01

Home Builder: BEAZER HOMES
Address: 3009 DOUGLAS
ROSEVELLE, CA

Stucco Contractor: KENYON CONSTRUCTION
Address: PO BOX 2077
North Highlands, CA

Telephone Number: 916/349-8191

Approved Contractor Number as
issued by the Stucco Manufacturer: 1001

Card Print Date: 05/30/2001

This is to certify that the stucco system on the building exterior at the above address had been installed in accordance with the evaluation report specified above and the manufacturer's instructions.

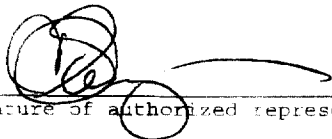

Signature of authorized representative of stucco contractor

5/30/01

Date



CAPITOL ENGINEERING LABORATORIES, INC.

631 Commerce Drive, Suite #200 • Roseville, California 95678 • (916) 786-2488

JOB REPORT

PAGE: _____

PROJECT NAME: BEAU FLEUR II BENZER FILE NO. 5212

INSPECTOR: James L. Ph... DATE: 3-21-01

PERSONS CONTACTED: CVC PERMIT #: _____

REFERENCE DOCUMENTS: ICBO Report # 4945 WEATHER: Clear

SERVICE PROVIDED: CONCRETE (INSP / SAMPLE ONLY / PU) MASONRY WELDING (SHOP / FIELD) SOILS

OTHER Iron, Bolts

Witness installation of iron bolts using Simpson Strong Tie epoxy. At 12/02 into holes brushed & blown out.

Lot 25 - 3 - 5/8" installed

Lot 21 - 2 - 5/8" "

Lot 19 - 2 - 5/8" "

COMPLIANCE OF WORK: _____

ATTACHMENTS: _____

EQUIPMENT/SUPPLIES USED: _____

NEXT VISIT: _____

REMARKS: _____

REVIEWED BY: James L. Ph... DATE: _____

THIS PLOT PLAN IS NOT FOR SALES PURPOSES. THIS PLOT PLAN IS FOR THE PURPOSES OF INDICATING COMPLIANCE WITH ZONING SET BACKS, GENERAL DRAINAGE DIRECTION, AND APPROXIMATE UTILITY CONNECTION. ALL OTHER DATA SHOWN HEREON IS CONCEPTUAL. THIS PLOT PLAN DOES NOT REFLECT AS-BUILT CONDITION. RETAINING WALLS ARE OPTIONAL AND MAY OR MAY NOT BE CONSTRUCTED.

- ☒ — WATER METER BOX
- ☒ — ELECTRICAL BOX
- * — UTILITY RISERS
- ⊖ — SEWER CLEANOUT
- ☒ — STREET LIGHT
- ⊖ — FIRE HYDRANT
- ☒ — TRANSFORMER
- ☒ — ELECTRICAL VAULT
- ⊖ — TELEPHONE PED.
- — DRAIN INLET

ROUTING/APPROVAL		INITIALS
President	✓	
Public Works Director		
City Engineer		
City Manager		

SERIO WAY

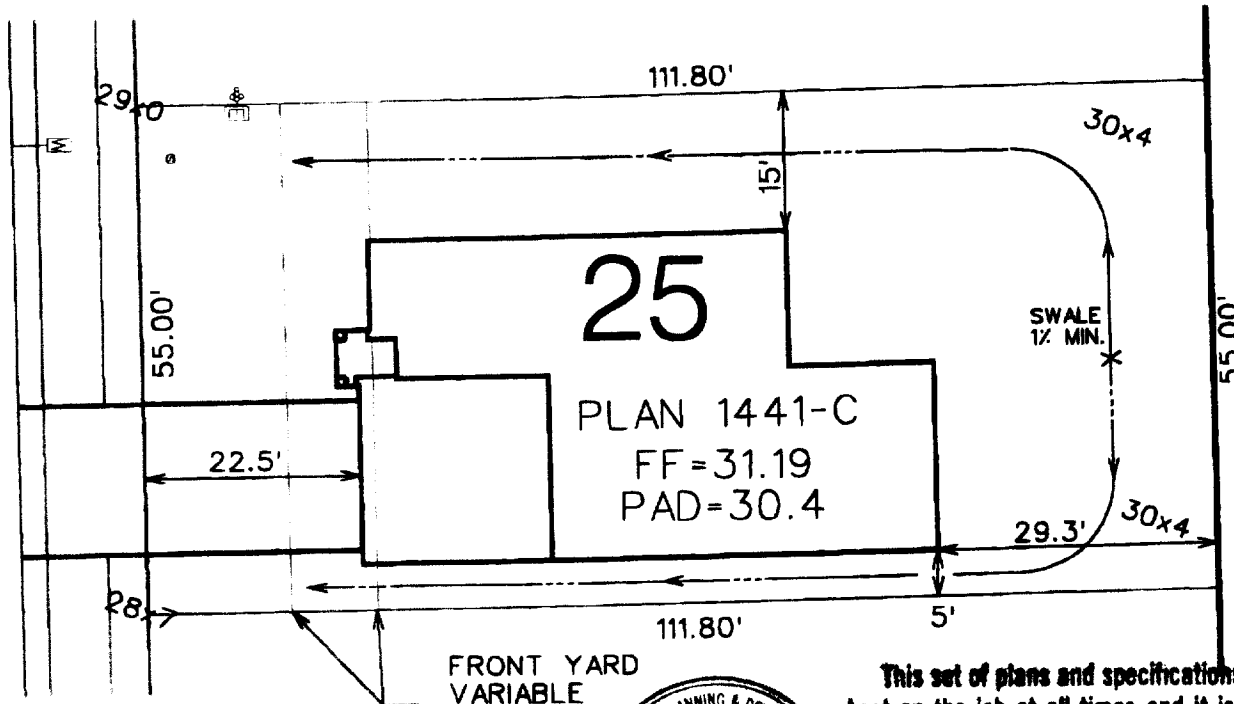

FRONT YARD VARIABLE SETBACK 15'-24'(TY)

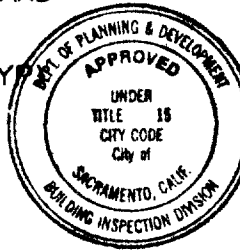

This set of plans and specifications must be kept on the job at all times and it is unlawful to make any changes or alterations from the same without written permission from the Building Inspection Division.

The approval of this plan and specification SHALL NOT be held to permit or approve the violation of any City Ordinance or State Law.

SCALE: 1"=20'

6149 SQUARE FEET

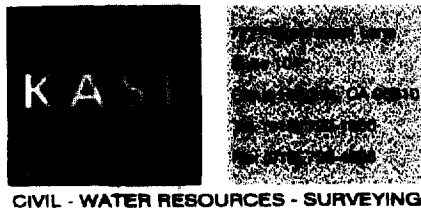

PLOT PLAN FOR
LOT 25
JACINTO VILLAGE NORTH
A.P.N.
ADDRESS:
COUNTY: SACRAMENTO

SCALE: 1"=20'
DATE: 12-08-00
REVISED:
DRAWN BY: PWG
CHK'D. BY: LK
W.O. 0434-02