

CITY OF SACRAMENTO
1231 I Street, Sacramento, CA 95814

Permit No: 0610347
Insp Area: 3
Thos Bros: 298F6

Site Address: 8642 ROYALGLEN WY SAC
Parcel No: 078-0065-009

Sub-Type: REM
Housing (Y/N): N

CONTRACTOR

OWNER
ROWEN SILVIANA
8642 ROYALGLEN WY
SACRAMENTO, CA 95826

ARCHITECT

Nature of Work: REMODEL 2ND BATH/NO STRUCTURAL CHANGES/SMOKE DETECTORS REQUIRED (REPIPE NOT IN THIS SCOPE OF WORK)

CONSTRUCTION LENDING AGENCY : I hereby affirm under penalty of perjury that there is a construction lending agency for the performance of the work for which this permit is issued (Sec. 3097, Civ. C).

Lender's Name _____ Lender's Address _____

LICENSED CONTRACTORS DECLARATION: I hereby affirm under penalty of perjury that I am licensed under provisions of Chapter 9 (commencing with section 7000) of Division 3 of the Business and Professions Code and my license is in full force and effect.

License Class _____ License Number _____ Date _____ Contractor Signature _____

OWNER-BUILDER DECLARATION: I hereby affirm under penalty of perjury that I am exempt from the contractors License Law for the following reason (Sec. 7031.5, Business and Professions Code; any city or county which requires a permit to construct, alter, improve, demolish, or repair any structure, prior to its issuance, also requires the applicant for such permit to file a signed statement that he or she is licensed pursuant to the provisions of the Contractors License Law (Chapter 9 (commencing with Section 7000) of Division 8 of the Business and Professions Code) or that he or she is exempt therefrom and the basis for the alleged exemption. Any violation of Section 7031.5 by any applicant for a permit subjects the applicant to a civil penalty of not more than five hundred dollars (\$500.00);

I, as a owner of the property, or my employees with wages as their sole compensation, will do the work, and the structure is not intended or offered for sale (Sec. 7044, Business and Professional Code: The Contractors License Law does not apply to an owner of property who builds or improves thereon, and who does such work himself or herself or through his/her own employees, provided that such improvements are not intended or offered for sale. If, however, the building or improvement is sold within one year of completion, the owner-builder will have the burden of proving that he/she did not build or improve for the purpose of sale.)

____ I, as owner of the property, am exclusively contracting with licensed contractors to construct the project (Sec. 7044, Business and Professions Code: The Contractors License Law does not apply to an owner of property who builds or improves thereon, and who contracts for such projects with a contractor(s) licensed pursuant to the Contractors License Law).

____ I am exempt under Sec. _____ B & PC for this reason: _____

Date 7/12/04 Owner Signature Silviana Rowen

IN ISSUING THIS BUILDING PERMIT, the applicant represents, and the city relies on the representation of the applicant, that the applicant verified all measurements and locations shown on the application or accompanying drawings and that the improvement to be constructed does not violate any law or private agreement relating to permissible or prohibited locations for such improvements. The City of Sacramento does not authorize any illegal location of any improvement or the violation of any private agreement relating to location of improvements.

I certify that I have read this application and state that all information is correct. I agree to comply with all city and county ordinances and state laws relating to building construction and hereby authorize representative(s) of this city to enter upon the abovementioned property for inspection purposes.

X Date 7/12/04 Applicant/Agent Signature Silviana Rowen

WORKER'S COMPENSATION DECLARATION: I hereby affirm under penalty of perjury one of the following declarations:

____ I have and will maintain a certificate of consent to self-insure for workers' compensation as provided for by Section 3700 of the Labor Code, for the performance of work for which the permit is issued.

____ I have and will maintain workers' compensation insurance, as required by Section 3700 of the Labor Code, for the performance of the work for which this permit is issued. My workers' compensation insurance carrier and policy number are:

Carrier Exempt Policy Number _____ Exp Date _____

____ (This section need not be completed if the permit is for \$100 or less) I certify that in the performance of the work for which this permit is issued, I shall not employ any person in any manner so as to become subject to the workers' compensation laws of California and agree that if I should become subject to the workers' compensation provisions of Section 3700 of the Labor Code, I shall forthwith comply with those provisions.

X Date 7/12/04 Applicant Signature Silviana Rowen

WARNING: FAILURE TO SECURE WORKER'S COMPENSATION COVERAGE IS UNLAWFUL AND SHALL SUBJECT AN EMPLOYER TO CRIMINAL PENALTIES AND CIVIL FINES UP TO ONE HUNDRED THOUSAND DOLLARS (\$100,000) IN ADDITION TO THE COST OF COMPENSATION, DAMAGES AS PROVIDED FOR IN SECTION 3706 OF THE LABOR CODE, INTEREST AND ATTORNEY'S FEE.

THIS PERMIT SHALL EXPIRE BY LIMITATION IF WORK IS NOT COMMENCED WITHIN 180 DAYS.

Existing main bathroom at 8642 Royalglen Way

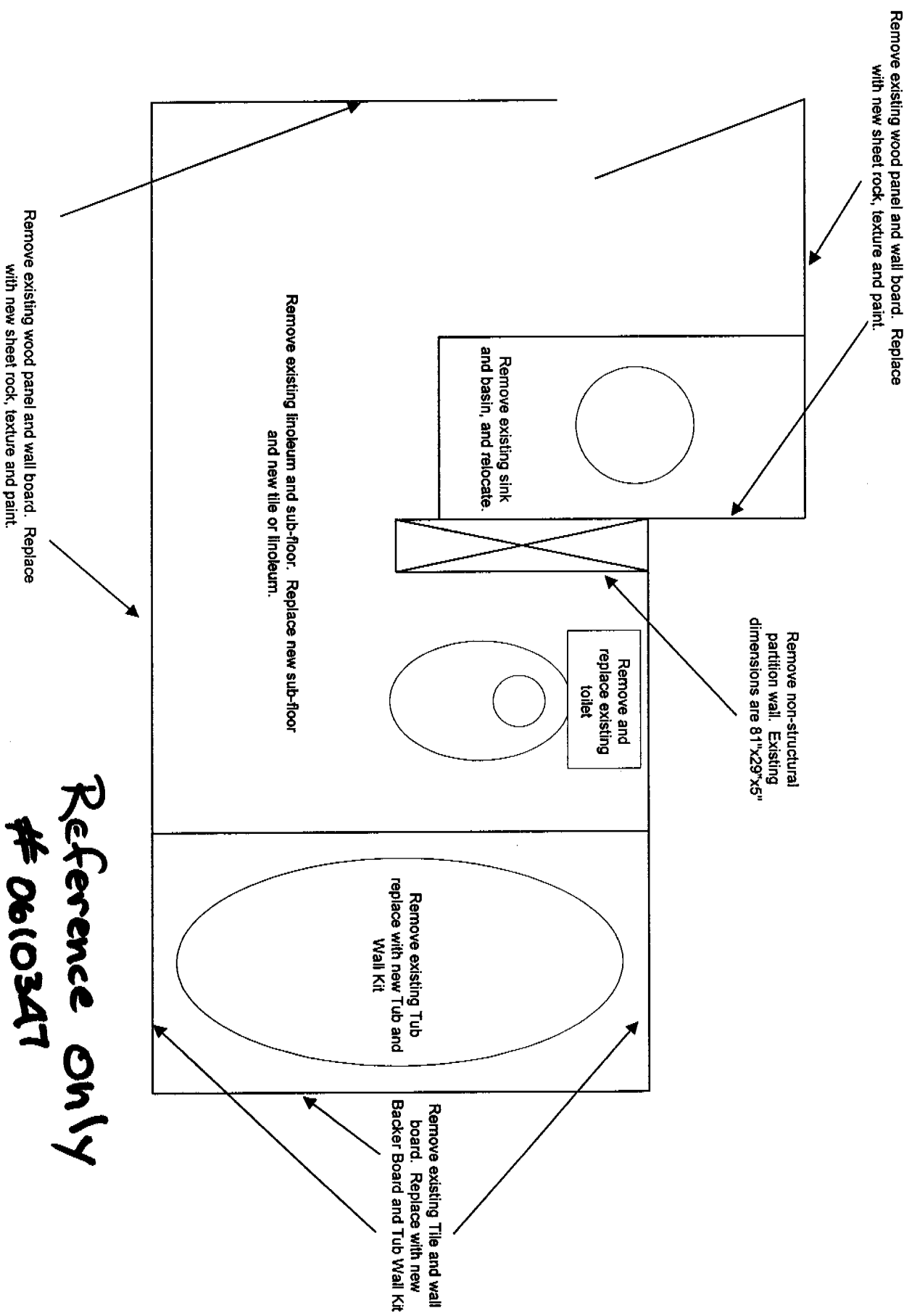

Reference Only
0610347

City Copy

Scale: 3/4" = 1'

Remodeled main bathroom at 8642 Royalglen Way

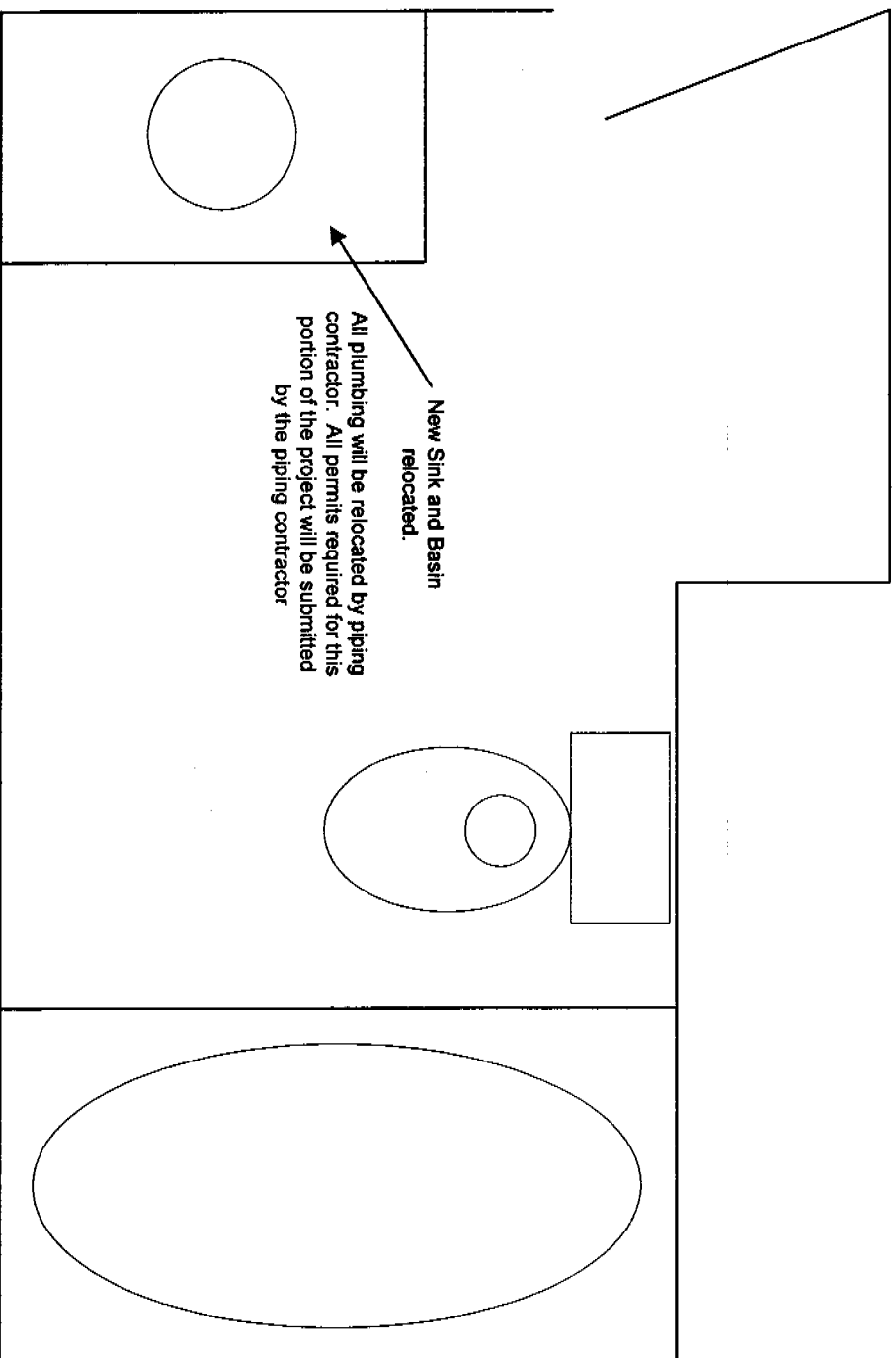

Reference Only
0610347

City Copy

Scale: 3/4" = 1'

Existing main bathroom at 8642 Royalglen Way

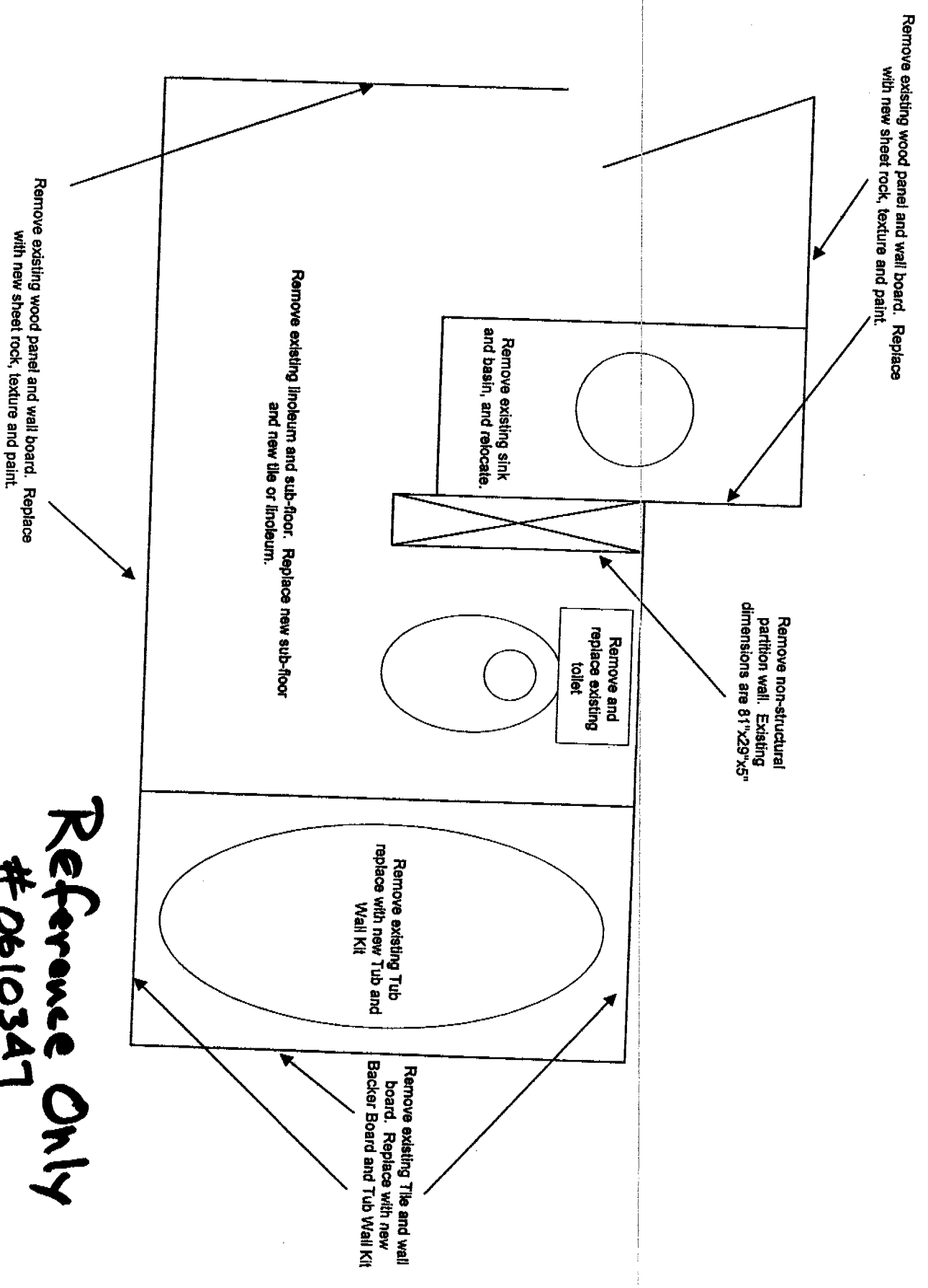

Reference Only
#0610347

Job Copy

Scale: 3/4" = 1'

Remodeled main bathroom at 8642 Royalglen Way

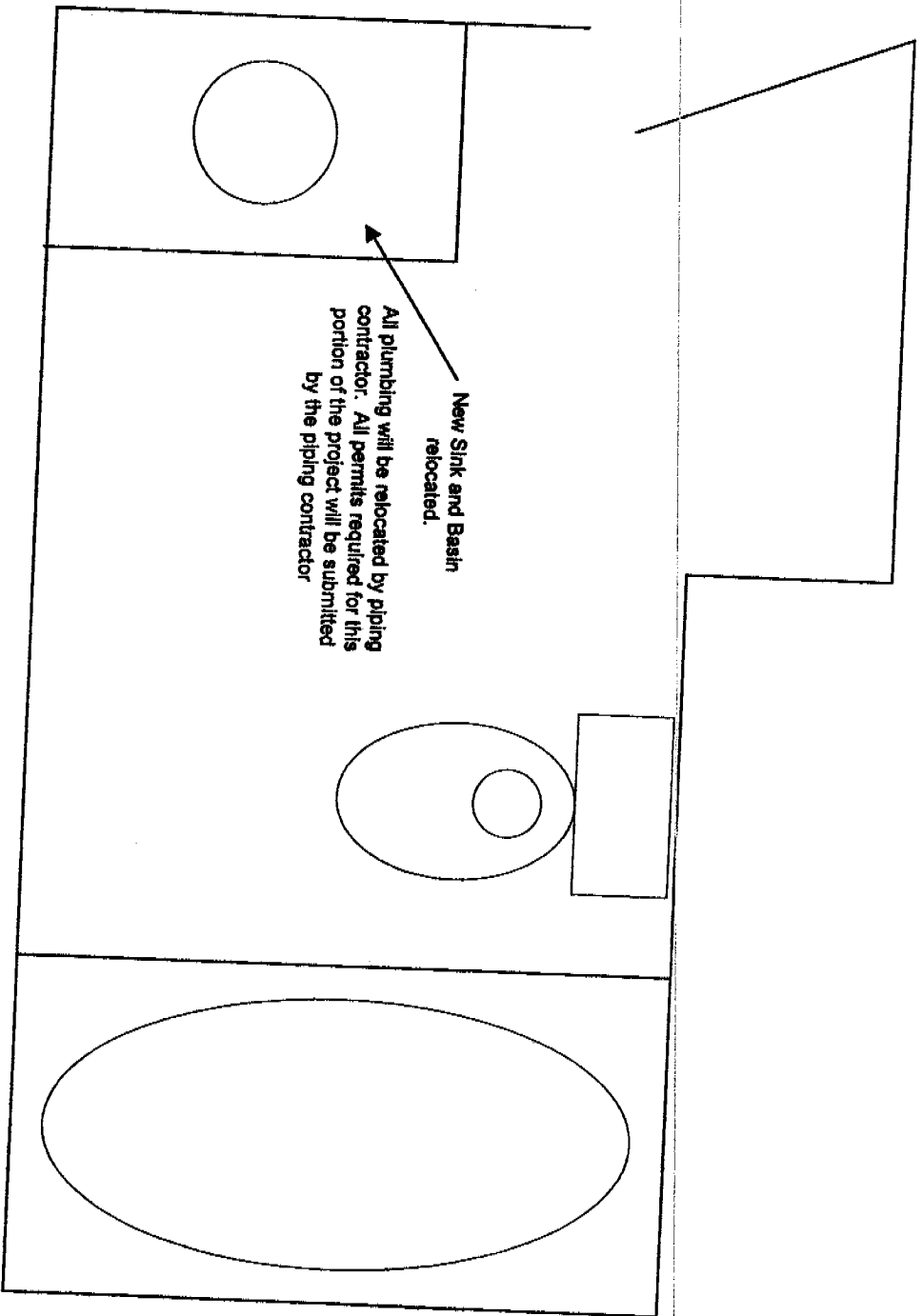

Reference Only
#0610347

Job Copy

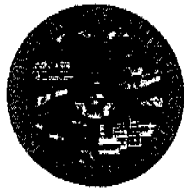

**CITY OF SACRAMENTO
DEVELOPMENT SERVICES DEPARTMENT
BUILDING DIVISION**

North Permit Center
2101 Arena Blvd., Suite 200
Sacramento, CA 95834
Inspection: (916) 808-4677

OWNER BUILDER VERIFICATION

1. Check one below - I or my immediate family (parent, spouse, or child) will perform:

- A - all the work authorized by this permit.
- B - a portion of the work.
- C - none of the work.

If B or C is checked, complete 2 or 3 below.

2. A State licensed contractor (*) will be hired to do:

- all of the authorized work.
- a portion of the authorized work.

Name _____ Phone _____

Address _____

Type of Work _____

Name _____ Phone _____

Address _____

Type of Work _____

Name _____ Phone _____

Address _____

Type of Work _____

Name _____ Phone _____

Address _____

Type of Work _____

3. I will utilize unlicensed person(s) other than my immediate family to perform all or portions of the authorized work. A Certificate of Workers Compensation must be on file at this office.

I declare under penalty of perjury that the above is true and correct. I have read and understand the owner-builder information on the reverse side of this form.

Signed: Property Owner Silvian Rowe

Date 7/12/06 Case No. _____ Permit No. 0610347

Job Address _____

Note: * Information regarding unknown contractors or change in subcontractors shall be submitted to the Building Inspection field office.