

CITY OF SACRAMENTO  
1231 I Street, Sacramento, CA 95814

Permit No: 0214875  
Insp Area: 4  
Thos Bros: 257C3

Site Address: 5917 MEEKS WY SAC  
Parcel No: NORTHPOINTE PARK 26 LOT 5

Sub-Type: NSFR  
Housing (Y/N): N

CONTRACTOR  
BEAZER HOMES  
3009 DOUGLAS BL #150  
ROSEVILLE CA 95661

OWNER

ARCHITECT

Nature of Work: MP1170 1 STORY 6 ROOM SFR

**CONSTRUCTION LENDING AGENCY:** I hereby affirm under penalty of perjury that there is a construction lending agency for the performance of the work for which this permit is issued (Sec. 3097, Civ. C).

Lender's Name \_\_\_\_\_ Lender's Address \_\_\_\_\_

**LICENSED CONTRACTORS DECLARATION:** I hereby affirm under penalty of perjury that I am licensed under provisions of Chapter 9 (commencing with section 7000) of Division 3 of the Business and Professions Code and my license is in full force and effect.

License Class B License Number 724191 Date 10/23/02 Contractor Signature Sheuy Van Maeren

**OWNER-BUILDER DECLARATION:** I hereby affirm under penalty of perjury that I am exempt from the contractors License Law for the following reason (Sec. 7031.5, Business and Professions Code; any city or county which requires a permit to construct, alter, improve, demolish, or repair any structure, prior to its issuance, also requires the applicant for such permit to file a signed statement that he or she is licensed pursuant to the provisions of the Contractors License Law (Chapter 9 (commencing with Section 7000) of Division 8 of the Business and Professions Code) or that he or she is exempt therefrom and the basis for the alleged exemption. Any violation of Section 7031.5 by any applicant for a permit subjects the applicant to a civil penalty of not more than five hundred dollars (\$500.00);

I, as a owner of the property, or my employees with wages as their sole compensation, will do the work, and the structure is not intended or offered for sale (Sec. 7044, Business and Professional Code: The Contractors License Law does not apply to an owner of property who builds or improves thereon, and who does such work himself or herself or through his/her own employees, provided that such improvements are not intended or offered for sale. If, however, the building or improvement is sold within one year of completion, the owner-builder will have the burden of proving that he/she did not build or improve for the purpose of sale.)

I, as owner of the property, am exclusively contracting with licensed contractors to construct the project (Sec. 7044, Business and Professions Code: The Contractors License Law does not apply to an owner of property who builds or improves thereon, and who contracts for such projects with a contractor(s) licensed pursuant to the Contractors License Law).

I am exempt under Sec. \_\_\_\_\_ B & PC for this reason: \_\_\_\_\_

Date \_\_\_\_\_ Owner Signature \_\_\_\_\_

**IN ISSUING THIS BUILDING PERMIT,** the applicant represents, and the city relies on the representation of the applicant, that the applicant verified all measurements and locations shown on the application or accompanying drawings and that the improvement to be constructed does not violate any law or private agreement relating to permissible or prohibited locations for such improvements. This building permit does not authorize any illegal location of any improvement or the violation of any private agreement relating to location of improvements.

I certify that I have read this application and state that all information is correct. I agree to comply with all city and county ordinances and state laws relating to building construction and hereby authorize representative(s) of this city to enter upon the abovementioned property for inspection purposes.

Date 10/23/02 Applicant/Agent Signature Sheuy Van Maeren

**WORKER'S COMPENSATION DECLARATION:** I hereby affirm under penalty of perjury one of the following declarations:  
I have and will maintain a certificate of consent to self-insure for workers' compensation as provided for by Section 3700 of the Labor Code, for the performance of work for which the permit is issued.

I have and will maintain workers' compensation insurance, as required by Section 3700 of the Labor Code, for the performance of the work for which this permit is issued. My workers' compensation insurance carrier and policy number are:

Carrier LIBERTY MUTUAL INS CO. Policy Number WA2-65D-004147-082 Exp Date 04/01/2003

(This section need not be completed if the permit is for \$100 or less) I certify that in the performance of the work for which this permit is issued, I shall not employ any person in any manner so as to become subject to the workers' compensation laws of California and agree that if I should become subject to the workers' compensation provisions of Section 3700 of the Labor Code, I shall forthwith comply with those provisions.

Date 10/23/02 Applicant Signature Sheuy Van Maeren

**WARNING: FAILURE TO SECURE WORKER'S COMPENSATION COVERAGE IS UNLAWFUL AND SHALL SUBJECT AN EMPLOYER TO CRIMINAL PENALTIES AND CIVIL FINES UP TO ONE HUNDRED THOUSAND DOLLARS (\$100,000) IN ADDITION TO THE COST OF COMPENSATION, DAMAGES AS PROVIDED FOR IN SECTION 3706 OF THE LABOR CODE, INTEREST AND ATTORNEY'S FEE.**

**THIS PERMIT SHALL EXPIRE BY LIMITATION IF WORK IS NOT COMMENCED WITHIN 180 DAYS.**

**RESIDENTIAL BUILDING PERMIT APPLICATION**

New Construction       Addition       Remodels       Other

Project Address: Lot 5 5917 MEER WAY Assessor Parcel # 201-0320-022 & 023

**OWNER INFORMATION:** Northpointe Park Village 26

Legal Property Owner: Beazer Homes Holdings Corp. Phone # 916-773-3888  
Owner Address: 3009 Douglas Blvd. 150 City Roseville State CA Zip 95661

**CONTRACTOR INFORMATION:**

Contractor: Same as above Lic. # B724191 Phone # 773-3888 Fax # 773-0425

**PROJECT INFORMATION:**

Land Use Zone \_\_\_\_\_ Occupancy Group \_\_\_\_\_ Construction Type \_\_\_\_\_ Fed Code \_\_\_\_\_

No. of stories: 1 No. of rooms: \_\_\_\_\_ Street width: \_\_\_\_\_

1<sup>st</sup> Floor Area 1170 2<sup>nd</sup> Floor Area \_\_\_\_\_ Basement \_\_\_\_\_ Roof Material \_\_\_\_\_

AREA IN SQUARE FOOT OF:	EXISTING	NEW
Dwelling/Living	_____	<u>1170</u>
Garage/Storage	_____	<u>417</u>
Decks/Balconies	_____	_____
Carports	_____	_____

SCOPE OF WORK: Single Family Homes

**FOR OFFICE USE ONLY**

Information above complete       AR Flood Waiver required       Planning Approval  
 Violation files checked       Flood Elevation Certificate Required       Design Review Approval  
 Standard setbacks       Water Development Infill Area       Special Fee Districts Apply : \_\_\_\_\_  
 County Sewer

**NEW STRUCTURES & ADDITIONS**

◆ THE FOLLOWING MUST BE PROVIDED IN ORDER TO SUBMIT FOR PLAN REVIEW

2 COMPLETE PLANS, LEGIBLE & DRAWN TO SCALE      ◆ Plans to include: site plan, floor plan, elevations, roof/ceiling plan, foundation and structural framing details, and structural calculations for non-conforming structures.  
 3 SETS IF PROJECT IS IN A DESIGN REVIEW AREA

Title 24 Energy Compliance documentation       11" x 17" copy of floor plan for County Assessor  
 Grading and Erosion Control Questionnaire       Plan Review Fees

Date: \_\_\_\_\_ Received by: (staff) \_\_\_\_\_

ACTIVITY/PERMIT # \_\_\_\_\_

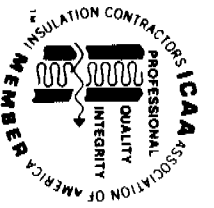

**INSULATION CONTRACTORS  
ASSOCIATION  
OF AMERICA**

INSULATION  
CERTIFICATE  
72466

1321 DUKE STREET, SUITE 303 • ALEXANDRIA, VA 22314 • (703) 739-0356

THIS IS TO CERTIFY THAT INSULATION HAS BEEN INSTALLED IN CONFORMANCE WITH CURRENT ENERGY REGULATIONS, CALIFORNIA ADMINISTRATIVE CODE, TITLE 24, STATE OF CALIFORNIA, IN THE BUILDING LOCATED AT:

Bozzer LOT # 5 TRACT # Providence

STREET 5917 Meeks CITY SAC

**EXTERIOR WALLS:**

MANUFACTURER Ec THICKNESS/TYPE 3 5/8 R- VALUE 13

**CEILING:**

BATTS: MANUFACTURER Ec THICKNESS/TYPE 10 R- VALUE 30

BLOWN IN: MANUFACTURER AT THICKNESS/TYPE 12 R- VALUE 30

SQUARE FOOTAGE COVERED 1090 NUMBER OF BAGS USED 20

FLOORS: MANUFACTURER \_\_\_\_\_ THICKNESS/TYPE \_\_\_\_\_ R- VALUE \_\_\_\_\_

SLAB ON GRADE: MANUFACTURER \_\_\_\_\_ THICKNESS/TYPE \_\_\_\_\_ R- VALUE \_\_\_\_\_

WIDTH OF INSULATION \_\_\_\_\_ INCHES

FOUNDATION WALLS: MANUFACTURER \_\_\_\_\_ THICKNESS/TYPE \_\_\_\_\_ R- VALUE \_\_\_\_\_

GENERAL CONTRACTOR \_\_\_\_\_

CALIFORNIA CONTRACTORS LICENSE # \_\_\_\_\_ DATE \_\_\_\_\_

SIGNATURE \_\_\_\_\_ TITLE \_\_\_\_\_

INSULATION CONTRACTOR **ARCADE INSULATION**

CALIFORNIA CONTRACTORS LICENSE #263784 DATE 2-8-3

Ray R... SIGNATURE Riseman TITLE

#6005

# OMEGA PRODUCTS INTERNATIONAL, INC.

DIAMOND WALL INSULATING STUCCO SYSTEM

JOB ADDRESS:

EXPANDED PRODUCTIONS

ICBO Report #4004

Date of Job Completion

2/6/03

PLASTERING CONTRACTOR:

Name: SHILOH WORKS INC

Address: 500 WINDY HILLS ROAD SHERMAN TX 75082

Telephone No: 972-383-6699

Contractor Number of Diamond Wall System 2175

This is to certify that the exterior coating system on the building exterior at the above address has been installed in accordance with the evaluation report specified above and the manufacturer's instructions.

Date 3/1/03

Signature of authorized representative of Plastering Contractor

This installation card must be presented to the building inspector after completion of work and before final inspection.

5917

Weeks

WAY

**THIS PLOT PLAN IS NOT FOR SALES PURPOSES. THIS PLOT PLAN IS FOR THE PURPOSES OF INDICATING COMPLIANCE WITH ZONING SET BACKS, GENERAL DRAINAGE DIRECTION, AND APPROXIMATE UTILITY CONNECTION. ALL OTHER DATA SHOWN HEREON IS CONCEPTUAL. THIS PLOT PLAN DOES NOT REFLECT AS-BUILT CONDITION, RETAINING WALL ARE OPTIONAL AND MAY OR MAY NOT BE CONSTRUCTED.**

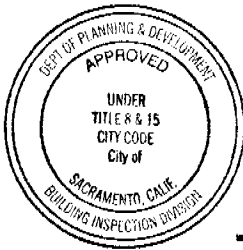

This set of plans and specifications must be kept on the job at all times and it is unlawful to make any changes or alterations to the same without written permission from the Building Inspection Division.

The approval of this plan and specification SHALL NOT be held **SUBORDINATE** to the violation of any City Ordinance or State Law.

SCALE: 1" = 20'

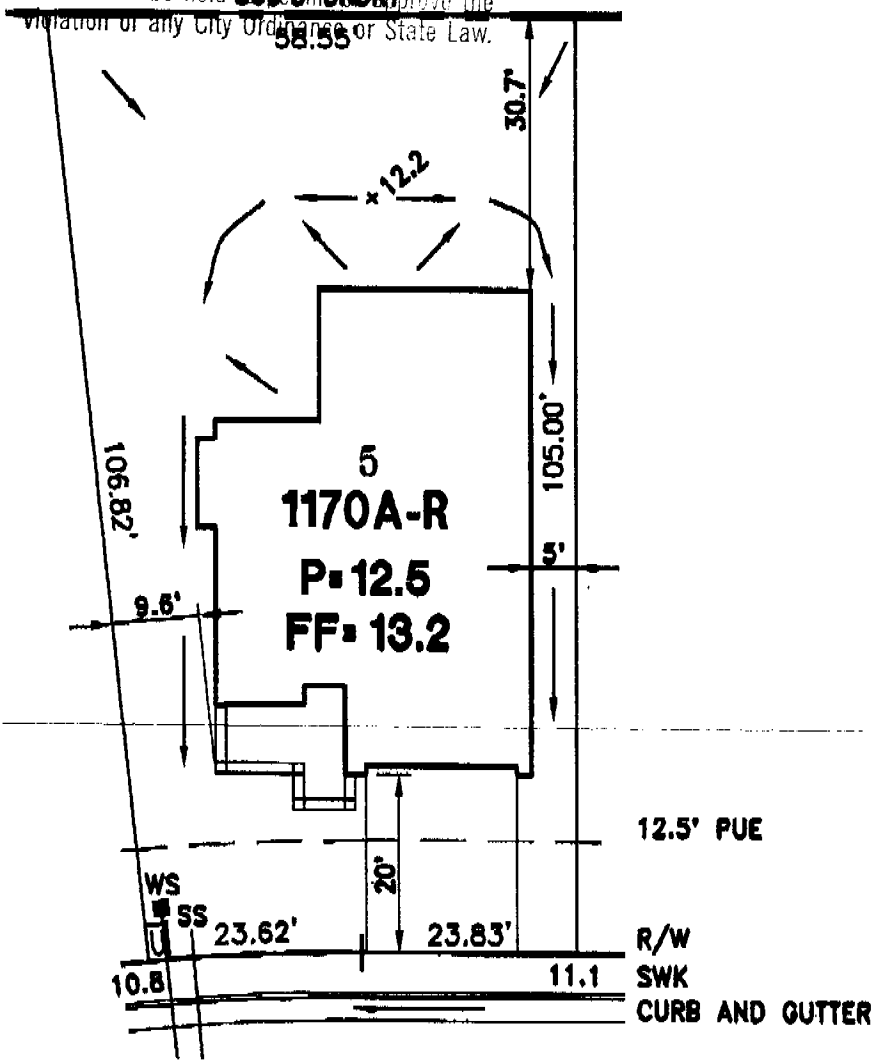

**MEEKS WAY**

ROUTING/APPROVAL		
	✓	INITIALS
President		
Project Development		
Construction		
Marketing	✓	GR
Admin.		
Accounting		

**LEGEND**

- STREET LIGHT
- TRANSFORMER
- UTILITY BOX
- FIRE HYDRANT

**PLOT PLAN  
LOT 5  
PROVIDENCE  
AT REGENCY PARK VILLAGE 26  
FOR  
BEAZER HOMES  
CITY OF SACRAMENTO CALIFORNIA**

**WOOD RODGERS**  
ENGINEERING • PLANNING • MAPPING • SURVEYING  
8301 Q STREET, BLDG. 100-B, SACRAMENTO, CA 95816  
PHONE: (916) 341-7740 FAX: (916) 341-7787

DATE:	DRAWN:	CHECKED:	PROJECT NO:
OCT '02	DZR		1045.069

File: J:\JOBS\NORTHPOINTE PHASE 2\VILLAGE 26\DWGS\CIVIL\LOT PLANS\05.DWG Last edited: 10/07/02 @ 12:52 p.m. by: didier