

CITY OF SACRAMENTO
1231 I Street, Sacramento, CA 95814

Permit No: 0308191

Insp Area: 4

Thos Bros: 257-C4

Site Address: 1662 MARING WY SAC

Parcel No: 201-0800-049

NORTHPT PK 21 LOT 83

Sub-Type: NSFR

Housing (Y/N): N

CONTRACTOR

FORECAST HOMES
1796 TRIBUTE RD. STE 100, SAC. CAL.
95815

OWNER

ARCHITECT

Nature of Work: NSFR MP 2212 2 STORY 9 ROOMS

CONSTRUCTION LENDING AGENCY : I hereby affirm under penalty of perjury that there is a construction lending agency for the performance of the work for which this permit is issued (Sec. 3097, Civ. C).

Lender's Name _____ Lender's Address _____

LICENSED CONTRACTORS DECLARATION: I hereby affirm under penalty of perjury that I am licensed under provisions of Chapter 9 (commencing with section 7000) of Division 3 of the Business and Professions Code and my license is in full force and effect.

License Class B License Number 685513 Date _____ Contractor Signature [Signature]

OWNER-BUILDER DECLARATION: I hereby affirm under penalty of perjury that I am exempt from the contractors License Law for the following reason (Sec. 7031.5, Business and Professions Code; any city or county which requires a permit to construct, alter, improve, demolish, or repair any structure, prior to its issuance, also requires the applicant for such permit to file a signed statement that he or she is licensed pursuant to the provisions of the Contractors License Law (Chapter 9 (commencing with Section 7000) of Division 8 of the Business and Professions Code) or that he or she is exempt therefrom and the basis for the alleged exemption. Any violation of Section 7031.5 by any applicant for a permit subjects the applicant to a civil penalty of not more than five hundred dollars (\$500.00);

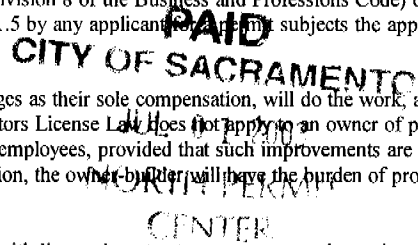

_____, I, as a owner of the property, or my employees with wages as their sole compensation, will do the work, and the structure is not intended or offered for sale (Sec. 7044, Business and Professional Code: The Contractors License Law does not apply to an owner of property who builds or improves thereon, and who does such work himself or herself or through his/her own employees, provided that such improvements are not intended or offered for sale. If, however, the building or improvement is sold within one year of completion, the owner-builder will have the burden of proving that he/she did not build or improve for the purpose of sale.)

_____, I, as owner of the property, am exclusively contracting with licensed contractors to construct the project (Sec. 7044, Business and Professions Code: The Contractors License Law does not apply to an owner of property who builds or improves thereon, and who contracts for such projects with a contractor(s) licensed pursuant to the Contractors License Law).

_____ I am exempt under Sec. _____ B & PC for this reason: _____

Date _____ Owner Signature _____

IN ISSUING THIS BUILDING PERMIT, the applicant represents, and the city relies on the representation of the applicant, that the applicant verified all measurements and locations shown on the application or accompanying drawings and that the improvement to be constructed does not violate any law or private agreement relating to permissible or prohibited locations for such improvements. This building permit does not authorize any illegal location of any improvement or the violation of any private agreement relating to location of improvements.

I certify that I have read this application and state that all information is correct. I agree to comply with all city and county ordinances and state laws relating to building construction and hereby authorize representative(s) of this city to enter upon the abovementioned property for inspection purposes.

Date 7-01-03 Applicant/Agent Signature [Signature]

WORKER'S COMPENSATION DECLARATION: I hereby affirm under penalty of perjury one of the following declarations:

_____ I have and will maintain a certificate of consent to self-insure for workers' compensation as provided for by Section 3700 of the Labor Code, for the performance of work for which the permit is issued.

I have and will maintain workers' compensation insurance, as required by Section 3700 of the Labor Code, for the performance of the work for which this permit is issued. My workers' compensation insurance carrier and policy number are:

Carrier STATE FUND Policy Number 1659383 Exp Date 01/10/2004

_____, (This section need not be completed if the permit is for \$100 or less) I certify that in the performance of the work for which this permit is issued, I shall not employ any person in any manner so as to become subject to the workers' compensation laws of California and agree that if I should become subject to the workers' compensation provisions of Section 3700 of the Labor Code, I shall forthwith comply with those provisions.

Date 7-01-03 Applicant Signature [Signature]

WARNING: FAILURE TO SECURE WORKER'S COMPENSATION COVERAGE IS UNLAWFUL AND SHALL SUBJECT AN EMPLOYER TO CRIMINAL PENALTIES AND CIVIL FINES UP TO ONE HUNDRED THOUSAND DOLLARS (\$100,000) IN ADDITION TO THE COST OF COMPENSATION, DAMAGES AS PROVIDED FOR IN SECTION 3706 OF THE LABOR CODE, INTEREST AND ATTORNEY'S FEE.

THIS PERMIT SHALL EXPIRE BY LIMITATION IF WORK IS NOT COMMENCED WITHIN 180 DAYS.

RESIDENTIAL BUILDING PERMIT APPLICATION

New Construction

Addition

Remodels

Other

LOT# 83

Project Address: 1662 MARINE WAY

Assessor Parcel # 201-0801-049

OWNER INFORMATION:

NORTHPOINTE PARK VILLAGE 21

Legal Property Owner: Forecast Homes Phone # (916) 920-0200

Owner Address: 1796 Tribute Rd. #100 City Sacramento State CA Zip 95815

CONTRACTOR INFORMATION:

Contractor: Forecast Homes Lic. # 606862 Phone # 920-0200 Fax# 920-0379

PROJECT INFORMATION:

Land Use Zone R/A Occupancy Group R3 Construction Type 1/1/1 Fed Code 1A

No. of stories: TWO No. of rooms: 7 Street width: 40'

1st Floor Area 1284 2nd Floor Area 928 Basement N/A Roof Material TILE

| AREA IN SQUARE FOOT OF: | EXISTING | NEW |
|-------------------------|----------|-------------|
| Dwelling/Living | _____ | <u>2212</u> |
| Garage/Storage | _____ | <u>518</u> |
| Decks/Balconies | _____ | _____ |
| Carports | _____ | _____ |

SCOPE OF WORK: New SFD
MP 464B

FOR OFFICE USE ONLY

- Information above complete
- Violation files checked
- Standard setbacks
- County Sewer
- AR Flood Waiver required
- Flood Elevation Certificate Required
- Water Development Infill Area
- Planning Approval
- Design Review Approval
- Special Fee Districts Apply: _____

NEW STRUCTURES & ADDITIONS

THE FOLLOWING MUST BE PROVIDED IN ORDER TO SUBMIT FOR PLAN REVIEW

- 2 COMPLETE PLANS, LEGIBLE & DRAWN TO SCALE
- 3 SETS IF PROJECT IS IN A DESIGN REVIEW AREA
- Title 24 Energy Compliance documentation
- Grading and Erosion Control Questionnaire
- Plans to include: site plan, floor plan, elevations, roof/ceiling plan, foundation and structural framing details, and structural calculations for non-conforming structures.
- 11" x 17" copy of floor plan for County Assessor
- Plan Review Fees

Date: _____ Received by: (staff) _____

ACTIVITY/PERMIT #

plot plan

THIS PLOT PLAN IS FOR THE PURPOSE OF SHOWING THE HOUSE TO BE CONSTRUCTED ON THE LOT AND MAY NOT REPRESENT THE FINAL AS-BUILT CONFIGURATION OF THE PROPERTY OR IMPROVEMENTS THEREON. THE ACCURACY OF THIS PLOT PLAN IS NOT GUARANTEED, NOR IS IT A PART OF ANY POLICY, REPORT OR GUARANTEE TO WHICH IT MAY BE ATTACHED. ACTUAL DIMENSIONS, OTHER THAN THE MINIMUM ORDINANCE, MAY VARY OR CHANGE WITHOUT PRIOR NOTICE DUE TO ACTUAL SITE CONDITIONS.

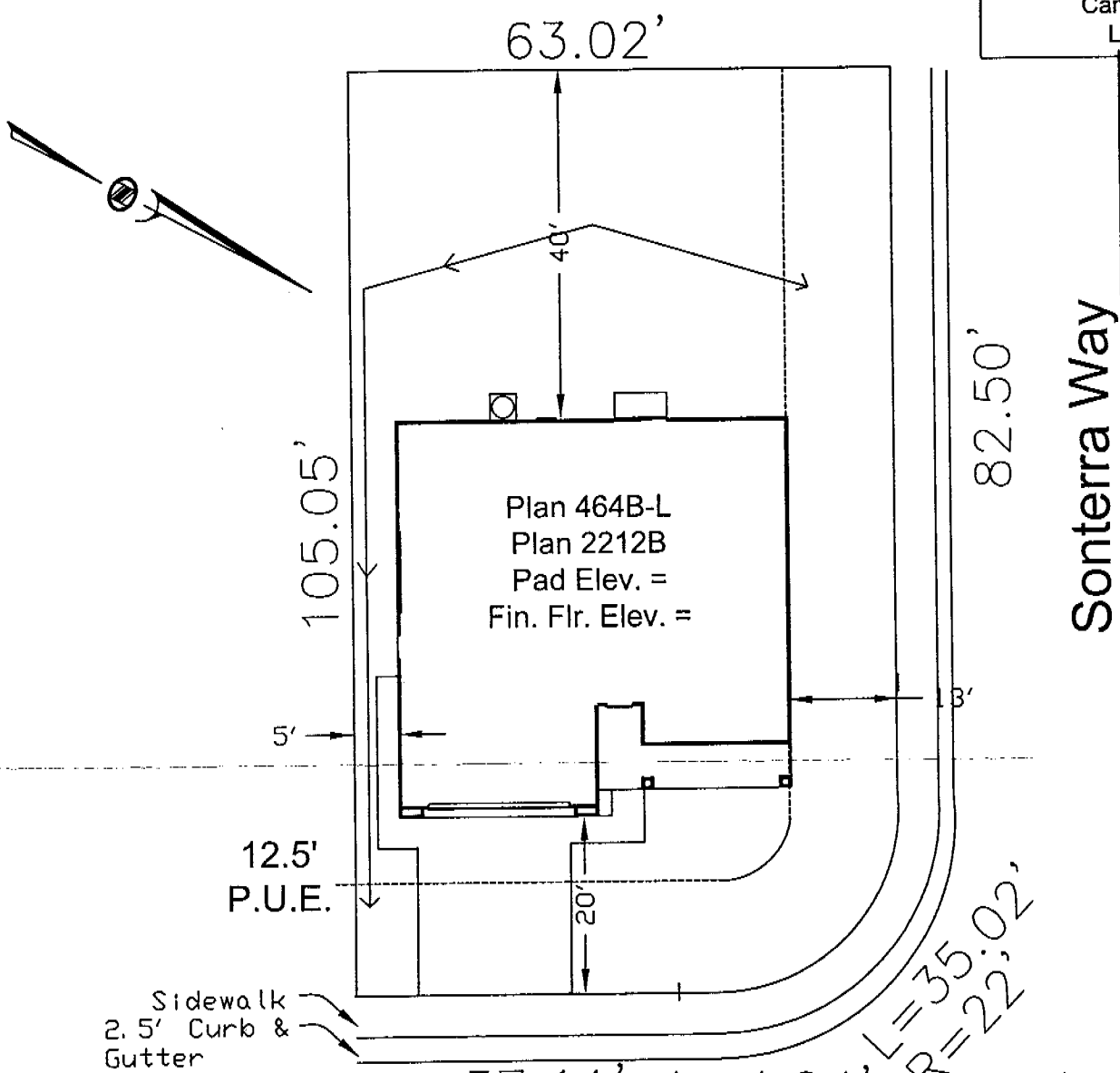

Canterbury
Lot 83

This set of plans and specifications must be kept on the job at all times and it is unlawful to make any changes or alterations from the same without written permission from the City Inspecting Division.

The approval of this plan and specification shall not be held to permit or approve the violation of any City Ordinance or State Law.

Lot Sf: 6,419+/-

Maring Way

Northpointe Park
Village 21

Lot #83
1662 Maring Way
City of Sacramento
A.P.N.:201-0800-049

Forecast Homes

| Symbols Legend | |
|-----------------------------|--|
| Street Light: | |
| Drop Inlet: | |
| Electric Service Box: | |
| Fire Hydrant: | |
| Pad-Mount Transformer: | |
| Sewer Service: | |
| Water Service: | |
| Flow Line: | |
| High Point: | |
| Flow Line: | |
| Elevation Back of Sidewalk: | |
| 2nd Story Element: | |

A

Apollo
Real
Estate
Group

1204 El Sur Way
Sacramento, CA 95864
(916) 978-9726

| | | | |
|-------|----------|---------|--------|
| 11 | MAH | 5/29/03 | 1"=20' |
| Phase | Drawn By | Date | Scale |

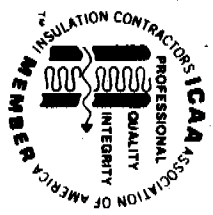

**INSULATION CONTRACTORS
ASSOCIATION
OF AMERICA**

0308191
0308182

INSULATION
CERTIFICATE
43338

1321 DUKE STREET, SUITE 303 • ALEXANDRIA, VA 22314 • (703) 739-0356

THIS IS TO CERTIFY THAT INSULATION HAS BEEN INSTALLED IN CONFORMANCE WITH CURRENT ENERGY REQUIREMENTS, CALIFORNIA ADMINISTRATIVE CODE, TITLE 24, STATE OF CALIFORNIA, IN THE BUILDING LOCATED AT:

Forest LOT # 2083 TRACT # Allegheny

STREET 1662 Moravia CITY SAZ

EXTERIOR WALLS:

MANUFACTURER LR THICKNESS/TYPE 3 9/16 R-VALUE 13 1/2

CEILINGS:

MANUFACTURER LR THICKNESS/TYPE 10 R-VALUE 30

BLOWN IN: OT MINIMUM THICKNESS 12 R-VALUE 30

MANUFACTURER _____ THICKNESS/TYPE _____ R-VALUE _____

SQUARE FOOTAGE COVERED 1050 NUMBER OF BAGS USED 19

FLOORS: MANUFACTURER _____ THICKNESS/TYPE _____ R-VALUE _____

SLAB ON GRADE: MANUFACTURER _____ THICKNESS/TYPE _____ R-VALUE _____

WIDTH OF INSULATION _____ INCHES

FOUNDATION WALLS: MANUFACTURER _____ THICKNESS/TYPE _____ R-VALUE _____

GENERAL CONTRACTOR _____ CALIFORNIA CONTRACTORS LICENSE # _____

SIGNATURE [Signature] DATE 10/15/03

INSULATION CONTRACTOR **ARCADE INSULATION** TITLE _____

CALIFORNIA CONTRACTORS LICENSE #815286 DATE 10.15.03

NEVADA CONTRACTORS LICENSE #55201 SIGNATURE [Signature] TITLE _____

Installation Card
Fiber Reinforced Stucco

Job Name and Address: CANTERBURY
LOT 21083
1662 MARINE WAY

ICBO# 5269
10-4-03
Date of job completion

Plastering Contractor

Name VISION PLASTERING
Address: 3774 GREENBACK LANE ORANGEVALE, CA 95662
Telephone No. (415) 937-5321

Approved contractor as issued by Basalite/Pacific Stucco

This is to certify the exterior coating system at the above address, has been installed in accordance with the evaluation report specified above and the manufacturers instructions

[Signature]
Signature of authorized representative of
plastering contractor

10-15-03
Date

This installation card must be presented to the building inspector after completion of work and before final inspection.

LE L O HES
Division of PACIFIC COAST
building products