

**CITY OF SACRAMENTO**  
1231 I Street, Sacramento, CA 95814

**Permit No: 0113248**  
**Insp Area: 4**  
Thos Bros:  
**Sub-Type: NSFR**  
N

**Site Address: 329 ALCANTAR CR SAC**  
Parcel No: RIVERVIEW 2-3B LOT 17 Housing (Y/N):

CONTRACTOR  
D. R. HORTON INC.  
4401 HAZEL AVE STE 135  
FAIR OAKS, CA 95628

OWNER

ARCHITECT

**Nature of Work: NSFR MP1804 1 STORY 7 RMS**

**CONSTRUCTION LENDING AGENCY :** I hereby affirm under penalty of perjury that there is a construction lending agency for the performance of the work for which this permit is issued (Sec. 3097, Civ. C).

Lender's Name \_\_\_\_\_ Lender's Address \_\_\_\_\_

**LICENSED CONTRACTORS DECLARATION:** I hereby affirm under penalty of perjury that I am licensed under provisions of Chapter 9 (commencing with section 7000) of Division 3 of the Business and Professions Code and my license is in full force and effect.

License Class B License Number 750190 Date 10/15/01 Contractor Signature N. Collins

**OWNER-BUILDER DECLARATION:** I hereby affirm under penalty of perjury that I am exempt from the contractors License Law for the following reason (Sec. 7031.5, Business and Professions Code; any city or county which requires a permit to construct, alter, improve, demolish, or repair any structure, prior to its issuance, also requires the applicant for such permit to file a signed statement that he or she is licensed pursuant to the provisions of the Contractors License Law (Chapter 9 (commencing with Section 7000) of Division 8 of the Business and Professions Code) or that he or she is exempt therefrom and the basis for the alleged exemption. Any violation of Section 7031.5 by any applicant for a permit subjects the applicant to a civil penalty of not more than five hundred dollars (\$500.00);

\_\_\_\_ I, as a owner of the property, or my employees with wages as their sole compensation, will do the work, and the structure is not intended or offered for sale (Sec. 7044, Business and Professional Code: The Contractors License Law does not apply to an owner of property who builds or improves thereon, and who does such work himself or herself or through his/her own employees, provided that such improvements are not intended or offered for sale. If, however, the building or improvement is sold within one year of completion, the owner-builder will have the burden of proving that he/she did not build or improve for the purpose of sale.)

\_\_\_\_ I, as owner of the property, am exclusively contracting with licensed contractors to construct the project (Sec. 7044, Business and Professions Code: The Contractors License Law does not apply to an owner of property who builds or improves thereon, and who contracts for such projects with a contractor(s) licensed pursuant to the Contractors License Law).

\_\_\_\_ I am exempt under Sec. \_\_\_\_\_ B & PC for this reason: \_\_\_\_\_

Date \_\_\_\_\_ Owner Signature \_\_\_\_\_

**IN ISSUING THIS BUILDING PERMIT,** the applicant represents, and the city relies on the representation of the applicant, that the applicant verified all measurements and locations shown on the application or accompanying drawings and that the improvement to be constructed does not violate any law or private agreement relating to permissible or prohibited locations for such improvements. This building permit does not authorize any illegal location of any improvement or the violation of any private agreement relating to location of improvements.

I certify that I have read this application and state that all information is correct. I agree to comply with all city and county ordinances and state laws relating to building construction and hereby authorize representative(s) of this city to enter upon the abovementioned property for inspection purposes.

Date 10/15/01 Applicant/Agent Signature N. Collins

**WORKER'S COMPENSATION DECLARATION:** I hereby affirm under penalty of perjury one of the following declarations:

\_\_\_\_ I have and will maintain a certificate of consent to self-insure for workers' compensation as provided for by Section 3700 of the Labor Code, for the performance of work for which the permit is issued.

I have and will maintain workers' compensation insurance, as required by Section 3700 of the Labor Code, for the performance of the work for which this permit is issued. My workers' compensation insurance carrier and policy number are:

Carrier KEMPER INSURANCE CO Policy Number 5BR08354700 Exp Date 07/01/2002

\_\_\_\_ (This section need not be completed if the permit is for \$100 or less) I certify that in the performance of the work for which this permit is issued, I shall not employ any person in any manner so as to become subject to the workers' compensation laws of California and agree that if I should become subject to the workers' compensation provisions of Section 3700 of the Labor Code, I shall forthwith comply with those provisions.

Date 10/15/01 Applicant Signature N. Collins

**WARNING: FAILURE TO SECURE WORKERS COMPENSATION COVERAGE IS UNLAWFUL AND SHALL SUBJECT AN EMPLOYER TO CRIMINAL PENALTIES AND CIVIL FINES UP TO ONE HUNDRED THOUSAND DOLLARS (\$100,000) IN ADDITION TO THE COST OF COMPENSATION, DAMAGES AS PROVIDED FOR IN SECTION 3706 OF THE LABOR CODE, INTEREST AND ATTORNEYS FEE.**

**THIS PERMIT SHALL EXPIRE BY LIMITATION IF WORK IS NOT COMMENCED WITHIN 180 DAYS.**

RESIDENTIAL SUBDIVISION BUILDING PERMIT APPLICATION

Project Address: 329 Alcantara Circle Assessor Parcel # 225-090-017
Lot Number: 17 Subdivision RIVERVIEW #2, Unit #3-B

OWNER INFORMATION:

Legal Property Owner: D.R. Horton Phone# 965-2200
Owner Address: City State Zip

CONTRACTOR INFORMATION:

Contractor: DA HORTON Lic. # 750190 Phone # 965-2200 Fax 956-22

PROJECT INFORMATION:

Land Use Zone R1A Occupancy Group R3 Construction Type VN Fed Code 1A
No. of Stories: 1 No. of Rooms: 7 Street Width:
1st Floor Area 2nd Floor Area Basement Roof Material
AREA IN SQUARE FOOT OF:
Dwelling/Living 1804
Garage/Storage 460
Decks/Balconies 56
Carports
SCOPE OF WORK:

Information Above Complete AR Flood Waiver Required Planning Approval
Violation Files Checked Flood Elevation Certificate Required Design Review Approval
Standard Setbacks Water Development Infill Area Special Fee Districts Apply.
County Sewer
-THE FOLLOWING MUST BE PROVIDED IN ORDER TO SUBMIT FOR PERMIT-
[X] 2 COMPLETE PLOT PLANS, LEGIBLE & DRAWN TO SCALE
[X] 11 X 17 COPY OF FLOOR PLAN WITH FOLLOWING INFORMATION
a) Assessors Parcel Number c) Owners Name
b) New Floor Area d) Project Address

# CERTIFICATION OF INSULATION

ADDRESS OR TRACT

SACRAMENTO INSULATION CONTRACTORS

D.R. HORTON

LOT 173

- P.O. BOX 854, WEST SACRAMENTO, CA 95691 LIC. #202026
- 1309 MELODY ROAD, MARYSVILLE, CA 95901 LIC. #202026
- P.O. BOX 9651, FRESNO, CA 93793-9651 LIC. #202026
- P.O. BOX 1631, RENO, NV 89505 LIC. #10675
- 3326 A PONDEROSA WAY, LAS VEGAS, NV 89118 LIC. #10675

PARK WEST

DATE INSULATION COMPLETED

PART I GENERAL

PART II AREAS INSULATED

PART III CHECKS

| WALLS                         |                      | CEILING                         |                      |   | FLOORS                        |                      |
|-------------------------------|----------------------|---------------------------------|----------------------|---|-------------------------------|----------------------|
| ( SQUARE FEET)                |                      | ( SQUARE FEET)                  |                      |   | ( SQUARE FEET)                |                      |
| TYPE OF INSULATION            |                      | TYPE OF INSULATION              |                      |   | TYPE OF INSULATION            |                      |
| MATERIAL<br><b>FIBERGLASS</b> |                      | MATERIAL<br><b>FIBERGLASS</b>   |                      |   | MATERIAL<br><b>FIBERGLASS</b> |                      |
| FORM<br><b>BATTS</b>          |                      | FORM<br><b>BATTS &amp; BLOW</b> |                      |   | FORM<br><b>BATTS</b>          |                      |
| MANUFACTURER'S PRODUCT I.D.   |                      | MANUFACTURER'S PRODUCT I.D.     |                      |   | MANUFACTURER'S PRODUCT I.D.   |                      |
| MANUFACTURER                  |                      | MANUFACTURER                    |                      |   | MANUFACTURER                  |                      |
| <b>OCF</b>                    |                      | <b>OCF</b>                      |                      |   | <b>OCF</b>                    |                      |
|                               |                      | BAGS                            |                      |   |                               |                      |
| R-VALUE<br>INSTALLED          | APPLIED<br>THICKNESS | R-VALUE<br>INSTALLED            | APPLIED<br>THICKNESS | MIN. INSTALLED<br>WEIGHT PER<br>SQUARE FOOT | R-VALUE<br>INSTALLED          | APPLIED<br>THICKNESS |
| 13                            | 3 5/8"               | 30<br>30                        | 9"<br>12"            |   |                               |                      |

KNEE WALLS IF R-VALUE IS OTHER THAN WALLS ABOVE

|                               |                      |         |                            |
|-------------------------------|----------------------|---------|----------------------------|
| MATERIAL<br><b>FIBERGLASS</b> | FORM<br><b>BATTS</b> | R VALUE | MANUFACTURER<br><b>OCF</b> |
|-------------------------------|----------------------|---------|----------------------------|

AIR INFILTRATION SEALANT

|                         |                                  |
|-------------------------|----------------------------------|
| MATERIAL<br><b>FOAM</b> | MANUFACTURER<br><b>W R GRACE</b> |
|-------------------------|----------------------------------|

THIS IS TO CERTIFY THAT INSULATION AND/OR SEALANT HAS BEEN INSTALLED IN CONFORMANCE WITH APPLICABLE CODES, MATERIAL STANDARDS AND REGULATIONS.

|  |                  |                  |
|--|------------------|------------------|
| SIGNATURE - INSULATION CONTRACTOR<br><i>Jeff Cable</i> | TITLE<br>MANAGER | DATE<br>12-21-07 |
| SIGNATURE - GENERAL CONTRACTOR                         | TITLE            | DATE             |

REMARKS

17-3

# OMEGA PRODUCTS CORP.

DIAMOND WALL INSULATING STUCCO SYSTEM

JOB ADDRESS:

ICBO Report #4004

*D.R. Horton*  
*PAK VIEW*

Date of Job Completion *7/8/02*

PLASTERING CONTRACTOR:

Name: STUCCO WORKS INC.

Address: 5900 WAREHOUSE WAY, SACRAMENTO, CALIFORNIA 95826

Telephone No: (916) 383-6699

Contractor Number of Diamond Wall System 2175

This is to certify that the exterior coating system on the building exterior at the above address has been installed in accordance with the evaluation report specified above and the manufacturer's instructions.

Date 7/28/02

Signature of authorized representative of  
Plastering Contractor *[Signature]*

This installation card must be presented to the building inspector after completion of work and before final inspection.

34970.0001 11/20/01 Wood Rodgers, Inc.

2/12/01 10:00 AM  
55 8785 P. 1/17

THIS PLAN IS PREPARED TO SHOW THE DIMENSIONAL RELATIONSHIP FROM BUILDING FOUNDATION TO PROPERTY LINE, DESIGN DRAINAGE CONTROL ELEVATIONS, AND DIRECTION OF DRAINAGE FLOW TO CONFORM WITH LOCAL ORDINANCES FOR THE PURPOSE OF BUILDING PERMIT ISSUANCE. INFORMATION SHOWN IS APPROXIMATE EXCEPT FOR THOSE SETBACKS WHICH ARE MINIMUMS REQUIRED BY ORDINANCE. THIS PLOT DOES NOT REFLECT AS BUILT CONDITIONS WHICH WILL LIKELY VARY FROM THIS PLAN.

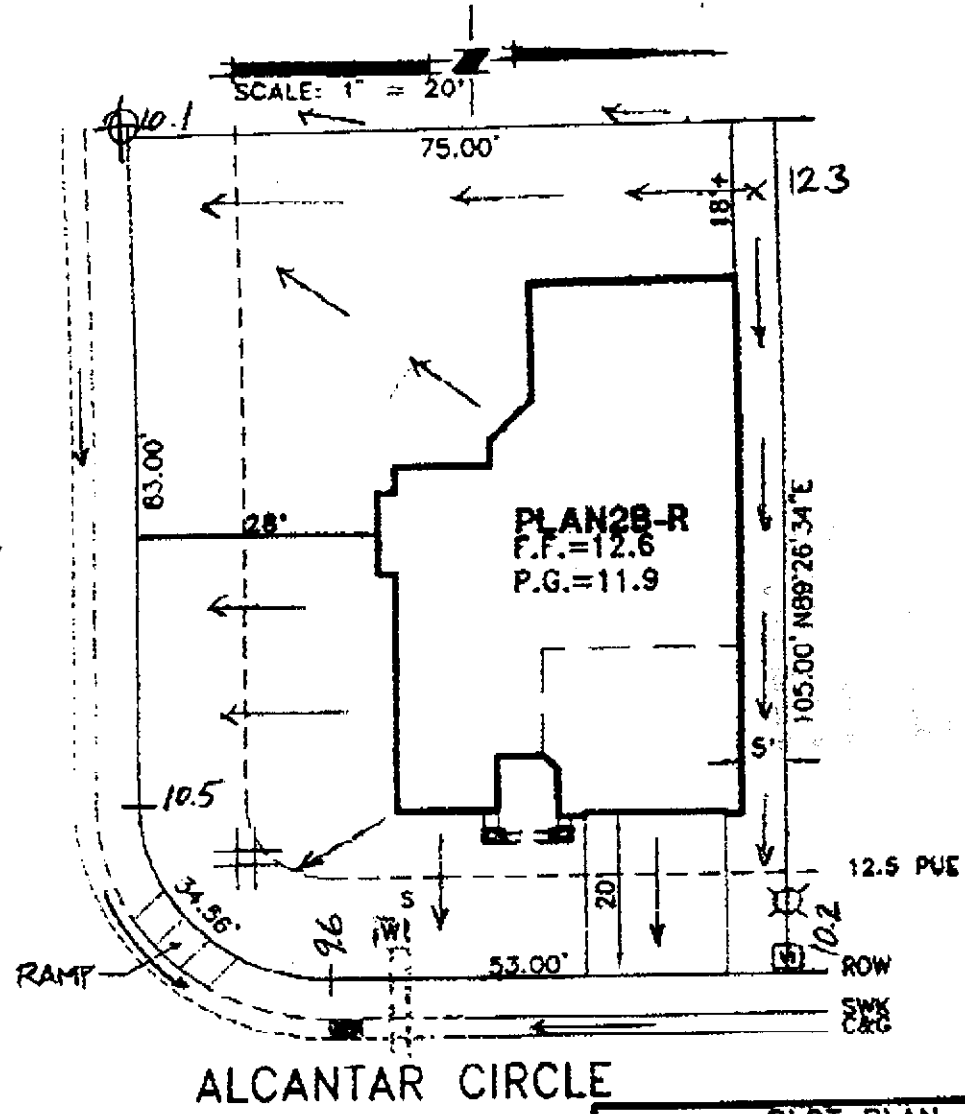

☉ = STREET LIGHT  
 ☐ = UTILITY BOX

**PLOT PLAN**  
**LOT 17 B**  
 RIVER VIEW #2, UNIT 3B  
 FOR  
 D.R. HORTON, INC.  
 SACRAMENTO CALIFORNIA

**WOOD RODGERS INC.**  
 GENERAL PLANNING ENGINEERING  
 2201 G STREET BLDG. 100-S SACRAMENTO, CA 95814  
 PHONE (916) 231-1700 FAX (916) 231-2782

|          |         |          |             |
|----------|---------|----------|-------------|
| DATE:    | DESIGN: | CHECKED: | PROJECT NO: |
| SEP 2001 | HMB/DAD | WRC      | 1055.014    |

FILE: J:\0085\GVIEW\GVIEW\CIVIL\PLOT PLANS\LOT 17B.DWG Last edited: 09/10/01 1:03 by: Dadey

OK