

CITY OF SACRAMENTO
1231 I Street, Sacramento, CA 95814

Permit No: 9907795
Insp Area: 4

Site Address: 34 SHADY ARBOR CT SAC
Parcel No: 274-0490-060

Sub-Type: NSFR
CALIFORNIA GARDENS LOT 64 Housing (Y/N): N

CONTRACTOR
KAUFMAN & BROAD
51 NORTH SUNRISE AV #1012
ROSEVILLE CA 95661

OWNER

ARCHITECT

Nature of Work: NEW HOME, MP1300, 7 ROOMS

CONSTRUCTION LENDING AGENCY: I hereby affirm under penalty of perjury that there is a construction lending agency for the performance of the work for which this permit is issued (Sec. 3097, Civ. C).

Lender's Name _____ Lender's Address _____

LICENSED CONTRACTORS DECLARATION: I hereby affirm under penalty of perjury that I am licensed under provisions of Chapter 9 (commencing with section 7000) of Division 3 of the Business and Professions Code and my license is in full force and effect.

License Class L License Number 27422 Date 8/20/99 Contractor Signature H. Collins

OWNER-BUILDER DECLARATION: I hereby affirm under penalty of perjury that I am exempt from the contractors License Law for the following reason (Sec. 7031.5, Business and Professions Code: any city or county which requires a permit to construct, alter, improve, demolish, or repair any structure, prior to its issuance, also requires the applicant for such permit to file a signed statement that he or she is licensed pursuant to the provisions of the Contractors License Law (Chapter 9 (commencing with Section 7000) of Division 8 of the Business and Professions Code) or that he or she is exempt therefrom and the basis for the alleged exemption. Any violation of Section 7031.5 by any applicant for a permit subjects the applicant to a civil penalty of not more than five hundred dollars (\$500.00).

I, _____, as a owner of the property, or my employees with wages as their sole compensation, will do the work, and the structure is not intended or offered for sale (Sec. 7044, Business and Professional Code: The Contractors License Law does not apply to an owner of property who builds or improves thereon, and who does such work himself or herself or through his/her own employees, provided that such improvements are not intended or offered for sale. If, however, the building or improvement is sold within one year of completion, the owner-builder will have the burden of proving that he/she did not build or improve for the purpose of sale.)

I, _____, as owner of the property, am exclusively contracting with licensed contractors to construct the project (Sec. 7044, Business and Professions Code. The Contractors License Law does not apply to an owner of property who builds or improves thereon, and who contracts for such projects with a contractor(s) licensed pursuant to the Contractors License Law)

I am exempt under Sec. _____ B & PC for this reason: _____

Date _____ Owner Signature _____

IN ISSUING THIS BUILDING PERMIT, the applicant represents, and the city relies on the representation of the applicant, that the applicant verified all measurements and locations shown on the application or accompanying drawings and that the improvement to be constructed does not violate any law or private agreement relating to permissible or prohibited locations for such improvements. This building permit does not authorize any illegal location of any improvement or the violation of any private agreement relating to location of improvements.

I certify that I have read this application and state that all information is correct. I agree to comply with all city and county ordinances and state laws relating to building construction and hereby authorize representative(s) of this city to enter upon the abovementioned property for inspection purposes.

Date 8/20/99 Applicant/Agent Signature H. Collins

WORKER'S COMPENSATION DECLARATION: I hereby affirm under penalty of perjury one of the following declarations:

I have and will maintain a certificate of consent to self-insure for workers' compensation as provided for by Section 3700 of the Labor Code, for the performance of work for which the permit is issued.

I have and will maintain workers' compensation insurance, as required by Section 3700 of the Labor Code, for the performance of the work for which this permit is issued. My workers' compensation insurance carrier and policy number are:

Carrier CCC Policy Number WC188899094 Exp Date 04-30-99

(This section need not be completed if the permit is for \$100 or less) I certify that in the performance of the work for which this permit is issued, I shall not employ any person in any manner so as to become subject to the workers' compensation laws of California and agree that if I should become subject to the workers' compensation provisions of Section 3700 of the Labor Code, I shall forthwith comply with those provisions.

Date _____ Applicant Signature H. Collins

WARNING - FAILURE TO SECURE WORKER'S COMPENSATION COVERAGE IS UNLAWFUL AND SHALL SUBJECT AN EMPLOYER TO CRIMINAL PENALTIES AND CIVIL FINES UP TO ONE HUNDRED THOUSAND DOLLARS (\$100,000) IN ADDITION TO THE COST OF COMPENSATION, DAMAGES AS PROVIDED FOR IN SECTION 3706 OF THE LABOR CODE, INTEREST AND ATTORNEY'S FEE.

THIS PERMIT SHALL EXPIRE BY LIMITATION IF WORK IS NOT COMMENCED WITHIN 180 DAYS.

K-B

WES PAC INSULATION

INSULATION CERTIFICATE

9907795

THIS IS TO CERTIFY THAT INSULATION HAS BEEN INSTALLED IN CONFORMANCE WITH CURRENT ENERGY REGULATIONS, CALIFORNIA ADMINISTRATIVE CODE, TITLE 24, STATE OF CALIFORNIA, IN THE BUILDING LOCATED AT:

California Gardens LOT # 64 Plat 1 w/vault
STREET 34 Shady Arbor Ct CITY Sacramento

EXTERIOR WALLS:

MANUFACTURER Jm THICKNESS/TYPE 3 1/2 R-VALUE 13

CEILINGS:

BATTS:
MANUFACTURER Jm THICKNESS/TYPE 12 R-VALUE 38

BLOWN IN:

MANUFACTURER Greenfiber THICKNESS/TYPE 10.3 R-VALUE 38

SQUARE FOOTAGE COVERED 797 NUMBER OF BAGS USED ~~27~~ 30

FLOORS:

MANUFACTURER _____ THICKNESS/TYPE _____ R-VALUE _____

SLAB ON GRADE:

MANUFACTURER _____ THICKNESS/TYPE _____ R-VALUE _____

WIDTH OF INSULATION _____ INCHES

FOUNDATION WALLS:

MANUFACTURER _____ THICKNESS/TYPE _____ R-VALUE _____

GENERAL CONTRACTOR _____

CALIFORNIA CONTRACTORS LICENSE # _____ DATE _____

SIGNATURE

TITLE

INSULATION CONTRACTOR WES PAC INSULATION, INC.

CALIFORNIA CONTRACTORS LICENSE # #487478 DATE _____

Robin Brown
SIGNATURE

Officer Best
TITLE

RESIDENTIAL BUILDING PERMIT APPLICATION

New Construction
 Addition
 Remodels
 Other

Project Address: _____ Assessor Parcel # 254 016 060

OWNER INFORMATION: Kaufman & Broad 66864

Legal Property Owner: Kaufman & Broad Phone # (707) 469-2400
 Owner Address: 611 Orange Drive City Vacaville, State Ca. Zip 95687

CONTRACTOR INFORMATION:

Contractor: Kaufman & Broad Lic. # 255425 / B Phone # (707) 469-2404 Fax # 469-2404

PROJECT INFORMATION:

Land Use Zone R1A Occupancy Group R3 Construction Type VN Fed Code 1A
 No. of stories: _____ No. of rooms: _____ Street width: _____
 1st Floor Area _____ 2nd Floor Area _____ Basement _____ Roof Material _____

AREA IN SQUARE FOOT OF:	<u>EXISTING</u>	<u>NEW</u>	
Dwelling/Living	_____	<u>1321</u>	_____
Garage/Storage	_____	<u>469</u>	_____
Decks/Balconies	_____	<u>184</u>	_____
Carports	_____	_____	_____

SCOPE OF WORK: _____

RECEIVED
JUN 30 1999

FOR OFFICE USE ONLY Building Inspection Division

- | | | |
|---|---|--|
| <input type="checkbox"/> Information above complete | <input type="checkbox"/> AR Flood Waiver required | <input type="checkbox"/> Planning Approval |
| <input type="checkbox"/> Violation files checked | <input type="checkbox"/> Flood Elevation Certificate Required | <input type="checkbox"/> Design Review Approval |
| <input type="checkbox"/> Standard setbacks | <input type="checkbox"/> Water Development Infill Area | <input type="checkbox"/> Special Fee Districts Apply : _____ |
| <input type="checkbox"/> County Sewer | | |

NEW STRUCTURES & ADDITIONS

❖ THE FOLLOWING MUST BE PROVIDED IN ORDER TO SUBMIT FOR PLAN REVIEW

- | | |
|---|---|
| <input type="checkbox"/> 2 COMPLETE PLANS, LEGIBLE & DRAWN TO SCALE
<input type="checkbox"/> 3 SETS IF PROJECT IS IN A DESIGN REVIEW AREA

<input type="checkbox"/> Title 24 Energy Compliance documentation
<input type="checkbox"/> Grading and Erosion Control Questionnaire | ❖ Plans to include: site plan, floor plan, elevations, roof/ceiling plan, foundation and structural framing details, and structural calculations for non-conforming structures.

<input type="checkbox"/> 11" x 17" copy of floor plan for County Assessor
<input type="checkbox"/> Plan Review Fees |
|---|---|

RECEIVED

JUN 24 1999

Date: _____ Received by: (staff) _____

ACTIVITY/PERMIT # _____
Building Inspection Division

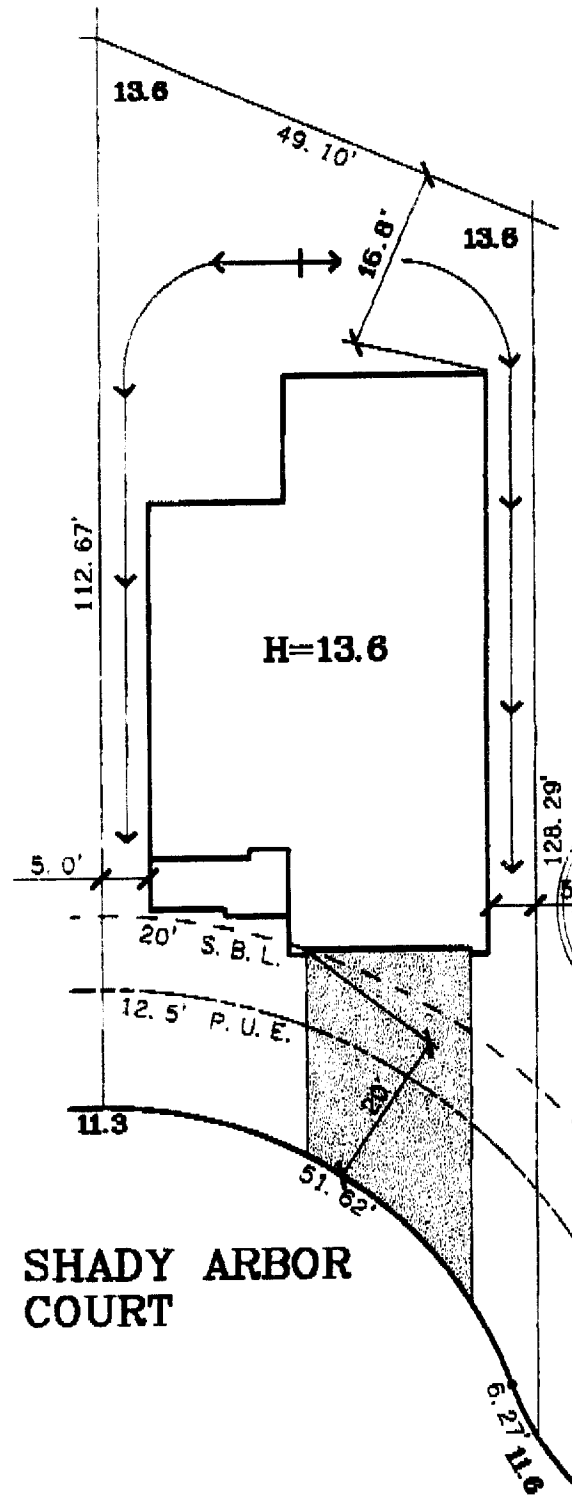
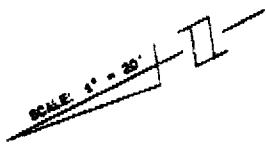

SHADY ARBOR COURT

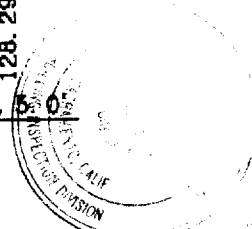

SHALL NOT be held responsible for any violation of any City Ordinance or State Law. The approval of this plan and specification Building Inspection Division shall not constitute any warranties or representations from the City of Sacramento and specifications must be made by the contractor at all times and it is the responsibility of the contractor to obtain all necessary permits from the Building Inspection Division.

DATE: 7-29-99
 A.P.N.:
 ADDRESS: 34 SHADY ARBOR COURT

LOT AREA: 5,057 SF
 LOT COVERAGE: 37%

The Splink Corporation
 2590 VENTURE OAKS WAY
 SACRAMENTO, CA. 95833
 PH (916)925-5550 FAX (916)921-9274

NATOMAS WEST VILLAGE 1
 LOT 64
 PLAN 1B

CALIFORNIA GARDENS
 CITY OF SACRAMENTO, CA
 CLIENT: KAUFMAN & BROAD