

CITY OF SACRAMENTO

1231 I Street, Sacramento, CA 95814

Permit No: 0101543

Insp Area: 4

Site Address: 3324 ZALEMA WY SAC
Parcel No: RIVERVIEW VILL 4A LOT 21

Sub-Type: NSFR
Housing (Y/N): N

CONTRACTOR OWNER
BEAZER HOMES
3009 DOUGLAS BL #150
ROSEVILLE CA 95661

ARCHITECT

Nature of Work: MP1509 1 STORY 8 ROOM SFR

CONSTRUCTION LENDING AGENCY : I hereby affirm under penalty of perjury that there is a construction lending agency for the performance of the work for which this permit is issued (Sec. 3097, Civ. C.).

Lender's Name _____ Lender's Address _____

LICENSED CONTRACTORS DECLARATION: I hereby affirm under penalty of perjury that I am licensed under provisions of Chapter 9 (commencing with section 7000) of Division 3 of the Business and Professions Code and my license is in full force and effect.

License Class B License Number 724191 Date 2/14/01 Contractor Signature Sheyf VanMaeren

OWNER-BUILDER DECLARATION: I hereby affirm under penalty of perjury that I am exempt from the contractors License Law for the following reason (Sec. 7031.5, Business and Professions Code; any city or county which requires a permit to construct, alter, improve, demolish, or repair any structure, prior to its issuance, also requires the applicant for such permit to file a signed statement that he or she is licensed pursuant to the provisions of the Contractors License Law (Chapter 9 (commencing with Section 7000) of Division 8 of the Business and Professions Code) or that he or she is exempt therefrom and the basis for the alleged exemption. Any violation of Section 7031.5 by any applicant for a permit subjects the applicant to a civil penalty of not more than five hundred dollars (\$500.00).

I, as a owner of the property, or my employees with wages as their sole compensation, will do the work, and the structure is not intended or offered for sale (Sec. 7044, Business and Professional Code). The Contractors License Law does not apply to an owner of property who builds or improves thereon, and who does such work himself or herself or through his/her own employees, provided that such improvements are not intended or offered for sale. If, however, the building or improvement is sold within one year of completion, the owner-builder will have the burden of proving that he/she did not build or improve for the purpose of sale.)

I, as owner of the property, am exclusively contracting with licensed contractors to construct the project (Sec. 7044, Business and Professions Code). The Contractors License Law does not apply to an owner of property who builds or improves thereon, and who contracts for such projects with a contractor(s) licensed pursuant to the Contractors License Law).

I am exempt under Sec _____ B & PC for this reason: _____

Date _____ Owner Signature _____

IN ISSUING THIS BUILDING PERMIT, the applicant represents, and the city relies on the representation of the applicant, that the applicant verified all measurements and locations shown on the application or accompanying drawings and that the improvement to be constructed does not violate any law or private agreement relating to permissible or prohibited locations for such improvements. This building permit does not authorize any illegal location of any improvement or the violation of any private agreement relating to location of improvements.

I certify that I have read this application and state that all information is correct. I agree to comply with all city and county ordinances and state laws relating to building construction and hereby authorize representative(s) of this city to enter upon the abovementioned property for inspection purposes.

Date 2/14/01 Applicant/Agent Signature Sheyf VanMaeren

WORKER'S COMPENSATION DECLARATION: I hereby affirm under penalty of perjury one of the following declarations:

I have and will maintain a certificate of consent to self-insure for workers' compensation as provided for by Section 3700 of the Labor Code, for the performance of work for which the permit is issued

I have and will maintain workers' compensation insurance, as required by Section 3700 of the Labor Code, for the performance of the work for which this permit is issued. My workers' compensation insurance carrier and policy number are:

Carrier LIBERTY MUTUAL INS CO. Policy Number WA2-651-004147-080 Exp Date 04/01/2001

(This section need not be completed if the permit is for \$100 or less) I certify that in the performance of the work for which this permit is issued, I shall not employ any person in any manner so as to become subject to the workers' compensation laws of California and agree that if I should become subject to the workers' compensation provisions of Section 3700 of the Labor Code, I shall forthwith comply with those provisions.

Date 2/14/01 Applicant Signature Sheyf VanMaeren

WARNING: FAILURE TO SECURE WORKER'S COMPENSATION COVERAGE IS UNLAWFUL AND SHALL SUBJECT AN EMPLOYER TO CRIMINAL PENALTIES AND CIVIL FINES UP TO ONE HUNDRED THOUSAND DOLLARS (\$100,000) IN ADDITION TO THE COST OF COMPENSATION, DAMAGES AS PROVIDED FOR IN SECTION 3706 OF THE LABOR CODE, INTEREST AND ATTORNEY'S FEE.

THIS PERMIT SHALL EXPIRE BY LIMITATION IF WORK IS NOT COMMENCED WITHIN 180 DAYS.

THIS PLOT PLAN IS NOT FOR SALES PURPOSES. THIS PLOT PLAN IS FOR THE PURPOSES OF INDICATING COMPLIANCE WITH ZONING SET BACKS, GENERAL DRAINAGE DIRECTION, AND APPROXIMATE UTILITY CONNECTION. ALL OTHER DATA SHOWN HEREON IS CONCEPTUAL. THIS PLOT PLAN DOES NOT REFLECT AS-BUILT CONDITION. RETAINING WALL ARE OPTIONAL AND MAY OR MAY NOT BE CONSTRUCTED.

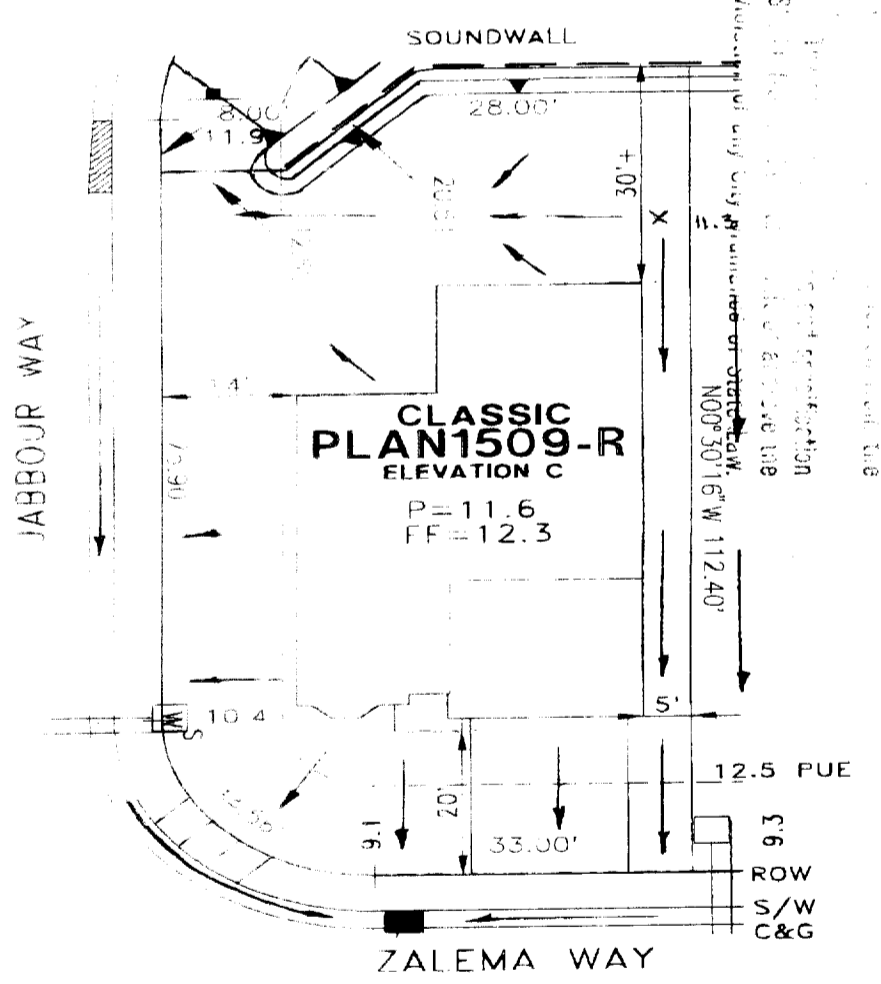

PLOT PLAN
LOT 21
RIVER VIEW #2 VILLAGE 4A
FOR
BEAZER HOMES
CITY OF SACRAMENTO CALIFORNIA

CIVIL ENGINEERING **SURVEYING**
MAPPING **PLANNING**

WOOD · RODGERS · INC.
3301 C STREET BLDG. 100B SACRAMENTO, CA 95816
TEL: 916/341-7760 FAX: 916/341-7767

DATE: JAN 2001	DRAWN: HMB	CHECKED:	PROJECT NO: 1055.015
-------------------	---------------	----------	-------------------------

J:\DOCS\RIVERVIEW\DWG\FROMRE\Y\UNIT2\PHASE4A\LOT PLAN\LOT1-715.WG 01/11/01 09:30

3324 ZALEMA

KWIKKOTE
STUCCO SYSTEM
INSTALLATION CARD

21115
BEAZER HOMES
CLASSICS OF SACRAMENTO LOT 21
3324 ZALEMA WAY SACRAMENTO

Stucco System Trade Name: KWIK KOTE
Name Stucco Manufacturer: KWIK KOTE CORP
ICBO Evaluation Service, Inc. Report No. 3607
Date of Job Completion 6-22-01

Stucco Contractor Kenyon Plastering, Inc.
Name John W. Kenyon, III
Address P.O. Box 2077
North Highlands, CA 95660
Telephone # (916) 349-8191

Approved Contractor Number as issued by the Stucco Manufacturer: 1

This is to certify that the stucco system on the building exterior at the above address had been installed in accordance with the evaluation report specified above and the manufacturer's instructions.

Signature of authorized representative of stucco contractor:

John A. Alvarez
Builder Copy

Date: 6-22-01

5374 2A 10M7

CERTIFICATION OF INSULATION

ADDRESS OR TRACT

SACRAMENTO INSULATION CONTRACTORS

BEAZER HOMES

LOT # 21

- P.O. BOX 854, WEST SACRAMENTO, CA 95891 LIC. #202026
- 1308 MELODY ROAD, MARYSVILLE, CA 95801 LIC. #202026
- P.O. BOX 9851, FRESNO, CA 93793-9851 LIC. #202026
- P.O. BOX 1831, RENO, NV 89505 LIC. #10875
- 3326 A PONDEROSA WAY, LAS VEGAS, NV 89118 LIC. #10875

CLASSICS

DATE INSULATION COMPLETED
6/11/01

WALLS		CEILING		FLOOR	
SQUARE FEET		SQUARE FEET		SQUARE FEET	
TYPE OF INSULATION		TYPE OF INSULATION		TYPE OF INSULATION	
MATERIAL FIBERGLASS		MATERIAL FIBERGLASS		MATERIAL FIBERGLASS	
FORM BATTS		FORM BATTS & BLOW		FORM BATTS	
MANUFACTURER'S PRODUCT I.D.		MANUFACTURER'S PRODUCT I.D.		MANUFACTURER'S PRODUCT I.D.	
MANUFACTURER OCF		MANUFACTURER OCF		MANUFACTURER OCF	
APPLIED THICKNESS 30		R VALUE 9"		APPLIED THICKNESS 30	
APPLIED THICKNESS 30		R VALUE 12"		APPLIED THICKNESS	

FOR KNEE WALLS (IF R VALUE IS OTHER THAN WALLS ABOVE)

MATERIAL FIBERGLASS	FORM BATTS	R VALUE	MANUFACTURER OCF
------------------------	---------------	---------	---------------------

AIR INFILTRATION SEALANT

MANUFACTURER W R GRACE

INSULATION AND SEALANT HAS BEEN INSTALLED IN CONFORMANCE WITH APPLICABLE CODES, STANDARDS AND REGULATIONS

INSULATION CONTRACTOR B. J. Mc...	TITLE MANAGER	DATE 5-18-01
GENERAL CONTRACTOR	TITLE	DATE

CERTIFICATION OF INSULATION

PART I GENERAL

ADDRESS OR TRACT <div style="font-size: 2em; font-family: cursive;">3324 Zalema Wy</div> LOT #20	SACRAMENTO INSULATION CONTRACTORS <input checked="" type="checkbox"/> P.O. BOX 854, WEST SACRAMENTO, CA 95691 LIC. #202026 <input type="checkbox"/> 1309 MELODY ROAD, MARYSVILLE, CA 95901 LIC. #202026 <input type="checkbox"/> P.O. BOX 9651, FRESNO, CA 93793-9651 LIC. #202026 <input type="checkbox"/> P.O. BOX 1631, RENO, NV 89505 LIC. #10675 <input type="checkbox"/> 3326 A PONDEROSA WAY, LAS VEGAS, NV 89118 LIC. #10675 DATE INSULATION COMPLETED
---	--

PART II AREAS INSULATED

WALLS		CEILINGS			FLOORS	
SQUARE FEET		SQUARE FEET)			(SQUARE FEET)	
TYPE OF INSULATION		TYPE OF INSULATION			TYPE OF INSULATION	
MATERIAL FIBERGLASS		MATERIAL FIBERGLASS			MATERIAL FIBERGLASS	
FORM BATTS		FORM BATTS & BLOW			FORM BATTS	
MANUFACTURER'S PRODUCT ID		MANUFACTURER'S PRODUCT ID			MANUFACTURER'S PRODUCT ID	
MANUFACTURER		MANUFACTURER			MANUFACTURER	
OCF		OCF			OCF	
R - VALUE INSTALLED	APPLIED THICKNESS	R - VALUE INSTALLED	APPLIED THICKNESS	MIN. INSTALLED WEIGHT PER SQUARE FOOT	R - VALUE INSTALLED	APPLIED THICKNESS
13		30				
		30				
KNEE WALLS IF R-VALUE IS OTHER THAN WALLS ABOVE						
MATERIAL FIBERGLASS		FORM BATTS			R VALUE OCF	
AIR INFILTRATION SEALANT						
MATERIAL FOAM				MANUFACTURER W R GRACE		

THIS IS TO CERTIFY THAT INSULATION AND/OR SEALANT HAS BEEN INSTALLED IN CONFORMANCE WITH APPLICABLE CODES, MATERIAL STANDARDS AND REGULATIONS.

PART III CERTIFICATION

SIGNATURE—INSULATION CONTRACTOR	TITLE MANAGER	DATE 5-29-1
SIGNATURE—GENERAL CONTRACTOR	TITLE	DATE
REMARKS		