

**THIS IS A 2 PART FORM
WRITE ON A FIRM SURFACE**

**USE BLACK INK BALL POINT PEN - PRESS FIRMLY
SIGN PERMIT APPLICATION**

Handwritten signature

CONSTRUCTION LENDING AGENCY

SITE ADDRESS

1 SPORTS PARKWAY

SUITE

INSR AREA
4

ASSESSOR
PARCEL NO

225.0070.000 PERMIT NO. 00140533

NAME OF APPLICANT

ADDRESS

ZIP CODE

PHONE NO.

LICENSED CONTRACTOR'S
BUSINESS OWNER

Arroyo Sign Co. 1051-46th Ave, Oakland

94661

510-533-7698

LICENSED CONTRACTORS DECLARATION

I hereby affirm under penalty of perjury that I am licensed under provisions of Chapter 7 commencing with Section 70000 of Division 3 of the Business and Professions Code and my license is in full force and effect

License Class C-45 License Number 314194

Date 11/22/08 Contractor Arroyo Sign Co.
(Signature)

OWNER - BUILDER DECLARATION

I hereby affirm under penalty of perjury that I am exempt from the Contractor's License Law for the following reason (See 70815, Business and Professions Code: Any city or county which requires a permit to construct, alter, improve, demolish, or repair any structure, prior to its issuance, also requires the applicant for such permit to file a certificate of insurance with the licensed pursuant to the provisions of the Contractor's License Law. I hereby declare that the above licensed pursuant to the provisions of the Contractor's License Law. My exemption is based on Section 70815 of Division 3 of the Business and Professions Code. Any contractor of Section 70815 by any applicant for a permit to construct, alter, improve, demolish, or repair any structure, shall have the same rights and remedies as if the contractor had been bonded.

I have and will maintain a certificate of consent to self-insure for workers' compensation as provided for by Section 4700 of the Labor Code for the performance of work for which the permit is issued.

I have and will maintain workers' compensation insurance for my employees and self-maintain workers' compensation insurance for myself. My workers' compensation insurance carrier and policy number is State of Calif

Permit Number 146-00 UNIT 0000365

This section need not be completed if the permit is for one hundred dollars (\$100) or less. I certify that on the performance of the work for which the permit is issued, I shall not employ any person or persons, as to become subject to the workers' compensation laws of California and that the person or persons who shall be employed by me shall be insured pursuant to Section 4700 of the Labor Code and I shall maintain compliance with those provisions.

Date 12/22/08 Applicant Arroyo Sign Co.

Signature of Licensed Contractor
Signature of Owner/Builder
City of Sacramento Permit Services
264-7619

THIS PERMIT SHALL EXPIRE BY LIMITATION IF WORK AUTHORIZED IS NOT COMMENCED WITHIN 180 DAYS.

SIGN INFORMATION

- ATTACHED
- INTERIOR / ELECT
- SINGLE FACED
- UNLIMINATED
- NON UNLIMINATED
- BILLBOARD / SUBDIVISION
- INDIVIDUAL LETTERS
- PAINTED ON BUILDING
- LOGO
- METAL
- POLE
- DOUBLE FACED
- PLASTIC
- MONUMENT
- VINYL/GATOR FOAM
- WOODEN
- PROJECTING
- RE-FACE

SIGN COPY 1 Sacramento Kings / In search of

2 SACRAMENTO KINGS SACRAMENTO HONORS

in full liability with PEPSI

State of Calif

(A) HEIGHT: 12'11" (B) LENGTH: 18'-6"

(A X B) SIGN AREA: 18.5 SQ FT

POLE SIZE: _____ FOOTING SIZE: _____

STREET FRONTAGE (FT): _____

OCCUPANCY FRONTAGE (FT): _____

OFFICE USE ONLY

ENGINEERING REQUIRED: YES NO APPROVED BY: _____

DESIGN REVIEW REQUIRED: YES NO APPROVED BY: _____

SPECIAL PERMIT REQUIRED: YES NO # _____

VARIANCE REQUIRED: YES NO # _____

LOOK AHEAD REQUIRED: YES NO WHICH PLD: EXX

SIGN VIOLATION

LOCAL INSPECTIONS

BUILDING INSPECTOR: D. Paolini DATE: 12-7-00

FIELD INSPECTOR: _____ DATE: _____

DATE RECEIVED: _____ AMOUNT: _____

TOTAL FEES \$ _____

PERMIT NO. 00140533

DATE 11/22/08

AMOUNT 7500



ARCO
ARENA

1051 46th Avenue
Oakland, CA 94601
Phone 510.533.7693
Fax. 510.533.0815
Lic. #314794

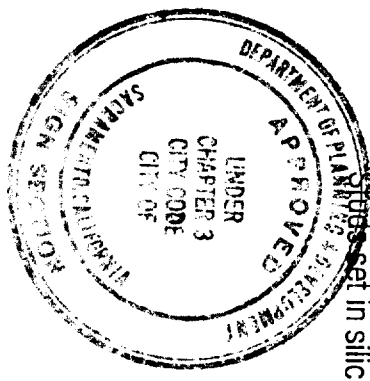
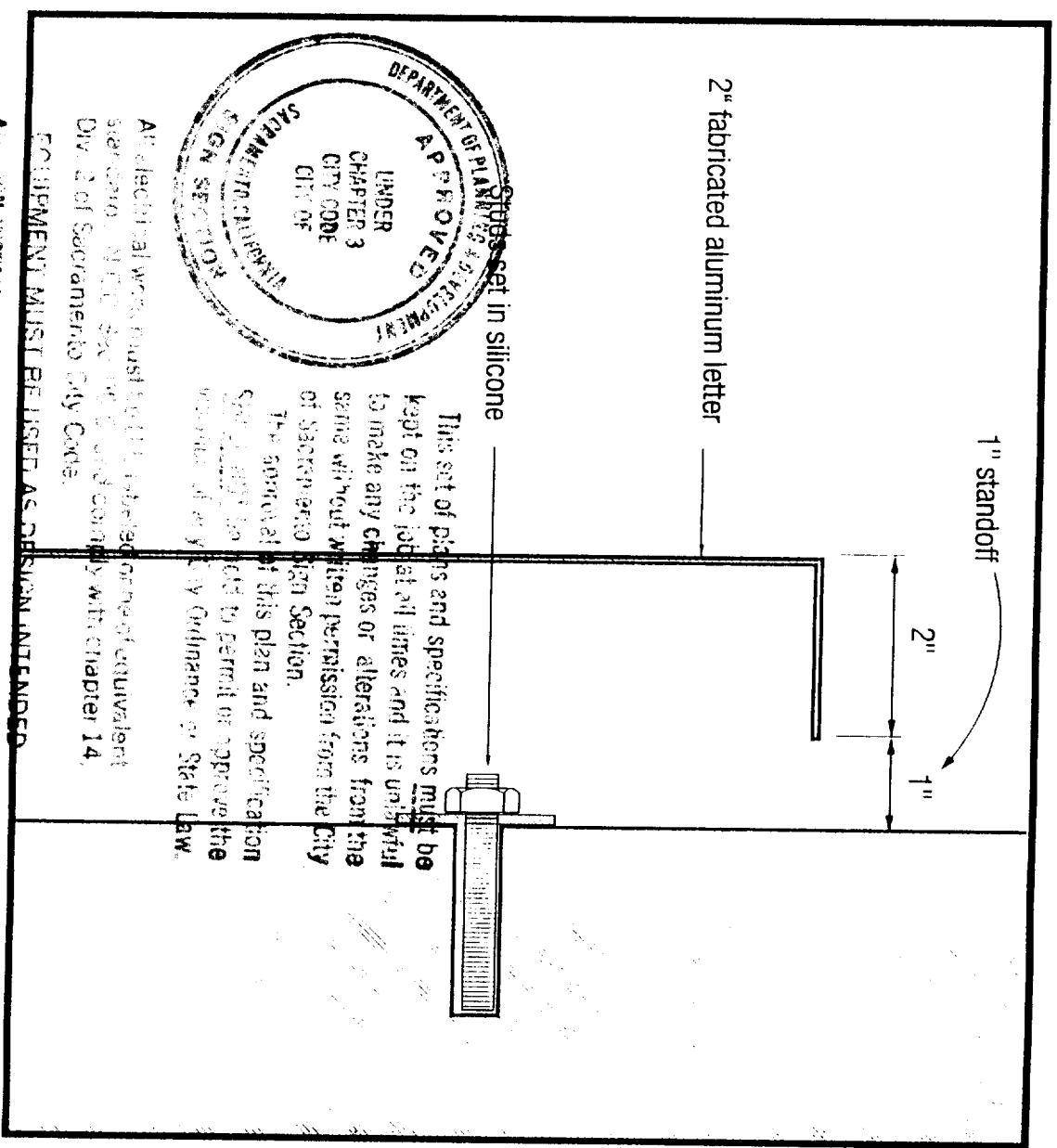

All electrical work must be performed in accordance with the California Electrical Code, Chapter 25, and comply with Chapter 14, Equipment, as amended.

This set of plans and specifications must be kept on the job at all times and it is unlawful to make any changes or alterations from the same without written permission from the City of Sacramento Sign Section. The approval of this plan and specification shall not be construed to permit or approve the work unless it is done in accordance with the City Ordinance or State Law.

Mounting Detail

2" deep fabricated letter

full scale

A Building Entry Identification

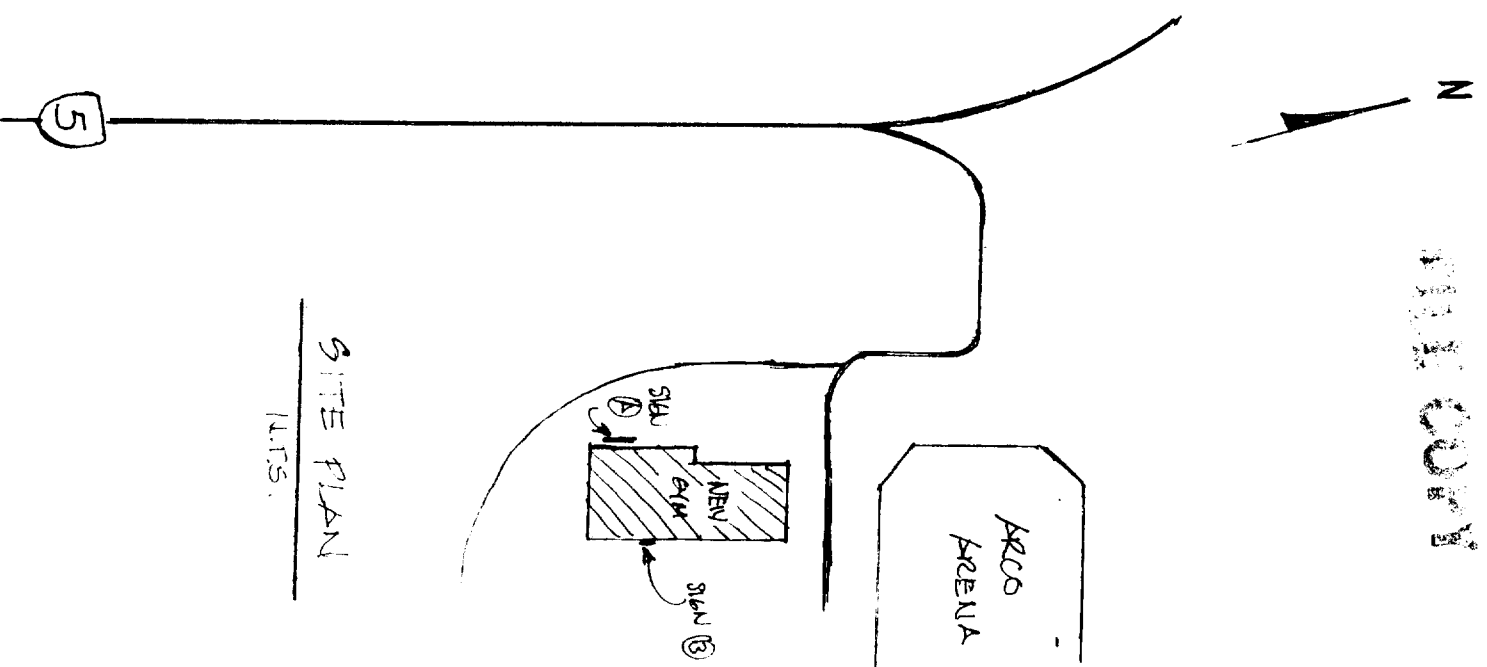

Job Name: Sacramento Kings
Address: Arco Arena
City: Sacramento, CA
Date: 11-21-00
Sales: Neil Febus
Design: G. Hopkins
Design: 01147
Filename: Sac Kings Sign
Sheet 1

Customer Approval:

Version	Date	Description

This is an original architectural drawing prepared for you by Arrow Sign Co. in a sign program designed for your business. It is not to be shown to anyone outside of your organization nor to be reproduced, copied or exhibited in any fashion.

11.21.00



1051 46th Avenue
Oakland, CA 94601
Phone 510.533.7693
Fax 510.533.0815
Lic. #314794

Job Name: Sacramento Kings
Address: Arco Arena
City: Sacramento, CA
Date: 11-21-00
Sales: Neil Febus
Design: G. Hopkins
Design #: 01147
Filename: Sac. Kings Sign
Sheet 2

Customer Approval: _____
Revision Date Description

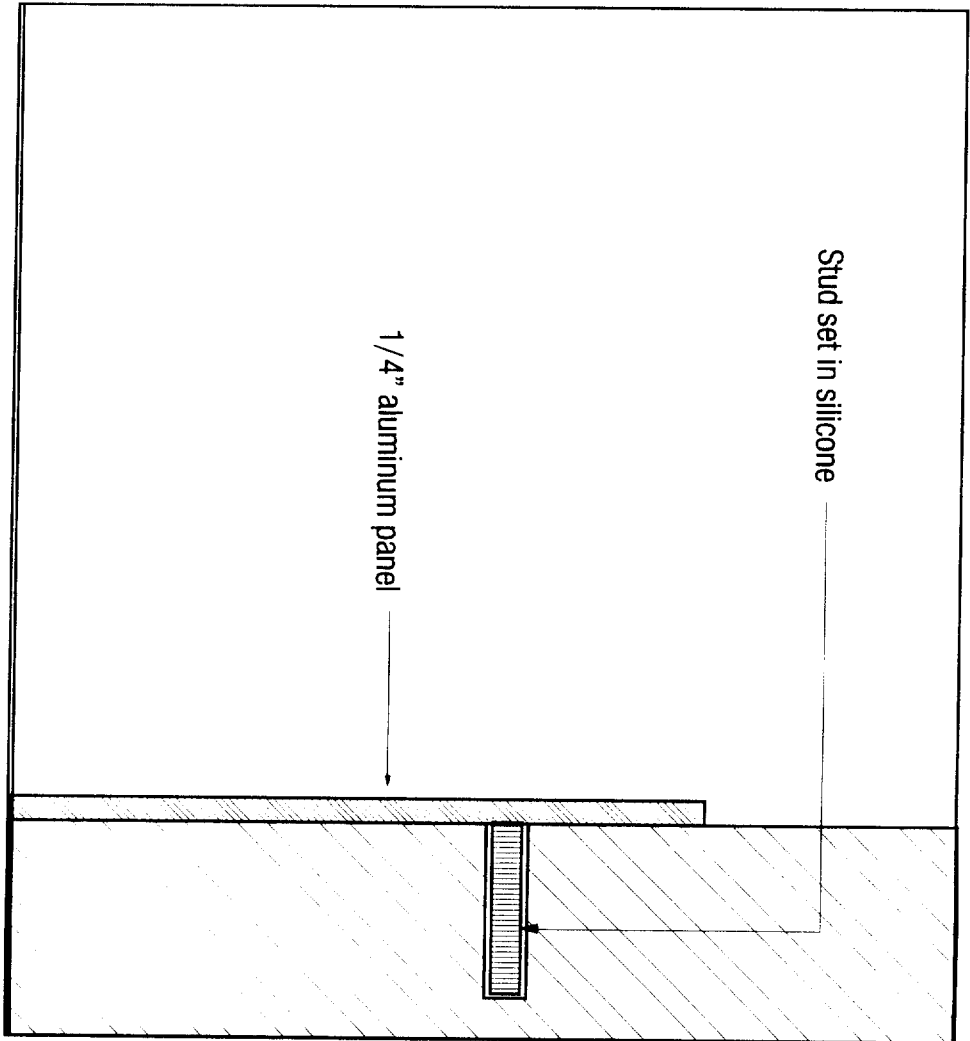

Mounting Detail
FCO Letters with studs

B Directional Sign

This is an original unaltered drawing prepared for you by Arrow Sign Co. in a sign program designed for your business. It is not to be shown to anyone outside of your organization nor to be reproduced, copied or published in any fashion.

Scale : 1/4" = 1'-0"

18'-6" (A)

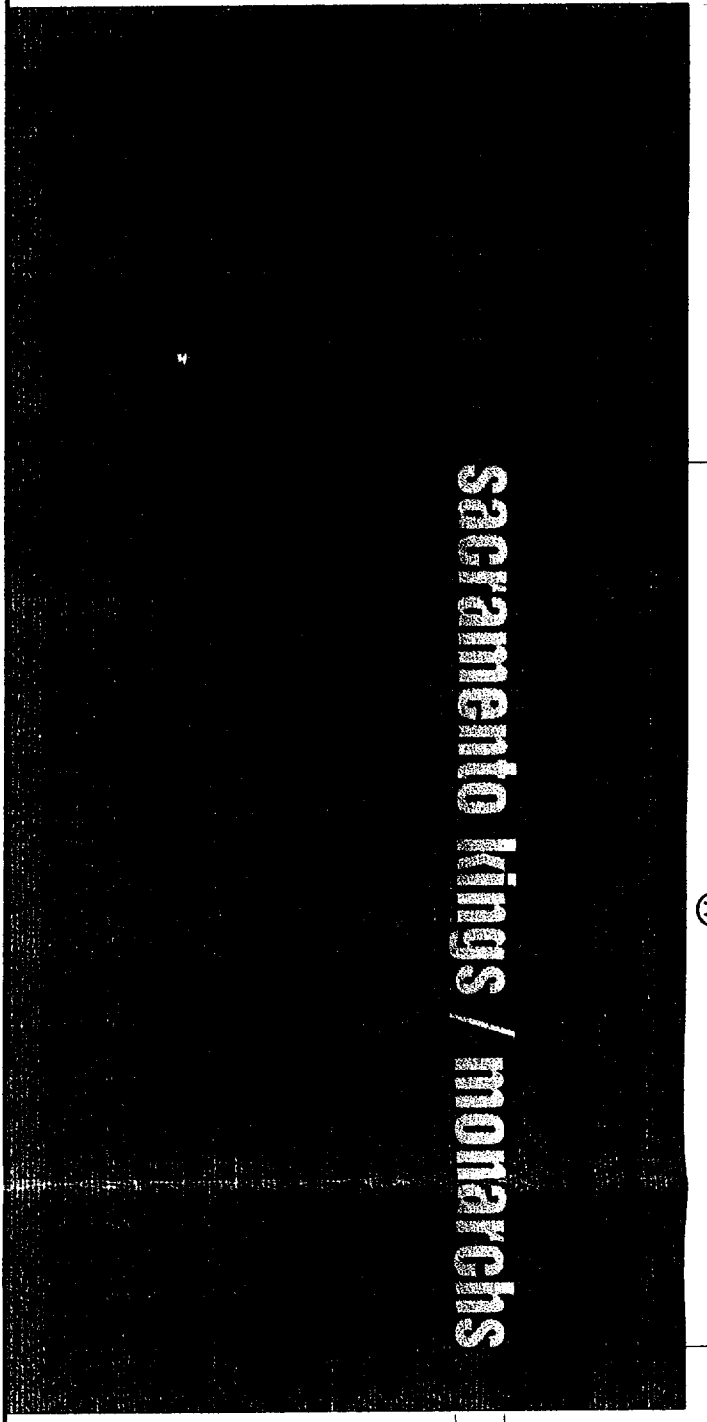
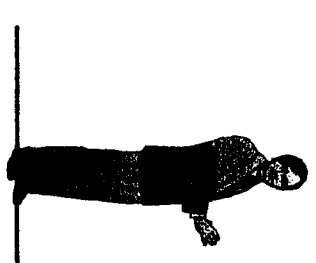

12" 92"

End View

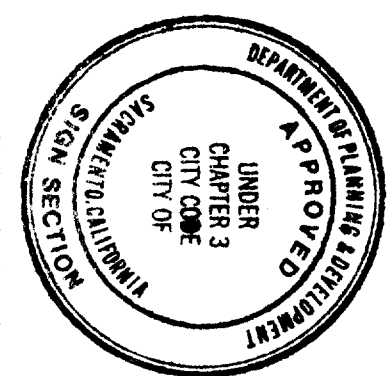

This set of plans and specifications must be kept on the job at all times and it is unlawful to make any changes or alterations from the same without written permission from the City of Sacramento Sign Section.
The approval of this plan and specification SHALL NOT be held to permit or approve the violation of any City Ordinance or State Law.

Face View

Scale : 1/4" = 1'-0"

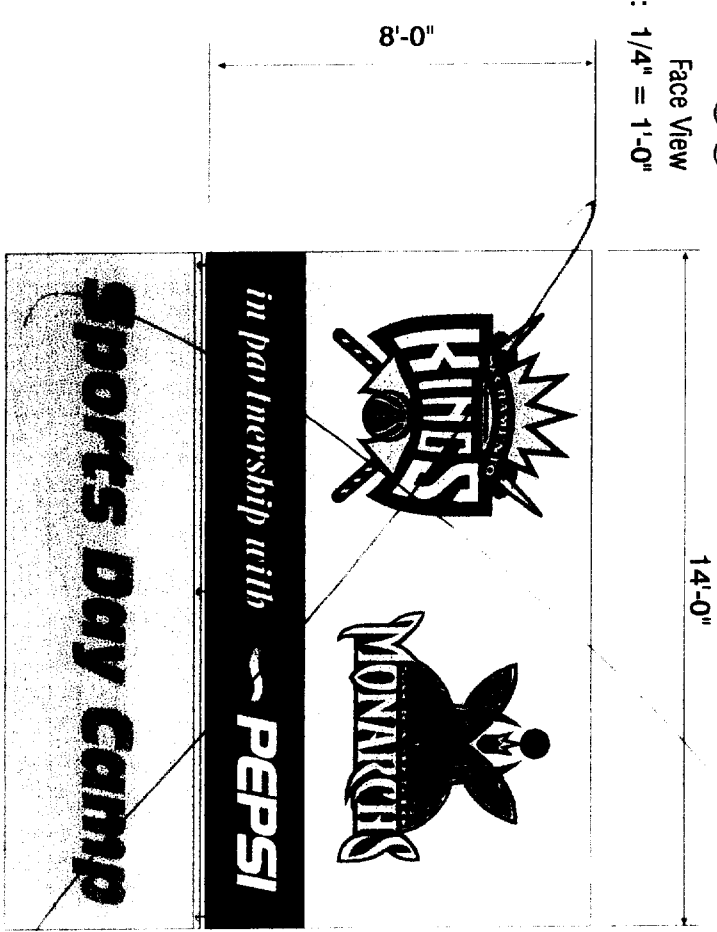

14'-0"

8'-0"

All electrical work must be U.L. labeled or be of equivalent standards, N.E.C. Sec. 90-6/ and comply with chapter 14 Div. 2 of Sacramento City Code
EQUIPMENT MUST BE USED AS DESIGN INTENDED
ALL SIGN INSTALLATIONS ARE SUBJECT TO FIELD INSPECTIONS

- (B) Wall Signs
- (C) **Manufacture & install two (2) new single-faced wall displays**

Signs fabricated with .090 aluminum skins over 3" aluminum angle framing
Paint aluminum faces white, paint 3" returns black.
Team logos c/o from .250 aluminum sheet. Digital image printed graphics on vinyl applied to aluminum.
Logos are blind stud mounted to backgrounds 1" from surface.
Provide hooks on bottom of sign panels for temporary attachment of banners.
Verify type and size of hooks. 3 hooks are shown. Size of banners TBD.
Banner material could be sewn with hem/sleeve @ top for insertion of metal rod to slide over hooks on bottom of signs. Banner material would require cut outs for access to hooks.

* M14053
922412

Approved
 Approved with changes noted

TA 118b r1 00.cdr Peter McGoldrick
DESIGN NUMBER DRAWN BY
Sacramento Kings Monarchs r1
FILE NAME CHECKED BY
Karin Tucker April 17, 2000
SALESPERSON DATE
April 20, 2000
REVISIONS DATE



Sacramento Kings Monarchs Practice Facility, Sacramento, CA

This original artwork is protected under Federal Copyright Laws. Make no reproduction of this design concept without permission from TubeArt.

TubeArt
Signs & Sports Displays
4243-A SE International Way
Milwaukie, OR 97222
TEL 503 653 1133
USA 1-800-562-2854
FAX 503 659 9191

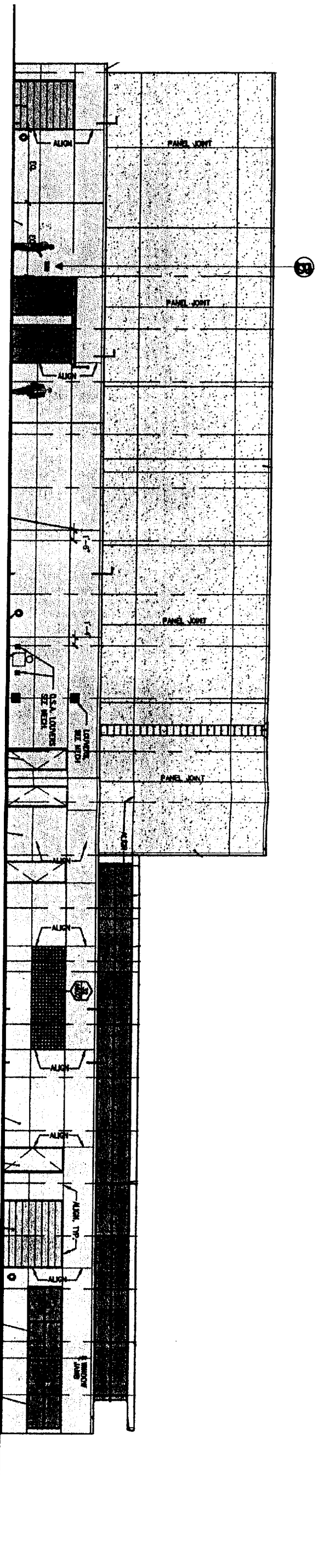

NORTH ELEVATION

SCALE: 1/16" = 1'-0"

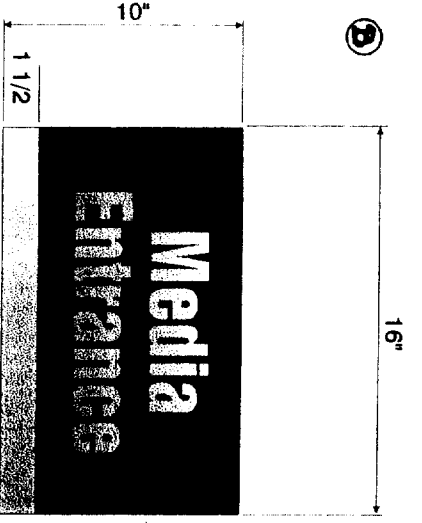

2 1/2" Caps

B Directional Sign
Manufacture & install one (1) new non illuminated directional

Sign panel fabricated from 250 aluminum. Overlay with brushed finish "WRISCO" (vertical grain)
 Paint wrisco to match PMS 266 purple. Mask out for 1/4" copy and accent stripe at bottom.
 Blind stud mount sign panel to wall surface adjacent to entry.
 Exact mounting position TBD with survey.

Scale: 1 1/2" = 1'-0"

TubeArt
 Signs & Sports Displays
 4243-A SE International Way
 Milwaukie, OR 97222
 TEL 503 653 1133
 USA 1-800-562-2854
 FAX 503 659 9191

TA 1188 r1 00.cdr
 DESIGN NUMBER
 Sacramento Kings Monarchs 11
 FILE NAME
 Kevin Tucker
 SALESPERSON
 Peter McGoldrick
 DRAWN BY
 CHECKED BY
 April 17, 2000
 DATE
 April 20, 2000
 REVISIONS
 Approved
 Approved with changes noted
 CUSTOMER SIGNATURE
 LANDLORD SIGNATURE
 DATE
 DATE

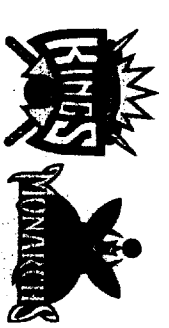

Sacramento Kings Monarchs Practice Facility, Sacramento, CA

This original artwork is protected under Federal Copyright Laws. Make no reproduction of this design concept without permission from TubeArt.