

CITY OF SACRAMENTO
1231 I Street, Sacramento, CA 95814

Permit No: 0102476
Insp Area: 4

Site Address: 2300 SWAINSON WY SAC
Parcel No: SHOREBIRD UNIT 2 LOT 78

Sub-Type: NSFR
Housing (Y/N): N

CONTRACTOR
CITATION NORTHERN
597 CENTER AVE. STE 150
MARTINEZ CAL. 94553

OWNER

ARCHITECT

Nature of Work: MP 2142 10 ROOM SFR (MP 2505 W/O 2ND STORY)

CONSTRUCTION LENDING AGENCY: I hereby affirm under penalty of perjury that there is a construction lending agency for the performance of the work for which this permit is issued (Sec. 3097, Civ. C)

Lender's Name _____ Lender's Address _____

LICENSED CONTRACTORS DECLARATION: I hereby affirm under penalty of perjury that I am licensed under provisions of Chapter 9 (commencing with section 7000) of Division 3 of the Business and Professions Code and my license is in full force and effect.

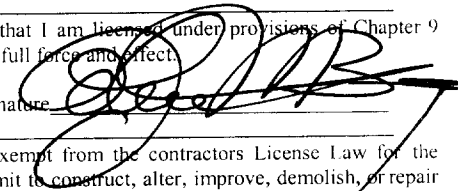
License Class B License Number 547764 Date 3-9-01 Contractor Signature 

OWNER-BUILDER DECLARATION: I hereby affirm under penalty of perjury that I am exempt from the contractors License Law for the following reason (Sec. 7031.5, Business and Professions Code): any city or county which requires a permit to construct, alter, improve, demolish, or repair any structure, prior to its issuance, also requires the applicant for such permit to file a signed statement that he or she is licensed pursuant to the provisions of the Contractors License Law (Chapter 9 (commencing with Section 7000) of Division 8 of the Business and Professions Code) or that he or she is exempt therefrom and the basis for the alleged exemption. Any violation of Section 7031.5 by any applicant for a permit subjects the applicant to a civil penalty of not more than five hundred dollars (\$500.00).

I, as a owner of the property, or my employees with wages as their sole compensation, will do the work, and the structure is not intended or offered for sale (Sec. 7044, Business and Professions Code). The Contractors License Law does not apply to an owner of property who builds or improves thereon, and who does such work himself or herself or through his/her own employees, provided that such improvements are not intended or offered for sale. If, however, the building or improvement is sold within one year of completion, the owner-builder will have the burden of proving that he/she did not build or improve for the purpose of sale.

I, as owner of the property, am exclusively contracting with licensed contractors to construct the project (Sec. 7044, Business and Professions Code). The Contractors License Law does not apply to an owner of property who builds or improves thereon, and who contracts for such projects with contractor(s) licensed pursuant to the Contractors License Law.

I am exempt under Sec. _____ B & PC for this reason: _____

Date 3-9-01 Owner Signature _____

IN ISSUING THIS BUILDING PERMIT, the applicant represents, and the city relies on the representation of the applicant, that the applicant verified all measurements and locations shown on the application or accompanying drawings and that the improvement to be constructed does not violate any law or private agreement relating to permissible or prohibited locations for such improvements. This building permit does not authorize any illegal location of any improvement or the violation of any private agreement relating to location of improvements.

I certify that I have read this application and state that all information is correct. I agree to comply with all city and county ordinances and state laws relating to building construction and hereby authorize representative(s) of this city to enter upon the above-mentioned property for inspection purposes.

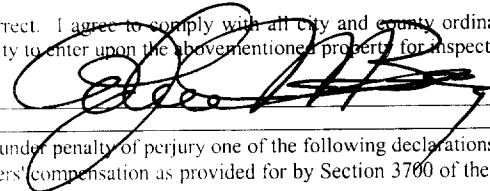
Date 3-9-01 Applicant Agent Signature 

WORKER'S COMPENSATION DECLARATION: I hereby affirm under penalty of perjury one of the following declarations:

I have and will maintain a certificate of consent to self-insure for workers' compensation as provided for by Section 3700 of the Labor Code, for the performance of work for which the permit is issued.

I have and will maintain workers' compensation insurance, as required by Section 3700 of the Labor Code, for the performance of the work for which this permit is issued. My workers' compensation insurance carrier and policy number are:

Carrier FREMONT IND. CO. Policy Number WN99-70750-03 Exp Date 06/30/2001

(This section need not be completed if the permit is for 2000 or less square feet) I shall not employ any person in any manner so as to become subject to the workers' compensation laws of California and agree that if I should become subject to the workers' compensation provisions of Section 3700 of the Labor Code, I shall forthwith comply with those provisions.

Date 3-9-01 Applicant Signature 

WARNING - FAILURE TO SECURE WORKER'S COMPENSATION COVERAGE IS UNLAWFUL AND SHALL SUBJECT AN EMPLOYER TO CRIMINAL PENALTIES AND CIVIL FINES UP TO ONE HUNDRED THOUSAND DOLLARS (\$100,000) IN ADDITION TO THE COST OF COMPENSATION, DAMAGES AS PROVIDED FOR IN SECTION 3706 OF THE LABOR CODE, INTEREST AND ATTORNEY'S FEE.

THIS PERMIT SHALL EXPIRE BY LIMITATION IF WORK IS NOT COMMENCED WITHIN 180 DAYS.



**INSULATION CONTRACTORS
ASSOCIATION
OF AMERICA**

INSULATION
CERTIFICATE

69514

1321 DUKE STREET, SUITE 303 • ALEXANDRIA, VA 22314 • (703) 739-0356

THIS IS TO CERTIFY THAT INSULATION HAS BEEN INSTALLED IN CONFORMANCE WITH CURRENT ENERGY REGULATIONS, CALIFORNIA ADMINISTRATIVE CODE, TITLE 24, STATE OF CALIFORNIA, IN THE BUILDING LOCATED AT:

CITY Atlanta LOT # 78 TRACT # Shoreland
2300 Swainson
STREET Swainson way 2300 CITY SAC

EXTERIOR WALLS:

MANUFACTURER _____ THICKNESS/TYPE _____ VALUE _____ R-

CEILINGS:

BATTS: MANUFACTURER _____ THICKNESS/TYPE _____ VALUE _____ R-

BLOWN IN: MANUFACTURER _____ THICKNESS/TYPE _____ VALUE _____ R-
OT 143/4 38

MANUFACTURER _____ THICKNESS/TYPE _____ VALUE _____ R-
115 28

FLOORS: SQUARE FOOTAGE COVERED _____ NUMBER OF BAGS USED _____ R-
115 28

MANUFACTURER _____ THICKNESS/TYPE _____ VALUE _____ R-
115 28

SLAB ON GRADE: MANUFACTURER _____ THICKNESS/TYPE _____ VALUE _____ R-
115 28

MANUFACTURER _____ THICKNESS/TYPE _____ VALUE _____ R-
115 28

WIDTH OF INSULATION _____ INCHES _____ R-
115 28

FOUNDATION WALLS: MANUFACTURER _____ THICKNESS/TYPE _____ VALUE _____ R-
115 28

GENERAL CONTRACTOR _____ DATE _____

CALIFORNIA CONTRACTORS LICENSE # _____ TITLE _____

INSULATION CONTRACTOR **ARCADE INSULATION** _____ DATE 7-29

CALIFORNIA CONTRACTORS LICENSE #263784 _____ TITLE _____

SIGNATURE _____ SIGNATURE _____

RESIDENTIAL BUILDING PERMIT APPLICATION

New Construction Addition Remodels Other

Project Address: LOT 7B SHOREBIRD UNIT II Assessor Parcel # _____

OWNER INFORMATION: 2300 SWANSON STREET 0102476

Legal Property Owner: Citation Northern Phone # 925-372-0300
Owner Address: 597 Center Ave., Suite 150 City Martinez State CA Zip 94553

CONTRACTOR INFORMATION:

Contractor: Citation Northern Lic. # 547764 Phone # 925-372-0300 Fax # 925-228-1833

PROJECT INFORMATION:

Land Use Zone _____	Occupancy Group _____	Construction Type _____	Fed Code _____
No. of stories: <u>1</u>	No. of rooms: <u>10</u>	Street width: <u>40 + RW</u>	
1 st Floor Area <u>2142</u>	2 nd Floor Area _____	Basement _____	Roof Material _____
AREA IN SQUARE FOOT OF:		EXISTING	NEW
Dwelling/Living		_____	<u>2142</u>
Garage/Storage		_____	<u>561</u>
Decks/Balconies		_____	_____
Carports		_____	<u>2703</u>
SCOPE OF WORK: <u>single family</u>		<u>Plan 21 Master</u>	

FOR OFFICE USE ONLY

- Information above complete
- AR Flood Waiver required
- Planning Approval
- Violation files checked
- Flood Elevation Certificate Required
- Design Review Approval
- Standard setbacks
- Water Development Infill Area
- Special Fee Districts Apply: _____
- County Sewer

NEW STRUCTURES & ADDITIONS

◆ THE FOLLOWING MUST BE PROVIDED IN ORDER TO SUBMIT FOR PLAN REVIEW

- 2 COMPLETE PLANS, LEGIBLE & DRAWN TO SCALE
- 3 SETS IF PROJECT IS IN A DESIGN REVIEW AREA
- ◆ Plans to include: site plan, floor plan, elevations, roof/celling plan, foundation and structural framing details, and structural calculations for non-conforming structures.
- Title 24 Energy Compliance documentation
- 11" x 17" copy of floor plan for County Assessor
- Grading and Erosion Control Questionnaire
- Plan Review Fees

Date: _____ Received by: (staff) _____



residentialapp (rev 3/03/99)

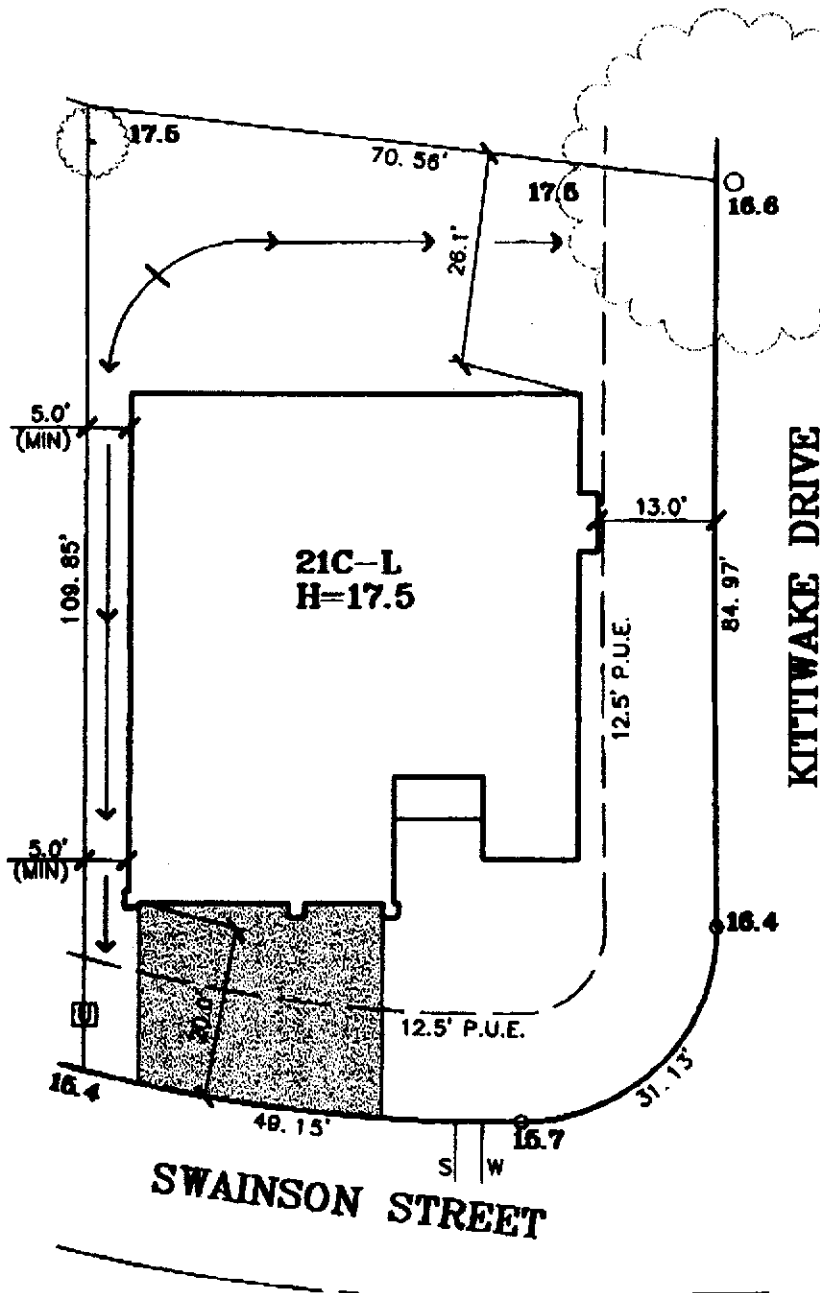

This plan and specification shall not be held to permit or approve the violation of any City Ordinance or State Law.



DATE: 1-29-01
 A.P.N.:
 ADDRESS: SWAINSON STREET

LOT AREA: 7,633 SF
 LOT COVERAGE: 36%

The Splink Corporation
 2590 VENTURE OAKS WAY
 SACRAMENTO, CA 95833
 PH (916)925-5550 FAX (916)921-9274

SHOREBIRD
 UNIT NO. 2
 LOT 78
 PLAN 21C

SHOREBIRD
 CITY OF SACRAMENTO, CA
 CLIENT: CITATION NORTHERN
 JOB NO.: 1579-001