

CITY OF SACRAMENTO

Permit No: 0116089

1231 I Street, Sacramento, CA 95814

Insp Area: 4

Site Address: 460 ALCANTAR CR SAC

Thos Bros:

Parcel No: 002-2564-006

RIVERVIEW 2-3B LOT 3

Sub-Type: NSFR

Housing (Y/N): N

CONTRACTOR

OWNER

ARCHITECT

D. R. HORTON INC.
4401 HAZEL AVE STE 135
FAIR OAKS, CA 95628

Nature of Work: MP 2126/FLEX 2 STORY 10 ROOM NSFR

CONSTRUCTION LENDING AGENCY : I hereby affirm under penalty of perjury that there is a construction lending agency for the performance of the work for which this permit is issued (Sec. 3097, Civ. C).

Lender's Name Lender's Address

LICENSED CONTRACTORS DECLARATION: I hereby affirm under penalty of perjury that I am licensed under provisions of Chapter 9 (commencing with section 7000) of Division 3 of the Business and Professions Code and my license is in full force and effect.

License Class B License Number 750190 Date 12/24/01 Contractor Signature D. Collins

OWNER-BUILDER DECLARATION: I hereby affirm under penalty of perjury that I am exempt from the contractors License Law for the following reason (Sec. 7031.5, Business and Professions Code; any city or county which requires a permit to construct, alter, improve, demolish, or repair any structure, prior to its issuance, also requires the applicant for such permit to file a signed statement that he or she is licensed pursuant to the provisions of the Contractors License Law (Chapter 9 (commencing with Section 7000) of Division 8 of the Business and Professions Code) or that he or she is exempt therefrom and the basis for the alleged exemption. Any violation of Section 7031.5 by any applicant for a permit subjects the applicant to a civil penalty of not more than five hundred dollars (\$500.00);

I, as a owner of the property, or my employees with wages as their sole compensation, will do the work, and the structure is not intended or offered for sale (Sec. 7044, Business and Professional Code: The Contractors License Law does not apply to an owner of property who builds or improves thereon, and who does such work himself or herself or through his/her own employees, provided that such improvements are not intended or offered for sale. If, however, the building or improvement is sold within one year of completion, the owner-builder will have the burden of proving that he/she did not build or improve for the purpose of sale.)

I, as owner of the property, am exclusively contracting with licensed contractors to construct the project (Sec. 7044, Business and Professions Code: The Contractors License Law does not apply to an owner of property who builds or improves thereon, and who contracts for such projects with a contractor(s) licensed pursuant to the Contractors License Law).

I am exempt under Sec. B & PC for this reason:

Date Owner Signature

IN ISSUING THIS BUILDING PERMIT, the applicant represents, and the city relies on the representation of the applicant, that the applicant verified all measurements and locations shown on the application or accompanying drawings and that the improvement to be constructed does not violate any law or private agreement relating to permissible or prohibited locations for such improvements. This building permit does not authorize any illegal location of any improvement or the violation of any private agreement relating to location of improvements.

I certify that I have read this application and state that all information is correct. I agree to comply with all city and county ordinances and state laws relating to building construction and herby authorize representative(s) of this city to enter upon the abovementioned property for inspection purposes.

Date 12/24/01 Applicant/Agent Signature D. Collins

WORKER'S COMPENSATION DECLARATION: I hereby affirm under penalty of perjury one of the following declarations:

I have and will maintain a certificate of consent to self-insure for workers' compensation as provided for by Section 3700 of the Labor Code, for the performance of work for which the permit is issued.

X I have and will maintain workers' compensation insurance, as required by Section 3700 of the Labor Code, for the performance of the work for which this permit is issued. My workers' compensation insurance carrier and policy number are:

Carrier KEMPER INSURANCE CO Policy Number 5BR083547 00 Exp Date 07/01/2002

(This section need not be completed if the permit is for \$100 or less) I certify that in the performance of the work for which this permit is issued, I shall not employ any person in any manner so as to become subject to the workers' compensation laws of California and agree that if I should become subject to the workers' compensation provisions of Section 3700 of the Labor Code, I shall forthwith comply with those provisions.

Date 12/24/01 Applicant Signature D. Collins

WARNING: FAILURE TO SECURE WORKER'S COMPENSATION COVERAGE IS UNLAWFUL AND SHALL SUBJECT AN EMPLOYER TO CRIMINAL PENALTIES AND CIVIL FINES UP TO ONE HUNDRED THOUSAND DOLLARS (\$100,000) IN ADDITION TO THE COST OF COMPENSATION, DAMAGES AS PROVIDED FOR IN SECTION 3706 OF THE LABOR CODE, INTEREST AND ATTORNEY'S FEE.

THIS PERMIT SHALL EXPIRE BY LIMITATION IF WORK IS NOT COMMENCED WITHIN 180 DAYS.

RESIDENTIAL SUBDIVISION BUILDING PERMIT APPLICATION

Project Address: 460 Alcantar Circle Assessor Parcel # 225.1640.0600
Lot Number: 3 Subdivision RIVERVIEW #2, Unit #3-B

OWNER INFORMATION:

Legal Property Owner: D.R. HORTON Phone# 965-2200
Owner Address: _____ City _____ State _____ Zip _____

CONTRACTOR INFORMATION:

Contractor: DR HORTON Lic. # 750190 Phone # 965-2200 Fax 956-22

PROJECT INFORMATION:

Land Use Zone RIA Occupancy Group R3 Construction Type VN Fed Code 1A
No. of Stories: 2 No. of Rooms: 10 Street Width: _____
1st Floor Area _____ 2nd Floor Area _____ Basement _____ Roof Material _____
AREA IN SQUARE FOOT OF:
Dwelling/Living 2320
Garage/Storage 492
Decks/Balconies 40
Carports _____
SCOPE OF WORK: _____

FORM OFFICE USE ONLY

- Information Above Complete
- Violation Filcs Checked
- Standard Setbacks
- County Sewer
- AR Flood Waiver Required
- Flood Elevation Certificate Required
- Water Development Infill Area
- Planning Approval
- Design Review Approval
- Special Fee Districts Apply:

~THE FOLLOWING MUST BE PROVIDED IN ORDER TO SUBMIT FOR PERMIT~

- 2 COMPLETE PLOT PLANS, LEGIBLE & DRAWN TO SCALE
- 11 X 17 COPY OF FLOOR PLAN WITH FOLLOWING INFORMATION
 - a) Assessors Parcel Number
 - b) New Floor Area
 - c) Owners Name
 - d) Project Address

Received by: (staff) _____ Permit # _____

CERTIFICATION OF INSULATION

PART I GENERAL

PART II AREAS INSULATED

PART III CERTIFICATION

ADDRESS OR TRACT

SACRAMENTO INSULATION CONTRACTORS

D.R. HORTON
460 Alcantara

LOT # 3B

- P.O. BOX 854, WEST SACRAMENTO, CA 95691 LIC. #202026
- 1309 MELODY ROAD, MARYSVILLE, CA 95901 LIC. #202026
- P.O. BOX 9651, FRESNO, CA 93793-9651 LIC. #202026
- P.O. BOX 1631, RENO, NV 89505 LIC. #10675
- 3326 A PONDEROSA WAY, LAS VEGAS, NV 89118 LIC. #10675

PARK WEST

DATE INSULATION COMPLETED

WALLS		CEILING			FLOORS	
(SQUARE FEET)		(SQUARE FEET)			(SQUARE FEET)	
TYPE OF INSULATION		TYPE OF INSULATION			TYPE OF INSULATION	
MATERIAL	FIBERGLASS	MATERIAL	FIBERGLASS		MATERIAL	FIBERGLASS
FORM	BATTS	FORM	BATTS & BLOW		FORM	BATTS
MANUFACTURER'S PRODUCT I D.		MANUFACTURER'S PRODUCT I D.			MANUFACTURER'S PRODUCT I D.	
MANUFACTURER		MANUFACTURER			MANUFACTURER	
OCF		OCF			OCF	
		BAGS				
R-VALUE INSTALLED	APPLIED THICKNESS	R-VALUE INSTALLED	APPLIED THICKNESS	MIN. INSTALLED WEIGHT PER SQUARE FOOT	R-VALUE INSTALLED	APPLIED THICKNESS
13 19	3 7/8" 5 1/2"	30 30	9" 12"			

KNEE WALLS IF R-VALUE IS OTHER THAN WALLS ABOVE

MATERIAL	FORM	R VALUE	MANUFACTURER
FIBERGLASS	BATTS		OCF

AIR INFILTRATION SEALANT

MATERIAL	MANUFACTURER
FOAM	W R GRACE

THIS IS TO CERTIFY THAT INSULATION AND/OR SEALANT HAS BEEN INSTALLED IN CONFORMANCE WITH APPLICABLE CODES, MATERIAL STANDARDS AND REGULATIONS.

SIGNATURE - INSULATION CONTRACTOR	TITLE	DATE
<i>[Signature]</i>	MANAGER	3/4/02
SIGNATURE - GENERAL CONTRACTOR	TITLE	DATE

REMARKS

460 Alcantara Circle

OMEGA PRODUCTS CORP.

DIAMOND WALL INSULATING STUCCO SYSTEM

JOB ADDRESS:

ICBO Report 14004

D.R. London
PAVE VIEW

Date of Job Completion, 3-6-02

PLASTERING CONTRACTOR:

Name: STUCCO NORRIS INC.

Address: 5900 WAREHOUSE WAY, SACRAMENTO, CALIFORNIA 95826

Telephone No: (916) 383-6699

Contractor Number of Diamond Wall System 2175

This is to certify that the exterior coating system on the building exterior at the above address has been installed in accordance with the evaluation report specified above and the manufacturer's instructions.

Date 3/6/02

Signature of authorized representative of
Plastering Contractor

This installation card must be presented to the building inspector after completion of work and before final inspection.



WALLACE • KUHL & ASSOCIATES INC.
 GEOTECHNICAL ENGINEERING • CONSTRUCTION TESTING

3050 Industrial Blvd.
 PO Box 1137
 West Sacramento
 California 95891
 916-372-1434

DATE 2-11-02		JOB NO. 4290.10		WEATHER		TEMP. ° at		AM	
PROJECT Parkview		LOCATION Lots 1-8		TYPE OF WORK Pull test		Technician I <input type="checkbox"/>		Staff E/G <input type="checkbox"/>	
Inside 50 mi. radius <input type="checkbox"/>		Outside 50 mi. radius <input type="checkbox"/>		Nuclear Densities <input type="checkbox"/>		Principal E/G <input type="checkbox"/>			
PERSONNEL		REG. HRS	OT HRS	TOTAL HRS	TRAVEL	ON JOB	VEHICLE		MILES
<i>[Handwritten Name]</i>									

OBSERVATIONS:
[Handwritten notes describing test results and procedures]

FIELD REPORT

Signed: *[Handwritten Signature]*

Norman

Scheel

Structural

Engineer

Sacramento
5022 Sunrise Blvd.
Fair Oaks, CA 95628
(916) 536-9585
(916) 536-0260 (fax)

NORMAN SCHEEL
Structural Engineer
Email: norm@nsse.com

ROBERT COON
Project Manager
Email: rob@nsse.com

PAULO IBAÑEZ, P.E.
Project Manager
Email: paulo@nsse.com

TIM SLOAN, P.E.
Project Manager
Email: tim@nsse.com

STEVE COOKSEY
CAD Supervisor
Email: steve@nsse.com

STACY MARLIN
Office Manager
Email: stacy@nsse.com

Davis
213 B Street Suite B
Davis, CA 95616
(530)753-5300
(530)753-5380(fax)

TRACY HARRIS, P.E.
Project Manager
Email: tracy@nssedavis.com

DARRELL PEREIRA
Design Engineer
Email: darrell@nssedavis.com

February 1, 2002

D.R. Horton
4401 Hazel Avenue #135
Fair Oaks, CA 95628

Re: Park West (Riverview) (Job #20424)
Inspection Clarification

To Whom It May Concern:

This letter is to clarify the following comments:

1. Walls hanging over the foundation – if the walls hang over the concrete more than ½" both MAS anchors and HPAHD-22-2P holdowns will require repairs. For the MAS anchors, anchor bolts should be installed per the specifications on the plans using Simpson Epoxy. For the holdowns, a HTT22 epoxy fix will be required. See sketches with this letter.
2. Spalling around HPAHD22 holdowns – if the spall is less than 4" no repair is required. If the spall exceeds 4" install HTT22 epoxy fix.
3. See alternate detail with this letter for TJI rafter at overhang.

If you have any questions, please call Rob Coon

NORMAN SCHEEL
STRUCTURAL ENGINEER

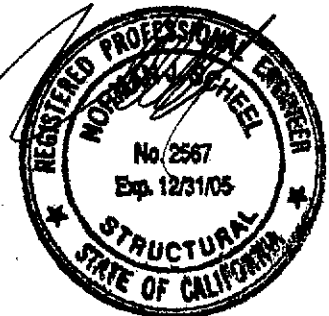

THIS PLOT PLAN IS NOT FOR SALES PURPOSES. THIS PLOT PLAN IS FOR THE PURPOSES OF INDICATING COMPLIANCE WITH ZONING SET BACKS, GENERAL DRAINAGE DIRECTION, AND APPROXIMATE UTILITY CONNECTION. ALL OTHER DATA SHOWN HEREON IS CONCEPTUAL. THIS PLOT PLAN DOES NOT REFLECT AS-BUILT CONDITION, RETAINING WALL ARE OPTIONAL AND MAY OR MAY NOT BE CONSTRUCTED.

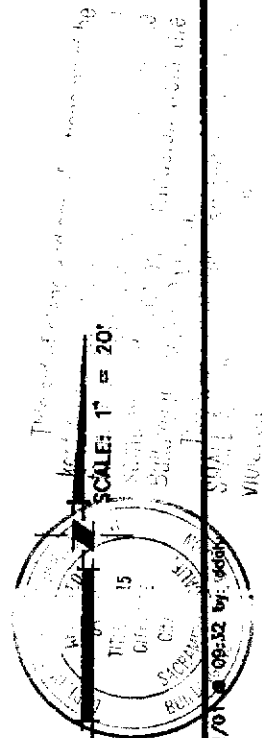
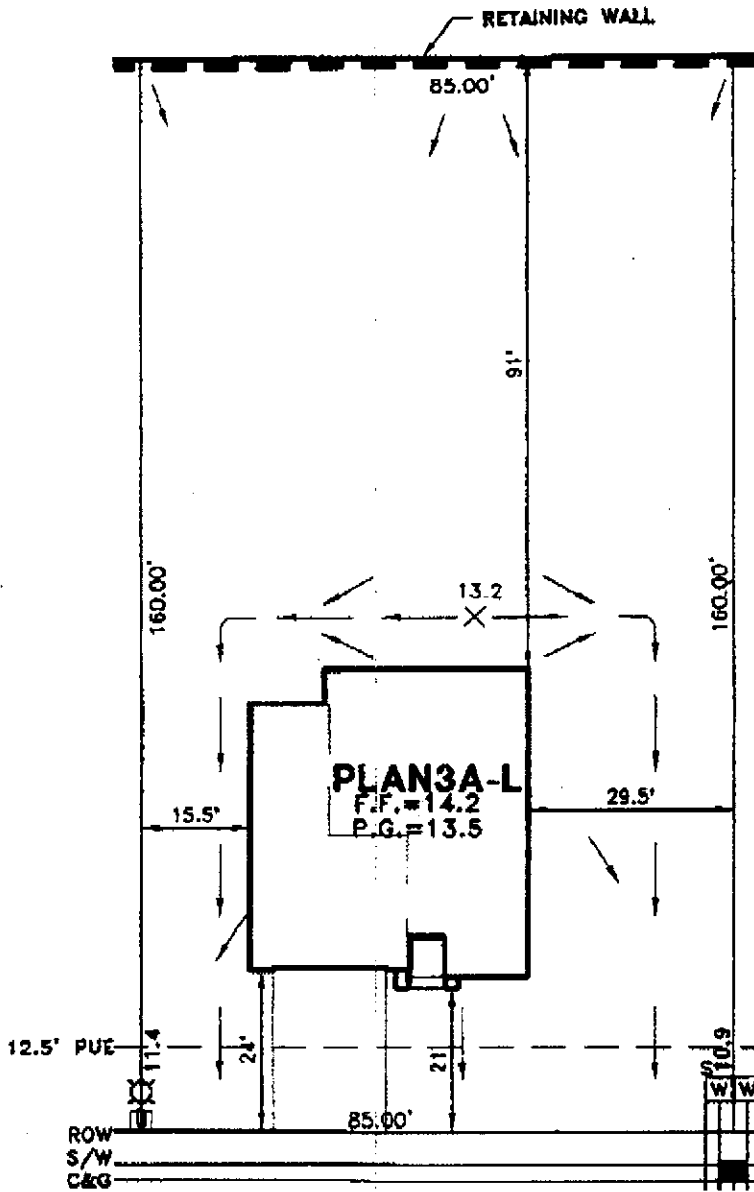

ALCANTAR CIRCLE

- ☐ = UTILITY SERVICE BOX
- ⊙ = STREET LIGHT

PLOT PLAN
LOT 3B
RIVERVIEW #2, UNIT 3B
FOR
D.R. HORTON
CITY OF SACRAMENTO CALIFORNIA

WOOD RODGERS INC.

ENGINEERING PLANNING MAPPING SURVEYING
2301 D STREET, BLDG. 100-W, SACRAMENTO, CA 95818
PHONE (916) 381-7288 FAX (916) 381-7287

DATE OCT 2001	DRAWN DAD	CHECKED PMT	PROJECT NO. 1055.014
------------------	--------------	----------------	-------------------------

File: J:\JOBS\RIVERVIEW\DWG\CIVIL\LOT PLANS SAMPLER\3A3B\LOT03B.DWG Last edited: 10/22/01 09:32 by: 6656