



5

CITY OF SACRAMENTO

DEPARTMENT OF ENGINEERING

915 I STREET
CITY HALL ROOM 207

SACRAMENTO, CALIFORNIA 95814
TELEPHONE (916) 449-5281

CITY MANAGER'S OFFICE
RECEIVED
JUL 13 1983

J.F. VAROZZA
CITY ENGINEER
M.H. JOHNSON
ASSISTANT CITY ENGINEER

July 12, 1983

City Council
Sacramento, California

Honorable Members in Session:

SUBJECT: Revocable Encroachment Permit - Lee Caron & Richard Ohm
1931 H Street, Northwest Corner of 20th and H Streets

SUMMARY:

Lee Caron & Richard Ohm have applied for a revocable encroachment permit for the purpose of constructing exposed aggregate sidewalk. The City Engineer recommends that the permit be granted.

BACKGROUND:

The area for which this request is being made consists of an area adjacent to permittee's property at 1931 H Street. The area is 6' x 56' and 10'-2"x 9' and 8"x12' or approximately 436 square feet.

RECOMMENDATION:

The City Engineer recommends that the attached resolution be passed granting a revocable encroachment permit to Lee Caron & Richard Ohm in the area and for the purpose outlined above.

Respectfully submitted,

Recommendation Approved:

Walter J. Slife
Walter J. Slife, City Manager

J. F. Varozza
J. F. VAROZZA
Director of Public Works

14-R-030-00-0

cc: Bob Blaser
Bill Seeber
Vitello, Niiya, Inc.

APPROVED
BY THE CITY COUNCIL

JUL 19 1983

OFFICE OF THE
CITY CLERK

July 19, 1983
District #1

RESOLUTION No. 83-546

Adopted by The Sacramento City Council on date of

July 19, 1983

RESOLUTION GRANTING REVOCABLE ENCROACHMENT TO:

Lee Caron & Richard Ohm

BE IT RESOLVED BY THE COUNCIL OF THE CITY OF SACRAMENTO:

That a revocable encroachment permit for the purpose of constructing exposed aggregate sidewalk is hereby granted to Lee Caron & Richard Ohm, whose address is as follows: 1010 21st Street, Sacramento, California 95814.

The encroachment area is described as follows:

An area adjacent to permittee's property at 1931 H Street. An area 6' x 56' and 10'-2"x9' and 8" x 12' or approximately 436 square feet.

This permit is granted subject to the "General Provisions - Revocable Encroachment Permit", which were adopted by the City Council in Resolution No. 81-845 dated November 17, 1981, and the hereinafter specified special conditions, if any. This permit shall be effective only after the applicant files with the Department of Finance of the City of Sacramento, the insurance certificates required by the General Provisions.

SPECIAL CONDITIONS

1. Permittee shall comply with all requirements of the Community Development Department, Public Works Department and City Sign Ordinance.
2. Exposed aggregate sidewalk shall not be installed at corners leading to streets.

APPROVED
BY THE CITY COUNCIL

JUL 19 1983

OFFICE OF THE
CITY CLERK

3. Permittee shall contact Bill Seeber at 449-5236 (Street Maintenance Division) for construction inspection at least 24 hours prior to beginning construction.

MAYOR

ATTEST:

CITY CLERK

7'-0" 6'-0" 5'-2.7"

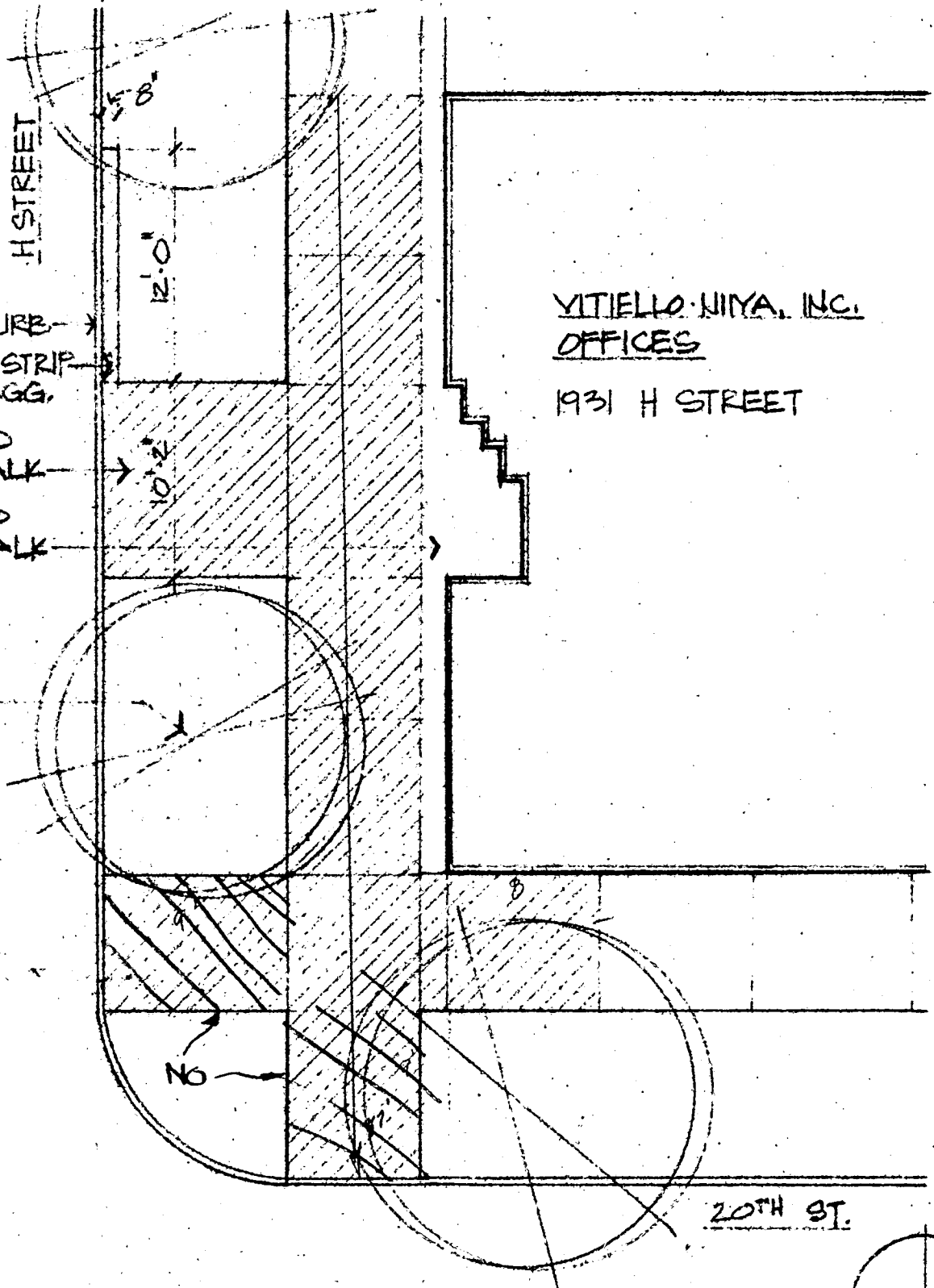

- (E) CONC. CURB
- (N) 8' x 12'-0" STRIP EXPOSED AGG.
- (N) EXPOSED AGG. WALK
- (E) EXPOSED AGG. WALK
- (E) ULMUS TYP.

VITIELLO-NIYA, INC.
 OFFICES
 1931 H STREET

SITE PLAN
 SCALE: 1/8" = 1'-0"

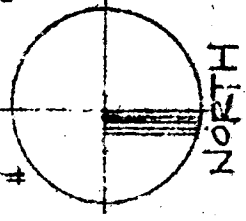

VITIELLO-NIYA, INC.
 1000 15th Street, San Francisco, CA 94103
 (415) 448-0225

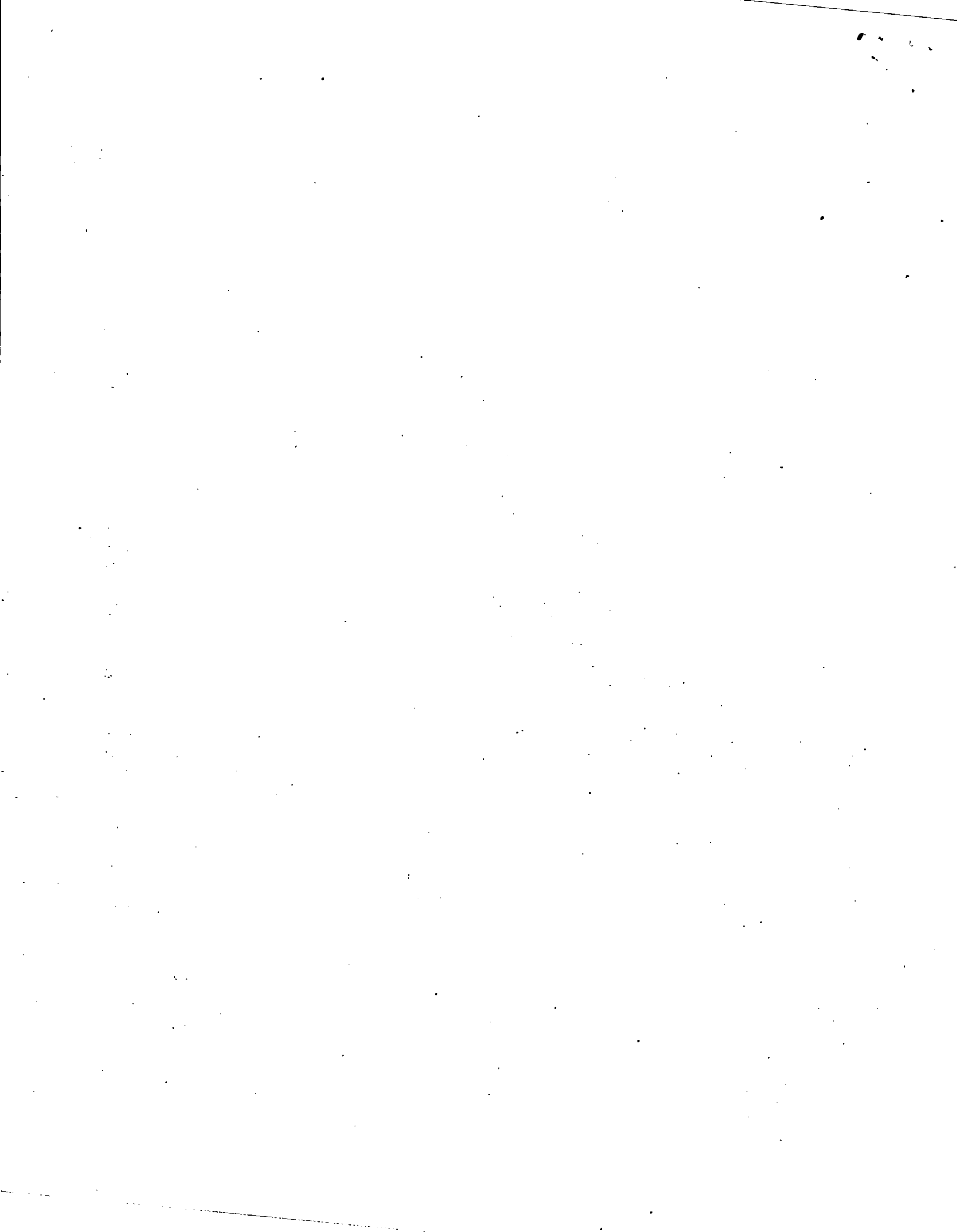

July 20, 1983

Lee Caron & Richard Ohm
1010 21st Street
Sacramento, CA 95814

Dear Gentlemen:

On July 19, 1983, the Sacramento City Council adopted Resolution No. 83-546 granting the following Revocable Encroachment Permit in accordance with "General Provisions - Revocable Encroachment Permit," adopted by Council Resolution 81-845 as amended.

The permit is for the purpose of constructing exposed aggregate sidewalk located adjacent to 1931 H Street.

This permit shall be effective only after you file with the Risk Management and Insurance Division of the City of Sacramento, 800 10th Street, Suite 4, Sacramento, CA 95814, the insurance certificates required by the General Provisions.

Enclosed, for your records, is a copy of the resolution granting the permit, and Council Resolution 81-845, as amended.

Sincerely,

Lorraine Magana
City Clerk

LM/km/5
Enclosures

cc: Risk Management