

CONSULTATION ENGINE AGENCY

Contract Address: _____
 LICENSED CONTRACTORS DECLARATION

I hereby affirm under penalty of perjury that I am licensed under provisions of Chapter 1000 commencing with Section 7000 of Division 5 of the Business and Professions Code and my business is in full force and effect.

License Class: C45 License Number: 206124
 Date: 9-22-02 Contractor Signature: [Signature]

OWNER BUILDERS DECLARATION

I hereby affirm under penalty of perjury that I am exempt from the Contractors License Act of the following persons: SA, 70315, Business and Professions Code. Any city or county that requires a contractor license shall not apply to me. I am not subject to the provisions of the Contractors License Act. I am not subject to the provisions of the Contractors License Act. I am not subject to the provisions of the Contractors License Act.

SITE ADDRESS: 2450 SEMMIST DR. SUITE _____
 ASSESSOR PARCEL NO: 274-072-06 PERMIT NO. 02

NAME OF APPLICANT: _____ ADDRESS: _____ ZIP CODE: _____

LICENSED CONTRACTOR: PROGRESSIVE IMPACT ADDRESS: 4180C WATERSIDE
 BUSINESS OWNER: DELTA RIDGE APTS ADDRESS: 3450 SEMMIST DR SACRAMENTO

- SIGN INFORMATION
- ATTACHED
 - ILLUMINATED
 - INDIVIDUAL LETTERS
 - METAL
 - PLASTIC
 - WOODEN
 - INTERIOR / ELECT
 - NON-ILLUMINATED
 - PAINTED ON BUILDING
 - POLY
 - MONUMENT
 - PROJECTING
 - BILBOARD / SUBDIVISION
 - LOGO
 - DOUBLE FACED
 - VINYL/GATOR FOAM
 - RE-FACE

SIGN COPY: DELTA RIDGE
521349

CITY OF SACRAMENTO PERMIT SERVICES
 BUILDING INSPECTION DIVISION 264-7619

WORKERS COMPENSATION DECLARATION

I have a firm under contract to provide construction services for the following: _____
 and will contract with any of my employees for the purpose of providing construction services for the above project. I have a firm under contract to provide construction services for the following: _____ and will contract with any of my employees for the purpose of providing construction services for the above project.

DATE: 9-22-02
 SIGNATURE: [Signature]

TOTAL FEES \$ _____

WRITE ON A FIRM SURFACE

SIGN PERMIT APPLICATION

CONSTRUCTION PERMIT

CONTRACTOR'S DECLARATION

LICENSED CONTRACTORS DECLARATION

I hereby affirm under penalty of perjury that I am licensed under provisions of Chapter 10000 of the California Code of Regulations, Section 10000 of the Business and Professions Code and my license is in full force and effect.

License Class 2445 License Number 2016124
Date 9-22-02 Signature [Signature]

OWNER'S DECLARATION

I hereby affirm under penalty of perjury that I am exempt from the Contractor's License requirements under Section 10000 of the Business and Professions Code and my license is in full force and effect.

SITE ADDRESS:

2430 SEMMIST DR.

SITE

ASSESSOR PARCEL NO. 274-0322-044

PERMIT NO. 001

NAME OF APPLICANT

ADDRESS

ZIP CODE

LICENSED CONTRACTOR PROGRESSIVE INTERIORS ADDRESS 4800 W. WYLSIDE ZIP CODE 95208
BUSINESS OWNER DEBRA RIDGEE ADDRESS 2430 SEMMIST DR. ZIP CODE 95833

SIGN INFORMATION

- ATTACHED
- HLLMINATED
- INDIVIDUAL LETTERS
- METAL
- PLASTIC
- WOODEN
- INTERIOR / ELECT
- NON-HLLMINATED
- PAINTED ON BUILDING
- POLE
- MONTMENT
- PROJECTING
- SINGLE FACED
- BILLBOARD / SUBDIVISION
- LOGO
- DOT BILE FACED
- VINYL/GATOR FOAM
- RE FACE

SIGN COPY DEBRA RIDGEE

521349

CITY OF SACRAMENTO PERMIT SERVICES
BUILDING INSPECTION DIVISION 264-7619

WORKER'S COMPENSATION DECLARATION

I hereby affirm under penalty of perjury that I am licensed under provisions of Chapter 10000 of the California Code of Regulations, Section 10000 of the Business and Professions Code and my license is in full force and effect.

Non-ITL
MSJ

I hereby affirm under penalty of perjury that I am licensed under provisions of Chapter 10000 of the California Code of Regulations, Section 10000 of the Business and Professions Code and my license is in full force and effect.

[Signature]

I hereby affirm under penalty of perjury that I am licensed under provisions of Chapter 10000 of the California Code of Regulations, Section 10000 of the Business and Professions Code and my license is in full force and effect.

[Signature]

TOTAL FEES \$

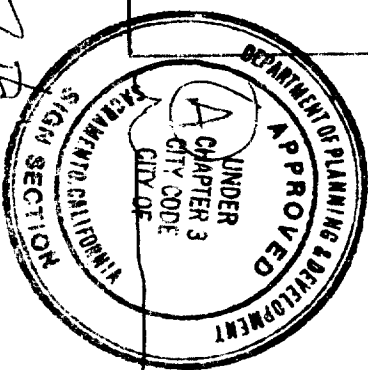
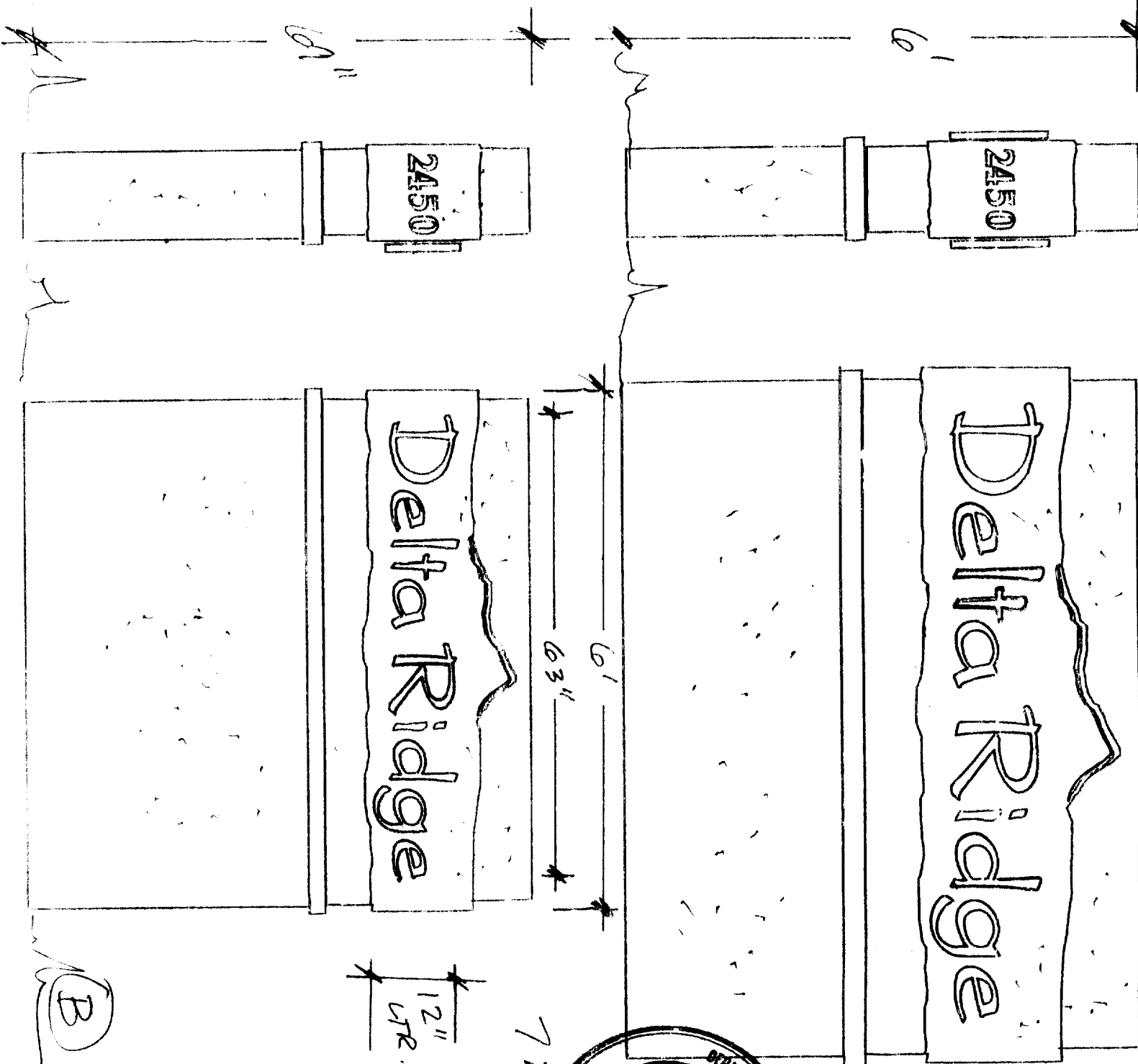

This set of plans kept on the job at to make any change same without written of Sacramento Sign. The approval of t SHALL NOT be held violator of any City.

74
All electrical work must be U.L. labeled or meet standards, N.E.C. Sec. 90.67 and comply with Div. 2 of Sacramento City Code.
EQUIPMENT MUST BE USED AS DESIGNED AND SIGN INSTALLATIONS ARE SUBJECT TO FIELD

521349
521350

16" WTR. AREA

9'3 1/4"

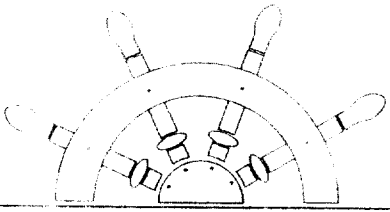

DELTA RIDGE

WEST EL CAMINO AVE.



SIGN A

SEA-MIST DRIVE

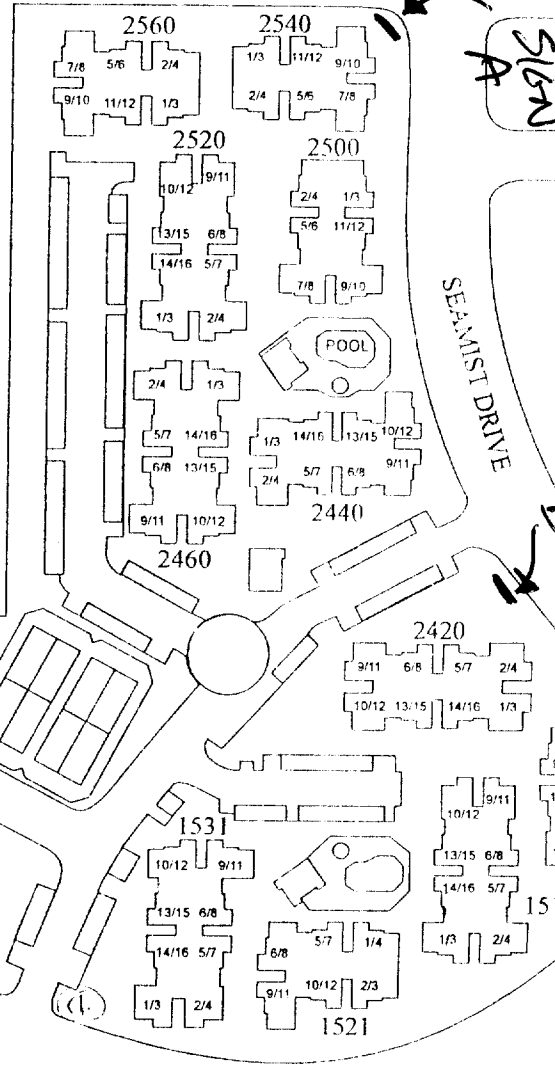

WATERWHEEL DRIVE

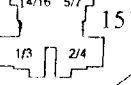
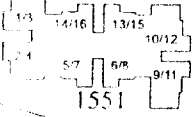
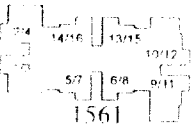
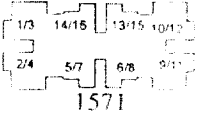

W. EL CAMINO

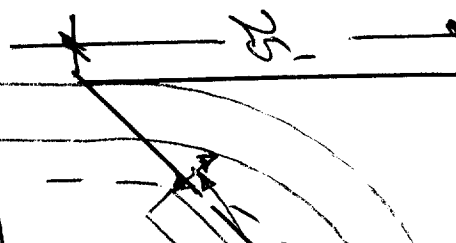

BL CAMINO AVE.

FOUND 4" IRON PIPE PER 62 P.M. 16

FOUND 4" IRON PIPE PER 62 P.M. 16

FOUND 4" IRON PIPE PER 62 P.M. 16

TRUXEL ROAD

10000

61500

PARCEL 62 P.M. 16

FOUND 4" IRON PIPE PER 62 P.M. 16

PARCEL 1

PARCEL 2

DELTA POINT WEST - A CONDOMINIUM

LOT II

LOT I

LOT 13

LOT 14

DELTA

