

CITY OF SACRAMENTO

Permit No: 0002477

1231 I Street, Sacramento, CA 95814

Insp Area: 4

Site Address: 5140 FREDERICKSBURG WY SAC

Sub-Type: NSFR

Parcel No: 201-0390-015

LOT 74 NORTHBR 6-1

Housing (Y/N): N

CONTRACTOR

OWNER

ARCHITECT

CS HOME
2366 GOLD MEADOW DR STE 100
GOLD RIVER, CA 95670 77041

Nature of Work: NSFR MP 3712/OPT BONUS 2 STORY 12 RMS

CONSTRUCTION LENDING AGENCY: I hereby affirm under penalty of perjury that there is a construction lending agency for the performance of the work for which this permit is issued (Sec. 3097, Civ. C).

Lender's Name _____ Lender's Address _____

LICENSED CONTRACTORS DECLARATION: I hereby affirm under penalty of perjury that I am licensed under provisions of Chapter 9 (commencing with section 7000) of Division 3 of the Business and Professions Code and my license is in full force and effect.

License Class _____ License Number _____ Date: 3/24/20 Contractor Signature [Signature]

OWNER-BUILDER DECLARATION: I hereby affirm under penalty of perjury that I am exempt from the contractors License Law for the following reason (Sec. 7031.5, Business and Professions Code; any city or county which requires a permit to construct, alter, improve, demolish, or repair any structure, prior to its issuance, also requires the applicant for such permit to file a signed statement that he or she is licensed pursuant to the provisions of the Contractors License Law (Chapter 9 (commencing with Section 7000) of Division 8 of the Business and Professions Code) or that he or she is exempt therefrom and the basis for the alleged exemption. Any violation of Section 7031.5 by any applicant for a permit subjects the applicant to a civil penalty of not more than five hundred dollars (\$500.00);

____ I, as a owner of the property, or my employees with wages as their sole compensation, will do the work, and the structure is not intended or offered for sale (Sec. 7044, Business and Professional Code: The Contractors License Law does not apply to an owner of property who builds or improves thereon, and who does such work himself or herself or through his/her own employees, provided that such improvements are not intended or offered for sale. If, however, the building or improvement is sold within one year of completion, the owner-builder will have the burden of proving that he/she did not build or improve for the purpose of sale.)

____ I, as owner of the property, am exclusively contracting with licensed contractors to construct the project (Sec. 7044, Business and Professions Code: The Contractors License Law does not apply to an owner of property who builds or improves thereon, and who contracts for such projects with a contractor(s) licensed pursuant to the Contractors License Law).

____ I am exempt under Sec. _____ B & PC for this reason: _____

Date _____ Owner Signature _____

IN ISSUING THIS BUILDING PERMIT, the applicant represents, and the city relies on the representation of the applicant, that the applicant verified all measurements and locations shown on the application or accompanying drawings and that the improvement to be constructed does not violate any law or private agreement relating to permissible or prohibited locations for such improvements. This building permit does not authorize any illegal location of any improvement or the violation of any private agreement relating to location of improvements.

I certify that I have read this application and state that all information is correct. I agree to comply with all city and county ordinances and state laws relating to building construction and hereby authorize representative(s) of this city to enter upon the abovementioned property for inspection purposes.

Date: 3/24/20 Applicant/Agent Signature [Signature]

WORKER'S COMPENSATION DECLARATION: I hereby affirm under penalty of perjury one of the following declarations:

____ I have and will maintain a certificate of consent to self-insure for workers' compensation as provided for by Section 3700 of the Labor Code, for the performance of work for which the permit is issued.

____ I have and will maintain workers' compensation insurance, as required by Section 3700 of the Labor Code, for the performance of the work for which this permit is issued. My workers' compensation insurance carrier and policy number are:

Carrier OLD REPUBLIC INS. CO. Policy Number MWC107468 00 Exp Date 11/01/2000

____ (This section need not be completed if the permit is for \$100 or less) I certify that in the performance of the work for which this permit is issued, I shall not employ any person in any manner so as to become subject to the workers' compensation laws of California and agree that if I should become subject to the workers' compensation provisions of Section 3700 of the Labor Code, I shall forthwith comply with those provisions.

Date: 3/20/20 Applicant Signature [Signature]

WARNING: FAILURE TO SECURE WORKER'S COMPENSATION COVERAGE IS UNLAWFUL AND SHALL SUBJECT AN EMPLOYER TO CRIMINAL PENALTIES AND CIVIL FINES UP TO ONE HUNDRED THOUSAND DOLLARS (\$100,000) IN ADDITION TO THE COST OF COMPENSATION, DAMAGES AS PROVIDED FOR IN SECTION 3706 OF THE LABOR CODE, INTEREST AND ATTORNEY'S FEE.

THIS PERMIT SHALL EXPIRE BY LIMITATION IF WORK IS NOT COMMENCED WITHIN 180 DAYS.

RESIDENTIAL BUILDING PERMIT APPLICATION

- New Construction
- Addition
- Remodels
- Other

Project Address: 5140 Fredricksburg Way Assessor Parcel # 201-0390-015

OWNER INFORMATION:

Legal Property Owner: U.S. Home Phone # 858-3900
 Owner Address: 2366 Old Peakway #200 City Old River State Ca Zip 95670

CONTRACTOR INFORMATION:

Contractor: U.S. Home Lic. # 451838 Phone # 858-3900 Fax# 858-3925

PROJECT INFORMATION:

Land Use Zone _____ Occupancy Group R-14 Construction Type VN Fed Code 1A
 No. of stories: 2 No. of rooms: 12 Street width: _____
 1st Floor Area 1904 2nd Floor Area 2184 Basement _____ Roof Material _____

AREA IN SQUARE FOOT OF:

	EXISTING	NEW
Dwelling/Living	_____	<u>4088</u>
Garage/Storage	_____	<u>670</u>
Decks/Balconies	_____	<u>174</u>
Carports	_____	_____

SCOPE OF WORK: S.F.D.

FOR OFFICE USE ONLY

- Information above complete
- Violation files checked
- Standard setbacks
- County Sewer
- AR Flood Waiver required
- Flood Elevation Certificate Required
- Water Development Infill Area
- Planning Approval
- Design Review Approval
- Special Fee Districts Apply : _____

NEW STRUCTURES & ADDITIONS

✦ THE FOLLOWING MUST BE PROVIDED IN ORDER TO SUBMIT FOR PLAN REVIEW

- 2 COMPLETE PLANS, LEGIBLE & DRAWN TO SCALE
 - 3 SETS IF PROJECT IS IN A DESIGN REVIEW AREA
 - Title 24 Energy Compliance documentation
 - Grading and Erosion Control Questionnaire
 - 11" x 17" copy of floor plan for County Assessor
 - Plan Review Fees
- ✦ Plans to include: site plan, floor plan, elevations, roof/ceiling plan, foundation and structural framing details, and structural calculations for non-conforming structures.

Date: _____ Received by: (staff) _____



INSULATION
CERTIFICATE

WES PAC INSULATION, INC.

THIS IS TO CERTIFY THAT INSULATION HAS BEEN INSTALLED IN CONFORMANCE WITH
CURRENT ENERGY REGULATIONS, CALIFORNIA ADMINISTRATIVE CODE, TITLE 24, STATE OF
CALIFORNIA, IN THE BUILDING LOCATED AT:

LOT OR PLAN # 5140 Frederickburg Tract # Lot 74
CITY SACRAMENTO

EXTERIOR WALLS:

MANUFACTURER _____ THICKNESS/TYPE _____ R-VALUE 13

CEILINGS:

BATTS:
MANUFACTURER _____ THICKNESS/TYPE _____ R-VALUE 38

BLOWN IN:
MANUFACTURER GREENSTONE THICKNESS/TYPE _____ R-VALUE 38

SQUARE FOOTAGE COVERED 1793 NUMBER OF BAGS USED 67

FLOORS:

MANUFACTURER _____ THICKNESS/TYPE _____ R-VALUE _____

SLAB ON GRADE:

MANUFACTURER _____ THICKNESS/TYPE _____ R-VALUE _____

WIDTH OF INSULATION _____ INCHES

FOUNDATION WALLS:

MANUFACTURER _____ THICKNESS/TYPE _____ R-VALUE _____

GENERAL CONTRACTOR _____

CALIFORNIA CONTRACTORS LICENSE # _____ DATE _____

SIGNATURE _____ TITLE _____

INSULATION CONTRACTOR WES PAC INSULATION, INC.

CALIFORNIA CONTRACTORS LICENSE # #487478 DATE 6/30/00

SIGNATURE [Signature] TITLE [Title]

Lot Area = 7,119 sf
Building Footprint = 2,748 sf
Gross Coverage = 38.6%
Porch Allowance = 174 sf
Net Coverage = 36.2%

SCALE: 1"=20'

APN:

201-039-015

Address:

5140 Fredericksburg Way

Owner:

Plan:

4090 R

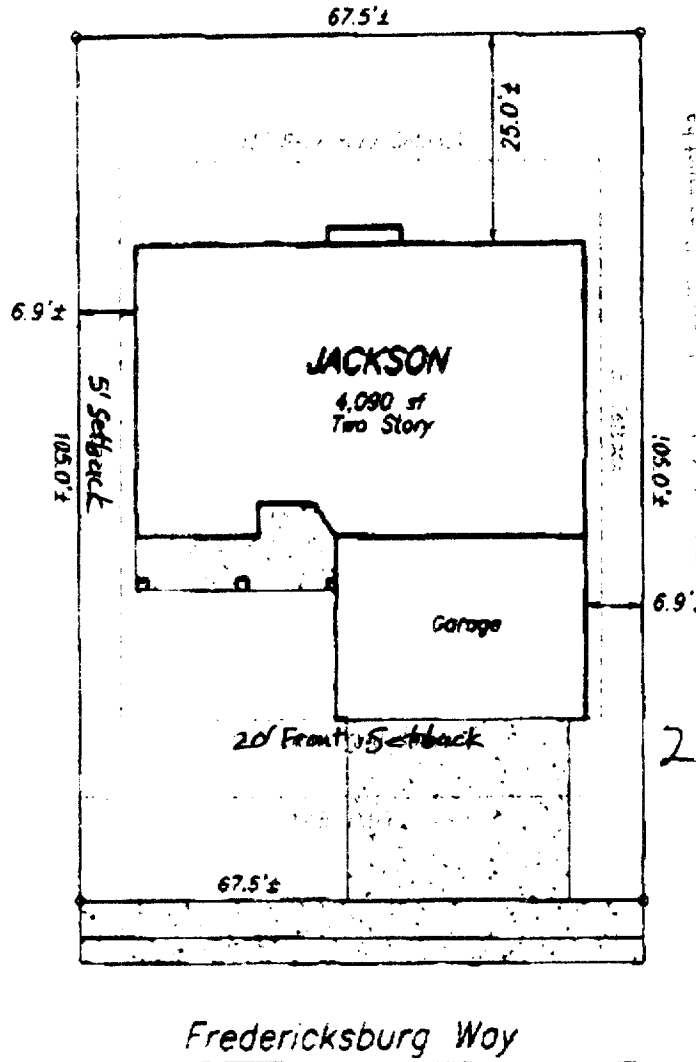

This plot plan has been prepared by
 Murray Smith & Associates
 Engineering, Inc. for the purpose of
 showing the building footprint and
 setbacks to the property line. It is
 not to be used for any other purpose
 without the written consent of the
 engineer.

Plot Plan for Lot 74 for Northborough Village 6-1
U.S.Home - Northborough - Legends Series
 City of Sacramento

Note:

This plot plan has been prepared for the purpose of showing the building foundation relationship to the property line, proposed drainage elevations and direction of flow to conform to local ordinances and for the purpose of building permit issuance. Information shown is approximate except for those setbacks which are minimums required by ordinance. This plot does not reflect as-built conditions which will likely vary from this plan.

**Murray Smith & Associates
 Engineering, Inc.**

3110 Gold Canal Drive
 Rancho Cordova, CA 95670
 Ph.: (916) 635-1511

March 2, 2000

PN: 99003