



REPORT TO COUNCIL

City of Sacramento

915 I Street, Sacramento, CA 95814-2604
www.CityofSacramento.org

CONSENT
July 14, 2009

Honorable Mayor and
Members of the City Council

Title: Contract: *Parks and Recreation Safety Implementation Plan: Strawberry Manor Park Renovation (L19808300)*

Location/Council District: 200 Danville Way / Council District 2

Recommendation: Adopt a **Resolution:** 1) approving the contract specifications for Strawberry Manor Park Renovation (L19808300) and awarding the contract to JM Slover, Inc. for an amount not to exceed \$521,599; and 2) authorizing the City Manager to execute the contract for the project.

Contact: Dennis Day, Associate Landscape Architect, 808-7633; J.P. Tindell, Park Planning and Development Manager, 808-1955

Presenters: Not applicable

Department: Parks and Recreation

Division: Park Planning & Development Services

Organization No: 19001121

Description/Analysis

Issue: Strawberry Manor Park is a 1.30 acre neighborhood park located in North Sacramento. On April 10, 2008, the City Council adopted the *Parks and Recreation Safety Implementation Plan (PSIP)*. As part of the *PSIP*, the City Council approved action plans for nine City parks to implement capital improvements to make these parks safer for their users. Strawberry Manor Park was identified as one of the nine parks with action plans for immediate implementation. On March 31, 2009, City Council approved the master plan update for this project in Resolution 2009-186. Staff is seeking approval to award a contract to perform the improvements to the park. The formal bid process for this project has been completed and a bidder has been selected based on the qualifications set forth by the City.

A summary of the project history is included as Attachment 1 (page 5) and a location map is included as Attachment 2 (page 6).

Policy Considerations: Sacramento City Code Chapter 3.60 identifies the general guidelines for completing contracts for public projects and procedures for bidding and issuing contracts over \$100,000.

Providing parks and recreation facilities is consistent with the City's strategic plan to enhance livability in Sacramento's neighborhoods by expanding park, recreation, and trail facilities throughout the City.

This is part of the Park Development Process for park planning as stated in the *2005-2010 Parks and Recreation Master Plan*.

Committee/Commission Action: The Parks and Recreation Commission (PRC) participated in a public workshop on February 20, 2008, as part of the Park Safety Audit process. Members discussed and made recommendations on the nine parks selected for a Park Safety Audit. The Parks and Recreation Commission supported the adoption of the *PSIP* at its March 6, 2008, meeting. On October 2, 2008, the PRC's Park Planning and Development Committee unanimously supported the Strawberry Manor Park Master Plan (Attachment 3, page 7).

The Strawberry Manor Park Master Plan Update was reviewed and supported by the PRC on October 2, 2008, and approved by City Council on March 31, 2009.

Environmental Considerations:

California Environmental Quality Act (CEQA): The proposed project is exempt from the provisions of CEQA under the following sections of the CEQA Guidelines (Title 14 Cal. Code Reg. § 15000 et seq.): 15301 (minor alteration of existing public or private structures); 15302 (replacement of existing structures on the same site as the structure being replaced with the same purpose and capacity as the structure replaced); and 15303 (new construction and location of limited numbers of new, small facilities or structures; accessory structures including garages, carports, patios, swimming pools and fences).

Sustainability Considerations: Strawberry Manor Park has been reviewed for consistency with the goals, policies and targets of the City's Sustainability Master Plan (SMP), the Parks and Recreation Sustainability Plan, and the 2030 General Plan. The renovation of this park will advance SMP goals, policies, and targets by reducing air pollution, reducing water consumption, and expanding park and recreation opportunities.

The park renovation is also consistent with sustainable design and development. The goals of sustainable park design and development include reducing operational and maintenance costs; reducing adverse impacts to the environment; increasing the ecological function of landscape and natural areas; and increasing the comfort, health and safety of park visitors.

The addition of trees, other plantings and shade structures in the park reduces greenhouse gas emissions and air pollution and improves the urban climate by reducing the urban heat island effect. Planting native, drought tolerant and low water using vegetation in the park reduces water use for irrigation. Installing permanent recycling receptacles in the park encourages the public to reuse and recycle local materials. Providing access to a diverse mix of wellness activities in the park improves the health of visitors to the park.

Rationale for Recommendation: The formal bidding process for the Strawberry Manor Park Renovation project was posted in accordance with City Code 3.60 and Administrative Policy Instruction #48. The project was posted and the bids were opened on May 13, 2009. The staff/engineer's estimate for the base bid and additive alternates on this project was \$589,953. Staff received eight bids and the results are listed below

CONTRACTOR	Base Bid	Additive Alternates (1-5)	Total Bid	SBE %
JM Slover, Inc.	\$417,334	\$104,265	\$521,599	97.9%
Procida Landscape	\$466,354	\$103,003	\$569,357	27.4%
Ad Land Venture	\$458,431	\$123,826	\$582,257	32.0%
Biundo Landscape Construction	\$478,454	\$110,650	\$589,104	97.2%
PBM Construction	\$484,985	\$118,912	\$603,897	89.1%
Hemington Landscape	\$484,313	\$133,418	\$617,731	25.9%
Gateway Landscape	\$506,000	\$148,000	\$654,000	100%
Gold Valley Construction	\$518,184	\$142,895	\$661,079	98.3%

Pursuant to City Code Section 3.60.020, it was determined that J M Slover Inc. had the lowest, responsible total bid. The project award will be for the base bid and additive alternates 1-5 (fabric shade canopy over the playground, picnic tables, water mister area, skater play component, and fitness stations) for an amount not to exceed \$521,599.

The Strawberry Manor Park Renovation project includes: a group picnic area with shade structure, a new children's playground with shade canopy, a water mister area, a Freegame multi-use sport court, a new park sign, individual picnic areas, fitness equipment, drinking fountain, renovated irrigation system, additional landscaping and shade trees, and new site furniture (tables, benches, bike rack and trash receptacles).

Financial Considerations: There are sufficient funds in L19808300 (\$700,000) to award the construction contract. Funding for this project comes from Park Development Impact fees (PIF) funds in the North Sacramento Community Planning Area.

Ongoing maintenance for improvements to this existing park will be absorbed by the existing Park Operations staff.

Emerging Small Business Development (ESBD): The selection of consultants and contractors for this project followed City established guidelines for inclusion of ESBD firms. At an SBE/EBE percentage total of 97.9% (SBE percentage is based on the base bid only), JM Slover, Inc., and its subcontractors are above meeting the City's required 20% ESBD rate.

Respectfully Submitted by:

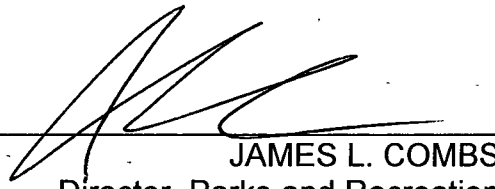

JAMES L. COMBS
Director, Parks and Recreation

Recommendation Approved:

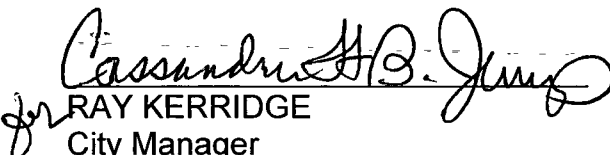

RAY KERRIDGE
City Manager

Table of Contents:

Report	pg. 1
Attachments	
1 Background Information	pg. 5
2 Strawberry Manor Park Location Map	pg. 6
3 Strawberry Manor Park Master Plan	pg. 7
4 Resolution	pg. 8

Attachment 1

Background Information

According to two public surveys of residents within the City of Sacramento, the public perception of the safety in parks and recreation facilities has declined since 2003. A comprehensive strategy targeted at the facility/neighborhood level was recommended to ensure that the City's park and recreation system creates a positive, clean, vibrant, and safe environment.

On April 10, 2008, the City Council adopted the *Parks and Recreation Safety Implementation Plan (PSIP)*. As part of the *PSIP*, the City Council approved action plans for nine City parks to implement capital improvements and operational enhancements.

Strawberry Manor Park was one of the nine selected park sites. Immediate improvements were recommended as Tier I improvements. Tier I consists of implementing the improvements identified in the park action plans, which is included in this project. To help ensure that these parks are an asset to their neighborhood, Tier III or longer-term planning projects were recommended to be implemented as funding becomes available. In the case of Strawberry Manor Park, the recommended Tier III projects are new enhancements to the park which include a group picnic area with shade structure, a new children's playground with shade canopy, a water mister area, a Freegame multi-use sport court, a new park sign, individual picnic areas, fitness equipment, drinking fountain, renovated irrigation system, additional landscaping and shade trees, and new site furniture (tables, benches, bike rack and trash receptacles).

The Strawberry Manor Park Renovation project will begin construction in July 2009 and construction is anticipated to be complete by the end of 2009.

Attachment 2

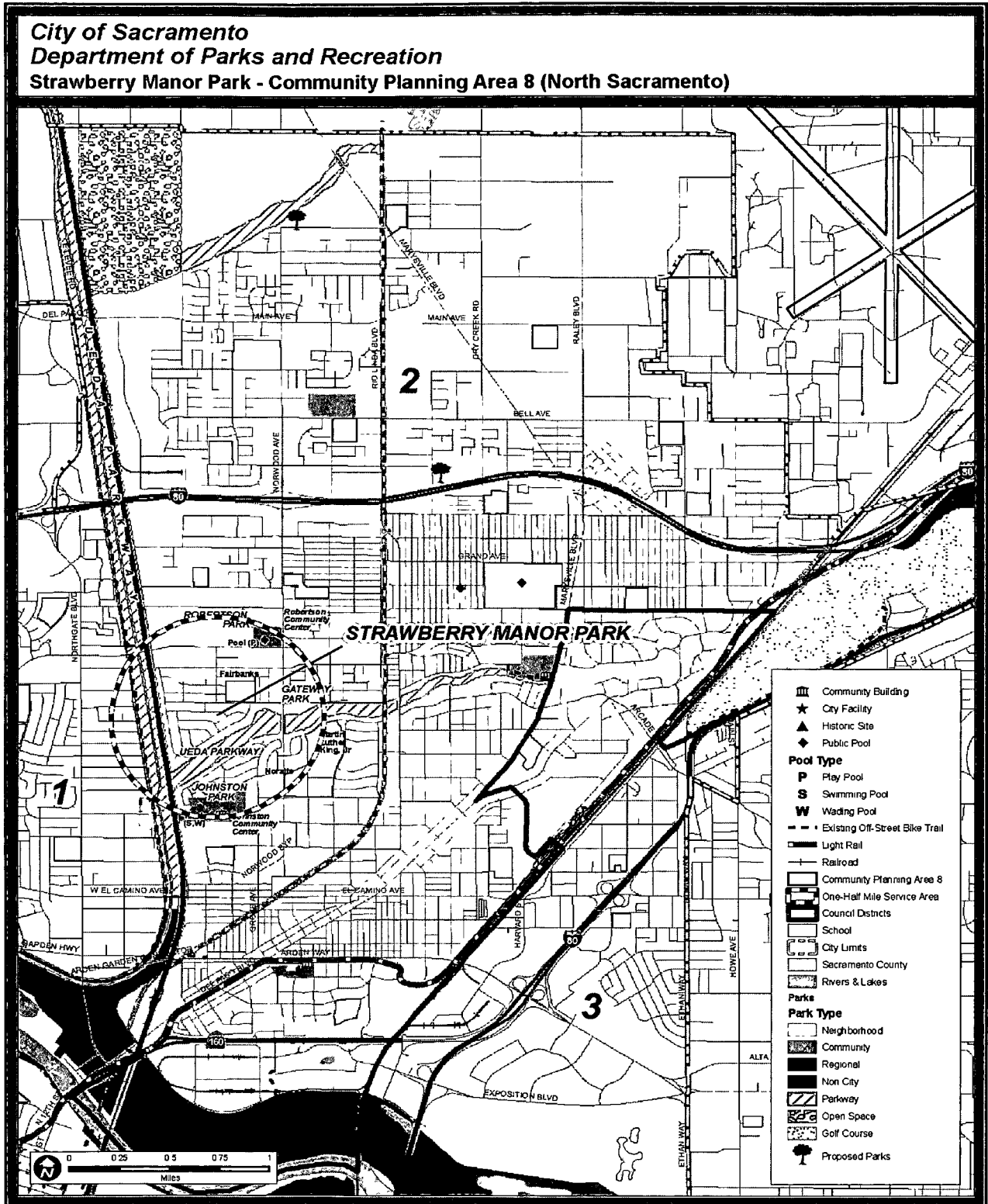

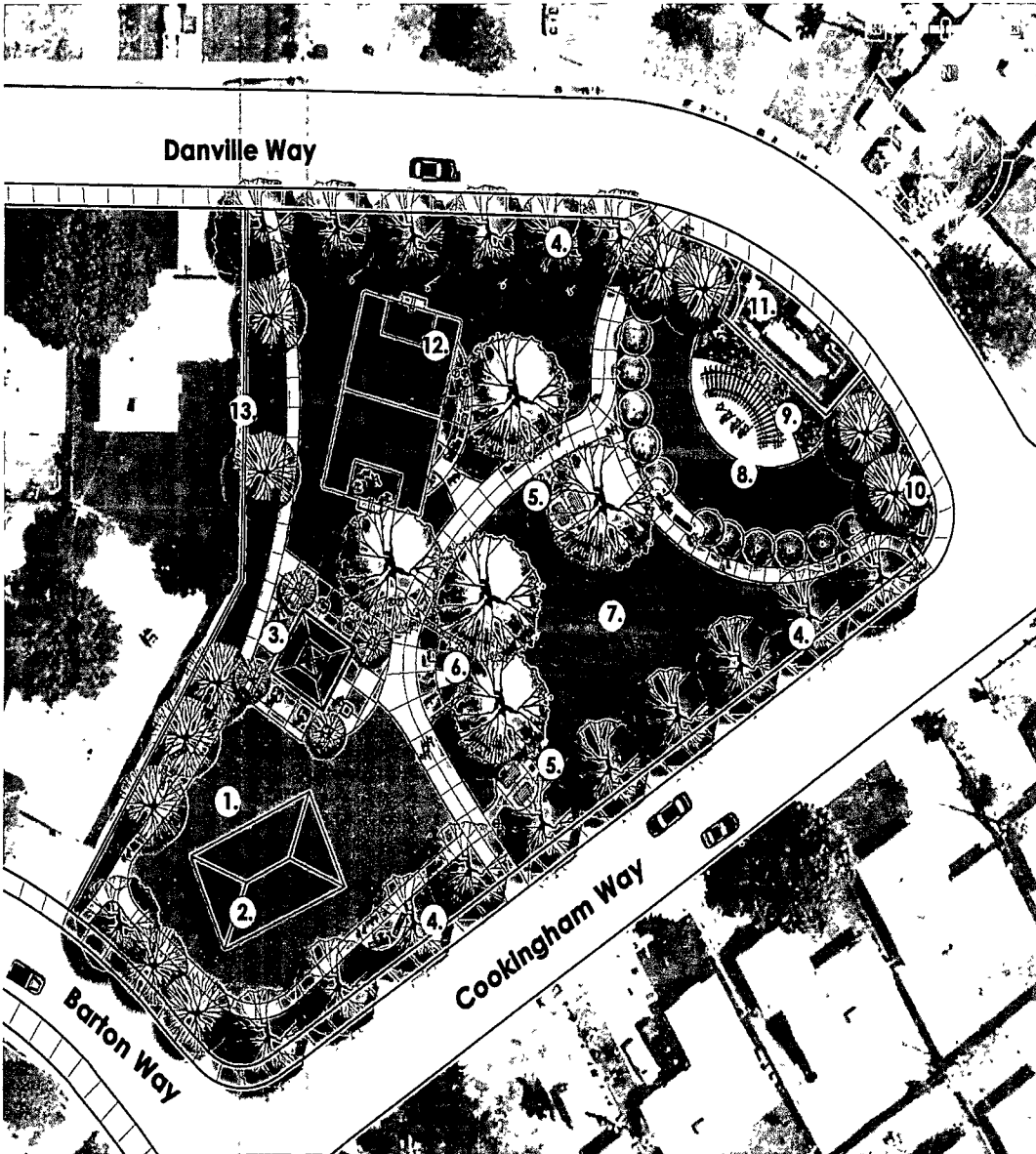

LEGEND

- 1. FENCED ADVENTURE PLAYGROUND
- 2. FABRIC SHADE STRUCTURE FOR THE PLAYGROUND
- 3. SHADED PICNIC AREA WITH PICNIC TABLES AND GROUP GRILL
- 4. FITNESS STATIONS (TYPICAL OF 3)
- 5. INDEPENDANT PICNIC AREA (TYPICAL OF 2)
- 6. INTERACTIVE WATER MIST AREA
- 7. OPEN LAWN AREA
- 8. AMPHITHEATER WITH LAWN SEATING
- 9. TRELIS
- 10. NEW PARK SIGN
- 11. EXISTING WELL
- 12. MULTI-PURPOSE COURT OFFERING BASKETBALL, SOCCER, TENNIS, BADMINTON, FIELD HOCKEY, AND VOLLEYBALL
- 13. NEW CHAIN LINK FENCE WITH VEGETATED A BUFFER

MASTER PLAN FOR
STRAWBERRY MANOR PARK (1.38 ACRES)
 CITY OF SACRAMENTO CALIFORNIA

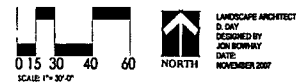

RESOLUTION NO. 2009-

Adopted by the Sacramento City Council

July 14, 2009

**CONTRACT: *PARKS AND RECREATION SAFETY IMPLEMENTATION PLAN*:
STRAWBERRY MANOR PARK RENOVATION (L19808300)**

BACKGROUND

- A. Strawberry Manor Park is a 1.30 acre neighborhood park in North Sacramento. The Strawberry Manor Park Master Plan was approved by the City Council on March 31, 2009.
- B. On April 10, 2008, the City Council adopted the *Parks and Recreation Safety Implementation Plan (PSIP)*. As part of the *PSIP*, the City Council approved action plans for nine City parks to implement capital improvements and operational enhancements to make these parks positive, clean, vibrant, and safe environments for park users.
- C. City Code Chapter 3.60 identifies the general guidelines for completing contracts for public projects and procedures for bidding and issuing contracts over \$100,000.
- D. The formal bid process for the Strawberry Manor Park Renovation project has been completed based on the qualifications set forth by the City.
- E. Pursuant to City Code Section 3.60.020, it was determined that JM Slover, Inc. was the responsible, low bidder with the total bid of \$521,599.
- F. There are sufficient funds in L19808300 to award this contract.

**BASED ON THE FACTS SET FORTH IN THE BACKGROUND, THE CITY COUNCIL
RESOLVES AS FOLLOWS:**

- Section 1. The contract specifications for Strawberry Manor Park Renovation (L19808300) are approved and the contract is awarded to JM Slover, Inc. for an amount not to exceed \$521,599.
- Section 2. The City Manager is authorized to execute the contract with JM Slover, Inc. for an amount not to exceed \$521,599 for Strawberry Manor Park Renovation (L19808300).