

CITY OF SACRAMENTO

1231 I Street, Sacramento, CA 95814

Permit No: 9905340

Insp Area: 4

Site Address: 3805 AETNA SPRINGS WY SAC

Parcel No: 225-1180-024

GATEWAY WEST LOT 24

Sub-Type: NSFR

Housing (Y/N): N

CONTRACTOR

KAUFMAN AND BROAD
3300 DOUGLAS BLVD. STE 330
ROSEVILLE CA. 95661

OWNER

ARCHITECT

Nature of Work: MP 1968 2 STORY SFR

CONSTRUCTION LENDING AGENCY : I hereby affirm under penalty of perjury that there is a construction lending agency for the performance of the work for which this permit is issued (Sec. 3097, Civ. C).

Lender's Name _____ Lender's Address _____

LICENSED CONTRACTORS DECLARATION: I hereby affirm under penalty of perjury that I am licensed under provisions of Chapter 9 (commencing with section 7000) of Division 3 of the Business and Professions Code and my license is in full force and effect.

I license Class 17 License Number 2484257 Date 6/22/99 Contractor Signature N. Gollins

OWNER-BUILDER DECLARATION: I hereby affirm under penalty of perjury that I am exempt from the contractors License Law for the following reason (Sec. 7031.5, Business and Professions Code; any city or county which requires a permit to construct, alter, improve, demolish, or repair any structure, prior to its issuance, also requires the applicant for such permit to file a signed statement that he or she is licensed pursuant to the provisions of the Contractors License Law (Chapter 9 (commencing with Section 7000) of Division 8 of the Business and Professions Code) or that he or she is exempt therefrom and the basis for the alleged exemption. Any violation of Section 7031.5 by any applicant for a permit subjects the applicant to a civil penalty of not more than five hundred dollars (\$500.00):

____ I, as a owner of the property, or my employees with wages as their sole compensation, will do the work, and the structure is not intended or offered for sale (Sec. 7044, Business and Professional Code: The Contractors License Law does not apply to an owner of property who builds or improves thereon, and who does such work himself or herself or through his/her own employees, provided that such improvements are not intended or offered for sale. If, however, the building or improvement is sold within one year of completion, the owner-builder will have the burden of proving that he/she did not build or improve for the purpose of sale.)

____ I, as owner of the property, am exclusively contracting with licensed contractors to construct the project (Sec. 7044, Business and Professions Code: The Contractors License Law does not apply to an owner of property who builds or improves thereon, and who contracts for such projects with a contractor(s) licensed pursuant to the Contractors License Law).

____ I am exempt under Sec. _____ B & PC for this reason: _____

Date _____ Owner Signature _____

IN ISSUING THIS BUILDING PERMIT, the applicant represents, and the city relies on the representation of the applicant, that the applicant verified all measurements and locations shown on the application or accompanying drawings and that the improvement to be constructed does not violate any law or private agreement relating to permissible or prohibited locations for such improvements. This building permit does not authorize any illegal location of any improvement or the violation of any private agreement relating to location of improvements.

I certify that I have read this application and state that all information is correct. I agree to comply with all city and county ordinances and state laws relating to building construction and hereby authorize representative(s) of this city to enter upon the abovementioned property for inspection purposes.

Date 6/22/99 Applicant/Agent Signature N. Gollins

WORKER'S COMPENSATION DECLARATION: I hereby affirm under penalty of perjury one of the following declarations:

____ I have and will maintain a certificate of consent to self-insure for workers' compensation as provided for by Section 3700 of the Labor Code, for the performance of work for which the permit is issued.

____ I have and will maintain workers' compensation insurance, as required by Section 3700 of the Labor Code, for the performance of the work for which this permit is issued. My workers' compensation insurance carrier and policy number are:

Carrier CONTINENTAL CAS. CO. Policy Number WC188899094 Exp Date 05/01/2000

____ (This section need not be completed if the permit is for \$100 or less) I certify that in the performance of the work for which this permit is issued, I shall not employ any person in any manner so as to become subject to the workers' compensation laws of California and agree that if I should become subject to the workers' compensation provisions of Section 3700 of the Labor Code, I shall forthwith comply with those provisions.



Date 6/22/99 Applicant Signature N. Gollins

WARNING: FAILURE TO SECURE WORKER'S COMPENSATION COVERAGE IS UNLAWFUL AND SHALL SUBJECT AN EMPLOYER TO CRIMINAL PENALTIES AND CIVIL FINES UP TO ONE HUNDRED THOUSAND DOLLARS (\$100,000) IN ADDITION TO THE COST OF COMPENSATION, DAMAGES AS PROVIDED FOR IN SECTION 3706 OF THE LABOR CODE, INTEREST AND ATTORNEY'S FEE.

THIS PERMIT SHALL EXPIRE BY LIMITATION IF WORK IS NOT COMMENCED WITHIN 180 DAYS.

CERTIFICATION OF COMPLIANCE

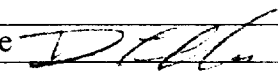
SCHOOL DISTRICT DEVELOPMENT FEES

PART I: TO BE COMPLETED BY APPLICANT			
Property Owner's Name	Kaufman & Broad		
Owner's Address	611 Grange Drive Davisville CA 95687		
Project Address	3505 Helena Springs Way Lot 24		
Parcel Number	P H R U N A N 000		
Subdivision Name	Gateway West Village Unit 4		
Number of Units	1		
Print Applicant's Name	D. Ellis	Applicant's Signature	
Title of Applicant	Oper.	Telephone Number	991-1200
Date	5/23/99		
PART II: TO BE COMPLETED BY BUILDING DEPARTMENT			
Plan Identification Number			
Building Type (Check One)	<input checked="" type="checkbox"/> Residential <input type="checkbox"/> Apartment/Condominium <input type="checkbox"/> Commercial/Industrial		
Square Feet of Chargeable Building Area	1968		
Signature			
Title		Date	5-24-99
PART III: TO BE COMPLETED BY NATOMAS UNIFIED SCHOOL DISTRICT			
District Certification Number	99-359		
Fees Collected:			
Residential:	1968 Sq. Ft. X \$	4.57	= \$ 8993.76
Apartment/Condominium:	Sq. Ft. X \$		= \$
Commercial/Industrial:	Sq. Ft. X \$		= \$
NOTICE TO APPLICANT: Pursuant to government code section 66020 (d), this will serve to notify you that the 90-day approval period in which you may protest the fees, or other payment identified above, will begin to run on the date in which the building or installation permit for this project is issued, or on which they are paid to the District, or to another public entity authorized to collect them on behalf of the District, whichever is earlier.			
Applicant Signature:			Date:

This certification covers only the amount of square footage indicated above. Any additions or corrections to the square footage for this project will require an amendment to the Certificate of Compliance.

As the authorize Natomas Unified School District official, I hereby certify that the requirements of Government Code Section 95995 have been complied with by the above signed applicant.

SIGNATURE:  DATE: 6-1-99
 TITLE: Facilities Planner

WES PAC

INSULATION, INC.

INSULATION
CERTIFICATE

THIS IS TO CERTIFY THAT INSULATION HAS BEEN INSTALLED IN CONFORMANCE WITH CURRENT ENERGY REGULATIONS CALIFORNIA ADMINISTRATIVE CODE, TITLE 24, STATE OF CALIFORNIA, IN THE BUILDING LOCATED AT:

STREET 3805 Aethna Springs Road LOT # 24 TRACT #

EXTERIOR WALLS:

MANUFACTURER TM THICKNESS/TYPE 3/4 R- VALUE 13

CEILING:

BATTS: MANUFACTURER TM THICKNESS/TYPE 1/2 R- VALUE 3.8

BLENN IN:

MANUFACTURER _____ THICKNESS/TYPE _____ R- VALUE _____

SQUARE FOOTAGE COVERED _____ NUMBER OF BAGS USED _____

FLOORS: MANUFACTURER _____ THICKNESS/TYPE _____ R- VALUE _____

SLAB ON GRADE: MANUFACTURER _____ THICKNESS/TYPE _____ R- VALUE _____

MANUFACTURER _____ THICKNESS/TYPE _____ R- VALUE _____

WIDTH OF INSULATION _____ INCHES _____ R- VALUE _____

FOUNDATION WALLS: MANUFACTURER _____ THICKNESS/TYPE _____ R- VALUE _____

GENERAL CONTRACTOR _____ DATE _____

CALIFORNIA CONTRACTORS LICENSE # _____

SIGNATURE

TITLE

INSULATION CONTRACTOR WES PAC INSULATION, INC.

#487478

DATE

SIGNATURE

TITLE

COUNTY SANITATION DISTRICT NO. 1
SACRAMENTO REGIONAL COUNTY SANITATION DISTRICT
SEWER IMPACT FEE
PERMIT AND CALCULATION SHEET

APPLICATION NO:

GENERAL INFORMATION

BLDG PERMIT NO: City

THIS PERMIT GOOD ONLY WHEN VALIDATED BY THE CASHIER

DEPT 26 \$2,414.00
TRAN 390887 06/09/99
RECEIPT 703021 C#1 \$2,414.00

THIS PERMIT TO CONNECT EXPIRES ONE YEAR FROM DATE OF ISSUANCE

FEE CALCULATION

BUILDING USE

INSPECTION	RESIDENTIAL	SF	MF	UNITS
CSD-1				
SRCSD				
CONSTRUCTION				
IN-LIEU				
TOTAL FEE				2,414

APN: PARUNKN000

DESCRIPTION / SUBDIVISION Gateway West Village #1 Unit #4 LOT: 24

PROPERTY ADDRESS 3805 Aethna Springs Way

OWNER Kaufman & Broad

MAILING ADDRESS 611 Orange Drive

CITY-STATE-ZIP Vacaville, Ca. 95567 PHONE (707) 488-2400

ADDITIONAL FEES MAY BE DUE IF CHANGES IN USE INCREASE SEWER IMPACT.

APPLICANT SIGNATURE

CONSOLIDATED UTILITY BILLING USE ONLY

ACCT _____ INPUT _____ START _____

AETNA SPRINGS WAY

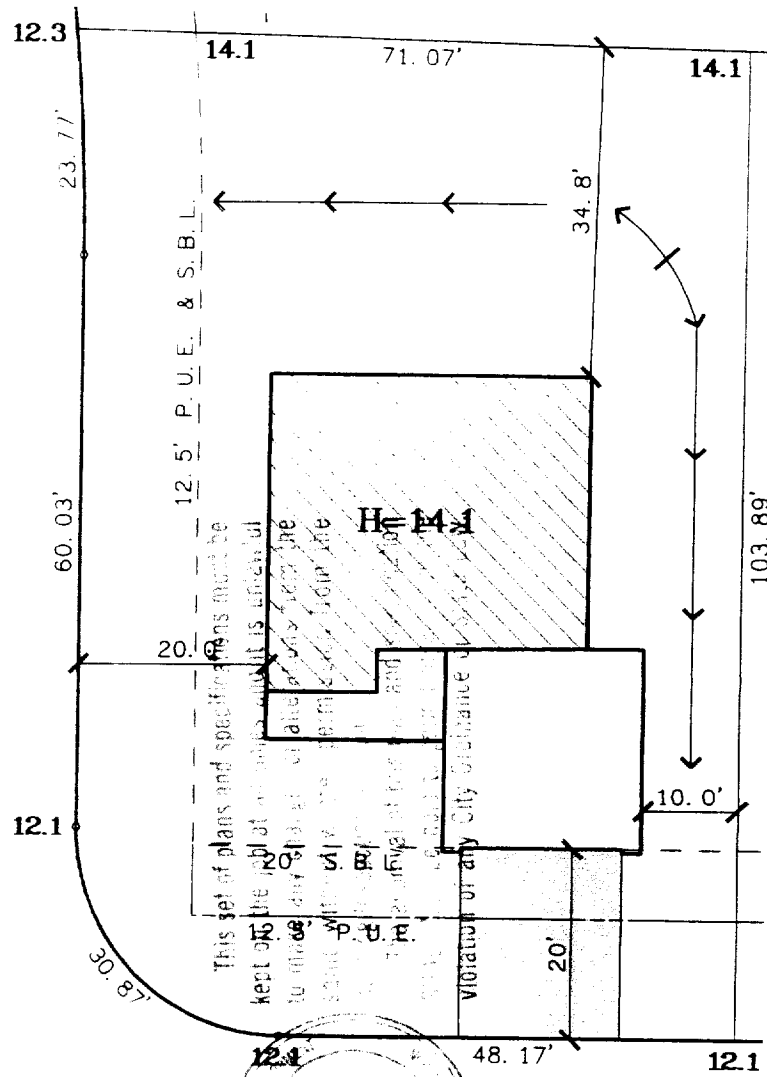

AETNA SPRINGS WAY

This set of plans and specifications must be kept on the job at all times until it is official to make any change. It is the responsibility of the contractor to verify all dimensions and conditions on the job. No part of this set of plans and specifications shall be used for any other project without the written consent of the City of Sacramento. Violation of any City Ordinance is prohibited.

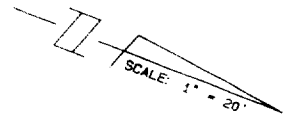

DATE: 5-6-99
 A.P.N.:
 ADDRESS: 3805 AETNA SPRINGS WAY

LOT AREA: 7,238 SF
 LOT COVERAGE: 22%

The Spink Corporation
 2590 VENTURE OAKS WAY
 SACRAMENTO, CA. 95833
 PH:(916)925-5550 FAX:(916)921-9274

GATEWAY WEST
 VILLAGE 1 UNIT 4
 LOT 24
 PLAN 3B

GATEWAY WEST
 CITY OF SACRAMENTO, CA.
 CLIENT: KAUFMAN & BROAD
 JOB NO.: 4734-042