

CITY OF SACRAMENTO  
1231 I Street, Sacramento, CA 95814

Permit No: 0104282  
Insp Area: 4

Site Address: 669 ALCANTAR CR SAC  
Parcel No: 225-1630-029 RIVER VIEW 2 VIL 2A LOT 57

Sub-Type: NSFR  
Housing (Y/N): N

**CONTRACTOR**  
BEAZER HOMES  
3009 DOUGLAS BL #150  
ROSEVILLE CA 95661

**OWNER**

**ARCHITECT**

Nature of Work: MP 2010 1 STORY 9 ROOM SFR

**CONSTRUCTION LENDING AGENCY:** I hereby affirm under penalty of perjury that there is a construction lending agency for the performance of the work for which this permit is issued (Sec. 3097, Civ. C)

Lender's Name \_\_\_\_\_ Lender's Address \_\_\_\_\_

**LICENSED CONTRACTORS DECLARATION:** I hereby affirm under penalty of perjury that I am licensed under provisions of Chapter 9 (commencing with section 7000) of Division 3 of the Business and Professions Code and my license is in full force and effect.

License Class E License Number 241991 Date 4/18/01 Contractor Signature Sheuy Van Maer

**OWNER-BUILDER DECLARATION:** I hereby affirm under penalty of perjury that I am exempt from the contractors License Law for the following reason (Sec. 7031.5, Business and Professions Code; any city or county which requires a permit to construct, alter, improve, demolish, or repair any structure, prior to its issuance, also requires the applicant for such permit to file a signed statement that he or she is licensed pursuant to the provisions of the Contractors License Law (Chapter 9 (commencing with Section 7000) of Division 8 of the Business and Professions Code) or that he or she is exempt therefrom and the basis for the alleged exemption. Any violation of Section 7031.5 by any applicant for a permit subjects the applicant to a civil penalty of not more than five hundred dollars (\$500.00):

\_\_\_\_\_, I, as a owner of the property, or my employees with wages as their sole compensation, will do the work, and the structure is not intended or offered for sale (Sec. 7044, Business and Professional Code: The Contractors License Law does not apply to an owner of property who builds or improves thereon, and who does such work himself or herself or through his/her own employees, provided that such improvements are not intended or offered for sale. If, however, the building or improvement is sold within one year of completion, the owner-builder will have the burden of proving that he/she did not build or improve for the purpose of sale.)

\_\_\_\_\_, I, as owner of the property, am exclusively contracting with licensed contractors to construct the project (Sec. 7044, Business and Professions Code: The Contractors License Law does not apply to an owner of property who builds or improves thereon, and who contracts for such projects with a contractor(s) licensed pursuant to the Contractors License Law)

I am exempt under Sec. \_\_\_\_\_ B & PC for this reason \_\_\_\_\_

Date \_\_\_\_\_ Owner Signature \_\_\_\_\_

**IN ISSUING THIS BUILDING PERMIT,** the applicant represents, and the city relies on the representation of the applicant, that the applicant verified all measurements and locations shown on the application or accompanying drawings and that the improvement to be constructed does not violate any law or private agreement relating to permissible or prohibited locations for such improvements. This building permit does not authorize any illegal location of any improvement or the violation of any private agreement relating to location of improvements.

I certify that I have read this application and state that all information is correct. I agree to comply with all city and county ordinances and state laws relating to building construction and hereby authorize representative(s) of this city to enter upon the above mentioned property for inspection purposes.

Date 4/18/01 Applicant/Agent Signature Sheuy Van Maer

**WORKER'S COMPENSATION DECLARATION:** I hereby affirm under penalty of perjury one of the following declarations:

\_\_\_\_\_, I have and will maintain a certificate of consent to self-insure for workers' compensation as provided for by Section 3700 of the Labor Code, for the performance of work for which the permit is issued

I have and will maintain workers' compensation insurance, as required by Section 3700 of the Labor Code, for the performance of the work for which this permit is issued. My workers' compensation insurance carrier and policy number are:

Carrier: LIBERTY MUTUAL INS CO Policy Number: WA2-651-004147-080 Exp Date: 04/01/2002

\_\_\_\_\_, (This section need not be completed if the permit is for \$100 or less) I certify that in the performance of the work for which this permit is issued, I shall not employ any person in any manner so as to become subject to the workers' compensation laws of California and agree that if I should become subject to the workers' compensation provisions of Section 3700 of the Labor Code, I shall forthwith comply with those provisions.

Date 4/18/01 Applicant Signature Sheuy Van Maer

WARNING: FAILURE TO SECURE WORKER'S COMPENSATION COVERAGE IS UNLAWFUL AND SHALL SUBJECT AN EMPLOYER TO CRIMINAL PENALTIES AND CIVIL FINES UP TO ONE HUNDRED THOUSAND DOLLARS (\$100,000) IN ADDITION TO THE COST OF COMPENSATION, DAMAGES AS PROVIDED FOR IN SECTION 3706 OF THE LABOR CODE, INTEREST AND ATTORNEY'S FEE.

THIS PERMIT SHALL EXPIRE BY LIMITATION IF WORK IS NOT COMMENCED WITHIN 180 DAYS.

RIVER VIEW 4A/4B

RESIDENTIAL BUILDING PERMIT APPLICATION

- New Construction
- Addition
- Remodels
- Other

Project Address: lots 57 1609 Alcantara Circle Assessor Parcel # \_\_\_\_\_

OWNER INFORMATION:

Legal Property Owner: Beazer Homes Holdings Corp. Phone # 916-773-3888  
 Owner Address: 3009 Douglas Blvd. 150 City Roseville State CA Zip 95661

CONTRACTOR INFORMATION:

Contractor: Beazer Homes Lic. # B724191 Phone # 916-773-3888 Fax# 916-773-0425

PROJECT INFORMATION:

Land Use Zone \_\_\_\_\_ Occupancy Group \_\_\_\_\_ Construction Type \_\_\_\_\_ Fed Code \_\_\_\_\_  
 No. of stories: 1 No. of rooms: \_\_\_\_\_ Street width: \_\_\_\_\_  
 1<sup>st</sup> Floor Area 2010 2<sup>nd</sup> Floor Area \_\_\_\_\_ Basement \_\_\_\_\_ Roof Material \_\_\_\_\_

AREA IN SQUARE FOOT OF:	EXISTING	NEW
Dwelling/Living	_____	<u>2010</u>
Garage/Storage	_____	<u>638</u>
Decks/Balconies	_____	<u>-0-</u>
Carpports	_____	<u>-0-</u>

SCOPE OF WORK: Single Family Dwelling

FOR OFFICE USE ONLY

- Information above complete
- Violation files checked
- Standard setbacks
- County Sewer
- AR Flood Waiver required
- Flood Elevation Certificate Required
- Water Development Infill Area
- Planning Approval
- Design Review Approval
- Special Fee Districts Apply : \_\_\_\_\_

NEW STRUCTURES & ADDITIONS

◆ THE FOLLOWING MUST BE PROVIDED IN ORDER TO SUBMIT FOR PLAN REVIEW

- 2 COMPLETE PLANS, LEGIBLE & DRAWN TO SCALE
  - 3 SETS IF PROJECT IS IN A DESIGN REVIEW AREA
  - Title 24 Energy Compliance documentation
  - Grading and Erosion Control Questionnaire
  - 11" x 17" copy of floor plan for County Assessor
  - Plan Review Fees
- ◆ Plans to include: site plan, floor plan, elevations, roof/ceiling plan, foundation and structural framing details, and structural calculations for non-conforming structures.

Date: \_\_\_\_\_ Received by: (staff) \_\_\_\_\_

ACTIVITY/PERMIT # \_\_\_\_\_

# CERTIFICATION OF INSULATION

ADDRESS OR TRACT <div style="font-size: 2em; font-family: cursive;">BEAZER</div> <div style="font-size: 2em; font-family: cursive;">MEMORIES</div>	LOT # <span style="font-size: 2em; font-family: cursive;">57</span>	SACRAMENTO INSULATION CONTRACTORS <input checked="" type="checkbox"/> P.O. BOX 854, WEST SACRAMENTO, CA 95691 LIC. #202026 <input type="checkbox"/> 1309 MELODY ROAD, MARYSVILLE, CA 95901 LIC. #202026 <input type="checkbox"/> P.O. BOX 9651, FRESNO, CA 93793-9651 LIC. #202026 <input type="checkbox"/> P.O. BOX 1631, RENO, NV 89505 LIC. #10675 <input type="checkbox"/> 3326 A PONDEROSA WAY, LAS VEGAS, NV 89118 LIC. #10675 DATE INSULATION COMPLETED
---	---	--

WALLS		CEILINGS			FLOORS	
( SQUARE FEET)		( SQUARE FEET)			( SQUARE FEET)	
TYPE OF INSULATION		TYPE OF INSULATION			TYPE OF INSULATION	
MATERIAL <b>FIBERGLASS</b>		MATERIAL <b>FIBERGLASS</b>			MATERIAL <b>FIBERGLASS</b>	
FORM <b>BATTS</b>		FORM <b>BATTS &amp; BLOW</b>			FORM <b>BATTS</b>	
MANUFACTURER'S PRODUCT I.D.		MANUFACTURER'S PRODUCT I.D.			MANUFACTURER'S PRODUCT I.D.	
MANUFACTURER		MANUFACTURER			MANUFACTURER	
<b>OCF</b>		<b>OCF</b>			<b>OCF</b>	
BAGS						
R-VALUE INSTALLED	APPLIED THICKNESS	R-VALUE INSTALLED	APPLIED THICKNESS	MIN. INSTALLED WEIGHT PER SQUARE FOOT	R-VALUE INSTALLED	APPLIED THICKNESS
<span style="font-size: 2em; font-family: cursive;">13</span>	<span style="font-size: 2em; font-family: cursive;">3 1/8"</span>	<span style="font-size: 2em; font-family: cursive;">30</span>	<span style="font-size: 2em; font-family: cursive;">9"</span> <span style="font-size: 2em; font-family: cursive;">12"</span>			
KNEE WALLS IF R-VALUE IS OTHER THAN WALLS ABOVE						
MATERIAL <b>FIBERGLASS</b>		FORM <b>BATTS</b>		R VALUE	MANUFACTURER <b>OCF</b>	
AIR INFILTRATION SEALANT						
MATERIAL <span style="font-size: 2em; font-family: cursive;">FOAM</span>				MANUFACTURER <b>W R GRACE</b>		

THIS IS TO CERTIFY THAT INSULATION AND/OR SEALANT HAS BEEN INSTALLED IN CONFORMANCE WITH APPLICABLE CODES, MATERIAL STANDARDS AND REGULATIONS

SIGNATURE—INSULATION CONTRACTOR <span style="font-size: 1.5em; font-family: cursive;">Bill Dierke</span>	TITLE MANAGER	DATE <span style="font-size: 1.5em; font-family: cursive;">7-9-01</span>
SIGNATURE—GENERAL CONTRACTOR	TITLE	DATE
REMARKS		



CAPITOL ENGINEERING LABORATORIES, INC.

631 Commerce Drive, Suite #200 • Roseville, California 95678 • (916) 786-2488

JOB REPORT

PAGE: 1 of 1

PROJECT NAME: MEMORIES II

FILE NO: 5222

INSPECTOR: KENNETH JOHN

DATE: 6-18-01

PERSONS CONTACTED: CVC

PERMIT #:

REFERENCE DOCUMENTS: ICBU Report 4945

WEATHER: CLDY

SERVICE PROVIDED: CONCRETE (INSP/SAMPLE ONLY/PU)  MASONRY  WELDING (SHOP/FIELD)  SOILS

OTHER:  Epoxy Boats

Proof Loaded epoxyed Boats to 150% of Allowable per ICBU 4945 OR to 6015 lbs For 5/8"

Lot 56	LOADER	13 - 5/8"	without Movement	
★ Lot 57	"	22 - 5/8"	"	"
Lot 59	"	15 - 5/8"	"	"
Lot 60	"	1 - 5/8"	"	- HIT -
Lot 61	"	8 - 5/8"	"	"
Lot 62	"	11 - 5/8"	"	"
Lot 14	"	20 - 5/8"	"	"
Lot 16	"	7 - 5/8"	"	"
Lot 17	"	1 - 5/8"	"	" - HIT -
Lot 18	"	12 - 5/8"	"	"

WITNESS INSTALLATION of Epoxy Boats USING SIMPSON STRONG-TIE

COMPLIANCE OF WORK: Epoxy Dated 12/02 INTO CLEAN HOLES

LOT 53 - 18 - 5/8" INSTALLED

ATTACHMENTS: Lot 54 - 12 - 5/8" AND 1 - HIT INSTALLED

EQUIPMENT/SUPPLIES USED: Lot 55 - 29 - 5/8" INSTALLED

NEXT VISIT:

REMARKS:

REVIEWED BY: Kenneth John DATE:

THIS PLOT PLAN IS NOT FOR SALES PURPOSES. THIS PLOT PLAN IS FOR THE PURPOSES OF INDICATING COMPLIANCE WITH ZONING SET BACKS, GENERAL DRAINAGE DIRECTION, AND APPROXIMATE UTILITY CONNECTION. ALL OTHER DATA SHOWN HEREON IS CONCEPTUAL. THIS PLOT PLAN DOES NOT REFLECT AS-BUILT CONDITION, RETAINING WALL ARE OPTIONAL AND MAY OR MAY NOT BE CONSTRUCTED.

ROUTING/SURVEY  
DATE: 2/27/01  
DRAWN BY: HMB  
CHECKED BY: JMR

SCALE: 1" = 20'

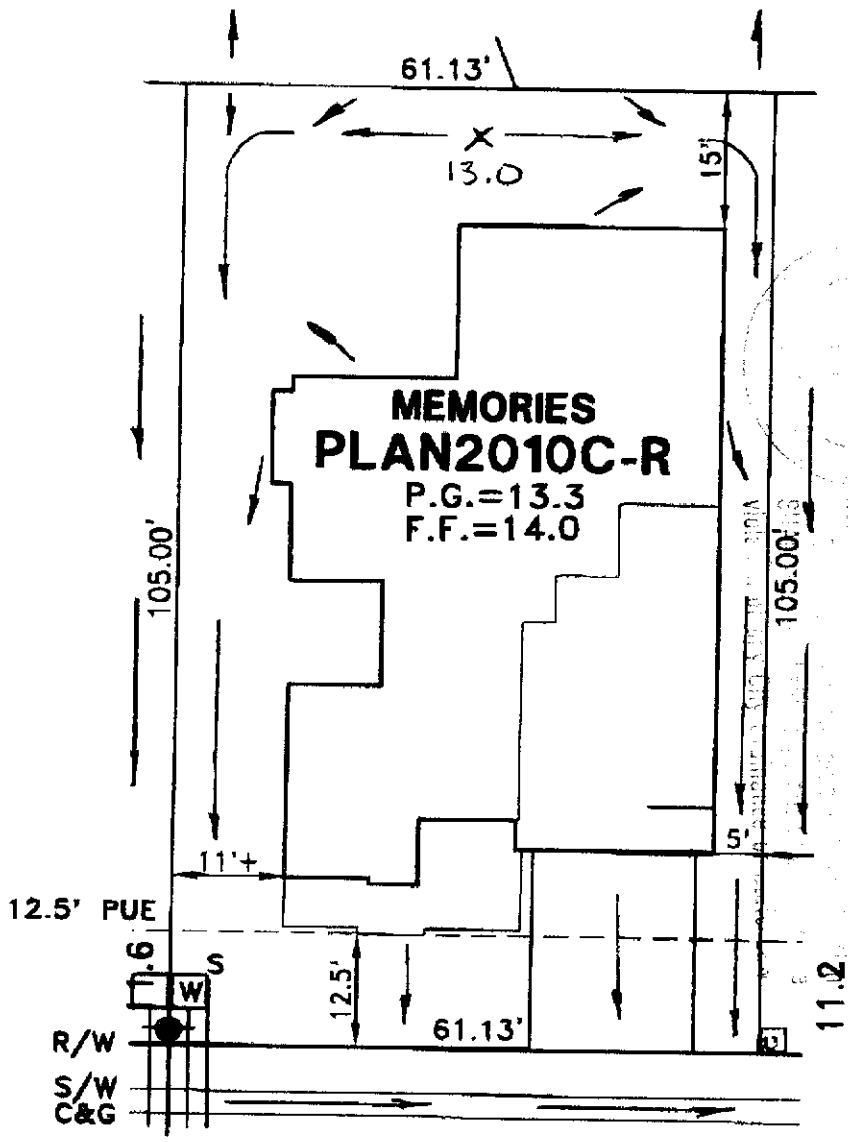

### ALCANTAR CIRCLE

☐ = UTILITY SERVICE BOX  
● = FIRE HYDRANT

**PLOT PLAN  
LOT 57  
RIVER VIEW #2 VILLAGE 2A  
FOR  
BEAZER HOMES**

CITY OF SACRAMENTO CALIFORNIA

CIVIL ENGINEERING SURVEYING  
MAPPING PLANNING

**WOOD RODGERS INC.**  
3301 C STREET BLDG. 100B SACRAMENTO, CA 95816  
TEL: 916/341-7760 FAX: 916/341-7767

DATE: FEB 2001	DRAWN: HMB	CHECKED: JMR	PROJECT NO: 1055.015
-------------------	---------------	-----------------	-------------------------

J:\JOBS\RIVERVIEW\DWG\FROMREY\UNIT2\PHASE2A\PLOTPANS\LOT57.DWG 02/27/01 05:59