

CITY OF SACRAMENTO

1231 I Street, Sacramento, CA 95814

Permit No: 0112582

Insp Area: 4

Site Address: 60 SPINEL CR SAC

Thos Bros:

**Parcel No: 225-1340-025
N**

NATOMAS CROSSING UNIT 19 LOT 25

Sub-Type:

NSFR

Housing (Y/N):

CONTRACTOR

**KIMBALL HILL HOMES
10535 EAST STOCKTON BL. STE. K
ELK GROVE CA. 95624**

OWNER

ARCHITECT

Nature of Work: KIMBALL HILL MP3161 NSFR

CONSTRUCTION LENDING AGENCY : I hereby affirm under penalty of perjury that there is a construction lending agency for the performance of the work for which this permit is issued (Sec. 3097, Civ. C).

Lender's Name _____

Lender's Address _____

LICENSED CONTRACTORS DECLARATION: I hereby affirm under penalty of perjury that I am licensed under provisions of Chapter 9 (commencing with section 7000) of Division 3 of the Business and Professions Code and my license is in full force and effect.

License Class **B**

License Number 701803

Date 10/04/01

Contractor Signature *N. Collins*

OWNER-BUILDER DECLARATION: I hereby affirm under penalty of perjury that I am exempt from the contractors License Law for the following reason (Sec. 7031.5, Business and Professions Code; any city or county which requires a permit to construct, alter, improve, demolish, or repair any structure, prior to its issuance, also requires the applicant for such permit to file a signed statement that he or she is licensed pursuant to the provisions of the Contractors License Law (Chapter 9 (commencing with Section 7000) of Division 8 of the Business and Professions Code) or that he or she is exempt therefrom and the basis for the alleged exemption. Any violation of Section 7031.5 by any applicant for a permit subjects the applicant to a civil penalty of not more than five hundred dollars (\$500.00);

____ I, as a owner of the property, or my employees with wages as their sole compensation, will do the work, and the structure is not intended or offered for sale (Sec. 7044, Business and Professional Code: The Contractors License Law does not apply to an owner of property who builds or improves thereon, and who does such work himself or herself or through his/her own employees, provided that such improvements are not intended or offered for sale. If, however, the building or improvement is sold within one year of completion, the owner-builder will have the burden of proving that he/she did not build or improve for the purpose of sale.)

____ I, as owner of the property, am exclusively contracting with licensed contractors to construct the project (Sec. 7044, Business and Professions Code: The Contractors License Law does not apply to an owner of property who builds or improves thereon, and who contracts for such projects with a contractor(s) licensed pursuant to the Contractors License Law).

____ I am exempt under Sec. _____ B & PC for this reason: _____

Date _____

Owner Signature _____

IN ISSUING THIS BUILDING PERMIT, the applicant represents, and the city relies on the representation of the applicant, that the applicant verified all measurements and locations shown on the application or accompanying drawings and that the improvement to be constructed does not violate any law or private agreement relating to permissible or prohibited locations for such improvements. This building permit does not authorize any illegal location of any improvement or the violation of any private agreement relating to location of improvements.

I certify that I have read this application and state that all information is correct. I agree to comply with all city and county ordinances and state laws relating to building construction and hereby authorize representative(s) of this city to enter upon the abovementioned property for inspection purposes.

Date 10/04/01

Applicant/Agent Signature *N. Collins*

WORKER'S COMPENSATION DECLARATION: I hereby affirm under penalty of perjury one of the following declarations:

____ I have and will maintain a certificate of consent to self-insure for workers' compensation as provided for by Section 3700 of the Labor Code, for the performance of work for which the permit is issued.

I have and will maintain workers' compensation insurance, as required by Section 3700 of the Labor Code, for the performance of the work for which this permit is issued. My workers' compensation insurance carrier and policy number are:

Carrier CLAREDON NAT. INS. CO.

Policy Number SCF98-3482-000

Exp Date 10/01/2001

____ (This section need not be completed if the permit is for \$100 or less) I certify that in the performance of the work for which this permit is issued, I shall not employ any person in any manner so as to become subject to the workers' compensation laws of California and agree that if I should become subject to the workers' compensation provisions of Section 3700 of the Labor Code, I shall forthwith comply with those provisions.

Date 10/04/01

Applicant Signature *N. Collins*

WARNING: FAILURE TO SECURE WORKER'S COMPENSATION COVERAGE IS UNLAWFUL AND SHALL SUBJECT AN EMPLOYER TO CRIMINAL PENALTIES AND CIVIL FINES UP TO ONE HUNDRED THOUSAND DOLLARS (\$100,000) IN ADDITION TO THE COST OF COMPENSATION, DAMAGES AS PROVIDED FOR IN SECTION 3706 OF THE LABOR CODE, INTEREST AND ATTORNEY'S FEE.

THIS PERMIT SHALL EXPIRE BY LIMITATION IF WORK IS NOT COMMENCED WITHIN 180 DAYS.

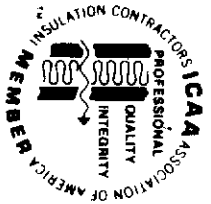

**INSULATION CONTRACTORS
ASSOCIATION
OF AMERICA**

INSULATION
CERTIFICATE

70425

1321 DUKE STREET, SUITE 303 • ALEXANDRIA, VA 22314 • (703) 739-0356

THIS IS TO CERTIFY THAT INSULATION HAS BEEN INSTALLED IN CONFORMANCE WITH CURRENT ENERGY REGULATIONS, CALIFORNIA ADMINISTRATIVE CODE TITLE 24, STATE OF CALIFORNIA IN THE BUILDING LOCATED AT:

R.H.A. LOT # 25 TRACT # NATDMS

STREET Leo SPIVET CITY SACRAMENTO

EXTERIOR WALLS:

MANUFACTURER EG THICKNESS/TYPE 3 5/8" VALUE 13

CEILING:

BATS: MANUFACTURER EG THICKNESS/TYPE 10 R- VALUE 30

BLOWN IN: MANUFACTURER AT MINIMUM THICKNESS 12 R- VALUE 30

SQUARE FOOTAGE COVERED 1886 NUMBER OF BAGS USED 36

FLOORS: MANUFACTURER _____ THICKNESS/TYPE _____ R- VALUE _____

SLAB ON GRADE: MANUFACTURER _____ THICKNESS/TYPE _____ R- VALUE _____

WIDTH OF INSULATION _____ INCHES

FOUNDATION WALLS: MANUFACTURER _____ THICKNESS/TYPE _____ R- VALUE _____

GENERAL CONTRACTOR _____ CALIFORNIA CONTRACTORS LICENSE # _____ DATE _____

SIGNATURE _____ TITLE _____

INSULATION CONTRACTOR **ARCADE INSULATION** DATE 4-21-2
CALIFORNIA CONTRACTORS LICENSE #263784

SIGNATURE [Signature] TITLE Rigman

RESIDENTIAL BUILDING PERMIT APPLICATION

New Construction

Addition

Remodels

Other

Project Address: 60 Spinel Circle

Assessor Parcel # 225-

OWNER INFORMATION:

Lot 25

Legal Property Owner: Kimball Hill Homes

Phone # (916) 714-1153

Owner Address: 10535 East Stockton Blvd
Suite K City Elk Grove State Ca. Zip 95624

CONTRACTOR INFORMATION:

Natomas Crossing #19

Contractor: Kimball Hill Homes Llc # 701803

Phone # 714-1153 Fax# 714-1425

PROJECT INFORMATION:

Land Use Zone R-14

Occupancy Group R-3

Construction Type VN

Fed Code 1A

No. of stories: 2

No. of rooms: 10

Street width: _____

1st Floor Area _____

2nd Floor Area _____

Basement _____

Roof Material _____

AREA IN SQUARE FOOT OF:

EXISTING

NEW

Dwelling/Living _____

3161

Garage/Storage _____

653

Decks/Balconies _____

Carports _____

SCOPE OF WORK:

FOR OFFICE USE ONLY

- Information above complete
- Violation files checked
- Standard setbacks
- County Sewer

- AR Flood Waiver required
- Flood Elevation Certificate Required
- Water Development Infill Area

- Planning Approval
- Design Review Approval
- Special Fee Districts Apply :

NEW STRUCTURES & ADDITIONS

◆ THE FOLLOWING MUST BE PROVIDED IN ORDER TO SUBMIT FOR PLAN REVIEW

- 2 COMPLETE PLANS, LEGIBLE & DRAWN TO SCALE
- 3 SETS IF PROJECT IS IN A DESIGN REVIEW AREA

◆ Plans to include: site plan, floor plan, elevations, roof/ceiling plan, foundation and structural framing details, and structural calculations for non-conforming structures.

- Title 24 Energy Compliance documentation
- Grading and Erosion Control Questionnaire
- 11" x 17" copy of floor plan for County Assessor
- Plan Review Fees

Date: _____

Received by: (staff) _____



INSTALLATION CARD

OMEGA DIAMOND WALL INSULATING ONE COAT SYSTEM
OMEGA PRODUCTS INTERNATIONAL, INC.

Address:

60 Spinel Cir.
SACRAMENTO, CA

ICBO Evaluation Service, Inc.
Report 4004

3-29-02
Date of Job Completion

Plastering Contractor:

Mid Valley Plastering, Inc.

Address: 4807 S. Airport Way, Unit # D

Stockton, CA 95206-4924

Phone: (209) 234-2671

Registered Contractor Number as
required by the Coating Manufacturer

Omega Diamond Wall No. 2315

I hereby certify that the exterior system on the building exterior at the above
address has been installed in accordance with the evaluation report specified above
and in accordance with the manufacturer's instructions

[Signature]
Plastering Contractor

4-1-02
Date

This installation card must be presented to the building inspector after completion
and before final inspection

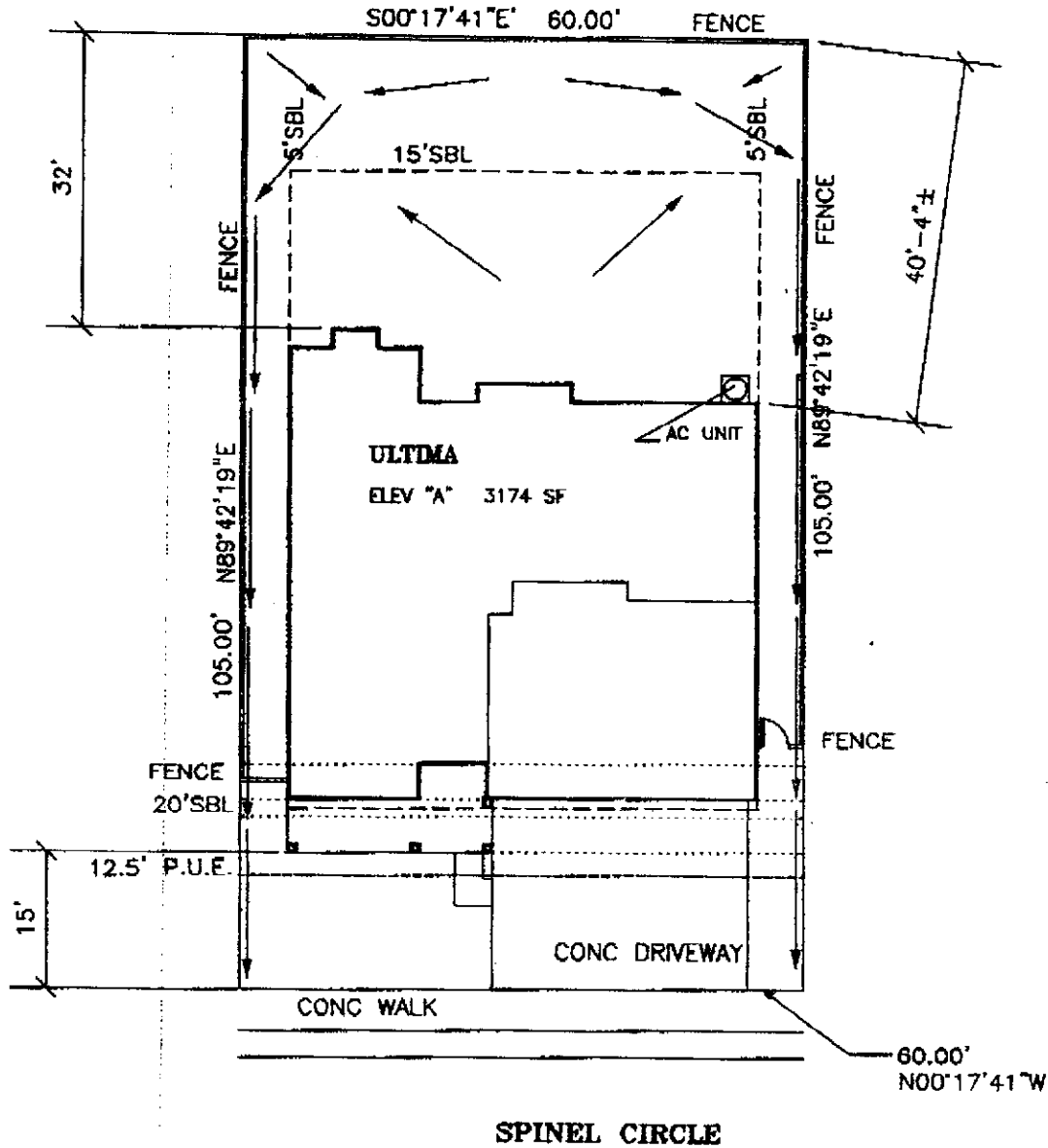

BLOOM
Architectural
Developments
Incorporated
 4437 Kenneth Avenue
 Fair Oaks, CA 95628
 (916)961-1553
 (916)967-3611 Fax

www.bloomarchitect.com



Plot Plan Disclosure This plot plan approximates a general representation of lot dimensions, easements, fence and home placement, etc. This illustration is not a condition of Kimball Hill Homes sales agreement. The actual placement and measurements demonstrated on this diagram are subject to change without notice.

Signature _____

KHH California, Inc. (916)714-1153
 10535 E. Stockton Blvd. Ste. K, Elk Grove, CA 95758



Job#	1642 25	Plan#	3161
Date	Jul 14 01	Draft	1
Plan	ULTIMA	Elev	A
Project	Natomas Crossing		
Lot	25	Unit	19
Address	60 Spinel Cir		
City	Sacramento	State	CA
APN			-0000

PLOT PLAN
 Scale 1"=20'