

CITY OF SACRAMENTO

1231 I Street, Sacramento, CA 95814

Permit No: 0404091

Insp Area: 1

Thos Bros: 297G5

Site Address: 3573 FOLSOM BL SAC

Parcel No: 007-0233-008

Sub-Type: REP

Housing (Y/N): N

CONTRACTOR

SPENCER P LEGATE
4000 COPPERTREE WY
SACAMENTO CA 95821

OWNER

SWEETLAND HELEN
3573 FOLSOM BL
SACRAMENTO CA 95816

ARCHITECT

Nature of Work: STRENGTHEN ROOF STRUCTURAL MEMBERS (REAR UNIT)

CONSTRUCTION LENDING AGENCY : I hereby affirm under penalty of perjury that there is a construction lending agency for the performance of the work for which this permit is issued (Sec. 3097, Civ. C).

Lender's Name _____ Lender's Address _____

LICENSED CONTRACTORS DECLARATION: I hereby affirm under penalty of perjury that I am licensed under provisions of Chapter 9 (commencing with section 7000) of Division 3 of the Business and Professions Code and my license is in full force and effect.

License Class B License Number 547874 Date X 19 March 04 Contractor Signature Spencer P. Legate

OWNER-BUILDER DECLARATION: I hereby affirm under penalty of perjury that I am exempt from the contractors License Law for the following reason (Sec. 7031.5, Business and Professions Code; any city or county which requires a permit to construct, alter, improve, demolish, or repair any structure, prior to its issuance, also requires the applicant for such permit to file a signed statement that he or she is licensed pursuant to the provisions of the Contractors License Law (Chapter 9 (commencing with Section 7000) of Division 8 of the Business and Professions Code) or that he or she is exempt therefrom and the basis for the alleged exemption. Any violation of Section 7031.5 by any applicant for a permit subjects the applicant to a civil penalty of not more than five hundred dollars (\$500.00);

____ I, as a owner of the property, or my employees with wages as their sole compensation, will do the work, and the structure is not intended or offered for sale (Sec. 7044, Business and Professional Code: The Contractors License Law does not apply to an owner of property who builds or improves thereon, and who does such work himself or herself or through his/her own employees, provided that such improvements are not intended or offered for sale. If, however, the building or improvement is sold within one year of completion, the owner-builder will have the burden of proving that he/she did not build or improve for the purpose of sale.)

____ I, as owner of the property, am exclusively contracting with licensed contractor to construct the project (Sec. 7044, Business and Professions Code: The Contractors License Law does not apply to an owner of property who builds or improves thereon, and who contracts for such projects with a contractor(s) licensed pursuant to the Contractors License Law).

**PAYED
CITY OF SACRAMENTO**

I am exempt under Sec. _____ B & PC for this reason: MAR 19 2004

Date _____ Owner Signature _____

**NEIGHBORHOODS, PLANNING
AND DEVELOPMENT SERVICES**

IN ISSUING THIS BUILDING PERMIT, the applicant represents and warrants on behalf of the applicant, that the applicant verified all measurements and locations shown on the application or accompanying drawings and that the improvement to be constructed does not violate any law or private agreement relating to permissible or prohibited locations for such improvements. This building permit does not authorize any illegal location of any improvement or the violation of any private agreement relating to location of improvements.

I certify that I have read this application and state that all information is correct. I agree to comply with all city and county ordinances and state laws relating to building construction and hereby authorize representative(s) of this city to enter upon the abovementioned property for inspection purposes.

Date 7 19 March 2004 Applicant/Agent Signature X Spencer P. Legate

WORKER'S COMPENSATION DECLARATION: I hereby affirm under penalty of perjury one of the following declarations:

____ I have and will maintain a certificate of consent to self-insure for workers' compensation as provided for by Section 3700 of the Labor Code, for the performance of work for which the permit is issued.

SP I have and will maintain workers' compensation insurance, as required by Section 3700 of the Labor Code, for the performance of the work for which this permit is issued. My workers' compensation insurance carrier and policy number are:

Carrier STATE FUND Policy Number 1115472 Exp Date 03/01/2005

____ (This section need not be completed if the permit is for \$100 or less) I certify that in the performance of the work for which this permit is issued, I shall not employ any person in any manner so as to become subject to the workers' compensation laws of California and agree that if I should become subject to the workers' compensation provisions of Section 3700 of the Labor Code, I shall forthwith comply with those provisions.

Date X 19 March 2004 Applicant Signature X Spencer P. Legate

WARNING: FAILURE TO SECURE WORKER'S COMPENSATION COVERAGE IS UNLAWFUL AND SHALL SUBJECT AN EMPLOYER TO CRIMINAL PENALTIES AND CIVIL FINES UP TO ONE HUNDRED THOUSAND DOLLARS (\$100,000) IN ADDITION TO THE COST OF COMPENSATION, DAMAGES AS PROVIDED FOR IN SECTION 3706 OF THE LABOR CODE, INTEREST AND ATTORNEY'S FEE.

THIS PERMIT SHALL EXPIRE BY LIMITATION IF WORK IS NOT COMMENCED WITHIN 180 DAYS.

0404091K
3573 FOLSOM BL.

SWEETLAND GARAGE/COTTAGE
3573 1/2 FOLSOM BLVD.

SPENCE LE GATO
Gen. Contractor

PROJECT: Remove ROOF SWALES by SISTERING 2"X8" RAFTERS to existing 2"X4" rafters @ 32" O.C. Re-sheet and re-roof with 30 year comp.

NAIL w/ 16d @ 12" o/c

ISSUED

MAR 19 2004

Sacramento Building Division

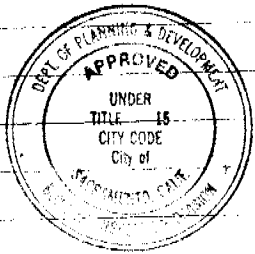

This set of plans and specifications must be kept on the job at all times and it is unlawful to make any changes or alterations from the same without written permission from the Building Inspection Division.

The approval of this plan and specification SHALL NOT be held to permit or approve the violation of any City Ordinance or State Law.

Blal
3/19/04

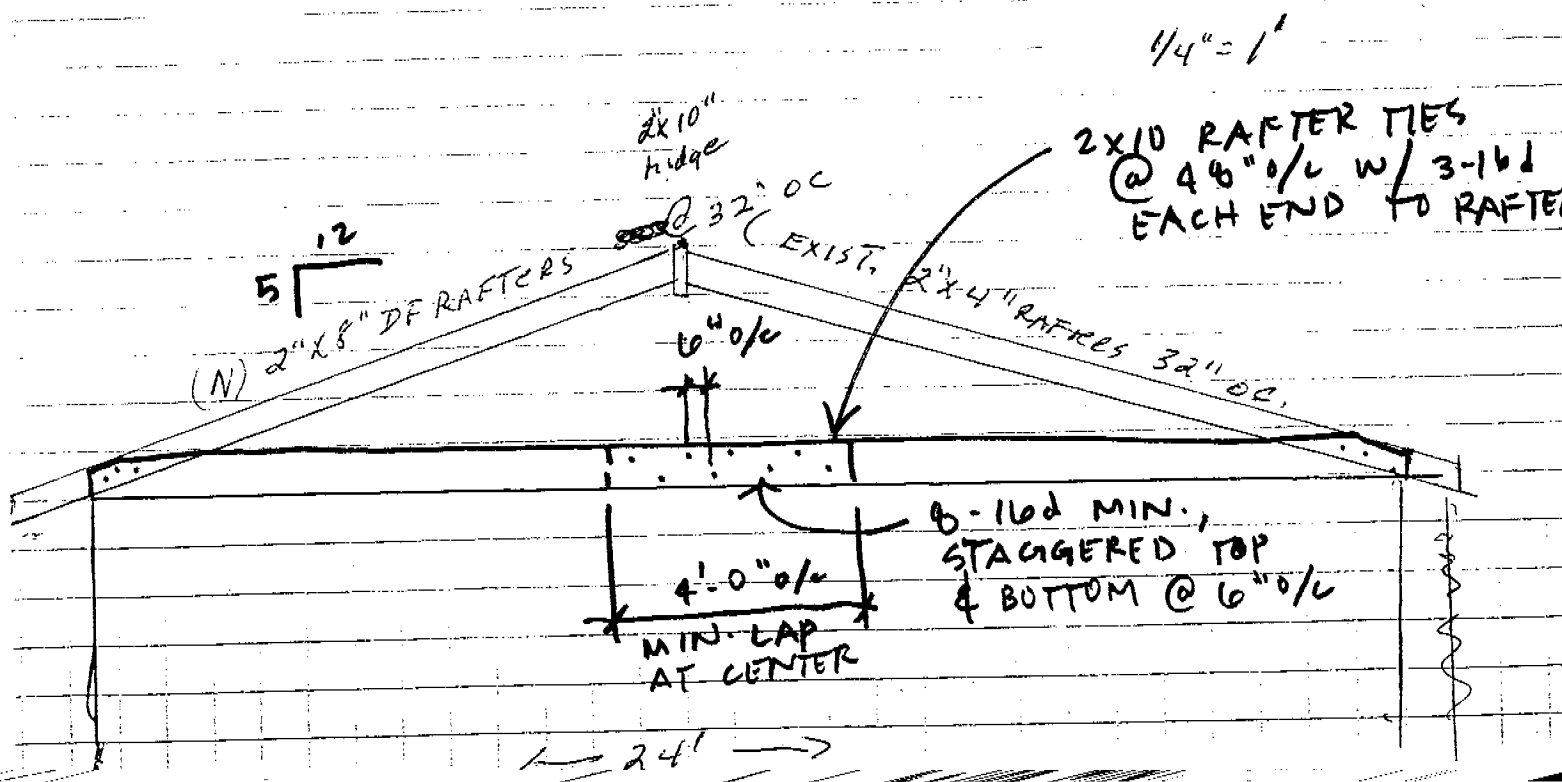

← 24' →

EXIST. 2"X4" @ 32" O.C.

(N) 2"X8" @ 32" O.C.
SISTERED TO EXIST

L

(N) 2"X10" RIDGE BEAM

STRIP
OLD
ROOF

SISTER
IN

2"X8" RAFTER

TO EXISTING

2"X4" RAFTER

Re-sheet
with 5/8"
plywood

ADD INSTAL

30 YEAR COM
SHINGLE.

↑
36'
↓

ISSUED

MAR 1 9 2008

sacramento Building Division

1/4" = 1'

SWEETLAND GARAGE/COTTAGE
25721 FAISAN BLVD

SPENCE LE GATE
GEN. CONTRACTOR