

CONSTRUCTION LENDING AGENCY

I hereby affirm under penalty of perjury that there is a construction lending agency for the performance of the work for which this permit is issued (Sec. 3097, Civ. C.).

Lenders Name _____
Lenders Address _____

LICENSED CONTRACTORS DECLARATION

I hereby affirm under penalty of perjury that I am licensed under provisions of Chapter 9 (commencing with Section 7000) of Division 3 of the Business and Professions Code and my license is in full force and effect.

License Class 045 Lic. Number 4423432
Date 11/24 Contractor [Signature]
(Signature)

OWNER - BUILDER DECLARATION

I hereby affirm under penalty of perjury that I am exempt from the Contractors License Law for the following reason (Sec. 7031.5, Business and Professions Code: Any city or county which requires a permit to construct, alter, improve, demolish, or repair any structure, prior to its issuance, also requires the applicant for such permit to file a signed statement that he or she is licensed pursuant to the provisions of the Contractors License Law (Chapter 9 (commencing with Section 7000) of Division 8 of the Business and Professions Code) or that he or she is exempt therefrom and the basis for the alleged exemption. Any violation of Section 7031.5 by any applicant for a permit subjects the applicant to a civil penalty of not more than five hundred dollars (\$500.00):

I, as owner of the property, or my employees with wages as their sole compensation, will do the work, and the structure is not intended or offered for sale (Sec. 7044, Business and Professions Code: The Contractors License Law does not apply to an owner of property who builds or improves thereon, and who does such work himself or herself or through his or her own employees, provided that such improvements are not intended or offered for sale. If, however, the building or improvement is sold within one year of completion, the owner-builder will have the burden of proving that he or she did not build or improve for the purpose of sale.)

I, as owner of the property, am exclusively contracting with licensed contractors to construct the project (Sec. 7044, Business and Professions Code: The Contractors License Law does not apply to an owner of property who builds or improves thereon, and who contracts for such projects with a contractor(s) licensed pursuant to the Contractors License Law).

I am exempt under Sec. _____ B & P C for this reason _____

Date _____ Owner _____ (Signature)

In issuing this building permit, the applicant represents, and the City relies on the representation of the applicant, that the applicant verified all measurements and locations shown on the application or accompanying drawings and that the improvement to be constructed does not violate any law or private agreement relating to permissible or prohibited locations for such improvements. This building permit does not authorize any illegal location of any improvement or the violation of any private agreement relating to location of improvements.

I certify that I have read this application and state that all information is correct. I agree to comply with all city and county ordinances and state laws relating to building construction and hereby authorize representative of this city to enter upon the above mentioned property for inspection purposes.

Date 11/24/09 Signature of Applicant or Agent [Signature]

USE BLACK INK BALL POINT PEN - PRESS FIRMLY
SIGN PERMIT APPLICATION

SITE ADDRESS 1089 ARDEN WAY, (Arden Fairway) SACRAMENTO 95828
SUITE 405
INSP. AREA 2086

ASSESSOR PARCEL NO. 277-0160-071 PERMIT NO. 913569

LICENSED CONTRACTOR BUDE CITY SIGNS ADDRESS 249 SARGENT WY. ZIP CODE 95691 PHONE NO. 371-3800

BUSINESS OWNER AVIATE PAINTS SIGN INFORMATION 920-8652

- ATTACHED INTERIOR / ELECT. SINGLE FACED
- ILLUMINATED NON-ILLUMINATED BILLBOARD / SUBDIVISION
- INDIVIDUAL LETTERS PAINTED ON BUILDING LOGO
- METAL POLE DOUBLE FACED
- PLASTIC MONUMENT VINYL/GATOR FOAM
- WOODEN PROJECTING RE-FACE

SIGN COPY 4 AVIATE PAINTS
GRASSA ALCON TUBING CO
RAVIA .. RA. SIGNING
CITY OF SACRAMENTO PERMIT SERVICES
BUILDING INSPECTION DIVISION 264-7819

WORKER'S COMPENSATION DECLARATION

I hereby affirm under penalty of perjury one of the following declarations:
 I have and will maintain a certificate of consent to self-insure for workers' compensation as provided for by Section 3700 of the Labor Code, for the performance of work for which the permit is issued.

I have and will maintain workers' compensation insurance, as required by Section 3700 of the Labor Code, for the performance of the work for which this permit is issued. My workers' compensation insurance carrier and policy number are:
Carrier STATE FUND INS.

Policy Number 1455554.99

(This section need not be completed if the permit is for one hundred dollars (\$100) or less) I certify that in the performance of the work for which this permit is issued, I shall not employ any person in any manner so as to become subject to the workers' compensation laws of California and agree that if I should become subject to the workers' compensation provisions of Section 3700 of the Labor Code, I shall comply with those provisions.

Date 11/24 Applicant [Signature]

WARNING: FAILURE TO SECURE WORKERS' COMPENSATION COVERAGE IS UNLAWFUL AND SHALL SUBJECT AN EMPLOYER TO CRIMINAL PENALTIES AND CIVIL FINES UP TO ONE HUNDRED THOUSAND DOLLARS (\$100,000) IN ADDITION TO THE COST OF COMPENSATION, DAMAGES AS PROVIDED FOR IN SECTION 3706 OF THE LABOR CODE, INTEREST AND ATTORNEY'S FEES.

THIS PERMIT SHALL EXPIRE BY LIMITATION IF WORK AUTHORIZED IS NOT COMMENCED WITHIN 180 DAYS.

(A) HEIGHT _____	(B) LENGTH _____
(A X B) SIGN AREA _____	FOOTING SIZE _____
POLE SIZE _____	POLE SIZE _____
STREET FRONTAGE (FT) _____	STREET FRONTAGE (FT) _____
OCCUPANCY FRONTAGE (FT) _____	OCCUPANCY FRONTAGE (FT) _____
ENGINEERING REQUIRED? YES <input checked="" type="checkbox"/> NO <input type="checkbox"/>	ENGINEERING REQUIRED? YES <input checked="" type="checkbox"/> NO <input type="checkbox"/>
DESIGN REVIEW REQUIRED? YES <input checked="" type="checkbox"/> NO <input type="checkbox"/>	DESIGN REVIEW REQUIRED? YES <input checked="" type="checkbox"/> NO <input type="checkbox"/>
SPECIAL PERMIT REQUIRED? YES <input checked="" type="checkbox"/> NO <input type="checkbox"/>	SPECIAL PERMIT REQUIRED? YES <input checked="" type="checkbox"/> NO <input type="checkbox"/>
VARIANCE REQUIRED? YES <input checked="" type="checkbox"/> NO <input type="checkbox"/>	VARIANCE REQUIRED? YES <input checked="" type="checkbox"/> NO <input type="checkbox"/>
LOCATED IN PUD? YES <input checked="" type="checkbox"/> NO <input type="checkbox"/>	LOCATED IN PUD? YES <input checked="" type="checkbox"/> NO <input type="checkbox"/>
SIGN VALUATION	
A. TYPE OF SIGN _____	SIGN VALUATION _____
B. \$ _____ PER SQ. FT. X _____ SQ. FT. = \$ _____	
APPROVED BY <u>[Signature]</u> DATE _____	APPROVED BY <u>[Signature]</u> DATE _____
DENIED BY _____ DATE _____	DENIED BY _____ DATE _____
FINAL INSPECTIONS	
BUILDING INSPECTOR _____ DATE _____	BUILDING INSPECTOR _____ DATE _____
ELECTRICAL INSPECTOR _____ DATE _____	ELECTRICAL INSPECTOR _____ DATE _____
SIGN INSPECTOR _____ DATE _____	SIGN INSPECTOR _____ DATE _____
FEES:	RECEIVED
CITY OF SACRAMENTO	DATE AMOUNT
PAYED	
ENERGY SIGNAGE	
NEIGHBORHOOD COMMUNITY	
CITY AND COUNTY PLANNING	
AND DESIGN SERVICES	
OTHER	
TOTAL FEES \$ _____	

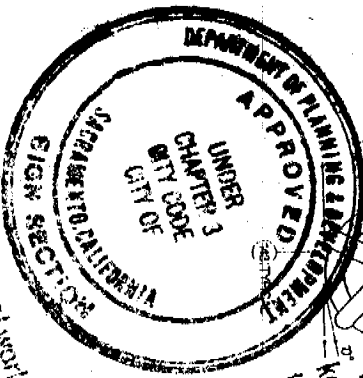

This set of plans and specifications must be kept in the job file and it is understood that no alterations or changes shall be made without written permission from the City of Sacramento Sign Section. The approval of this plan and specifications shall not be construed as a warranty or representation of any kind by the City of Sacramento. The approval of this plan and specifications shall not be construed as a warranty or representation of any kind by the City of Sacramento.

SIGN LOCATION
 ALL ELECTRICAL WORK MUST BE U.L. LABELED OR BE OF EQUIPMENT 14, AND COMPLY WITH CHAPTER 14, STANDARDS, N.E.C. Sec. 90.6, CITY CODE, DIV. 2 OF SACRAMENTO.

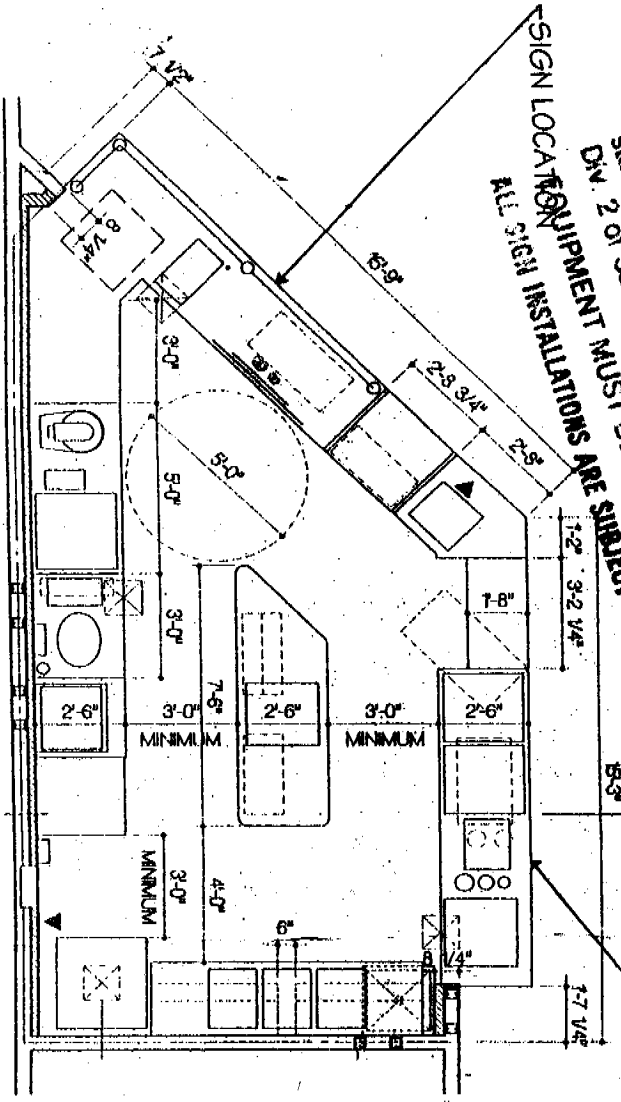

SITE PLAN
 SCALE: 3/16" = 1'

5-20366

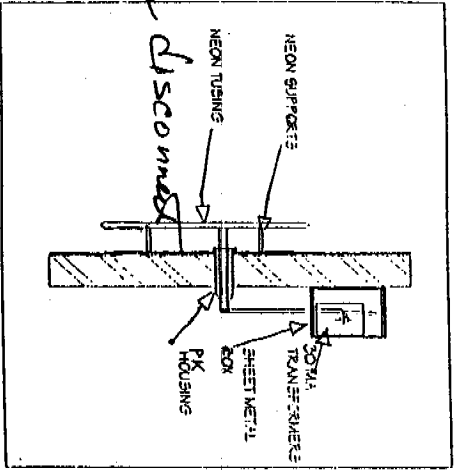

SECTION DETAIL
 NOT TO SCALE

APPROVED PER 1996
 NATIONAL ELECTRICAL CODE
 AND CITY OF SACRAMENTO
 AMENDMENTS:
 11-24-99
 ELECTRICAL DIVISION

MANUFACTURE AND INSTALL:
 TWO (2) SETS EXPOSED NEON LETTERS AND PRETZEL
 10 MM DOUBLE STROKE NEON, HALO BLUE COLOR
 OFFSET MOUNTED ON GLASS POSTS
 U.L. PK HOUSINGS & GREENFIELD CONNECTIONS

FILE COPY

RIVER CITY SIGNS	
2419 SELLERS WAY WEST SACRAMENTO, CA 95871 (916) 577-3800 FAX 577-3757	
PROJECT NAME	AUNTIE ANNIE'S ARDEN FAIR MALL
ADDRESS	1689 ARDEN WAY SACRAMENTO, CA
SCALE	DATE 11-3-99
SALESMAN LEE	DESIGNER DUSTIN
APPROVED	
Landlord	Tenant
JOB NUMBER 7927	



RIVER CITY
SIGNS

2419 SELLERS WAY WEST SACRAMENTO, CA 95691
(916) 371-3300 FAX 371-3757

PROJECT NAME
AUNTIE ANNIE'S
ARDEN FAIR MALL

ADDRESS
1689 ARDEN WAY
SACRAMENTO, CA

SCALE DATE
11-3-99

SALESMAN DESIGNER
LEE DUSTIN

JOB NUMBER
4927

APPROVED

Tenant _____

Landlord _____

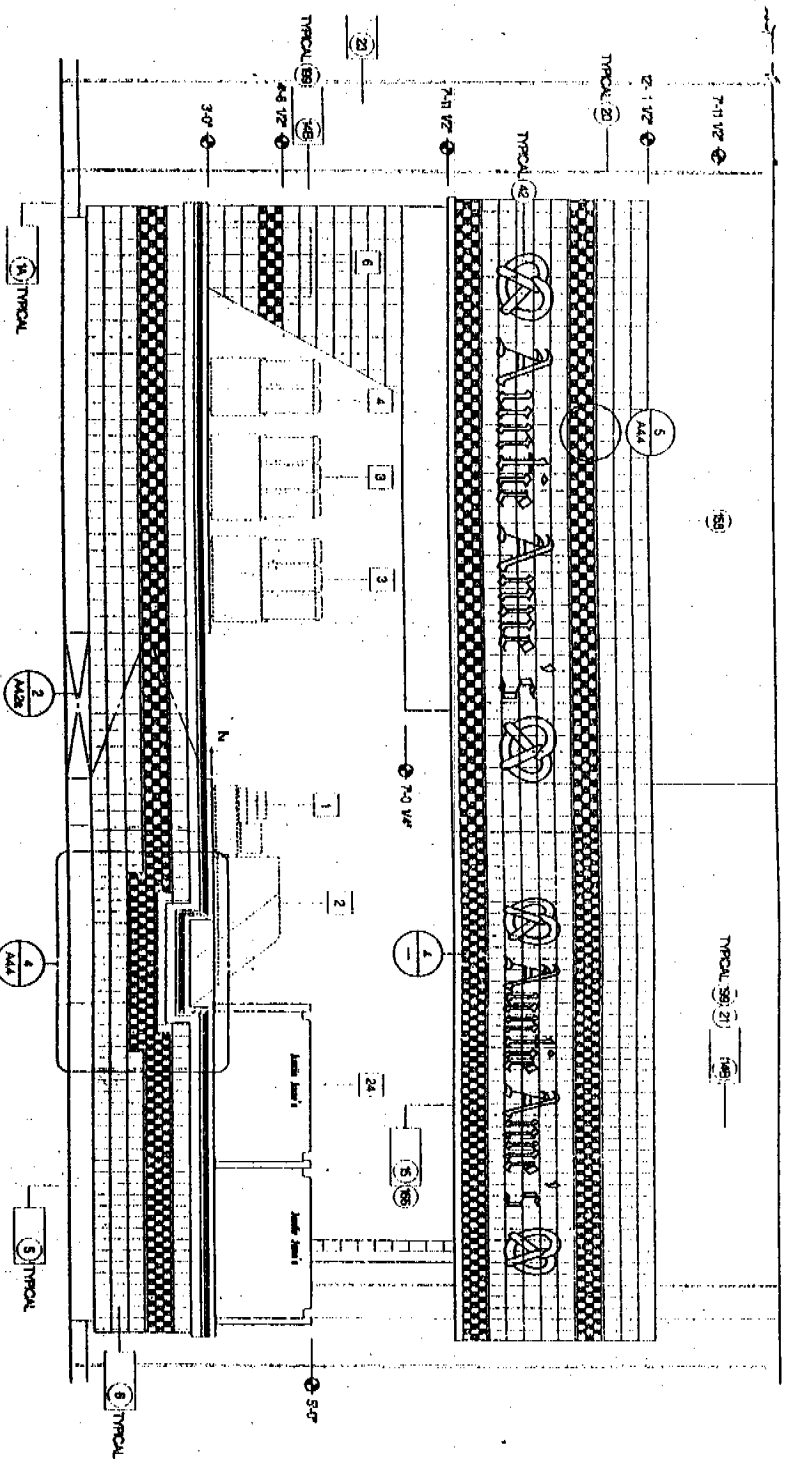

ELEVATION

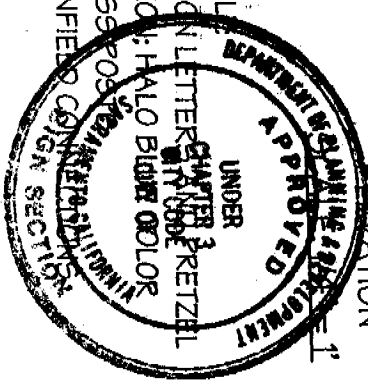

MANUFACTURE AND INSTALL
TWO (2) SETS EXPOSED NEGATIVE LETTERING
10 MM DOUBLE STROKE NEGATIVE HALO BLIND COLOR
OFFSET MOUNTED ON GLASS POSITIVE LETTERING
U.L. PK HOUSINGS & GREENFIELD CONSTRUCTION

This set of plans and specifications must be kept on the job at all times and it is unlawful to make any changes or alterations from the same without written permission from the City of Sacramento Sign Section. The approval of this plan and specifications SHALL NOT be held to permit or approve the violation of any City Ordinance or State Law.

All electrical work must be U.L. labeled or be of equivalent standards, N.E.C. Sec. 90-6/and comply with chapter 14, Div. 2 of Sacramento City Code.
EQUIPMENT MUST BE USED AS DESIGN INTENDED
ALL SIGN INSTALLATIONS ARE SUBJECT TO FIELD INSPECTIONS

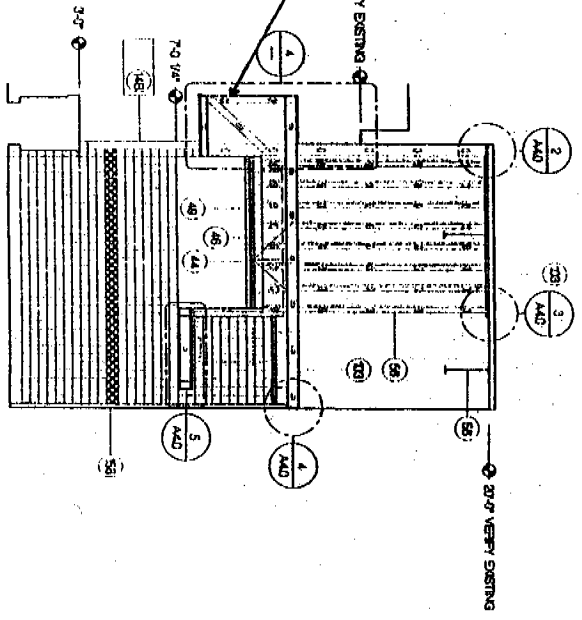

SIDE VIEW

SCALE: 1/8" = 1'

Auntie Ann's
 space # 2008
 located upstairs
 in the old
 Swiss Pictel
 space

SEARS
 154,600 S.F.

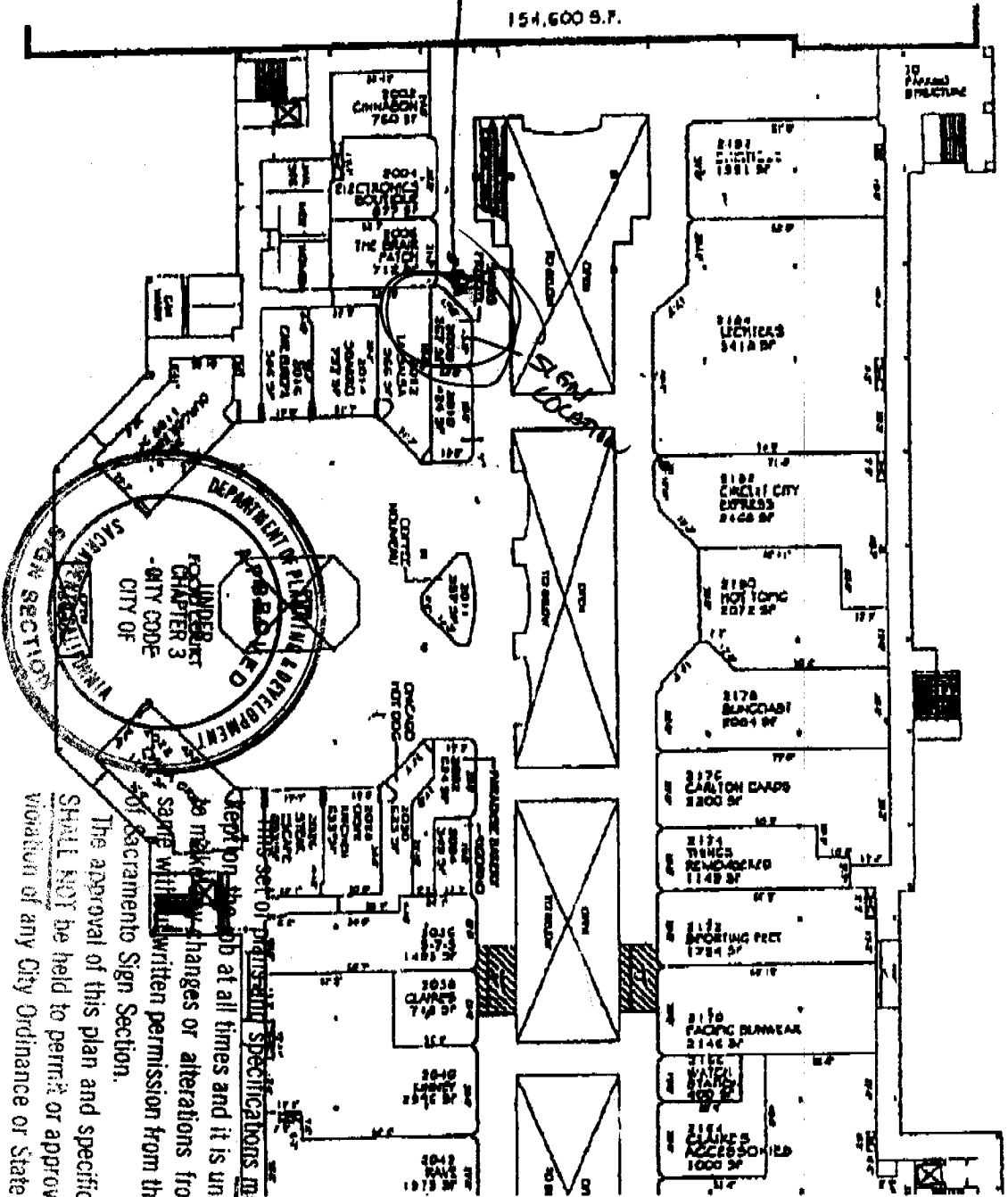

Specifications must be
 Dept on the job at all times and it is unlawful
 to make any changes or alterations from the
 same without written permission from the City
 of Sacramento Sign Section.
 The approval of this plan and specification
 SHALL NOT be held to permit or approve the
 violation of any City Ordinance or State Law.

All electrical work must be U.L. labeled or be of equivalent
 standards, N.E.C. Sec. 90.6/and comply with chapter 14,
 Div. 2 of Sacramento City Code.
EQUIPMENT MUST BE USED AS DESIGN INTENDED
ALL SIGN INSTALLATIONS ARE SUBJECT TO FIELD INSPECTIONS

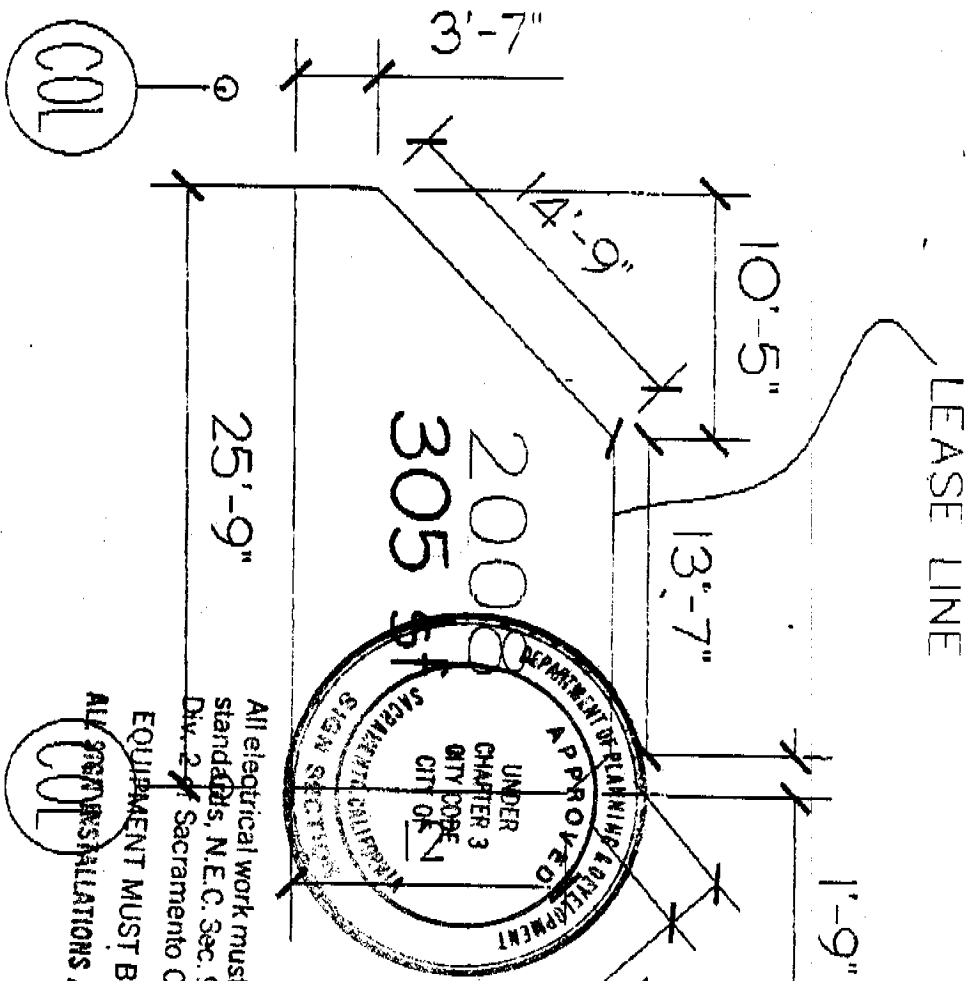

This set of plans and specifications must be kept on the job at all times and it is unlawful to make any changes or alterations from the same without written permission from the City of Sacramento Sign Section.
 The approval of this plan and specification shall not be held to permit or approve the violation of any City Ordinance or State Law.

All electrical work must be U.L. labeled or be of equivalent standard, N.E.C. Sec. 90-6/and comply with chapter 14, Div. 2 Sacramento City Code.

EQUIPMENT MUST BE USED AS DESIGN INTENDED
 ALL INSTALLATIONS ARE SUBJECT TO FIELD INSPECTIONS

AUNTIE ANNE'S PRETZELS
 SPACE #2008

