

**CITY OF SACRAMENTO**  
1231 I Street, Sacramento, CA 95814

**Permit No: 0014347**  
**Insp Area: 4**

**Site Address: 2134 MOONSTONE WY SAC**  
Parcel No: 225-1410-011  
N

Sub-Type: NSFR  
NORTHPOINTE PARK UNIT 7-2 LOT 11  
Housing (Y/N):

CONTRACTOR  
CENTEX HOMES  
3300 DOUGLAS BLVD  
STE. 210 95661

OWNER

ARCHITECT

**Nature of Work: NSFR MP1603 7 RMS 2 STORY**

**CONSTRUCTION LENDING AGENCY :** I hereby affirm under penalty of perjury that there is a construction lending agency for the performance of the work for which this permit is issued (Sec. 3097, Civ. C).

Lender's Name N/A Lender's Address \_\_\_\_\_

**LICENSED CONTRACTORS DECLARATION:** I hereby affirm under penalty of perjury that I am licensed under provisions of Chapter 9 (commencing with section 7000) of Division 3 of the Business and Professions Code and my license is in full force and effect.

License Class B License Number 734394 Date 12-7-00 Contractor Signature Debbie Stawen

**OWNER-BUILDER DECLARATION:** I hereby affirm under penalty of perjury that I am exempt from the contractors License Law for the following reason (Sec. 7031.5, Business and Professions Code: any city or county which requires a permit to construct, alter, improve, demolish, or repair any structure, prior to its issuance, also requires the applicant for such permit to file a signed statement that he or she is licensed pursuant to the provisions of the Contractors License Law (Chapter 9 (commencing with Section 7000) of Division 8 of the Business and Professions Code) or that he or she is exempt therefrom and the basis for the alleged exemption. Any violation of Section 7031.5 by any applicant for a permit subjects the applicant to a civil penalty of not more than five hundred dollars (\$500.00):

\_\_\_\_ I, as a owner of the property, or my employees with wages as their sole compensation, will do the work, and the structure is not intended or offered for sale (Sec. 7044, Business and Professional Code: The Contractors License Law does not apply to an owner of property who builds or improves thereon, and who does such work himself or herself or through his/her own employees, provided that such improvements are not intended or offered for sale. If, however, the building or improvement is sold within one year of completion, the owner-builder will have the burden of proving that he/she did not build or improve for the purpose of sale.)

\_\_\_\_ I, as owner of the property, am exclusively contracting with licensed contractors to construct the project (Sec. 7044, Business and Professions Code: The Contractors License Law does not apply to an owner of property who builds or improves thereon, and who contracts for such projects with a contractor(s) licensed pursuant to the Contractors License Law).

\_\_\_\_ I am exempt under Sec. \_\_\_\_\_ B & PC for this reason: \_\_\_\_\_

Date \_\_\_\_\_ Owner Signature \_\_\_\_\_

**IN ISSUING THIS BUILDING PERMIT,** the applicant represents, and the city relies on the representation of the applicant, that the applicant verified all measurements and locations shown on the application or accompanying drawings and that the improvement to be constructed does not violate any law or private agreement relating to permissible or prohibited locations for such improvements. This building permit does not authorize any illegal location of any improvement or the violation of any private agreement relating to location of improvements.

I certify that I have read this application and state that all information is correct. I agree to comply with all city and county ordinances and state laws relating to building construction and hereby authorize representative(s) of this city to enter upon the abovementioned property for inspection purposes.

Date 12-7-00 Applicant/Agent Signature Debbie Stawen

**WORKER'S COMPENSATION DECLARATION:** I hereby affirm under penalty of perjury one of the following declarations:  
\_\_\_\_ I have and will maintain a certificate of consent to self-insure for workers' compensation as provided for by Section 3700 of the Labor Code, for the performance of work for which the permit is issued.

I have and will maintain workers' compensation insurance, as required by Section 3700 of the Labor Code, for the performance of the work for which this permit is issued. My workers' compensation insurance carrier and policy number are:

Carrier AMER GUAR.& LIAB. INS Policy Number WC8322096-02 Exp Date 10/01/2000

\_\_\_\_ (This section need not be completed if the permit is for \$100 or less) I certify that in the performance of the work for which this permit is issued, I shall not employ any person in any manner so as to become subject to the workers' compensation laws of California and agree that if I should become subject to the workers' compensation provisions of Section 3700 of the Labor Code, I shall forthwith comply with those provisions.

Date 12-7-00 Applicant Signature Debbie Stawen

**WARNING: FAILURE TO SECURE WORKER'S COMPENSATION COVERAGE IS UNLAWFUL AND SHALL SUBJECT AN EMPLOYER TO CRIMINAL PENALTIES AND CIVIL FINES UP TO ONE HUNDRED THOUSAND DOLLARS (\$100,000) IN ADDITION TO THE COST OF COMPENSATION, DAMAGES AS PROVIDED FOR IN SECTION 3706 OF THE LABOR CODE, INTEREST AND ATTORNEY'S FEE.**

**THIS PERMIT SHALL EXPIRE BY LIMITATION IF WORK IS NOT COMMENCED WITHIN 180 DAYS.**

COUNTY SANITATION DISTRICT NO. 1  
 SACRAMENTO REGIONAL COUNTY SANITATION DISTRICT  
**SEWER IMPACT FEE** *EFB*  
 PERMIT AND CALCULATION SHEET *12-7-00*

APPLICATION NO: \_\_\_\_\_  
 GENERAL INFORMATION

BLDG PERMIT NO: *City*  
 THIS PERMIT GOOD ONLY WHEN  
 VALIDATED BY THE CASHIER  
*EFB*  
*205620 12-7-00*

THIS PERMIT TO CONNECT EXPIRES  
 ONE YEAR FROM DATE OF ISSUANCE

FEE CALCULATION		BUILDING USE	
INSPECTION		RESIDENTIAL	SF <input type="checkbox"/> MF <input type="checkbox"/>
CSD-1	<i>221.--</i>	COMMERCIAL USE	UNITS
SRCSO	<i>2404.-</i>		
CONSTRUCTION			
IN-LIEU			
<b>TOTAL FEE</b>	<b><i>2625.00</i></b>		

APN: *225-1410-018*

DESCRIPTION / SUBDIVISION *Northpointe 7-2* LOT: *18*

PROPERTY ADDRESS *2127 Moonstone Avenue*

OWNER *Gentry Hemen*

MAILING ADDRESS *3700 Douglas Blvd. # 150*

CITY-STATE-ZIP *Roseville, CA 95661* PHONE *786-8613*

ADDITIONAL FEES MAY BE DUE IF CHANGES IN USE INCREASE SEWER IMPACT.

APPLICANT SIGNATURE *Debbie Stowers*

CONSOLIDATED UTILITY BILLING USE ONLY

ACCT \_\_\_\_\_ INPUT \_\_\_\_\_ START \_\_\_\_\_

INSPECTOR'S COPY

**Natomas Unified School District**  
 1515 Sports Drive, #1 • Sacramento, CA 95834-1905  
 Phone 916/641-3300 • Fax 916/928-1629

**CERTIFICATION OF COMPLIANCE**  
**SCHOOL DISTRICT DEVELOPMENT FEES**

<b>PART I: TO BE COMPLETED BY APPLICANT</b>			
Property Owner's Name <u>Cheryl H. ...</u>			
Owner's Address <u>3700 ... #150, Box 16 95661</u>			
Project Address <u>2127 ...</u>			
Parcel Number <u>225-1410-018</u> <span style="float: right;">Lot 13</span>			
Subdivision Name <u>... 7-2</u>			
Number of Units <u>1</u>			
Print Applicant's Name <u>Denise Starnes</u>		Applicant's Signature <u>Denise Starnes</u>	
Title of Applicant <u>Permit Applicant</u>			
Date <u>11-27-00</u>		Telephone Number <u>786-8113</u>	
<b>PART II: TO BE COMPLETED BY BUILDING DEPARTMENT</b>			
Plan Identification Number <u>MC 1423</u>			
Building Type (Check One)			
<input checked="" type="checkbox"/> Residential <input type="checkbox"/> Apartment/Condominium <input type="checkbox"/> Commercial/Industrial			
Square Feet of Chargeable Building Area <u>1423 sq ft</u>			
Signature _____			
Title _____		Date _____	
<b>PART III: TO BE COMPLETED BY NATOMAS UNIFIED SCHOOL DISTRICT</b>			
District Certification Number <u>...</u>			
Fees Collected:			
Residential:	<u>1423</u>	Sq. Ft. X \$ <u>325</u>	= \$ <u>4624.75</u>
Apartment/Condominium:		Sq. Ft. X \$	= \$
Commercial/Industrial:		Sq. Ft. X \$	= \$
<b>NOTICE TO APPLICANT:</b> Pursuant to government code section 66020 (d), this will serve to notify you that the 90-day approval period in which you may protest the fees, or other payment identified above, will begin to run on the date in which the building or installation permit for this project is issued, or on which they are paid to the District, or to another public entity authorized to collect them on behalf of the District, whichever is earlier.			
Applicant Signature: <u>Denise Starnes</u>		Date: <u>11-27-00</u>	

This certification covers only the amount of square footage indicated above. Any additions or corrections to the square footage for this project will require an amendment to the Certificate of Compliance.

As the authorize Natomas Unified School District official, I hereby certify that the requirements of Government Code Section 95995 have been complied with by the above signed applicant.

SIGNATURE: \_\_\_\_\_ DATE: \_\_\_\_\_

TITLE: \_\_\_\_\_

New Construction     Addition     Remodels     Other

Project Address: 2134 Manstone Avenue

Assessor Parcel # 225-1410-011

LOT 11

0014347

OWNER INFORMATION:

Legal Property Owner: Center Homes Phone # 786-8693  
Owner Address: 3700 Douglas Blvd #150 City Roseville State CA Zip 95661

CONTRACTOR INFORMATION:

Contractor: Center Homes Lic. # 734094 Phone # 786-8693 Fax# 786-6802

PROJECT INFORMATION:

Land Use Zone RIA Occupancy Group R3 Construction Type VN Fed Code 1A  
No. of stories: 2 No. of rooms: \_\_\_\_\_ Street width: \_\_\_\_\_  
1<sup>st</sup> Floor Area 871 2<sup>nd</sup> Floor Area 732 Basement \_\_\_\_\_ Roof Material \_\_\_\_\_

AREA IN SQUARE FOOT OF:	EXISTING	NEW
Dwelling/Living	_____	<u>1603</u>
Garage/Storage	_____	<u>437</u>
Decks/Balconies	_____	_____
Carports	_____	_____

SCOPE OF WORK: MP 1603 New SFR

FOR OFFICE USE ONLY

- Information above complete
- Violation files checked
- Standard setbacks
- County Sewer
- AR Flood Waiver required
- Flood Elevation Certificate Required
- Water Development Infill Area
- Planning Approval
- Design Review Approval
- Special Fee Districts Apply : \_\_\_\_\_

NEW STRUCTURES & ADDITIONS

◆ THE FOLLOWING MUST BE PROVIDED IN ORDER TO SUBMIT FOR PLAN REVIEW

- 2 COMPLETE PLANS, LEGIBLE & DRAWN TO SCALE
  - 3 SETS IF PROJECT IS IN A DESIGN REVIEW AREA
  - Title 24 Energy Compliance documentation
  - Grading and Erosion Control Questionnaire
  - 11" x 17" copy of floor plan for County Assessor
  - Plan Review Fees
- ◆ Plans to include: site plan, floor plan, elevations, roof/ceiling plan, foundation and structural framing details, and structural calculations for non-conforming structures.

Date: \_\_\_\_\_

Received by: (staff) \_\_\_\_\_



INSULATION CERTIFICATE

THIS IS TO CERTIFY THAT INSULATION HAS BEEN INSTALLED IN CONFORMANCE WITH THE CURRENT ENERGY REGULATIONS, CALIFORNIA ADMINISTRATION CODE, TITLE 24, STATE OF CALIFORNIA, IN THE BUILDING LOCATED AT:

SITE ADDRESS: LOT 211 NORTHPOINTE SACRAMENTO, CA  
NUMBER STREET CITY STATE

CEILINGS:

BLOW: MANUFACTURER GREENSTONE THICKNESS 10.3" R/VALUE 38

SQUARE FEET 1065 # BAGS/LBS PER BAGS 31

BATTS: MANUFACTURER JOHNS MANVILLE THICKNESS 13" R/VALUE 38

JOHNS MANVILLE

EXYERIOR WALLS:

MANUFACTURER JOHNS MANVILLE THICKNESS 3.5" R/VALUE 13

JOHNS MANVILLE

FLOOR INSULATION:

MANUFACTURER JOHNS MANVILLE THICKNESS 6.5" R/VALUE 19

AIR INFILTRATION: (TITLE 24)

YES  NO

OTHER:

GENERAL CONTRACTOR: CENTEX LICENSE#

BY: TITLE: DATE

INSULATION CONTRACTOR: WESTERN INSULATION, INC. LICENSE 481278

BY: TAWNYA PEIRCE TITLE: AUTH. AGENT DATE 5/31/01

Note to Buyer: This plot plan is provided as a general layout of the property. All information on this plan, including but not limited to tree locations and sizes, setback dimensions, driveway grades, and wall heights and locations, are approximate and may vary or change without prior notice.

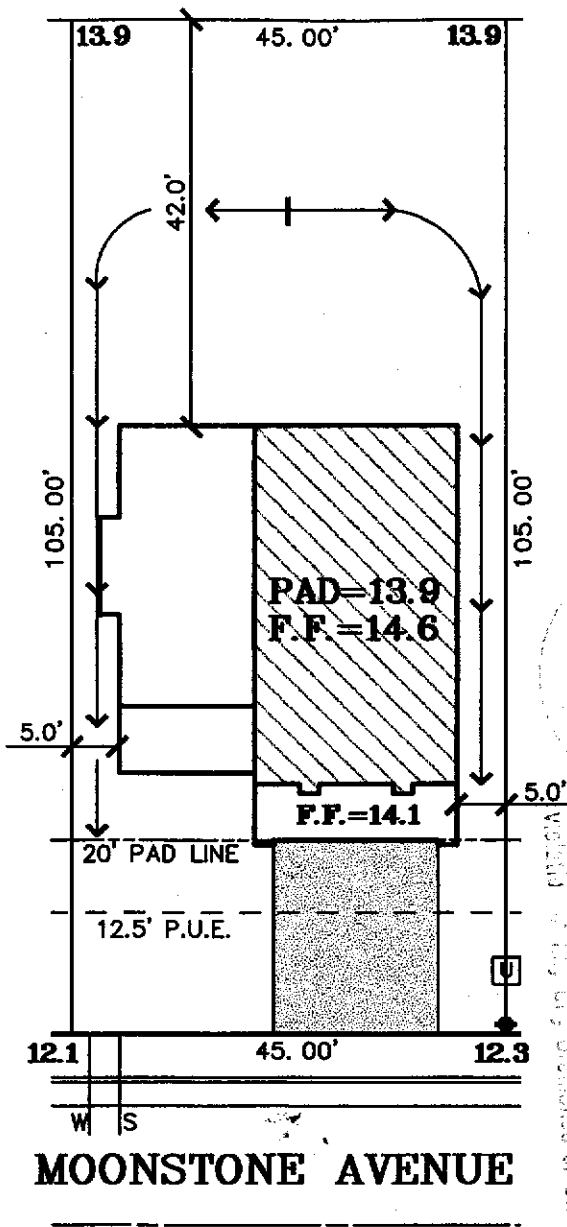

THIS PLAN IS APPROVED FOR THE CITY OF SACRAMENTO, CALIFORNIA, BY THE CITY ENGINEER, DATE 11/17/00. THE CITY ENGINEER'S OFFICE IS LOCATED AT 1500 J STREET, SACRAMENTO, CALIFORNIA 95811. THIS PLAN IS APPROVED FOR THE CITY OF SACRAMENTO, CALIFORNIA, BY THE CITY ENGINEER, DATE 11/17/00. THE CITY ENGINEER'S OFFICE IS LOCATED AT 1500 J STREET, SACRAMENTO, CALIFORNIA 95811. THIS PLAN IS APPROVED FOR THE CITY OF SACRAMENTO, CALIFORNIA, BY THE CITY ENGINEER, DATE 11/17/00. THE CITY ENGINEER'S OFFICE IS LOCATED AT 1500 J STREET, SACRAMENTO, CALIFORNIA 95811.

LOT 11  
 PLAN 1603C RIGHT  
 A.P.N.:  
 ADDRESS: 2134 MOONSTONE AVENUE  
 LOT AREA: 4,725 SF  
 LOT COVERAGE: 30%

READ AND APPROVED  
 Plan 1603 Land Development St 11/17/00  
 Elevation C Const. Manager \_\_\_\_\_  
 Orientation G-rt Sales Appr. \_\_\_\_\_  
 Color B Field Manager \_\_\_\_\_

**The Spink Corporation**  
 2590 VENTURE OAKS WAY  
 SACRAMENTO, CA 95833

**CENTEX HOMES**  
 3700 Douglas Boulevard  
 Suite 150  
 Roseville, Ca. 95661

**NORTHPOINTE PARK**  
 UNIT NO. 7 PHASE 2  
 City of Sacramento, California

PR:(916)925-5550 FAX:(916)921-9274

office: (916) 786-8693  
 fax: (916) 786-8802

Scale: 1"=20'

November 16, 2000