

CITY OF SACRAMENTO
1231 I Street, Sacramento, CA 95814

Permit No: 0406503
Insp Area: 4
Thos Bros: 257C5

Site Address: 160 REGENCY PARK CR SAC
Parcel No: 201-0940-003 REGENCY PARK B LOT 3

Sub-Type: NSFR
Housing (Y/N): N

CONTRACTOR
PULTE HOME CORP.
985 SUN CITY LN.
LINCOLN CA. 95648

OWNER

ARCHITECT

Nature of Work: MP1871 2 STORY 7 ROOM SFR

CONSTRUCTION LENDING AGENCY : I hereby affirm under penalty of perjury that there is a construction lending agency for the performance of the work for which this permit is issued (Sec. 3097, Civ. C).

Lender's Name _____ Lender's Address _____

LICENSED CONTRACTORS DECLARATION: I hereby affirm under penalty of perjury that I am licensed under provisions of Chapter 9 (commencing with section 7000) of Division 3 of the Business and Professions Code and my license is in full force and effect.

License Class B License Number 517593 Date 5/13/04 Contractor Signature KJ Hazlett

OWNER-BUILDER DECLARATION: I hereby affirm under penalty of perjury that I am exempt from the contractors License Law for the following reason (Sec. 7031.5, Business and Professions Code; any city or county which requires a permit to construct, alter, improve, demolish, or repair any structure, prior to its issuance, also requires the applicant for such permit to file a signed statement that he or she is licensed pursuant to the provisions of the Contractors License Law (Chapter 9 (commencing with Section 7000) of Division 8 of the Business and Professions Code) or that he or she is exempt therefrom and the basis for the alleged exemption. Any violation of Section 7031.5 by any applicant for a permit subjects the applicant to a civil penalty of not more than five hundred dollars (\$500.00);

I, as a owner of the property, or my employees with wages as their sole compensation, will do the work, and the structure is not intended or offered for sale (Sec. 7044, Business and Professional Code: The Contractors License Law does not apply to an owner of property who builds or improves thereon, and who does such work himself or herself or through his/her own employees, provided that such improvements are not intended or offered for sale. If, however, the building or improvement is sold within one year of completion, the owner-builder will have the burden of proving that he/she did not build or improve for the purpose of sale.)

I, as owner of the property, am exclusively contracting with licensed contractors to construct the project (Sec. 7044, Business and Professions Code: The Contractors License Law does not apply to an owner of property who builds or improves thereon, and who contracts for such projects with a contractor(s) licensed pursuant to the Contractors License Law).

I am exempt under Sec. _____ B & PC for this reason: _____
Date _____ Owner Signature _____

PAID
CITY OF SACRAMENTO
MAY 19 2004
NORTH PERMIT

IN ISSUING THIS BUILDING PERMIT, the applicant represents, and the city relies on the representation of the applicant, that the applicant verified all measurements and locations shown on the application or accompanying drawings and that the improvement to be constructed does not violate any law or private agreement relating to permissible or prohibited locations for such improvements. This building permit does not authorize any illegal location of a any improvement or the violation of any private agreement relating to location of improvements.

I certify that I have read this application and state that all information is correct. I agree to comply with all city and county ordinances and state laws relating to building construction and herby authorize representative(s) of this city to enter upon the abovementioned property for inspection purposes.

Date 5/13/04 Applicant/Agent Signature KJ Hazlett

WORKER'S COMPENSATION DECLARATION: I hereby affirm under penalty of perjury one of the following declarations:

I have and will maintain a certificate of consent to self-insure for workers' compensation as provided for by Section 3700 of the Labor Code, for the performance of work for which the permit is issued.

I have and will maintain workers' compensation insurance, as required by Section 3700 of the Labor Code, for the performance of the work for which this permit is issued. My workers' compensation insurance carrier and policy number are:

Carrier LIBERTY MUTUAL FIRE INS CO Policy Number WA269D004261012 Exp Date 08/01/2004

(This section need not be completed if the permit is for \$100 or less) I certify that in the performance of the work for which this permit is issued, I shall not employ any person in any manner so as to become subject to the workers' compensation laws of California and agree that if I should become subject to the workers' compensation provisions of Section 3700 of the Labor Code, I shall forthwith comply with those provisions.

Date 5/13/04 Applicant Signature KJ Hazlett

WARNING: FAILURE TO SECURE WORKER'S COMPENSATION COVERAGE IS UNLAWFUL AND SHALL SUBJECT AN EMPLOYER TO CRIMINAL PENALTIES AND CIVIL FINES UP TO ONE HUNDRED THOUSAND DOLLARS (\$100,000) IN ADDITION TO THE COST OF COMPENSATION, DAMAGES AS PROVIDED FOR IN SECTION 3706 OF THE LABOR CODE, INTEREST AND ATTORNEY'S FEE.

THIS PERMIT SHALL EXPIRE BY LIMITATION IF WORK IS NOT COMMENCED WITHIN 180 DAYS.

THIS PLOT PLAN IS NOT FOR SALES PURPOSES. THIS PLOT PLAN IS FOR THE PURPOSES OF INDICATING COMPLIANCE WITH ZONING SETBACKS, GENERAL DRAINAGE DIRECTION, AND APPROXIMATE UTILITY CONNECTION. ALL OTHER DATA SHOWN HEREON IS CONCEPTUAL. THIS PLOT PLAN DOES NOT REFLECT AS-BUILT CONDITIONS, RETAINING WALLS ARE OPTIONAL AND MAY OR MAY NOT BE CONSTRUCTED.

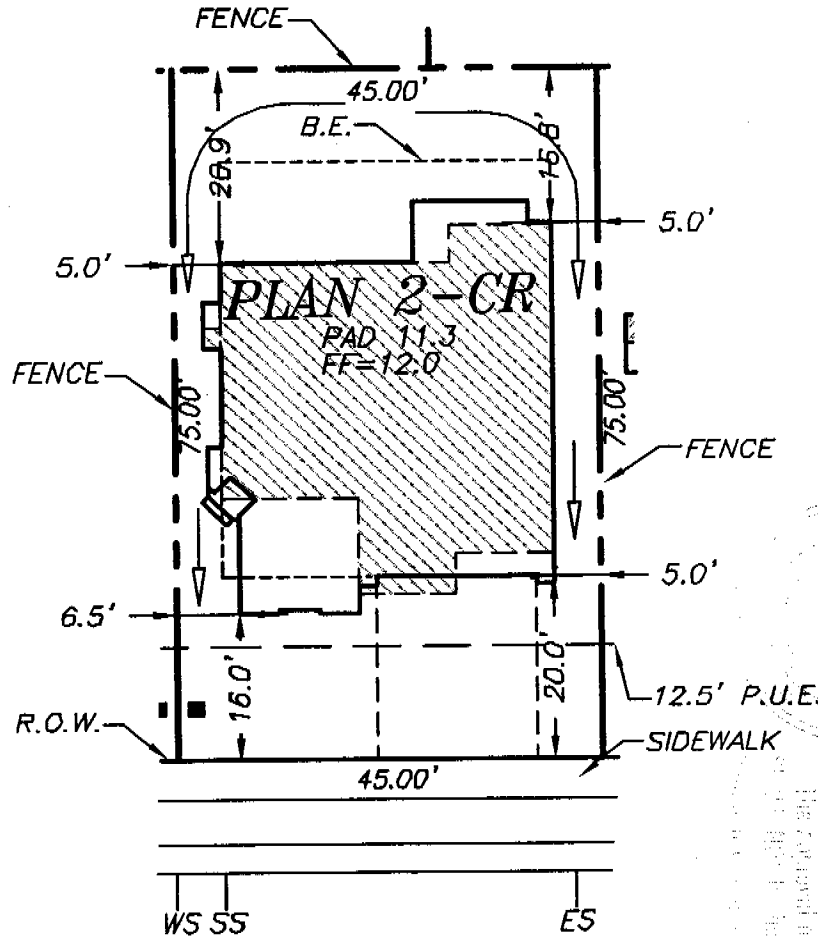

This set of plans and specifications must be kept on the job at all times and it is unlawful to make any changes or alterations from the same without written permission from the Building Inspector. The Council of the City of Sacramento, California, is hereby notified that the undersigned is the author of the above described plans and specifications and that he is a duly licensed Professional Engineer in the State of California, No. 100042, dated 04/07/04.

LEGEND

- ← DRAINAGE FLOW
- ☐ PHONE / CABLE PEDESTAL
- ▲ TRANSFORMER
- ☐ 2 JUNCTION BOX
- ES ELECTRIC SERVICE
- SS SEWER CONNECTION
- WS WATER SERVICE
- STREET LIGHT
- FIRE HYDRANT
- 10"X12" VAULT



PULTE HOME CORPORATION
PARK LANE
AT REGENCY PARK
 CITY OF SACRAMENTO, CALIFORNIA

PLOT PLAN

160 REGENCY PARK CR

LOT AREA 3375 SQ.FT.

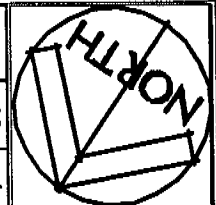

A.P.N.:

DATE: 4/7/04 SCALE: 1"=20' UNIT: VILLAGE "B" LOT NO.: 03 APPROVED:

LOTUS.dwg Apr 13, 2004 - 10:04am

OMEGA PRODUCTS INTERNATIONAL, INC.

DIAMOND WALL INSULATING STUCCO SYSTEM

JOB ADDRESS:

160 REGENCY PARK

ICBO Report #4004

Date of Job Completion 10/6

PLASTERING CONTRACTOR:

Name: STELAR ENTERPRISES

Address: 29054 GOETT RD

Telephone No: 909-244-0525

Contractor Number of Diamond Wall System _____

This is to certify that the exterior coating system on the building exterior at the above address has been installed in accordance with the evaluation report specified above and the manufacturer's instructions.

10/6
Date

JR
Signature of authorized representative of
Plastering Contractor

This installation card must be presented to the building inspector after completion of work and before final inspection.

INSULATION CERTIFICATE

160 REGENCY PARK CIR

SACRAMENTO, CA

Address of Property

County Job No.

County Bid Permit No.

PARK LANE

3,

SACRAMENTO

Development

Lot, Section

County

EXTERIOR WALLS

Type of Material BATTS

Manufacturer: Knauf

Thickness: 3.5"

R Value: R13

Type of Material BATTS

Manufacturer: Johns Manville

Thickness: 6.5"

R Value: R19

FLAT CEILING

Type of Material _____

Manufacturer: Greenfiber

Thickness: 10.3"

R Value: R38

1008.00 Sq. Ft. Covered

____ No. of Bags

____ Wt./Bag

FLAT CEILING NOT BLOWABLE

Type of Material _____

Manufacturer: Knauf

Thickness: 13"

R Value: R38

GARAGE CEILING UNDER LIVING

Type of Material BATTS

Manufacturer: Johns Manville

Thickness: 10"

R Value: R30

INTERIOR WALLS

Type of Material BATTS

Manufacturer: Knauf

Thickness: 3.5"

R Value: R11

SHEAR EXTERIOR WALL

Type of Material BATTS

Manufacturer: Knauf

Thickness: 3.5"

R Value: R13

Type of Material BATTS

Manufacturer: Knauf

Thickness: 3.5"

R Value: R13

Western Insulation - Sacramento

I CERTIFY UNDER THE PENALTY OF PERJURY UNDER THE LAWS OF THE STATE OF THAT THE FOREGOING IS TRUE AND CORRECT.

General Contractor (Builder) PULTE HOMES - PARK LANE

Contractors Reg. Number: _____

Licensed Architect/Engineer

By Beehy Luther

TITLE: Auth Agent

Date and Place

10-7-04

INSTALLATION CERTIFICATE

CF-6R

LOT _____ **PLAN #** _____ **PULTE PARK LANE**
Site Address _____ **Permit Number** _____

An installation certificate is required to be posted at the building site or made available for all appropriate inspections. (The information provided on this form is required; however, use of this form to provide the information is optional.) After completion of final inspection a copy must be provided to the building department (upon request) and the building owner at occupancy, per Section 10-103(b).

HVAC SYSTEMS:

Heating Equipment

Equip. Type (pkg. Heat pump)	CEC Certified Mfr name and Model #	# of Identical Systems	(1) Efficiency (AFUE, etc.) > CF-1R value	Duct Location (attic, etc.)	Duct or Piping R-value	Heating Load (Btu/hr)	Heating Capacity (Btu/hr)	
FURNACE	York P4HUB16L064	1	80%	ATTIC	6	33,067	64,000	Plan 1 (1685)
FURNACE	York P4HUB16L064	1	80%	ATTIC	6	31,882	64,000	Plan 2 (1871)
FURNACE	York P4HUB16L064	1	80%	ATTIC	6	32,161	64,000	Plan 3 (2108)

Cooling Equipment

Equip. Type (pkg. Heat pump)	CEC Certified Compressor Unit Mfr Name and Model #	# of Identical Systems	(1) Efficiency (SEER, etc.) > CF-1R Value	Duct Location (attic, etc.)	Duct R-value	Cooling Load (Btu/hr)	Cooling Capacity (Btu/hr)	
A/C	York H*RC042*	1	12.0	ATTIC	6	23,303	35,500	Plan 1 (1685)
A/C	York H*RC042*	1	12.0	ATTIC	6	23,343	35,500	Plan 2 (1871)
A/C	York H*RC048*	1	12.0	ATTIC	6	24,814	40,900	Plan 3 (2108)

* = TXV valve installed as part of coil

(1) > reads greater than or equal to.
 I, the undersigned, verify that equipment listed above is: 1) is the actual equipment installed, 2) equivalent to or more efficient than that specified in the certificate of compliance (Form CF-1R) submitted for compliance with the *Energy Efficiency Standards* for residential buildings, and 3) equipment that meets or exceeds the appropriate requirements for manufactured devices (from the *Appliance Efficiency Regulations* or Part 6), where applicable.

Jash Ojil 10/20/04
 Signature, Date

BEUTLER CORPORATION #####
 Installing Subcontractor (Co. Name)
 OR General Contractor (Co. Name) OR Owner

WATER HEATING SYSTEMS:

Heater Type	CEC Certified Mfr Name & Model #	Distribution Type (Std, point of use)	If Recirculation Control Type	# of Identical Systems	(2) Rated Input (kW or Btu/hr)	Tank Volume (gallons)	(2) Efficiency (EF,RE)	(2) Standby Loss (%)	External Insulation R-value

(2) For small gas storage (rated input of less than or equal to 75,000 Btu/hr), electric resistance and heat pump water heaters, list Energy Factor. For large gas storage water heaters (rated input of greater than 75,000 Btu/hr), list Recovery Efficiency, Standby Loss and Rated Input. For instantaneous gas water heaters, list Recovery efficiency and Rated Input.
 (3) R-12 external insulation is mandatory for storage water heaters with an energy factor of less than 0.58.

Facets & Shower Heads: