

CITY OF SACRAMENTO  
1231 I Street, Sacramento, CA 95814

Permit No: 0518076

Insp Area: 4

Thos Bros:

Sub-Type: NSFR

Housing (Y/N): N

Site Address: 650 CANDELA CR SAC  
Parcel No: WESTLAKE PARCEL 31 LOT 10

CONTRACTOR  
JOHN LAING HOMES  
1536 EUREKA RD STE 100  
ROSEVILLE CA. 95661

OWNER

ARCHITECT

Nature of Work: MP1541 2 STORY 5 RM SFR

**CONSTRUCTION LENDING AGENCY :** I hereby affirm under penalty of perjury that there is a construction lending agency for the performance of the work for which this permit is issued (Sec. 3097, Civ. C).

Lender's Name \_\_\_\_\_ Lender's Address \_\_\_\_\_

**LICENSED CONTRACTORS DECLARATION:** I hereby affirm under penalty of perjury that I am licensed under provisions of Chapter 9 (commencing with section 7000) of Division 3 of the Business and Professions Code and my license is in full force and effect.

License Class B License Number 687596 Date \_\_\_\_\_ Contractor Signature [Signature]

**OWNER-BUILDER DECLARATION:** I hereby affirm under penalty of perjury that I am exempt from the contractors License Law for the following reason (Sec. 7031.5, Business and Professions Code; any city or county which requires a permit to construct, alter, improve, demolish, or repair any structure, prior to its issuance, also requires the applicant for such permit to file a signed statement that he or she is licensed pursuant to the provisions of the Contractors License Law (Chapter 9 (commencing with Section 7000) of Division 8 of the Business and Professions Code) or that he or she is exempt therefrom and the basis for the alleged exemption. Any violation of Section 7031.5 by any applicant for a permit subjects the applicant to a civil penalty of not more than five hundred dollars (\$500.00);

\_\_\_\_\_, I, as a owner of the property, or my employees with wages as their sole compensation, will do the work, and the structure is not intended or offered for sale (Sec. 7044, Business and Professional Code: The Contractors License Law does not apply to an owner of property who builds or improves thereon, and who does such work himself or herself or through his/her own employees, provided that such improvements are not intended or offered for sale. If, however, the building or improvement is sold within one year of completion, the owner-builder will have the burden of proving that he/she did not build or improve for the purpose of sale.)

\_\_\_\_\_, I, as owner of the property, am exclusively contracting with licensed contractors to construct the project (Sec. 7044, Business and Professions Code: The Contractors License Law does not apply to an owner of property who builds or improves thereon, and who contracts for such projects with a contractor(s) licensed pursuant to the Contractors License Law).

\_\_\_\_\_, I am exempt under Sec. \_\_\_\_\_ B & PC for this reason: \_\_\_\_\_  
Date \_\_\_\_\_ Owner Signature \_\_\_\_\_

PAID  
CITY OF SACRAMENTO  
NOV 21 2005  
NEIGHBORHOOD PLANNING  
AND DEVELOPMENT SERVICES

**IN ISSUING THIS BUILDING PERMIT,** the applicant represents, and the city relies on the representation of the applicant that the applicant verified all measurements and locations shown on the application or accompanying drawings and that the improvements to be constructed does not violate any law or private agreement relating to permissible or prohibited locations for such improvements. This building permit does not authorize any illegal location of any improvement or the violation of any private agreement relating to location of improvements.

I certify that I have read this application and state that all information is correct. I agree to comply with all city and county ordinances and state laws relating to building construction and hereby authorize representative(s) of this city to enter upon the abovementioned property for inspection purposes.

Date 11-21-05 Applicant/Agent Signature [Signature]

**WORKER'S COMPENSATION DECLARATION:** I hereby affirm under penalty of perjury one of the following declarations:  
\_\_\_\_\_, I have and will maintain a certificate of consent to self-insure for workers' compensation as provided for by Section 3700 of the Labor Code, for the performance of work for which the permit is issued.

I have and will maintain workers' compensation insurance, as required by Section 3700 of the Labor Code, for the performance of the work for which this permit is issued. My workers' compensation insurance carrier and policy number are:

Carrier LUMBERMANS MUTUAL Policy Number 3BA16432400 Exp Date 04/15/2005

\_\_\_\_\_, (This section need not be completed if the permit is for \$100 or less) I certify that in the performance of the work for which this permit is issued, I shall not employ any person in any manner so as to become subject to the workers' compensation laws of California and agree that if I should become subject to the workers' compensation provisions of Section 3700 of the Labor Code, I shall forthwith comply with those provisions.

Date 11-21-05 Applicant Signature [Signature]

**WARNING: FAILURE TO SECURE WORKER'S COMPENSATION COVERAGE IS UNLAWFUL AND SHALL SUBJECT AN EMPLOYER TO CRIMINAL PENALTIES AND CIVIL FINES UP TO ONE HUNDRED THOUSAND DOLLARS (\$100,000) IN ADDITION TO THE COST OF COMPENSATION, DAMAGES AS PROVIDED FOR IN SECTION 3706 OF THE LABOR CODE, INTEREST AND ATTORNEY'S FEE.**

**THIS PERMIT SHALL EXPIRE BY LIMITATION IF WORK IS NOT COMMENCED WITHIN 180 DAYS.**

**INSTALLATION CERTIFICATE**

650 CANDELA CIR 0518076  
 Site Address Permit Number  
 John Laing Candela Plan I

**FENESTRATION/GLAZING:**

Manufacturer/Brand Name (GROUP LIKE PRODUCTS)	Product U-Value <sup>1</sup> (≤ CF-1R value) <sup>2</sup>	Product SHGC <sup>1</sup> (≤ CF-1R value) <sup>2</sup>	# of Pans	Total Quantity of Like Product (Optional)	Square Feet	Interior or Exterior Shading Device or Overhang	Comments/Location/Special Features
1. XO	.35	.33	2		64		
2. S/H	.35	.29	2		94		
3. P/W	.33	.36	2		54		
4. SGD	.34	.33	2		48		
5.							
6.							
7.							
8.							
9.							
10.							
11.							
12.							
13.							
14.							
15.							

<sup>1</sup> Manufactured fenestration products use the values from the product label. Field fabricated fenestration products use the default values from Section 116 of the Energy Efficiency Standards.  
<sup>2</sup> Installed U-value must be less than or equal to values from CF-1R. Installed SHGC must be less than or equal to values from CF-1R, or a shading device (interior, exterior or overhang) is installed as specified on the CF-1R. Alternatively, installed weighted average U-values for the total fenestration area are less than or equal to values from CF-1R.

I, the undersigned, verify that the fenestration/glazing listed above my signature: 1) is the actual fenestration product installed; 2) is equivalent to or has a lower U-Value and lower SHGC than that specified in the certificate of compliance (Form CF-1R) submitted for compliance with the Energy Efficiency Standards for residential buildings; and 3) the product meets or exceeds the appropriate requirements for manufactured devices (from Part 6), where applicable.

4 Item #s (if applicable)	<u>Kurt Ryden</u> Signature, Date 1/5/06	Ultra Glass Inc. Distributor Installing Subcontractor (Co. Name) OR General Contractor (Co. Name) OR Owner OR Window Distributor IWC windows + SGD
Item #s (if applicable)	Signature, Date	Installing Subcontractor (Co. Name) OR General Contractor (Co. Name) OR Owner OR Window Distributor
Item #s (if applicable)	Signature, Date	Installing Subcontractor (Co. Name) OR General Contractor (Co. Name) OR Owner OR Window Distributor

COPY TO: Building Department  
 HERS Provider (if applicable)  
 Building Owner at Occupancy

**INSTALLATION CERTIFICATE**

CF-6R

650 CANDELA CIR John Laing Homes - Candela  
Site Address

0518076  
Permit Number

An installation certificate is required to be posted at the building site or made available for all appropriate inspections. (The information provided on this form is required; however, use of this form to provide the information is optional.) After completion of final inspection a copy must be provided to the building department (upon request) and the building owner at occupancy, per Section 10-103(b).

**HVAC SYSTEMS:**

**Heating Equipment**

Equip. Type (pkg. Heat pump)	CEC Certified Mfr name and Model #	# of Identical Systems	(1) Efficiency (AFUE, etc.) > CF-1R value	Duct Location (attic, etc.)	Duct or Piping R-value	Heating Load (Btu/hr)	Heating Capacity (Btu/hr)	
Furnace	York LY8S080A12	1	0.80	Attic	R-4.2	30,469	60,000	Plan 1
Furnace	York LY8S080A12	1	0.80	Attic	R-4.2	30,895	60,000	Plan 2
Furnace	York LY8S080A12	1	0.80	Attic	R-4.2	33,122	60,000	Plan 3
Furnace	York LY8S080A12	1	0.80	Attic	R-4.2	33,192	60,000	Plan 4
Furnace	York LY8S080A12	1	0.80	Attic	R-4.2	36,390	60,000	Plan 5

**Cooling Equipment**

Equip. Type (pkg. Heat pump)	CEC Certified Compressor Unit Mfr Name and Model #	# of Identical Systems	(1) Efficiency (SEER, etc.) > CF-1R Value	Duct Location (attic, etc.)	Duct R-value	Cooling Load (Btu/hr)	Cooling Capacity (Btu/hr)	
Condenser	York H*RD024	1	13.0	Attic	R-4.2	17,265	40,700	Plan 1
Condenser	York H*RD024	1	13.0	Attic	R-4.2	17,709	41,100	Plan 2
Condenser	York H*RD024	1	13.0	Attic	R-4.2	19,630	34,900	Plan 3
Condenser	York H*RD024	1	13.0	Attic	R-4.2	18,914	26,800	Plan 4
Condenser	York H*RD030	1	13.0	Attic	R-4.2	22,153	34,800	Plan 5

**\*TXV - Indicates Thermal Expansion Valve On Coil**

(1) > reads greater than or equal to.

I, the undersigned, verify that equipment listed above is: 1) the actual equipment installed, 2) equivalent to or more efficient than that specified in the certificate of compliance (Form CF-1R) submitted for compliance with the *Energy Efficiency Standards* for residential buildings, and 3) equipment that meets or exceeds the appropriate requirements for manufactured devices (from the *Appliance Efficiency Regulations* or Part 6), where applicable.

Signature, Date

Beutler Corporation

OR General Contractor ( Co. Name) OR Owner

**WATER HEATING SYSTEMS:**

Heater Type	CEC Certified Mfr Name & Model #	Distribution Type (Std. point of use)	If Recirculation Control Type	# of Identical Systems	(2) Rated Input (kW or Btu/hr)	Tank Volume (gallons)	(2) Efficiency (EF,RE)	(2) Standby Loss (%)	External Insulation R-value
NG	STATE 651640yexF	STD		1	40,000	40	.62	3.20	16

(2) For small gas storage (rated input of less than or equal to 75,000 Btu/hr), electric resistance and heat pump water heaters, list Energy Factor. For large gas storage water heaters (rated input of greater than 75,000 Btu/hr), list Recovery Efficiency, Standby Loss and Rated Input. For instantaneous gas water heaters, list Recovery efficiency and Rated Input.

(3) R-12 external insulation is mandatory for storage water heaters with an energy factor of less than 0.58.

**Facets & Shower Heads:**

All facets and showerheads installed are certified to the Commission, pursuant to Title 24, Part 6, Section 111.

I, the undersigned, verify that equipment listed above my signature is: 1) the actual equipment installed; 2) equivalent to or more efficient than that specified in the certificate of compliance (Form CF-1R) submitted for compliance with the *Energy Efficiency Standards* for residential buildings; and 3) equipment that meets or exceeds the appropriate requirements for manufactured devices (from the *Appliance Efficiency Regulations* or Part 6), where applicable.

Signature, Date

DIMARTEL PLUMBING, INC.

Installing Subcontractor (Co. Name)

OR General Contractor ( Co. Name) OR Owner

COPY TO: Building Department  
HERS Provider (if applicable)  
Building Owner at Occupancy

### Insulation Certificate

This is to certify that insulation has been installed in conformance with the current energy regulations, California Administration code. Title 24, State of California, in the building located at:

Site Address: 650 (Lot10) Candela Circle Sacramento CA  
Number Street City State

#### Ceilings:

Blow: Manufacturer Greenfiber Thickness 8.36" R / Value R-30  
Square Feet 810 # Bags / Lbs. Per Bag 28

Batts: Manufacturer Johns Manville Thickness 10.25" R / Value R-30

Batts: Manufacturer Johns Manville Thickness N/A R / Value N/A

#### Exterior Walls:

Manufacturer Johns Manville Thickness 6.5" R / Value R-19

Manufacturer Johns Manville Thickness 3.5" R / Value R-13

#### Floor Insulation:

Manufacturer Johns Manville Thickness 6.5" R / Value R-19

Air Infiltration: (Title 24)

Yes  No

Other: \_\_\_\_\_  
\_\_\_\_\_  
\_\_\_\_\_

General Contractor: John Laing Homes Lic. # \_\_\_\_\_

By: \_\_\_\_\_ Title: \_\_\_\_\_ Date: \_\_\_\_\_

Insulation Contractor: Gold Star Insulation, Inc. Lic. # 797510

By: Patrice May Title: Admin Assistant Date: 3/23/06



CERTIFICATE OF FIELD VERIFICATION AND DIAGNOSTIC TESTING (Part 1)

CF-4R

Project Title: Candela Phl Job# 45020015 Lot# 10 Date: 4/11/06  
 Project Address: 650 Candela Cir. Sacramento, Ca. 95835 Builder Name: WL Homes  
 Builder Contact: Jeremie Russell Telephone: \_\_\_\_\_ Plan Number: 1 (154)  
 HERS Rater: Jeremie Russell Telephone: \_\_\_\_\_ Sample Group Number: \_\_\_\_\_  
 Certifying Signature: [Signature] Date: \_\_\_\_\_ Sample House Number: \_\_\_\_\_  
 Firm: ACS HERS Provider: \_\_\_\_\_  
 Street Address: 9524 MOSQUITO rd. City/State/Zip: Placerville, Ca 95667  
 Copies to: Builder, HERS Provider

**HERS RATER COMPLIANCE STATEMENT**

This house was:  Tested  Approved as part of sample testing, but was not tested

As the HERS rater providing diagnostic testing and field verification, I certify that the houses identified on this form comply with the diagnostic tested compliance requirements as checked on this form.

- Distribution system is fully ducted (i.e., does not use building cavities as plenums or platform returns in lieu of ducts)
- Where cloth backed, rubber adhesive duct tape is installed, mastic and drawbands are used in combination with cloth backed, rubber adhesive duct tape to seal leaks as duct connections.

**MINIMUM REQUIREMENTS FOR DUCT LEAKAGE REDUCTION COMPLIANCE CREDIT**

**Duct Diagnostic Leakage Testing Results (Maximum 6% Duct Leakage)**

Duct Pressurization Test Results (CFM @ 25 Pa)

Measured values

If Fan Flow is Calculated at 400 cfm/ton x number of tons enter calculated value here 998 fcu

Test Leakage in CFM) 60 CFM

If fan flow is measured enter measured value here \_\_\_\_\_

Leakage Percentage (100 x Test Leakage/Fan Flow) = 6%  
Check Box for Pass or Fail (Pass = 6% or less)

**THERMOSTATIC EXPANSION VALVE (TXV)** or Commission approved equivalent

Pass  Fail

Yes  No Thermostatic Expansion Valve (or Commission approved equivalent) is installed and Access is provided for inspection  
Yes is a pass

Pass  Fail

**MINIMUM REQUIREMENTS FOR DUCT DESIGN COMPLIANCE CREDIT**

1.  Yes  No ACCA Manual D Design requirements have been met (rater has verified that actual installation matches values in CF-1R and design on plan.)

2.  Yes  No TXV is installed or Fan flow has been verified. If no TXV, verified fan flow matches design from CF-1R.  
Measured Fan Flow = \_\_\_\_\_

Pass  Fail

Yes for both 1 and 2 is a Pass

THIS PLOT PLAN IS NOT FOR SALES PURPOSES. THIS PLOT PLAN IS FOR THE PURPOSES OF INDICATING COMPLIANCE WITH ZONING SET BACKS, GENERAL DRAINAGE DIRECTION, AND APPROXIMATE UTILITY CONNECTION. ALL OTHER DATA SHOWN HEREON IS CONCEPTUAL. THIS PLOT PLAN DOES NOT REFLECT AS-BUILT CONDITION, RETAINING WALL ARE OPTIONAL AND MAY OR MAY NOT BE CONSTRUCTED.

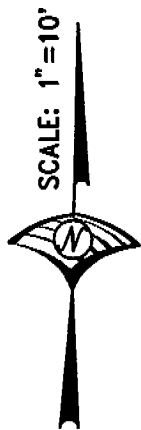

EX WESTBOROUGH VILLAGE 1

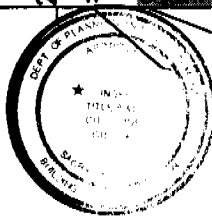
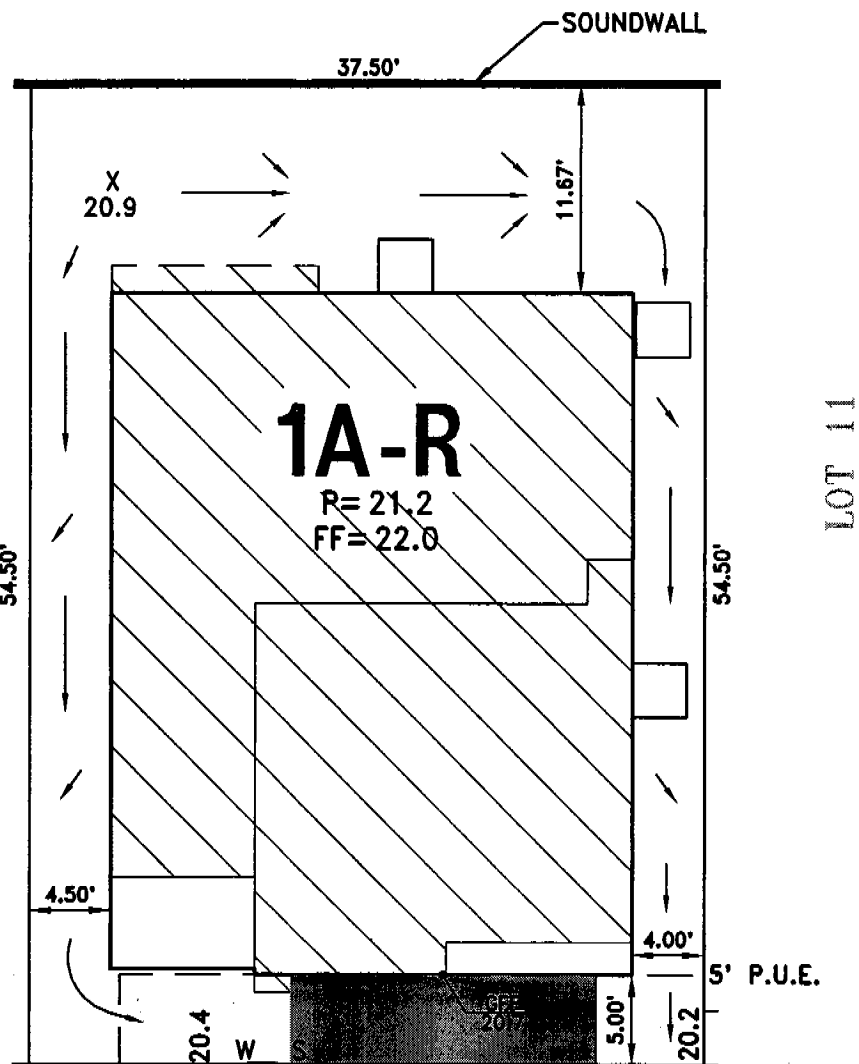

Set of plans and specifications must be kept on the job at all times and it is unlawful to make any changes or alterations from the same without written permission from the Building Inspection Division. The approval of this plan and specification SHALL NOT be held to permit or approve the violation of any City Ordinance or State Law.

LEGEND

- STREET LIGHT
- ▲ TRANSFORMER
- U UTILITY BOX
- SL STREET LIGHT SERVICE BOX
- ≠ STREET SIGN
- FIRE HYDRANT
- DRAINAGE INLET
- BLOWOFF VALVE

A.P.N.: \_\_\_\_\_  
 LOT AREA: 2044 S.F.  
 ADDRESS: 650 CANDELA CIRCLE

<b>PLOT PLAN</b> <b>LOT 10</b> WESTLAKE PARCEL 31 FOR JOHN LAING HOMES CITY OF SACRAMENTO CALIFORNIA			
<b>WOOD RODGERS</b> engineering • planning • mapping • surveying 1012 11th St, Suite 300, Modesto, CA 95354 Tel 209.549.7060 Fax 209.549.7064			
DATE: OCTOBER 2005	DRAWN: JD	CHECKED: JR	PROJECT NO: 1122.059