

CITY OF SACRAMENTO

1231 I Street, Sacramento, CA 95814

Permit No: 0606400

Insp Area: 1

Thos Bros: 298A5

Site Address: 5800 H ST SAC

Parcel No: 005-0241-010

RIVER PARK COMM.

Sub-Type: FREESTD

CONTRACTOR  
CADENCE CONSTR.  
5308 CALLISTER AV  
SAC CA

OWNER  
COUNTY OF SACRAMENTO  
7311 GREENHAVEN DR STE  
SACRAMENTO CA 95831

TENANT

Nature of Work: CONSTRUCT MONUMENT SIGN FOR "RIVER PARK COMMUNITY"

CONSTRUCTION LENDING AGENCY : I hereby affirm under penalty of perjury that there is a construction lending agency for the performance of the work for which this permit is issued (Sec. 3097, Civ. C).

Lender's Name \_\_\_\_\_ Lender's Address \_\_\_\_\_

LICENSED CONTRACTORS DECLARATION: I hereby affirm under penalty of perjury that I am licensed under provisions of Chapter 9 (commencing with section 7000) of Division 3 of the Business and Professions Code and my license is in full force and effect.

License Class B License Number 460077 Date 5/15/06 Contractor Signature [Signature]

OWNER-BUILDER DECLARATION: I hereby affirm under penalty of perjury that I am exempt from the contractors License Law for the following reason (Sec. 7031.5, Business and Professions Code; any city or county which requires a permit to construct, alter, improve, demolish, or repair any structure, prior to its issuance, also requires the applicant for such permit to file a signed statement that he or she is licensed pursuant to the provisions of the Contractors License Law (Chapter 9 (commencing with Section 7000) of Division 8 of the Business and Professions Code) or that he or she is exempt therefrom and the basis for the alleged exemption. Any violation of Section 7031.5 by any applicant for a permit subjects the applicant to a civil penalty of not more than five hundred dollars (\$500.00);

I, as a owner of the property, or my employees with wages as their sole compensation, will do the work, and the structure is not intended or offered for sale (Sec. 7044, Business and Professional Code: The Contractors License Law does not apply to an owner of property who builds or improves thereon, and who does such work himself or herself or through his/her own employees, provided that such improvements are not intended or offered for sale. If, however, the building or improvement is sold within one year of completion, the owner-builder will have the burden of proving that he/she did not build or improve for the purpose of sale.)

I, as owner of the property, am exclusively contracting with licensed contractors to construct the project (Sec. 7044, Business and Professions Code: The Contractors License Law does not apply to an owner of property who builds or improves thereon, and who contracts for such projects with a contractor(s) licensed pursuant to the Contractors License Law).

I am exempt under Sec. \_\_\_\_\_ B & PC for this reason: \_\_\_\_\_  
Date \_\_\_\_\_ Owner Signature \_\_\_\_\_

PAID  
CITY OF SACRAMENTO  
MAY 16 2006  
PLANNING  
DEVELOPMENT

IN ISSUING THIS BUILDING PERMIT, the applicant represents, and the city relies on the representation of the applicant, that the applicant verified all measurements and locations shown on the application or accompanying drawings and that the improvements to be constructed does not violate any law or private agreement relating to permissible or prohibited locations for such improvements. This building permit does not authorize any illegal location of any improvement or the violation of any private agreement relating to location of improvements.

I certify that I have read this application and state that all information is correct. I agree to comply with all city and county ordinances and state laws relating to building construction and hereby authorize representative(s) of this city to enter upon the abovementioned property for inspection purposes.

Date 5/16/06 Applicant/Agent Signature [Signature]

WORKER'S COMPENSATION DECLARATION: I hereby affirm under penalty of perjury one of the following declarations:

I have and will maintain a certificate of consent to self-insure for workers' compensation as provided for by Section 3700 of the Labor Code, for the performance of work for which the permit is issued.

I have and will maintain workers' compensation insurance, as required by Section 3700 of the Labor Code, for the performance of the work for which this permit is issued. My workers' compensation insurance carrier and policy number are:

Carrier \_\_\_\_\_ Policy Number \_\_\_\_\_ Exp Date \_\_\_\_\_

(This section need not be completed if the permit is for \$100 or less) I certify that in the performance of the work for which this permit is issued, I shall not employ any person in any manner so as to become subject to the workers' compensation laws of California and agree that if I should become subject to the workers' compensation provisions of Section 3700 of the Labor Code, I shall forthwith comply with those provisions.

Date 5/15/06 Applicant Signature [Signature]

WARNING: FAILURE TO SECURE WORKER'S COMPENSATION COVERAGE IS UNLAWFUL AND SHALL SUBJECT AN EMPLOYER TO CRIMINAL PENALTIES AND CIVIL FINES UP TO ONE HUNDRED THOUSAND DOLLARS (\$100,000) IN ADDITION TO THE COST OF COMPENSATION, DAMAGES AS PROVIDED FOR IN SECTION 3706 OF THE LABOR CODE, INTEREST AND ATTORNEY'S FEE.

THIS PERMIT SHALL EXPIRE BY LIMITATION IF WORK IS NOT COMMENCED WITHIN 180 DAYS.

# Sign Permit Application

101 Arena Blvd. Ste.200 Sacramento CA 95834  
 231 I St. Ste.200 Sacramento CA 95814  
 (916) 808-5656  
 Required Information

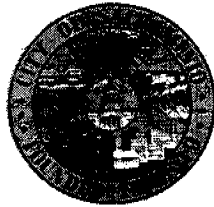

# Inspection Line

(916) 808-7622 or 808-5716

Sign Permit # 0606400 Area 1-CS

Sign Address

5800 H STREET

PN # 005-0241-010-0000 Zone WCACOA DR-PB / PUD / SC: P / ZA File:

Sign Applicant

Property Owner \ License Contractor: CITY OF SACRAMENTO / JEFF HARRIS  
RIVER PARK NEIGHBORHOOD ASSOCIATION  
 Address: P.O. BOX 19866, SACRAMENTO, CA 95819 Phone: 916-455-0996  
 Contractor License # 460077 Class B

Sign Information Attached Detached  
 Bldg. Tenant Frontage N/A lineal. foot Parcel Street Frontage N/A lineal. foot

| Sign I.D. Tag  | *Ht. x Wth.     | = Sign Area                | Sign Copy                   |
|----------------|-----------------|----------------------------|-----------------------------|
| <u>S060262</u> | <u>6' x 12'</u> | <u>72 FOOT<sup>2</sup></u> | <u>RIVER PARK COMMUNITY</u> |
| <u>S</u>       |                 |                            |                             |
| <u>S</u>       |                 |                            |                             |
| <u>S</u>       |                 |                            |                             |

Required Plan Review Approvals Structural Electrical Design Review

| Code       | Final Sign Inspection     | Approved  | Date           |
|------------|---------------------------|-----------|----------------|
| <u>99</u>  | <u>FOOTING</u>            | <u>JH</u> | <u>8-15-06</u> |
| <u>99</u>  | <u>BUILDING</u>           |           |                |
| <u>98</u>  | <u>ELECTRICAL</u>         |           |                |
| <u>n/a</u> | <u>SPECIAL INSPECTION</u> |           |                |

THIS SIGN PERMIT SHALL EXPIRE BY LIMITATION IF WORK AUTHORIZED IS NOT COMMENCED WITHIN 180 DAYS

PAID  
 CITY OF SACRAMENTO  
 MAY 15 2006  
 NEIGHBORHOODS PLANNING  
 AND DEVELOPMENT SERVICES

| Fees  |                      | \$100.00 per application. |               |
|---|----------------------|---------------------------|---------------|
| Total Sign Permit Fees : see Development Fee Schedule |                      |                           |               |
| Cashier   | Description          | Date                      | Amount        |
| <u>EPH</u>  | Sign Application Fee | <u>5/8/06</u>             | <u>100.-</u>  |
|   | Other                |                           |               |
|   | Balance              |                           | <u>61.79</u>  |
| <b>Total</b>  | Sign Permit Fee      |                           | <u>161.79</u> |

Manda Oller 5/12/06 Approved Sign Permit

**WEIDNER**  
ARCHITECTURAL  
SIGNAGE

4517 Franklin Blvd  
Sacramento CA 95820  
916.452.8000  
Fax 916.452.3331  
CA Lic. #59909D  
NY Lic. #0040109

Project: RIVER PARK ENTRY MONUMENT  
Company: RIVER PARK NEIGHBORHOOD ASSOCIATION  
Work Order: 20142  
Drawn By: WAS  
Checked By/Date: [ ]  
Date: 12-21-05  
Project Name: 01-27-08 REV WAS

Sign Type Description: CONCEPT OPTION 1

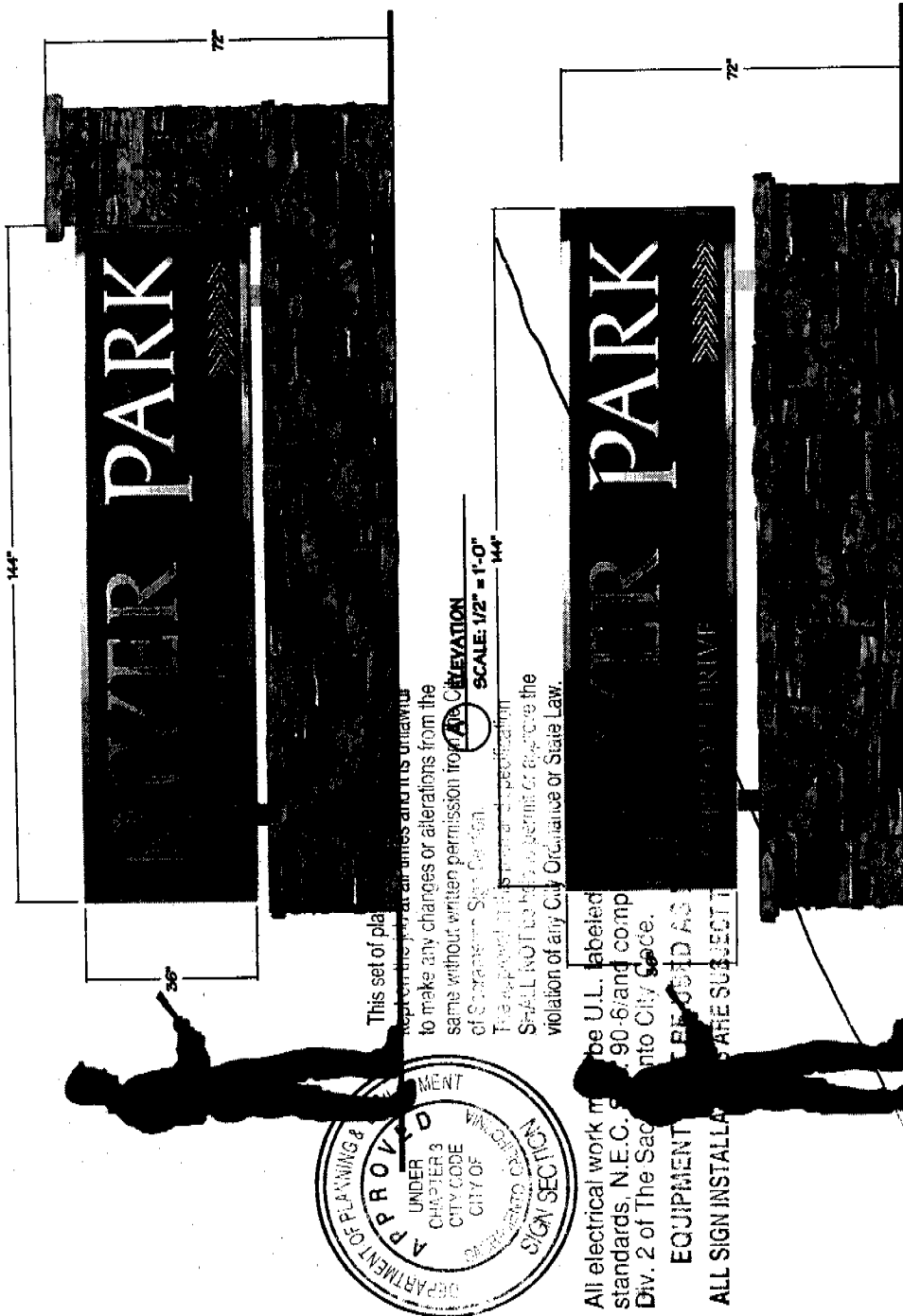

This set of plans is to be used for construction and its installation to make any changes or alterations from the same without written permission from the City of Sacramento Sign Division. The approval of this sign and its installation shall not be construed as a permit or license, the violation of any City Ordinance or State Law.

All electrical work must be U.L. labeled and meet all applicable standards, N.E.C. and into City Code. Div. 2 of The Sacramento Code. ALL SIGN INSTALLATION SHALL BE SUBJECT TO THE CITY OF SACRAMENTO SIGN DIVISION.

**A** ELEVATION  
SCALE: 1/2" = 1'-0"

|  |  |                                    |                              |
|--|--|------------------------------------|------------------------------|
| <p>(1) DOUBLE SIDED MONUMENT SIGN RETROFIT (REUSE) EXISTING SIGN PANEL</p> | <p>MATCH STONE TO VILLAGES @ GALLERIA*</p> | <p>(REUSE EXISTING SIGN PANEL)</p> | <p>Sign Type Code: MID-M</p> |
| <p>NATURAL ROCK BASE ALUMINUM CHANNEL SUPPORT</p>                          | <p>TBD</p>                                 | <p>Sheet No. 01</p>                | <p>CONCEPT OPTION 1</p>      |

**CITY COPY**

ATTN: Monte Gillan  
 From: Jeff Harris  
 Cadence Const. Co.  
 cell 806-3347  
 cadence@surewest.net

AP #

RIVER PARK SIGN PROTECT

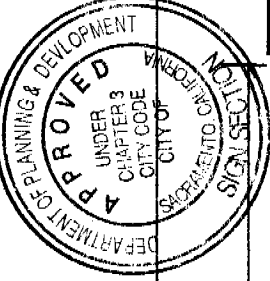

This set of plans and specifications must be kept on the job at all times and it is unlawful to make any changes or alterations from the same without written permission from the City of Sacramento, Sign Section.  
 The approval of this plan and specification SHALL NOT be held to permit or approve the violation of any City Ordinance or State Law.

Overall Length 168"

144"

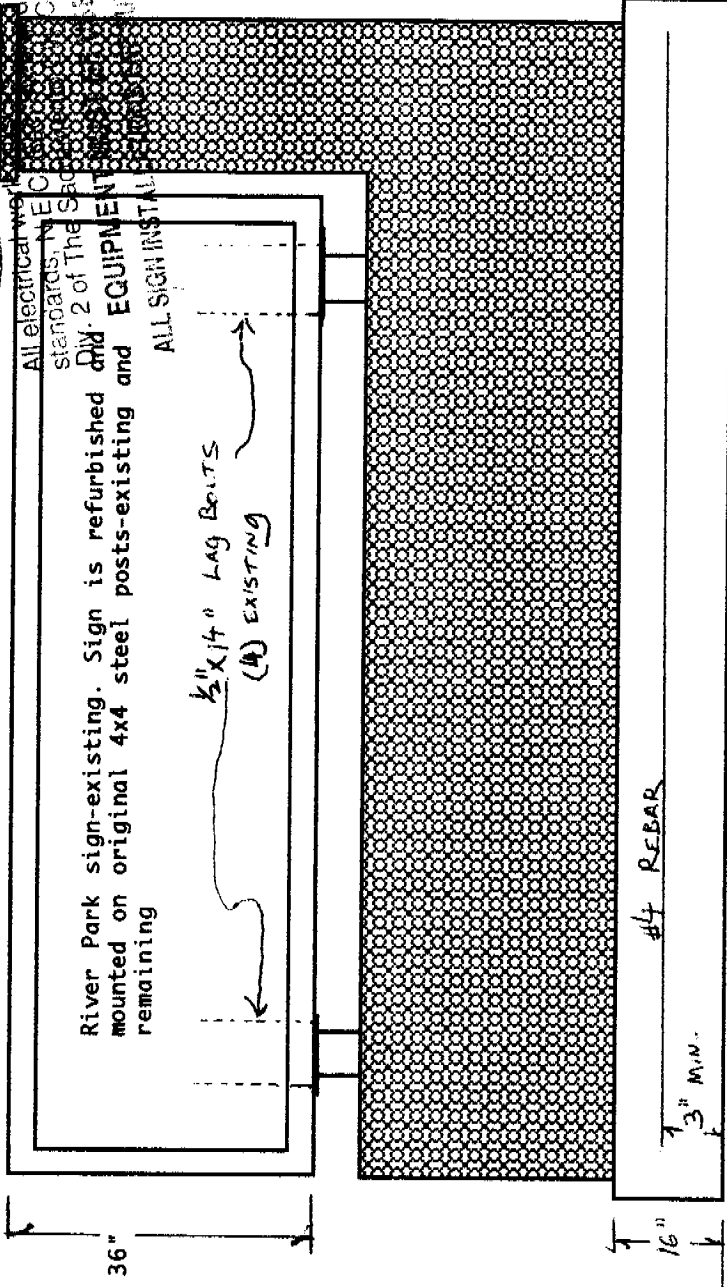

Plan View

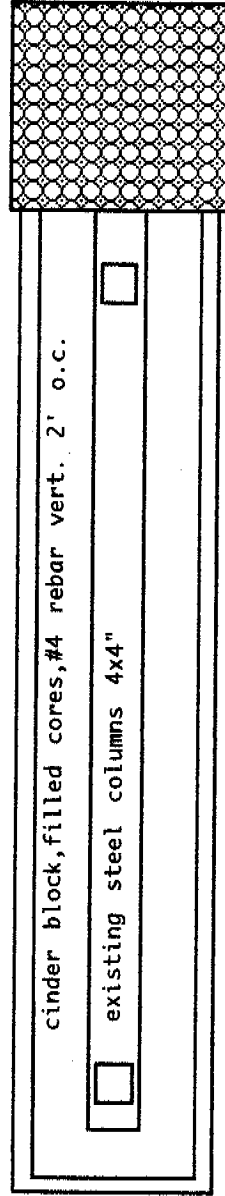

Column 22x22"

All electricals shall comply with chapter 14, standards of the City of Sacramento.  
 DIV. 2 of The Sign Code  
 ALL SIGN INSTALL

Column Height 78"  
 Column and sign base- stone veneer over cinderblock

CITY OF SACRAMENTO  
 NORTH PERMIT  
 CENTER

MAY 08 2006

RECEIVED

New footing 16" deep  
 24" wide x 14'9" long  
 2-#4 rebar along length of footing

River Park Sign  
cont'd

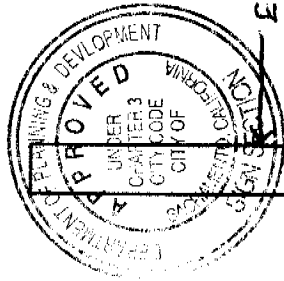

This set of plans and specifications must be kept on the job at all times and it is unlawful to make any changes or alterations from the same without written permission from the City of Sacramento Sign Section. The approval of this plan and specification SHALL NOT be held to approve the violation of any City Ordinance or State Law.

ALL OF SACRAMENTO  
NORTH PERMIT  
CENTER

All electrical work must be U.L. labeled or be of equivalent standards, N.E.C. Sec. 90-6 and comply with chapter 14, Div. 2 of The Sacramento City Code.

EQUIPMENT MUST BE USED AS DESIGN INTENDED MAY 03 2006

EXISTING 4x4x4"  
STEEL POSTS SET IN  
CONCRETE

ALL SIGN INSTALLATIONS ARE SUBJECT TO INSPECTIONS

RECEIVED

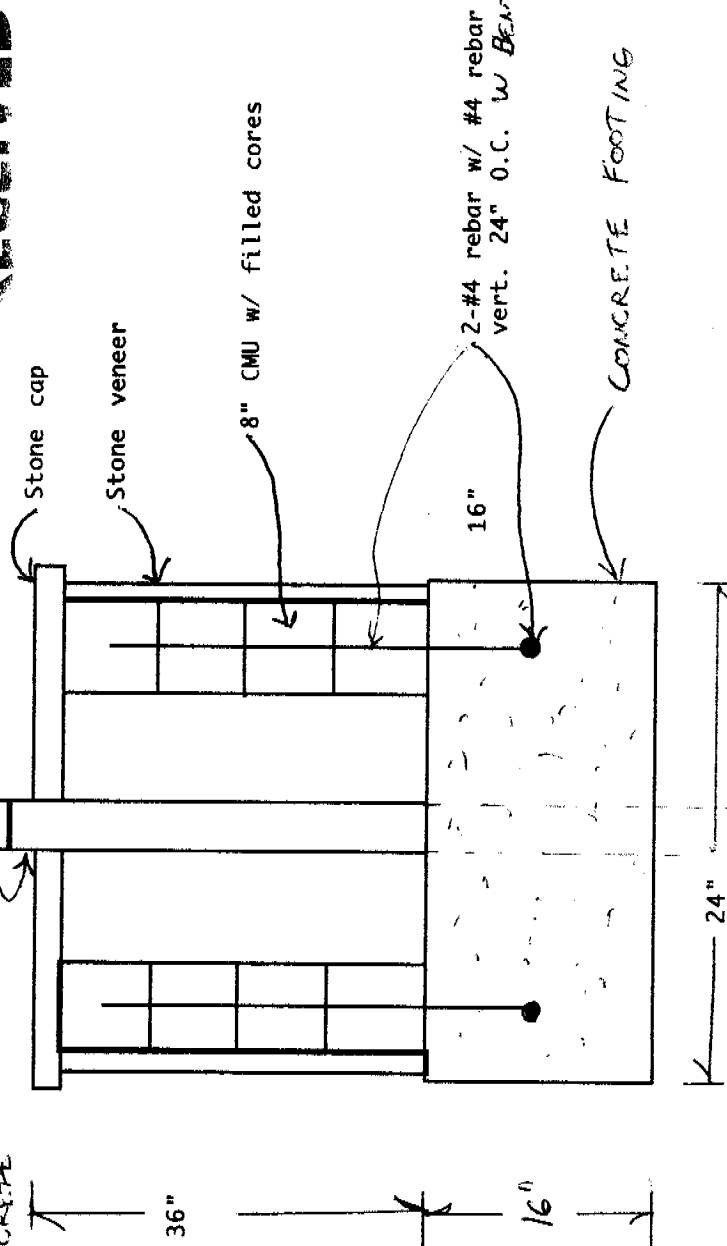

2-#4 rebar w/ #4 rebar  
vert. 24" O.C. w BENT HOOKS

CONCRETE FOOTING

36"

16"

24"

16"