

CITY OF SACRAMENTO
1231 I Street, Sacramento, CA 95814

Permit No: 0108696
Insp Area: 4

Site Address: 4756 SAVOIE WY SAC
Parcel No: 225-1570-013 WESTBR 1-1 LOT 52

Sub-Type: NSFR
Housing (Y/N): N

CONTRACTOR
WOODSIDE HOMES OF N. CALIF.
15 AUTO PLAZA DR #102
FOLSOM CA. 95630

OWNER

ARCHITECT

Nature of Work: MP 1800 1 STORY 6 ROOM SFR

CONSTRUCTION LENDING AGENCY: I hereby affirm under penalty of perjury that there is a construction lending agency for the performance of the work for which this permit is issued (Sec. 3097, Civ. C).

Lender's Name _____ Lender's Address _____

LICENSED CONTRACTORS DECLARATION: I hereby affirm under penalty of perjury that I am licensed under provisions of Chapter 9 (commencing with section 7000) of Division 8 of the Business and Professions Code and my license is in full force and effect.

License Class 2 License Number 744379 Date 7/12/01 Contractor Signature Kerr Mahetta

OWNER-BUILDER DECLARATION: I hereby affirm under penalty of perjury that I am exempt from the contractors License Law for the following reason (Sec. 7031.5, Business and Professions Code, any city or county which requires a permit to construct, alter, improve, demolish, or repair any structure, prior to its issuance, also requires the applicant for such permit to file a signed statement that he or she is licensed pursuant to the provisions of the Contractors License Law (Chapter 9 (commencing with Section 7000) of Division 8 of the Business and Professions Code) or that he or she is exempt therefrom and the basis for the alleged exemption. Any violation of Section 7031.5 by any applicant for a permit subjects the applicant to a civil penalty of not more than five hundred dollars (\$500.00):

I, as a owner of the property, or my employees with wages as their sole compensation, will do the work, and the structure is not intended or offered for sale (Sec. 7044, Business and Professional Code). The Contractors License Law does not apply to an owner of property who builds or improves thereon, and who does such work himself or herself or through his/her own employees, provided that such improvements are not intended or offered for sale. If, however, the building or improvement is sold within one year of completion, the owner-builder will have the burden of proving that he/she is not build or improve for the purpose of sale.)

I, as owner of the property, am exclusively contracting with licensed contractors to construct the project (Sec. 7044, Business and Professions Code). The Contractors License Law does not apply to an owner of property who builds or improves thereon, and who contracts for such projects with a contractor(s) licensed pursuant to the Contractors License Law.

I am exempt under Sec. _____ B & PC for this reason 111 1 - 2001
Date _____ Owner Signature _____

IN ISSUING THIS BUILDING PERMIT, the applicant represents, and the city relies on the representation of the applicant, that the applicant verified all measurements and locations shown on the application or accompanying drawings and that the improvement to be constructed does not violate any law or private agreement relating to permissible or prohibited locations for such improvements. This building permit does not authorize any illegal location of any improvement or the violation of any private agreement relating to location of improvements.

I certify that I have read this application and state that all information is correct. I agree to comply with all city and county ordinances and state laws relating to building construction and hereby authorize representative(s) of this city to enter upon the abovementioned property for inspection purposes.

Date 7/12/01 Applicant Agent Signature Kerr Mahetta

WORKER'S COMPENSATION DECLARATION: I hereby affirm under penalty of perjury one of the following declarations:

I have and will maintain a certificate of consent to self-insure for workers' compensation as provided for by Section 3700 of the Labor Code, for the performance of work for which the permit is issued.

I have and will maintain workers' compensation insurance, as required by Section 3700 of the Labor Code, for the performance of the work for which this permit is issued. My workers' compensation insurance carrier and policy number are:

Carrier INSURANCE CO OF THE WEST Policy Number WSL170169001 Exp Date 12/12/2001

(This section need not be completed if the permit is for \$100 or less) I certify that in the performance of the work for which this permit is issued, I shall not employ any person in any manner so as to become subject to the workers' compensation laws of California and agree that if I should become subject to the workers' compensation provisions of Section 3700 of the Labor Code, I shall forthwith comply with those provisions.

Date 7/12/01 Applicant Signature Kerr Mahetta

WARNING: FAILURE TO SECURE WORKER'S COMPENSATION COVERAGE IS UNLAWFUL AND SHALL SUBJECT AN EMPLOYER TO CRIMINAL PENALTIES AND CIVIL FINES UP TO ONE HUNDRED THOUSAND DOLLARS (\$100,000) IN ADDITION TO THE COST OF COMPENSATION, DAMAGES AS PROVIDED FOR IN SECTION 3706 OF THE LABOR CODE, INTEREST AND ATTORNEY'S FEE.

THIS PERMIT SHALL EXPIRE BY LIMITATION IF WORK IS NOT COMMENCED WITHIN 180 DAYS.

COUNTY SANITATION DISTRICT NO. 1
 SACRAMENTO REGIONAL COUNTY SANITATION DISTRICT
SEWER IMPACT FEE *Phyllis*
 PERMIT AND CALCULATION SHEET *7/16/01*

APPLICATION NO: ****CITY**** BLDG PERMIT NO: _____
 GENERAL INFORMATION THIS PERMIT GOOD ONLY WHEN
 VALIDATED BY THE CASHIER

paid thru *# 273461*
SWD 2001-00534 *7/16/01*
 THIS PERMIT TO CONNECT EXPIRES
 ONE YEAR FROM DATE OF ISSUANCE

FEE CALCULATION		BUILDING USE	
INSPECTION		RESIDENTIAL	SF <input checked="" type="checkbox"/> MF <input type="checkbox"/>
CSD-1	600 <i>78</i>	COMMERCIAL USE	UNITS
SRCSO	3,500 <i>78</i>		
CONSTRUCTION			
IN-LIEU			
TOTAL FEE	4,100 <i>78</i>		

APN: **225-1570-013**
 DESCRIPTION/ SUBDIVISION: **Westborough-Village 1, Ph 1 LOT: 52**
 PROPERTY ADDRESS: **4756 Savole Way**
 OWNER: **Woodside Westlake, Inc.**
 MAILING ADDRESS: **15 Plaza Drive #102 Rolsom, CA 95630**
 CITY-STATE-ZIP: **Rolsom, CA 95630** PHONE: **608-9600**
 ADDITIONAL FEES MAY BE DUE IF CHANGES IN USE INCREASE SEWER IMPACT.
 APPLICANT SIGNATURE: *Krista M. ...*
 CONSOLIDATED UTILITY BILLING USE ONLY
 ACCT _____ INPUT _____ START _____

Natomas Unified School District

1515 Sports Drive, #1 • Sacramento, CA 95834-1905
 Phone 916/641-3300 • Fax 916/928-1629

CERTIFICATION OF COMPLIANCE

SCHOOL DISTRICT DEVELOPMENT FEES

PART I: TO BE COMPLETED BY APPLICANT			
Property Owner's Name	Woodside Westlake, Inc.		
Owner's Address	15 Plaza Drive #102 Folsom, CA 95630		
Project Address	4756 Savoie Way		
Parcel Number	225-1570-013		
Subdivision Name	Westborough Village I, Ph 1		
Number of Units	1		
Print Applicant's Name	Woodside Homes of CA, Inc.	Applicant's Signature	
Title of Applicant	Construction Admin.	Telephone Number	(916) 608-9600
Date	6/18/01		
PART II: TO BE COMPLETED BY BUILDING DEPARTMENT			
Plan Identification Number	01086442		
Building Type (Check One)	<input checked="" type="checkbox"/> Residential <input type="checkbox"/> Apartment/Condominium <input type="checkbox"/> Commercial/Industrial		
Square Feet of Chargeable Building Area	1300		
Signature			
Title	Bldg Insp	Date	7/16/01
PART III: TO BE COMPLETED BY NATOMAS UNIFIED SCHOOL DISTRICT			
District Certification Number	02-115		
Fees Collected:			
Residential:	1300	Sq. Ft. X \$ 3.35	= \$ 6030
Apartment/Condominium:		Sq. Ft. X \$	= \$
Commercial/Industrial:		Sq. Ft. X \$	= \$
<p>NOTICE TO APPLICANT: Pursuant to government code section 66020 (d), this will serve to notify you that the 90-day approval period in which you may protest the fees, or other payment identified above, will begin to run on the date in which the building or installation permit for this project is issued, or on which they are paid to the District, or to another public entity authorized to collect them on behalf of the District, whichever is earlier.</p>			
Applicant Signature:		Date:	7/16/01

This certification covers only the amount of square footage indicated above. Any additions or corrections to the square footage for this project will require an amendment to the Certificate of Compliance.

As the authorize Natomas Unified School District official, I hereby certify that the requirements of Government Code Section 95995 have been complied with by the above signed applicant.

SIGNATURE: **DATE:** 7/16/01

TITLE: _____

LOT
52
4756
SAVOIE



UOI 10 2001
809 North Market Blvd., Ste. 11 • Sacramento, CA 95834
(916) 927-7149 • Fax (916) 927-4257
Lic. #487478

MesPac

insulation
a MASCO Company



Installed Insulation Certificate

We certify that the building insulation listed herein is installed in conformance with current energy conservation regulations, California Administrative Code, Title 24, State of California

R FACTOR	AREA	TYPE	INCHES/BAGS (BLOWN)
R30	CEILING AREA	FIBERGLASS BATT	17" / 33 BAGS
R30	CELLING AREA	FIBERGLASS BATT	19.25"
R13	EXT. WALL AREA	FIBERGLASS BATT	3.5"

Certified by 

Title Secretary

WOODSIDE HOMES WESTLAK
ADDRESS OF HOMES/52
10/94/01
Phase B

Date Installed

KwikKote

No. 200-004170

Stucco System Installation Card

Job Name: WESTLAKE
Address: 4756 SAVOIE WAY
SACRAMENTO,
Lot #: 0000052

Stucco System Trade Name: KWIK KOTE
Stucco System Manufacturer: KWIK KOTE CORP.

ICBO Evaluation Service, Inc.
Report No. 3607
Date of Job Completion: October 09, 2001

Home Builder: WOODSIDE HOMES
Address: 15 PLAZA DR. #102
FOLSOM, CA

Stucco Contractor: KENYON PLASTERING, INC.
Address: PO BOX 2077
North Highlands, CA

Telephone Number: 916/349-8191

Approved Contractor Number as
issued by the Stucco Manufacturer: 1001

Card Print Date: 11/27/2001

This is to certify that the stucco system on the building exterior at the above address had been installed in accordance with the evaluation report specified above and the manufacturer's instructions.

Signature of authorized representative of stucco contractor

11-27-01
Date

RESIDENTIAL SUBDIVISION BUILDING PERMIT APPLICATION

84

Project Address: 4756 Savoie Way Assessor Parcel # 225-1570-013
 Lot Number: 52 Subdivision Westborough Village 1, Ph 1

OWNER INFORMATION:

Legal Property Owner: Woodside Westlake, Inc. Phone# (916) 608-9600
 Owner Address: 15 Plaza Dr. #102 City Folsom State CA Zip 95630

CONTRACTOR INFORMATION:

Contractor: Woodside Homes of CA, Inc. # 744379-B Phone# 608-9600 Fax 608-9940

PROJECT INFORMATION:

Land Use Zone RIA Occupancy Group R3 Construction Type VN Fed Code 1A
 No. of Stories: 1 No. of Rooms: _____ Street Width: _____
 1st Floor Area 1800 2nd Floor Area _____ Basement N/A Roof Material Concrete Tile
 AREA IN SQUARE FOOT OF:
 Dwelling/Living 1800
 Garage/Storage 435
 Decks/Balconies N/A
 Carpports N/A
 SCOPE OF WORK: New Residential Construction

6-27-01

FOR OFFICE USE ONLY

- | | | |
|---|---|---|
| <input type="checkbox"/> Information Above Complete | <input type="checkbox"/> AR Flood Waiver Required | <input type="checkbox"/> Planning Approval |
| <input type="checkbox"/> Violation Files Checked | <input type="checkbox"/> Flood Elevation Certificate Required | <input type="checkbox"/> Design Review Approval |
| <input type="checkbox"/> Standard Setbacks | <input type="checkbox"/> Water Development Infill Area | <input type="checkbox"/> Special Fee Districts Apply: |
| <input type="checkbox"/> County Sewer | | |

THE FOLLOWING MUST BE PROVIDED IN ORDER TO SUBMIT FOR PERMIT

- 2 COMPLETE PLOT PLANS, LEGIBLE & DRAWN TO SCALE
- 11 X 17 COPY OF FLOOR PLAN WITH FOLLOWING INFORMATION

a) Assessors Parcel Number	c) Owners Name
b) New Floor Area	d) Project Address

SCALE : 1"=20'

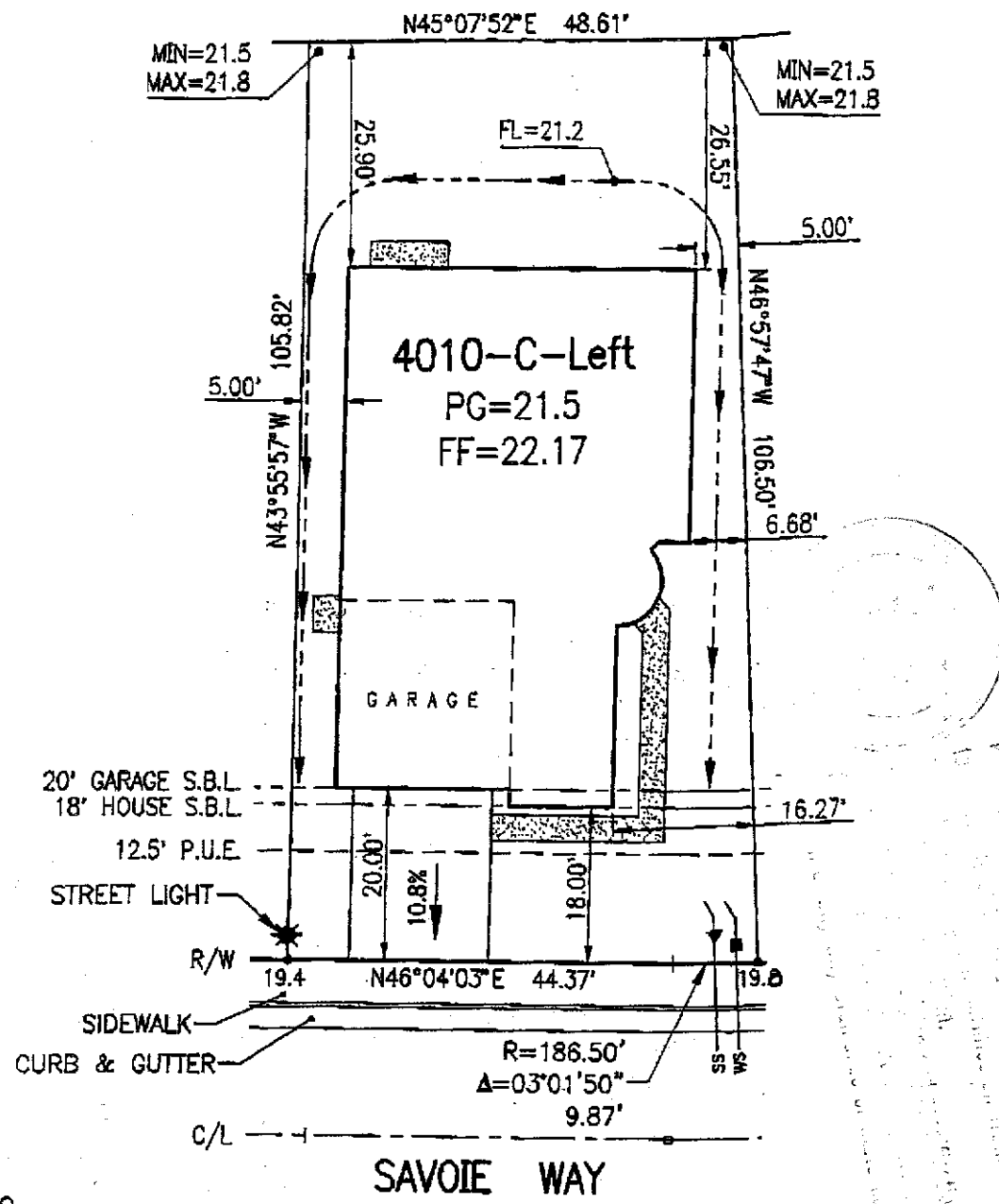

PLAN 4010
1-STORY
2-CAR GARAGE
LIVABLE AREA=1800 sf
GARAGE AREA= 435 sf
FOOTPRINT = 2236 sf

PLOT PLAN FOR LOT 52  WOODSIDE HOMES OF CA, INC.	Westborough ~ Village 1 , Phase 1		SCALE : 1"=20' Date: May 21, 2001
	ADDRESS: 4756 SAVOIE WAY CITY OF SACRAMENTO, NATOMAS SACRAMENTO COUNTY, CALIFORNIA	A.P.N.: 225-1570-013 Lot Area: 5461 s.f. Lot Coverage: 45.7%	Revised: Drawn By: T.D.B. Job No: 00-11-132