

SACRAMENTO CITY PLANNING COMMISSION 1-10- 67

REQUEST: Special Permit to utilize R-1 Single Family Residential zone for a church development with off street parking facility.

OWNER: Glen Elder Baptist Church.

APPLICANT: James O. Myart, 7513 Vallecitos Way, Sacramento

PROPERTY: Metes & Bounds parcel of land described as Parcel 9, Bk 38, 21 on County Assessors Records.
NO PARCELS: 1 AGGREGATE SIZE: 1.91 ACRES

LOCATION: 6613 Elder Creek Road

ZONING: R-1 Single Family Residential

STATEMENT: Proposed first stage of development to be a 25'x50' Bldg. to be used as a temporary meeting hall for approximately 60 member congregation, and parking area for 23 cars. Future church building to accommodate approximately 304 persons, plus classrooms and Pastor's office.

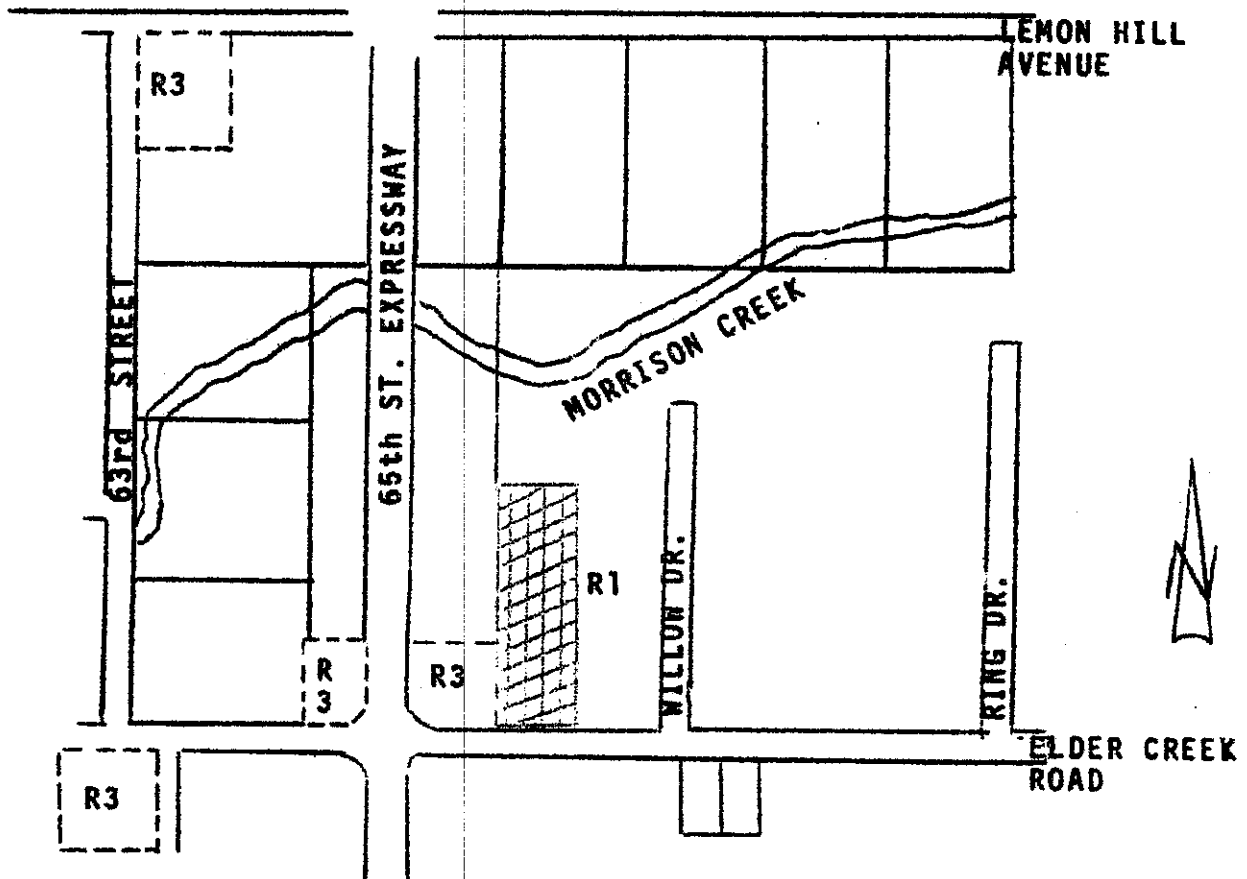

000250