

**CITY OF SACRAMENTO**  
1231 I Street, Sacramento, CA 95814

Permit No: 0103960

Insp Area: 4

Site Address: 510 EASTBROOK WY SAC  
Parcel No: 201-0420-021 NORTHBR 3-2 LOT 21

Sub-Type: NSFR  
Housing (Y/N): N

CONTRACTOR  
US HOME  
2366 GOLD MEADOW DR  
STE # 100 95670

OWNER

ARCHITECT

Nature of Work: MP 2566 2 STORY 9 ROOM SFR

**CONSTRUCTION LENDING AGENCY:** I hereby affirm under penalty of perjury that there is a construction lending agency for the performance of the work for which this permit is issued (Sec. 3607, Civ. C.)

Lender's Name \_\_\_\_\_ Lender's Address \_\_\_\_\_

**LICENSED CONTRACTORS DECLARATION:** I hereby affirm under penalty of perjury that I am licensed under provisions of Chapter 9 commencing with section 7000 of Division 3 of the Business and Professions Code and my license is in full force and effect.

License Class B License Number 45839 Date 4/13/01 Contractor Signature Don McCloskey

**OWNER-BUILDER DECLARATION:** I hereby affirm under penalty of perjury that I am exempt from the contractors License Law for the following reason (Sec. 7031.5, Business and Professions Code, any city or county which requires a permit to construct, alter, improve, demolish, or repair any structure, prior to its issuance, also requires the applicant for such permit to file a signed statement that he or she is licensed pursuant to the provisions of the Contractors License Law (Chapter 9 commencing with Section 7000) of Division 3 of the Business and Professions Code) or that he or she is exempt therefrom and the basis for the alleged exemption. Any violation of Section 7031.5 by any applicant for a permit subjects the applicant to a civil penalty of not more than five hundred dollars (\$500.00).

I, as a owner of the property, or my employees with wages as their sole compensation, will do the work, and the structure is not intended or offered for sale (Sec. 7044, Business and Professional Code: The Contractors License Law does not apply to an owner of property who builds or improves thereon, and who does such work himself or herself or through his/her own employees, provided that such improvements are not intended or offered for sale. If, however, the building or improvement is sold within one year of completion, the owner-builder will have the burden of proving that he/she did not build or improve for the purpose of sale.)

I, as owner of the property, am exclusively contracting with licensed contractors to construct the project (Sec. 7044, Business and Professions Code: The Contractors License Law does not apply to an owner of property who builds or improves thereon, and who contracts for such projects with a contractor(s) licensed pursuant to the Contractors License Law)

I am exempt under Sec. \_\_\_\_\_ B & PC for this reason: \_\_\_\_\_  
Date \_\_\_\_\_ Owner Signature \_\_\_\_\_

**IN ISSUING THIS BUILDING PERMIT,** the applicant represents, and the city relies on the representation of the applicant, that the applicant verified all measurements and locations shown on the application or accompanying drawings and that the improvement to be constructed does not violate any law or private agreement relating to permissible or prohibited locations for such improvements. This building permit does not authorize any illegal location of any improvement or the violation of any private agreement relating to location of improvements.

I certify that I have read this application and state that all information is correct. I agree to comply with all city and county ordinances and state laws relating to building construction and hereby authorize representative(s) of this city to enter upon the abovementioned property for inspection purposes.

Date 4/13/01 Applicant/Agent Signature Don McCloskey

**WORKER'S COMPENSATION DECLARATION:** I hereby affirm under penalty of perjury one of the following declarations:  
I have and will maintain a certificate of consent to self-insure for workers' compensation as provided for by Section 3700 of the Labor Code, for the performance of work for which the permit is issued.

I have and will maintain workers' compensation insurance, as required by Section 3700 of the Labor Code, for the performance of the work for which this permit is issued. My workers' compensation insurance carrier and policy number are:

Carrier WELLS REPUBLIC INS CO Policy Number MWC107468 00 Exp Date 11/01/2001

(This section need not be completed if the permit is for \$100 or less) I certify that in the performance of the work for which this permit is issued, I shall not employ any person in any manner so as to become subject to the workers' compensation laws of California and agree that if I should become subject to the workers' compensation provisions of Section 3700 of the Labor Code, I shall forthwith comply with those provisions.

Date 4/13/01 Applicant Signature Don McCloskey

**WARNING:** FAILURE TO SECURE WORKER'S COMPENSATION COVERAGE IS UNLAWFUL AND SHALL SUBJECT AN EMPLOYER TO CRIMINAL PENALTIES AND CIVIL FINES UP TO ONE HUNDRED THOUSAND DOLLARS (\$100,000) IN ADDITION TO THE COST OF COMPENSATION, DAMAGES AS PROVIDED FOR IN SECTION 3706 OF THE LABOR CODE, INTEREST AND ATTORNEY'S FEE.

**THIS PERMIT SHALL EXPIRE BY LIMITATION IF WORK IS NOT COMMENCED WITHIN 180 DAYS.**

RESIDENTIAL SUBDIVISION BUILDING PERMIT APPLICATION

Project Address: 310 Eastbrook Way Assessor Parcel # 201-0420-021  
Lot Number: 21 Subdivision NORTHBOROUGH VILLAGE 3-2

OWNER INFORMATION:

Legal Property Owner: US HOME Phone# 858-3900  
Owner Address: 366 GOLD MEADOW WAY City GOLD RIVER State CA. Zip 95670

CONTRACTOR INFORMATION:

Contractor: US HOME Lic. # 451839 Phone # 858-3900 Fax 858-3925  
DON McCLOSKEY 719-9059

PROJECT INFORMATION:

Land Use Zone R1A Occupancy Group R3 Construction Type VN Fed Code 1A  
No. of Stories: 2 No. of Rooms: \_\_\_\_\_ Street Width: \_\_\_\_\_  
1<sup>st</sup> Floor Area 1329 2<sup>nd</sup> Floor Area 1237 Basement \_\_\_\_\_ Roof Material \_\_\_\_\_  
AREA IN SQUARE FOOT OF:  
Dwelling/Living 25600  
Garage/Storage 445  
Decks/Balconies 33  
Carports \_\_\_\_\_  
SCOPE OF WORK: \_\_\_\_\_  
\_\_\_\_\_

FOR OFFICE USE ONLY

- Information Above Complete
- Violation Files Checked
- Standard Setbacks
- County Sewer
- AR Flood Waiver Required
- Flood Elevation Certificate Required
- Water Development Infill Area
- Planning Approval
- Design Review Approval
- Special Fee Districts Apply:

**THE FOLLOWING MUST BE PROVIDED IN ORDER TO SUBMIT FOR PERMIT**

- 2 COMPLETE PLOT PLANS, LEGIBLE & DRAWN TO SCALE
- 11 X 17 COPY OF FLOOR PLAN WITH FOLLOWING INFORMATION
  - a) Assessor's Parcel Number
  - b) New Floor Area
  - c) Owners Name
  - d) Project Address

Date: \_\_\_\_\_ Received by: (staff) \_\_\_\_\_ Permit # \_\_\_\_\_



# WesPac

**insulation**  
a MASCO Company



809 North Market Blvd., Ste. 11 • Sacramento, CA 95834  
(916) 927-7149 • Fax (916) 927-4257  
Lic. #487478

## Installed Insulation Certificate

We certify that the building insulation listed herein is installed in conformance with current energy conservation regulations, California Administrative Code, Title 24, State of California

R FACTOR	AREA	TYPE	INCHES/BACS (BLOWN)
R38	CEILING	FIBERGLASS BLOW	14.75" / 15 BAGS
R38	CEILING	FIBERGLASS BATTS	13"
R19	2X6 EXT. WALLS	FIBERGLASS BATTS	6.5"
R13	2X4 EXT. WALLS	FIBERGLASS BATTS	3.5"

US HOMES CORP.

Certified by

NATOMAS TRADITIONS

Address of Lot Number 1580 NATOMAS TRADITION/221

Title Secretary

Date Installed 09/25/01

Phase # \_\_\_\_\_



**WALLACE • KUHL & ASSOCIATES INC.**  
 GEOTECHNICAL ENGINEERING • CONSTRUCTION TESTING

3050 Industrial Blvd.  
 PO Box 1137  
 West Sacramento  
 California 95691  
 916-372-1434

DATE 7-20-01		JOB NO. 3425.17		WEATHER		TEMP. ° at ° at		AM PM	
PROJECT Northborough 3-2 US hms					Technician I <input type="checkbox"/>		Staff E/G <input type="checkbox"/>		
LOCATION Lot # 221					Technician II <input type="checkbox"/>		Project E/G <input type="checkbox"/>		
TYPE OF WORK Pull TEST					Technician III <input type="checkbox"/>		Senior E/G <input type="checkbox"/>		
Inside 50 mi. radius <input checked="" type="checkbox"/>			Outside 50 mi. radius <input type="checkbox"/>		Nuclear Densities <input type="checkbox"/>		Principal E/G <input type="checkbox"/>		
PERSONNEL		REG. HRS	OT HRS	TOTAL HRS	TRAVEL	ON JOB	VEHICLE		MILES
DS		1.0	0	1.5	5	7 <sup>40</sup> # 14			20

OBSERVATIONS: ON SITE AS REQUESTED TO PERFORM PULL TEST ON 5/8" ALL-THREAD FOR HITIZZ HOLD DOWN @ A PULL VALUE OF 7875 # "PER ATTACHED LETTER" AND A GAGE PSI. OF 3600 # US JACK E WITH GAGE # SE @ THE FOLLOWING LOCATION:

Lot # 221 - 1 EA. HITIZZ ON E/WALL OF KITCHEN PANTRY. PASSED

**FIELD REPORT**

Signed

Lot Area = 5,435 sf  
 Building Footprint = 2,021 sf  
 Gross Coverage = 37.2%  
 Porch Allowance = 54 sf  
 Net Coverage = 36.2%

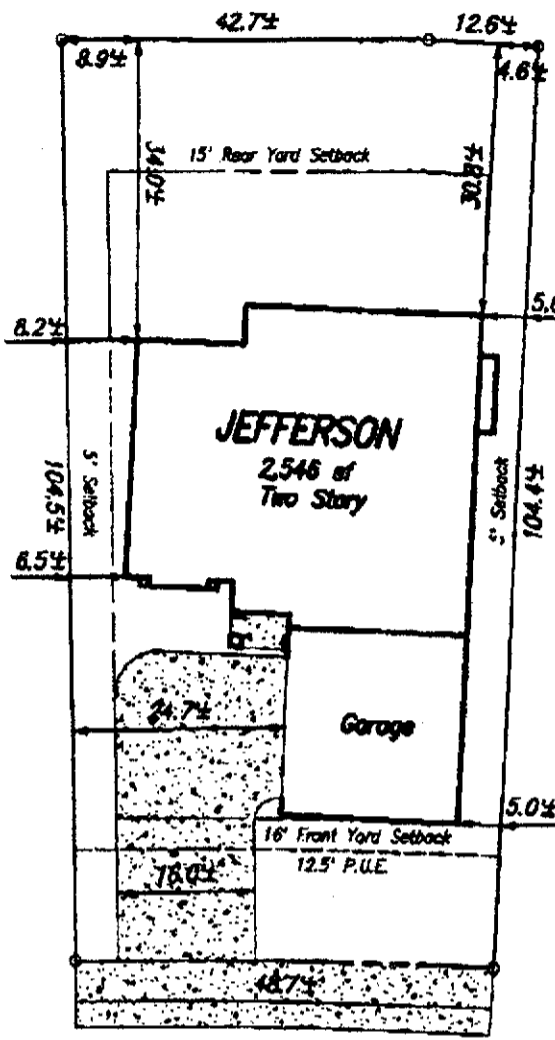

This plot plan is prepared in accordance with the provisions of the California Building Code and the California State Building Code. It is intended to show the location and specification of the proposed building and its relationship to the property lines. It is not intended to show the location and specification of the proposed building and its relationship to the property lines.

APN:  
201-042-021  
 Address:  
510 Eastbrook Way  
 Owner:  
 \_\_\_\_\_  
 Plan:  
2546 R

Eastbrook Way

Plot Plan for Lot 21 for Northborough Village 3-2  
 U.S.Home - Northborough - Traditions Series  
 City of Sacramento

**Note:**  
 This plot plan has been prepared for the purpose of showing the building foundation relationship to the property line, proposed drainage elevations and direction of flow to conform to local ordinances and for the purpose of building permit issuance. Information shown is approximate except for those setbacks which are minimums required by ordinance. This plot does not reflect as-built conditions which will likely vary from this plan.

Murray Smith & Associates  
 Engineering, Inc.  
 3110 Gold Canal Drive  
 Rancho Cordova, CA 95670  
 Ph.: (916) 635-1511

March 8, 2001

PN: 99003