

CITY OF SACRAMENTO
1231 I Street, Sacramento, CA 95814

Permit No: 0102480

Insp Area: 4

Site Address: 2324 SWAINSON WY SAC
Parcel No: SHOREBIRD UNIT 2 1 OT 81

Sub-Type: NSFR
Housing (Y/N): N

CONTRACTOR
CITATION NORTHERN
507 CENTER AVE. STE. 150
MARTINEZ CA. 94553

OWNER

ARCHITECT

Nature of Work: MP2161 2 STORY 9 ROOM SFR

CONSTRUCTION LENDING AGENCY: I hereby affirm under penalty of perjury that there is a construction lending agency for the performance of the work for which this permit is issued (Sec. 3097, Civ. C.)

Lender's Name _____ Lender's Address _____

LICENSED CONTRACTORS DECLARATION: I hereby affirm under penalty of perjury that I am licensed under provisions of Chapter 9 commencing with section 7000 of Division 3 of the Business and Professions Code and my license is in full force and effect.

License Class B License Number 547764 Date 3-9-01 Contractor Signature 

OWNER-BUILDER DECLARATION: I hereby affirm under penalty of perjury that I am exempt from the contractors License Law for the following reason (Sec. 7031.5, Business and Professions Code, any city or county which requires a permit to construct, alter, improve, demolish, or repair any structure, prior to its issuance, also requires the applicant for such permit to file a signed statement that he or she is licensed pursuant to the provisions of the Contractors License Law (Chapter 9 commencing with Section 7000) of Division 8 of the Business and Professions Code) or that he or she is exempt therefrom and the basis for the alleged exemption: Any violation of Section 7031.5 by any applicant for a permit subjects the applicant to a civil penalty of not more than five hundred dollars (\$500.00).

I, as a owner of the property, or my employees with wages as their sole compensation, will do the work, and the structure is not intended or offered for sale (Sec. 7044, Business and Professional Code). The Contractors License Law does not apply to an owner of property who builds or improves thereon, and who does such work himself or herself or through his/her own employees, provided that such improvements are not intended or offered for sale. If, however, the building or improvement is sold within one year of completion, the owner-builder will have the burden of proving that he/she did not build or improve for the purpose of sale.

I, as owner of the property, am exclusively contracting with licensed contractors to construct the project (Sec. 7044, Business and Professions Code). The Contractors License Law does not apply to an owner of property who builds or improves thereon, and who contracts for such projects with a contractor(s) licensed pursuant to the Contractors License Law.

I am exempt under Sec. _____ B & PC for this reason _____

Date _____ Owner Signature _____

IN ISSUING THIS BUILDING PERMIT, the applicant represents, and the city relies on the representation of the applicant, that the applicant verified all measurements and locations shown on the application or accompanying drawings and that the improvement to be constructed does not violate any law or private agreement relating to permissible or prohibited locations for such improvements. This building permit does not authorize any illegal location of any improvement or the violation of any private agreement relating to location of improvements.

I certify that I have read this application and state that all information is correct. I agree to comply with all city and county ordinances and state laws relating to building construction and hereby authorize representative(s) of this city to enter upon the abovementioned property for inspection purposes.

Date 3-9-01 Applicant Agent Signature 

WORKER'S COMPENSATION DECLARATION: I hereby affirm under penalty of perjury one of the following declarations:

I have and will maintain a certificate of consent to self-insure for workers' compensation as provided for by Section 3700 of the Labor Code, for the performance of work for which the permit is issued.

I have and will maintain workers' compensation insurance, as provided by Section 3700 of the Labor Code, for the performance of the work for which this permit is issued. My workers' compensation insurance carrier and policy number are:

Carrier _____ Policy Number _____ Exp Date _____

(This section need not be completed if the permit is for \$100 or less) I certify that in the performance of the work for which this permit is issued, I shall not employ any person in any manner so as to become subject to the workers' compensation laws of California and agree that if I should become subject to the workers' compensation provisions of Section 3700 of the Labor Code, I shall forthwith comply with those provisions.

Date 3-9-01 Applicant Signature 

WARNING: FAILURE TO SECURE WORKER'S COMPENSATION COVERAGE IS UNLAWFUL AND SHALL SUBJECT AN EMPLOYER TO CRIMINAL PENALTIES AND CIVIL FINES UP TO ONE HUNDRED THOUSAND DOLLARS (\$100,000) IN ADDITION TO THE COST OF COMPENSATION, DAMAGES AS PROVIDED FOR IN SECTION 3706 OF THE LABOR CODE, INTEREST AND ATTORNEY'S FEE.

THIS PERMIT SHALL EXPIRE BY LIMITATION IF WORK IS NOT COMMENCED WITHIN 180 DAYS.

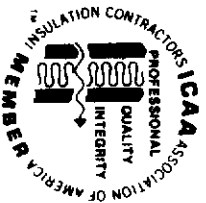

**INSULATION CONTRACTORS
ASSOCIATION
OF AMERICA**

INSULATION
CERTIFICATE

69803

1321 DUKE STREET, SUITE 303 • ALEXANDRIA, VA 22314 • (703) 739-0356

THIS IS TO CERTIFY THAT INSULATION HAS BEEN INSTALLED IN CONFORMANCE WITH CURRENT ENERGY REGULATIONS, CALIFORNIA ADMINISTRATIVE CODE, TITLE 24, STATE OF CALIFORNIA, IN THE BUILDING LOCATED AT

LOT # **81**

TRACT # **Swanson**

STREET **2324 Swanson** CITY **Stac**

EXTERIOR WALLS:

MANUFACTURER _____ THICKNESS/TYPE _____ VALUE _____ R-

CEILINGS:

BATTS: _____ THICKNESS/TYPE _____ VALUE _____ R-

MANUFACTURER _____ THICKNESS/TYPE _____ VALUE _____ R-

BLOWN IN: _____ MINIMUM _____ VALUE _____ R- **38**

MANUFACTURER _____ THICKNESS _____ VALUE _____ R-

SQUARE FOOTAGE COVERED _____ NUMBER OF BAGS USED _____ VALUE _____ R-

FLOORS: _____ THICKNESS/TYPE _____ VALUE _____ R-

MANUFACTURER _____ THICKNESS/TYPE _____ VALUE _____ R-

SLAB ON GRADE: _____ THICKNESS/TYPE _____ VALUE _____ R-

MANUFACTURER _____ THICKNESS/TYPE _____ VALUE _____ R-

WIDTH OF INSULATION _____ INCHES _____ VALUE _____ R-

FOUNDATION WALLS: _____ THICKNESS/TYPE _____ VALUE _____ R-

MANUFACTURER _____ THICKNESS/TYPE _____ VALUE _____ R-

GENERAL CONTRACTOR _____ DATE _____

CALIFORNIA CONTRACTORS LICENSE # _____

SIGNATURE _____ TITLE _____

INSULATION CONTRACTOR **ARCADE INSULATION**

CALIFORNIA CONTRACTORS LICENSE # **263784**

DATE **9-7-01**

SIGNATURE _____ TITLE _____

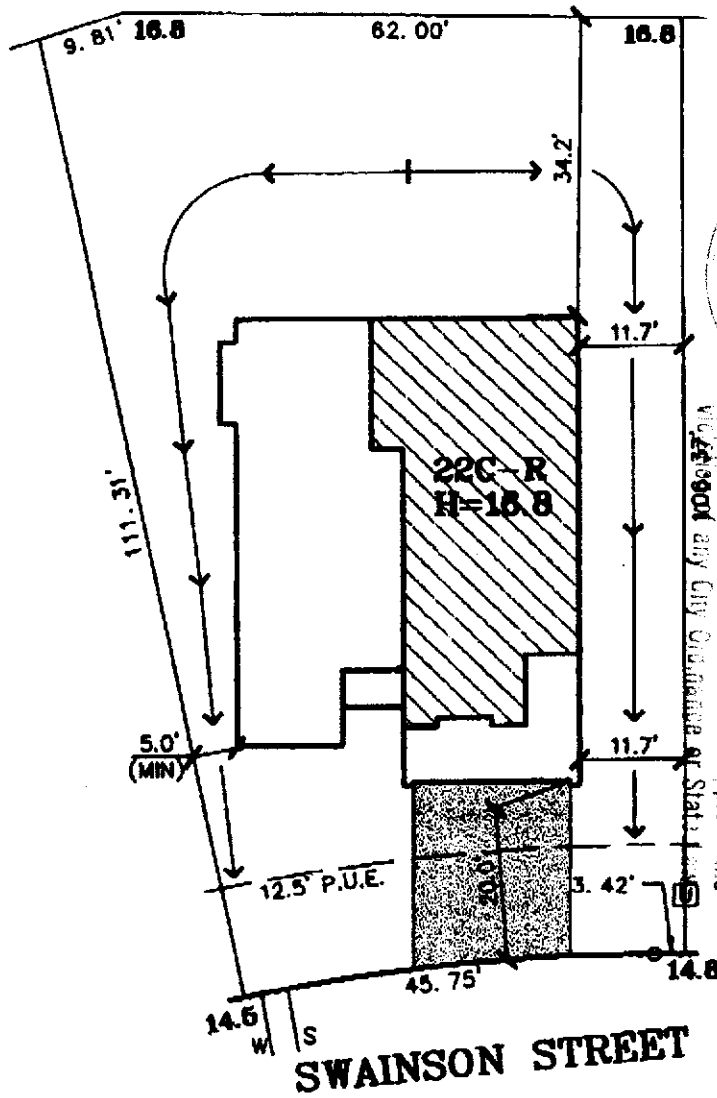

The approval of this plan and specification shall NOT be held to permit or approval of any City Ordinance or State law. The approval of this plan and specification shall NOT be held to permit or approval of any City Ordinance or State law. The approval of this plan and specification shall NOT be held to permit or approval of any City Ordinance or State law.



DATE 1-29-01

A.P.N.:

ADDRESS: SWAINSON STREET

LOT AREA: 6,666 SF
LOT COVERAGE: 29%

The Splink Corporation
 2590 VENTURE OAKS WAY
 SACRAMENTO, CA 95833
 PH (916)925-5550 FAX (916)921-9274

SHOREBIRD
 UNIT NO. 2
 LOT 81
 PLAN 22C

SHOREBIRD
 CITY OF SACRAMENTO, CA
 CLIENT: CITATION NORTHERN
 JOB NO.: 1579-001