

CITY OF SACRAMENTO  
1231 I Street, Sacramento, CA 95814

Permit No: 0006436  
Insp Area: 4

Site Address: 42 CARVER CT SAC  
Parcel No: LOT 59 NORTHPOINTE PARK UNIT 1  
N

Sub-Type: NSFR  
Housing (Y/N):

CONTRACTOR  
WESTERN PACIFIC HOUSING  
1210 CENTRAL BLVD  
BRENTWOOD CA. 94513

OWNER

ARCHITECT

Nature of Work: MP 2484 2 STORY 10 ROOM SFR

**CONSTRUCTION LENDING AGENCY** : I hereby affirm under penalty of perjury that there is a construction lending agency for the performance of the work for which this permit is issued (Sec. 3097, Civ. C).

Lender's Name \_\_\_\_\_ Lender's Address \_\_\_\_\_

**LICENSED CONTRACTORS DECLARATION**: I hereby affirm under penalty of perjury that I am licensed under provisions of Chapter 9 (commencing with section 7000) of Division 3 of the Business and Professions Code and my license is in full force and effect.

License Class B License Number 672709 Date 6/26/00 Contractor Signature N. Collins

**OWNER-BUILDER DECLARATION**: I hereby affirm under penalty of perjury that I am exempt from the contractors License Law for the following reason (Sec. 7031.5, Business and Professions Code; any city or county which requires a permit to construct, alter, improve, demolish, or repair any structure, prior to its issuance, also requires the applicant for such permit to file a signed statement that he or she is licensed pursuant to the provisions of the Contractors License Law (Chapter 9 (commencing with Section 7000) of Division 8 of the Business and Professions Code) or that he or she is exempt therefrom and the basis for the alleged exemption. Any violation of Section 7031.5 by any applicant for a permit subjects the applicant to a civil penalty of not more than five hundred dollars (\$500.00).

\_\_\_\_ I, as a owner of the property, or my employees with wages as their sole compensation, will do the work, and the structure is not intended or offered for sale (Sec. 7044, Business and Professional Code: The Contractors License Law does not apply to an owner of property who builds or improves thereon, and who does such work himself or herself or through his/her own employees, provided that such improvements are not intended or offered for sale. If, however, the building or improvement is sold within one year of completion, the owner-builder will have the burden of proving that he/she did not build or improve for the purpose of sale.)

\_\_\_\_ I, as owner of the property, am exclusively contracting with licensed contractors to construct the project (Sec. 7044, Business and Professions Code: The Contractors License Law does not apply to an owner of property who builds or improves thereon, and who contracts for such projects with a contractor(s) licensed pursuant to the Contractors License Law).

\_\_\_\_ I am exempt under Sec. \_\_\_\_\_ B & PC for this reason: \_\_\_\_\_

Date \_\_\_\_\_ Owner Signature \_\_\_\_\_

**IN ISSUING THIS BUILDING PERMIT**, the applicant represents, and the city relies on the representation of the applicant, that the applicant verified all measurements and locations shown on the application or accompanying drawings and that the improvement to be constructed does not violate any law or private agreement relating to permissible or prohibited locations for such improvements. This building permit does not authorize any illegal location of any improvement or the violation of any private agreement relating to location of improvements.

I certify that I have read this application and state that all information is correct. I agree to comply with all city and county ordinances and state laws relating to building construction and hereby authorize representative(s) of this city to enter upon the abovementioned property for inspection purposes.

Date 6/26/00 Applicant/Agent Signature N. Collins

**WORKER'S COMPENSATION DECLARATION**: I hereby affirm under penalty of perjury one of the following declarations:

\_\_\_\_ I have and will maintain a certificate of consent to self-insure for workers' compensation as provided for by Section 3700 of the Labor Code, for the performance of work for which the permit is issued.

I have and will maintain workers' compensation insurance, as required by Section 3700 of the Labor Code, for the performance of the work for which this permit is issued. My workers' compensation carrier and policy number are:

Carrier EAGLE INS. CO. Policy Number 4S-0000273 Exp Date 03/19/2001

\_\_\_\_ (This section need not be completed if the permit is for \$100 or less) I certify that in the performance of the work for which this permit is issued, I shall not employ any person in any manner so as to become subject to the workers' compensation laws of California and agree that if I should become subject to the workers' compensation provisions of Section 3700 of the Labor Code, I shall forthwith comply with those provisions.

Date 6/26/00 Applicant Signature N. Collins

**WARNING** FAILURE TO SECURE WORKER'S COMPENSATION COVERAGE IS UNLAWFUL AND SHALL SUBJECT AN EMPLOYER TO CRIMINAL PENALTIES AND CIVIL FINES UP TO ONE HUNDRED THOUSAND DOLLARS (\$100,000) IN ADDITION TO THE COST OF COMPENSATION, DAMAGES AS PROVIDED FOR IN SECTION 3706 OF THE LABOR CODE, INTEREST AND ATTORNEY'S FEE.

**THIS PERMIT SHALL EXPIRE BY LIMITATION IF WORK IS NOT COMMENCED WITHIN 180 DAYS.**

PERMISSION BUILDING PERMIT APPLICATION

Project Address: 42 Carver Court  
Lot Number 39

Assessor Parcel # \_\_\_\_\_  
Subdivision Northpointe Park Unit #/

**OWNER INFORMATION:**

Legal Property Owner: Western Pacific Housing Phone# (925) 634-6023  
Owner Address: 1210 Central Boulevard, City Brentwood, State Ca. Zip 94513

**CONTRACTOR INFORMATION:**

Contractor: western Pacific Lic# 075709/B Phone # (925) 634-6023 Fax 634-6166

**PROJECT INFORMATION:**

Land Use Zone RIA Occupancy Group R3 Construction Type YN Fed Code 1A

No. of Stories 2 No. of Rooms: \_\_\_\_\_ Street Width: \_\_\_\_\_

1<sup>st</sup> Floor Area 1229 2<sup>nd</sup> Floor Area 1255 Basement \_\_\_\_\_ Roof Material \_\_\_\_\_

**AREA IN SQUARE FOOT OF:**

Dwelling/Living 2484  
Garage/Storage 418 + 186  
Decks/Balconies 28  
Carports \_\_\_\_\_

**SCOPE OF WORK:**

- Information Above Complete
- Violation Files Checked
- Standard Setbacks
- County Sewer
- AR Flood Waiver Required
- Flood Elevation Certificate Required
- Water Development Infill Area
- Planning Approval
- Design Review Approval
- Special Fee Districts Apply:

**~THE FOLLOWING MUST BE PROVIDED IN ORDER TO SUBMIT FOR PERMIT~**

- 2 COMPLETE PLOT PLANS, LEGIBLE & DRAWN TO SCALE
- 1 X 17 COPY OF FLOOR PLAN WITH FOLLOWING INFORMATION
  - a) Assessor's Parcel Number
  - b) New Floor Area
  - c) Owners Name
  - d) Project Address

Date

Received by: (staff)

Permit #

# CERTIFICATION OF INSULATION

<b>ADDRESS OF TRACT</b> 42 Carver	<b>SACRAMENTO INSULATION CONTRACTORS</b> <input checked="" type="checkbox"/> P.O. BOX 854, WEST SACRAMENTO, CA 95691 LIC. #202026 <input type="checkbox"/> 1309 MELODY ROAD, MARYSVILLE, CA 95901 LIC. #202026 <input type="checkbox"/> P.O. BOX 9651, FRESNO, CA 93793-9651 LIC. #202026 <input type="checkbox"/> P.O. BOX 1631, RENO, NV 89505 LIC. #10675 <input type="checkbox"/> 3325 A PONDEROSA WAY, LAS VEGAS, NV 89118 LIC. #10675  DATE INSULATION COMPLETED
--------------------------------------	---

WALLS	CEILING	FLOORS
( SQUARE FEET )	( SQUARE FEET )	( SQUARE FEET )
TYPE OF INSULATION	TYPE OF INSULATION	TYPE OF INSULATION
FIBERGLASS	FIBERGLASS	FIBERGLASS
FORM	FORM	FORM
BATTS	BATTS & BLOW	BATTS
MANUFACTURER'S PRODUCT ID	MANUFACTURER'S PRODUCT ID	MANUFACTURER'S PRODUCT ID
MANUFACTURER	MANUFACTURER	MANUFACTURER
OCF	OCF	OCF
R - VALUE INSTALLED	APPLIED THICKNESS	MIN. INSTALLED WEIGHT PER SQUARE FOOT
R - VALUE INSTALLED	APPLIED THICKNESS	APPLIED THICKNESS
R-13	5 1/2"	R-50 1 1/4"
KNEE WALLS IF R-VALUE IS OTHER THAN WALL'S ABOVE		
MATERIAL	FORM	MANUFACTURER
FIBERGLASS	BATTS	OCF
AIR INFILTRATION SEALANT		
MANUFACTURER		
W R GRACE		

**THIS IS TO CERTIFY THAT INSULATION AND/OR SEALANT HAS BEEN INSTALLED IN CONFORMANCE WITH APPLICABLE CODES, MATERIAL STANDARDS AND REGULATIONS.**

SIGNATURE INSULATION CONTRACTOR	TITLE	DATE
[Signature]	MANAGER	11-13-00
SIGNATURE GENERAL CONTRACTOR	TITLE	DATE
REMARKS		



4290 Roseville Road  
North Highlands, CA 95660-5710  
(916) 486-4094  
Fax (916) 486-4187

Installation Card  
Fiber Reinforced Stucco

Job Name and Address: OFFICE BUILDING  
10014 BAYSAVA  
STREET

ICBO# 5269

11-13-00  
Date of job completion

LOT-A 59

Plastering Contractor:

Name: VISION PLASTERING  
Address: 8974 GREENBACH LN  
Telephone No.: 987 3324

Approved contractor as issued by Basalite/Pacific Stucco

This is to certify the exterior coating system at the above address, has been installed in accordance with the evaluation report specified above and the manufacturers instructions.

[Signature]  
Signature of authorized representative of  
plastering contractor

12-13-00  
Date

This installation card must be presented to the building inspector after completion of work and before final inspection

**LEGEND**

→ SWALE  
 □ MAILBOX

\* WOOD FENCE  
 ○ SIDEYARD GATE

SS SEWER SERVICE  
 WS WATER SERVICE

□ UTILITY SERVICE  
 F.F. FINISH FLOOR

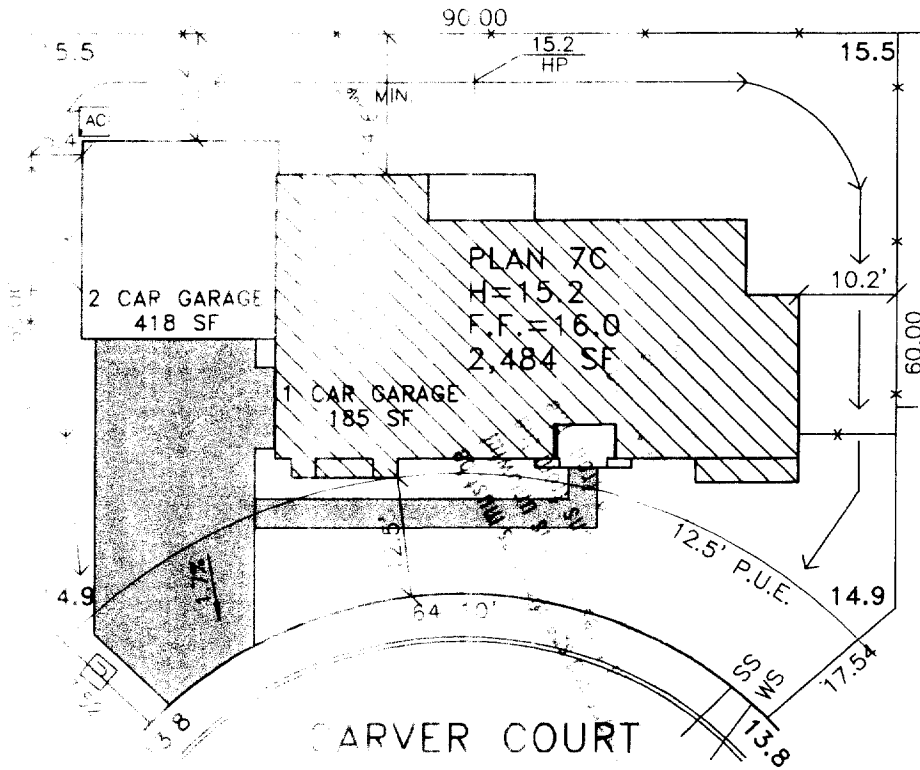

**LOT 59**  
**PLAN 7C**  
**A.P.N.:**  
**ADDRESS: CARVER COURT**  
**LOT AREA: 5,717 SF**

DUE TO THE UNIQUE CONDITIONS OF THIS LOT, THE BUYER HAS WALKED AND APPROVED THE SITE. FINAL GRADING CONDITIONS MAY VARY. THE INFORMATION ON THIS PLOT PLAN IS PROVIDED FOR YOUR CONVENIENCE AS A GUIDE TO THE GENERAL LOCATION OF THE SUBJECT PROPERTY. THE ACCURACY OF THIS PLOT PLAN IS NOT GUARANTEED NOR IS IT A PART OF ANY POLICY, REPORT OR GUARANTEE TO WHICH IT MAY BE ATTACHED. ACTUAL DIMENSIONS MAY VARY OR CHANGE WITHOUT PRIOR NOTICE DUE TO ACTUAL SITE CONDITIONS.

PLAN: \_\_\_\_\_ SIGNED (BUYER) \_\_\_\_\_ DATE \_\_\_\_\_  
 ELEVATION: \_\_\_\_\_  
 ORIENTATION: \_\_\_\_\_ PROJECT SUPERINTENDENT APPROVAL \_\_\_\_\_ DATE \_\_\_\_\_  
 COLOR: \_\_\_\_\_ SITE SUPERINTENDENT APPROVAL \_\_\_\_\_ DATE \_\_\_\_\_  
 ESTIMATING APPROVAL \_\_\_\_\_ DATE \_\_\_\_\_  
 SALES APPROVAL \_\_\_\_\_ DATE \_\_\_\_\_  
 CONSTRUCTION APPROVAL \_\_\_\_\_ DATE \_\_\_\_\_

**The Splink Corporation**  
 2590 VENTURE OAKS WAY  
 SACRAMENTO, CA. 95833

**Western Pacific Housing**  
 1210 Central Boulevard  
 Brentwood, CA 94513  
 office: (925) 634-6023  
 fax: (925) 634-6063

**SIENA**  
 NORTHPOINTE PARK UNIT 1  
 City of Sacramento, California

Scale: 1"=20' June 15, 2000