

CITY OF SACRAMENTO  
1231 I Street, Sacramento, CA 95814

Permit No: 0007933  
Insp Area: 4

Site Address: 2148 NEW HAMPSHIRE WY SAC  
Parcel No: 225-1130-063 PARKWAY PLAZA UNIT 2 LOT 63  
N

Sub-Type: NSFR  
Housing (Y/N):

CONTRACTOR  
LENNAR RENAISSANCE INC.  
2240 DOUGLAS BL  
ROSELILLE CA 95661

OWNER

ARCHITECT

Nature of Work: MP 133X 2 STORY 10 ROOM SFR

CONSTRUCTION LENDING AGENCY : I hereby affirm under penalty of perjury that there is a construction lending agency for the performance of the work for which this permit is issued (Sec. 3097, Civ. C).

Lender's Name \_\_\_\_\_ Lender's Address \_\_\_\_\_

LICENSED CONTRACTORS DECLARATION: I hereby affirm under penalty of perjury that I am licensed under provisions of Chapter 9 (commencing with section 7000) of Division 3 of the Business and Professions Code and my license is in full force and effect.

License Class \_\_\_\_\_ License Number T32346 Date 8/22/00 Contractor Signature [Signature]

OWNER-BUILDER DECLARATION: I hereby affirm under penalty of perjury that I am exempt from the contractors License Law for the following reason (Sec. 7031.5, Business and Professions Code: any city or county which requires a permit to construct, alter, improve, demolish, or repair any structure, prior to its issuance, also requires the applicant for such permit to file a signed statement that he or she is licensed pursuant to the provisions of the Contractors License Law (Chapter 9 (commencing with Section 7000) of Division 8 of the Business and Professions Code) or that he or she is exempt therefrom and the basis for the alleged exemption. Any violation of Section 7031.5 by any applicant for a permit subjects the applicant to a civil penalty of not more than five hundred dollars (\$500.00);

I, as a owner of the property, or my employees with wages as their sole compensation, will do the work, and the structure is not intended or offered for sale (Sec. 7044, Business and Professional Code: The Contractors License Law does not apply to an owner of property who builds or improves thereon, and who does such work himself or herself or through his/her own employees, provided that such improvements are not intended or offered for sale. If, however, the building or improvement is sold within one year of completion, the owner-builder will have the burden of proving that he/she did not build or improve for the purpose of sale.)

AUG 22 2000

I, as owner of the property, am exclusively contracting with licensed contractors to construct the project (Sec. 7044, Business and Professions Code: The Contractors License Law does not apply to an owner of property who builds or improves thereon, and who contracts for such projects with a contractor(s) licensed pursuant to the Contractors License Law).

CITY OF SACRAMENTO  
NEIGHBORHOODS PLANNING  
AND DEVELOPMENT SERVICES

I am exempt under Sec. \_\_\_\_\_ B & PC for this reason: \_\_\_\_\_

Date \_\_\_\_\_ Owner Signature \_\_\_\_\_

IN ISSUING THIS BUILDING PERMIT, the applicant represents, and the city relies on the representation of the applicant, that the applicant verified all measurements and locations shown on the application or accompanying drawings and that the improvement to be constructed does not violate any law or private agreement relating to permissible or prohibited locations for such improvements. This building permit does not authorize any illegal location of any improvement or the violation of any private agreement relating to location of improvements.

I certify that I have read this application and state that all information is correct. I agree to comply with all city and county ordinances and state laws relating to building construction and hereby authorize representative(s) of this city to enter upon the above mentioned property for inspection purposes.

Date 8/22/00 Applicant/Agent Signature [Signature]

WORKER'S COMPENSATION DECLARATION: I hereby affirm under penalty of perjury one of the following declarations:

I have and will maintain a certificate of consent to self-insure for workers' compensation as provided for by Section 3700 of the Labor Code, for the performance of work for which the permit is issued.

I have and will maintain workers' compensation insurance, as required by Section 3700 of the Labor Code, for the performance of the work for which this permit is issued. My workers' compensation insurance carrier and policy number are:

Carrier TRANSCONTINENTAL INSURANCE CO Policy Number WC166792277 Exp Date 06/01/2001

(This section need not be completed if the permit is for \$100 or less) I certify that in the performance of the work for which this permit is issued, I shall not employ any person in any manner so as to become subject to the workers' compensation laws of California and agree that if I should become subject to the workers' compensation provisions of Section 3700 of the Labor Code, I shall forthwith comply with those provisions.

Date 8/22/00 Applicant Signature [Signature]

WARNING: FAILURE TO SECURE WORKER'S COMPENSATION COVERAGE IS UNLAWFUL AND SHALL SUBJECT AN EMPLOYER TO CRIMINAL PENALTIES AND CIVIL FINES UP TO ONE HUNDRED THOUSAND DOLLARS (\$100,000) IN ADDITION TO THE COST OF COMPENSATION, DAMAGES AS PROVIDED FOR IN SECTION 3706 OF THE LABOR CODE, INTEREST AND ATTORNEY'S FEE.

THIS PERMIT SHALL EXPIRE BY LIMITATION IF WORK IS NOT COMMENCED WITHIN 180 DAYS.

# RESIDENTIAL BUILDING PERMIT APPLICATION

New Construction    
  Addition    
  Remodels    
  Other

Project Address: \_\_\_\_\_ Assessor Parcel # 225-111-1-0007

**OWNER INFORMATION:**

Legal Property Owner <u>Lennar Renaissance Inc.</u>	Phone # <u>(916) 773-4083</u>
Owner Address <u>2240 Douglas Blvd. #250</u>	City <u>Roseville</u> State <u>CA</u> Zip <u>95661</u>

**CONTRACTOR INFORMATION:**

Contractor <u>Same</u>	Lic. # <u>732348</u>	B	Phone # <u>773-4083</u>	Fax# <u>773-4086</u>
------------------------	----------------------	---	-------------------------	----------------------

**PROJECT INFORMATION:**

Land Use Zone <u>R/A</u>	Occupancy Group <u>R3</u>	Construction Type <u>VN</u>	Fed Code <u>1A</u>
No. of stories <u>2</u>	No. of rooms <u>10</u>	Street width <u>40</u>	
1 <sup>st</sup> Floor Area <u>1162</u>	2 <sup>nd</sup> Floor Area <u>975</u>	Basement _____	Roof Material _____

AREA IN SQUARE FOOT OF	EXISTING	NEW
Dwelling/Living		<u>2137</u>
Garage/Storage		<u>467</u>
Decks/Balconies		<u>98</u>
Carports		

SCOPE OF WORK: MP 2137/ 133X

**FOR OFFICE USE ONLY**

<input type="checkbox"/> Information above complete	<input type="checkbox"/> AR Flood Waiver required	<input type="checkbox"/> Planning Approval
<input type="checkbox"/> Violation files checked	<input type="checkbox"/> Flood Elevation Certificate Required	<input type="checkbox"/> Design Review Approval
<input type="checkbox"/> Standard setbacks	<input type="checkbox"/> Water Development Infill Area	<input type="checkbox"/> Special Fee Districts Apply _____
<input type="checkbox"/> County Sewer		

**NEW STRUCTURES & ADDITIONS**

❖ THE FOLLOWING MUST BE PROVIDED IN ORDER TO SUBMIT FOR PLAN REVIEW

<input type="checkbox"/> 2 COMPLETE PLANS, LEGIBLE & DRAWN TO SCALE <input type="checkbox"/> 3 SETS IF PROJECT IS IN A DESIGN REVIEW AREA	❖ Plans to include site plan, floor plan, elevations, roof ceiling plan, foundation and structural framing details, and structural calculations for non-conforming structures
<input type="checkbox"/> Title 24 Energy Compliance documentation <input type="checkbox"/> Grading and Erosion Control Questionnaire	<input type="checkbox"/> 11-0117 copy of floor plan for County Assessor <input type="checkbox"/> Plan Review Fees

Date: \_\_\_\_\_ Received by: (staff)

ACTIVITY PERMIT #

#63 OMEGA PRODUCTS INTERNATIONAL, INC.

DIAMOND WALL INSULATING STUCCO SYSTEM

JOB ADDRESS:

ICBO Report #4004

RENAISSANCE

SANDALWOOD

Date of Job Completion 12/29/00

PLASTERING CONTRACTOR:

Name: STUCCO WORKS INC

Address: 5900 WAREHOUSE WAY SACRAMENTO CA

Telephone No: (916) 383 66 99

Contractor Number of Diamond Wall System 2175

This is to certify that the exterior coating system on the building exterior at the above address has been installed in accordance with the evaluation report specified above and the manufacturer's instructions.

2/01/01

Date

[Signature] Signature of authorized representative of Plastering Contractor

This installation card must be presented to the building inspector after completion of work and approval of the installation.



# WesPac

## insulation

a MASCO Company



809 North Market Blvd., Ste. 11 • Sacramento, CA 95834

(916) 927-7149 • Fax (916) 927-4257

Lic. #487478

### Installed Insulation Certificate

We certify that the building insulation listed herein is installed in conformance with current energy conservation regulations, California Administrative Code, Title 24, State of California

RECTOR	AREA	TYPE	INCHES/BAGS (BLOWN)
3	Attic	blow	10
19	Basement	blow	4
13	Basement	blow	3.5

Certified by [Signature]

Shawwood Pot 1/3

Title \_\_\_\_\_

Address or Lot Number

191-110

Date Installed \_\_\_\_\_

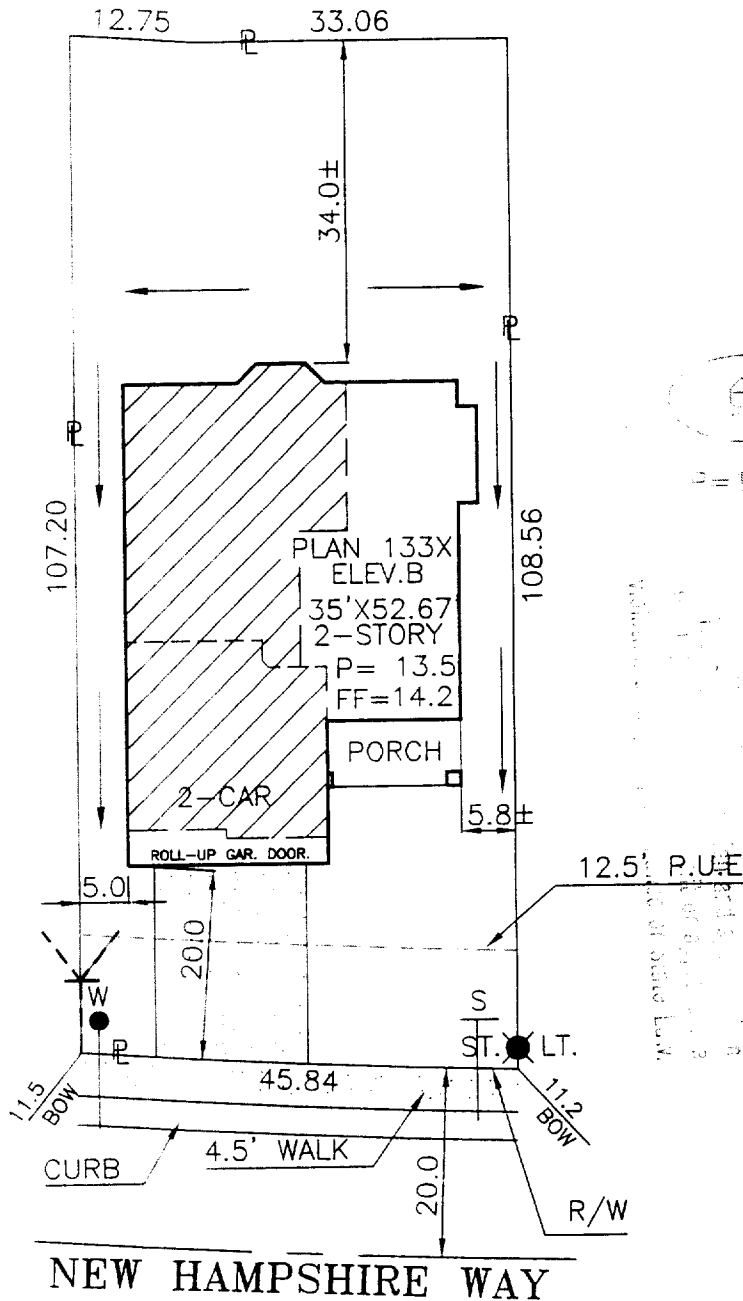

64  
P=13.5

Engineer's Seal  
Professional Engineer  
State of California  
No. 12345  
Exp. 12/31/2005

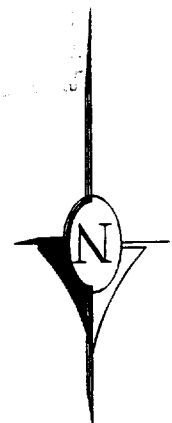

DIMENSIONS SHOWN ARE APPROXIMATE EXCEPT FOR MINIMUMS REQUIRED BY ORDINANCE. THIS PLOT DOES NOT REFLECT AS BUILT CONDITIONS AND MAY VARY FROM THIS PLAN.

<h1>RENAISSANCE HOMES</h1> <p>2240 DOUGLAS BLVD. SUITE 250 ROSEVILLE, CA. 95661 PHONE (916) 773-4083 FAX (916) 773-4086</p>	SANDALWOOD		PLOT PLAN
	PARKWAY PLAZA UNIT 2 CITY OF SACRAMENTO SACTO. COUNTY, CALIFORNIA		NOTES: CURVED LINES ARE CHORD MEASUREMENTS.
ADDRESS: 2148 NEW HAMPSHIRE WAY	LOT COV: 32.4%		
PLAN NO.: 133X-B	LOT SQ. FT.: 4,931.6	APN: 225-113-063-000	
DRAWN BY: R.P.	APPROVED BY: <i>[Signature]</i>	DATE: 7/7/00	SCALE: 1"=20'
			<b>LOT 63</b>